

rapoo

rapoo MT560 Multi
Mode Wireless
Mouse



rapoo MT560 Multi Mode Wireless Mouse User Guide

[Home](#) » [rapoo](#) » rapoo MT560 Multi Mode Wireless Mouse User Guide 

Contents

- 1 [rapoo MT560 Multi Mode Wireless Mouse](#)
- 2 [Overview](#)
- 3 [Packaging contents](#)
- 4 [Connection mode](#)
- 5 [Bluetooth mode](#)
- 6 [Switching among Bluetooth devices](#)
- 7 [Install driver](#)
- 8 [Safety Instructions](#)
- 9 [Warranty conditions](#)
- 10 [System requirements](#)
- 11 [Legal & Compliance Information](#)
- 12 [Recycling Information](#)
- 13 [Documents / Resources](#)
 - 13.1 [References](#)
- 14 [Related Posts](#)

rapoo

rapoo MT560 Multi Mode Wireless Mouse



Overview



- A Left button
- B Right button
- C Middle button/scroll wheel
- D Power and Connection Indicator
- E DPI Button
- F Side Scroll Wheel

- G Forward Button
- H Back Button
- Charging Port
- J Bluetooth Button
- K Bluetooth Indicator
- L Receiver Storage Bin
- M 2.4G Mode
 - Power Off
 - Bluetooth Mode

Packaging contents

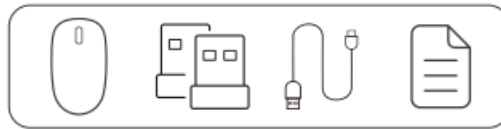

Connection mode

Connection mode

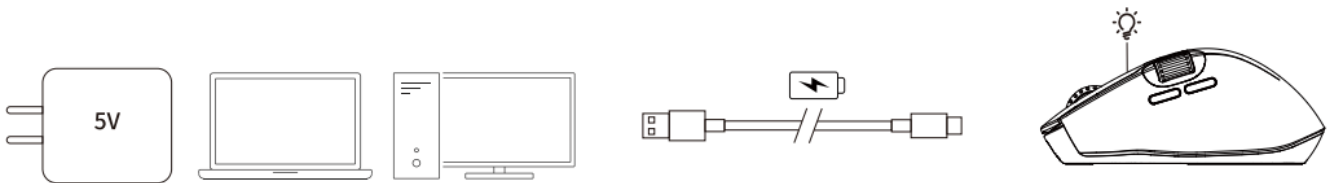

Lower Power Indication: Red indicator flashes (twice a second for 5 seconds) Charging: White indicator goes on
Fully Charged: Whited indicator goes off

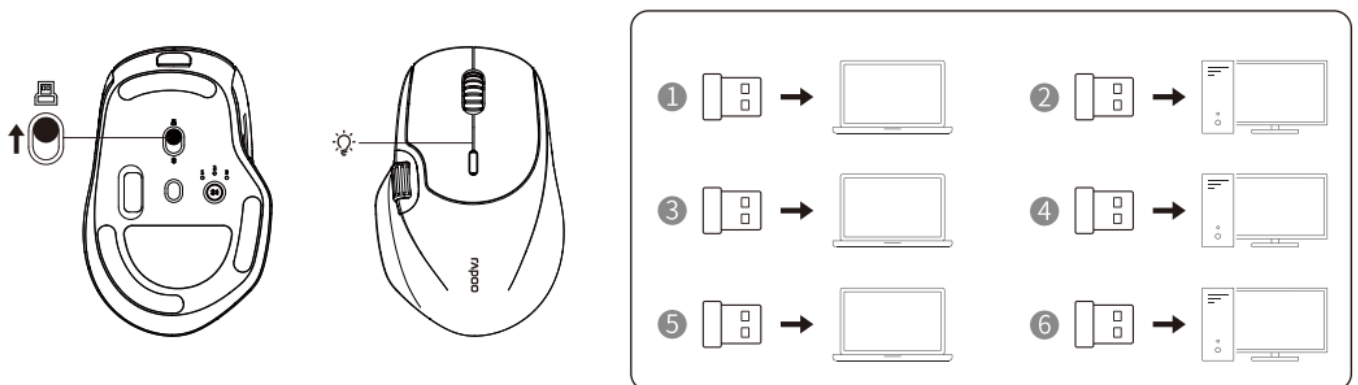

The mice can connect up to 6 receivers. The retail packaging includes 2 receivers are already connected to the mouse. Please purchase extra 4 receivers which needs to be paired by user (Please visit www.rapoo-eu.com for pairing steps)

Bluetooth mode

Connecting Device A

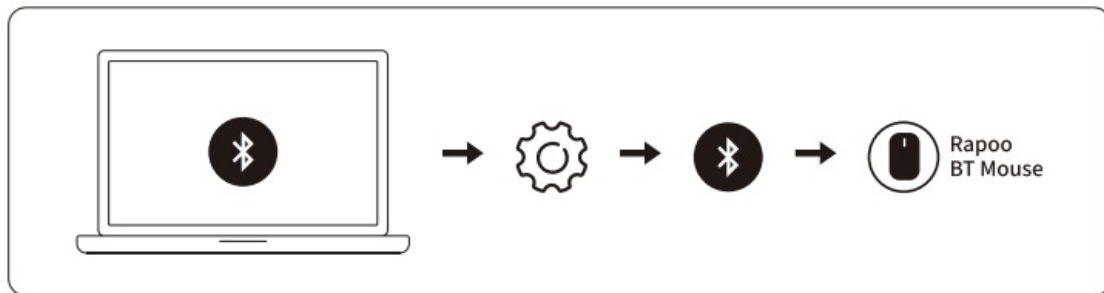
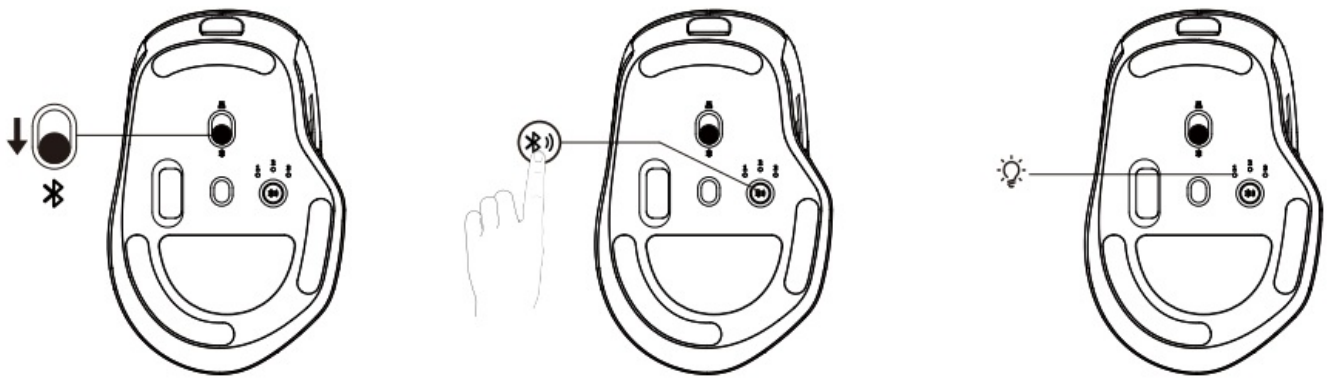

Press and hold the Bluetooth button more than 3 seconds for pairing: the green flashes rapidly twice a second; the light goes off if pairing is failed after 2 minute.

Connecting Device B and C

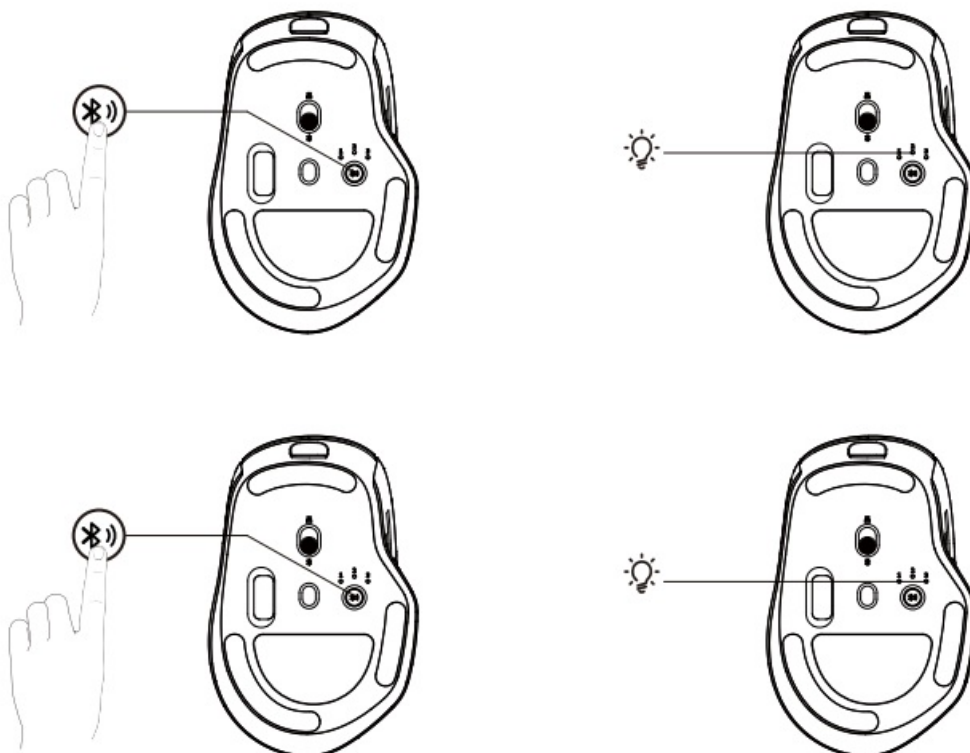

- Briefly press the Bluetooth button for switching: the green light flashes slowly once a second; the light goes off if pairing is failed after 30 seconds.
- Press and hold the Bluetooth button more than 3 seconds for pairing: the green flashes rapidly twice a second; the light goes off if pairing is failed after 2 minutes.

Switching among Bluetooth devices

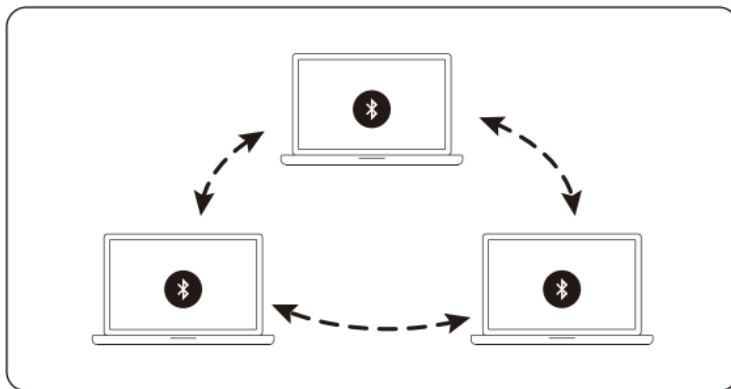
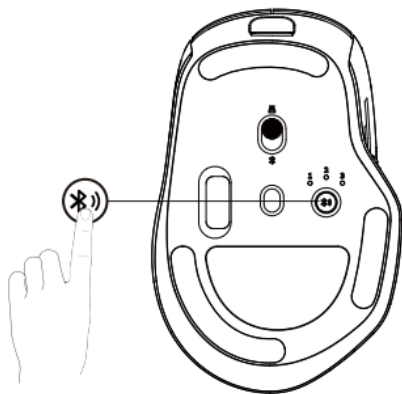

Briefly press the Bluetooth button to change among 3 paired devices.

Wired Mode

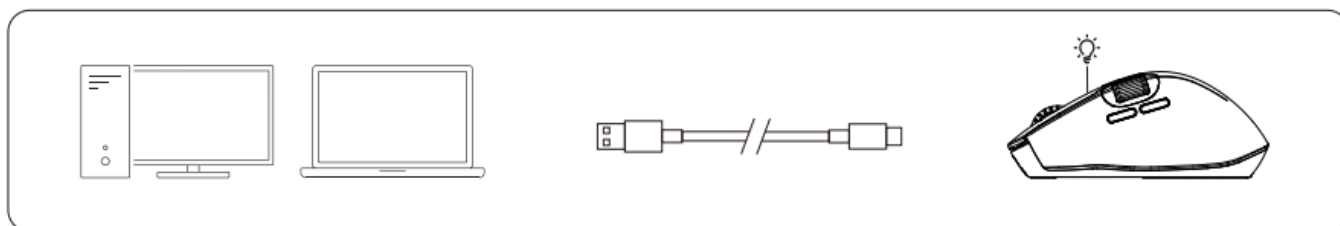

Wired Connection: The green light of the connection indicator is on for 3 seconds, while the white light of the power indicator stays on, and charging is carried out during connection and use.

Install driver

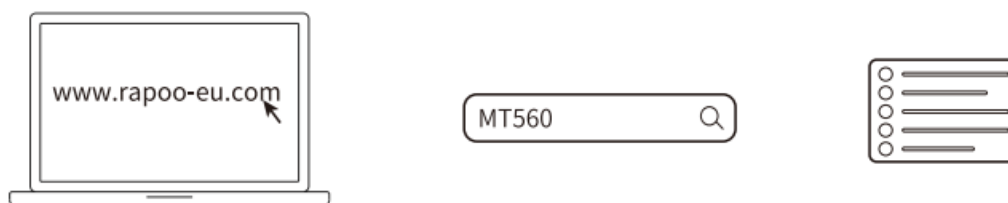

M+ Cross-device transmission function

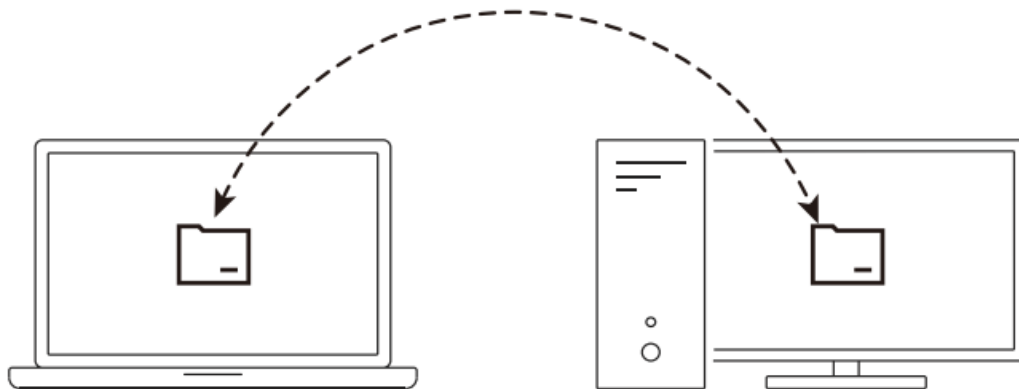

File transmission can be done by copying and pasting under Windows when mice is connected with 2,4Gj all paired devices are installed with driver and connected with same LAN in the same domain. File transmission doesn't support drag and drop among devices.

Safety Instructions



Please scan the QR code

Warranty conditions



This device is covered by a 2-year limited hardware warranty from the date of purchase.

System requirements

Windows7/8/10/11, Mac OS X 10.4 or later, USB port

Legal & Compliance Information

- Product: Rapoo Multi-mode Wireless Mouse

- Model: MT560 www.rapoo-eu.com as-europe@rapoo.com



Conformity Information: Hereby, Rapoo Europe B.V. declares that this radio equipment product is in compliance with Directive 2014/53 EU (RED) and all other applicable EU Regulations. The full text of the EU Declaration of Conformity is available at the following internet address: www.rapoo-eu.com. Operating frequency band: 2402-2479MHz Maximum radio-frequency power transmitted: 5dBm/3.16mW



Conformity Information United Kingdom: Hereby, ProductIP (I-JK) Ltd., as authorized representative of Rapoo Europe B.V., declares that this radio equipment product is in compliance with the UK Radio Equipment Regulations 2017 and all other applicable UK Regulations. The full text of the UK Declaration of Conformity is available at the following internet address: www.rapoo-eu.com. Operating frequency band: 2402 to 2479 MHz. Maximum radio-frequency power transmitted: 5d Bm/3.16mW

Recycling Information

Disposal of Packaging Materials: The packaging materials have been selected for their environmental friendliness and are recyclable.

Dispose of packaging materials which are no longer needed in accordance with applicable local regulations,

Disposal of the Device: The symbol above and on the product means that the product is classed as Electrical or Electronic equipment and should not be disposed with other household or commercial waste at the end of its useful life. The Waste of Electrical and Electronic Equipment (WEEE) Directive has been put in place to recycle products using best available recovery and recycling techniques to minimise the impact on the environment, treat any hazardous substances and avoid the increasing landfill. Contact local authorities for information on the correct disposal of Electrical or Electronic equipment.

Disposal of Batteries: used batteries may not be disposed of in normal household waste. All consumers are required by law to dispose of batteries at a collection point provided by their local community or at a retail store, The purpose of this obligation is to ensure that batteries are disposed of in a non-polluting manner. Only dispose of batteries when they are fully discharged Cover the poles of partially discharged batteries with tape to prevent short circuits.

Made in China

©2024 Rapoo. All rights reserved. The Bluetooth & word mark and logos are registered trademarks owned by Bluetooth SIG, Inc. and any use of such marks by Rapoo is under license, Rapoo, the Rapoo logo and other Rapoo marks are owned by Rapoo and may be registered. All other trademarks are property of their respective owners. It's forbidden to reproduce any part of this quick start guide without the permission of Rapoo.

Documents / Resources



[rapoo MT560 Multi Mode Wireless Mouse](#) [pdf] User Guide
MT560 Multi Mode Wireless Mouse, MT560, Multi Mode Wireless Mouse, Mode Wireless Mouse, Wireless Mouse

References

- [User Manual](#)

Manuals+. Privacy Policy

This website is an independent publication and is neither affiliated with nor endorsed by any of the trademark owners. The "Bluetooth®" word mark and logos are registered trademarks owned by Bluetooth SIG, Inc. The "Wi-Fi®" word mark and logos are registered trademarks owned by the Wi-Fi Alliance. Any use of these marks on this website does not imply any affiliation with or endorsement.