

RAPOO 9700M Wireless Keyboard and Mouse



# RAPOO 9700M Wireless Keyboard and Mouse Instruction Manual

[Home](#) » [rapoo](#) » RAPOO 9700M Wireless Keyboard and Mouse Instruction Manual 

## Contents

- [1 RAPOO 9700M Wireless Keyboard and Mouse](#)
- [2 CONNECTION](#)
- [3 Overview](#)
- [4 Instructions](#)
- [5 Bluetooth mode](#)
- [6 Warranty conditions](#)
- [7 Troubleshooting](#)
- [8 Package contents](#)
- [9 Documents / Resources](#)
  - [9.1 References](#)

# rapoo

## RAPOO 9700M Wireless Keyboard and Mouse



## CONNECTION

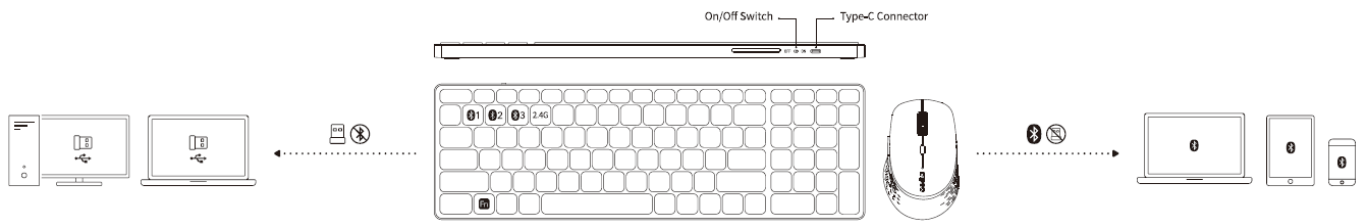

## Overview

### Keyboard

- Fn + F1\* = Back button
- Fn + F2\* = Forward button
- Fn + F3\* = Homepage
- Fn + F4\* = Email
- Fn + F5\* = Multimedia player
- Fn + F6 = Play / Pause
- Fn + F7\* = Stop
- Fn + F8 = Previous track
- Fn + F9 = Next track
- Fn + F10 = Volume-
- Fn + F11 = Volume+
- Fn + F12 = Mute

### Mouse

1. = Left button
2. = Right button
3. = Middle button/scroll wheel
4. = Forward button
5. = Back button
6. = DP| switching button
7. = Bluetooth button
8. = On/off switch
9. = Status LED

(Windows only)

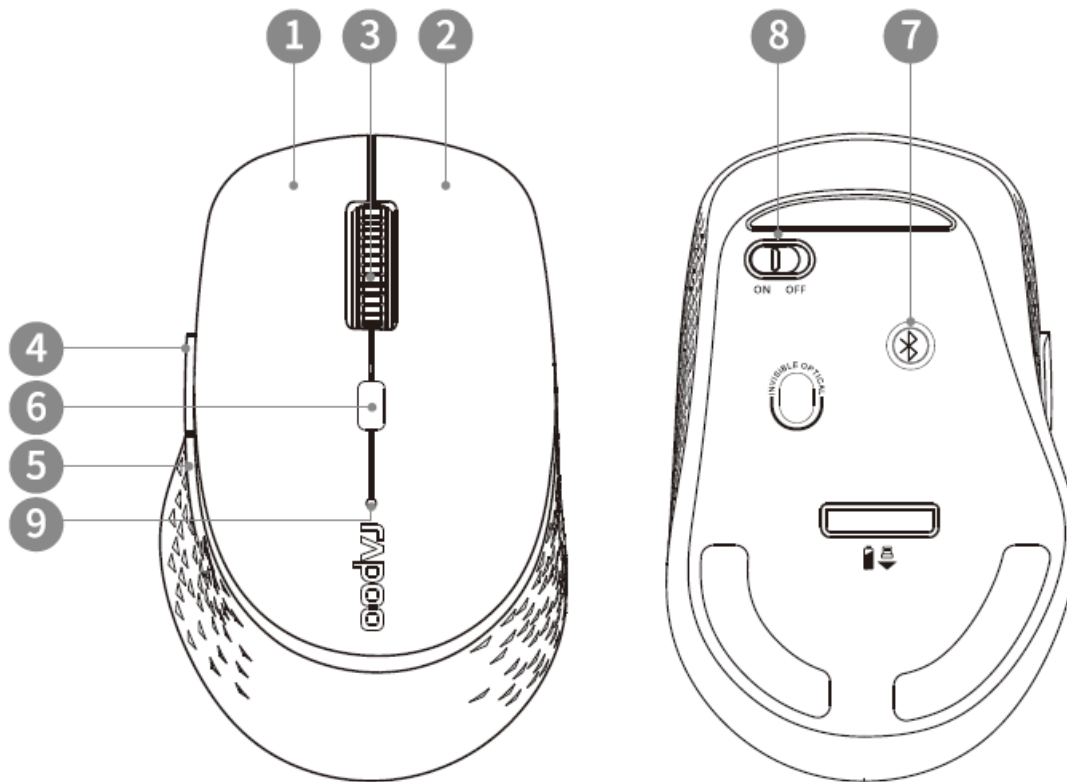

## Instructions

### Getting started

- **Keyboard:** We recommend charging the battery fully before first use.
- **Mouse:** The battery of the mouse is pre-installed. Please remove the label next to the battery.

### GHz

1. Plug the included USB receiver into a USB port on your computer.
2. Turn on the keyboard and the mouse. 2.4GHz mode should be active automatically.

If not, please follow these steps:

**Keyboard:** Press Fn+4 to activate 2.4 GHz mode.

**Mouse:** Press the Bluetooth button shortly until 2.4GHz mode is active (no LED active).

### Bluetooth mode

#### Keyboard

1. Turn on the keyboard.
2. Press and hold key combinations, Fn+1, Fn+2 or Fn+3 at least 3 seconds to pair 3 different devices via Bluetooth. The Status LED flashes blue slowly and the keyboard is discoverable for 120 seconds.
3. Complete "Bluetooth pairing" on your device. When the keyboard and your device are paired, the Status LED turns off.

#### Mouse

1. Turn on the mouse.
2. Press the Bluetooth button shortly to select the channel for device 1 (green LED flashes fast) or device 2 (blue LED flashes fast)
3. Keep pressing the Bluetooth button at least 3 seconds to pair. The Status LED flashes green or blue slowly. The mouse is discoverable for 120 seconds.
4. Complete "Bluetooth pairing" on your device. When the mouse and your device are paired, the Status LED turns off.

## **Bluetooth pairing**

1. Open the Bluetooth settings on your device.
2. Select the keyboard or mouse from the list.  
**Mouse:** RAPOO 3.0MS / RAPOO 5.0MS  
**Keyboard:** RAPOO 3.0KB / RAPOO 5.0KB
3. Click Pair and follow any other instructions that may appear on the screen.

## **Switching among paired devices**

### **Keyboard**

Press key combinations Fn+1, Fn+2, Fn+3 or Fn+4 to switch among paired devices.

You can connect the keyboard with up to 4 devices at the same time. (3 devices via Bluetooth, 1 device via USB 2.4 GHz receiver)

### **Mouse**

Press the Bluetooth button to switch between paired devices.

You can connect the mouse with up to 3 devices at the same time. (2 devices via Bluetooth, 1 device via USB 2.4 GHz receiver)

When you pick up the mouse, the Status LED shows which device is active.

1. Status LED stays stable for some seconds = Bluetooth device 1 is connected.
2. Status LED flashes slowly red for some seconds = Bluetooth device 2 is connected.
3. Status LED stays off = USB 2.4GHz receiver is connected.

## **DPI switch**

You can change the DPI by pressing the DPI switching button. For settings 1-4, the Status LED will flash 1, 2, 3 or 4 times.

### **Low battery**

#### **Keyboard**

If the status LED flashes constantly, it means the battery power is low. Please recharge the battery by using the cable included.

#### **Mouse**

If the status LED flashes twice every two seconds, it means the battery power is low. Please change the battery.

## **Warranty conditions**

- This device is covered by a 2-year limited hardware warranty from the date of purchase. For more information, please visit [www.rapoo-eu.com](http://www.rapoo-eu.com).

## **Troubleshooting**

1. Sleep mode: When not using the device for some time it will fall into a sleep mode to save battery.

You can press any key to wake it up again for further use.

2. If you are connected via Bluetooth and you may have issues with missing letters while typing, please connect again while using the alternative second Bluetooth Option to pair (BT3.0 or B5.0).
3. If you need more information, please visit [www.rapoo-eu.com](http://www.rapoo-eu.com). There you will find our FAQs. You can also download the latest drivers and User manuals for our products there.

### System requirements

Windows® 7/8/10/11, Mac OS X 10.4 or later, USB port

### Safety instructions

1. Never attempt to open the device or repair it yourself.
2. Do not use the device in a humid environment.
3. Please clean the device with a soft, dry cloth.

### Package contents

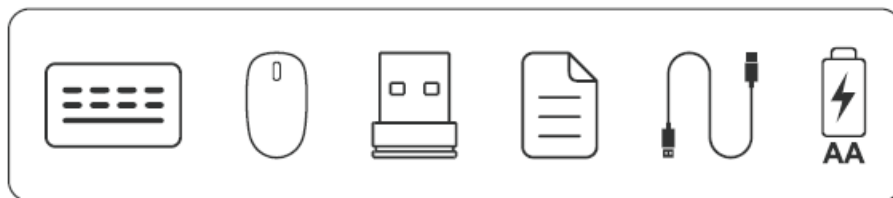

### Legal & Compliance Information

- Product: Rapoo Wireless Keyboard and Mouse
- Model: 9700M
- [www.rapoo-eu.com](http://www.rapoo-eu.com)
- [as-europe@rapoo.com](mailto:as-europe@rapoo.com)

### Manufacturer:

- Rapoo Europe B.V.
- Prismalaan West 27
- 2665 PC Bleiswijk
- The Netherlands

### UK Authorized Representative

- (for authorities only):
- ProductIP (UK) Ltd.
- 8, Northumberland Av.
- London WC2N 5BY
- United Kingdom

**Conformity Information:** Hereby, Rapoo Europe B.V. declares that this radio equipment product complies with Directive 2014/53 EU (RED) and all other applicable EU Regulations. The full text of the EU Declaration of

Conformity is available at the following internet address: [www.rapoo-cu.com](http://www.rapoo-cu.com). Operating frequency band: 2402-2480MHz Maximum radio-frequency power transmitted: 5dRm/3. 16mW



**Conformity Information United Kingdom:** Hereby, ProductiP (UK Llo., as an authorized representative of Kapoor Europe TV. declares that this radio equipment product complies with the UK Kolo equipment keg ations 2011/and all other applicable UK regulations. ner full text of the UK Declaration of Conformity is available at the following internet actress [www.rapoo-pu.com](http://www.rapoo-pu.com). Operating frequency band: 2402 to 2480 MHz. Maximum radio-frequency power transmitted: 5dBm/3.16mI.



**Disposal of the Device:** The symbol above and on the product means that the product 1ac Slorneal Nestor is not and should not be disposed of with other household or commercial waste at the end of its useful life. The Wasco of Electrical and Electronic Equipment VE Direstin has been put in place to read products using the best available recovery and ravelins technique to minimise the impact on the environmen.

©2023 Rapoo. All rights reserved. The Bluetooth® word mark and logos are registered trademarks owned by Bluetooth SIG, Inc. and any use of such marks by Rapoo is under license. Rapoo, the Rapoo logo and other Rapoo marks are owned by Rapoo and may be registered . All other trademarks are the property of their respective owners. It's forbidden to reproduce any part of this quick start guide without the permission of Rapoo.

[www.rapoo-eu.com](http://www.rapoo-eu.com).



---

## Documents / Resources

	<p><a href="#">RAPOO 9700M Wireless Keyboard and Mouse</a> [pdf] Instruction Manual 9700M, 9700M Wireless Keyboard and Mouse, Wireless Keyboard and Mouse, Keyboard and Mouse, Mouse</p>
---	--

## References

- [User Manual](#)

[Manuals+](#), [Privacy Policy](#)

This website is an independent publication and is neither affiliated with nor endorsed by any of the trademark owners. The "Bluetooth®" word mark and logos are registered trademarks owned by Bluetooth SIG, Inc. The "Wi-Fi®" word mark and logos are registered trademarks owned by the Wi-Fi Alliance. Any use of these marks on this website does not imply any affiliation with or endorsement.