

rapoo 13560 Keyboard and Mouse Set



rapoo 13560 Keyboard and Mouse Set Instruction Manual

[Home](#) » [rapoo](#) » rapoo 13560 Keyboard and Mouse Set Instruction Manual 

Contents

- 1 rapoo 13560 Keyboard and Mouse Set
- 2 Overview Keyboard
- 3 Instructions
- 4 Switching among paired devices
- 5 Warranty conditions
- 6 Troubleshooting
- 7 Documents / Resources
- 7.1 References



rapoo 13560 Keyboard and Mouse Set



WIRELESS KEYBOARD AND MOUSE 9700M

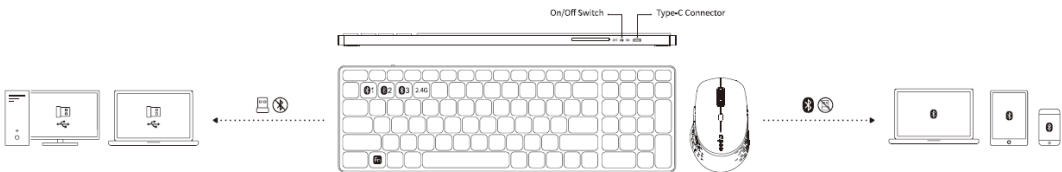

Overview Keyboard

- **Fn + F1*** = Back button
- **Fn + F2*** = Forward button
- **Fn + F3*** = Homepage
- **Fn + F4*** = Email
- **Fn + F5*** = Multimedia player
- **Fn + F6** = Play / Pause
- **Fn + F7*** = Stop
- **Fn + F8** = Previous track
- **Fn + F9** = Next track
- **Fn + F10** = Volume-
- **Fn + F11** = Volume+
- **Fn + F12** = Mute

Mouse

- **1** = Left button
- **2** = Right button
- **3** = Middle button/scroll wheel
- **4** = Forward button
- **5** = Back button
- **6** = DP| switching button
- **7** = Bluetooth button
- **8** = On/off switch
- **9** = Status LED

(Windows only)

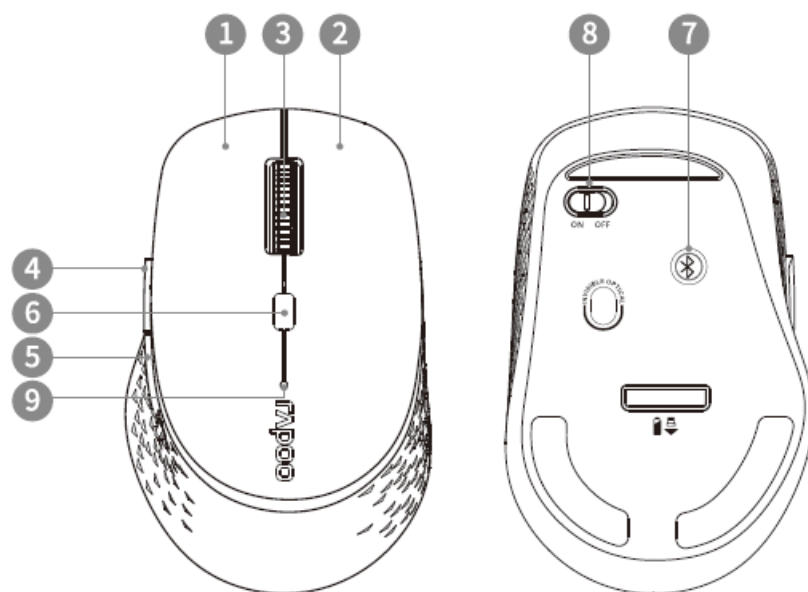

Instructions

Getting started

Keyboard: We recommend to charge the battery fully before first use.

Mouse: The battery of the mouse is pre-installed. Please remove the label next to the battery.

2.4 GHz

1. Plug the included USB receiver into a USB port on your computer.
2. Turn on the keyboard and the mouse. 2.4GHz mode should be active automatically.

If not, please follow these steps

Keyboard: Press Fn+4 to activate 2.4Ghz mode.

Mouse: Press the Bluetooth button shortly until 2.4GHz mode is active (no LED active).

Bluetooth mode

Keyboard

1. Turn on the keyboard.
2. Press and hold key combinations, Fn+1, Fn+2 or Fn+3 at least 3 seconds to pair 3 different devices via Bluetooth. The Status LED flashes blue slowly and the keyboard is discoverable for 120 seconds.
3. Complete "Bluetooth pairing" on your device. When the keyboard and your device are paired, the Status LED turns off.

Mouse

1. Turn on the mouse.
2. Press the Bluetooth button shortly to select the channel for device 1 (green LED flashes fast) or device 2 (blue LED flashes fast)
3. Keep pressing the Bluetooth button at least 3 seconds to pair. The Status LED flashes green or blue slowly. The mouse is discoverable for 120 seconds.
4. Complete "Bluetooth pairing" on your device. When the mouse and your device are paired, the Status LED turns off.

Bluetooth pairing

1. Open the Bluetooth settings on your device.
2. Select the keyboard or mouse from the list. Mouse: RAPOO 3.0MS / RAPOO 5.0MS Keyboard: RAPOO 0KB / RAPOO 5.0KB
3. Click Pair and follow any other instructions that may appear on the screen.

Switching among paired devices

Keyboard

Press key combinations Fn+1, Fn+2, Fn+3 or Fn+4 to switch among paired devices. You can connect the keyboard with up to 4 devices at the same time. (3 devices via Bluetooth, 1 device via USB 2.4 GHz receiver)

Mouse

Press Bluetooth button to switch among paired devices. You can connect the mouse with up to 3 devices at the same time. (2 devices via Bluetooth, 1 device via USB 2.4 GHz receiver) When you pick up the mouse, the Status LED shows which device is active.

1. Status LED stays stable for some seconds = Bluetooth device 1 is connected.

2. Status LED flash's slowly red for some seconds = Bluetooth device 2 is connected.
3. Status LED stays off = USB 2.4GHz receiver is connected.

DPI switch

You can change the DPI by pressing the DPI switching button. For setting 1-4, the Status LED will flash 1, 2, 3 or 4 times.

Low battery

Keyboard

If status LED flashes constantly, it means the battery power is low. Please recharge the battery by using the cable included.

Mouse

If status LED flashes twice every two seconds, it means the battery power is low. Please change the battery.

Warranty conditions

This device is covered by a 2-year limited hardware warranty from the date of purchase. For more information, please visit www.rapoo-eu.com.

Troubleshooting

1. **Sleep mode:** When not using the device for some time it will fall into a sleep mode to save battery. You can press any key to wake it up again for further use.
2. If you are connected via Bluetooth and you maybe have issues with missing letters while typing, please connect again while using the alternative second Bluetooth Option to pair (BT3.0 or B5.0).
3. If you need more information, please visit www.rapoo-eu.com. There you will find our FAQs. You can also download the latest drivers and User manuals for our products there.

System requirements

Windows® 7/8/10/11, Mac OS X 10.4 or later, USB port

Safety instructions

1. Never attempt to open the device or repair it yourself.
2. Do not use the device in a humid environment.
3. Please clean the device with a soft, dry cloth.

Documents / Resources



[rapoo 13560 Keyboard and Mouse Set](#) [pdf] Instruction Manual
13560 Keyboard and Mouse Set, 13560, Keyboard and Mouse Set, Mouse Set

References

- [User Manual](#)

[Manuals+](#), [Privacy Policy](#)

This website is an independent publication and is neither affiliated with nor endorsed by any of the trademark owners. The "Bluetooth®" word mark and logos are registered trademarks owned by Bluetooth SIG, Inc. The "Wi-Fi®" word mark and logos are registered trademarks owned by the Wi-Fi Alliance. Any use of these marks on this website does not imply any affiliation with or endorsement.