

[Home](#) » [rapidline](#) » **Rapidline Static Single Sided Fixed Height Workstation Frame Instruction Manual** 

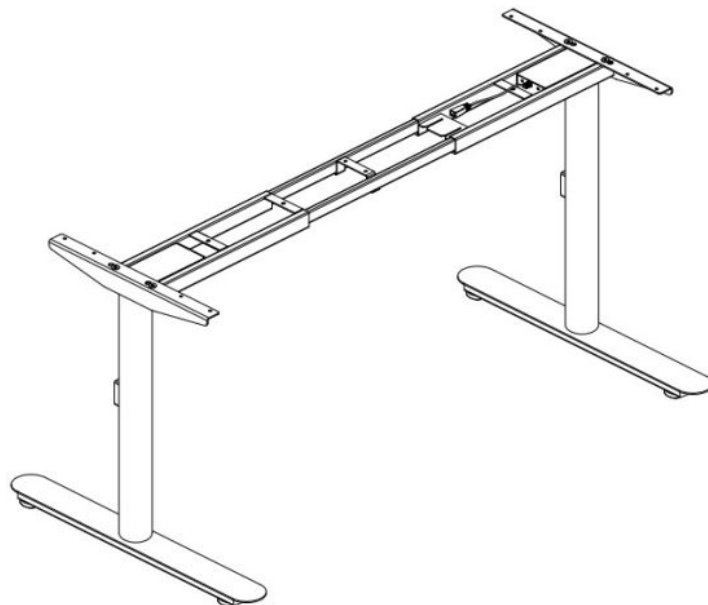

**Halo Static Single Sided Fixed  
Height Workstation Frame  
Instruction Manual**



**Contents** [ [hide](#) ]

- [1 Component parts](#)
- [2 Assembly Instructions](#)
- [3 Cable tray installation](#)
- [4 Screen panel installation \( Shush30 Privacy Screen \)](#)
- [5 EPS \(900mm H Eco Panel\) Screen panel installation](#)
- [6 Documents / Resources](#)
  - [6.1 References](#)

**Component parts**

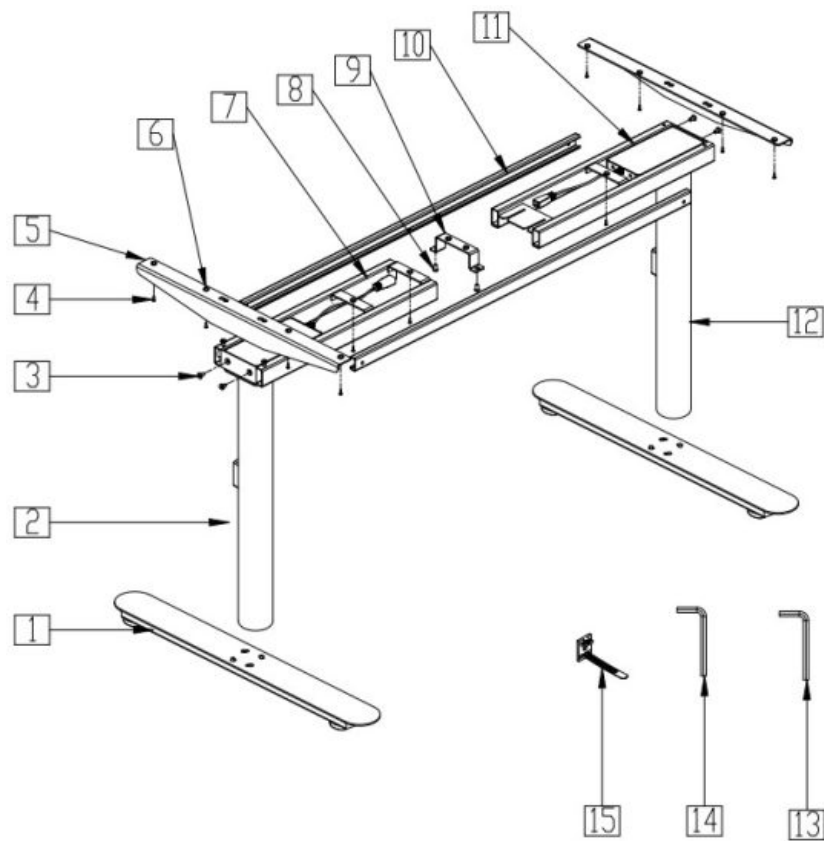

| NO. | Component Name | PCS |
|-----|----------------|-----|
| 1   | Table feet     | 2   |
| 2   | Column( right) | 1   |
| 3   | Bolt: M6x12    | 5   |
| 4   | Screw: ST4x20  | 22  |
| 5   | Side brackets  | 2   |
| 6   | Rubber pad     | 14  |
| 7   | Top frame-1    | 1   |
| 8   | Bolt: M6x10    | 3   |
| 9   | Centre bracket | 1   |
| 10  | Center rails   | 2   |
| 11  | Top frame-2    | 1   |

|    |                   |   |
|----|-------------------|---|
| 12 | Column( left)     | 1 |
| 13 | Allen Wrench(4mm) | 1 |
| 14 | Allen Wrench(5mm) | 1 |
| 15 | Cable Tie         | 5 |

## Assembly Instructions

### Step 1

Loosen the pre-installed bolts and adjust the length of the top frame to match the size of the table top.

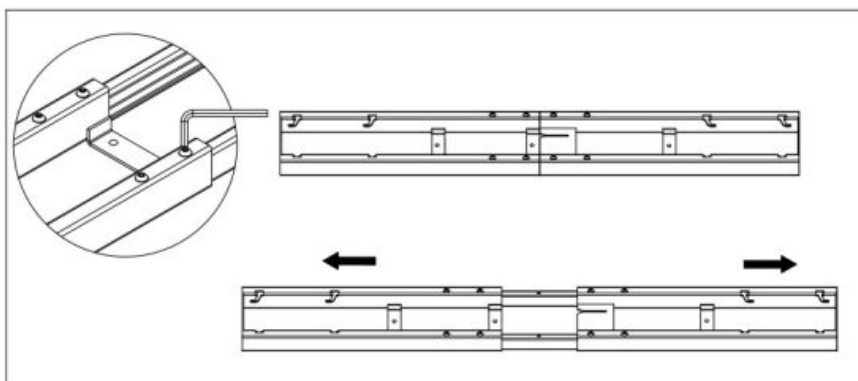

### Step 2

Insert the Column to the top frame, fix the lifting column with 4pcs of screws M6x12 like.

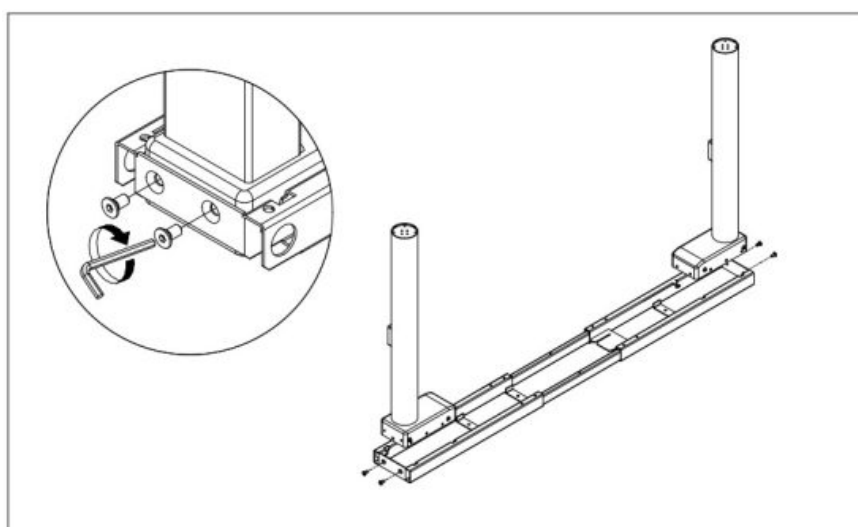

### Step 3

Place the table feet on the Column and rotate it to align, then tighten the pre-installed

bolt.

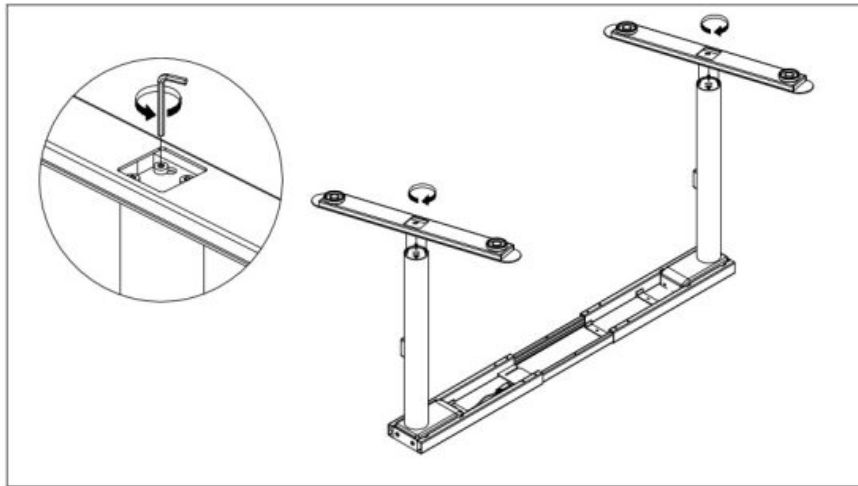

#### Step 4

Place the side bracket on the top frame and tighten the bolts.

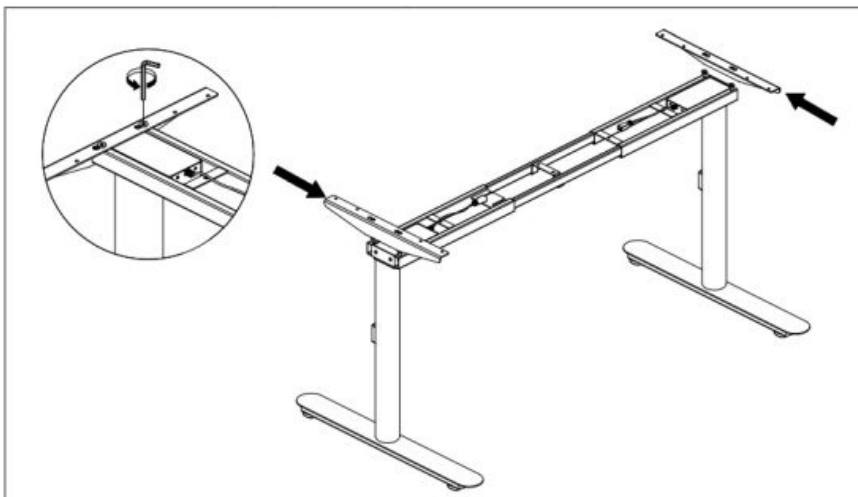

#### Step 5

Mount the tabletop and fix it with 14 pcs screws ST4x20;

Fix the centre bracket with 2 pcs of screws M6x10

Tighten the pre-installed bolts on the top frame

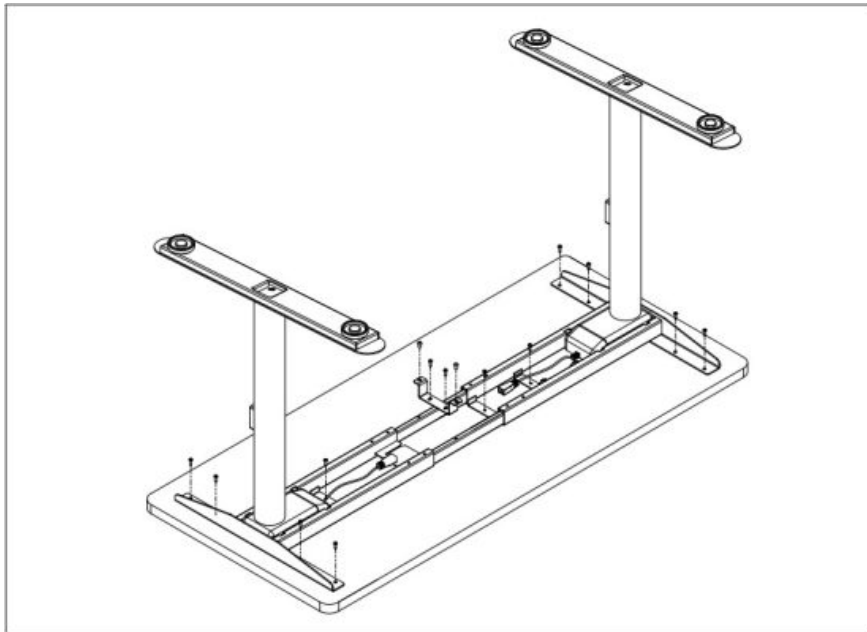

## Cable tray installation

### Step 1

- Fix the cable tray (B2-SSCT ) to the cable tray arms (HP-SSARM) with 8 pcs M6x10 screws.

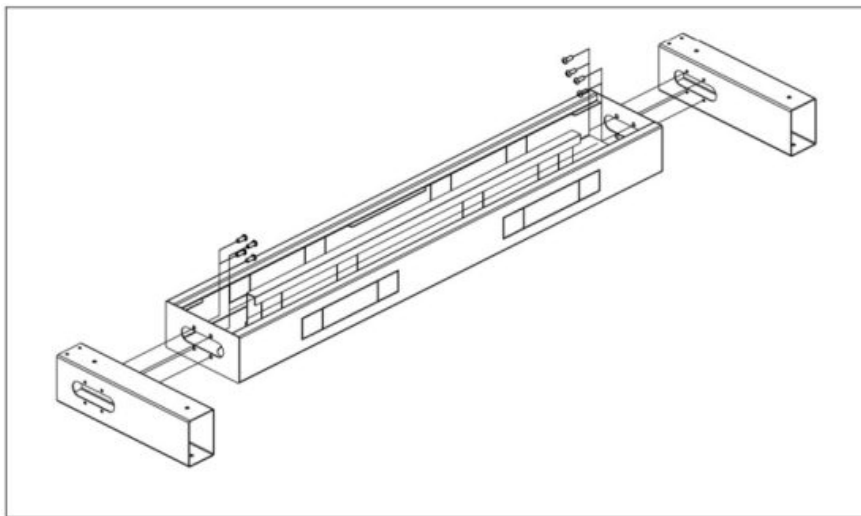

### Step 2

- Install the U brackets to the desk frame with 4 pcs M8x10 screws.
- Mount the cable tray to the desk frame and fix it with 6 pcs M6x10 screws

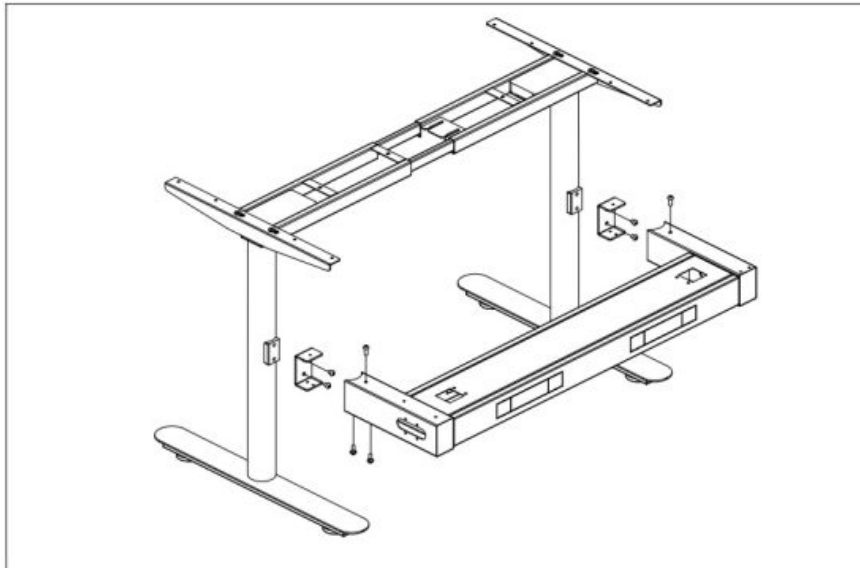

## Screen panel installation ( Shush30 Privacy Screen )

### Step 1

– Insert the tapped plates to the screen panel ( plates can be found in the B2-SBRAC carton )

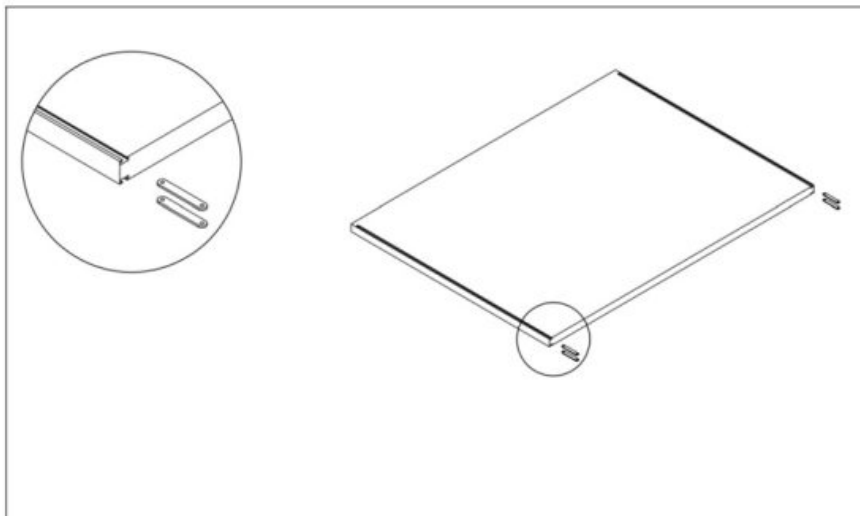

### Step 2

– Install the screen brackets (B2-SBRAC) to the Shush30 Extrusion with 8 pcs M5x6 screws.

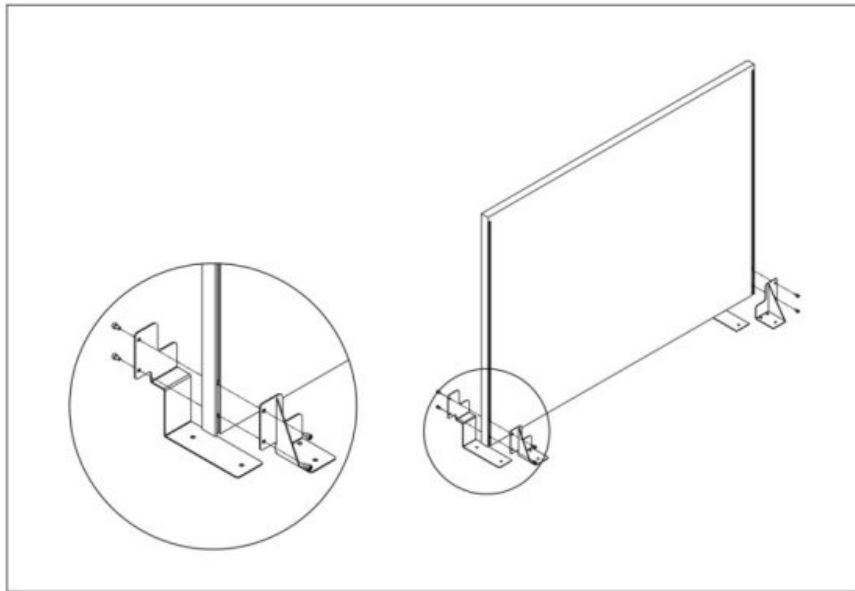

### Step 3

- Fix the screen brackets (B2-SBRAC) to the desk frame with 10 pcs M6x10 screws.

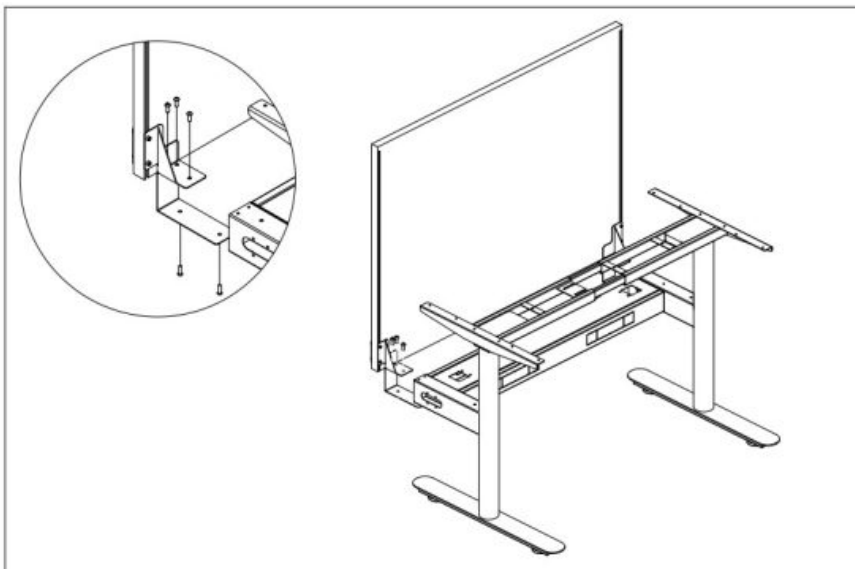

## EPS (900mm H Eco Panel) Screen panel installation

### Step 1

- Install the screen brackets (B2-SBRAC) on the cable tray arm (HP-SSARM) with 10 PCS M6x10 Screws. The direction as the photos display.

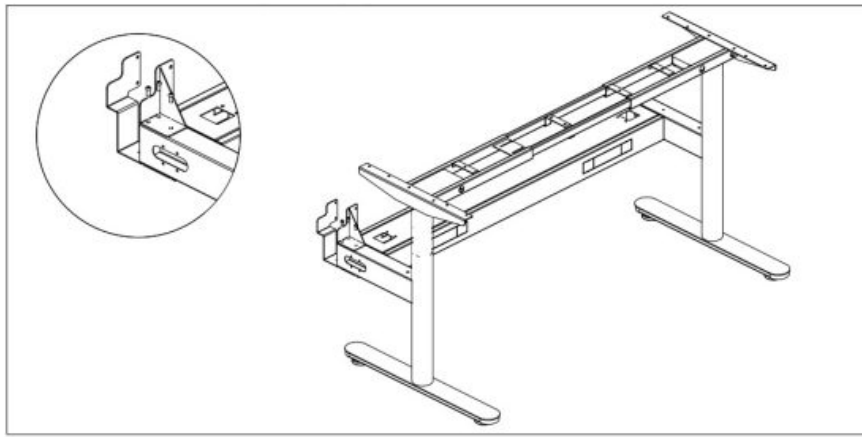

## Step 2

- Place the EPS panel on the screen brackets

Using a 6mm drill bit ( not included ), drill out holes in the Eco Panel Screen in line with the back-to-back screen bracket holes ( Note: Carbide Drill Bits Work Best For PET panel )

- Place 8 x Double Ended Bolts M5\* 32mm – 6mm through the screen bracket ( B2-SBRAC ) holes and the holes you have created in the Eco Panel Screen. Tighten the double-ended bolt with the Allen key.

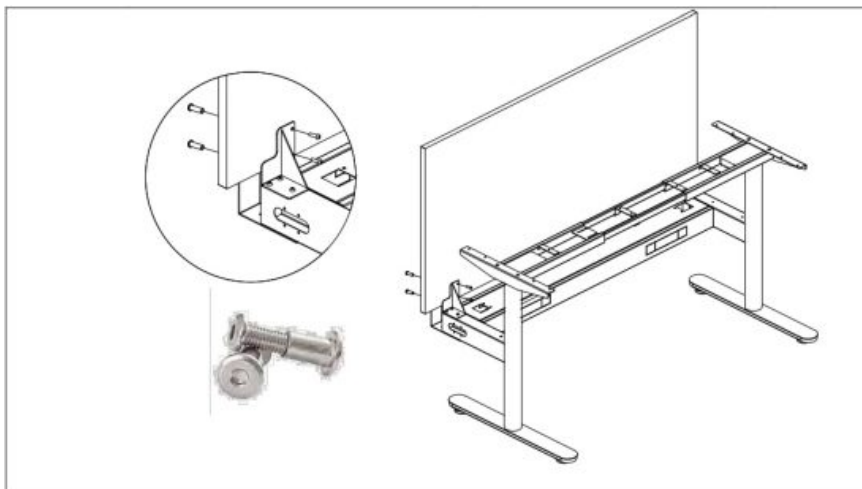

**rapidline**

## Documents / Resources



|   |   |
|---|---|
|  | <p><a href="#">Rapidline Static Single Sided Fixed Height Workstation Frame [pdf]</a> Instruction Manual</p> <p>Static Single Sided Fixed Height Workstation Frame, Single Sided Fixed Height Workstation Frame, Sided Fixed Height Workstation Frame, Fixed Height Workstation Frame, Height Workstation Frame, Workstation Frame, Frame</p> |
|---|---|

## References

- [User Manual](#)

rapidline

Fixed Height Workstation Frame, Frame, Height Workstation Frame, rapidline, Sided Fixed Height Workstation Frame, Single Sided Fixed Height Workstation Frame, Static Single Sided Fixed Height Workstation Frame, Workstation Frame

## Leave a comment

Your email address will not be published. Required fields are marked \*

Comment \*

Name

Email

Website

☐ Save my name, email, and website in this browser for the next time I comment.

**Post Comment**

**Search:**

e.g. whirlpool wrf535swhz

**Search**

[Manuals+](#) | [Upload](#) | [Deep Search](#) | [Privacy Policy](#) | [@manuals.plus](#) | [YouTube](#)

This website is an independent publication and is neither affiliated with nor endorsed by any of the trademark owners. The "Bluetooth®" word mark and logos are registered trademarks owned by Bluetooth SIG, Inc. The "Wi-Fi®" word mark and logos are registered trademarks owned by the Wi-Fi Alliance. Any use of these marks on this website does not imply any affiliation with or endorsement.