



# Raoping Ruhu Technology N272U RGB Light Strip Controller User Manual

[Home](#) » [Raoping Ruhu Technology](#) » Raoping Ruhu Technology N272U RGB Light Strip Controller User Manual

## Raoping User Manual





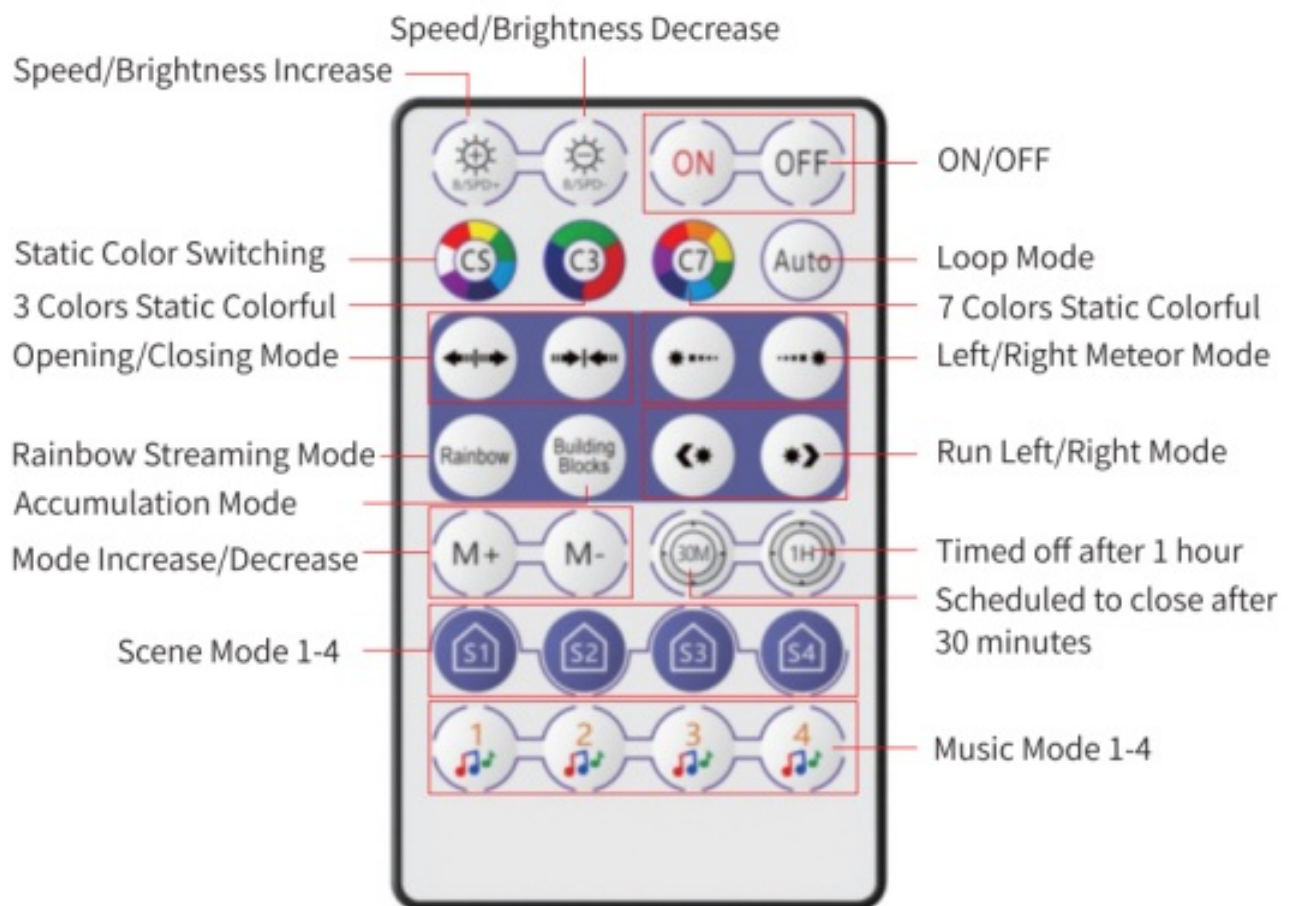

### Contents

- 1 Technical Parameter:
- 2 Remark:
- 3 How to set the IC model and IC numbers:
- 4 Detailed introduction of APP functions
- 5 ATTENTIONS
- 6 Documents / Resources
- 7 Related Posts

### Technical Parameter:

Product category	LEDController
Control principle	BLUETOOTH5.0
APP software type	ZENGGE
Language	Chinese, English, Japanese, German
Mobile version requirements	Android6.0 or IOS11 or higher
Input voltage	DC5V
Maximum power	144W 2048
Control points	SPI:W528128,SM16703,SM16704,
Led driver type	WS2811,UCS1 903,SK6812,
Scope of application	INK1003,UCS2904B
Working temperature	RGBIC light bar
Effective control distance	-20-+55°C 20m Visual distance 20m C
Certification	



	Static Color Switching	7 kinds of color static switching (Red/White/Green/Light Blue/Dark Blue/Purple/White)
	3 colors Static Colorful	3 colors static switching (Red/Blue/Green)
	7 Colors Static Colorful	7 kinds of color static switching (Red/Orange/White/Green/ Light Blue/Dark Blue/Purple)
	Loop Mode	Light cycle switching
	Mode Increase/Decrease	100 built-in modes affect increases or decreases
	Left/Right Meteor Mode	Left Meteor Mode: Lights fade from right to left. Right Meteor Mode: Lights fade from left to right.
	Run left/right mode	Run Left Mode: Lights cycle from right to left Run Right Mode: Lights cycle from left to right
	Rainbow Streaming Mode	7 colors flow by
	Accumulation Mode	7 color overlays
	Opening/Closing Mode	Closing: Lights run from both sides to the middle at the same time Opening: The lights run from the middle to both sides at the same time
	Scene Mode 1-4	Press and hold for 2 seconds to record the effect of the current mode, short press next time to trigger
	Jump/Fade/Strobe/Stream	The light moves with the outside music according to the mode 1-4 effect change

### Remark:

1. Scene mode can only record one custom color.
2. Remote control code matching function: power on the device, press the "ON" button for 5 seconds, the device flashes slowly, it means the code matching is successful  
Remote control clearing function: When the device is powered on, press the "OFF" button for 5 seconds, the device flashes quickly, indicating that the clearing is successful.

### How to set the IC model and IC numbers:

Long press the device and click on “LED Strip Setting” to set the IC model, Wiring and Sorting, Number of points, Number of segment(Total number of points can not exceed 300 in each segment and total LED chip’s quantity can not exceed 2048). On music mode, the total number of points in each segment and the total number of segments should be less than 150 points and 64 segments, the total LED Chip’s quantity should be less than 960.

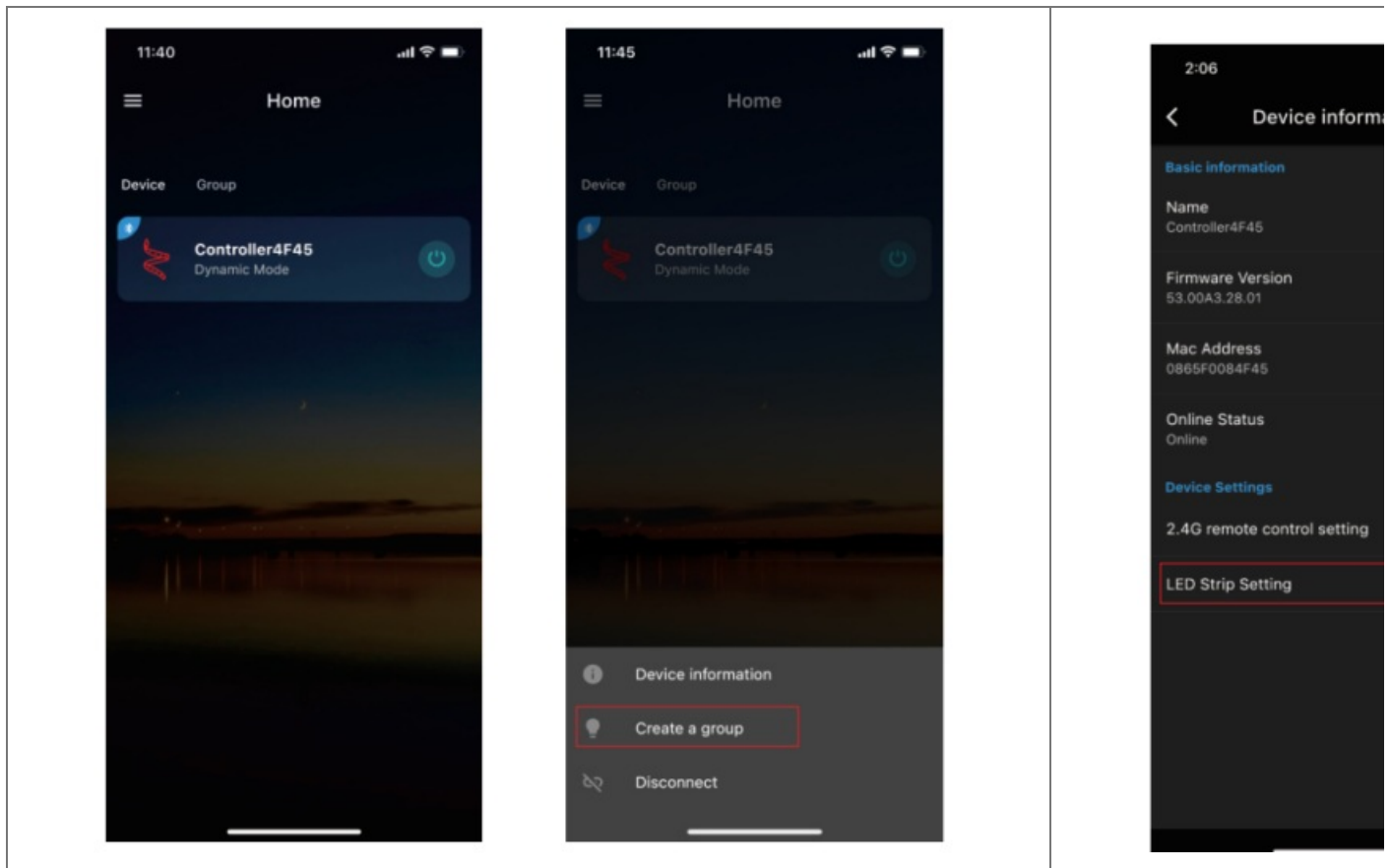

## Detailed introduction of APP functions

### a) Fixed Mode

10 fixed modes are built-in, can change foreground and background color, adjust brightness, speed and direction freely.



## b) Rim Mode

100 patterns of change, slide the ring to select pattern effect, and slide " \*" or "P " for overall pattern effect brightness or speed settings. Click on "AUTO" to enter cycle mode or click on the heart icon to mark the favorite effect.

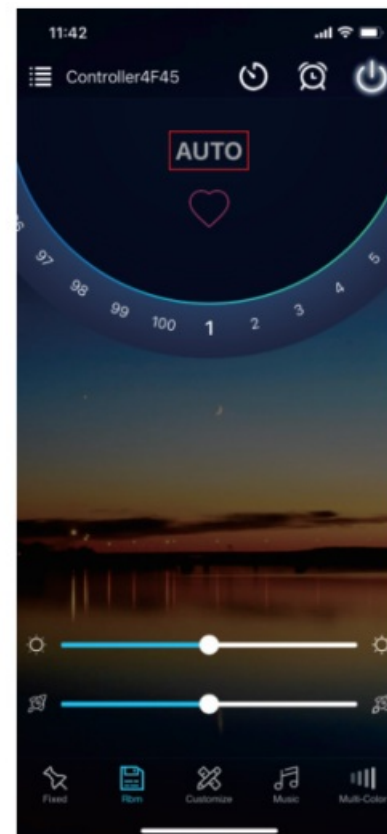
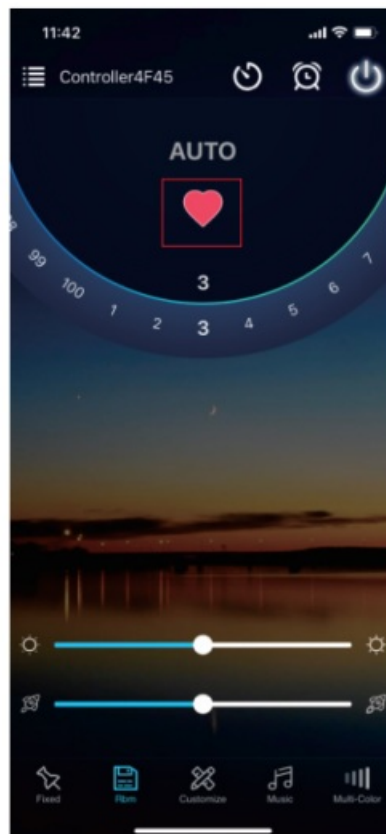

## c) DIY Mode

Customized your own effects, click on "+" to choose your favorite effect and color then save it, now you can enjoy your own light effects at any time.

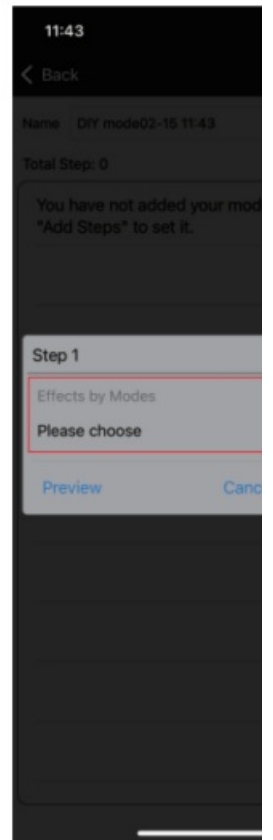
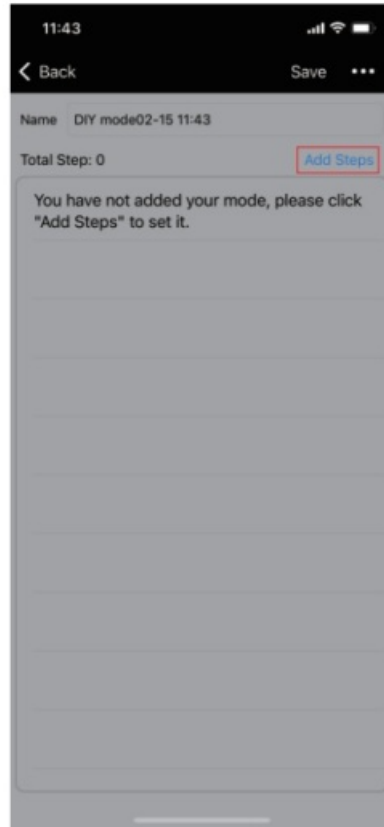
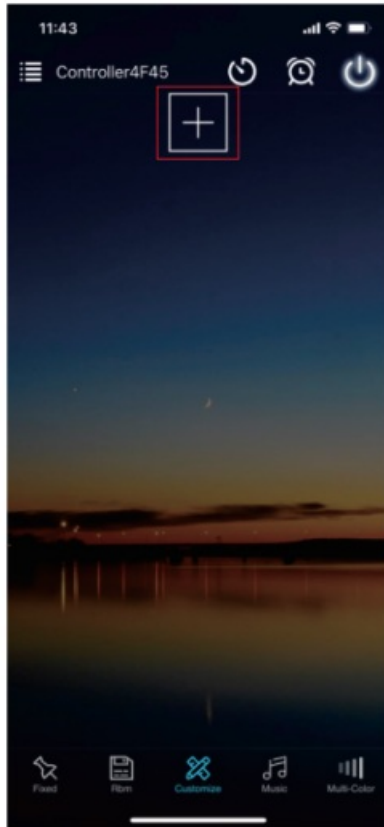

#### d) Musk Mode

1. In the Light Screen Mode, you can choose the falling color, column color, sensitivity, and brightness, which can be played circularly to achieve a more beautiful light effect.
2. In the LED Strip Mode, you can select the brightness and sensitivity. There are two ways to input the audio signal on the controller, built-in APP Microphone and Device Microphone.

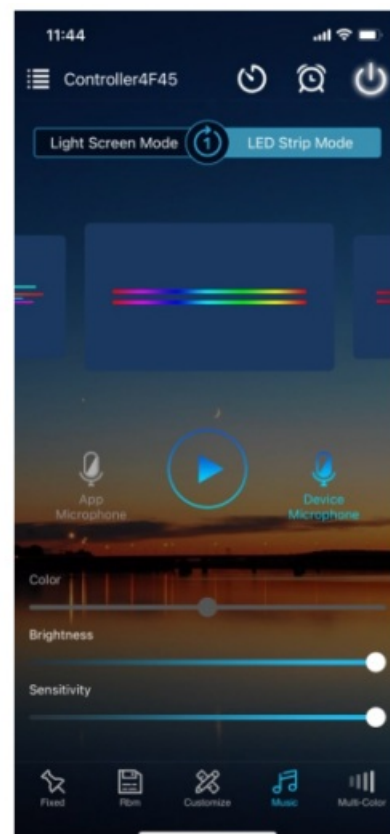
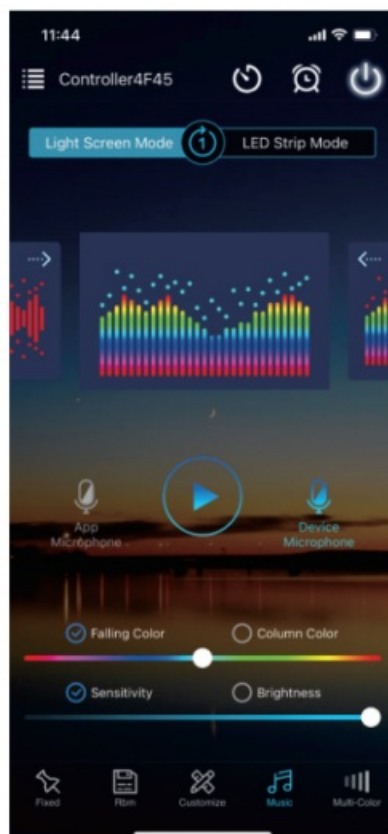



## e) Multicolor function

1. Can set each IC separately and set the lights with different modes.
2. Optional dynamic modes for color lump gradient or mixed colors gradient: Static, Running Water, Strobe, Jump, Breathing

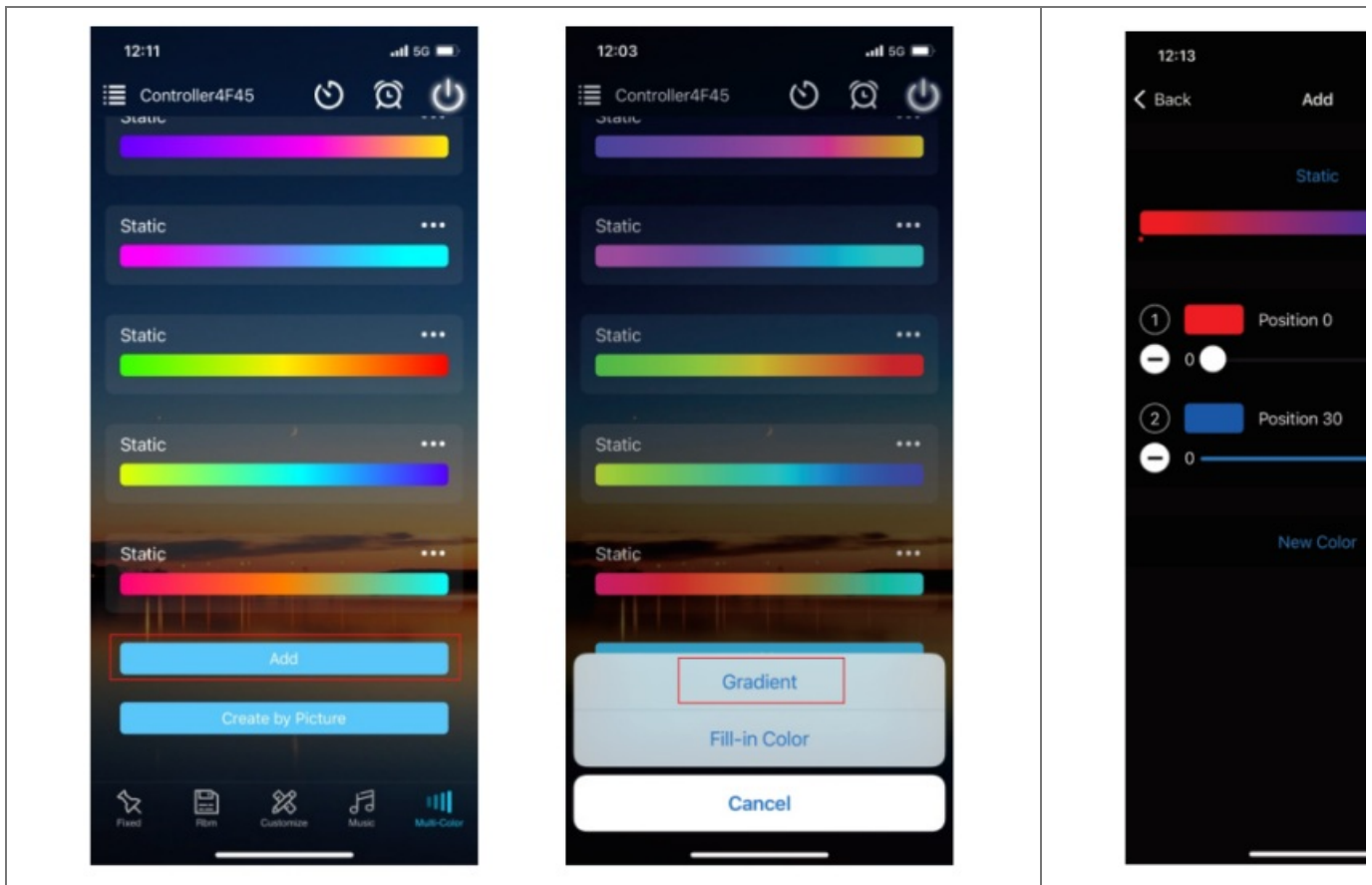

3. The area where the camera is aimed at the coloring area, and the light color will be changed accordingly.

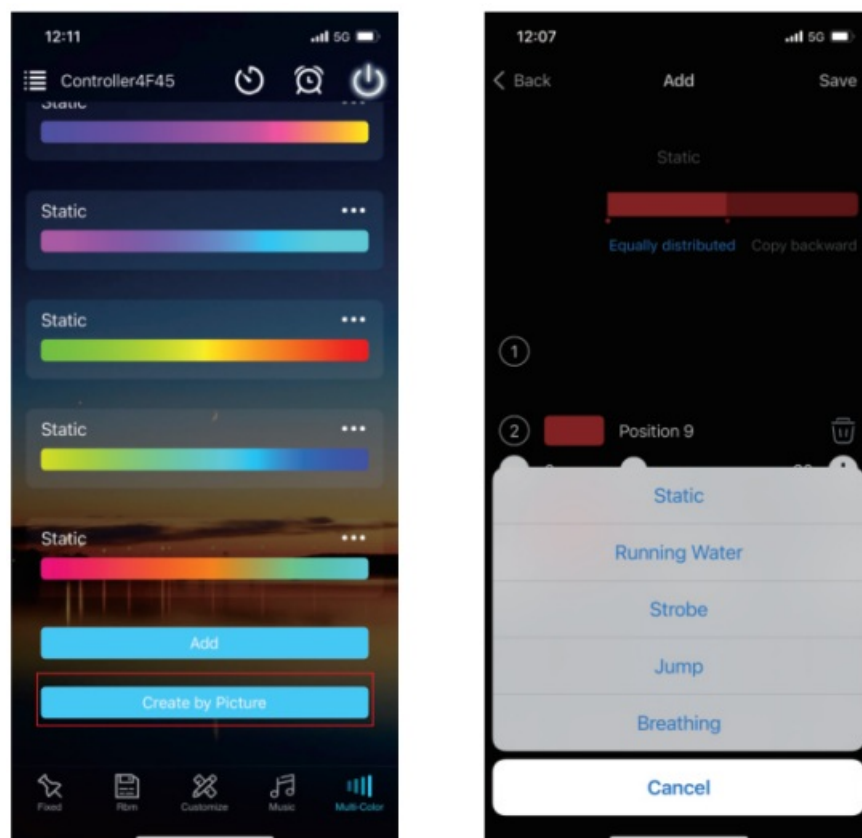

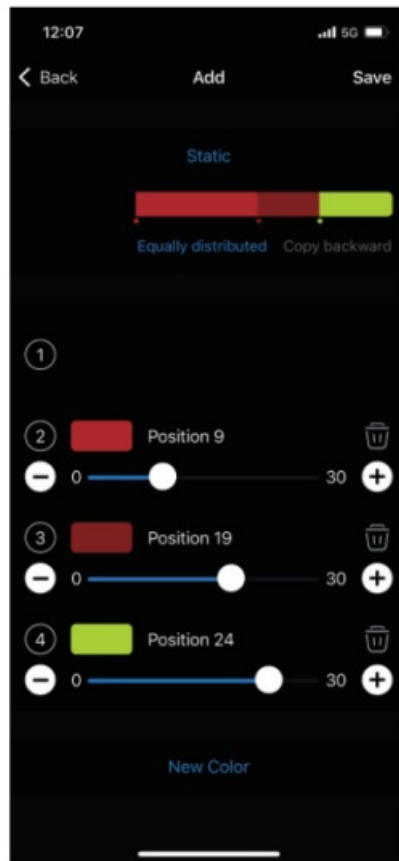

#### f) Timer function

Smart lights automatically come on and off at given times through the timer function.

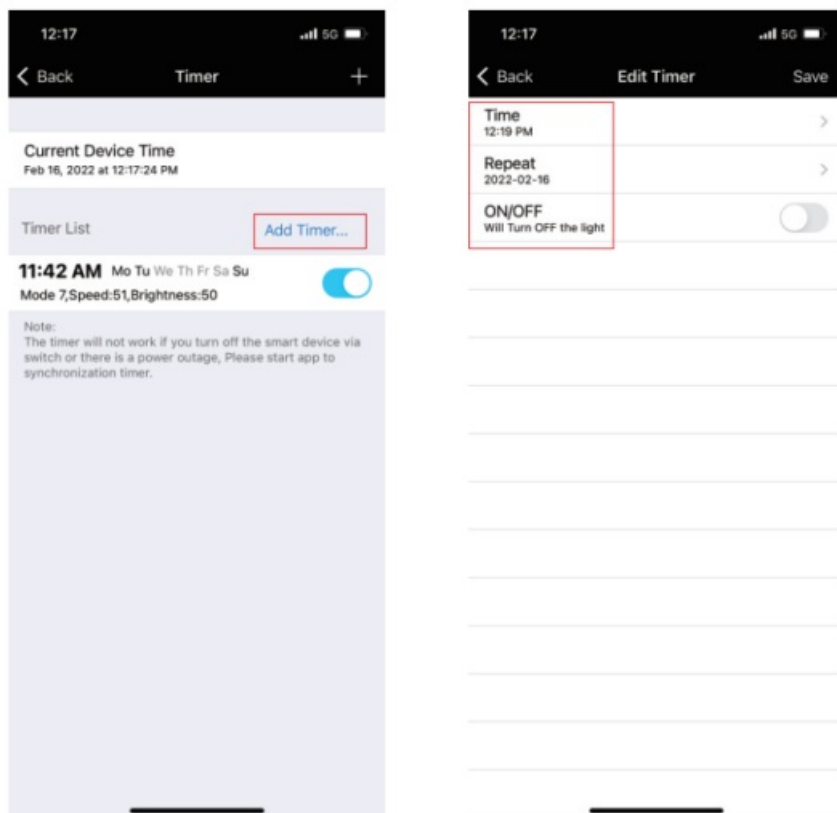

When setting the timer switch, you can select the color or dynamic mode and adjust the brightness and speed freely.



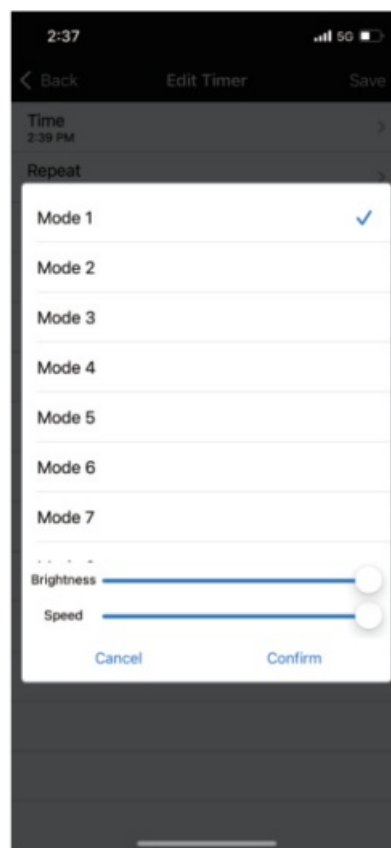
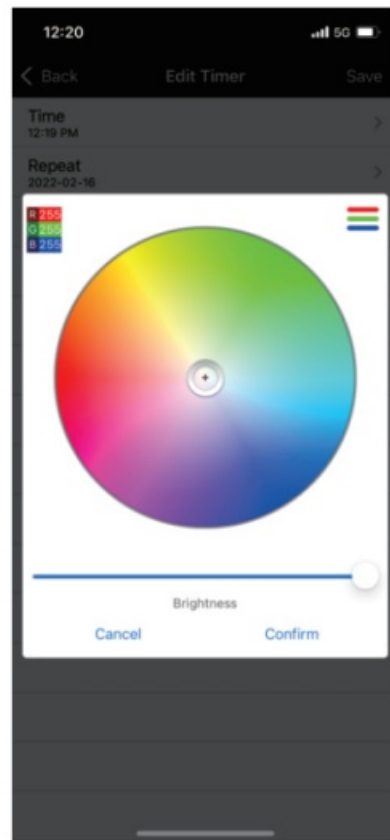

**g) Delay on-off function:**

The lighting delay on/off time can be set according to personal preference.

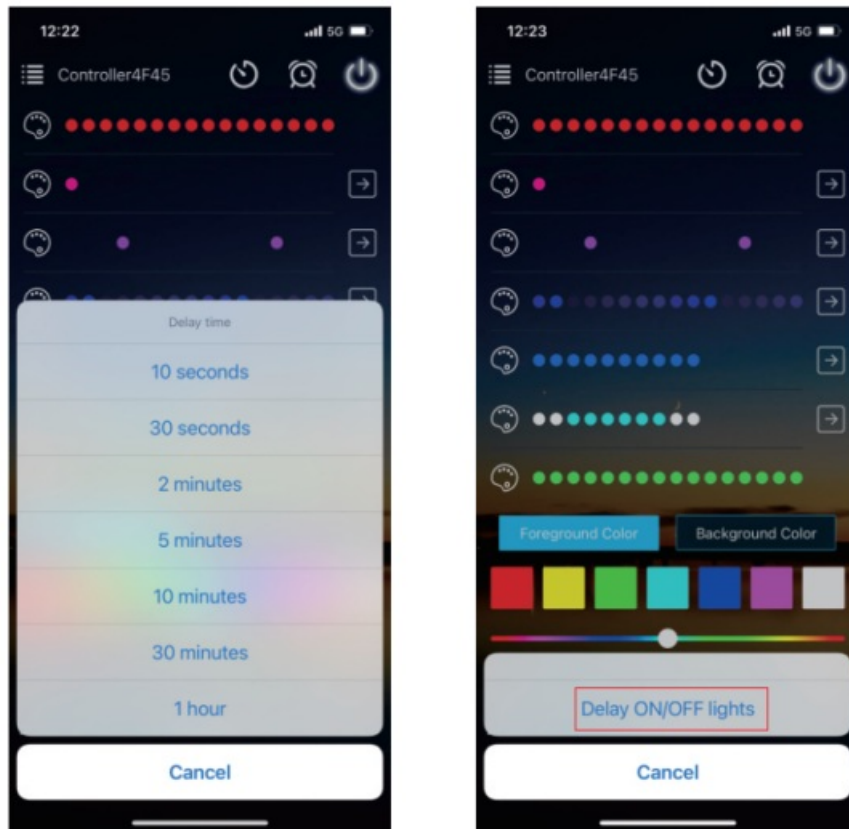

## ATTENTIONS

1. Please use the product in a dry environment.
2. Please use the input voltage at 5.24V DC voltage, must not connect into 220V AC directly.
3. The product is requested a common anode connection. The wrong connection will cause a malfunction

This device complies with part 15 of the FCC Rules. Operation is subject to the following two conditions: (1) This device may not cause harmful interference, and (2) this device must accept any interference received, including interference that may cause undesired operation.

Any changes or modifications not expressly approved by the party responsible for compliance could void the user's authority to operate the equipment.

**Note:** This equipment has been tested and found to comply with the limits for a Class B digital device, pursuant to part 15 of the FCC Rules. These limits are designed to provide reasonable protection against harmful interference in a residential installation. This equipment generates uses and can radiate radio frequency energy and, if not installed and used in accordance with the instructions, may cause harmful interference to radio communications. However, there is no guarantee that interference will not occur in a particular installation. If this equipment does cause harmful interference to radio or television reception, which can be determined by turning the equipment off and on, the user is encouraged to try to correct the interference by one or more of the following measures:

- Reorient or relocate the receiving antenna.
- Increase the separation between the equipment and receiver.
- Connect the equipment into an outlet on a circuit different from that to which the receiver is connected.
- Consult the dealer or an experienced radio/TV technician for help.



<https://faqsys.magichue.net:4489/wifi/page/download/ZGBLE02>



Made in China

## Documents / Resources

	<a href="#">Raoping Ruhu Technology N272U RGB Light Strip Controller</a> [pdf] User Manual N272U, 2A5HB-N272U, 2A5HBN272U, N272U RGB Light Strip Controller, RGB Light Strip Controller
-----------------------------------------------------------------------------------	--------------------------------------------------------------------------------------------------------------------------------------------------------------------------------------------

[Manuals+](#)