



RANGER N4-RS84-3 Shelving Installation Guide

[Home](#) » [RANGER](#) » RANGER N4-RS84-3 Shelving Installation Guide 



INSTALLATION GUIDE

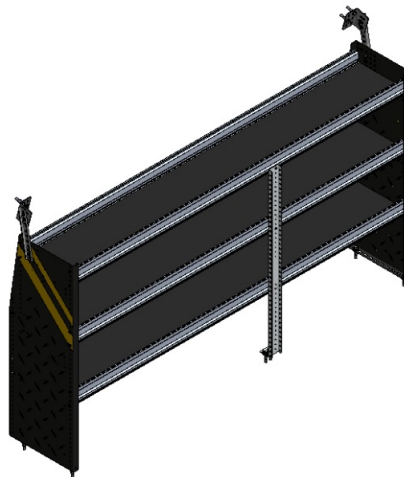

N4-RS84-3 Shelving (steel)
Transit Low Roof
Nissan NV Low Roof GM Savana

Contents

- [1 N4-RS84-3 Shelving](#)
- [2 PHASE 1 – ASSEMBLY](#)
- [3 PHASE 2 –
INSTALLATION](#)
- [4 Documents / Resources](#)
- [5 Related Posts](#)

N4-RS84-3 Shelving

REQUIRED ITEMS

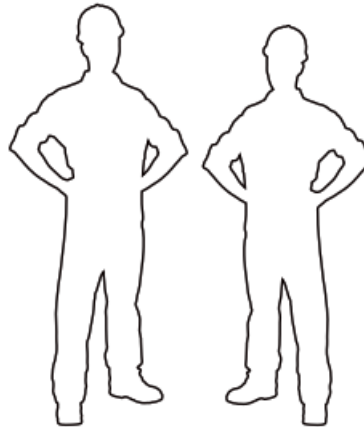

**2
PERSONS**

- Cordless Impact
- Cordless Drill
- Tape Measure
- Marker
- 1/2" Socket
- 1/2" Drill Bit w/ Drill Collar (Set at 1/2")
- 3/8" Driver Bit
- Knife
- Plusnut Tool / Plusnut Gun (5/16")

PHASE 1 – ASSEMBLY

1.1 SETUP

1.1.1 Unpack components; compare with the bill of materials.

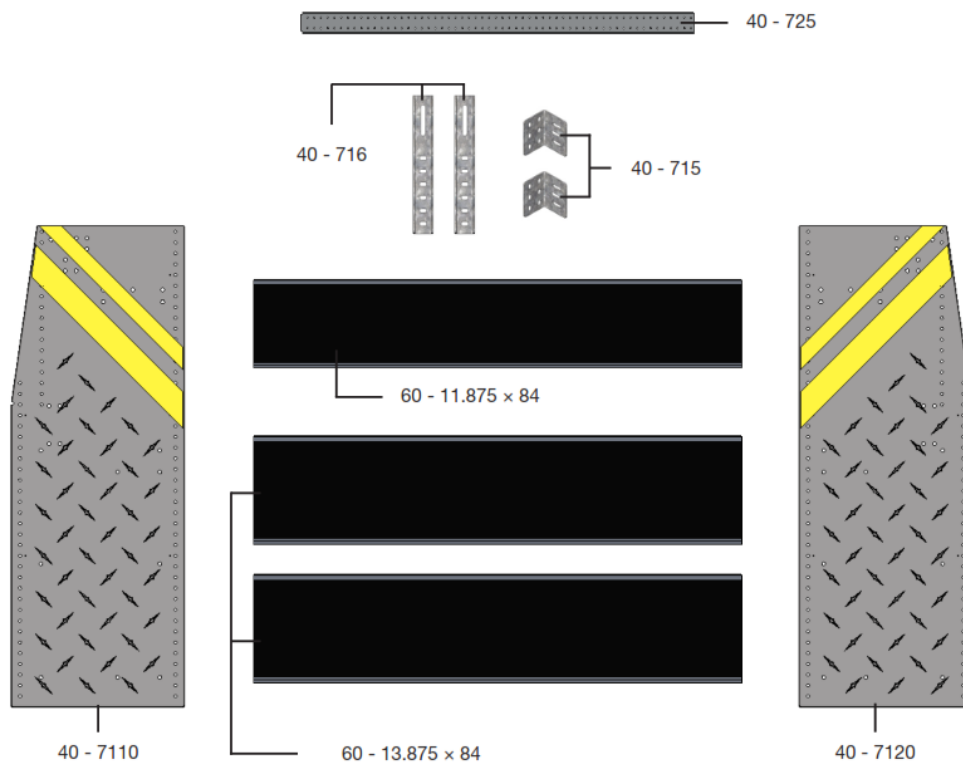

1.1.2 Verify all parts are present.

BILL OF MATERIALS



Item No.	Description	Qty.
40 – 725	Center Post, Low roof	1
40 – 715	Bracket head	2
40 – 716	Bracket arm	2
40 – 7110	End Panel (Left)	1
40 – 7120	End Panel (Right)	1
60 – 11.875 x 84	Shelf Tray, Black Plywood, Usable 12" x 84"	1
60 – 13.875 x 84	Shelf Tray, Black Plywood, Usable 14" x 84"	2
94 – 4028	Assembly Fastener Kit	1
96 – 4028	Install Fastener Kit	1

1.1.3Fastener kits.

94 – 4028 Fastener Kit	→	Fastener
------------------------	---	----------

8x		# 90-204	Hex Bolt 5/16"-18 x 3/4" GR-5 ZINC
6x		# 92-200	Screw HFH #10 – 16 x 3/4" ZINC
24x		# 92-102	Screw HWH #14 x 1" ZINC
8x		# 94-116	Serrated Nut 5/16"-18 ZINC
8x		# 98-116	Flat Washer 5/16" – 18 x 1" ZINC

8x

	#90-204 Hex Bolt 5/16" x 3/4"
	#98-116 Flat Washer
	#94-116 Serrated Nut

6x

	#92-200 Screw #10 - 16 x 3/4"
---	-------------------------------

24x

	#92-102 Screw #14 x 1"
---	------------------------

96 – 4028 Fastener Kit		F
------------------------	---	---

6×		# 90-011	Hex Bolt 5/16"-18 × 1-3/4" GR-5 ZINC
4×		# 90-212	Hex Bolt 5/16"-18 × 1-1/4" GR-5 ZINC
10×		# 94-132	Plusnut
10×		# 98-116	Flat Washer 5/16", O.D. 7/8" ZINC
10×		# 98-122	Lock Washer 5/16" ZINC
6×		# 98-157	Spacer 0.375" ID, × 1.0" OD × 0.25 NYLON

4×



6×

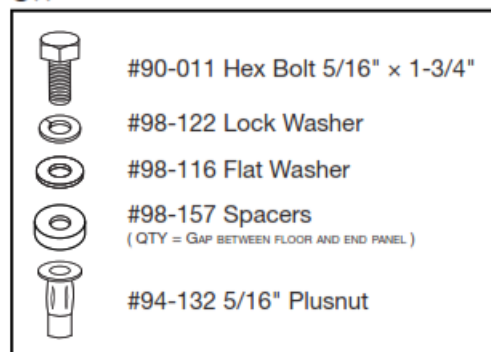

PHASE 1 – ASSEMBLY

1.2 SHELF ASSEMBLY

1.2.1 Attach both panels to the shelf trays.

NOTE: You can adjust the bottom shelf location to maximize or minimize your space over the wheel.

IMPORTANT: Always handle panels on a smooth, protected and clean surface to avoid unnecessary scratching.

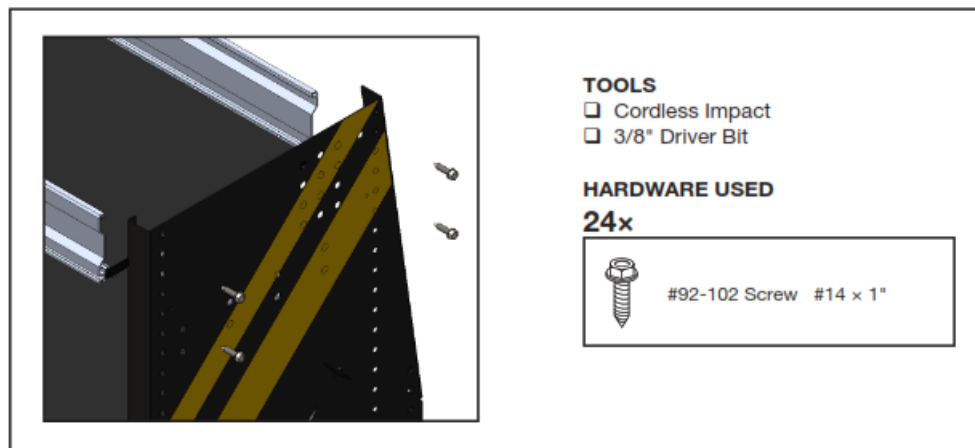
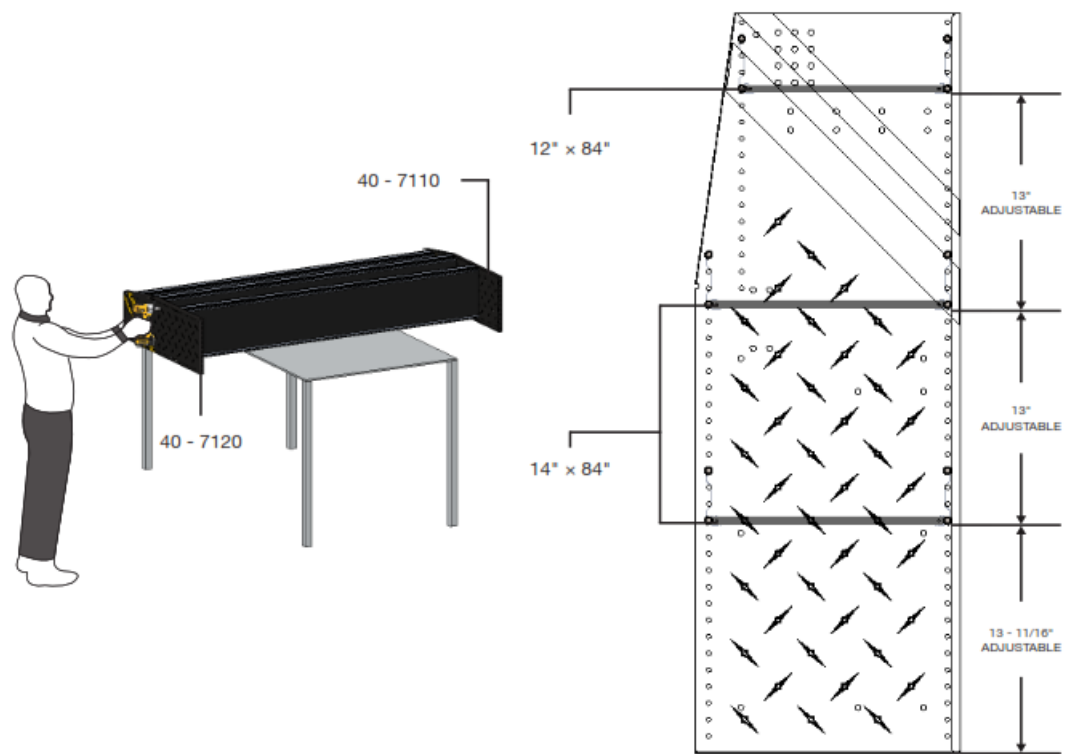

1.2.2 Attach the center post to the center front face of the shelf.

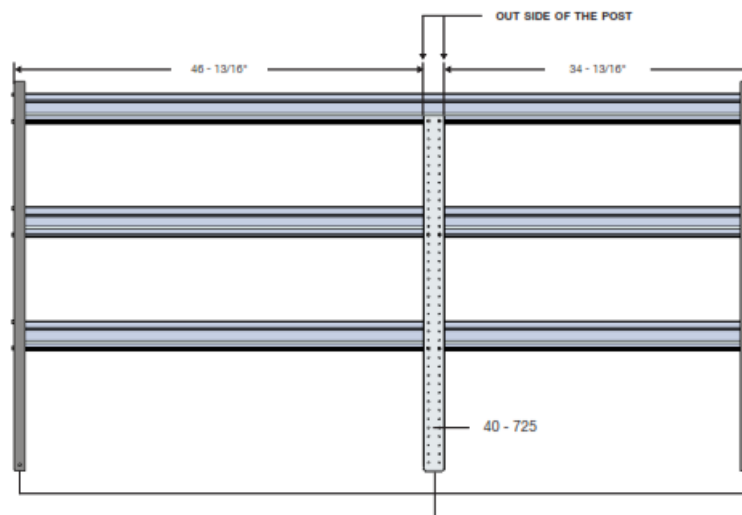

NOTE: The bottom flange of the center post need to be flush with the bottom of the end panel.

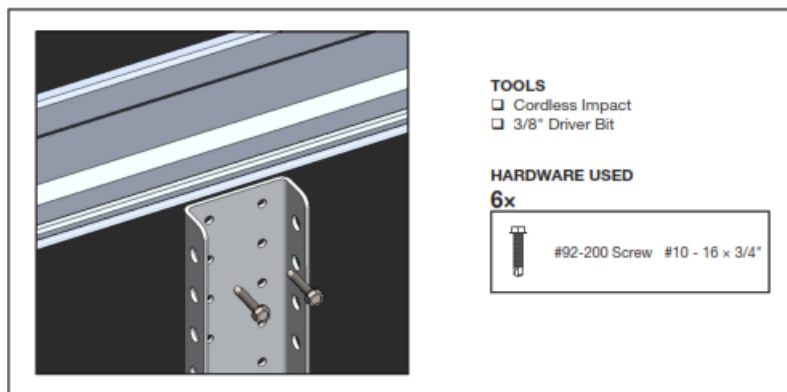

1.2.3 Attach the bracket head to the bracket arm.

NOTE: Hand-tighten the bolts for adjustment.

2x

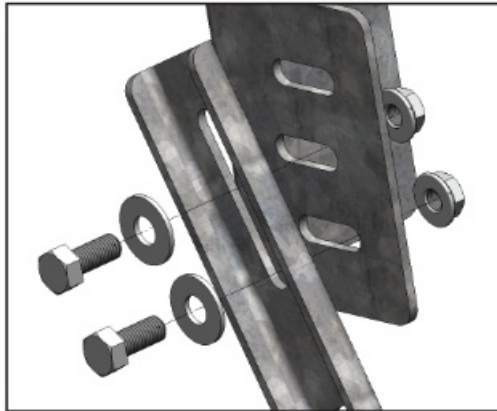
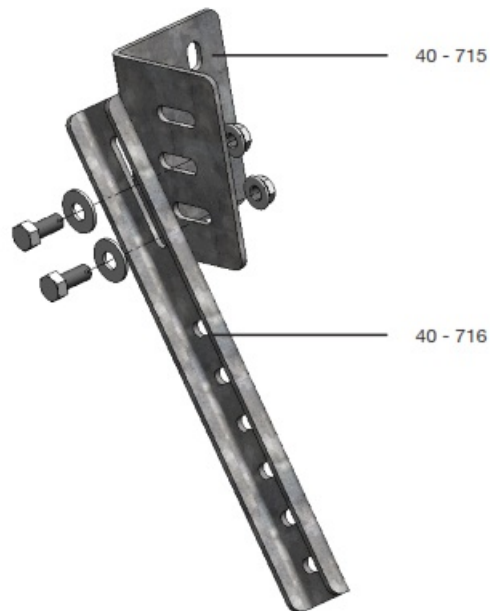

TOOLS

- ☐ Cordless Impact
- ☐ 1/2" Socket

HARDWARE USED

4x HAND-TIGHTEN THE BOLTS



#90-204 Hex Bolt 5/16" x 3/4"



#98-116 Flat Washer



#94-116 Serrated Nut

PHASE 2 – INSTALLATION

2.1 ATTACH WALL BRACKETS TO THE END PANELS

2.1.1 • Lift the assembled shelf to the vehicle, then put it in place.

- Attach the bracket arm to the panels aligning the bracket head to the horizontal rim of the vehicle.

NOTE: Handle with care.

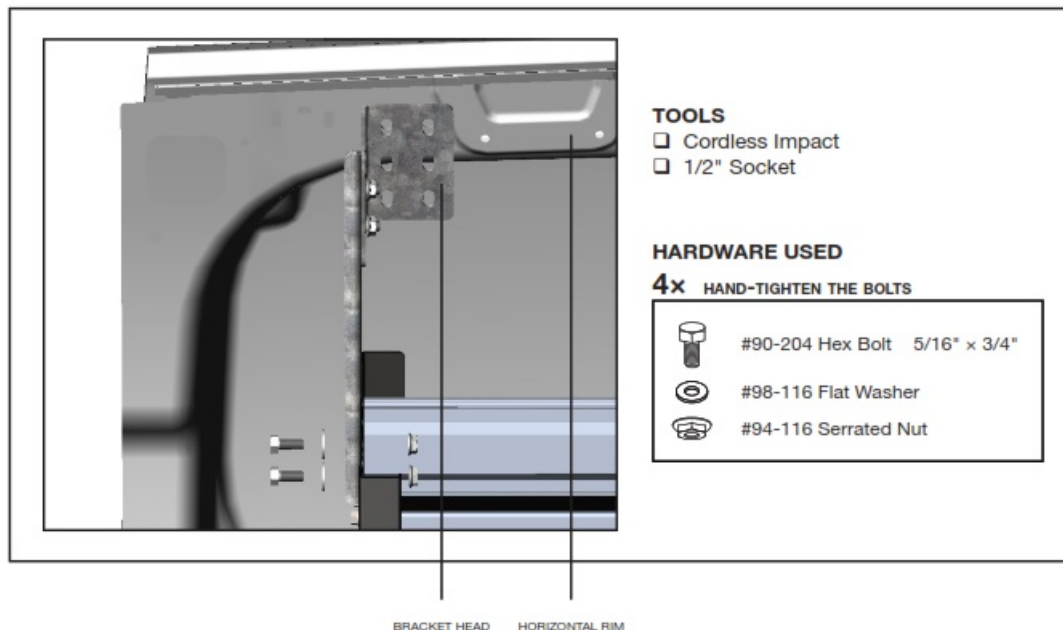
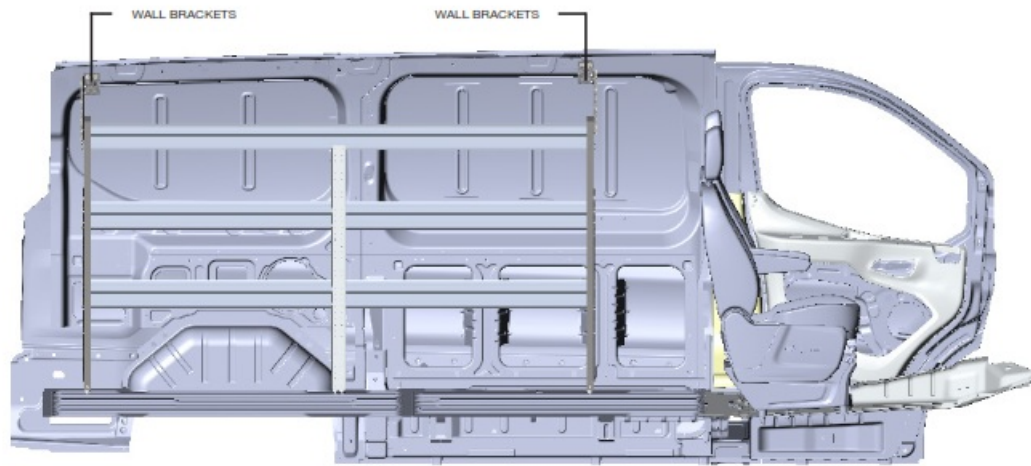

PHASE 2 – INSTALLATION

2.2 MARK HOLES FOR PLUS NUTS

2.2.1 After attaching the brackets mark the holes on the brackets, end panels and center post to the vehicle.

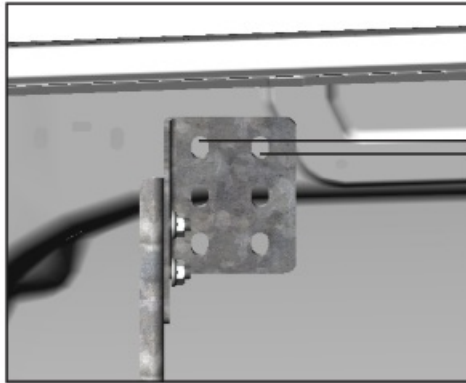
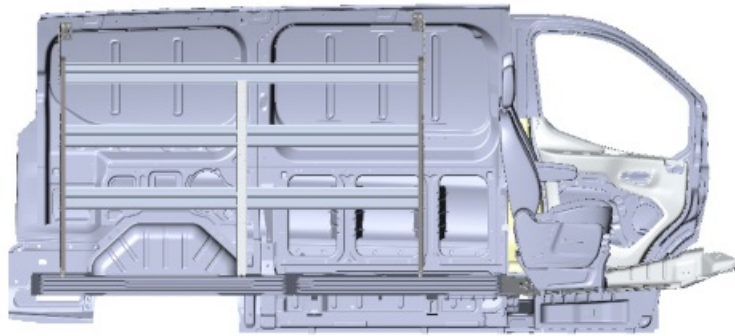

Mark 2 holes of the brackets head on the vehicle horizontal rim.

NOTE: If you are using Ranger wall kit, please go to **PAGE 15**.

TOOLS

☐ Marker

MARK

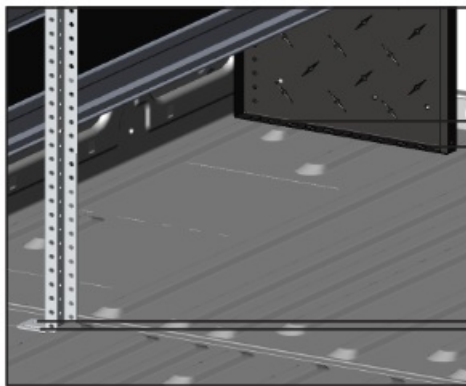

Mark 2 holes of each end panel and mark also the 2 holes of the center post on the vehicle floor.

NOTE: If you are using Ranger floor, please go to **PAGE 13**.

TOOLS

☐ Marker

MARK

PHASE 2 – INSTALLATION

2.3 ATTACH PLUS NUTS

2.3.1 • Lift the assembled shelf on the side.

- Drill all the marks using a 1/2" drill bit w/ drill collar, then attach plus nuts to the

NOTE: Use a 1/2" drill bit with a drill collar to stop the drill at 1/2" depth.

WARNING: Before drilling, ensure that you will not hit any critical parts of the vehicle like the Gas tank, Wiring Harness and Hose.

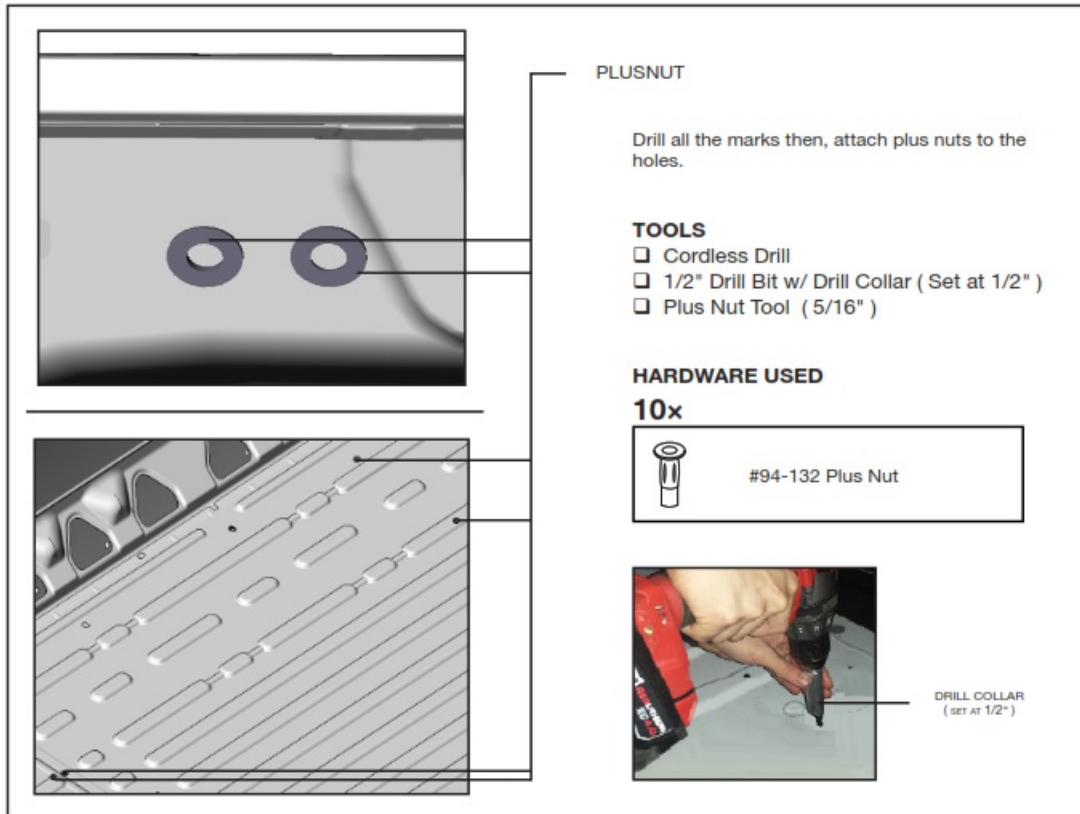
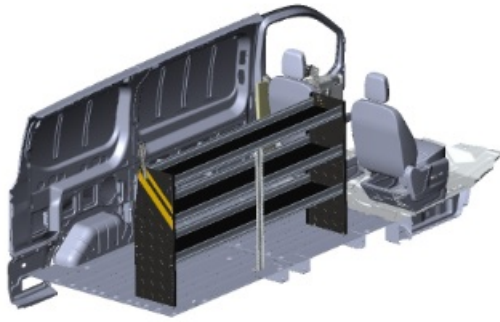

2.3.2 How to attach plus nut.

- using Plusnet gun

STEP: Put the Plusnet on the plus nut gun, then attach the plus nut in the hole by turning the gun forward until the plus nut locks, then remove the gun by turning in reverse.

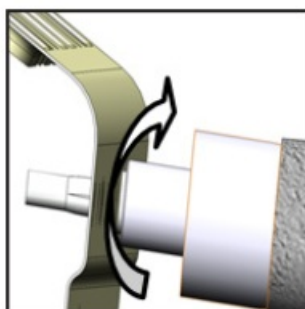

FORWARD

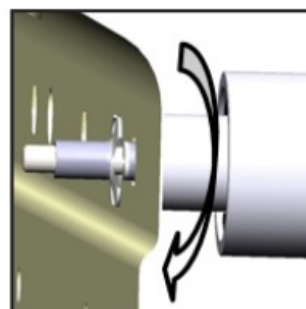

REVERSE

- using the 6491 plus nut tool

NOTE: The hardware used for the 6490 plus nut tool is not included in the fastener bag.

The 6490 plus nut tool can be ordered separately upon demand at no charge.

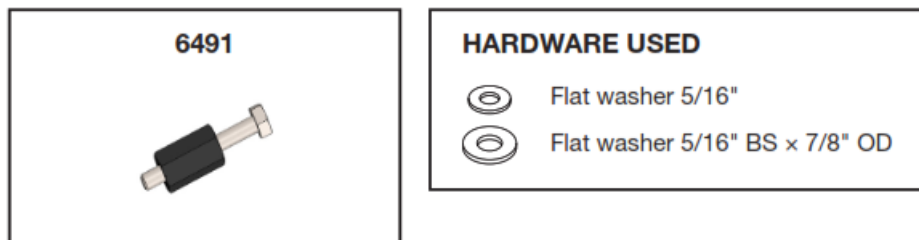

TOOLS

- Cordless Impact
- 1/2" Socket
- 9/16" Wrench

STEP 1: Assemble the 6491 plus nut tool with the hardware needed, plus the nut and the 9/16" wrench as shown.

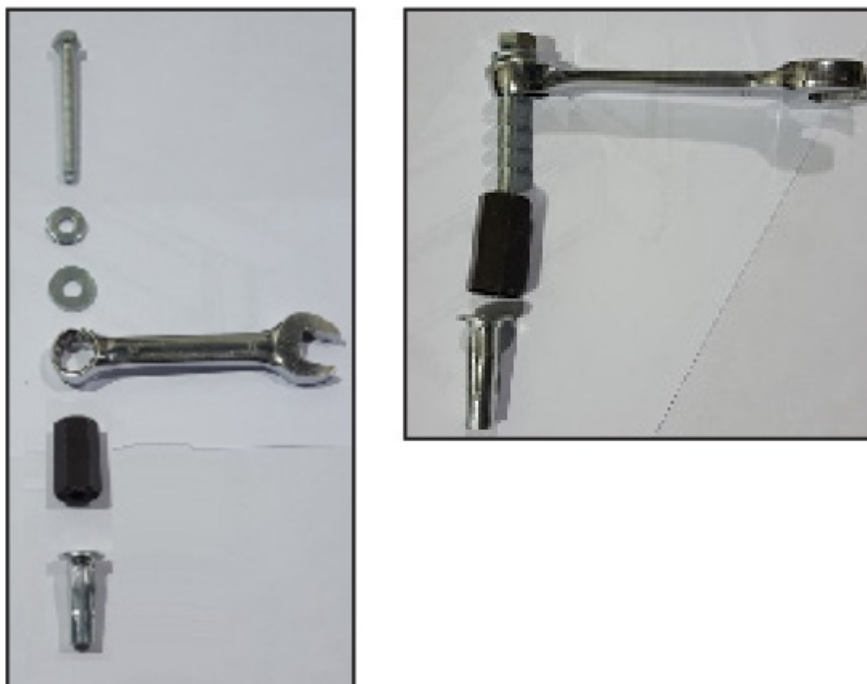

STEP 2: Attach the plus nut in the hole by turning the bolt forward using an impact with a 1/2" socket until the Plusnet locks, then remove the bolt by turning the impact in reverse.



FORWARD



REVERSE

PHASE 2 – INSTALLATION

2.4 ATTACH THE SHELF UNIT TO THE FLOOR

without ranger floor

2.4.1 Put the assembled shelf back in place aligning the holes to the plus nuts, then install the end panels and center post to the plus nuts.

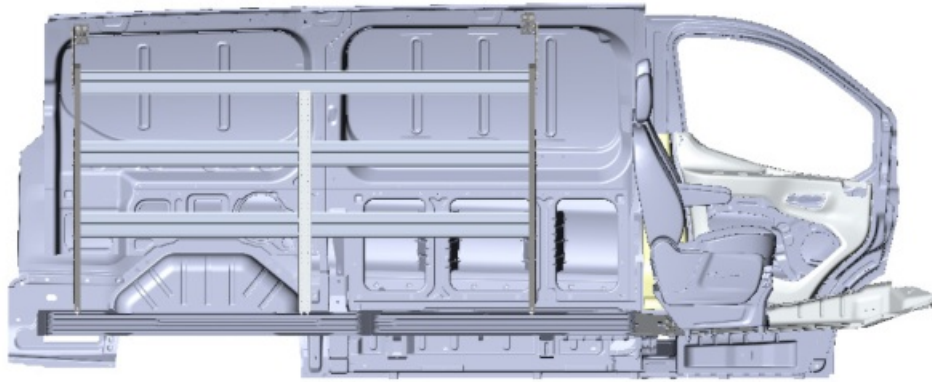

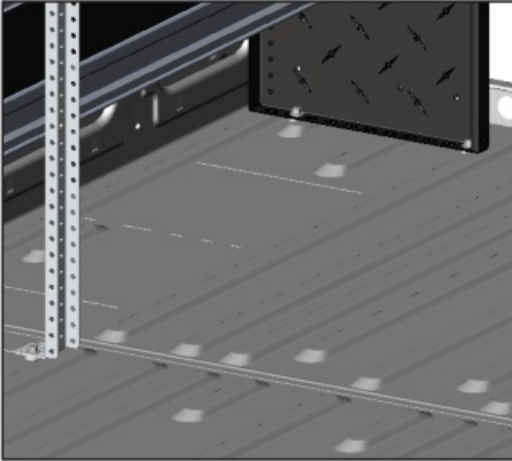





TOOLS

- ☐ Cordless Impact
- ☐ 1/2" Socket

HARDWARE USED

6x

	#90-011 Hex Bolt 5/16" x 1-3/4"
	#98-122 Lock Washer
	#98-116 Flat Washer
	#98-157 Spacers (QTY = GAP BETWEEN FLOOR AND END PANEL)
	#94-132 5/16" Plusnut

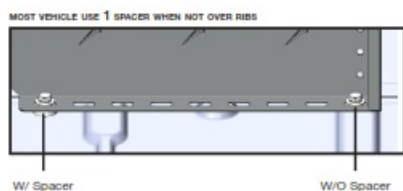

NOTE: Fastener should always be installed as close to the vertical face as possible.

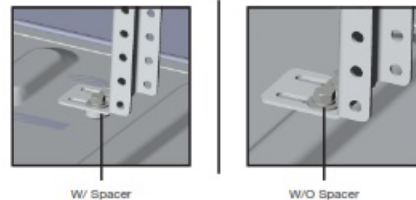

WITH RANGER FLOOR

2.4.2 • Lift the shelving unit inside the van, then put it in place.

- Install the shelving unit to the floor mounting track by sliding bolts in the mounting tracks, and putting screw in the last rear slot of the end panels of the shelving unit.

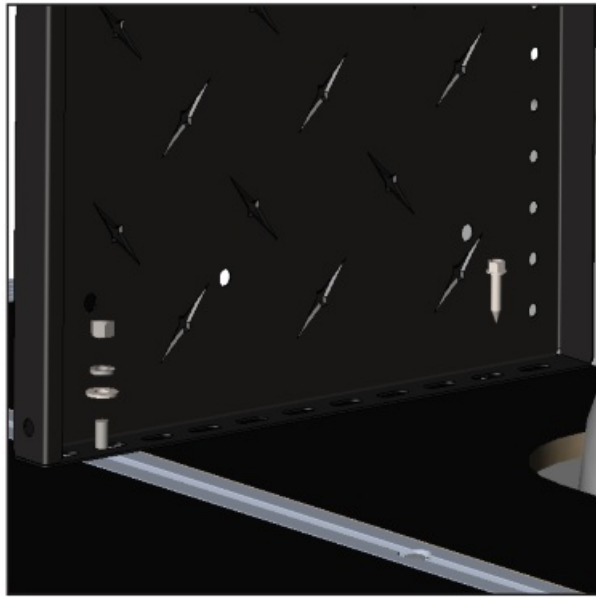
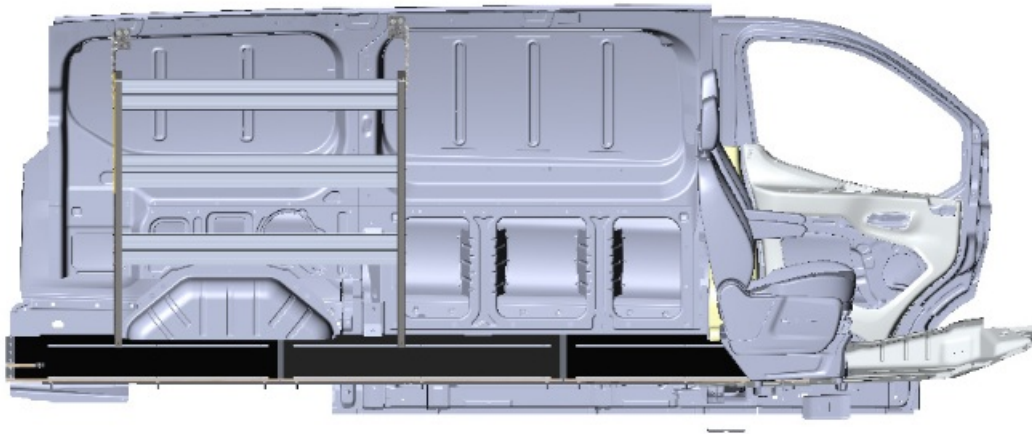

TOOLS

- ☐ Cordless Impact ☐ 3/8" Driver Bit
- ☐ 1/2" Socket

HARDWARE USED

2x FLOOR FASTENER KIT



#92-102 Screw 1"

HARDWARE USED

2x FLOOR FASTENER KIT



#90-490 Carriage Bolt 5/16" x 1"



#98-116 Lock Washer



#98-122 Flat Washer



#94-104 Hex Nut

PHASE 2 – INSTALLATION

2.5 ATTACH WALL BRACKETS WITH RANGER FLOOR

2.5.1 Aligned the wall brackets to the plus nuts, then install the wall brackets to the wall.

NOTE: Tightened the bolts that used to attach the wall bracket to the wall or wall kits 1 st before the bolts that used to attach the wall bracket to the end panel.

IMPORTANT: After installation is completed, ensure all bolts are tightened.

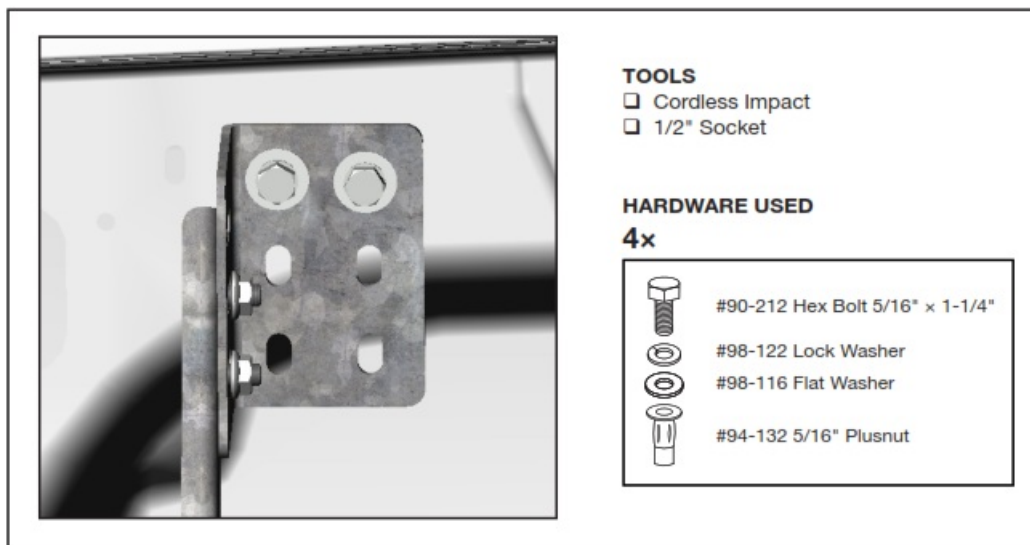
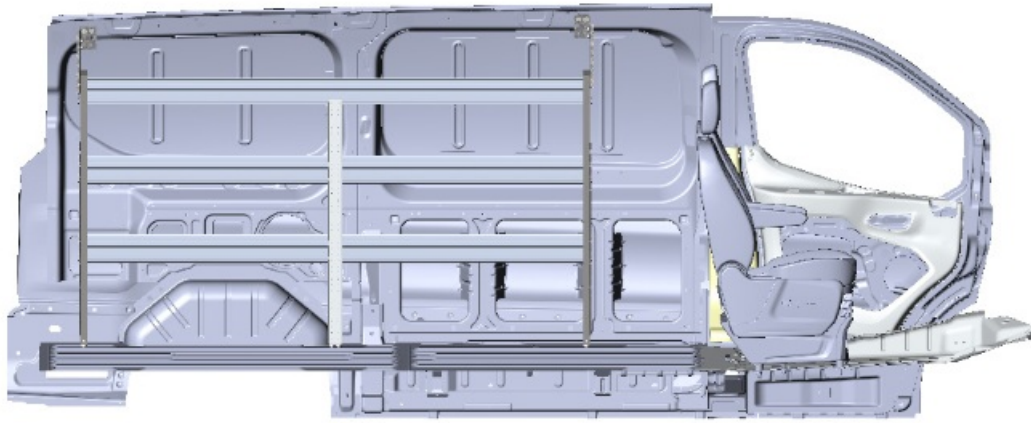

2.5.2 Aligned the wall brackets to the wall mounting track kits, then install the wall brackets to the wall mounting track kits using channel nuts.

NOTE: Tightened the bolts that are used to attach the wall bracket to the wall or wall kits 1 st before the bolts that are used to attach the wall bracket to the end panel.

IMPORTANT: After installation is completed, ensure all bolts are tightened.

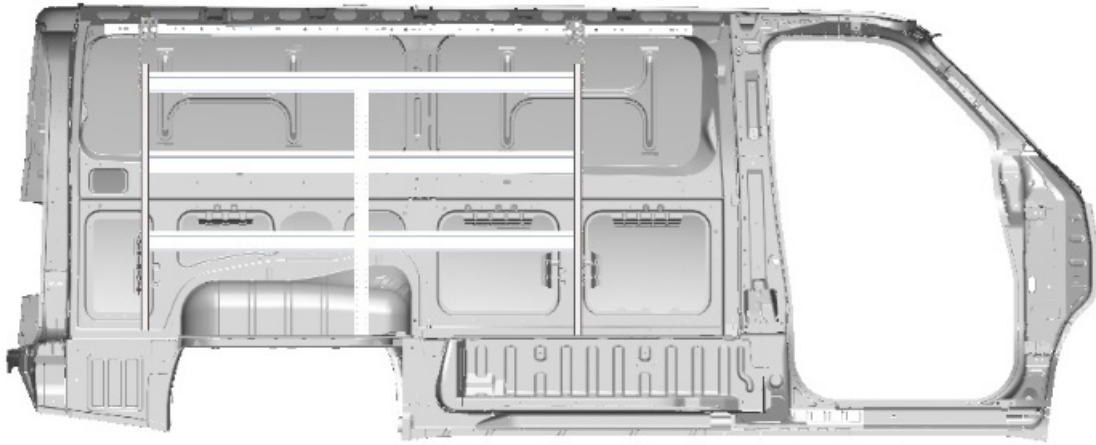

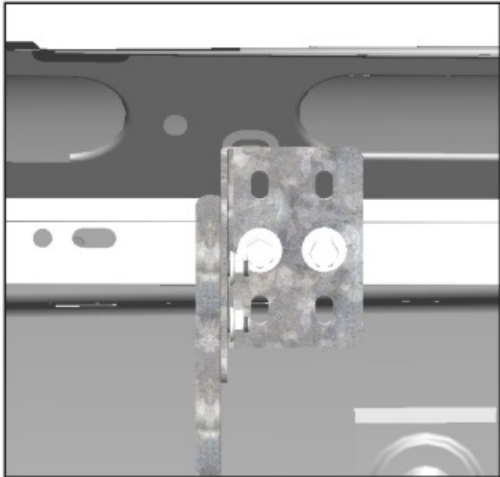





TOOLS

- ☐ Cordless Impact
- ☐ 1/2" Socket

FASTENERS USED

4x WALL KITS FASTENER KIT

	#90-212 Hex Bolt 5/16" x 1-1/4"
	#98-122 Lock Washer
	#98-116 Flat Washer
	#94-150 Channel Nut

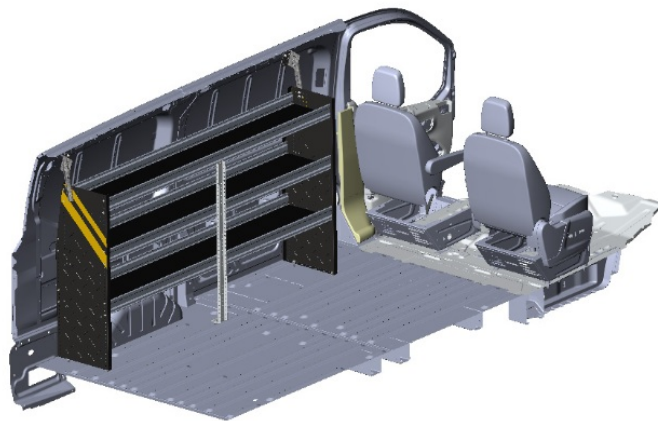

**“You have successfully installed your
N4-RS84-3**

Thank you for doing business with us.”

For any feedback or suggestions, you may have, please contact: cs@rangerdesign.com

For technical support, contact us at 1-800-565-5321

N4-RS84-3 Installation Guide | REV. B1

<p>INSTALLATION GUIDE</p>  <p>N4-RS84-3 Shelving (max.) Ranger N4-RS84-3 Ranger N4-RS84-3</p> 	<p>RANGER N4-RS84-3 Shelving [pdf] Installation Guide N4-RS84-3 Shelving, N4-RS84-3, Shelving</p>
---	---