

Randolph COMMUNICATIONS CommandIQ App User Guide

[Home](#) » [Randolph COMMUNICATIONS](#) » Randolph COMMUNICATIONS CommandIQ App User Guide 

Randolph COMMUNICATIONS Command IQ App User Guide

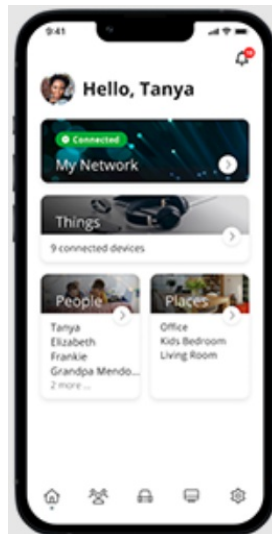

Contents

- [1 Setting up your Wi-Fi and App](#)
- [2 Documents / Resources](#)
 - [2.1 References](#)
- [3 Related Posts](#)

Setting up your Wi-Fi and App

1. Download the app. You can search either the Apple App Store or Google Play Store for: 'Command IQ ®', then install it on your mobile device.



2. Select "SIGN UP" towards the bottom of the screen

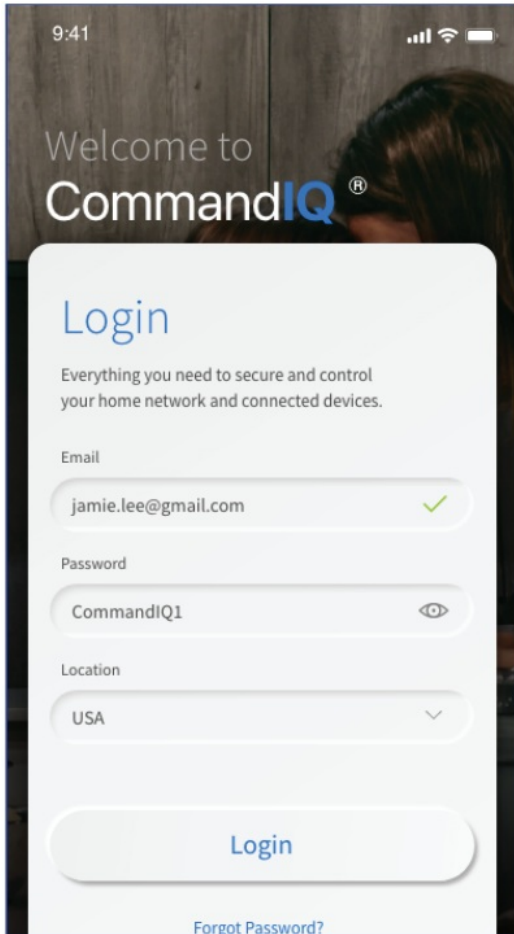

Getting started with the App

The App allows you to manage your home or small business Wi-Fi network. You can self-install and be managing your home or business within a few minutes. Download the app and start managing your home network today!

Next: Refer to the Command IQ Consumer Product Guide for details on how to use specific features.

3. Enter your personal information. The password you enter here will be used to access the app.

9:41

Step 1 of 3

Sign Up

Create a new account for CommandIQ

First Name

Jamie

Last Name

Lee

Email

jamie.lee@gmail.com ✓

Password

Location

USA

Sign up

Note: Please wait at least 10 minutes after your Giga Spire BLAST System has been 'turned up' before attempting step 4.

- If your system is plugged in and connected select "Yes" to continue. Otherwise select "Not Sure?" at the bottom of the screen and skip to steps 4a-4e on the next page to get things connected.

9:41

< X

Step 2 of 3

Scan Device

Scan your new device to get started.

The barcode is located lorem ipsum dolar sit lorem ipsum dolar sitlorem ipsum dolar sit.



Issue scanning?

5. Tap the QR code that appears within the app. (You will be asked to allow the app to access your camera). Point your camera at the QR Code found on the bottom of your Giga Spire BLAST System, or on the sticker that came in your box (example shown below). Select OK. After you select “Submit”, you may be asked to enter your account number.

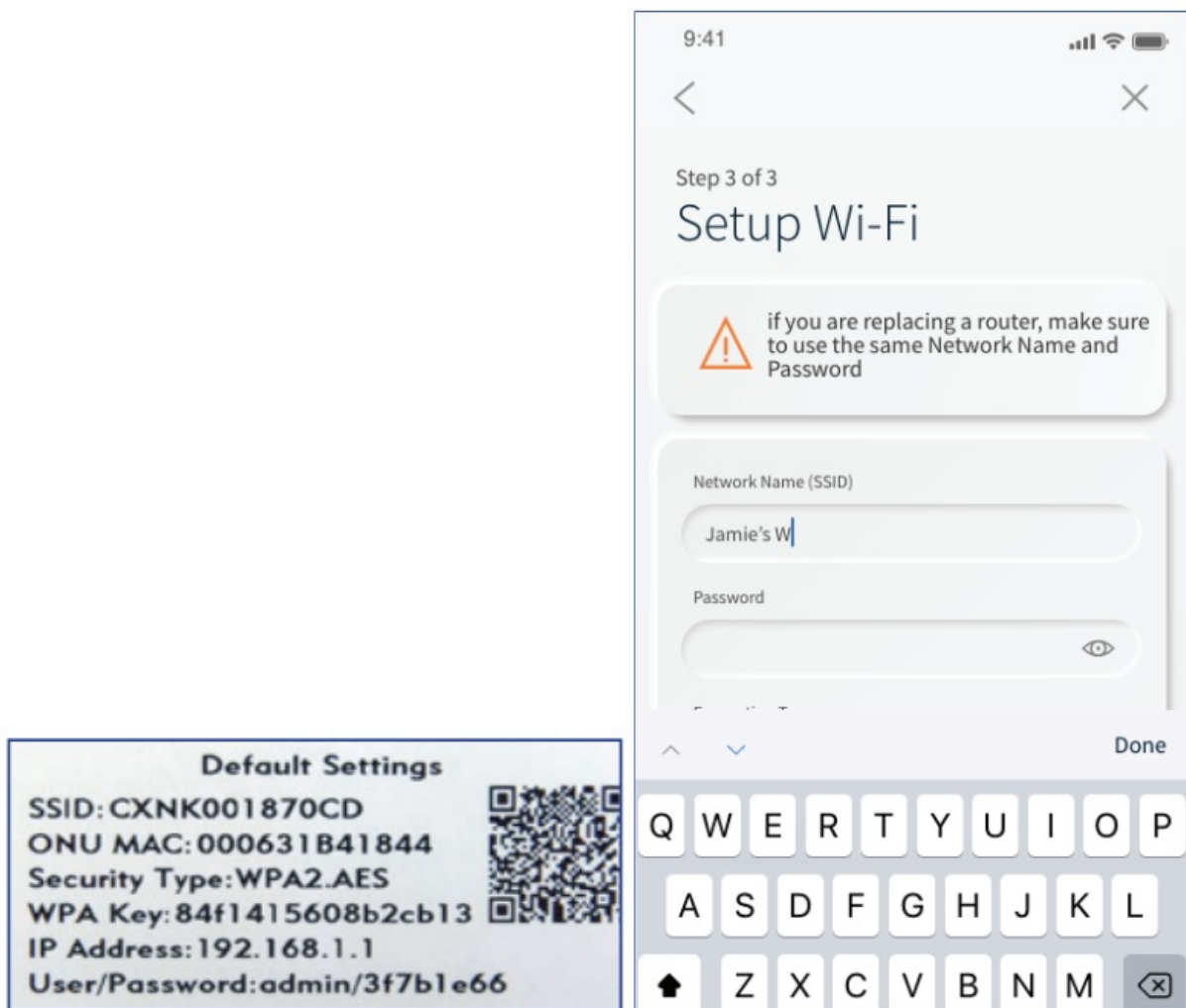

6. **Note:** If your system is already operating with Wi-Fi, tap the “Click here to skip” text. Other wise, complete these steps to set-up your Wi Fi. Name your network and create a password.

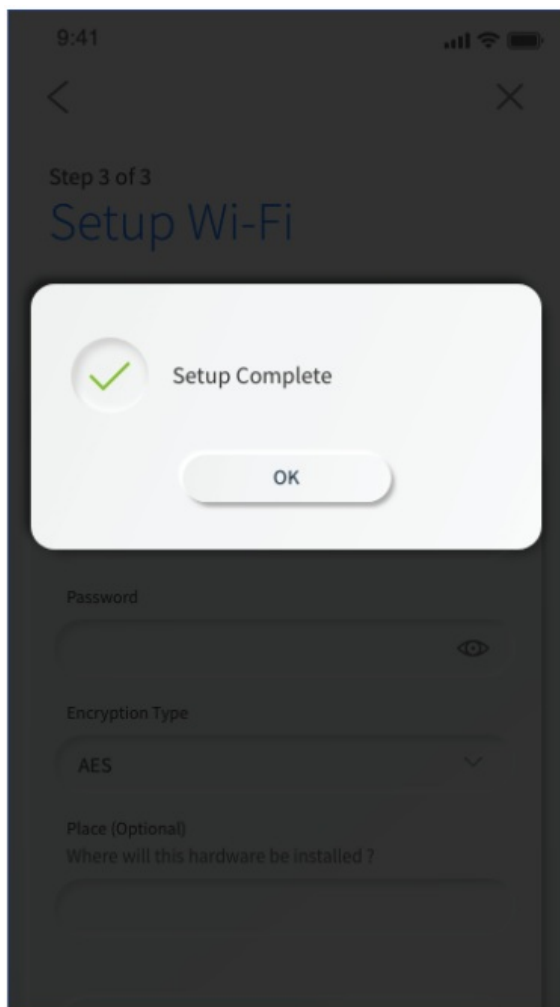

- The Router Name will be used throughout the app.
- The Network Name (**SSID**) is what you will use as your wireless connection name.
- Select a password for your wireless network, if you do not want to change it on all the devices in your home, use your existing wireless **SSID** and Password from your current router.

Need help?

Contact support: www.rtmc.net/commandiq.html
336-879-568



Documents / Resources

	<p>Randolph COMMUNICATIONS CommandIQ App [pdf] User Guide CommandIQ, App, CommandIQ App</p>
---	---

References

- [Randolph Communications - CommandIQ](#)

