



FP0282 Fork Protectors



RandG FP0282 Fork Protectors Instructions

[Home](#) » [RandG](#) » RandG FP0282 Fork Protectors Instructions 

Contents

- [1 RandG FP0282 Fork Protectors](#)
- [2 Product Specifications](#)
- [3 FAQ](#)
- [4 INTRODUCTION](#)
- [5 LEGEND](#)
- [6 ASSEMBLY DIAGRAM](#)
- [7 FITTING INSTRUCTIONS](#)
- [8 CONSUMER NOTICE](#)
- [9 R&G RACING RETURNS POLICY](#)
- [10 Documents / Resources](#)
 - [10.1 References](#)
- [11 Related Posts](#)



RandG FP0282 Fork Protectors



Product Specifications

- **Model:** FP0282 Fork Protectors
- **Manufacturer:** R&G
- **Material:** Various (refer to assembly diagram)
- **Dimensions:** Varies per component
- **Weight:** Varies per component

FAQ

- **Q:** Can I use these fork protectors on any bike?
 - **A:** These fork protectors are designed for specific models. Consult the manufacturer's compatibility list or contact a dealer for guidance.
- **Q:** Do I need any special skills to install these fork protectors?
 - **A:** Basic mechanical knowledge and familiarity with using tools like a socket set are recommended for installation. If unsure, seek assistance from a qualified technician.

- **Q:** How do I clean these fork protectors?
 - **A:** Use a mild soap solution and a soft cloth to clean the fork protectors. Avoid abrasive cleaners that may damage the surface.

INTRODUCTION

THIS KIT CONTAINS THE ITEMS PICTURED AND LABELLED OVER PAGE.

SOME PARTS MAY BE SHOWN FOR CLARITY OF INSTRUCTIONS ONLY.
DO NOT PROCEED UNTIL YOU ARE SURE ALL PARTS ARE PRESENT.
PLEASE READ ALL INSTRUCTIONS BEFORE PROCEEDING.

IF IN ANY DOUBT WHEN FITTING OUR PRODUCTS, CONSULT ONE OF OUR DEALERS OR HAVE FITTED BY A QUALIFIED TECHNICIAN.

PLEASE NOTE THAT THE WAY THE KIT IS PACKED DOES NOT NECESSARILY REPRESENT THE WAY OF MOUNTING TO THE BIKE.
IN THE EVENT OF RUBBER WASHERS BEING USED TO HOLD COMPONENTS ONTO BOLTS, THESE RUBBER WASHERS CAN BE THROWN AWAY.

TOOLS REQUIRED

TOOLS REQUIRED	GENERAL TORQUE SETTINGS
Socket Set to Include 2 x 13mm sockets and wrenches.	M4 BOLT = 8Nm M5 BOLT = 12Nm M6 BOLT = 15Nm M8 BOLT = 20Nm M10 BOLT = 40Nm M12 BOLT = 40Nm

LEGEND

ITEM No.	DESCRIPTION	QTY
ITEM 1	B0445 M8 CRASH PROTECTOR (BOTH SIDES)	2
ITEM 2	S1255 LEFT-HAND-SIDE CRASH PROTECTOR SPACER	1
ITEM 3	S1256 RIGHT-HAND-SIDE CRASH PROTECTOR SPACER	1
ITEM 4	SB024 SPINDLE BAR (M8 x 325mm LONG)	1
ITEM 5	M8 NYLOC NUT	2
ITEM 6	M8 WASHER (16mm O/D)	2

ASSEMBLY DIAGRAM

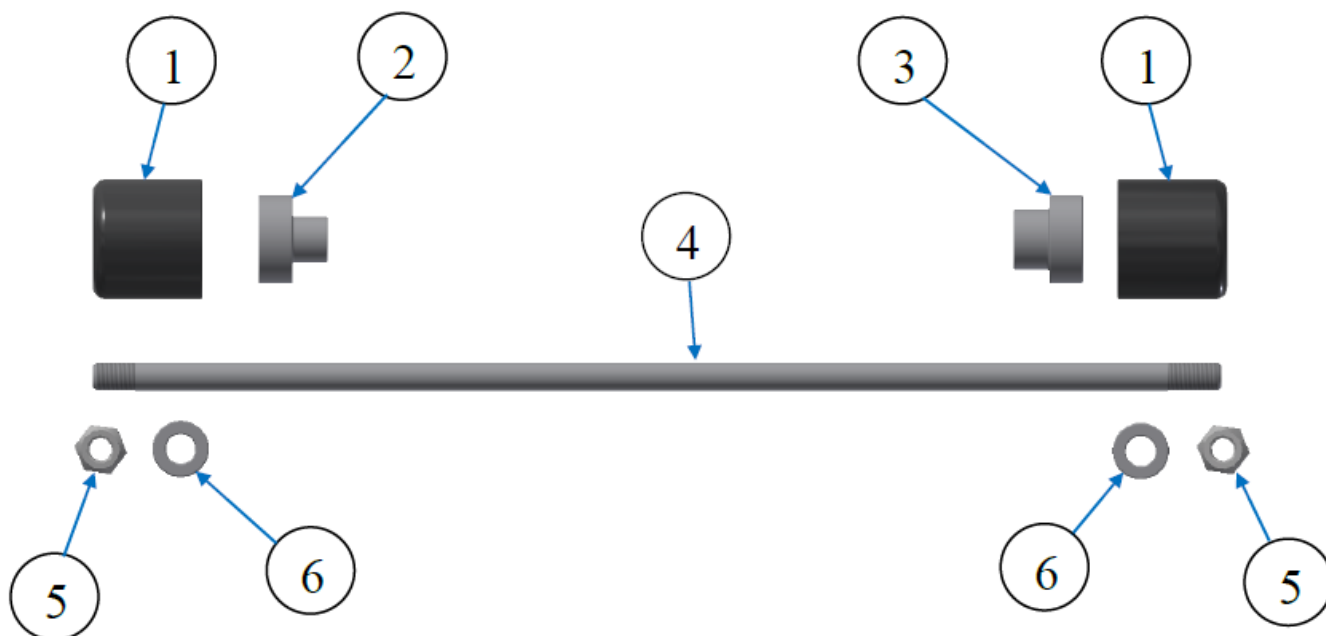

FITTING INSTRUCTIONS

- Fit one nut (item 5) and one washer (item 6) to the spindle bar (item 4), engaging the nut so the plastic insert of the nut is fully engaged and the bar protrudes by 1 or 2 threads. It is recommended to use a small amount of superglue or Loctite to fix this nut as this will aid when tightening the opposite side later.
- Feed the spindle bar with nut and washer through either crash protector (item 1) and then through the spacer with the smaller location diameter (item 2) as shown in the assembly diagram, then slide this assembly into the left hand side of the front spindle ensuring the spacer is located into the spindle.
- Moving to the right-hand side of the bike, slide the remaining spacer (item 3) over the exposed end of the spindle bar so the smaller-diameter end sits within the spindle.
- Fit the remaining crash protector (item 1) over the spindle bar and spacer, then fit the remaining washer (item 6) and nut (item 5) from the kit onto the thread protruding from the crash protector.
- Finally tighten the nut on both sides evenly using two 13mm sockets and ensure that the plastic insert of both nuts are fully engaged and the protruding threads are equal on both sides. Check the fork protectors are secure and held firmly against the spacers and do not spin.
- Do not overtighten – the Nyloc nuts will hold it tight.
- After riding the bike, check the tightness of the nuts regularly (e.g. when cleaning the bike).

ISSUE 1 – 08/01/2024 (MH)

CONSUMER NOTICE

The catalogue description and any exhibition of samples are only broad indications of the Products and R&G may make design changes which do not diminish their performance or visual appeal and supplying them in such state shall conform to the order. The Buyer acknowledges no representation or warranty (other than as to title) has been given or will apply to the Products other than those in R&G's order or confirmation and the Buyer confirms it has chosen the Products as being of merchantable quality and suitable for its particular purposes. Where R&G fits the Products or undertakes other services it shall exercise reasonable skill and care and rectify any fault free of charge unless the workmanship has been disturbed.

The Buyer is responsible for ensuring that the warranty on the motorcycle is not affected by the fitting of the

Products. On return of any defective Products R&G shall at its option either supply a replacement or refund the purchase money but shall not be liable if the Products have been modified or used or maintained otherwise than in accordance with R&G's or manufacturer's instructions and good engineering practice or if the defect arises from accident or neglect. Other than identified above and subject to R&G not limiting its liability for causing death and personal injury, it shall not be liable for indirect or consequential loss and otherwise its liability shall be limited to the amounts paid by the Buyer for the Products or the fitting or service concerned. These terms do not affect the Buyer's statutory rights.

R&G RACING RETURNS POLICY

R&G RACING RETURNS POLICY (NON-FAULTY GOODS)

Returns must be pre-authorized (if not pre-authorized the return will be rejected). Goods may only be returned direct to us if they were purchased direct from us (customer must prove if necessary). Otherwise to be returned to original vendor. Goods must be in re-sellable condition, in the opinion of R&G Racing. All returns are subject to a 25% restocking and handling fee (25% of the gross value exc. P&P – at the prevailing price at time of purchase). The customer must pay any and all carriage charges. No returns of discontinued products, unless within 14 days of purchase. This policy does not affect your statutory rights and does not refer to faulty goods.

No returns of discontinued products, unless within 14 days of purchase. This policy does not affect your statutory rights and does not refer to faulty goods.

R&G

- Unit 1, Shelley's Lane, East Worldham, Alton, Hampshire, GU34 3AQ
- **Tel:** +44 (0)1420 89007
- **Fax:** +44 (0)1420 87301
- www.rg-racing.com
- **Email:** info@rg-racing.com

Documents / Resources

	<p>RandG FP0282 Fork Protectors [pdf] Instructions FP0282 Fork Protectors, FP0282, Fork Protectors, Protectors</p>
---	--

References

- [R RACING.COM - YOUR RACING CONNECTION](http://R.RACING.COM)
- [Welcome to R&G | Setting the standard in bolt-on motorcycle accessories and Crash Protectors](#)
- [Welcome to R&G | Setting the standard in bolt-on motorcycle accessories and Crash Protectors](#)
- [User Manual](#)

[Manuals+](#), [Privacy Policy](#)

This website is an independent publication and is neither affiliated with nor endorsed by any of the trademark owners. The "Bluetooth®" word mark and logos are registered trademarks owned by Bluetooth SIG, Inc. The "Wi-Fi®" word mark and logos are registered trademarks owned by the Wi-Fi Alliance. Any use of these marks on this website does not imply any affiliation with or endorsement.