



**RTEK-100
576
Adjustabl
e Trailing
Arm**



RalliTEK RTEK-100576 Adjustable Trailing Arm Instruction Manual

[Home](#) » [RalliTEK](#) » RalliTEK RTEK-100576 Adjustable Trailing Arm Instruction Manual 

Contents

- [1 RalliTEK RTEK-100576 Adjustable Trailing Arm](#)
- [2 Product Usage Instructions](#)
- [3 FAQ](#)
- [4 Installation Instructions](#)
- [5 Documents / Resources](#)
 - [5.1 References](#)
- [6 Related Posts](#)



RalliTEK RTEK-100576 Adjustable Trailing Arm



Specifications

- Product Name: RalliTEK Adjustable Trailing Arm
- Model Number: RTEK-100576
- Fastener Torque Value: 67 ft-lbs for Trailing Arm Bolt Chassis, 67 ft-lbs for Trailing Arm Bolt Knuckle, 70 ft-lbs for 3/4-16 Jam Nuts

Product Usage Instructions

Installation

1. Lift the vehicle and support it with jack stands.
2. Remove the rear wheels.
3. Remove the bolts and nuts to take out the OEM trailing arms.
4. Adjust the RalliTEK arm using the 3/4-16 double adjuster ensuring even thread engagement on both sides.
5. Set the RalliTEK arm to a similar length as the OEM arm initially, then adjust as needed.
6. Install the RalliTEK arms, ensuring maximum clearance around the toe arms. Adjust to desired length and tighten jam nuts from clevis to rod end.
7. Reinstall the wheels and schedule a professional alignment.

Product Warranty

RalliTEK branded products are warranted against manufacturing defects for the lifetime of the product. Contact RalliTEK Customer Service for warranty evaluation and return instructions.

FAQ

Q: Can I use any fasteners for installation?

A: Use only the parts supplied by RalliTEK to install this kit to ensure proper fit and function.

Q: Do I need a professional alignment after installing the RalliTEK arms?

A: Yes, a professional alignment is required after installing the RalliTEK arms to ensure optimal performance and

safety.

Q: What should I do if I encounter stripped threads during re-installation?

A: Avoid using an impact wrench when re-installing bolts to prevent stripped threads. Contact RalliTEK Customer Service for guidance on resolving the issue.

Suggested Tools

- Metric Sockets, Ratchets, Wrenches
- Screw Drivers, Pliers
- Jack, Jack Stands, Wheel Chocks

Safety Warnings

- Always support the vehicle with jack stands before working underneath
- Use only the parts supplied by RalliTEK to install this kit
- Check ALL the fasteners for tightness before and after road testing the vehicle
- Do not use an impact wrench when re-installing bolts as stripped threads may occur

NOTICE

A professional alignment is required after this install.

Exercise caution during installation and operation of this product to prevent harm or damage to equipment. Thoroughly read and understand all safety precautions and operating instructions before proceeding with the installation and operation of this product.

| Fastener | Fastener Torque Value ft-lbs |
|---------------------------|------------------------------|
| Trailing Arm Bolt Chassis | 67 |
| Trailing Arm Bolt Knuckle | 67 |
| 3/4-16 Jam Nuts | 70 |

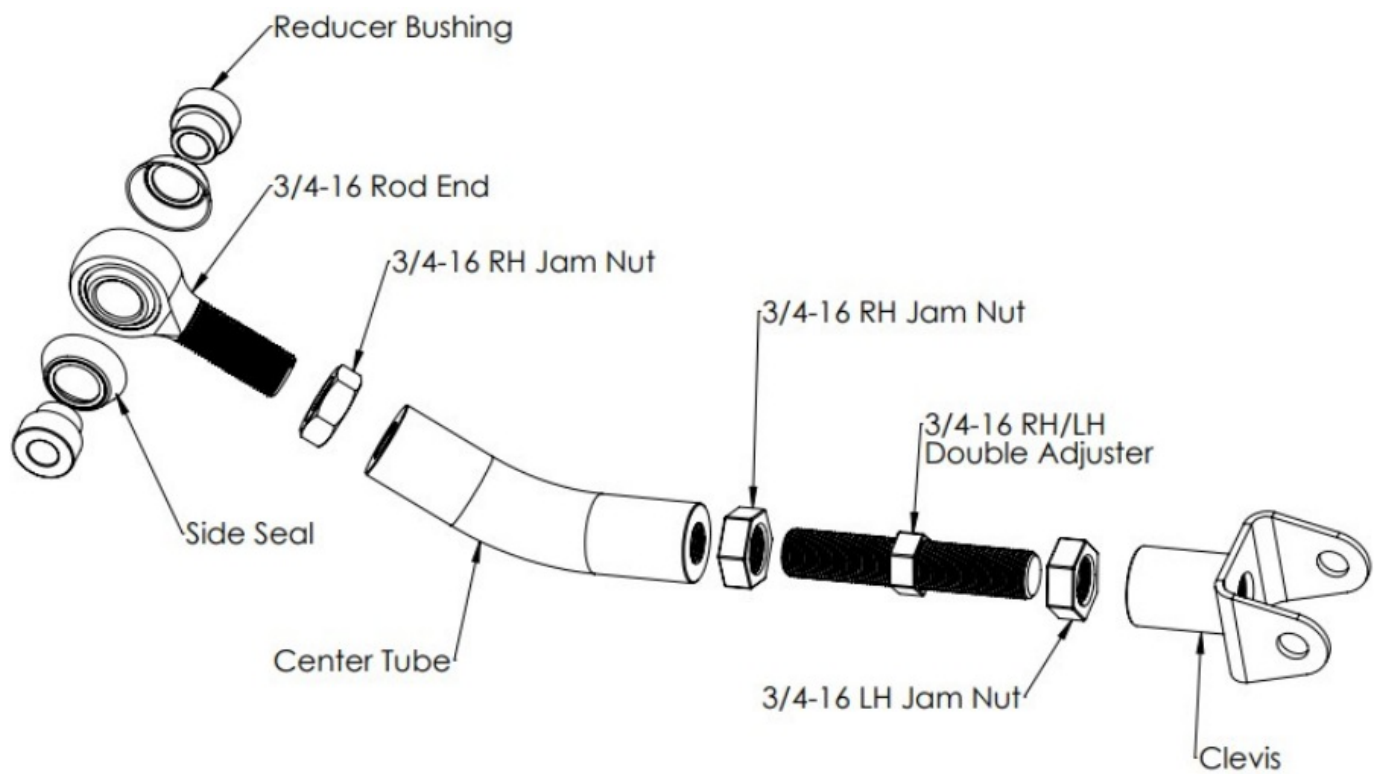

Installation Instructions

- Lift the vehicle and support with jack stands.
- Remove the rear wheels.
- Remove the bolts and nuts, and remove the OEM trailing arms.
- Using the parts diagram on the previous page, start assembling the RalliTEK trailing arms. Please use the supplied anti-seize to lubricate the threads and help prevent corrosion.
- The 3/4-16 rod end should be fully threaded into the center tube.
- All adjustments should be done with the 3/4-16 double adjuster. Take care to make sure there is an even amount of thread engagement on both sides of the double adjuster. Set RalliTEK arm to approximately the same length as the OEM arm as a starting point and adjust as needed.
- Install RalliTEK arms, making sure to orient the center tube for maximum clearance around the toe arms. Adjust to desired length and tighten jam nuts starting from the clevis and moving out toward the rod end.



Minimum and maximum safe adjustment are shown below.

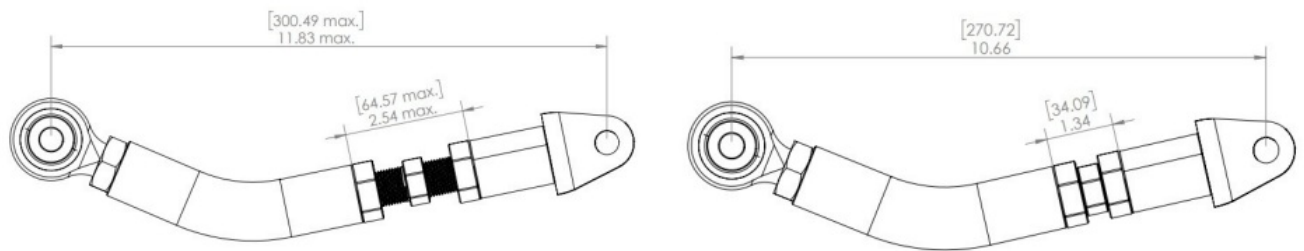

- Reinstall wheels and schedule a professional alignment.
- RalliTEK Products Lifetime Warranty RalliTEK branded products are warranted to the original owner against manufacturing defects in materials and workmanship for the lifetime of the product.
- If a RalliTEK branded product covered by this warranty fails due to a manufacturing defect, we will repair the product, without charge, or replace it at our discretion. This policy covers only original, unaltered, and unmodified materials and workmanship. This warranty does not cover damage caused by incorrect installation, accident, improper care, negligence, normal wear and tear, or the natural breakdown of colors and materials over extended time and use. Damage not covered under warranty may be repaired for a reasonable rate and a fee will be charged for return shipping.
- No payment or reimbursement shall be made for installation, removal, transportation, or other charges. The remedies outlined in this warranty are exclusive and the liability of RalliTEK with respect to any sale shall not exceed the price of the product on which the liability is based.
- For warranty evaluation, please contact RalliTEK Customer Service via phone (503) 619.0055 or email info@rallitek.com to obtain a return authorization. Once this step has been completed, your product must be returned directly to the RalliTEK Warranty Department, 13339 NE Airport Way, Suite 500, Portland, OR 97230. All shipping to the Warranty Department must be pre-paid and insured. RalliTEK will not be liable for damaged or lost inbound packages.

NOTE

- This warranty is only available within the United States or Canada
- This warranty does not cover products sold by RalliTEK that are not RalliTEK branded products
- This warranty gives you specific legal rights; you may have other rights, which vary from state to state

Documents / Resources

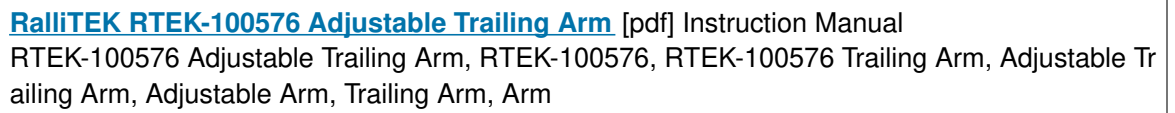

This website is an independent publication and is neither affiliated with nor endorsed by any of the trademark owners. The "Bluetooth®" word mark and logos are registered trademarks owned by Bluetooth SIG, Inc. The "Wi-Fi®" word mark and logos are registered trademarks owned by the Wi-Fi Alliance. Any use of these marks on this website does not imply any affiliation with or endorsement.