

Raddy WS-3
Smart Dual
Water Timer



Raddy WS-3 Smart Dual Water Timer User Manual

[Home](#) » [RADDY](#) » Raddy WS-3 Smart Dual Water Timer User Manual 

Contents

- 1 Raddy WS-3 Smart Dual Water Timer
- 2 Meet the Smart Dual Water Timer
- 3 Specification
- 4 Meet the Gateway
- 5 Meet the App Home Screen
- 6 Importance Preparation Checklist
- 7 Smart Life App Setup
- 8 Pair the Gateway and add Water Timer
- 9 Pair the Water Timer
- 10 Additional Water Timer Features
- 11 Troubleshooting
- 12 Documents / Resources
 - 12.1 References

RADDY

Raddy WS-3 Smart Dual Water Timer



Meet the Smart Dual Water Timer

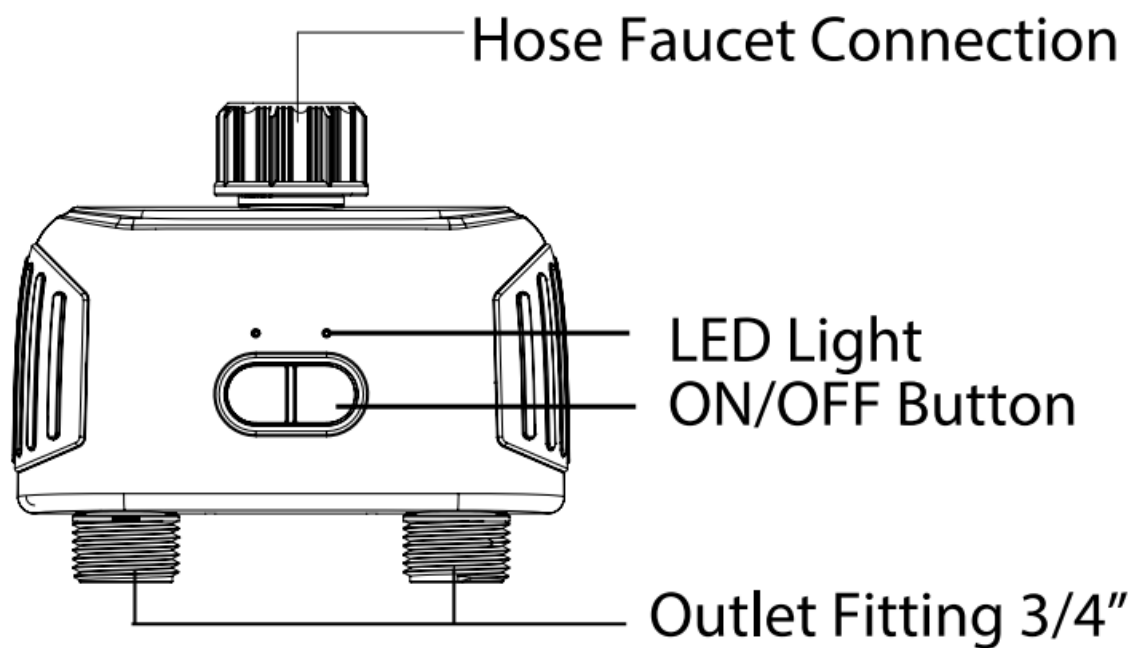

Specification

Bluetooth Range	49.2ft without interference
Working Water Pressure	7.25-116 psi
Working Temperature	40.1°F-113°F (4.5°(-45°))
Rain Delay Time	1 day and up to 7 days
Waterproof	IPX5
Battery	4x AA alkaline batteries

NOTE: Water Timer and Gateway should be placed at an appropriate distance according to the actual usage environment. Please find the best placement to ensure the connection stability.

Meet the Gateway

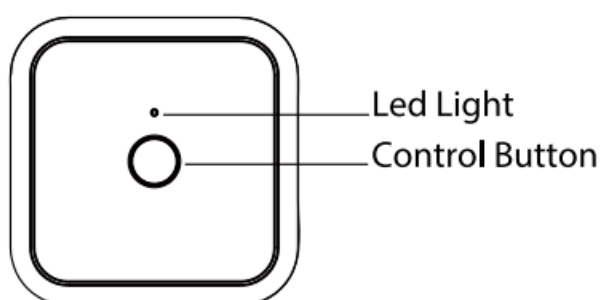

Working Humidity	10%-90% RH (no condensation)
Range	49.2ft without interference
Input	110-2S0V~S0/60Hz
WiFi Frequency	2.4GHzonly
Protocol	IEEE 802.11b/g/n & Bluetooth
APP	Smart Life
Total Number	32MAX
Note	For door use only

NOTE: Gateway and router should be placed at an appropriate distance according to the actual usage environment. Please find the best placement to ensure network stability.

Meet the App Home Screen

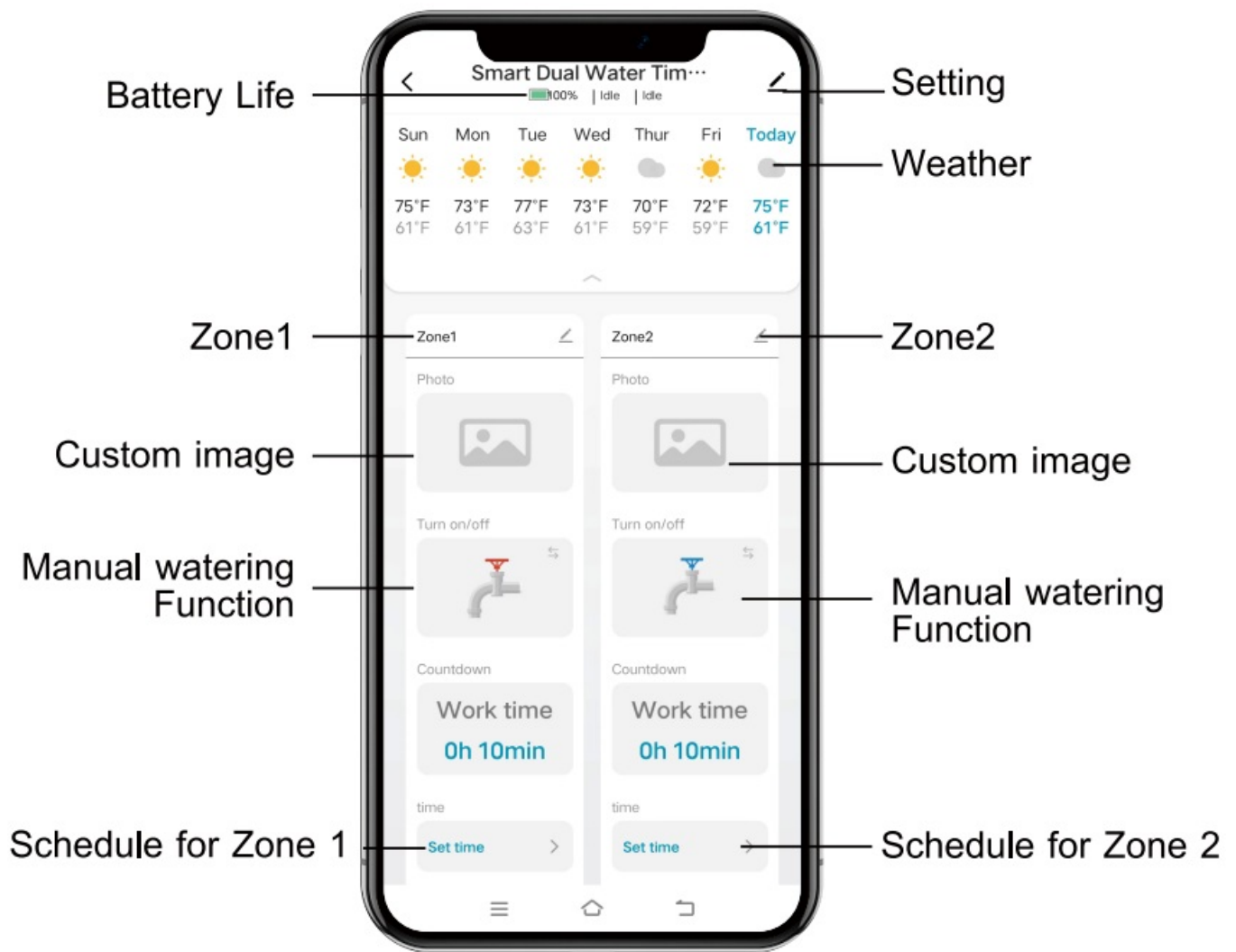

(Image 1)

Importance Preparation Checklist

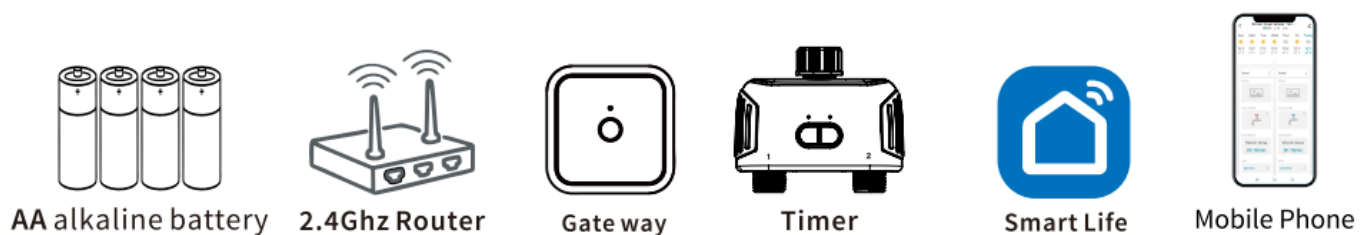

Note: Turn on Bluetooth on your phone.

Quick Installation Guide

1. Install the Smart Life app and log in.
2. Install 4 AA alkaline batteries into the timer.
3. Prepare your 2.4Ghz WIFI password.
4. Keep connected the Phone to 2.4Ghz WIFI.
5. Turn on Bluetooth on your phone.
6. Pair the Gateway.

7. Pair the Water Timer.
8. Finish Gateway and Water Timer associated.
9. Turn off Bluetooth on your phone.
10. **Note:** Check the Water Timer is under the Gateway list.

Smart Life App Setup

Scan the QR code and download the free Android or iOS app, then install the APP. Create an account with your email or mobile number or log in with an existing account.



Water Timer Setup

1. Remove the cover on the back of the timer by pulling it out.
2. Install 4 new AA (1.5V) alkaline batteries and reinstall the cover back into the timer. Do not mix alkaline, standard (carbon-zinc), or rechargeable batteries.

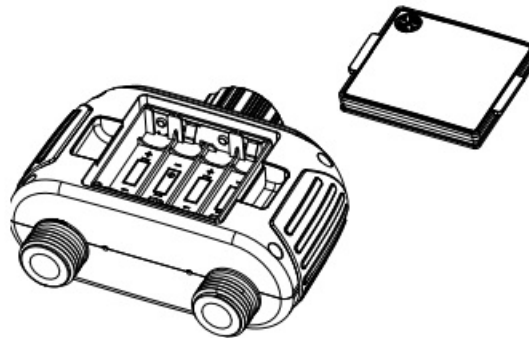

NOTE: Please pay attention to the positive and negative poles of the battery and place them correctly.

Pair the Gateway and add Water Timer

Before starting the following steps, make sure the phone is connected to 2.4GHz WIFI (Not 5GHz WIFI) and bluetooth is turned on.

Pair the Gateway

- Long press the Gateway control button for 5s until the green light flashes quickly, click the sign "+" in the upper right corner, and tap "Add Device" to add Gateway.

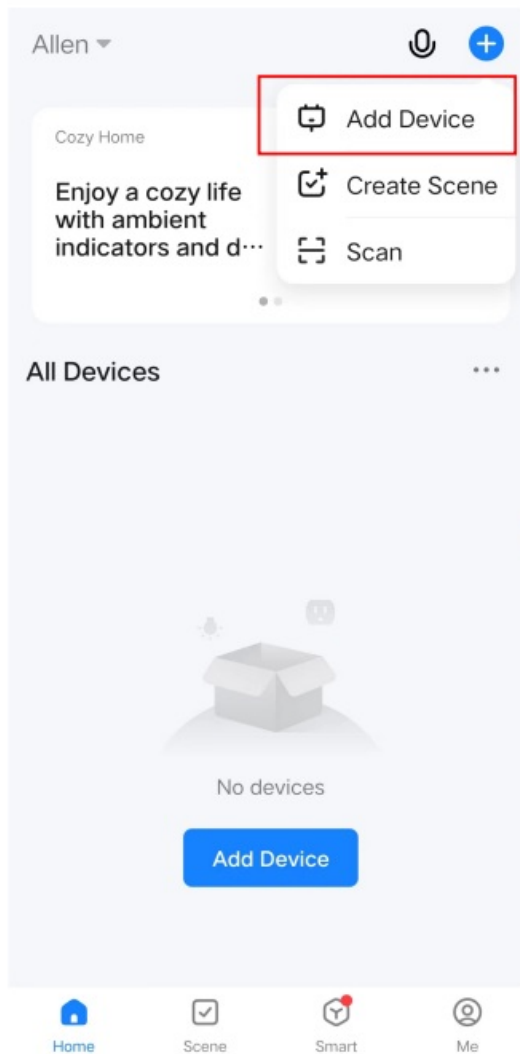

(Image 2)

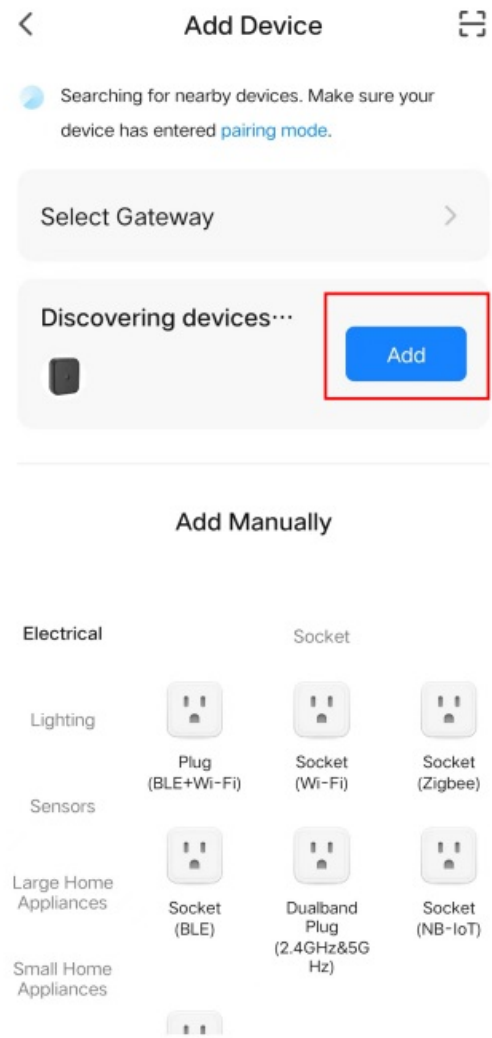

(Image 3)

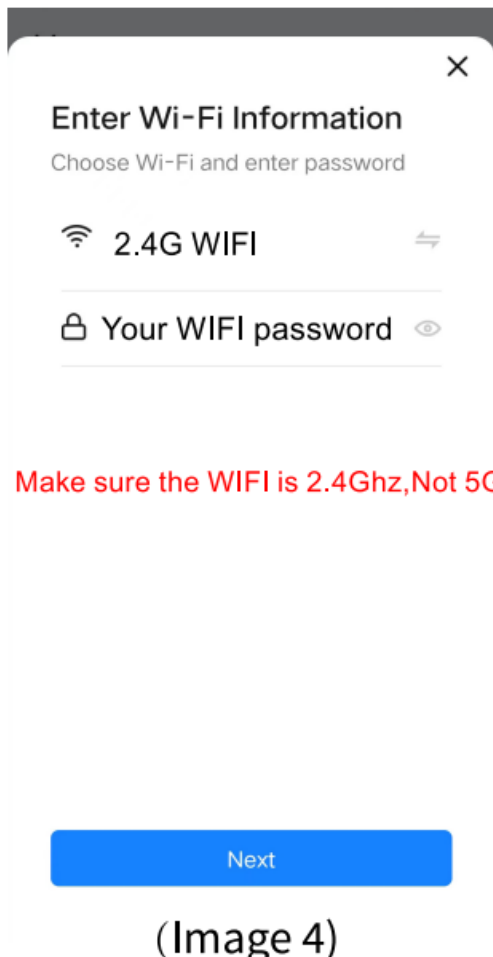

(Image 4)

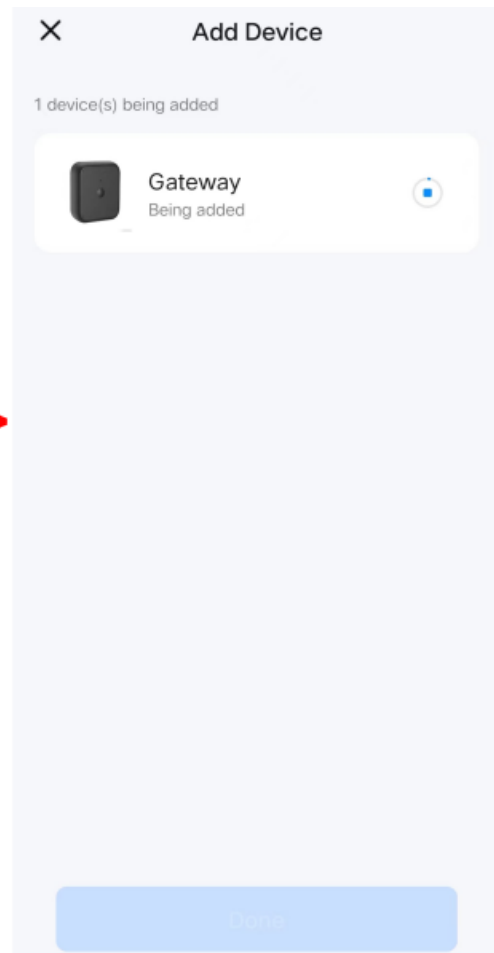

(Image 5)

- Waiting for connecting to be 100%.
- **Tips:** If failed, please power off the device, and try all steps again.

Pair the Water Timer

- Long press either of the “On/OFF buttons for 6s until the green light flashes quickly at the same time, click the sign”+” in the upper right corner, and tap “Add Device” to add Water Timer.

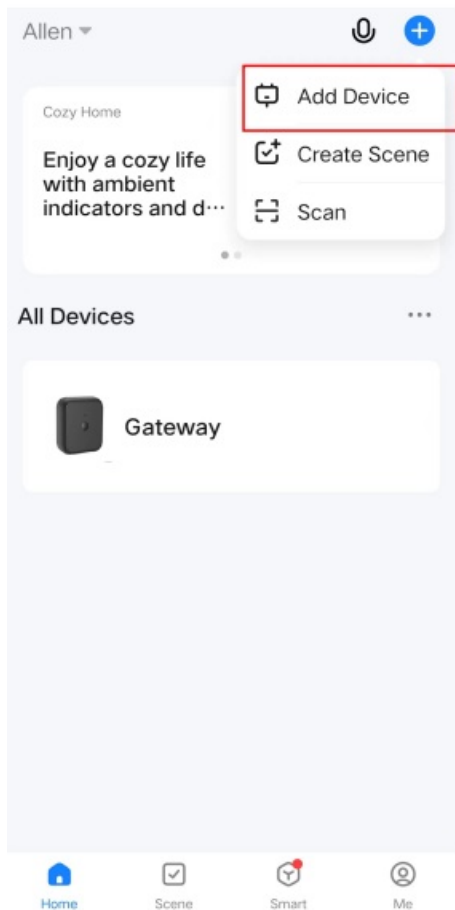

(Image 6)

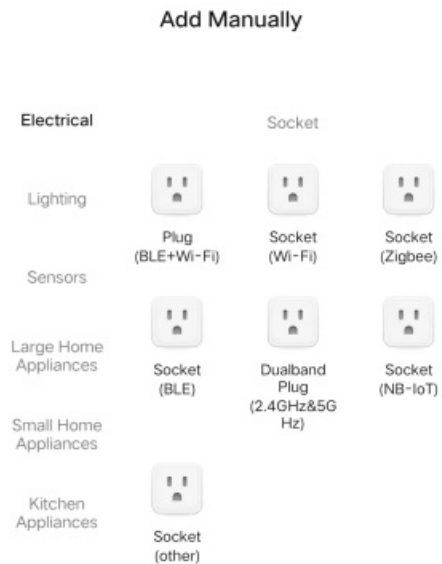
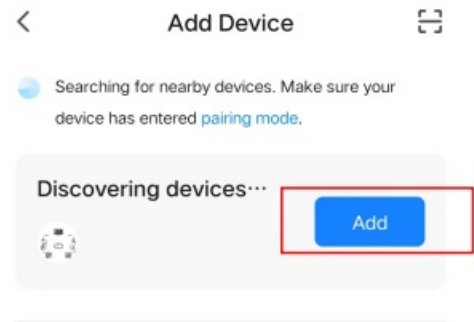

(Image 7)

- Waiting for connecting to be 100%.
- **Tips:** If failed, please power off the device, and try all steps again.

Gateway and Water Timer associated

- When the timer connecting is completed, it will come to "Association Settings" directly, follow all steps to complete the setup.

Association Settings

After the following Bluetooth devices are associated with the network, the status can be viewed remotely, and the remote association can be realized



Smart Dual Water Timer



Skip, set up later

(Image 8)



Association Settings

After the following Bluetooth devices are associated with the network, the status can be viewed remotely, and the remote association can be realized



Smart Dual Water Timer



Associate



Gateway

Linked
device(0/128)

Associate

(Image 9)

- If you choose “Skip, set up later”, don’t worry, please go to the next page.
- Go back to the App “Home” page, you will find Water Timer and Gateway both are under the “All Devices” list then please follow the below steps
- Tap “Gateway” → “Add device” → “Add existing.”
- Then choose the Water Timer and Confirm to add.

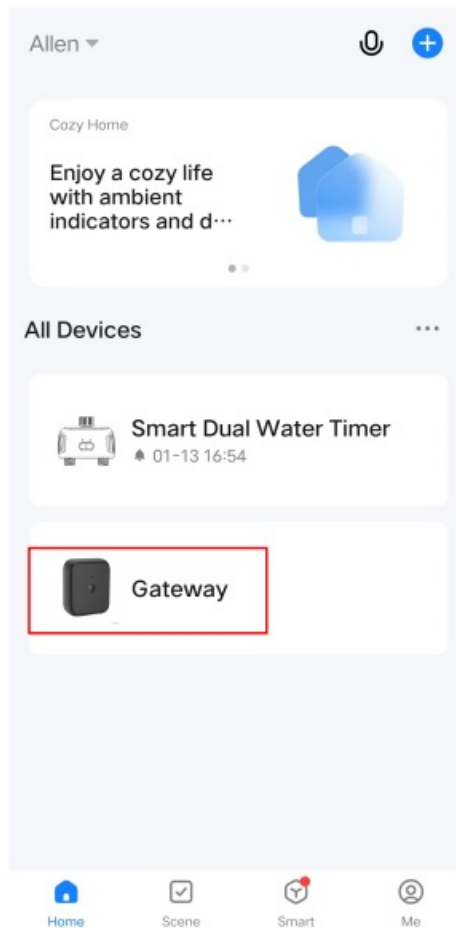

(Image 10)

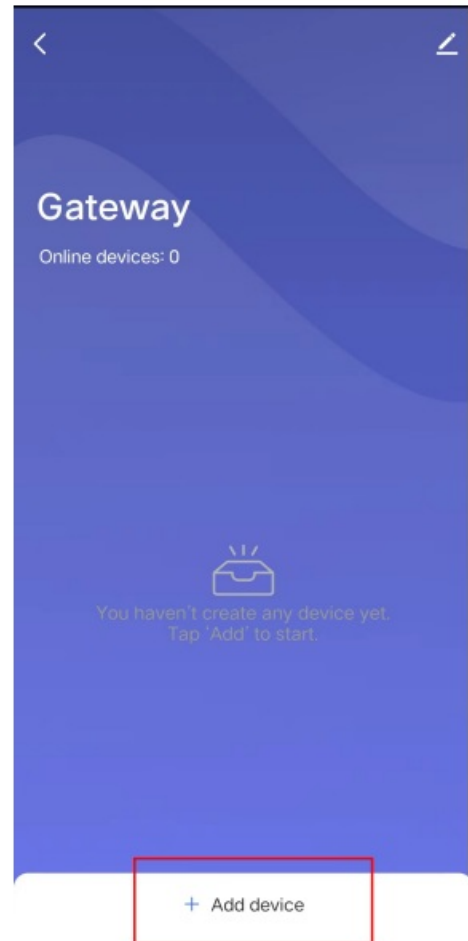

(Image 11)

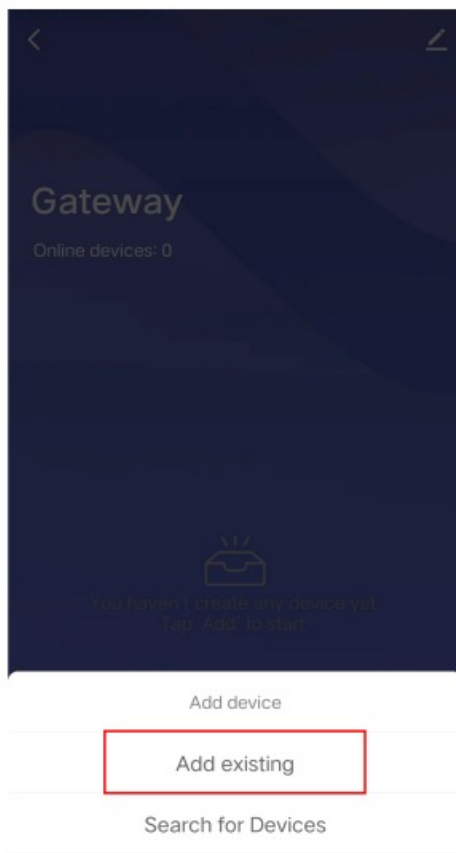

(Image 12)

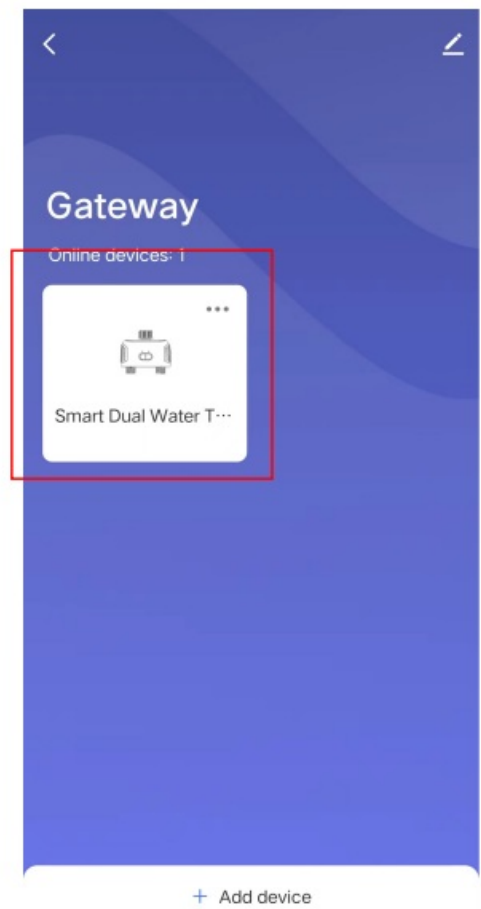

(Image 13)

- When you finish all the steps, please turn off the Bluetooth, The last final step (image 13) is very

important, which means you can remotely control the timer even if you are traveling.

Additional Water Timer Features

1. Manual Watering

- Your timer can allow you to manually water without disturbing the programmed schedule. Manual is used to test equipment, run an extra watering cycle in an area, or use the hose faucet without removing the timer.



- Click the button to activate manual watering.

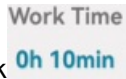

- Using the app you click to set how long you want manual watering time to run for the work time. Also, also remaining watering time will be displayed.

2. Stop Watering

- You can stop the flow of water at any time whether it is during manual watering, or during a programmed



time. Click the button once again to stop watering.

- **NOTE:** icon without water droplets

3. Rain Delay Function

The rain delay function allows you to postpone watering for 1 day and up to 7 days due to rain or when the ground is already wet.

Troubleshooting

Q1: Why the Bluetooth water timer didn't turn on/off at preset time?

- Programming is incorrect
- The water pressure is too low
- Particles of dirt or debris stuck in the valve
- More than one start time is programmed with overlapping schedules
- Manual watering is on
- Faulty valve
- The batteries were low
- The faucet is off.

Q2: Why does Bluetooth keep dropping connection?

- The Bluetooth of the water timer is currently in sleep mode, please wait 5-10 seconds, and the device will automatically reconnect. Or scroll down to refresh the home page of the APP, or disconnect the Bluetooth from your phone and turn it on again
- If the device has been connected to other mobile phones, please disconnect first.
- Make sure the device battery is charged and place the phone as close to the device as possible.
- Please note that you don't need to stay connected once you set up your schedule. The device will always keep your watering settings and work automatically according to the schedule.

Q3: Why is the water valve out of little water?

If you are a gravity feed system such as a rain barrel system, then it won't work and will keep low water pressure. Gravity feed has no real pressure when dealing with a rain barrel. It needs pressure measuring.

Warm Tips

- The best range for connection and control is within 49.2ft in the open area.
- The bluetooth water timer does not support Alexa & Google Voice or remote control.
- Do not use your timer when the air temperature is below 40°F(4.5°C), the timers should be removed from the hose faucet and stored indoors to avoid potential frozen damage.
- A filter can trap dirt particles, please clean the filter regularly and replace it if worn.
- Please replace batteries when the low battery indicator appears on the display. When replacing the power unit, please make sure that the water timer is dry.
- To prevent leakage, make sure that the water timer is tightly attached to the faucet and hose, add a rubber washer and thread seal tape if necessary.

Note:

1. The water flow is reduced by half when the two zones are turned on at the same time.
2. The water flow in two zones may be different if you turn on one zone first and then turn on the other zone.

Documents / Resources

	<p>Raddy WS-3 Smart Dual Water Timer [pdf] User Manual WS-3, WS-3 Smart Dual Water Timer, WS-3 Water Timer, Smart Dual Water Timer, Dual Water Timer, Smart Water Timer, Water Timer, Timer</p>
---	---

References

- [User Manual](#)

[Manuals+](#), [Privacy Policy](#)

This website is an independent publication and is neither affiliated with nor endorsed by any of the trademark owners. The "Bluetooth®" word mark and logos are registered trademarks owned by Bluetooth SIG, Inc. The "Wi-Fi®" word mark and logos are registered trademarks owned by the Wi-Fi Alliance. Any use of these marks on this website does not imply any affiliation with or endorsement.