

RAB
L2X Luminator
Versatile LED
Security Light



RAB L2X Luminator Versatile LED Security Light Installation Guide

[Home](#) » [RAB](#) » RAB L2X Luminator Versatile LED Security Light Installation Guide 

Contents

- [1 RAB L2X Luminator Versatile LED Security Light](#)
- [2 Specifications](#)
- [3 Frequently Asked Questions](#)
- [4 INSTALLATION](#)
- [5 OPERATION](#)
- [6 PARTS LIST](#)
- [7 Documents / Resources](#)
 - [7.1 References](#)

RAB

RAB L2X Luminator Versatile LED Security Light



Specifications

- Brand: RAB Lighting
- Type: LED Light Fixture
- Energy Efficiency: Energy-efficient LED lighting
- Installation: Mounting Bracket and Junction Box required
- Adjustability: Lamp heads can be adjusted left, right, up, and down
- Non-replaceable LED lamps

Frequently Asked Questions

- **Q: Can the LED lamps be replaced?**
 - A: No, LED lamps are non-replaceable. Attempting to access or maintain them may damage the LEDs and void the warranty.
- **Q: What are the default Photocell settings?**
 - A: The default settings include enabling the Dusk to Dawn function with specific Lux values for activation and deactivation. Disabling this function displays a steady mode day and night.

IMPORTANT

CAUTION: All wiring MUST comply with local electrical codes and should be installed by a qualified electrician. Read entire Installation Manual before proceeding. TURN OFF POWER BY REMOVING THE POWER FUSE OR TURNING OFF THE CIRCUIT BREAKER BEFORE INSTALLATION.

- These instructions do not cover all details or variations in equipment nor do they provide for every possible situation during installation, operation or maintenance.

WARNING: RISK OF ELECTRICAL SHOCK

- Turn off electrical power at the fuse or circuit breaker box before wiring the fixture to the power supply.

- Verify that the supply voltage is correct. Connect the fixture to a 120-volt, 60 Hz power source.

INSTALLATION

Step 1: Installing the Mounting Bracket

1. Line up the holes on the Mounting Bracket with the holes on the Junction Box (by others). Using the two Mounting Screws (F or G).
2. Attach the Ground wire to the Mounting Bracket (E), using Ground Screw (K).

Fig: 1

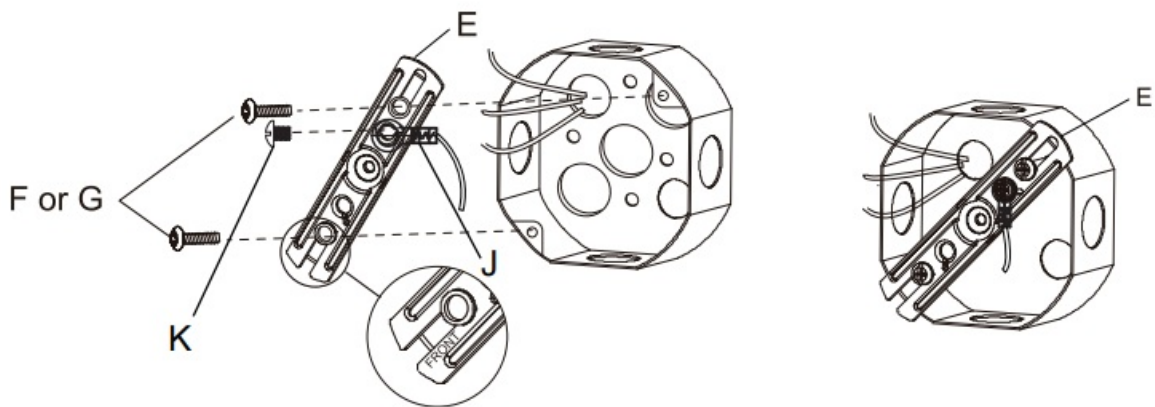

Step 2: Making Electrical Connections.

1. Connect the fixture wires through Gasket to the Junction Box wires with wire nuts as shown in Fig 2.
2. White to Neutral Black to Line Green ground wire to ground

Fig: 2

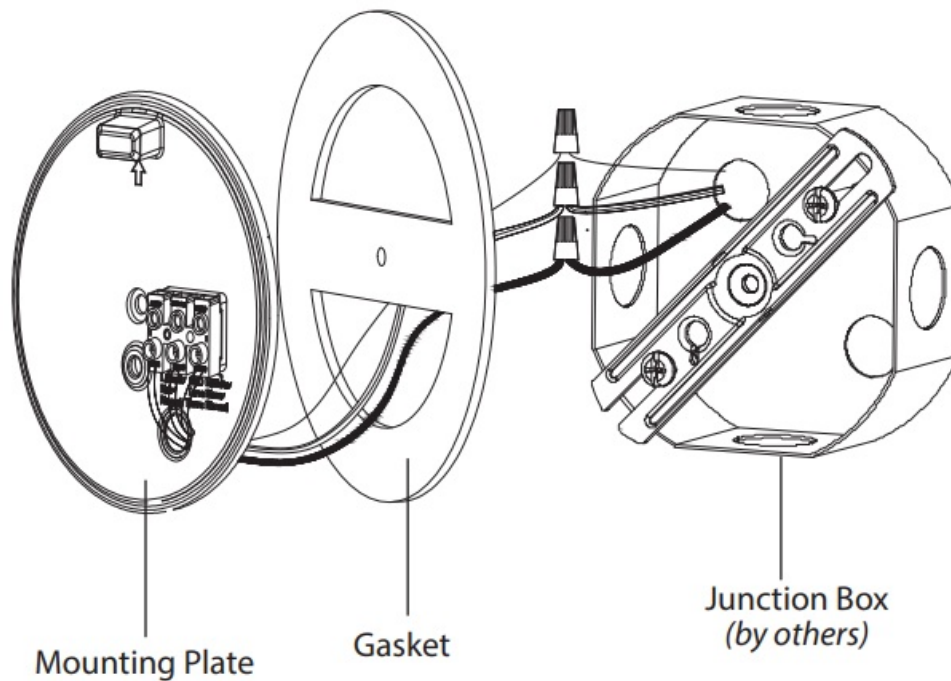

Step 3: Installing the Mounting Plate.

1. Place the Mounting Plate and Foam Gasket against the Junction Box (Fig. 2).
2. Insert the small mounting bolt through the Mounting Plate hole and Mounting Bracket hole. Tighten the bolt securely.

Step 4: Mounting the Light Fixture.

1. Align the bottom edge of the light fixture (A) with the bottom edge of the Mounting Plate (D). Tilt the light fixture (A) toward the Mounting Plate (D), making sure the light fixture (A) is centered on the Mounting Plate (D) as shown in Fig 3.
2. Tighten the large pre-installed Mounting Bolt (H) securely through the center of the Mounting Plate (D). Do not over tighten.
3. Push the Decorative Cap firmly into the large Mounting Bolt Hole on the light fixture (A).

Fig: 3

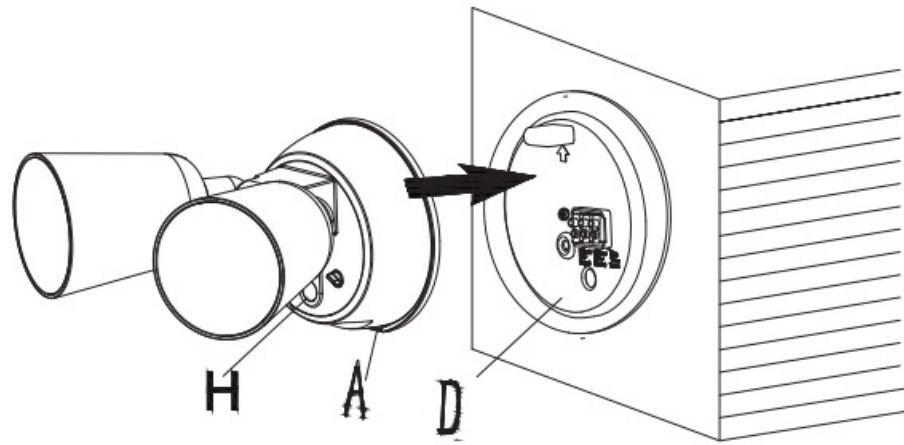

Step 5: Caulking Around the Light Fixture.

1. Caulk around the canopy and mounting surface with silicone sealant (by others) as shown in Fig 4.

Fig: 4

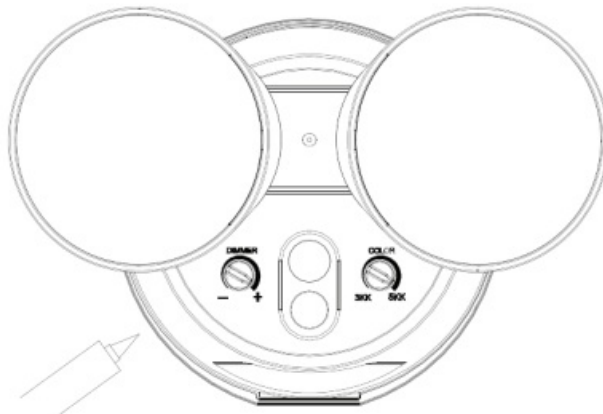

OPERATION

Step 6: Adjusting the Lamp Heads.

1. Lamp heads can be adjusted easily. You may adjust the lamp head left and right or up and down to get the desired lamp direction (Fig. 5).

Fig: 5

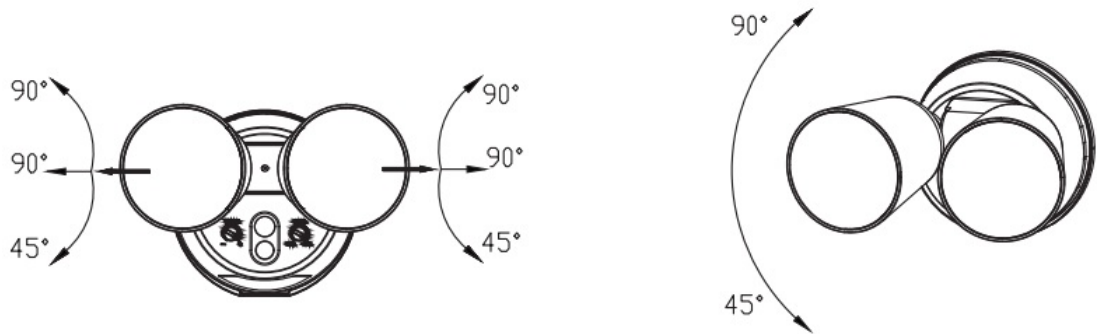

Note: LED LAMPS ARE NON-REPLACEABLE. Do not attempt to access or maintain the LEDs; they are non-replaceable and any contact may damage the LEDs and will void the warranty.

Default Settings:

- Dimmer: 2096lm
- CCT: 5000K

Photocell Settings:

(ON) enables the Dusk to Dawn function. The product is turned off during the day and on at night (Fig. 6).

- Enter Lux: 5~35Lx
- Exit Lux: 70~150Lx

(OFF) disables the Dusk to Dawn function. The steady mode is displayed day and night.

Fig: 6

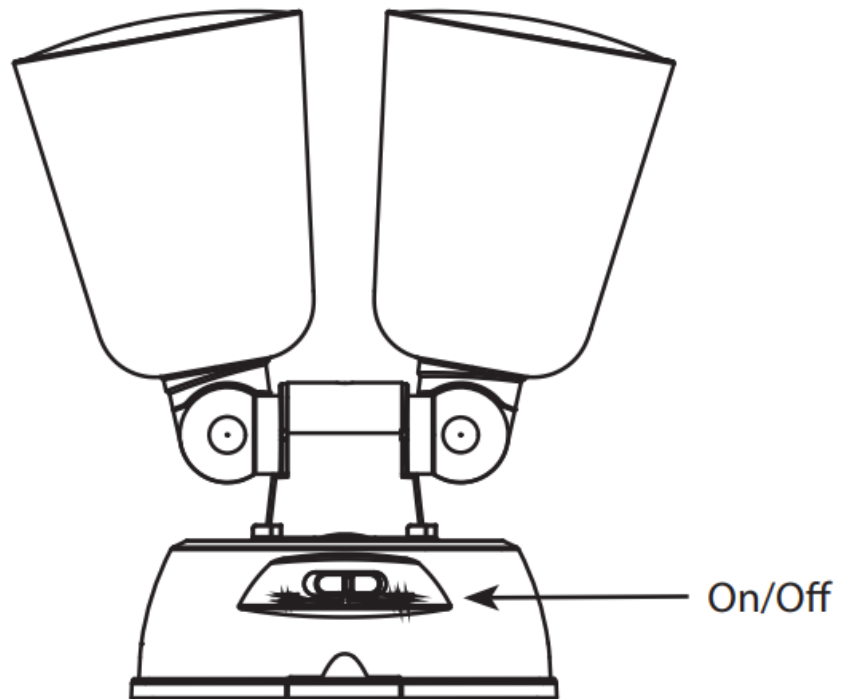

Dimmer Setting.

To adjust the brightness of the Floodlights: Set the "DIMMER" to the — position for 10% brightness, adjust to the + position for 100% brightness.

Fig: 6

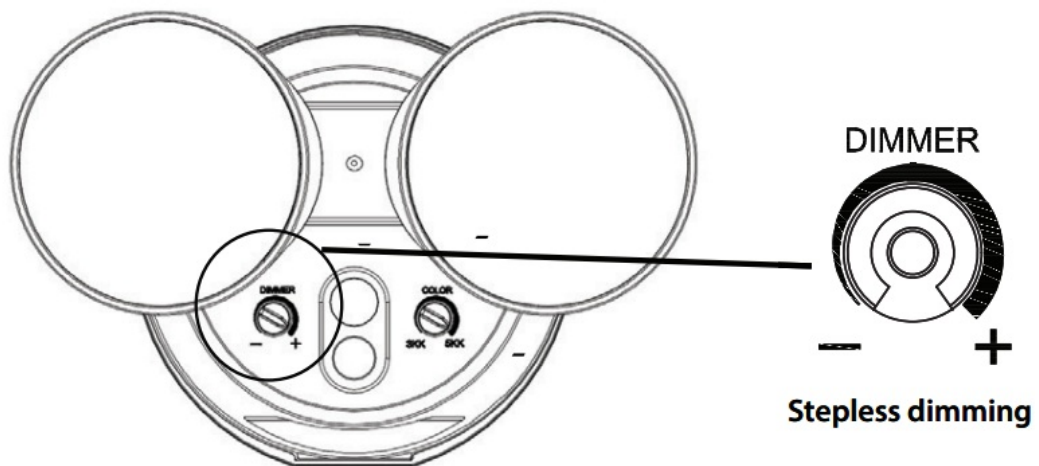

Color Setting.

To adjust the LED color temperature of the Floodlight: Set the "COLOR" dial to the 3K position for 3000K, adjust to the 5K position for 5000K (Color Temperature range is 3000K – 5000K) Fig. 7.

Fig: 7

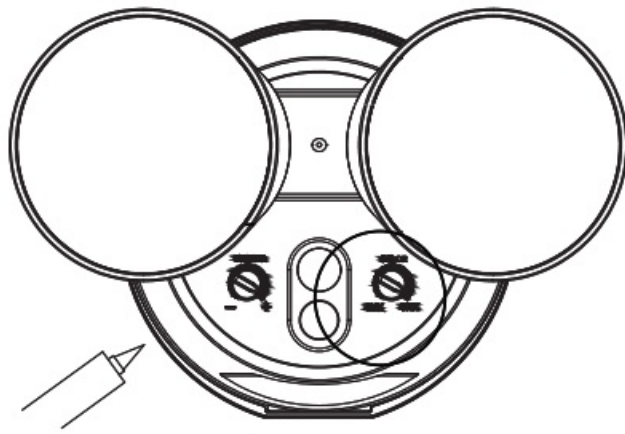

PARTS LIST

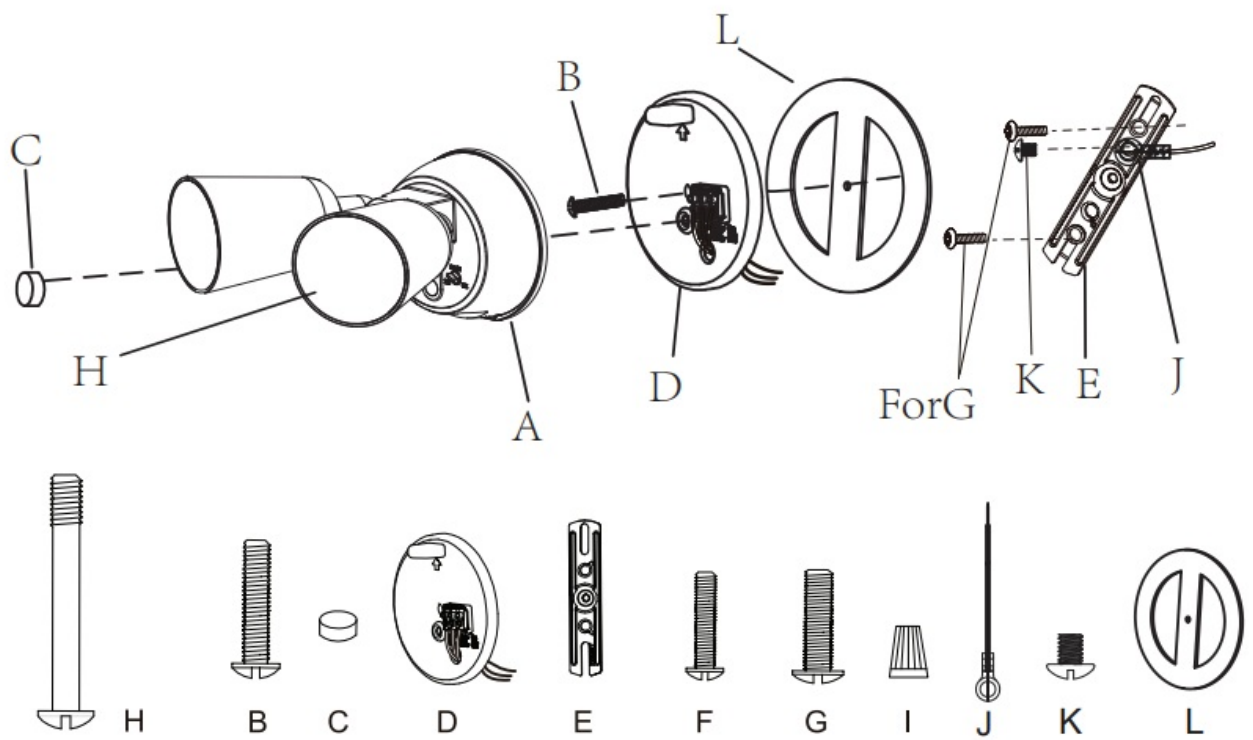

Part	Description	Quantity
A	Light Fixture	1
B	Small Mounting Bolt	1
C	Decorative Cover	1
D	Mounting Plate	1
E	Mounting Bracket	1
F	#6-32 x 1" Junction Box Screw	2
G	#8-32 x 1" Junction Box Screw	2
H	Large Mounting Bolt (pre-installed)	1
I	Wire Nut	3
J	Ground Wire	1
K	Ground Wire Screw	1
L	Gasket	1

Note: These instructions do not cover all details or variations in equipment nor do they provide for every possible situation during installation, operation or maintenance

Easy Answers

- rablighting.com
 - Visit our website for product info
- Tech Help Line
 - Call our experts: 888 722-1000
- e-mail
 - Answered promptly – tech@rablighting.com
- Free Lighting Layouts
 - © 2025 RAB LIGHTING Inc. Answered online or by request

RAB WARRANTY: RAB's warranty is subject to all terms and conditions found at rablighting.com/warranty

PATENT: Patent information can be found at rablighting.com/ip

RAB Lighting is committed to creating high-quality, affordable, well-designed, and energy-efficient LED lighting and controls that make it easy for electricians to install and end users to save energy. We'd love to hear your comments. Please call the Marketing Department at 888-RAB-1000 or email: marketing@rablighting.com

Documents / Resources

	<p>RAB L2X Luminator Versatile LED Security Light [pdf] Installation Guide L2X, L2X Luminator Versatile LED Security Light, Luminator Versatile LED Security Light, Versatile LED Security Light, LED Security Light, Security Light, Light</p>
--	--

References

- [R Welcome to RAB](#)
- [R Legal - RAB Lighting](#)
- [User Manual](#)

[Manuals+](#), [Privacy Policy](#)

This website is an independent publication and is neither affiliated with nor endorsed by any of the trademark owners. The "Bluetooth®" word mark and logos are registered trademarks owned by Bluetooth SIG, Inc. The "Wi-Fi®" word mark and logos are registered trademarks owned by the Wi-Fi Alliance. Any use of these marks on this website does not imply any affiliation with or endorsement.