



R TEC AUTOMATION Wall Box Mount Switch User Guide

[Home](#) » [R TEC AUTOMATION](#) » R TEC AUTOMATION Wall Box Mount Switch User Guide 



**R-TEC Smart Controls – Wall Box Mount Switch
RTMWSR15C**



Wall Box Mount Switch in cut in configuration provides a sensible control option for individual room and whole home window treatment control.

Available in 15 channel model, wall switches are compatible with all ARC motors.

Cut in wall switches feature a contemporary design and a wirefree deployment, making them retrofit ready for any location.

Contents

- [1 FEATURES – 15 CHANNEL](#)
- [2 COMPLIANCE STATEMENT](#)
- [3 TECHNICAL DATA / PACK CONTENTS](#)
- [4 SAFETY](#)
- [5 INSTALLATION](#)
- [6 FUNCTIONAL OVERVIEW](#)
- [7 IMPORTANT](#)
- [8 PROGRAMMING](#)
- [9 TROUBLESHOOTING](#)
- [10 Documents / Resources](#)
- [11 Related Posts](#)

FEATURES – 15 CHANNEL



2-Way RF
Communication



Multi Channel
Selectable



Retrofit
Ready



Group
Control



Hide Unused
Channels



LCD Display



COMPLIANCE STATEMENT

This device complies with part 15 of the FCC Rules. Operation is subject to the following two conditions:

- This device may not cause harmful interference.
- This device must accept any interference received, including interference that may cause undesired operation.

TECHNICAL DATA / PACK CONTENTS

PRODUCT SPECIFICATIONS

Parameters	Value
Voltage	3 V DC
Battery	2 x AAA
Radio Frequency	433.92 MHz
Transmitting Power	10 milliwatt
Transmission Range	65'
Temperature Working Range	14° F – 122° F (-10° C – 50° C)

PACK CONTENTS

1. Wall Box Mount Switch, 15 Channel
2. Wall Fixing Screws (2) and Anchors (2)
3. Instruction Manual
4. 1.5 V AAA Batteries (2)
5. White Single Gang Decorator Style Wall Plate with Mounting Screws (2)

SAFETY



WARNING

Any changes or modifications to this unit not expressly approved by the party responsible for compliance could void the user's authority to operate the equipment. Incorrect installation can lead to serious injury and will void manufacturer's liability and warranty.

CAUTION

- Do not expose to moisture or extreme temperatures.
- Do not allow children to play with this device.
- Use or modification outside the scope of this instruction manual will void warranty.
- Installation and programming to be performed by a suitably qualified installer.
- Use only R-TEC Automation® hardware.
- Keep clear when in operation.
- Replace battery with correctly specified type.

IMPORTANT SAFETY INSTRUCTIONS TO BE READ PRIOR TO OPERATION

- It is important for the safety of persons to follow the enclosed instructions. Save these instructions for future reference.
- Persons (including children) with reduced physical, sensory or mental capabilities, or lack of experience and knowledge should not be allowed to use this product.
- Frequently inspect for improper operation. Do not use if repair or adjustment is necessary.
- Keep away from children.

INSTALLATION

INSTALL SWITCH BATTERIES

Open rear battery cover by pressing gently in, then sliding down.

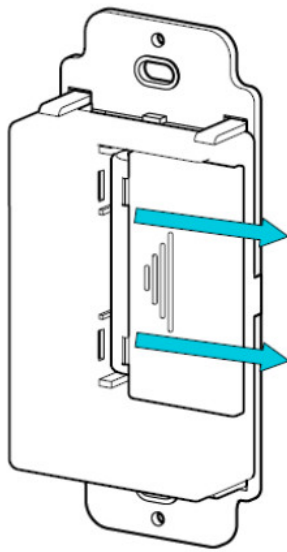

Install 2 x AAA batteries with negative (-) side facing springs.

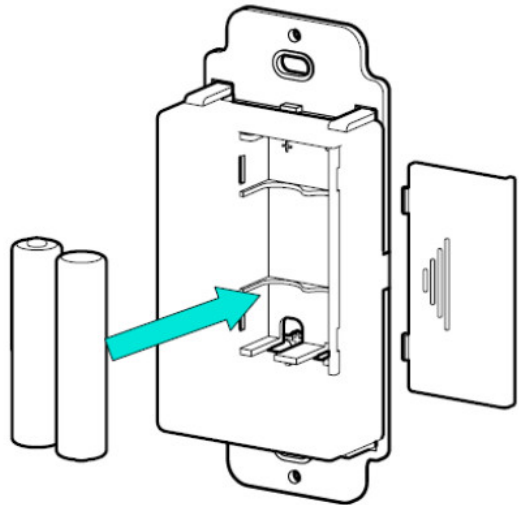

Replace cover by sliding into place.

MOUNT SWITCH

Use supplied fasteners and anchors as needed to attach base.

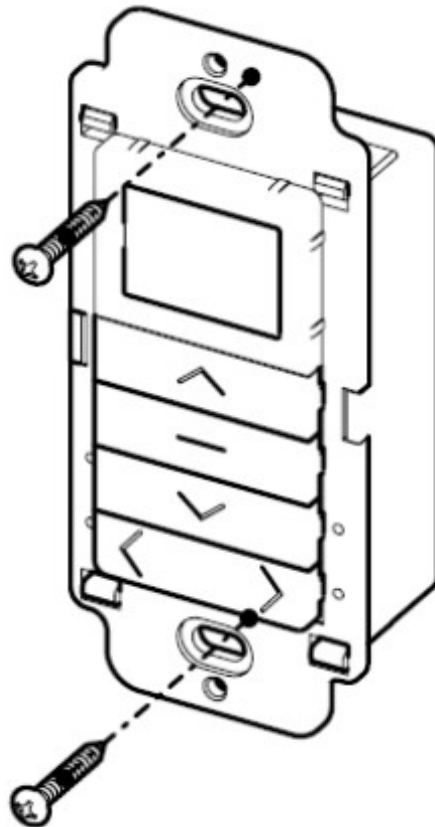

FUNCTIONAL OVERVIEW

BUTTONS

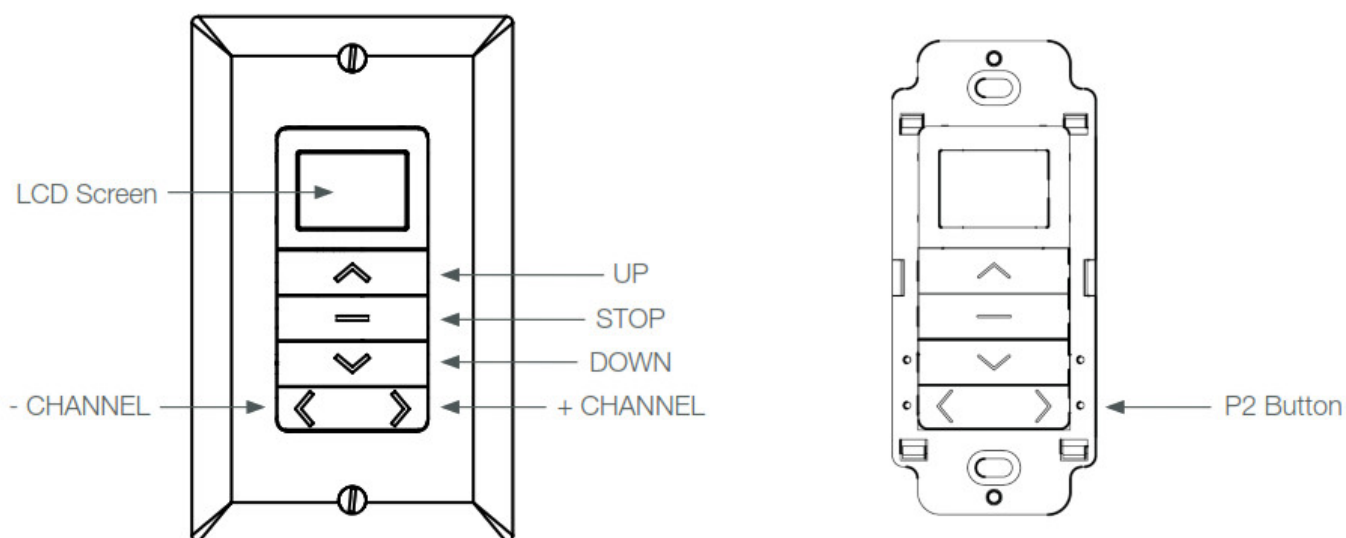

SELECTING A CHANNEL

Use **LEFT** and **RIGHT** arrows to change channels.

Use **RIGHT** arrow to increase channel.

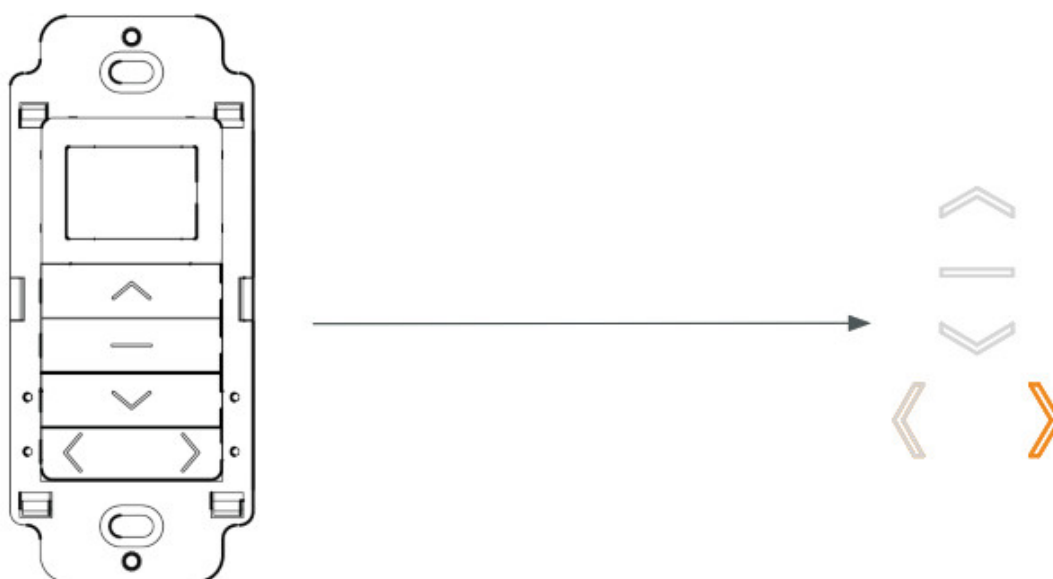

IMPORTANT

Please refer to the relevant documentation of your motor model for instructions on adjusting motor settings.

GROUP CONTROL USING CH “0”

Channel “0” is preset to control ALL window treatments paired within your multi channel switch. To create a customized group channel, reference page 9.

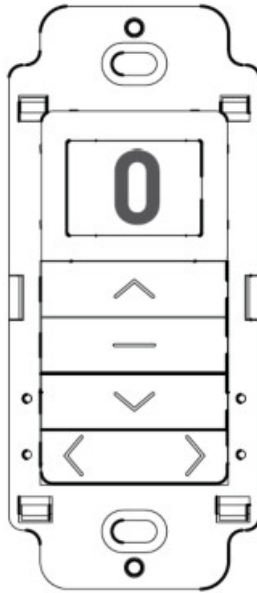

HIDE UNUSED CHANNELS

Your multi channel switch can be configured to have anywhere between 1 or 15 visible channels. Inactive channels will not be visible when scrolling through the < > selections.

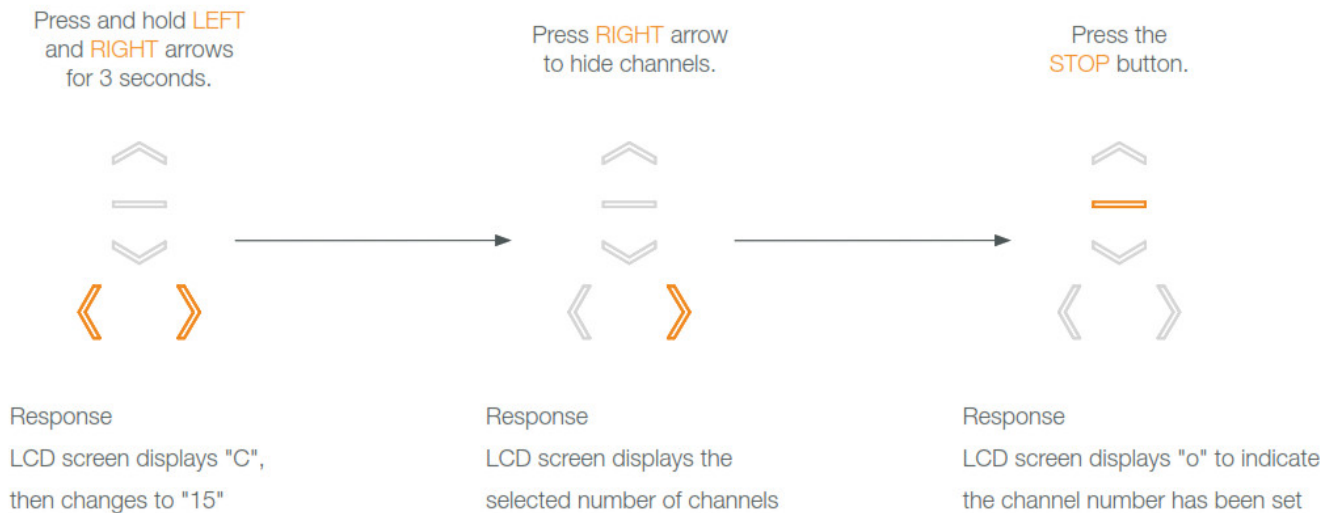

LOCK LIMIT SETTING

The 15 channel switch uses the LCD screen to notify the user when the lock feature has been activated.

Press **STOP** and
hold for 15 seconds.



Release **STOP** button.
Unlocked limit settings.

Response

LCD flashes "U" x 2

Press **STOP** and
hold for 15 seconds.



Release **STOP** button.
Locked limit settings.

Response

LCD flashes "L" x 2

PROGRAMMING

USING MOTOR P1 BUTTON



IMPORTANT

Multiple motors can be grouped onto shared channels for coordinated control.

- Confirm that motor limits and favorite position are already set for each individual motor.
- Ensure that each motor you want to group is also assigned to another channel by itself.

Select a channel on switch using the side arrow buttons.

Hold **P1** button on motor head.

Hold **STOP** on switch.

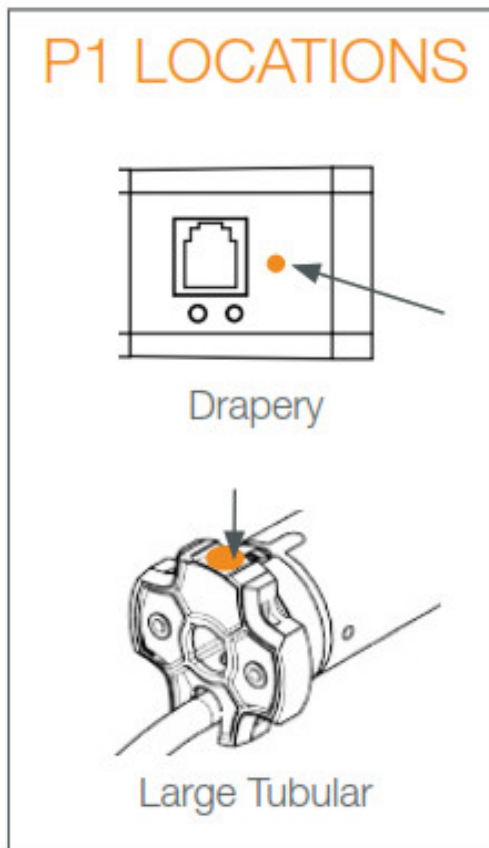
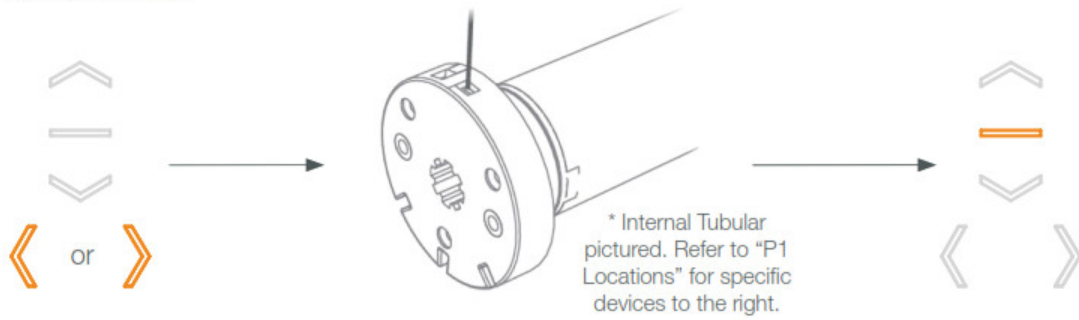

USING PRE-EXISTING CONTROLLER

A = Existing switch or channel (to keep). B = Switch or channel to add or remove.

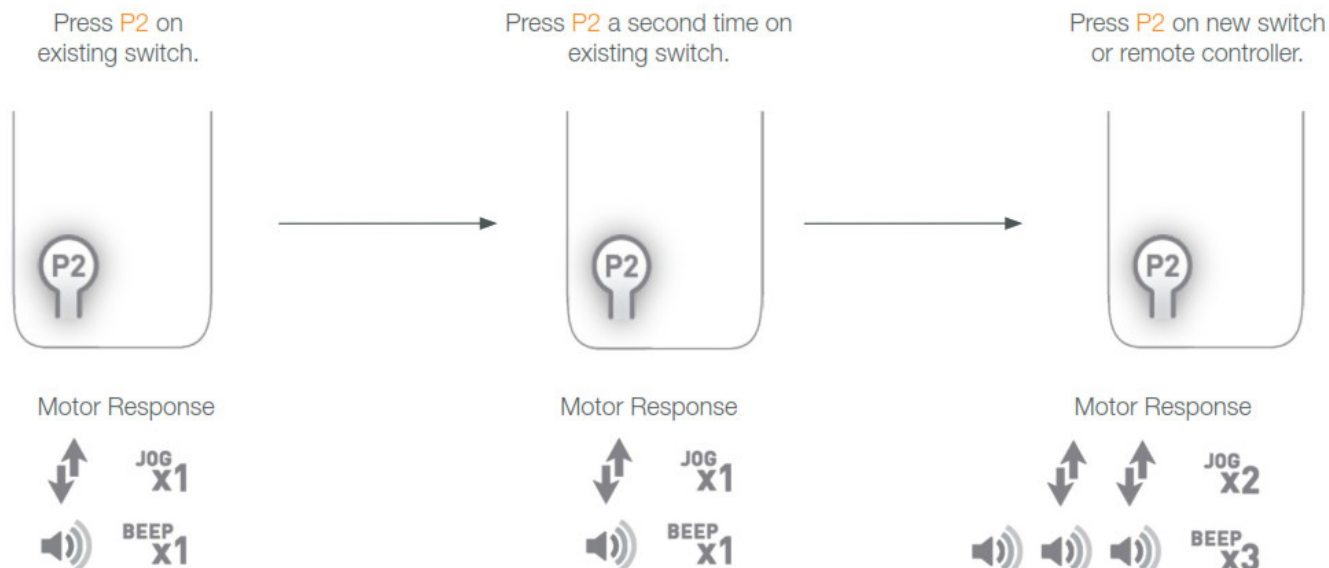

TROUBLESHOOTING

Problem	Cause	Remedy
Motor is not responding	Switch battery is discharged	Replace battery.
	Battery is inserted incorrectly	Check battery polarity.
	Radio interference / Shielding	Ensure switch is positioned away from metal objects and that aerial on motor or receiver is kept straight and away from metal.
	Receiver distance is too far from switch	Move switch to a closer position.
	Power failure	Check power supply to motor is connected and active.
	Incorrect wiring	Check wiring is connected correctly (refer to motor installation instructions).
Cannot set limits on a single motor (multiple motors respond)	Using "Group" channels to adjust motor limits	Check wiring is connected correctly (refer to motor installation instructions).
	Red LED is solid	SYSTEM BEST PRACTICE – Provide an extra 15 channel switch in your multi motor projects, that provides individual control for each motor for programming purposes.

Any Questions?

Contact our R-TEC Automation® in-house experts at 866.985.3423. Email us at RTECAutomation@RowleyCompany.com.



Do no dispose of in general waste.
Please recycle batteries and damaged electrical products appropriately.



Documents / Resources

	<p>R-TEC AUTOMATION Wall Box Mount Switch [pdf] User Guide Wall Box Mount Switch, RTMWSR15C</p>
--	---

[Manuals+](#)