



**RGOTWBMWLBL
Twister Mouse
Wireless
Bluetooth**



R-Go RGOTWBMWLBL Twister Mouse Wireless Bluetooth Instruction Manual

[Home](#) » [R-Go](#) » R-Go RGOTWBMWLBL Twister Mouse Wireless Bluetooth Instruction Manual 

Contents

- [1 R-Go RGOTWBMWLBL Twister Mouse Wireless Bluetooth](#)
- [2 Product Usage Instructions](#)
- [3 Product Overview](#)
- [4 Setup](#)
- [5 How to use](#)
- [6 R-Go Break](#)
- [7 Maintenance](#)
- [8 Troubleshooting](#)
- [9 Documents / Resources](#)
 - [9.1 References](#)



R-Go RGOTWBMWLBL Twister Mouse Wireless Bluetooth



Product Information

- **Product Name:** R-Go Twister
- **Model:** RGOTWBMWLBL
- **Compatibility:** Small & Medium, Bluetooth & Wired, Left & Right
- **Features:** Ergonomic design, multiple buttons, DPI adjustment, USB-C charging

Product Usage Instructions

Setup:

- **Step 1:** To switch from the right-handed position to the left-handed position, turn the shell clockwise 180 degrees until it clicks.
- **Step 2:** Lift the shell on the side of the thumb support until the mouse clicks into position.
- **Step 3:** Squeeze the thumb support to fold the mouse back into a flat position. Note: The mouse does not work in the flat position.

Customization:

- Optional Step 4: To adjust the mouse for a Medium or Small hand size, choose one of the extra pads provided and stick it onto the little finger support accordingly.
- Thicker pad for Small hand size, thinner pad for Medium hand size.

Usage:

Use the left and right buttons which switch automatically when twisting the mouse. The scroll wheel, DPI button, and on/off buttons provide additional functionalities.

Maintenance:

Store the mouse in the included bag when not in use to avoid damage.

FAQ

- **Q: How do I charge the R-Go Twister?**

A: The R-Go Twister can be charged using the included USB-C cable. Simply connect it to a power source or a computer for charging.

- **Q: Can I use the R-Go Twister in wired mode?**

A: Yes, the R-Go Twister can be used in wired mode by connecting it to a device using the USB-C to USB-A converter.

Congratulations on your purchase!

This vertical mouse is ambidextrous, meaning it is suitable for both left- and right-handed users. Thanks to the patented Switch & System, the Twister can be changed from a left-handed to a right-handed mouse and vice versa with one move. By regularly alternating between your left and right hand, you distribute the load on both hands and prevent annoying complaints such as RSI. In addition, the mouse is foldable, so it is easy to take with you. So you can work ergonomically anywhere. Let's do the twister!

System requirements/Compatibility:

Windows XP/Vista/10/11, MacOS

For more information about this product, scan the QR code! https://r-go.tools/twister_web_en.



Watch this video and let's do the twister!

**Product Overview**

- **01/02** Left (primary) button / Right (secondary) button*
- **03** Scroll wheel
- **04** Thumb support
- **05** Little finger support
- **06** On/off button
- **07** Pair button

- **08** DPI button
- **09** USB-C cable (for charging and wired use)
- **10** USB-C to USB-A converter
- **11** Extra pads for Small & Medium size little finger support

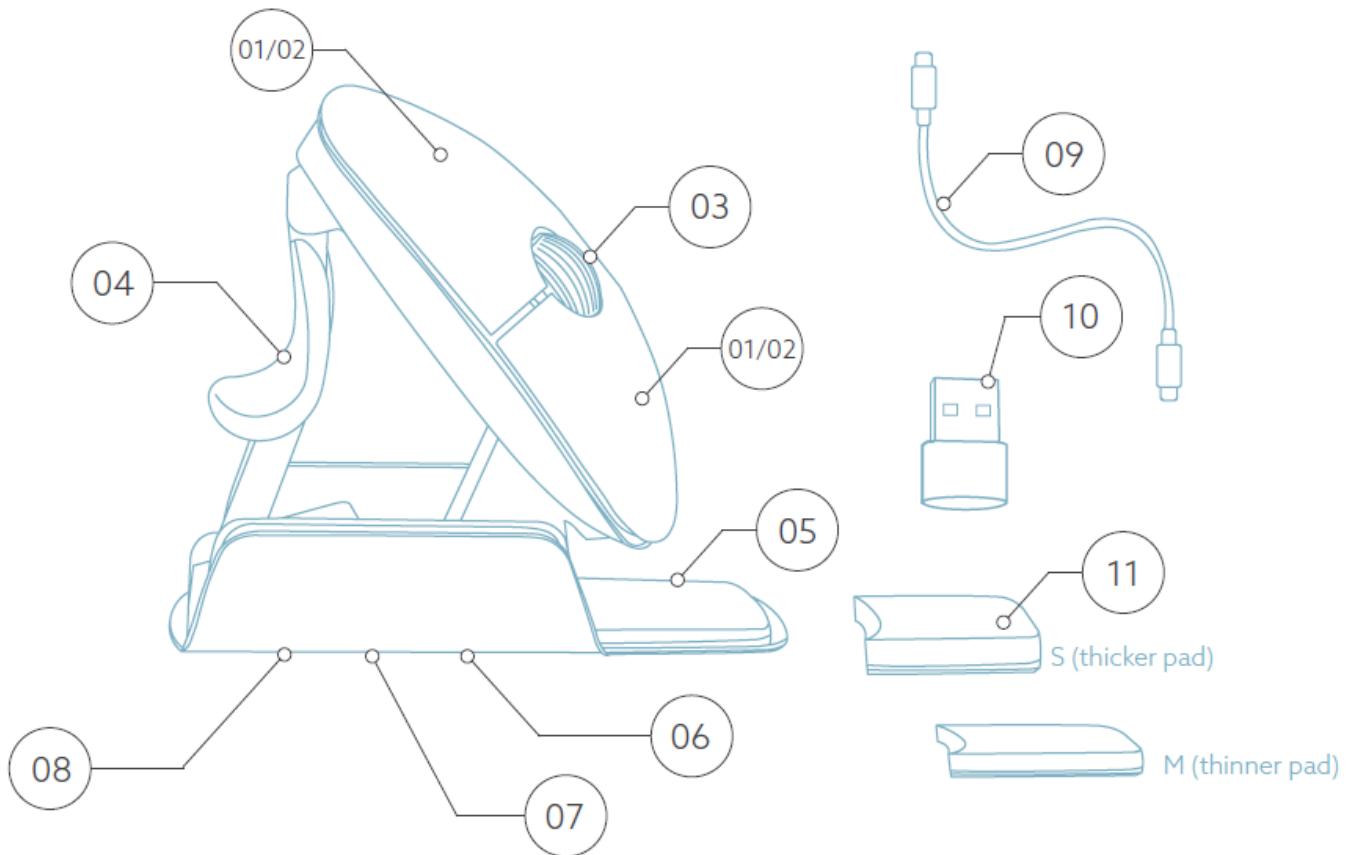

Left and right buttons switch automatically when twisting the mouse.

Setup

Windows

- Flip the switch 06 on the bottom to “ON”.
- Set the mouse settings in Windows for right-handed.
- Click the Windows icon on your screen or hit the Windows button on your keyboard.
- Type in “Bluetooth and other device settings” and click.
- If Bluetooth is not already working, click on the checkbox to turn Bluetooth on.
- In the window that appears click on “Add Bluetooth or other device”.
- In the new window, click on the option “Bluetooth”.
- Now click the pair button 07 on the bottom of the mouse and click on the new device that appears in the list.
- Your device will now establish a connection with the mouse.
- The next time your device starts up or when you turn the mouse on, just click one of the buttons and the mouse will be connected to your pc.

Note:

The mouse buttons work correctly when the mouse settings in Windows are set for right-handed use!

Mac Os

- Flip the switch 06 on the bottom to “ON”.
- Set the mouse settings in macOS to right-handed.
- Click the Apple icon in the top-left corner of the screen and select “System Preferences”.
- In the window that appears click on “Bluetooth”.
- If Bluetooth is not already working, select “Turn Bluetooth on”.
- Now click the pair button 07 on the bottom of the mouse and click on the new device that appears in the list.
- Your device will now establish a connection with the mouse.
- The next time your device starts up or when you turn the mouse on, just click one of the buttons and the mouse will be connected to your pc.

Note: The mouse buttons work correctly when the mouse settings in macOS are set for right-handed use!

DPI switch

To change the DPI mode, click the DPI button 08.

DPI means Dots Per Inch. With a low DPI, you will have to make larger movements to get the cursor to move the same distance on your screen compared to a higher DPI. We recommend a lower DPI setting, so you will move the mouse with your arm instead of your wrist to prevent RSI.

There is no dongle with my mouse. Is that correct?

Yes, that is correct. Our wireless products work via Bluetooth. You only need to pair your mouse and your computer once.

How do I pair my mouse with my computer?

- From the Windows menu, go to ‘Settings’ and click on ‘Devices’.
- Switch Bluetooth to ‘on’.
- Ensure that your new device is sufficiently charged.
- Press and hold the pair button 07 on the bottom of the mouse until the blue light blinks.
- Select the mouse from the displayed row on the computer screen to connect it to the computer

Can I use my Twister both wired and wireless with Bluetooth?

Yes. A cable is included, which you easily plug into your mouse and connect to your computer. The Twister can be used alternately with or without a cable without any problems. For wireless use, you only have to connect Bluetooth once: you don’t have to do this every time you use the mouse with a cable.

My Twister does not work in the collapsed position. Is that correct?

Yes, that is correct. The Twister can only be used in a vertical mouse unfolded position.

How to use

Step A

To switch from a right-handed position to a left-handed position, turn the shell clockwise 180 degrees until it clicks.



Step B

By lifting the shell on the side of the thumb support, the mouse will click into position. Your mouse is ready for use!

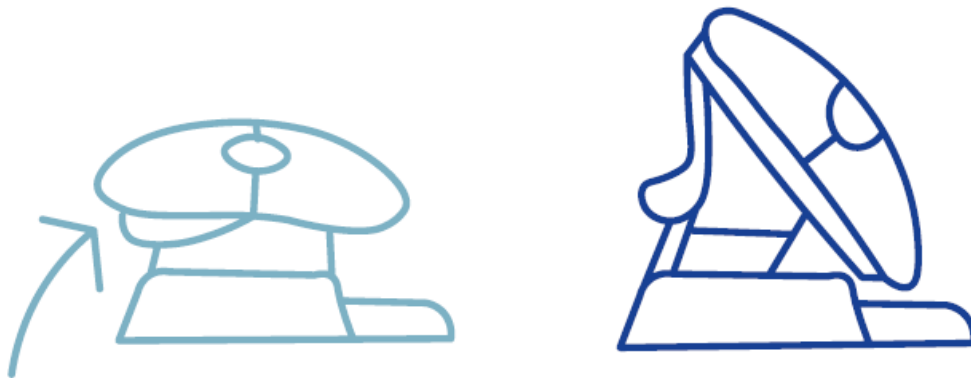

Step C

Squeeze the thumb support of the mouse, to fold the mouse back into a flat position.



Note: The mouse does not work in a flat position!

Step D (optional)

To turn the mouse into a Medium* or Small** size to support your hand and prevent it from sliding down, choose one of the extra pads 11 and stick it once on the little finger support 05. Your mouse is ready for use!

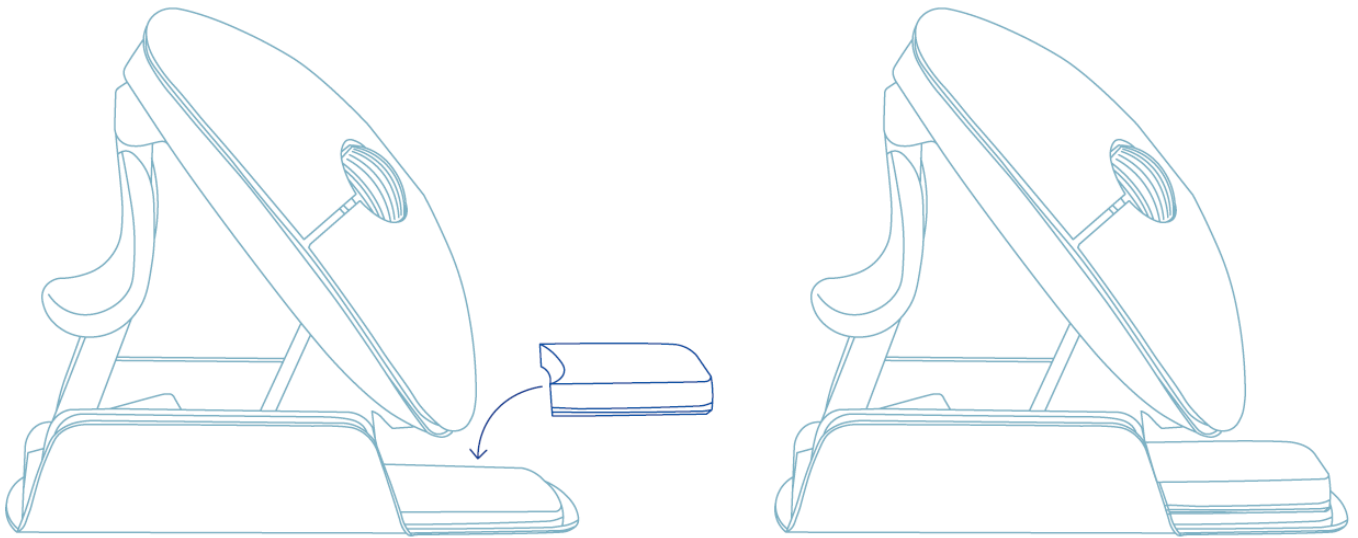

- Stick the thicker pad onto the little finger support for Small hand size.
- Stick the thinner pad onto the little finger support for Medium hand size.

R-Go Break

- Download the R-Go Break software at www.r-go-break.com
- The R-Go Break software is compatible with the R-Go Twister mouse and all R-Go HE Break mice and keyboards.
- The R-Go Break is a software tool that helps you to remember to take breaks from your work. As you work, the R-Go Break software controls the LED light on your Break mouse or keyboard. This break indicator changes color, like a traffic light. When the light turns green, it means you are working healthily. Orange indicates that it is time for a short break and red indicates that you have been working too long. This way you receive feedback on your break behavior positively.

For more information about the R-Go Break software, scan the QR code!

https://r-go.tools/break_web_en.



Maintenance

- Do not bring the mouse in contact with water. Water could damage the electronic parts inside the mouse. To clean the mouse, disconnect the device from your PC. Do not clean the mouse with alcohol or with water and soap. This will damage the coating of the mouse. If you want to clean the mouse, use a water-based damp cloth.
- Do not remove any of the rubber parts on the bottom of the mouse. You will not be able to place them back and your mouse will not move smoothly as before.

- Do not obstruct the laser on the bottom of the mouse.
- Do not turn the mouse anti-clockwise. This will damage the mechanism.
- Transport the mouse in the folded position, using the included bag to avoid damage.

Troubleshooting

Is your mouse not working properly, or do you experience problems while using it? Please follow the steps mentioned below.

- Check if the mouse is connected properly.
- Note that the mouse buttons work correctly when the mouse settings in Windows are set for right-handed use
- Click the 'Pair' button on the bottom of the mouse to start the pairing process. Check if the device appears on the screen. If it does not appear, restart your computer.
- Test the mouse on another device, if it is still not working contact us via info@r-go-tools.com.

Documents / Resources

	<p>R-Go RGOTWBMWLBL Twister Mouse Wireless Bluetooth [pdf] Instruction Manual RGOTWBMWLBL Twister Mouse Wireless Bluetooth, RGOTWBMWLBL, Twister Mouse Wireless Bluetooth, Mouse Wireless Bluetooth, Wireless Bluetooth, Bluetooth</p>
--	--

References

- [go-tools.com](https://www.r-go-tools.com)
- [Break software - R-Go Tools](#)
- [User Manual](#)

[Manuals+](#), [Privacy Policy](#)

This website is an independent publication and is neither affiliated with nor endorsed by any of the trademark owners. The "Bluetooth®" word mark and logos are registered trademarks owned by Bluetooth SIG, Inc. The "Wi-Fi®" word mark and logos are registered trademarks owned by the Wi-Fi Alliance. Any use of these marks on this website does not imply any affiliation with or endorsement.