



# R-Go Tools RGOARMSP R-Go Split Armrest User Manual

[Home](#) » [R-Go Tools](#) » R-Go Tools RGOARMSP R-Go Split Armrest User Manual 

## Contents

- [1 R-Go Tools RGOARMSP R-Go Split Armrest](#)
- [2 Product Information](#)
- [3 Product Overview](#)
- [4 Setup](#)
- [5 Final product](#)
- [6 Documents / Resources](#)
  - [6.1 References](#)
- [7 Related Posts](#)



**R-Go Tools RGOARMSP R-Go Split Armrest**



## Product Information

- Product Name: R-Go Split Armrest
- Model: RGOARMSP
- Language: English, Deutsch, Nederlands, Polski, Italiano, Svensk

## Product Overview

The R-Go Split Armrest is an ergonomic split armrest designed to provide comfort and support while working at a desk.

## Setup

1. **Step A:** Assemble the armrest components.
2. **Step B:** Attach the armrest to the desk following the provided instructions.
3. **Step C:** Adjust the height and angle of the armrest to your preference.
4. **Step D:** Secure the armrest in place to ensure stability.
5. **Step E:** Double-check the setup for proper fit and comfort.

## Final Product

Once properly set up, the R-Go Split Armrest provides ergonomic support for your arms while working at your desk.

## Usage Instructions

### To use the R-Go Split Armrest

1. Position the armrest at a comfortable height and angle.
2. Rest your arms on the armrest while typing or using the mouse.
3. Adjust the armrest as needed to maintain a natural and relaxed posture.
4. Regularly check and readjust the armrest to ensure optimal ergonomic support.

For more information about this product, scan the QR code!

## Frequently Asked Questions (FAQ)

### Q: Does the R-Go Split Armrest fit all desks?

A: The armrest fits all desks that comply with European guidelines but may not fit desks with specific features like sloping edges or raised tabletops smaller than 2.0 inches (50mm).

## Product Overview

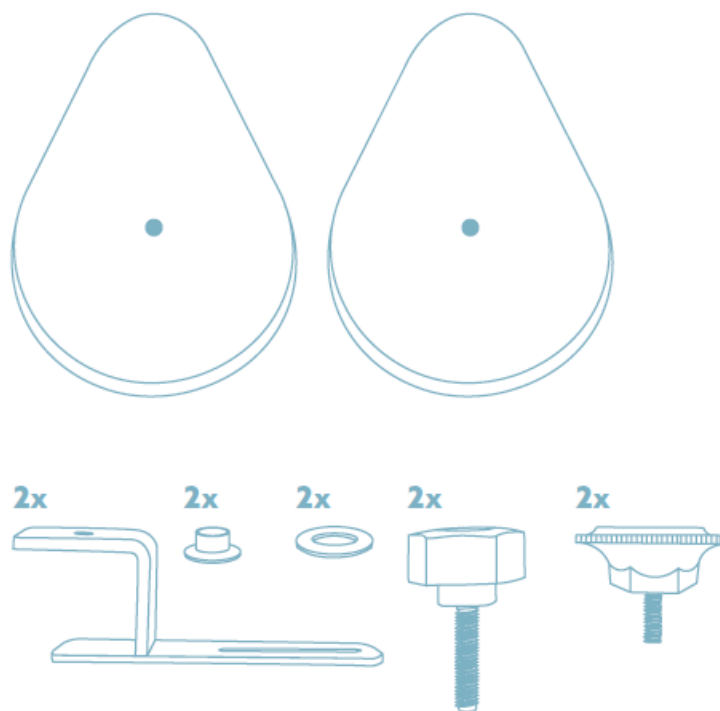

## Setup

Step A

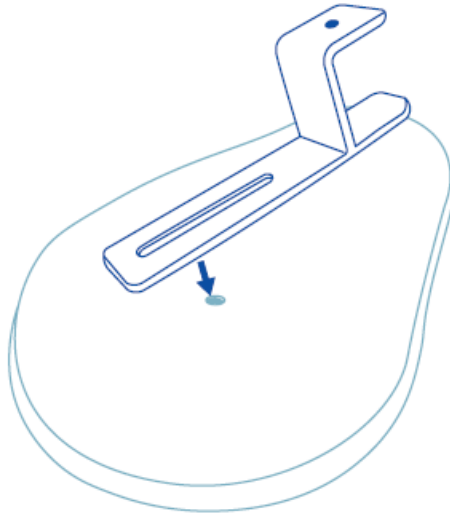

Step B

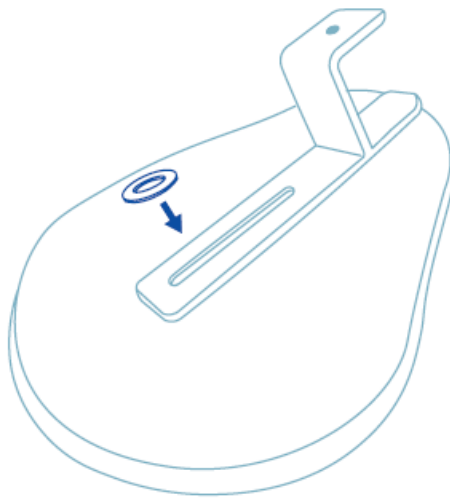

Step C

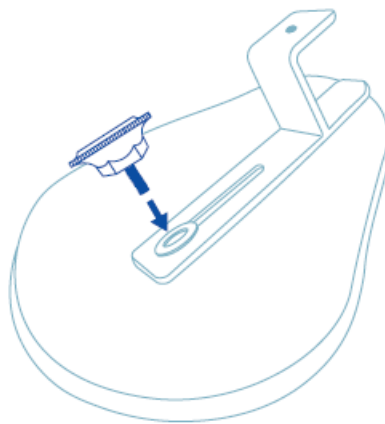

Step D

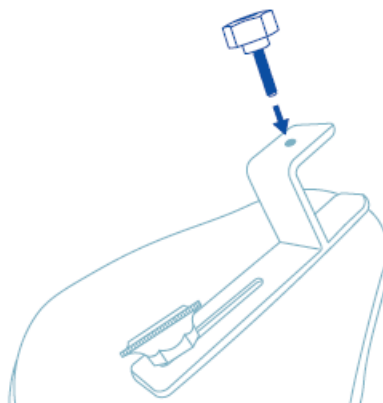

Step E

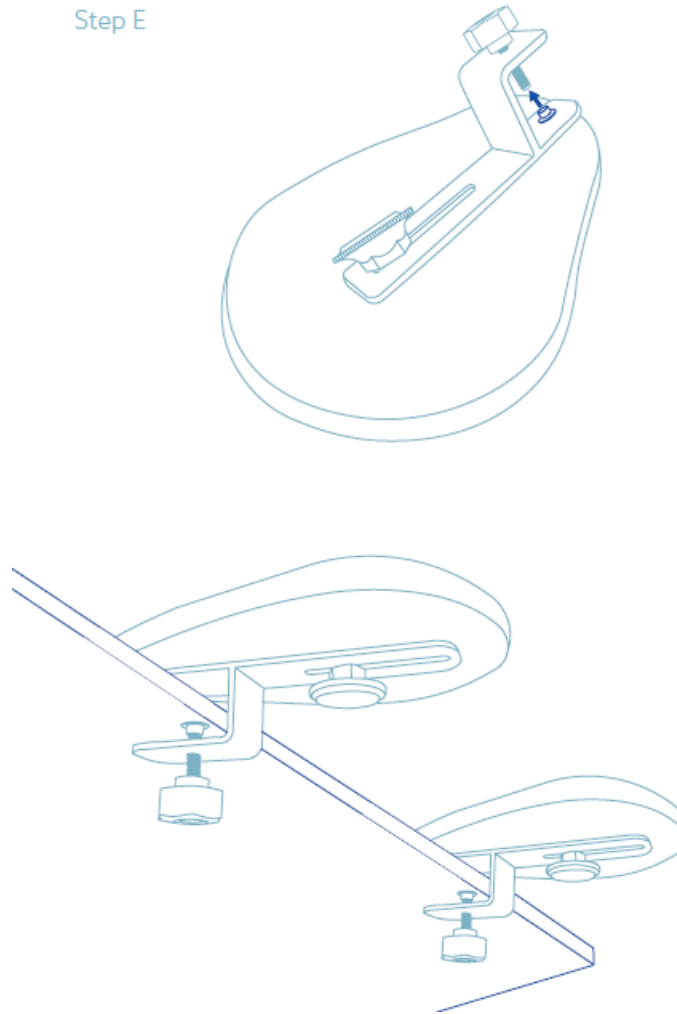

## Final product

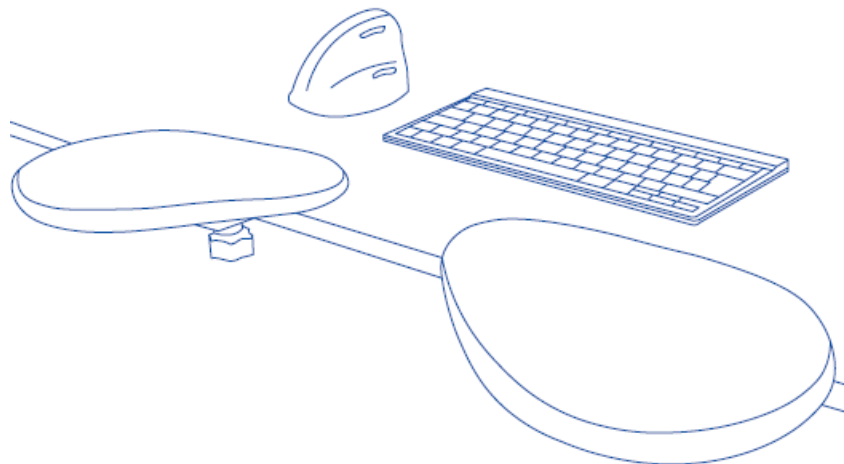

For more information about this product, scan the QR code! [https://r-go.tools/splitarmrest\\_web\\_en](https://r-go.tools/splitarmrest_web_en)



## Check if it fits!

Fits all desks that comply with the European guidelines.

Please note, the armrest does not fit the following type of tabletops:

- The table top has a sloping edge.
- The table has drawers.

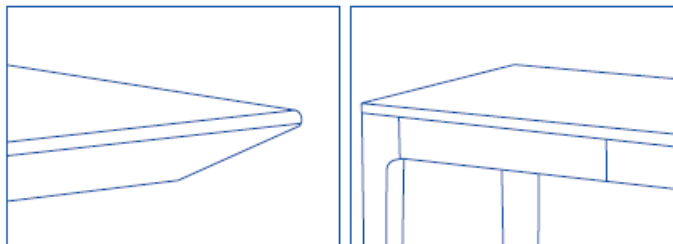

- The edge of the table top is raised.
- Protruding table top is smaller than 2.0 inch (50 mm).

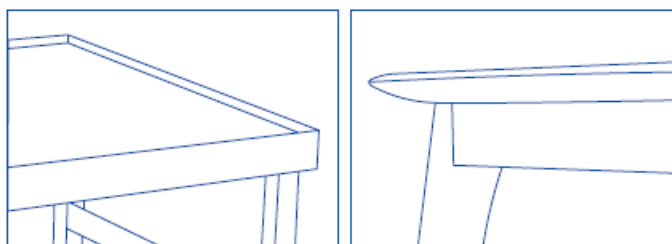

## Documents / Resources



[R-Go Tools RGOARMSP R-Go Split Armrest](#) [pdf] User Manual  
RGOARMSP R-Go Split Armrest, RGOARMSP, R-Go Split Armrest, Armrest

## References

- [User Manual](#)

[Manuals+](#), [Privacy Policy](#)

This website is an independent publication and is neither affiliated with nor endorsed by any of the trademark owners. The "Bluetooth®" word mark and logos are registered trademarks owned by Bluetooth SIG, Inc. The "Wi-Fi®" word mark and logos are registered trademarks owned by the Wi-Fi Alliance. Any use of these marks on this website does not imply any affiliation with or endorsement.