



## R AND G RACING LP0380 Tail Tidy Instruction Manual

[Home](#) » [R AND G RACING](#) » R AND G RACING LP0380 Tail Tidy Instruction Manual 

### R AND G RACING LP0380 Tail Tidy Instruction Manual



This kit contains the items pictured and labelled over page.

Some parts may be shown for clarity of instructions only.

Do not proceed until you are sure all parts are present.

Please read all instructions before proceeding.

**IF IN ANY DOUBT WHEN FITTING OUR PRODUCTS, CONSULT ONE OF OUR DEALERS OR HAVE FITTED BY A QUALIFIED TECHNICIAN.**

Please note that the way the kit is packed does not necessarily represent the way of mounting to the bike.

In the event of rubber washers being used to hold components onto bolts, these rubber washers can be thrown away.

DIGITAL COPIES OF THESE INSTRUCTIONS ARE AVAILABLE FROM [WWW.RG-RACING.COM](http://WWW.RG-RACING.COM)

## Contents

- [1 TOOLS REQUIRED](#)
- [2 GENERAL TORQUE SETTINGS](#)
- [3 LEGEND](#)
- [4 ASSEMBLY DIAGRAM](#)
- [5 FITTING PICTURES](#)
- [6 FITTING INSTRUCTIONS](#)
- [7 CONSUMER NOTICE](#)
- [8 Documents / Resources](#)
  - [8.1 References](#)
- [9 Related Posts](#)

## TOOLS REQUIRED

- Set of metric Hex keys
- Set of metric sockets and wrench.
- Cable cutters

## GENERAL TORQUE SETTINGS

- M4 BOLT = 8Nm
- M5 BOLT = 12Nm
- M6 BOLT = 15Nm
- M8 BOLT = 20Nm
- M10 BOLT = 40Nm
- M12 BOLT = 40Nm

## LEGEND

ITEM No.	DESCRIPTION	QTY
ITEM 1	TB0380 – TAIL TIDY BRACKET	1
ITEM 2	LA0002 – NUMBER PLATE LIGHT	1
ITEM 3	M8 x 1.25 x 25mm LONG BUTTON HEAD BOLT	4
ITEM 4	M8 x 16mm O/D WASHER	8
ITEM 5	M8 NYLOC NUT	4
ITEM 6	CON0007 LICENCE PLATE CONNECTOR	1
ITEM 7	CT75 75mm CABLE TIE	2
ITEM 8	200mm LENGTH OF HEAT SHRINK	1
ITEM 9	CLIP 1 SELF ADHESIVE CABLE CLIPS	4
ITEM 10	REFL 3 REFLECTOR	1

## ASSEMBLY DIAGRAM

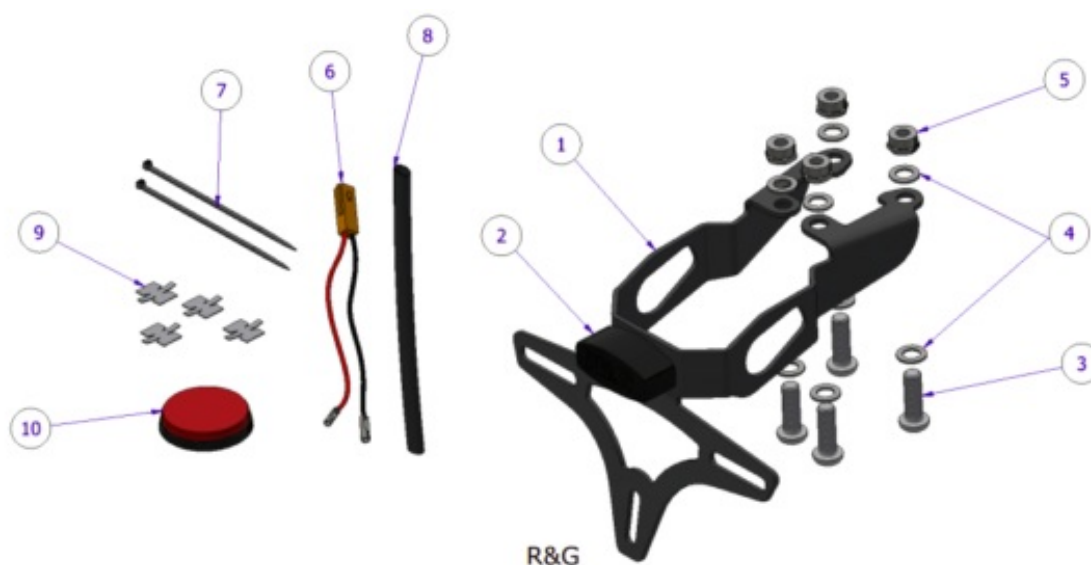

## FITTING PICTURES

Picture 1

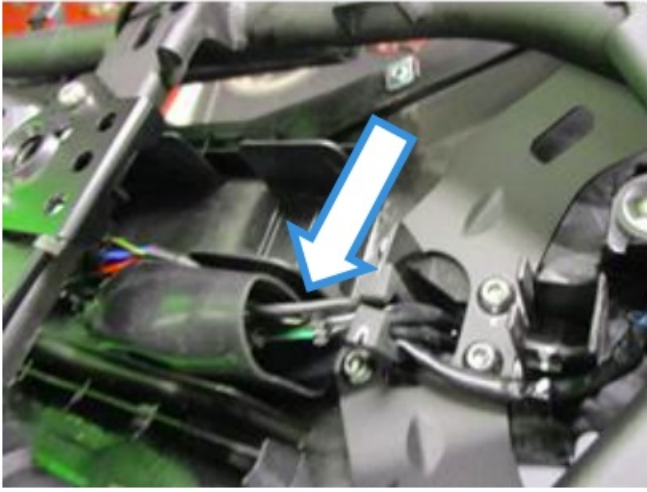

Picture 2

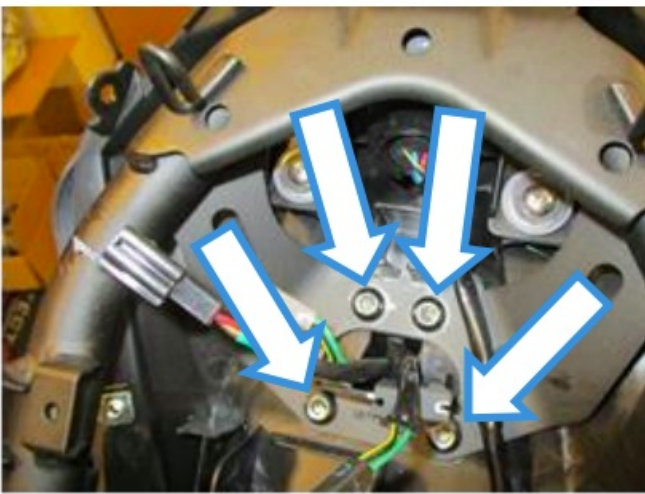

Picture 3



Picture 4



**Picture 5**



**Picture 6**



## **FITTING INSTRUCTIONS**

- To fit the R&G tail tidy, first remove the seat using the key.
- Slide the rubber plug socket cover along the wiring loom to give access to the indicator and licence plate illuminator as indicated in picture 1 and disconnect the three plug sockets.

- Remove the four bolts arrowed in picture 2, while supporting the original licence plate bracket from underneath.
- Carefully lower the original licence plate bracket while feeding the wiring through the hole in the under-tray.
- Remove the screw arrowed in picture 3. Remove the indicator clamp bracket as shown in picture 4. Remove the indicator spreader plate as shown in picture 5. Gently squeeze the indicator stem and remove the indicator.
- Repeat the above steps to remove the opposite indicator.
- Fit the indicators into the new licence plate bracket (item 1) and secure using the method detailed above in reverse order.
- Fit the R&G licence plate illuminator (item 2) as shown in the assembly diagram, please note you will have to fit the light shroud and use a small amount of adhesive to hold it in position. Fit one length of heat-shrink (item 8) to the wire.
- Tidy the wiring to the licence plate bracket using the clips and cable ties (items 7 and 9).
- Offer the new licence plate bracket into position while feeding the wiring through the hole in the under-tray, placing the OEM rubber bung back into position.
- Fit the four button head bolts with washers (items 3 and 4) through the four holes in the new licence plate bracket as shown in picture 6.
- Secure using the four nuts with washers (items 4 and 5), ensuring the wires are not crushed.
- Re-fit the licence plate (it may require drilling).
- Depending on local laws, attach enclosed reflector (item 10) in an appropriate location.
- Test the licence plate illuminator and all lights before riding.
- **IMPORTANT: IF FITTING A FULL-SIZE LICENCE PLATE AND PLACING IT FAR DOWN ON THE LICENCE PLATE HANGER, THERE IS A SMALL CHANCE OF THE LICENCE PLATE HITTING THE BACK WHEEL UNDER HEAVY LOAD AND OVER LARGE BUMPS IN THE ROAD. IT IS YOUR RESPONSIBILITY TO CHECK FOR THIS POSSIBILITY AND TAKE AVOIDING ACTION. FAILURE TO CHECK THIS COULD RESULT IN SERIOUS INJURY.**

**ISSUE 1 – 10/05/2024 (MH)**

## **CONSUMER NOTICE**

The catalogue description and any exhibition of samples are only broad indications of the Products and R&G may make design changes which do not diminish their performance or visual appeal and supplying them in such state shall conform to the order. The Buyer acknowledges no representation or warranty (other than as to title) has been given or will apply to the Products other than those in R&G's order or confirmation and the Buyer confirms it has chosen the Products as being of merchantable quality and suitable for its particular purposes. Where R&G fits the Products or undertakes other services it shall exercise reasonable skill and care and rectify any fault free of charge unless the workmanship has been disturbed. The Buyer is responsible for ensuring that the warranty on the motorcycle is not affected by the fitting of the Products. On return of any defective Products R&G shall at its option either supply a replacement or refund the purchase money but shall not be liable if the Products have been modified or used or maintained otherwise than in accordance with R&G's or manufacturer's instructions and good engineering practice or if the defect arises from accident or neglect. Other than identified above and subject to R&G not limiting its liability for causing death and personal injury, it shall not be liable for indirect or consequential loss and otherwise its liability shall be limited to the amounts paid by the Buyer for the Products or the fitting or service concerned. These terms do not affect the Buyer's statutory rights.

## **R&G RACING RETURNS POLICY (NON-FAULTY GOODS)**

Returns must be pre-authorised (if not pre-authorised the return will be rejected). Goods may only be returned direct to us if they were purchased direct from us (customer must prove if necessary). Otherwise to be returned to

original vendor. Goods must be in re-sellable condition, in the opinion of R&G Racing. All returns are subject to a 25% restocking and handling fee (25% of the gross value exc. P&P – at the prevailing price at time of purchase). The customer must pay any and all carriage charges. No returns of discontinued products, unless within 14 days of purchase. This policy does not affect your statutory rights and does not refer to faulty goods.

## R&G

Unit 1, Shelley's Lane, East Worldham, Alton, Hampshire, GU34 3AQ

Tel: +44 (0)1420 89007

Fax: +44 (0)1420 87301

[www.rg-racing.com](http://www.rg-racing.com)

Email: [info@rg-racing.com](mailto:info@rg-racing.com)



## Documents / Resources

	<p><a href="#">R AND G RACING LP0380 Tail Tidy</a> [pdf] Instruction Manual LP0380, LP0380 Tail Tidy, LP0380, Tail Tidy, Tidy</p>
---	---

## References

- [User Manual](#)

### [Manuals+](#), [Privacy Policy](#)

This website is an independent publication and is neither affiliated with nor endorsed by any of the trademark owners. The "Bluetooth®" word mark and logos are registered trademarks owned by Bluetooth SIG, Inc. The "Wi-Fi®" word mark and logos are registered trademarks owned by the Wi-Fi Alliance. Any use of these marks on this website does not imply any affiliation with or endorsement.