



**Contents** [ [hide](#) ]

- [1 QUIN E50 Label Printer](#)
- [2 Download App and More Guide](#)
- [3 Product Description](#)
- [4 Quick Use](#)
- [5 Safety Instructions](#)
- [6 Operation Panel Instructions](#)
- [7 Warranty Card](#)
- [8 Documents / Resources](#)
  - [8.1 References](#)

# QUIN

## QUIN E50 Label Printer

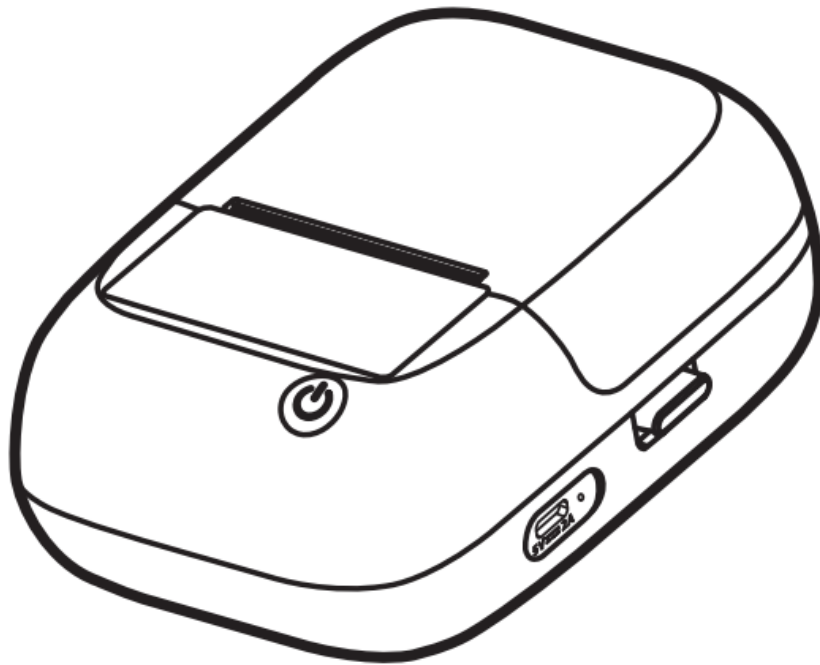

## Download App and More Guide

### Downloading the App

**Method 1:** Search for the “Print Master” app on App Store• or Google Play” for download and installation.

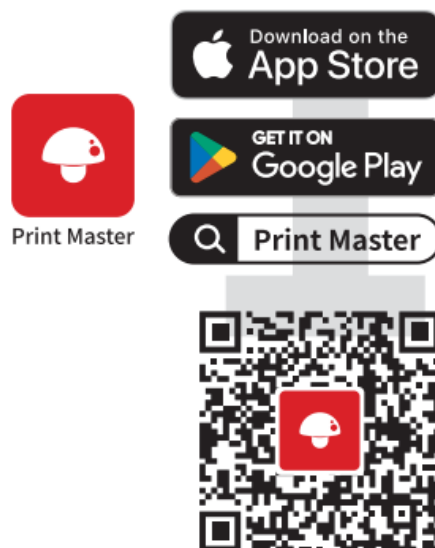

**Method 2:** Scan the QR code to download the app.

You can scan the code using your cell phone’s camera, the built-in QR code scanning feature of your browser, or a dedicated QR code scanning app.

As the Safari browser on Apple devices does not support direct QR code scanning, please use your device’s built-in QR code scanner instead.

## More Instructions

You can choose from the following methods to download the driver, check the detailed digital instructions which includes tutorial videos and access frequent questioned answers

Method: Scan the QR code

You can scan the code using your cell phone's camera, the built-in QR code scanning feature of your browser, or a dedicated QR code scanning app. As the Safari browser on Apple devices does not support direct QR code scanning, please use your device's built-in QR code scanner instead.



Method 2: Visit <https://www.aimotech.cn/download/>

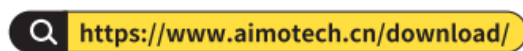

## Product Description

### Packing List



Printer  
×1

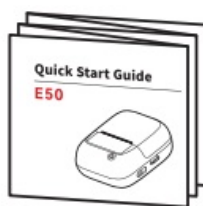

Quick Start Guide  
×1

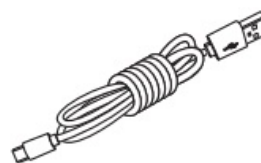

Type-C Cable  
×1

## Printer Parts

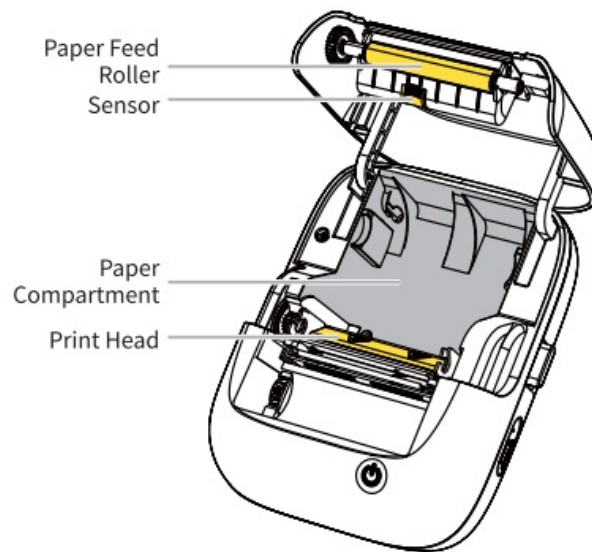
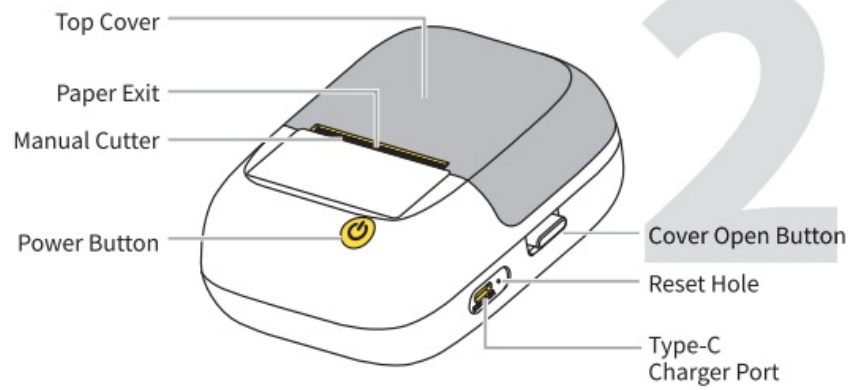

## Quick Use

### Install One-piece Consumable

1. Take new consumable
2. Press Cover Open Button
3. Remove the protective film
4. Place the consumable into Paper Compartment

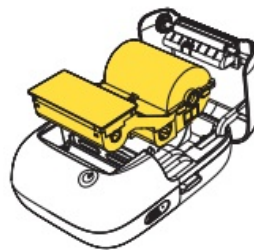
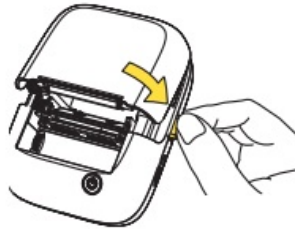
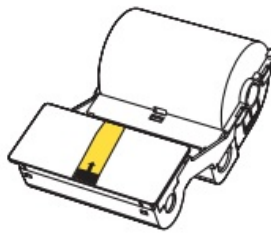

5. Pull the label paper out of the slot

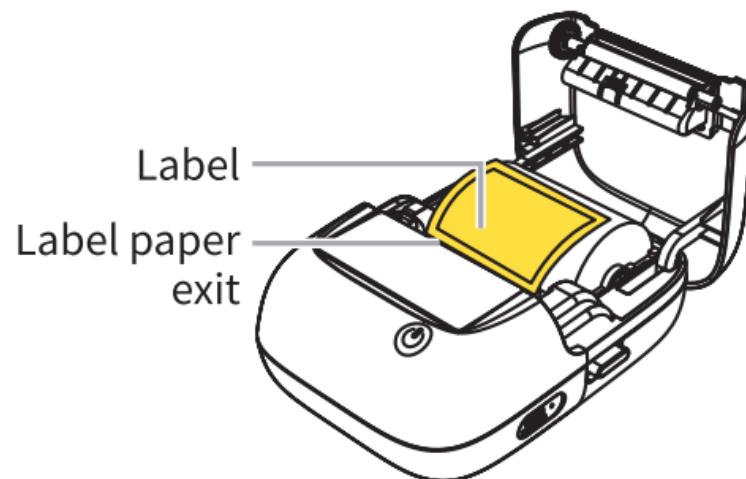

6. Close the Top Cover

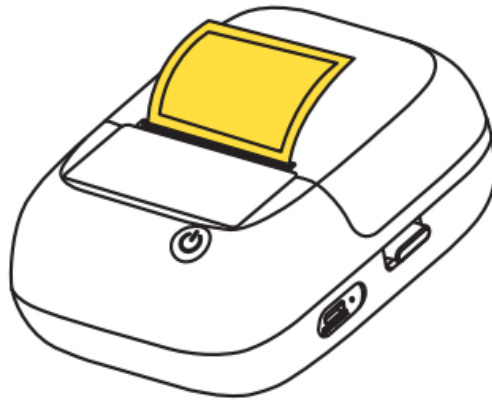

7. Long press Power Button for 3s to power on; click Feed Button to feed paper after the screen turn light

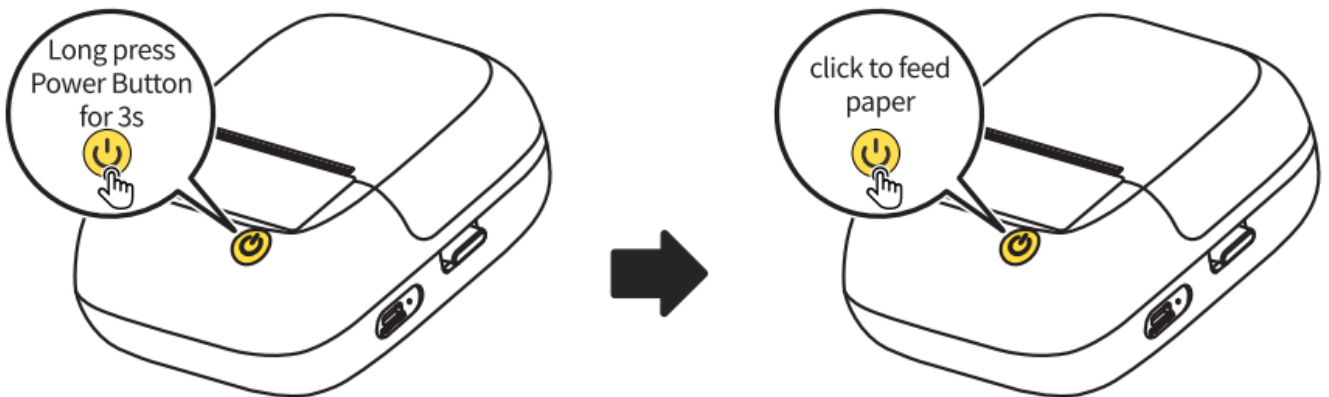

To install consumable when the power is on, click Feed Button to feed

## Safety Instructions

### Manual Cutter and Print Head Instructions

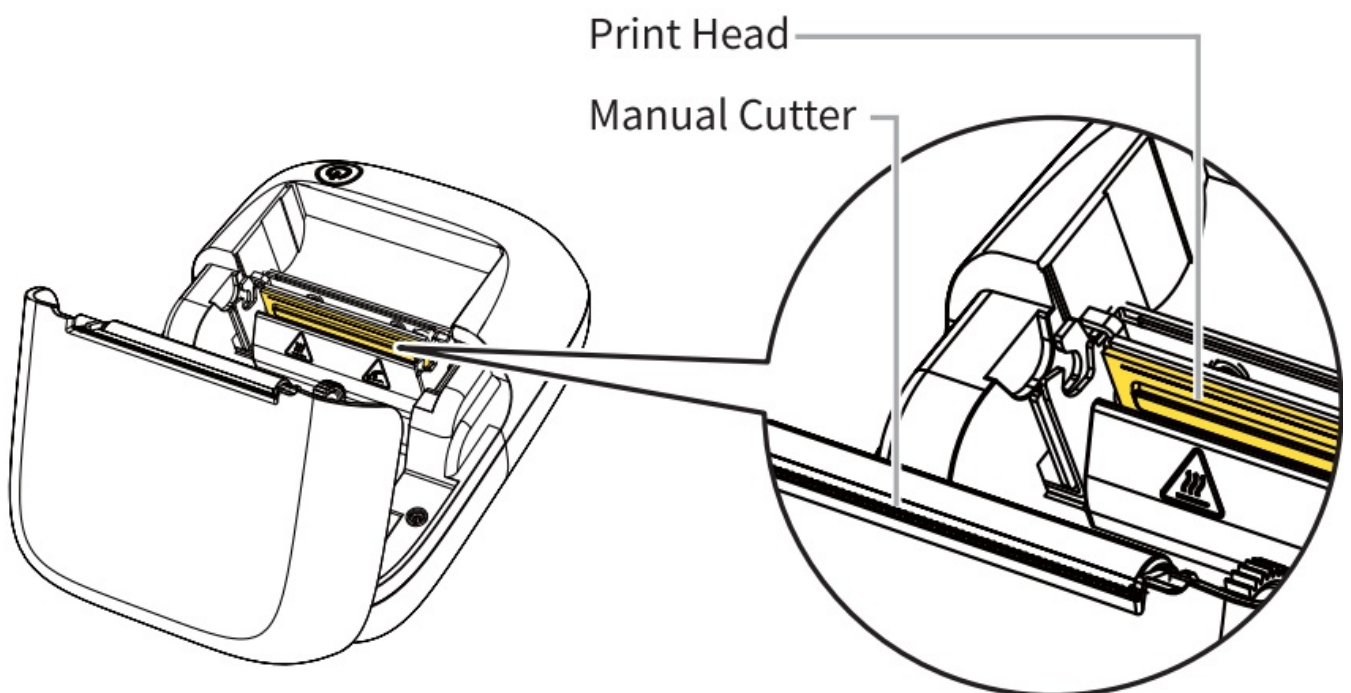

- **Manual Cutter Warning:** This cutter has sharp edges. Do not touch the edges of the cutter.
- **Print Head Warning:** The component can be HOT! Touching it when it is hot can cause burns to your fingers. Before you touch the Print Head, please wait for at least 30 minutes after turning off the printer.

## Charging Instructions

1. Please prepare your own power adapter (DC 5V/2A) with a Type-A port.
  2. Insert the Type-C end (flat end) of the USB cable into E50's Type-C Port; insert the Type-A end (wide end) of the USB cable into the Type-A port of the power adapter.
  3. When connected and plugged in, the printer's white indicator light shows it is charging.
  4. When the battery is depleted, charge for 20 minutes for quick usage. For a full charge, please charge for 2-3 hours or until the Indicator Light turns solid green.
  5. As the printer may heat up during charging, avoid placing it on materials such as cotton or linen. Once the battery is fully charged, please unplug the charger promptly.
  6. Once charged, please unplug the charger promptly.
- Avoid using the printer while charging.
  - Using the printer while charging may lead to reduced charging speed, compromised print quality, and shortened battery life.
  - Please use 5V=2A power adapters for charging to avoid potential injuries led by fire, electric shock or burns.

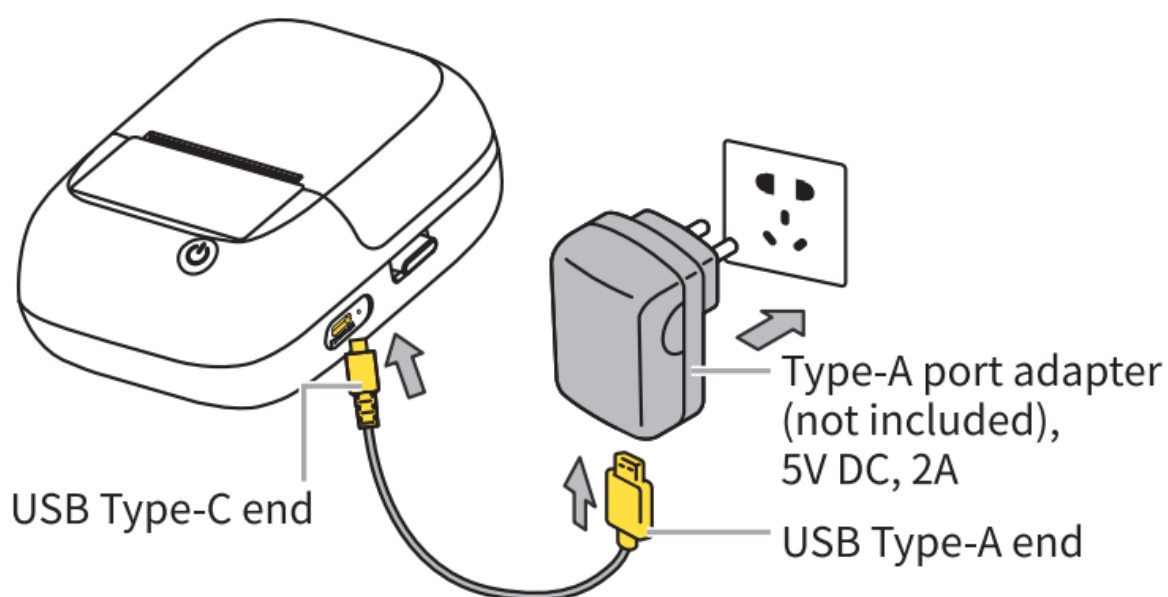

## Operation Panel Instructions

## Indicator Light Instructions

| Light                       | Printer status  |
|-----------------------------|---|
| Solid white light           | Standby/ Battery full when power on   |
| White light flashes slowly  | Battery being charged when power on   |
| White light flashes quickly | Battery being charged when power off  |
| Solid red light             | Printer anomaly (due to cover open, overheating, lack of paper, paper jam, printing paused, memory error, etc,) |
| Red light flashes quickly   | Battery level less than 20% while printer not being charged   |
| Red light flashes slowly    | Battery level less than 5% while printer not being charged  |

## Button Instructions

| Buttons                      | Operation                             | Function                    |
|------------------------------|---------------------------------------|-----------------------------|
| Power Button/<br>Feed Button | Long press for 3s (when power off)    | Power on                    |
|                              | Long press for 3s (when power on)     | Power off                   |
|                              | Long press to restart (when power on) | Restart to calibrate Sensor |
|                              | Click (Cut Label)                     | Feed a label                |
|                              | Click (Continuous Label)              | Feed 20mm                   |
|                              | Click (When printing)                 | Pause printing              |
|                              | Click (When print paused)             | Resume printing             |
|                              | Double-click (When print paused)      | Cancel printing             |

## Warranty Card

☐ Exchange☐ Return

|                            |                  |
|----------------------------|------------------|
| Customer Information       | Name             |
|                            | Sex              |
| Product Information        | Phone No.        |
|                            | Address          |
|                            | Date of Purchase |
| Return/Exchange Form       | Order No.        |
|                            | Serial No.       |
| Reason for Return/Exchange |                  |

## Special Notes

The company assumes full responsibility for the revision and explanation of this manual, exercising utmost diligence to guarantee its accuracy. Nevertheless, please note that any technical improvements to the product may not be separately notified, and that the images of the product, accessories, software interfaces, etc. in this manual serve solely as illustrations and references. Due to product updates and upgrades, the actual product may vary slightly from the images. Please refer to the physical product for accurate representations.

## Documents / Resources

|   |   |
|---|---|
|  | <a href="#">QUIN E50 Label Printer [pdf]</a> User Guide<br>2ASRB-E50, 2ASRBE50, e50, E50 Label Printer, E50, Label Printer, Printer |
|---|---|

## References

- [User Manual](#)

---

## Leave a comment

Your email address will not be published. Required fields are marked \*

Comment \*

Name

Email

Website

☐ Save my name, email, and website in this browser for the next time I comment.

**Post Comment**

**Search:**

**Search**

[Manuals+](#) | [Upload](#) | [Deep Search](#) | [Privacy Policy](#) | [@manuals.plus](#) | [YouTube](#)

This website is an independent publication and is neither affiliated with nor endorsed by any of the trademark owners. The "Bluetooth®" word mark and logos are registered trademarks owned by Bluetooth SIG, Inc. The "Wi-Fi®" word mark and logos are registered trademarks owned by the Wi-Fi Alliance. Any use of these marks on this website does not imply any affiliation with or endorsement.