

**QUIN D30 Smart
Mini Label Maker**



QUIN D30 Smart Mini Label Maker Instruction Manual

[Home](#) » [QUIN](#) » QUIN D30 Smart Mini Label Maker Instruction Manual 

Contents

- [1 QUIN D30 Smart Mini Label Maker](#)
- [2 Item Checklist](#)
- [3 Specifications](#)
- [4 Product Introduction Parts and Features](#)
- [5 How to Use](#)
- [6 Downloading the App](#)
- [7 Connecting the Label Maker](#)
- [8 Identifying the Label Size](#)
- [9 FCC STATEMENT](#)
- [10 Documents / Resources](#)
 - [10.1 References](#)

QUIN

QUIN D30 Smart Mini Label Maker



Item Checklist

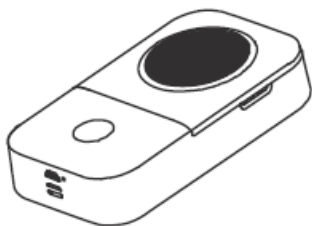

Label Maker*1

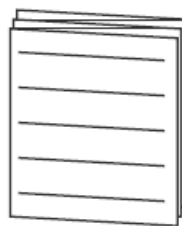

Instruction Manual*1

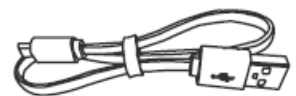

USB Cable*1

NOTE: The number of label rolls on the checklist is determined by the contents of the shipped package.

Specifications

| | |
|-----------------------|---|
| Name | Smart Mini Label Maker |
| Model | D30 |
| Technology | Thermal printing |
| Consumable width | 12-15mm |
| Supported Consumables | Black mark thermal Label, Pre-cut Label, Continuous Label |
| Darkness | Light, Medium, High |
| Resolution | 203 dpi |
| Printhead Lifespan | 50 KM |
| Communication Port | Bluetooth |
| Product Dimensions | 131.5*75.5*29 mm (5.2*2.9*1.2 inch) |
| Power Input | 5V==2A |
| Power Supply | Lithium Battery |
| | Micro USB |
| OS Supported | Android |
| | iOS |

Product Introduction Parts and Features

Label Maker display

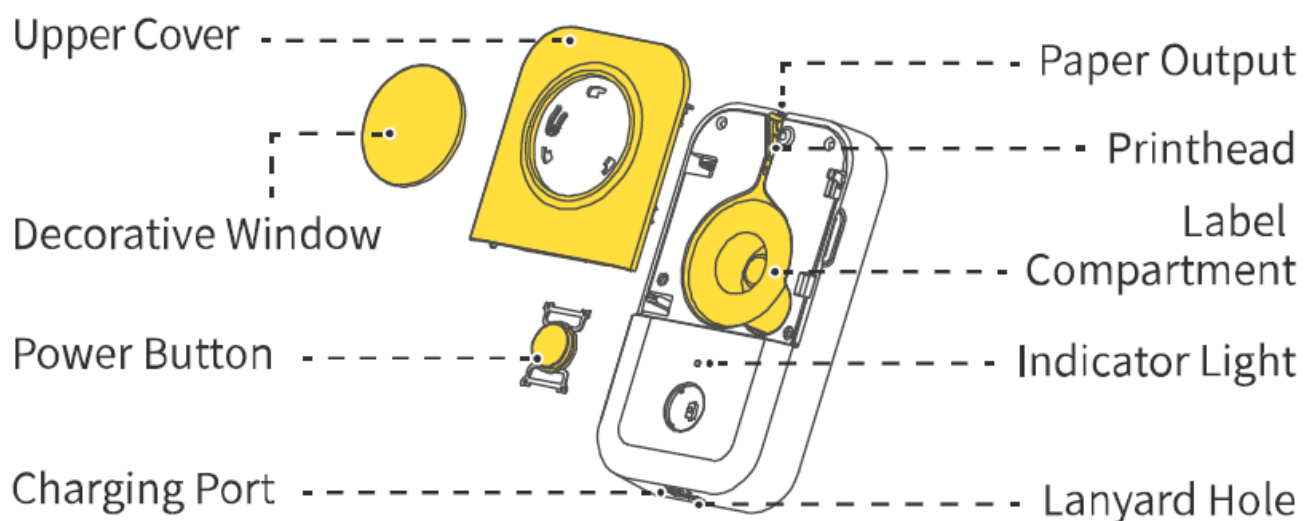

Features of Labels



Anti-loosening sticker

Various labels are available for purchase



Non-continuous label



Continuous label

Features of Continuous Labels

- Tear away the base of the label easily with the easy-to-tear line

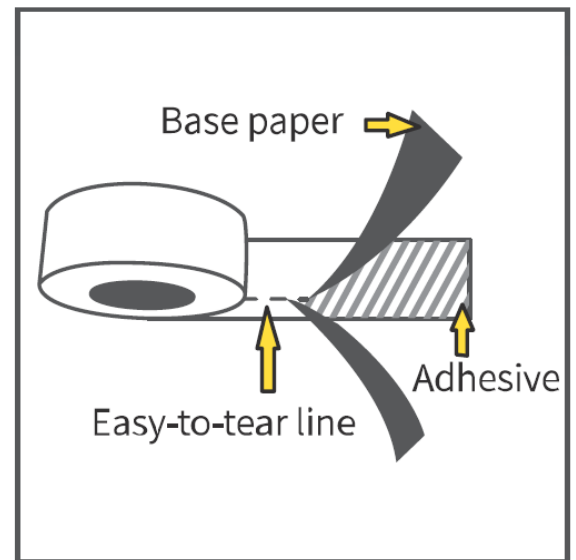
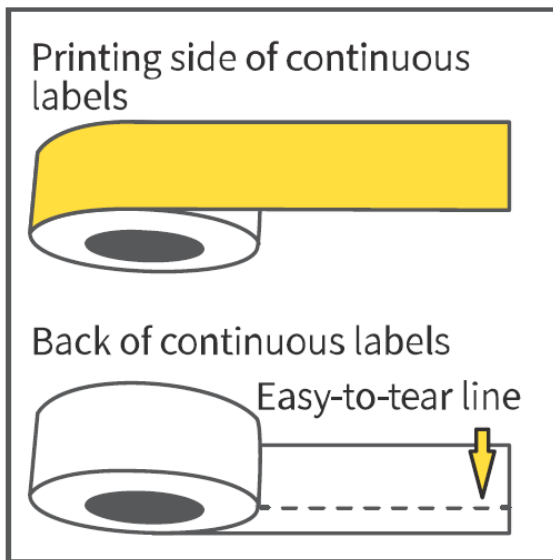

- Gently bend the label along the easy-to-tear line to tear the base from the adhesive easily

Product Introduction Power and Indicator Light



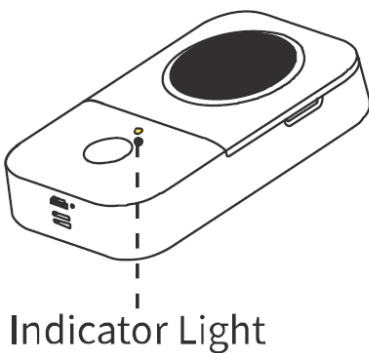



Power button description



Indicator Light

| Button | Operation | Functions |
|--------------|--------------------|-----------------------|
| Power button | Hold for 3 seconds | Power on/off |
| | Press once | Output the label |
| | Press twice | Print diagnostic page |

Indicator Light

| | |
|---|---|
|  Green Light | Normal |
|  Blinking (slow) Green Light | Powered on & charging |
|  Blinking (fast) Green Light | Powered off & charging |
|  Red Light | Error (No Paper, Cover is open, Overheat) |
|  Blinking (slow) Red Light | 10% Power left |
|  Blinking (fast) Red Light | 5% Power left |

How to Use

1. Open the label compartment.

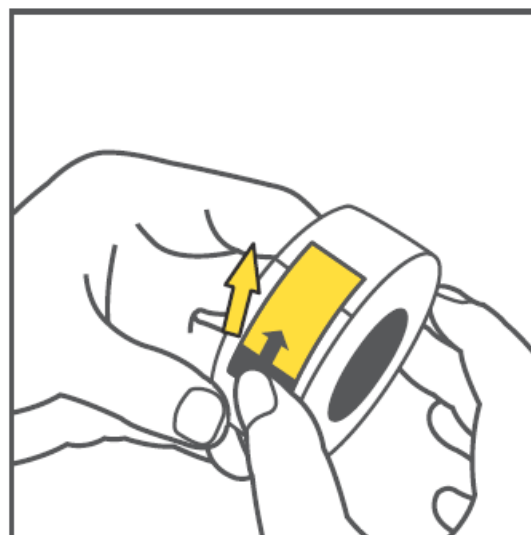
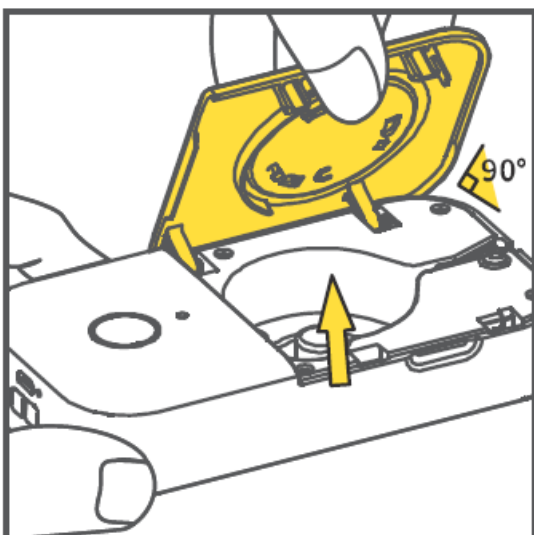

2. Take out the label roll, and tear the anti-loosening sticker.
3. place the label roll into the label compartment with the printing side facing left.

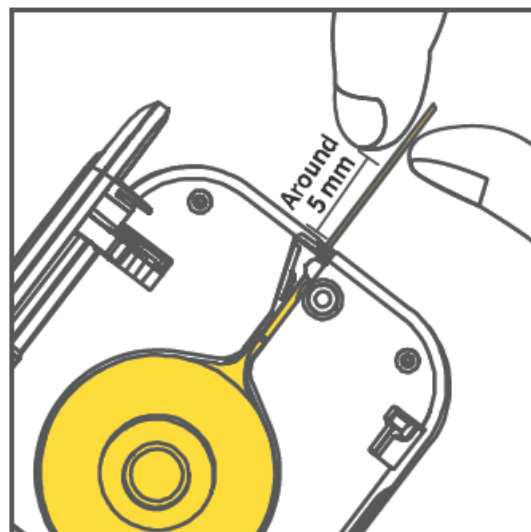
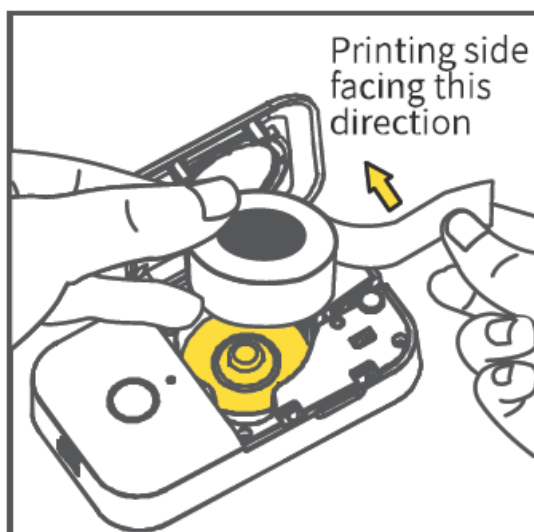

4. Pull out 5 mm of the label of the Label Maker.
5. Close the cover.

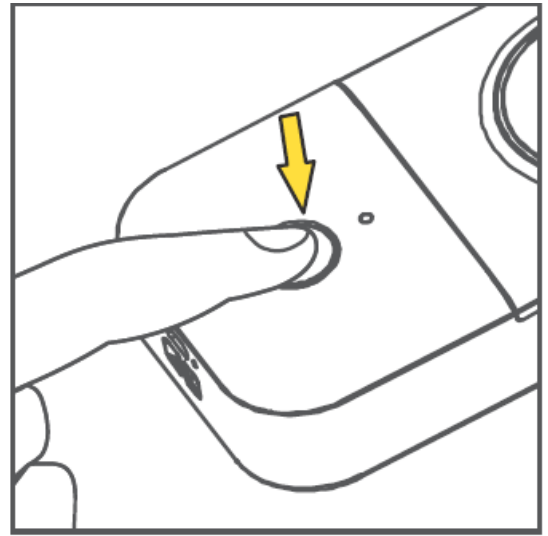
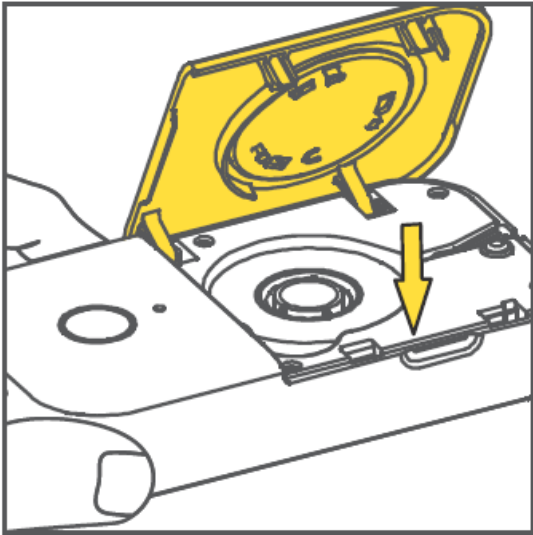

6. Hold the power button for 3s to start the Label Maker.

7. Press the power button once, and the Label Maker will start detecting the position of the label.

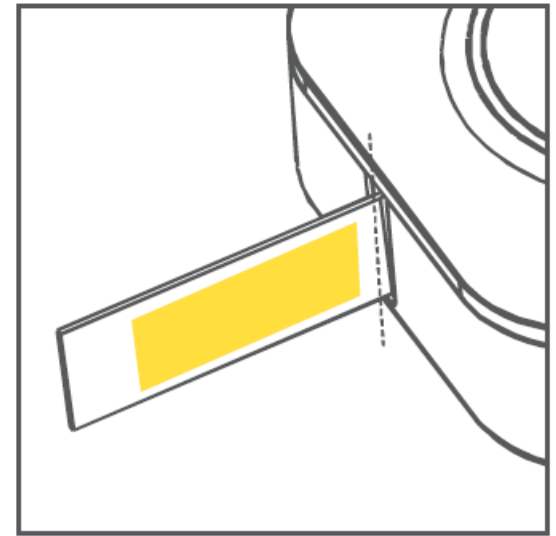
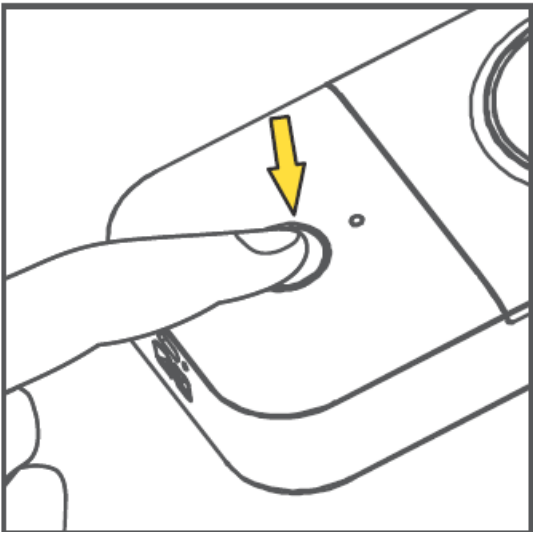

8. When the label comes out, the positioning of the label is complete.

NOTE

- After installing the label roll for the first time or replacing the label roll, remember to reposition the label (Step No. 7).
- If you do not reposition the label (Step No. 7), the first label you print will be printed incorrectly (missing contents, not aligning to the center, etc.).

Continuous labels do not need repositioning. You only need to pull the label to the opening of the Label Maker.

Downloading the App

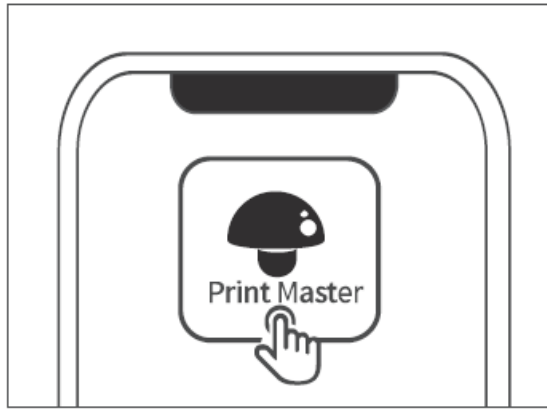

NOTE

- You need to connect the Label Maker through the Print Master app.
- In compliance with Google's requirement, Android phones must enable GPS (Location Services) before using Bluetooth.

Method 1

Use your phone to scan the QR code to install the App.

Method 2

Search for "Print Master" in the app store on your phone to download the App.



Connecting the Label Maker

1. Turn on GPS (Location Services) (Android phones only).

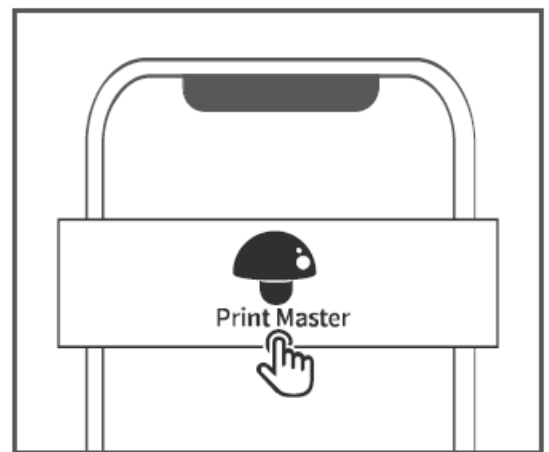

2. Open Print Master.

3. Tap the "Connect now" button to search for your device.

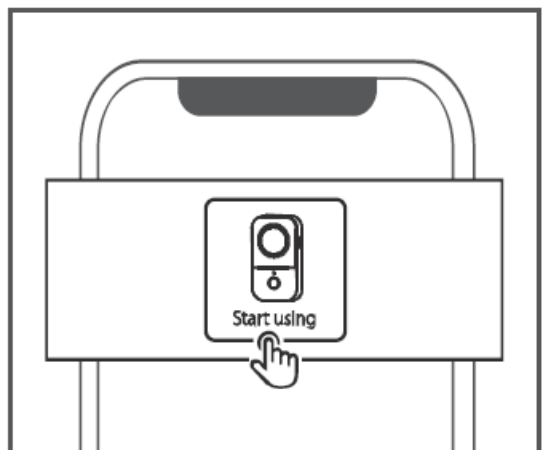
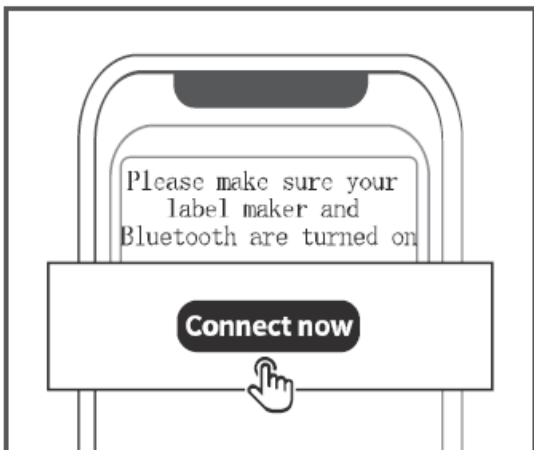

4. Press "Start using".

NOTE

- In compliance with Google's requirement, Android phones must enable GPS (Location Services) before using Bluetooth.
- Before connecting to your device in Print Master, please make sure your printer is turned on and your phone's Bluetooth is on.

Identifying the Label Size

Method 1

Check your label package.

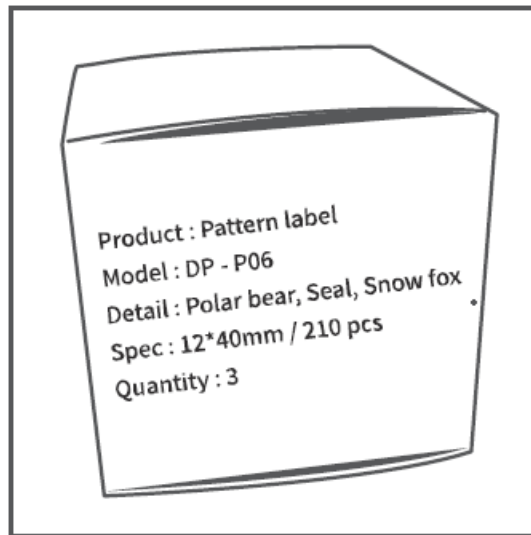

Method 2

Measure with a ruler.

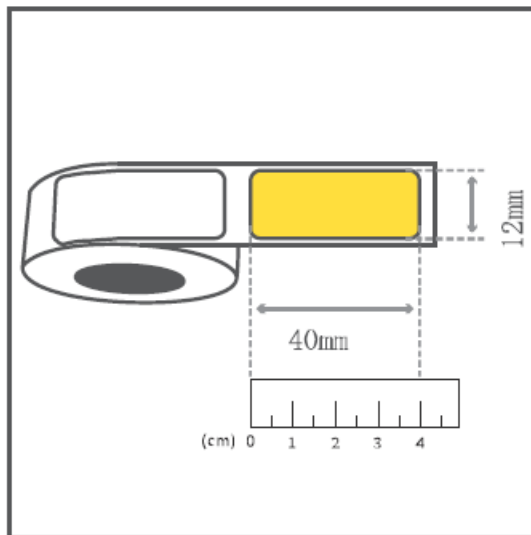

Method 3

Check the tag on your label roll. (Label rolls are being updated, so the actual product you receive may vary.)



This device (Main device model: D30; Series model: CP-D30, QY-D30, D30A, D30 Pro, D31, D30C, D30E, D30T) complies with part 15 of the FCC Rules. Operation is subject to the following two conditions:

1. This device may not cause harmful interference, and
2. this device must accept any interference received, including interference that may cause undesired operation.

Any Changes or modifications not expressly approved by the party responsible for compliance could void the user's authority to operate the equipment.

Note: This equipment has been tested and found to comply with the limits for a Class B digital device, according to part 15 of the FCC Rules.

These limits are designed to provide reasonable protection against harmful interference in a residential installation. This equipment generates uses and can radiate radio frequency energy and, if not installed and used under the instructions, may cause harmful interference to radio communications. However, there is no guarantee that interference will not occur in a particular installation. If this equipment does cause harmful interference to radio or television reception, which can be determined by turning the equipment off and on, the user is encouraged to try to correct the interference by one or more of the following measures:

- Reorient or relocate the receiving antenna.
- Increase the separation between the equipment and the receiver.
- Connect the equipment to an outlet on a circuit different from that to which the receiver is connected.
- Consult the dealer or an experienced radio/TV technician for help.

RF warning for Portable device

The device has been evaluated to meet general RF exposure requirements.

The device can be used in portable exposure conditions without restriction.

ISED NOTICE (Canada)

CAN ICES-003(B)/NMB-003(B)

This device contains license-exempt transmitters/receivers that comply with Innovation, Science, and Economic Development Canada's license-exempt RSS (s).

Operation is subject to the following two conditions:

1. This device may not cause interference.
2. This device must accept any interference, including interference that may cause undesired operation of the device.

This equipment complies with ISED radiation exposure limits set forth for an uncontrolled environment and meets RSS-102 of the ISED radio frequency (RF) IC RF exposure statement:

The device has been evaluated to meet the general IC RF exposure requirement.

The device can be used in portable exposure conditions without restriction.

Maintenance Card

**Replace****Return****User Information**

Name

Gender

Phone

Address

Product Information

Date of purchase

Product order number

Product serial number

Reason for Return
(Replace, Repair, Request
Maintenance)

Fault description

Multilingual Comprehensive Instruction Manual

Please scan the QR code to obtain the multilingual comprehensive version of the instruction manual and more tutorials.

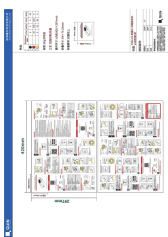
**Documents / Resources**

[QUIN D30 Smart Mini Label Maker](#) [pdf] Instruction Manual

D30C, 2ASRB-D30C, 2ASRBD30C, D30 Smart Mini Label Maker, D30, Mini Maker, Label Maker, Mini Label Maker, D30 Mini Label Maker, Smart Mini Label Maker

References

- [User Manual](#)

[Manuals+](#), [Privacy Policy](#)

This website is an independent publication and is neither affiliated with nor endorsed by any of the trademark owners. The "Bluetooth®" word mark and logos are registered trademarks owned by Bluetooth SIG, Inc. The "Wi-Fi®" word mark and logos are registered trademarks owned by the Wi-Fi Alliance. Any use of these marks on this website does not imply any affiliation with or endorsement.