



## Contents [ [hide](#) ]

[1 Quick Learn S8Q-04 High Gloss Handheld Transmitter](#)

[2 S8Q- Hand-held Transmitter](#)

[3 Important safety information](#)

[4 Intended use](#)

[5 Functional description](#)

[5.1 KeeLoq / change code](#)

[5.2 Linear code](#)

[5.3 Range](#)

[6 S8Q-04](#)

[7 Technical data](#)

[8 Disposal:](#)

[9 FAQ:](#)

[9.1 Q: What is the typical range of the transmitter?](#)

[9.2 Q: How do I teach the transmitter to the receiver?](#)

[10 Documents / Resources](#)

[10.1 References](#)

[11 Related Posts](#)

## Quick Learn S8Q-04 High Gloss Handheld Transmitter



## **INSTRUCTION MANUAL**

### **S8Q- Hand-held Transmitter**

15-Channel Group Hand-held Transmitter

4-Channel Hand-held Transmitter

KeeLoq or Linear Code

433,92MHz or 868,3MHz

With Remote Learning Function

### **Important safety information**

This remote control is only approved for use with devices and systems where a functional problem in the transmitter or receiver does not result in a personal or property hazard or this risk is covered by other safety equipment. Never let children play with the transmitter.

Never store or operate the transmitter in locations with dampness, steam, dust, sunlight, high relative humidity or similar conditions.

When using in a vehicle, store the transmitter so that it is not exposed to direct sunlight.

## Intended use

This transmitter is approved for general wireless control applications without safety relevance. The transmitter is exempt from licensing and fees. Any use other than the intended use shall be considered improper use for which the manufacturer is not liable. The fitter, electrician or operating organisation bears the risk and the liability here.



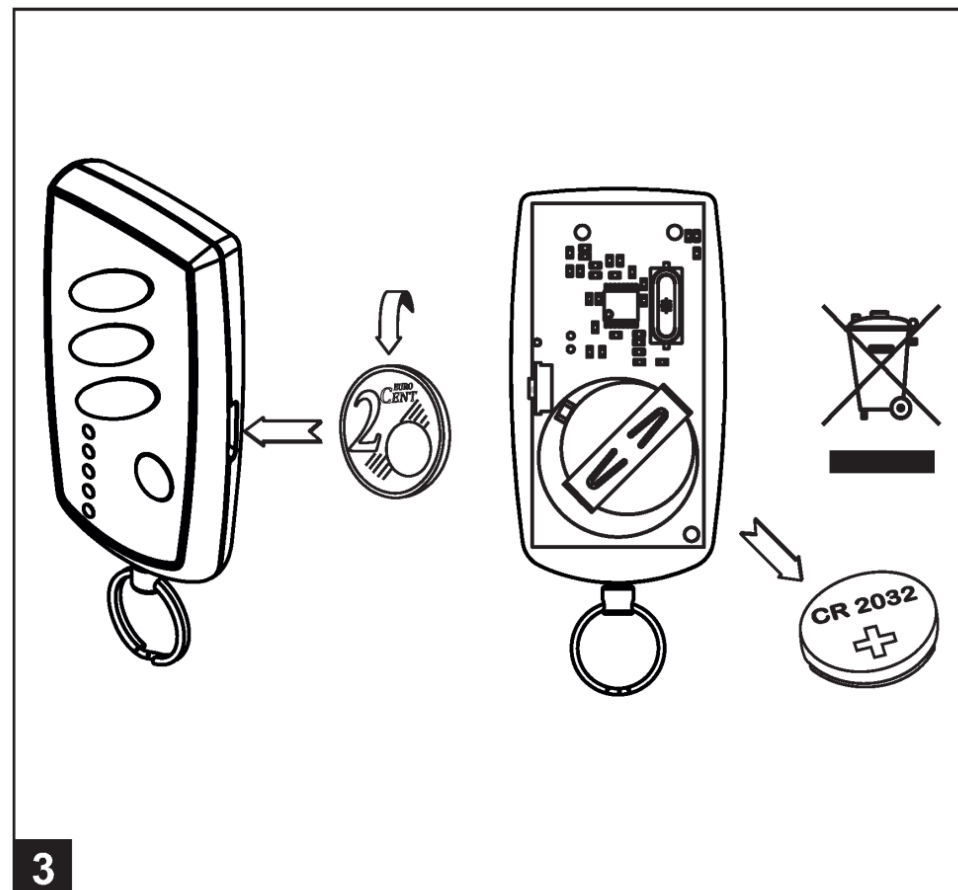
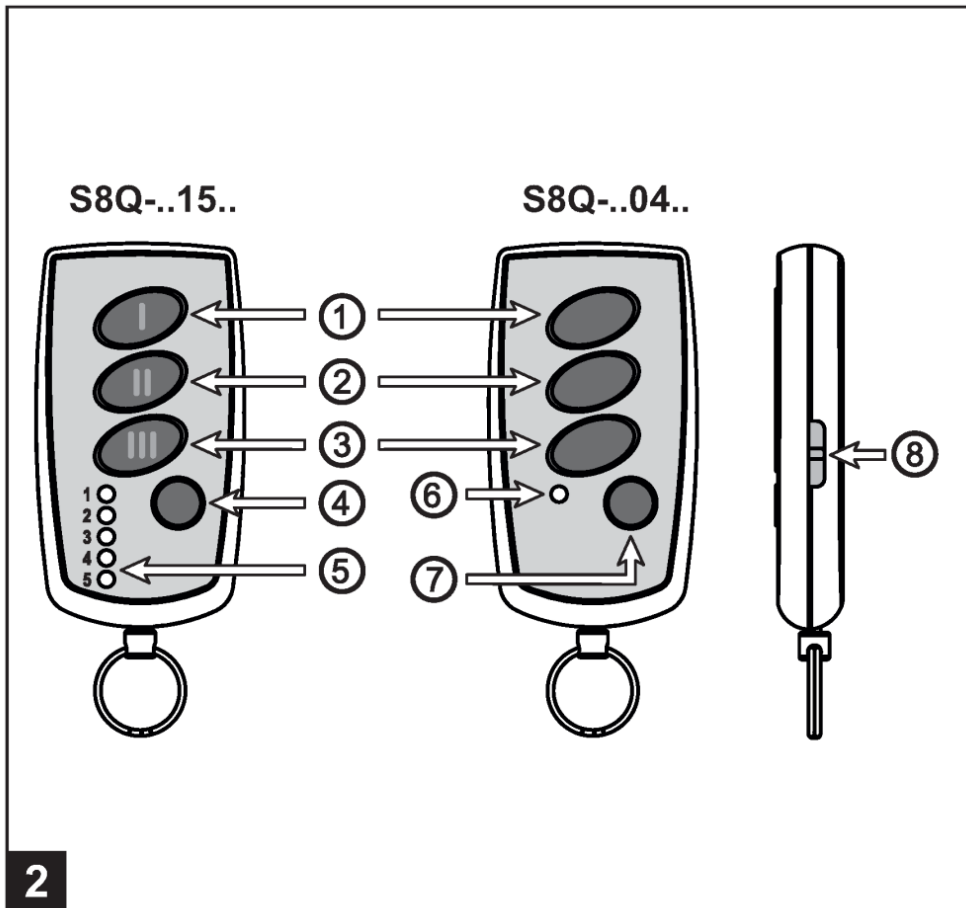

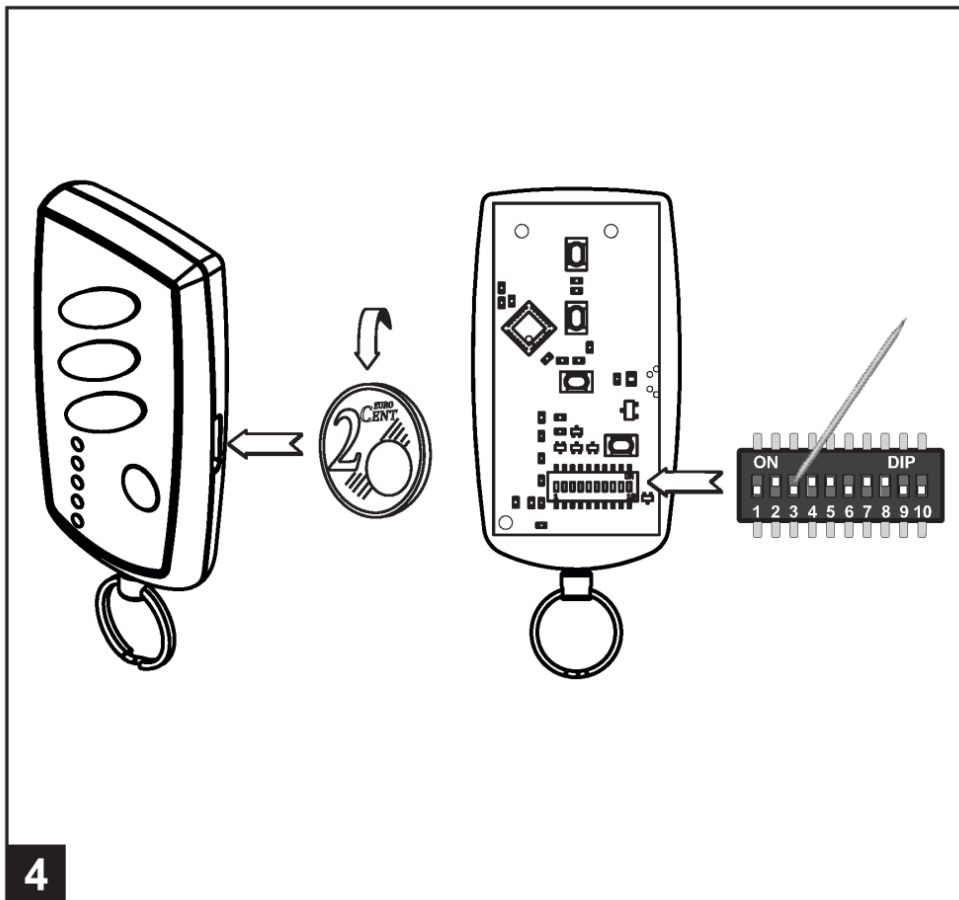

## Functional description

### KeeLoq / change code

A new code is calculated with each actuation. One learning process is required at the receiver per key and transmitter.

### Linear code

You can set your own security code using the coding switch.

One learning process is required at the receiver per key. For further transmitters only the security code has to be set the same.

If you leave all switches on “ON” or “OFF” at the coding switch, then the sender works with one code that is sequentially programmed at the factory.

### Range

Typical 75 m in an open field. The range achieved at the installation site depends on the receiver and transmitter position as well as the receiver's antenna position.

## **S8Q-04**

In the 4-channel transmitter, the key is set as transmit key 7 for channel 4 and the LED 6 as operating display.

In the 15-channel transmitter, the group selection key 4 serves for selecting the group. The selected group is indicated by the LEDs 5. You can select between the function sequence group/LED 5-4-3-2-1-5-4-3-etc. (delivery state) or 5-4-3-2-1-all-5-4-3-etc. In the function "all" (LEDs 1 to 5 are on) all receivers react to the learnt function of keys 1 to 111, e.g. blinds up or down. The function "all" can be changed/reset by pressing key 8 and inserting the battery at the same time: Activate "all": Keep key 8 pressed, insert battery- LED1 flashes – after about 5 sec. LEDs 1 to 5 will switch on.

Deactivate "all": Keep key 8 pressed, insert battery – LEDs 1 to 5 flash – later about 5 sec. LED1 will switch on.

The keys 1, 2, 3 are set as transmit keys for all versions (linear+KeeLoq) and the function key 8 serves in all versions for operating the special function "remote teaching" and "remote wipe" for receivers with software equipped for these function (e.g. E25Q). Teach the transmitter in accordance with the receiver instructions. The receiver checks the radio signal before it controls your unit. To do that, keep the transmit key pressed for at least 2 seconds.

## **Technical data**

- Permit: Exempt from licensing and fees
- Frequency: 868.3 MHz or 433.92 Mhz
- Modulation: Amplitude Shift Keying "ASK"
- Operating voltage: 3V Lithium button cell CR 2032
- Current consumption: Typ. 20mA in transmit mode
- Temperature range: -20 ..... +60°C
- Humidity: 30 ..... 80%

- Dimensions: Approx. 64 x 35 x 11 mm; (not including key fob)
- Weight: Approx. 22 g incl. battery

## **Disposal:**



Solely ROHS-conform components are used. Properly dispose of old appliances, device parts and batteries in a collecting point! Do not put them in domestic waste!

## **Dickert Electronic GmbH**

Fünfhausen 1

D-35091 Cölbe-Schönstadt

Tel.: +49 6427 / 9224-0

**Email: [info@dickert.net](mailto:info@dickert.net)**

hereby declares that the radio equipment type

S8Q is in compliance with the following Directives 2014/53/EU, 2011/65/EU

The full text of the EU declaration of conformity is available at the following internet address:

[dickert.com](http://dickert.com)

---

## **FAQ:**

**Q: What is the typical range of the transmitter?**

A: The typical range is 75m in an open field but may vary based on installation conditions.

**Q: How do I teach the transmitter to the receiver?**

A: Follow the receiver instructions provided and press and hold the transmit key for at least 2 seconds to teach the transmitter.

# Documents / Resources

	<p><a href="#">Quick Learn S8Q-04 High Gloss Handheld Transmitter [pdf]</a> Instruction Manual</p> <p>S8Q-04, S8Q-15, S8Q-04 High Gloss Handheld Transmitter, S8Q-04, High Gloss Handheld Transmitter, Gloss Handheld Transmitter, Handheld Transmitter, Transmitter</p>
---	--

## References

- [User Manual](#)

## Related Posts



### [EV R300 UHF Wireless Microphone Handheld Transmitter User Guide](#)

EV R300 UHF Wireless Microphone Handheld Transmitter Installation Instruction Of Handheld

Transmitter Install Antennas Install AC Adapter Blades...



### [Shure WA555 Handheld Transmitter Grip/Switch Cover User Manual](#)

Shure WA555 Handheld Transmitter Grip/Switch Cover General Description

The Shure Model WA555 is an external sleeve assembly that provides a textured grip to your microphone while preventing accidental contact with the microphone's side-mounted controls. The WA555 is designed for blackfinish microphones. To install the WA555: Unscrew and remove the battery...



### [Marantec 384 Digital Handheld Transmitter Owner's Manual](#)

Marantec 384 Digital Handheld Transmitter Product

Information Specifications: Model: Handsender Function:  
Programming of hand transmitter Compatibility: Existing hand...



[Saramonic Blink500 Pro HM Handheld Transmitter User Manual](#)

Blink500 Pro HM Product Structure Charging Contacts  
Power Indicator Solid Red Light = Blink500 Pro HM is

being...

■ Quick Learn

◆ Gloss Handheld Transmitter, Handheld Transmitter, High Gloss Handheld Transmitter, Quick Learn, S8Q-04, S8Q-04 High Gloss Handheld Transmitter, S8Q-15, Transmitter

---

## Leave a comment

Your email address will not be published. Required fields are marked \*

Comment \*

Name

Email

Website

☐ Save my name, email, and website in this browser for the next time I comment.

**Post Comment**

## Search:

e.g. whirlpool wrf535swhz

**Search**

[Manuals+](#) | [Upload](#) | [Deep Search](#) | [Privacy Policy](#) | [@manuals.plus](#) | [YouTube](#)

This website is an independent publication and is neither affiliated with nor endorsed by any of the trademark owners. The "Bluetooth®" word mark and logos are registered trademarks owned by Bluetooth SIG, Inc. The "Wi-Fi®" word mark and logos are registered trademarks owned by the Wi-Fi Alliance. Any use of these marks on this website does not imply any affiliation with or endorsement.