



Quam DTS4 Desktop PTT Station/ Intercom Station Installation Guide

[Home](#) » [Quam](#) » Quam DTS4 Desktop PTT Station/ Intercom Station Installation Guide 



DESKTOP INTERCOM STATION Installation Instructions

Contents

- [1 APPLICATION](#)
- [2 INSTALLATION INSTRUCTIONS](#)
- [3 TERMINATION](#)
- [4 Documents / Resources](#)
 - [4.1 References](#)
- [5 Related Posts](#)

APPLICATION

Intended Use: Indoor environment
Program Material: Signal tones and voice

INSTALLATION INSTRUCTIONS

1. Remove the front cover plate from the DTS4.
2. Select a field wiring entry point from the back or bottom of the DTS4.

The field wiring entry point in the bottom is for ½" electrical conduit whereas the field wiring entry point in the back is for multi-conductor field wiring such as Category 5 network cabling. If using a conduit, remove the knockout from the DTS4 enclosure.

3. Using the mounting holes in the bottom of the DTS4, mount to a solid surface to allow entry and connection of field wiring to the internal speaker, switch, and internal side of the XLR connector. If using an electrical conduit for field wiring, align the conduit entry hole with the field conduit. See mounting hole locations below.

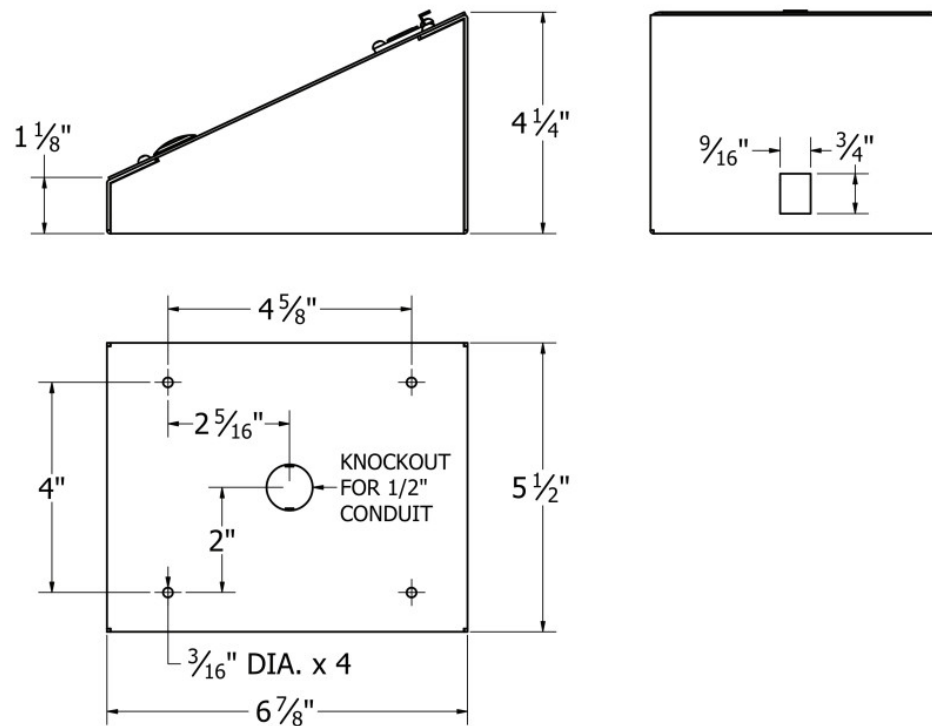

4. After the DTS4 enclosure has been securely mounted, verify that it cannot be dislodged from the mounting surface.

TERMINATION

1. Feed the field wiring into the DTS4 enclosure through the desired entry hole and conduit fitting (if applicable).
2. Terminate field wiring to allow connection to the speaker, switch, and XLR microphone socket of the DTS4.
3. Make necessary field wiring connections to DTS4 components. See diagrams below for field wiring connections.

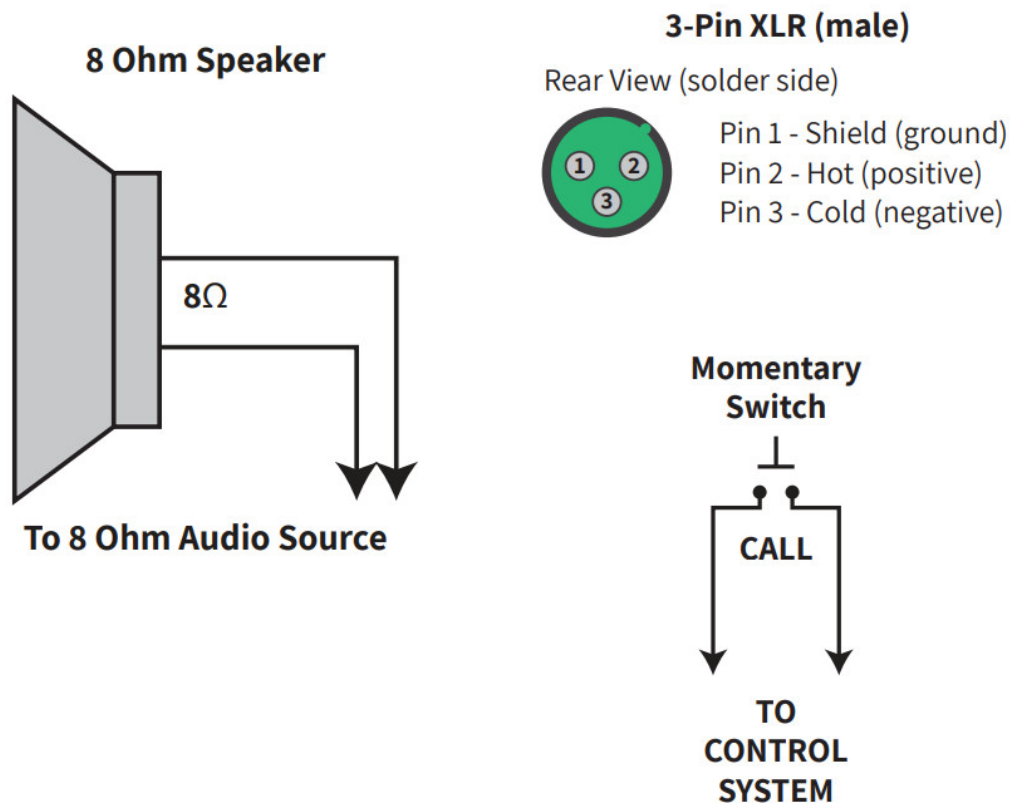

IMPORTANT:

- Be sure to insulate all unused wires from each other, the enclosure, and electrical ground.
 - Use code-compliant connectors for all field wiring connections.
 - Verify all code requirements with local AHJ before selecting the connection method.
4. If conduit fitting is used, tighten screws on the clamp of conduit fitting.
 5. Attach the front cover to the DTS4 enclosure using the included Torx security driver bit and four (4), #6-32, pin-in-Torx security screws. Tighten screws to prevent intrusion into the body of the DTS4.

Quam Nichols Company | 234 East Marquette Road | Chicago, IL. 60637 | t: 800-633-3669 | f: 888-633-3669 | e: NeedNow@QNC.com | QuamSpeakers.com

©2021 Quam Nichols Company reserves the right to make changes and/or improvements to its products at any time and without notice. | v.2104



Documents / Resources

	<p>Quam DTS4 Desktop PTT Station/ Intercom Station [pdf] Installation Guide DTS4, Desktop PTT Station, Desktop Intercom Station</p>
--	---

References

-  [Quam Speakers](#)

Manuals+.