



# QNAP QSW-M2106 Series Layer 2 Web Managed Switch Installation Guide

[Home](#) » [QNAP](#) » QNAP QSW-M2106 Series Layer 2 Web Managed Switch Installation Guide 

## Contents

- [1 QNAP QSW-M2106 Series Layer 2 Web Managed Switch](#)
- [2 Package Contents](#)
- [3 Top Panel](#)
- [4 Hardware Installation](#)
- [5 Accessing the Web User Interface](#)
- [6 LED Behavior](#)
- [7 Specifications](#)
- [8 FCC](#)
- [9 Documents / Resources](#)
  - [9.1 References](#)
- [10 Related Posts](#)



## QNAP QSW-M2106 Series Layer 2 Web Managed Switch



## Package Contents

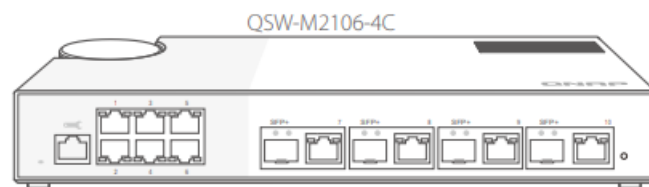
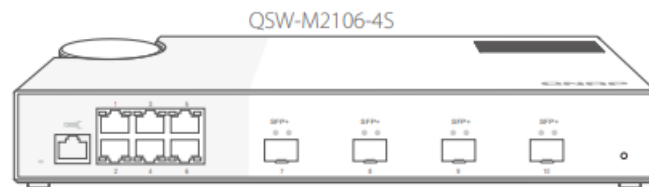
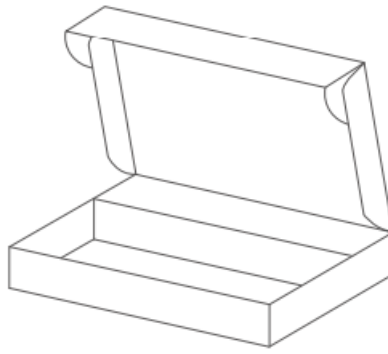

Power cord and adapter

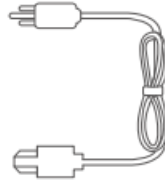
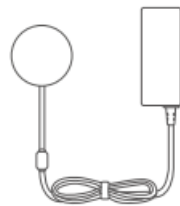

QIG



## Top Panel

## Power Input

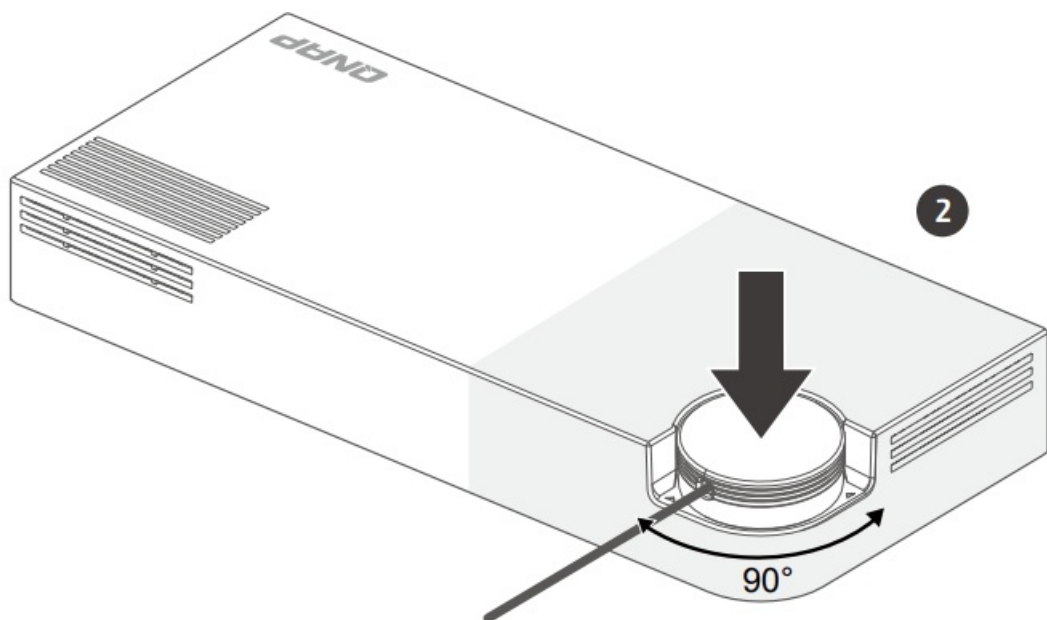
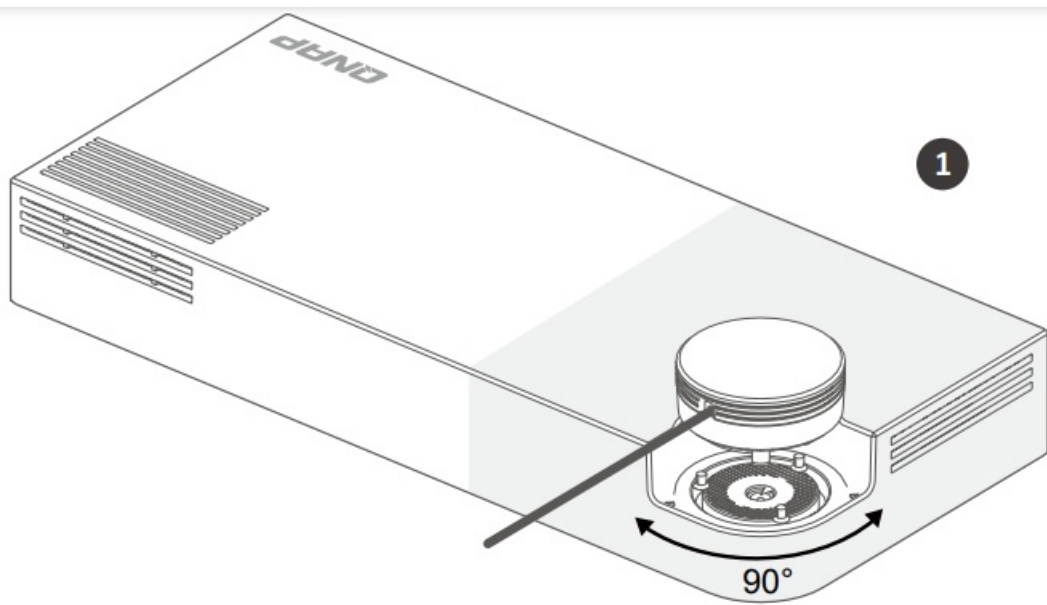

## Hardware Installation

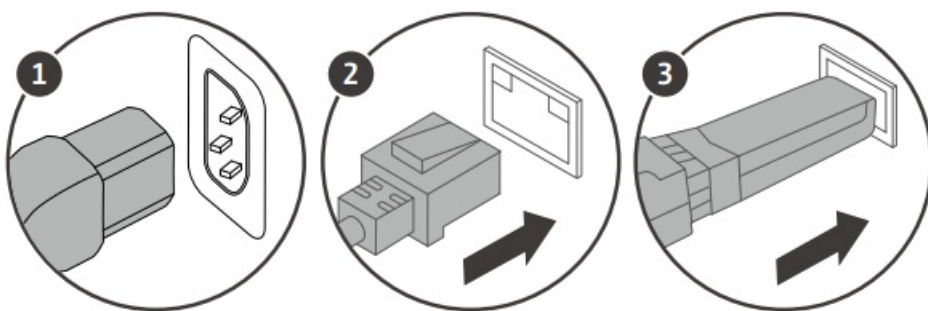

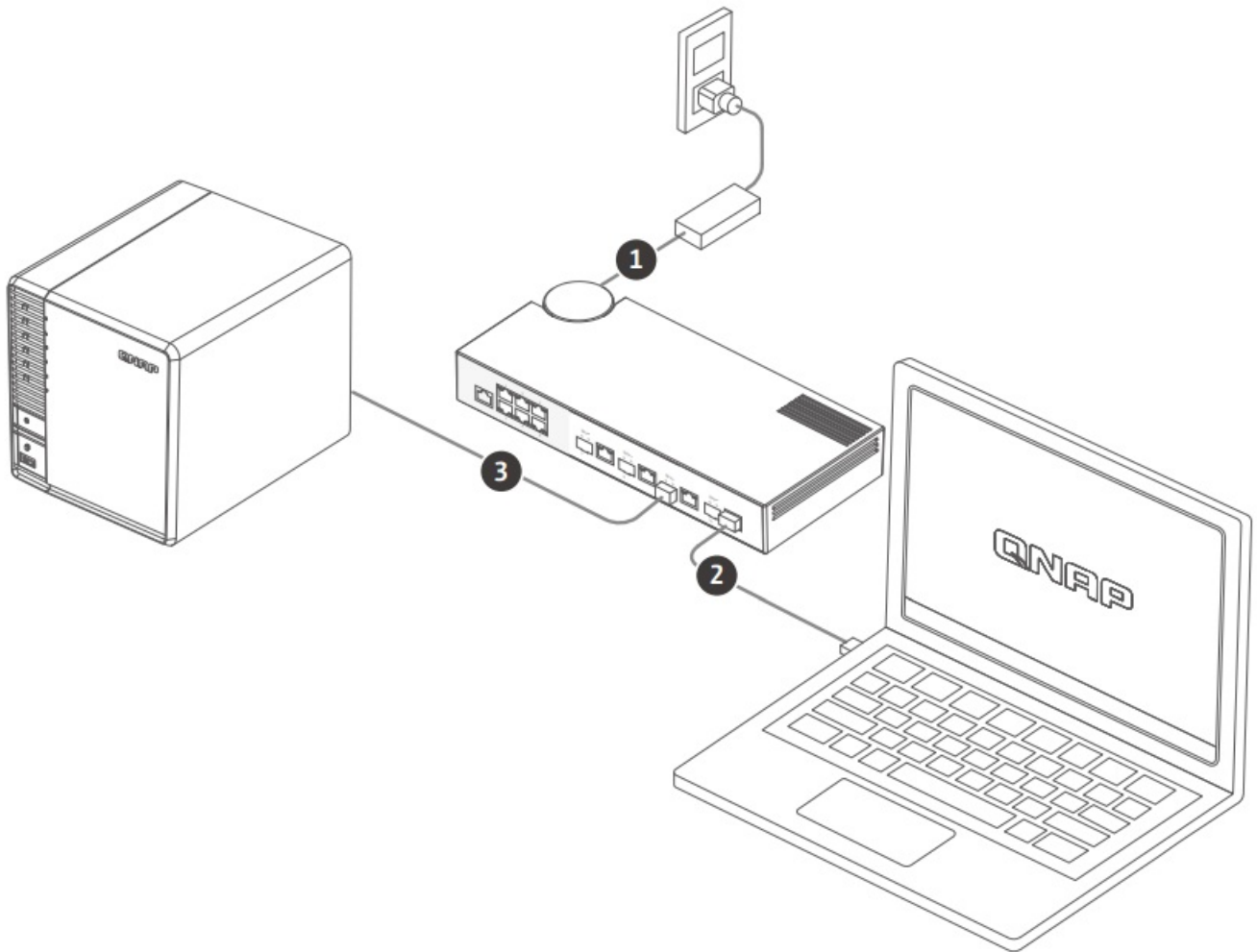

## Accessing the Web User Interface

If the device is unable to connect to a DHCP server to obtain an IP address, you can access the web user interface by changing the IP address of the computer to 169.254.100.102.

**Note:** Ensure that you change the IP address of the computer to its previous setting after configuring the switch. The default IP address of the QSW-M2106 series is 169.254.100.101.



Logging into the Web User Interface

Default username: admin

Default password: The default password is the MAC address in uppercase letters without special characters. For example, if the first MAC address is 00-08-9B-F6-15-75, then the admin password will be 00089BF61575.

Hardware Components

Front Panel Ports

Front Panel Ports

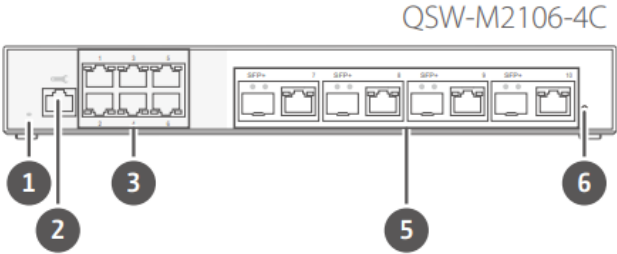
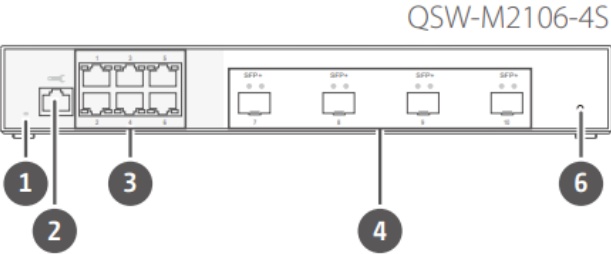

- 1. Status LED
- 2. 1 x RJ45 console port
- 3. 6 x 2.5GbE RJ45 ports
- 4. 4 x 10GbE SFP+ ports
- 5. 4 x 10GbE SFP+/RJ45 combo ports
- 6. Reset button

LED Behavior

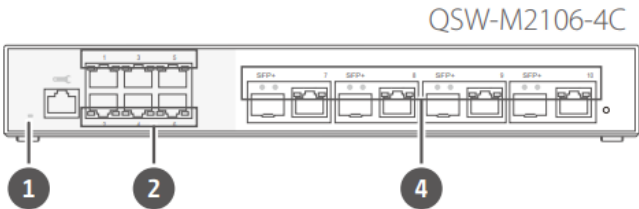

LED	Status	Description
System Status	Green	The device is ready.
	Flashes green	<ul style="list-style-type: none"><li>The device is being initialized.</li><li>The firmware is being updated.</li></ul> <p><b>Note:</b> When updating the firmware, do not remove the power cord or USB cable, and do not force-exit the application.</p> <ul style="list-style-type: none"><li>The device is being reset.</li></ul>

	Red	A fatal device error occurred.
	Off	The device is powered off.
<b>2.5GbE RJ45 (Left)</b>	Green	The link speed is operating at 2.5 Gbps.
	Flashes green	Data is being transmitted.
	Off	There is no network connection.
<b>2.5GbE RJ45 (Right)</b>	Amber	The link speed is operating at 1 Gbps, 100 Mbps or 10 Mbps.
	Flashes amber	Data is being transmitted.
	Off	There is no network connection.
<b>10GbE SFP+ (left)</b>	Green	The link speed is operating at 10 Gbps.
	Flashes green	Data is being transmitted.
	Off	There is no network connection.
<b>10GbE SFP+ (right)</b>	Amber	The link speed is operating at 1 Gbps.
	Flashes amber	Data is being transmitted.
	Off	There is no network connection.
	Green	The link speed is operating at 10 Gbps.

<b>10GbE SFP+/RJ45 combo (RJ45, left)</b>	Flashes green	Data is being transmitted.
	Off	There is no network connection.
<b>10GbE SFP+/RJ45 combo (RJ45, right)</b>	Amber	The link speed is operating at 5 Gbps, 2.5 Gbps, 1 Gbps, or 100 Mbps.
	Flashes amber	Data is being transmitted.
	Off	There is no network connection.
<b>10GbE SFP+/RJ45 combo (SFP+, left)</b>	Green	The link speed is operating at 10 Gbps.
	Flashes green	Data is being transmitted.
	Off	There is no network connection.
<b>10GbE SFP+/RJ45 combo (SFP+, right)</b>	Amber	The link speed is operating at 1 Gbps.
	Flashes amber	Data is being transmitted.
	Off	There is no network connection.

## Specifications

<b>Model</b>	QSW-M2106-4S	QSW-M2106-4C
<b>Dimensions (H x W x D)</b>	42.5 x 290 x 127 mm	
<b>Net weight Input voltage range Switching capacity RJ45 ports</b>	1.12 KG	1.12 KG
	100 – 240VAC	
	80 Gbps	
	8	
<b>SFP+ ports</b>	2	N/A
<b>Combo ports (SFP+/RJ45)</b>	N/A	2
<b>Operating temperature</b>	0°C to 40°C (32°F to 104°F)	
<b>Relative humidity</b>	5% to 95% (non-condensing)	

## FCC

This device complies with Part 15 of the FCC Rules. Operation is subject to the following two conditions:

1. This device may not cause harmful interference.
2. This device must accept any interference received, including interference that may cause undesired operation.

### **FCC Class B(QSW-M2106-4S) and Class B(QSW-M2106-4C) Notice:**

This equipment has been tested and found to comply with the limits for a Class B(QSW-M2106-4S) and Class B(QSW-M2106-4C) digital device, pursuant to Part 15 of the FCC Rules. These limits are designed to provide reasonable protection against harmful interference when the equipment is operated in a commercial environment. This equipment generates, uses, and can radiate radio frequency energy, and if not installed and used in accordance with the instruction manual, may cause harmful interference to radio communications. Operation of this equipment in a residential area is likely to cause harmful interference, in which case the user will be required to correct the interference at his own expense.

**Modifications:** Any modifications made to this device that are not approved by QNAP Systems, Inc. may void the authority granted to the user by the FCC to operate this equipment.

This device complies with CE compliance, QSW-M2106-4C Class B, QSW-M2106-4S Class B.

According to the requirement of the WEEE legislation the following user information is provided to customers for all branded QNAP Electronics products subject to the WEEE directive.

This symbol on the product or on its packaging indicates that this product must not be disposed of with your other household waste. Instead, it is your responsibility to dispose of your waste equipment by handing it over to a designated collection point for the recycling of waste electrical and electronic equipment. The separate collection and recycling of your waste equipment at the time of disposal will help to conserve natural resources and ensure that it is recycled in a manner that protects human health and the environment. For more information about where you can drop off your waste equipment for recycling, please contact your local city office, your household waste disposal service or the shop where you purchased the product.



**Office in EU;** QNAP GmbH,  
Karl-Arnold-Straße 26, 47877 Willich, Germany

**Office in UK;**  
QNAP Ltd,  
2 Drakes Meadow, Swindon SN3 3LL United Kingdom

This device complies with the UKCA requirements for products sold in Great Britain.

### THIS PRODUCT CONTAINS A BUTTON BATTERY



If swallowed, a lithium button battery can cause severe or fatal injuries within 2 hours. Keep batteries out of reach of children. If you think batteries may have been swallowed or placed inside any part of the body, seek immediate medical attention.

- [install.qnap.com](https://install.qnap.com)
- [service.qnap.com](https://service.qnap.com)
- [download.qnap.com](https://download.qnap.com)

## Documents / Resources

	<p><a href="#">QNAP QSW-M2106 Series Layer 2 Web Managed Switch</a> [pdf] Installation Guide</p> <p>QSW-M2106 Series Layer 2 Web Managed Switch, QSW-M2106 Series, Layer 2 Web Managed Switch, Managed Switch</p>
--	---

## References

-  [download.qnap.com](https://download.qnap.com)
-  [Cloud Install](#)
-  [Customer Service - QNAP](#)