

Qlima

**Qlima
SCM52
Remote
Control**

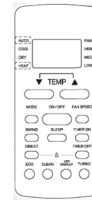

Qlima SCM52 Remote Control Instruction Manual

[Home](#) » [Qlima](#) » Qlima SCM52 Remote Control Instruction Manual 

Contents

- [1 Qlima SCM52 Remote Control](#)
- [2 Product Usage Instructions](#)
- [3 REMOTE CONTROLLER SPECIFICATIONS](#)
- [4 HANDLING THE REMOTE CONTROLLER](#)
- [5 FCC STATEMENT](#)
- [6 BUTTONS AND FUNCTIONS](#)
- [7 REMOTE SCREEN INDICATORS](#)
- [8 HOW TO USE BASIC FUNCTIONS](#)
- [9 HOW TO USE ADVANCED FUNCTIONS](#)
- [10 Documents / Resources](#)
 - [10.1 References](#)
- [11 Related Posts](#)

Qlima

Qlima SCM52 Remote Control

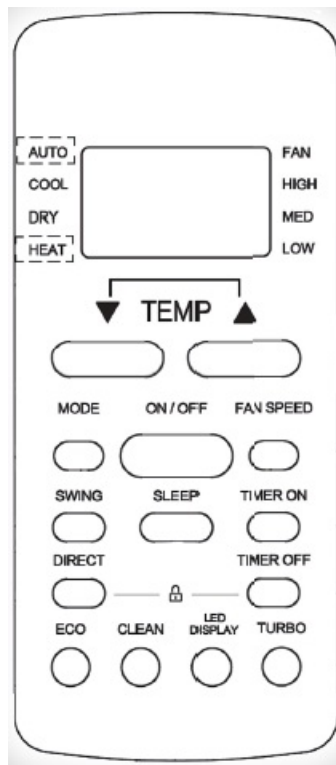

Product Usage Instructions

Handling the Remote Controller Inserting and Replacing Batteries:

1. Slide the back cover from the remote control downward to access the battery compartment.
2. Insert the batteries, ensuring the correct alignment of the (+) and (-) ends with the symbols inside the compartment.
3. Slide the battery cover back into place securely.

Battery Disposal: Please follow local laws for proper disposal of batteries. Do not dispose of them as unsorted municipal waste.

How to Use Basic Functions

1. Follow the quick start guide provided.
2. Insert batteries into the remote control.
3. Select the desired mode.
4. Choose the temperature setting.
5. Press the power button to turn on/off the unit.
6. Point the remote towards the unit for signal reception.
7. Select fan speed as needed.

How to Use Advanced Functions

If you are unsure about any function, refer to the detailed descriptions in the manual for further instructions on using advanced features.

FAQ

• **Q: What should I do if my remote control is not working?**

A: Check if the batteries are correctly inserted and functional. Ensure there are no obstructions between the remote and the unit. Refer to the troubleshooting section of the manual for more assistance.

REMOTE CONTROLLER SPECIFICATIONS

Rated Voltage	3.0V(Dry batteries R03/LR03×2)(not included)
Signal Receiving Range	8m
Environment	-5°C~60°C(23°F~140°F)

Quick start guide

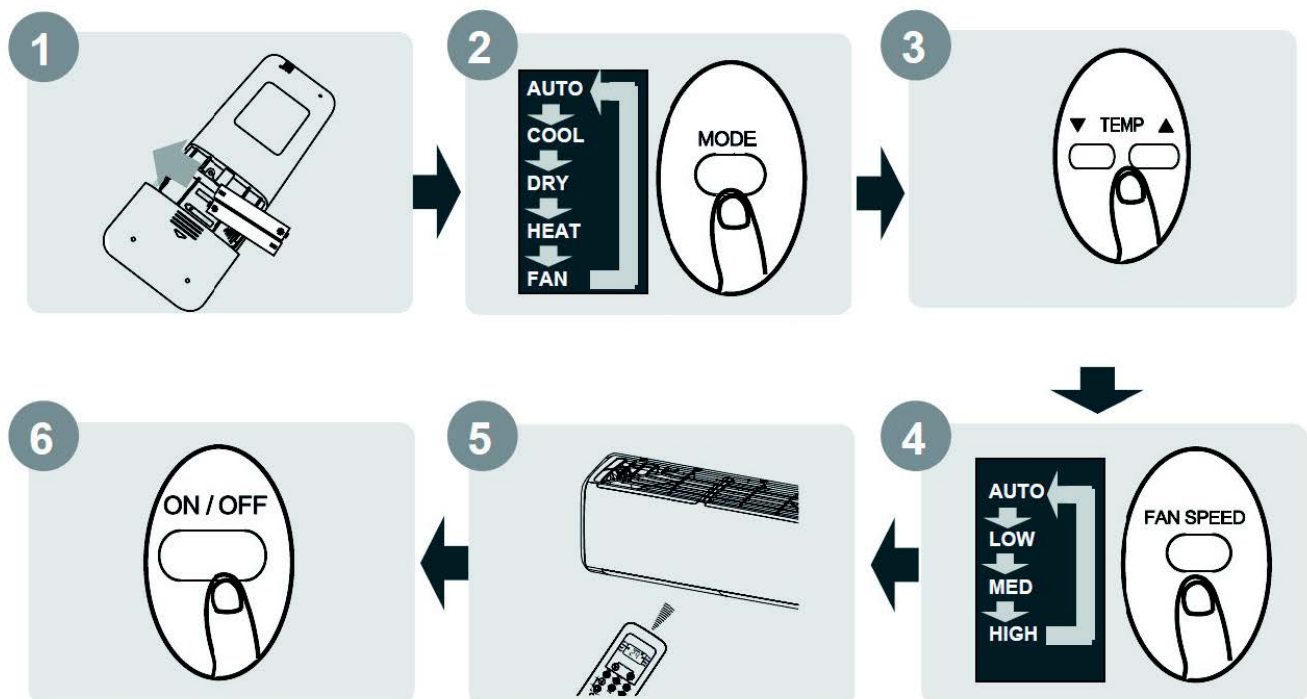

NOT SURE WHAT A FUNCTION DOES?

Refer to the How to Use Basic Functions and How to Use Advanced Functions sections of this manual for a detailed description of how to use your air conditioner.

SPECIAL NOTE

- Button designs on your unit may differ slightly from the example shown.
- If the indoor unit does not have a particular function, pressing that function's button on the remote control will have no effect.
- When there are wide differences between "Remote controller Manual" and "USER'S MANUAL" on function description, the description of "USER'S MANUAL" shall prevail.

HANDLING THE REMOTE CONTROLLER

INSERTING AND REPLACING BATTERIES

Put the batteries in the remote control before use.

1. Slide the back cover from the remote control downward, exposing the battery compartment.
2. Insert the batteries, paying attention to match up the (+) and (-) ends of the batteries with the symbols inside the battery compartment.
3. Slide the battery cover back into place.

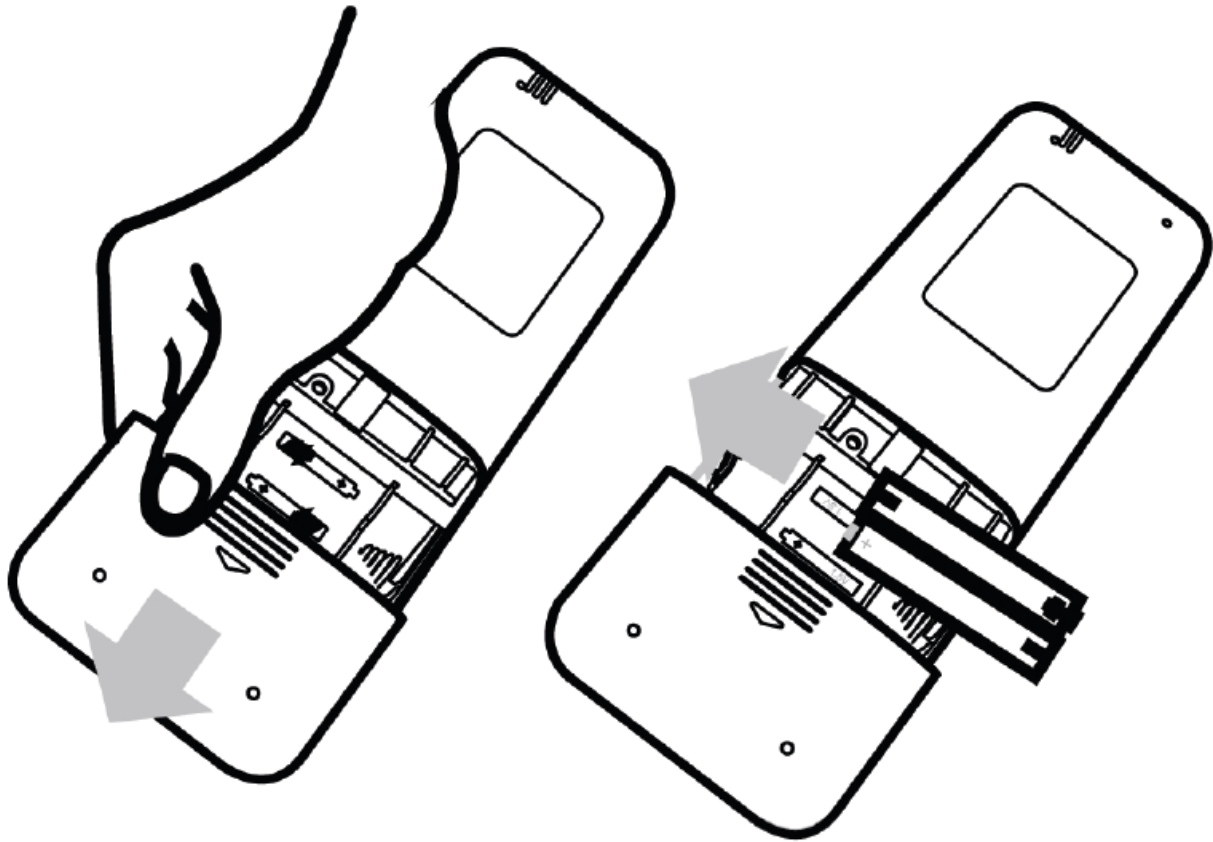

BATTERY NOTES

For optimum product performance:

- Do not mix old and new batteries, or batteries of different types.
- Do not leave batteries in the remote control , if you don't plan on using the device for more than 2 months.

BATTERY DISPOSAL

Do not dispose of batteries as unsorted municipal waste. Refer to local laws for proper disposal of batteries.

TIPS FOR USING REMOTE CONTROL

- The remote control must be used within 8 meters of the unit.
- The unit will beep when remote signal is received.
- Curtains, other materials and direct sunlight can interfere with the infrared signal receiver.
- Remove batteries if the remote will not be used more than 2 months.

CAUTIONS FOR USING REMOTE CONTROL

The device could comply with the local national regulations.

- In Canada, it should comply with CAN ICES-3(B)/NMB-3(B).

In USA, this device complies with part 15 of the FCC Rules. Operation is subject to the following two

conditions:

FCC STATEMENT

1. This device may not cause harmful interference and
2. this device must accept any interference received, including interference that may cause undesired operation.

This equipment has been tested and found to comply with the limits for a Class B digital device, pursuant to part 15 of the FCC Rules. These limits are designed to provide reasonable protection against harmful interference in a residential installation. This equipment generates, uses and can radiate radio frequency energy and, if not installed and used in accordance with the instructions, may cause harmful interference to radio communications. However, there is no guarantee that interference will not occur in a particular installation. If this equipment does cause harmful interference to radio or television reception, which can be determined by turning the equipment off and on, the user is encouraged to try to correct the interference by one or more of the following measures:

- Reorient or relocate the receiving antenna.
- Increase the separation between the equipment and receiver.
- Connect the equipment into an outlet on a circuit different from that to which the receiver is connected.
- Consult the dealer or an experienced radio/TV technician for help.
- Changes or modifications not expressly approved by the party responsible for compliance could void user's authority to operate the equipment.

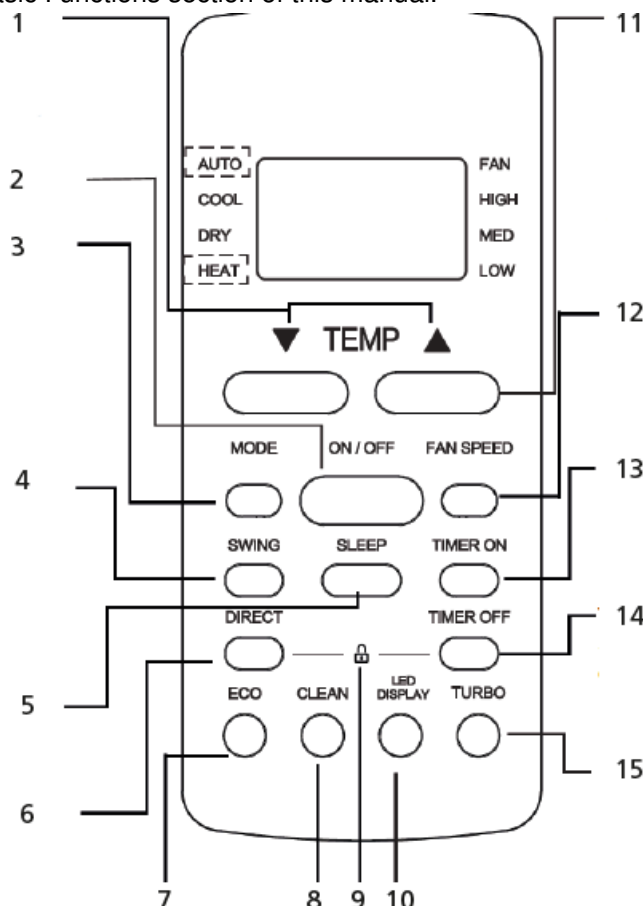

BUTTONS AND FUNCTIONS

Before you begin using your new air conditioner, make sure to familiarize yourself with its remote control. The following is a brief introduction to the remote control itself. For instructions on how to operate your air conditioner, refer to the How to Use Basic Functions section of this manual.



1. TEMP  : Decreases temperature in 1°C (1°F) increments. Min. temperature is 16°C (60°F).
2. ON/OFF: Turns the unit on or off.
3. MODE: Scrolls through operation modes as follows: AUTO -> COOL -> DRY -> HEAT -> FAN
NOTE: Cooling only models do not have AUTO and HEAT mode.
4. SWING: Starts and stops the horizontal louver movement. Hold down for 2 seconds to initiate vertical louver auto swing feature(some units) .
5. SLEEP: Saves energy during sleeping hours .
6. DIRECT: Use to set airflow direction.
7. ECO: Use to enter the energy efficient mode.
8. CLEAN: Used to start/stop the Self Clean or Active Clean function. (Model dependent, please refer to the USER'S OPERATION & INSTALLATION MANUAL).
9. LOCK: Press together DIRECT & TIMER OFF buttons simultaneously for 5 seconds to lock the keyboard.
Press together the two buttons for 2 seconds to unlock the keyboard.
10. LED DISPLAY: Turns indoor unit's LED display and air conditioner buzzer on and off (model dependent), which create a comfortable and quiet environment.

11. TEMP  : Increases temperature in 1°C (1°F) increments. Max. temperature is 30°C (86°F).

NOTE: Press together  &  buttons at the same time for 3 seconds will alternate the temperature display between the °C & °F.

12. FAN SPEED: Selects fan speeds in the following order: AUTO -> LOW -> MED -> HIGH
13. TIMER ON: Sets timer to turn unit on (see How to Use Basic Functions for instructions).
14. TIMER OFF: Sets timer to turn unit off (see How to Use Basic Functions for instructions).
15. TURBO: Enables unit to reach preset temperature in shortest possible time.

REMOTE SCREEN INDICATORS

Information are displayed when the remote controller is power up.

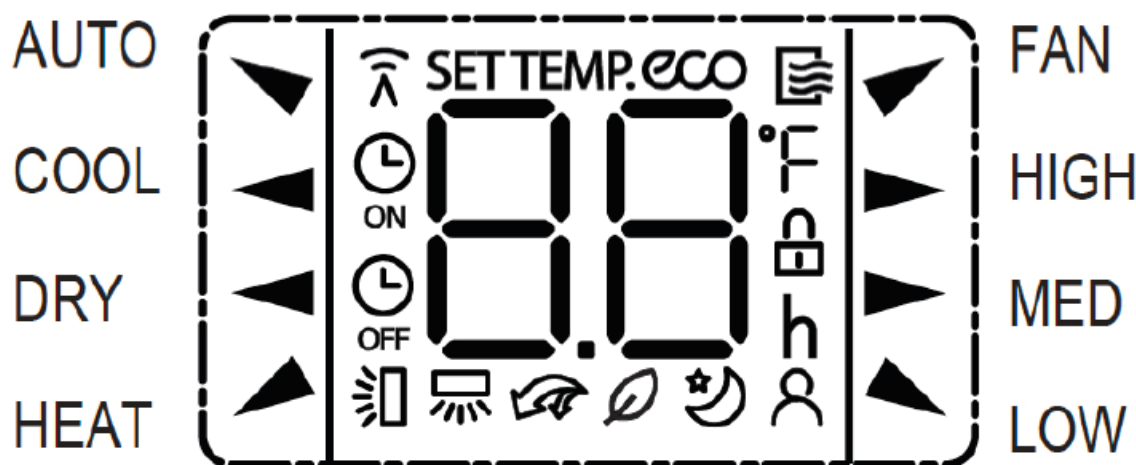

Mode display:

AUTO
HEAT

COOL
FAN

DRY



Displayed when data transmitted.



Displayed when remote controller is ON.



Displayed when TIMER ON time is set.



Displayed when TIMER OFF time is set.



Shows set temperature or room temperature, or time under TIMER setting.



Displayed when ECO feature is activated (some units).



Indicated all the current settings are locked.



Displayed when Follow Me feature is activated(some units).



Displayed when SLEEP feature is activated



Displayed when FRESH feature is activated(some units).



Displayed when TURBO feature is activated.





Horizontal louver auto swing display.



Vertical louver auto swing display(some units).

Fan speed indication:

- HIGH  High speed
- MED  Medium speed
- LOW  Low speed
- NO display Auto fan speed

NOTE: All indicators shown in the figure are for the purpose of clear presentation. But during the actual operation, only the relative function signs are shown on the display window.

HOW TO USE BASIC FUNCTIONS

Basic operation

ATTENTION! Before operation, please ensure the unit is plugged in and power is available.

SETTING TEMPERATURE

The operating temperature range for units is 16-30°C (60-86°F)/20-28 C(68-82°F). You can increase or decrease the set temperature in 1°C (1°F) increments.

AUTO MODE

In AUTO mode, the unit will automatically select the COOL, FAN, or HEAT operation based on the set temperature.

1. Press the MODE button to select AUTO.

2. Set your desired temperature using the TEMP ▲ or TEMP ▼ button.

3. Press the ON/OFF button to start the unit.

NOTE: FAN SPEED can't be set in AUTO mode.

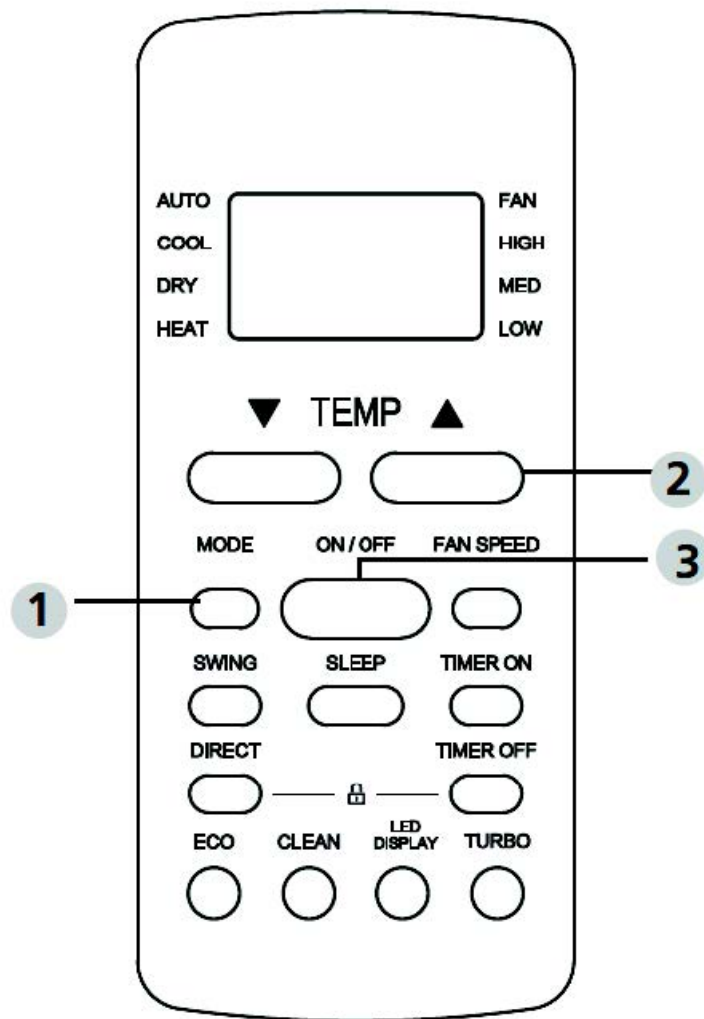

COOL MODE

1. Press the MODE button to select COOL mode.

2. Set your desired temperature using the TEMP ▲ or TEMP ▼ button.

3. Press FAN button to select the fan speed: AUTO, LOW, MED or HIGH.

4. Press the ON/OFF button to start the unit.

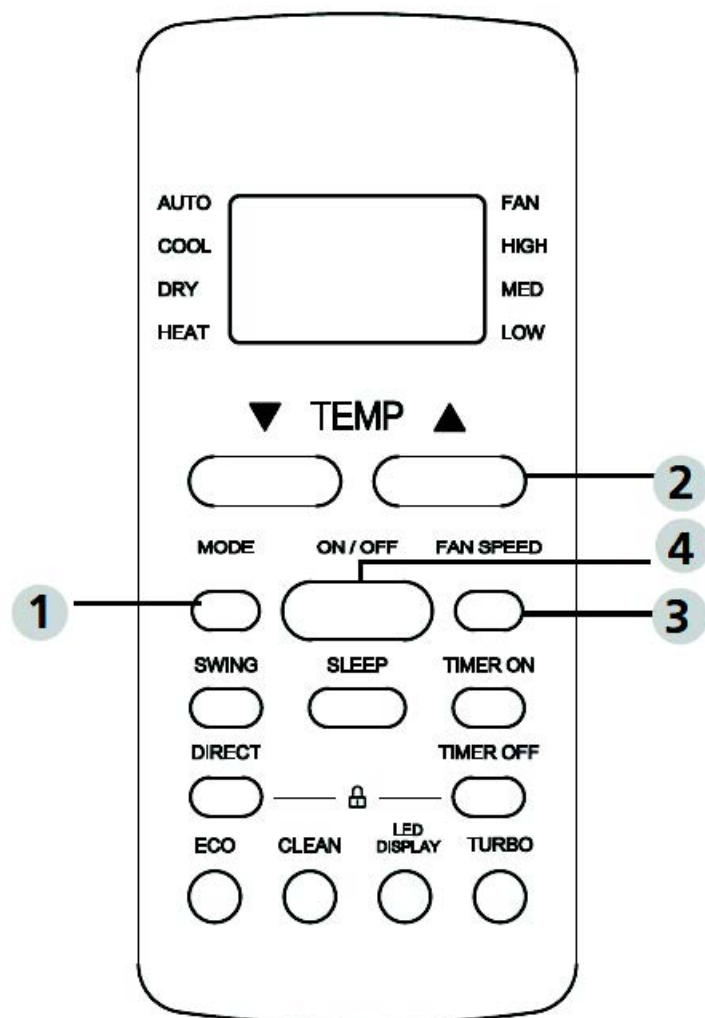

DRY MODE (DEHUMIDIFYING)

1. Press the MODE button to select DRY.

2. Set your desired temperature using the TEMP ▲ or TEMP ▼ button.

3. Press the ON/OFF button to start the unit.

NOTE: FAN SPEED cannot be changed in DRY mode.

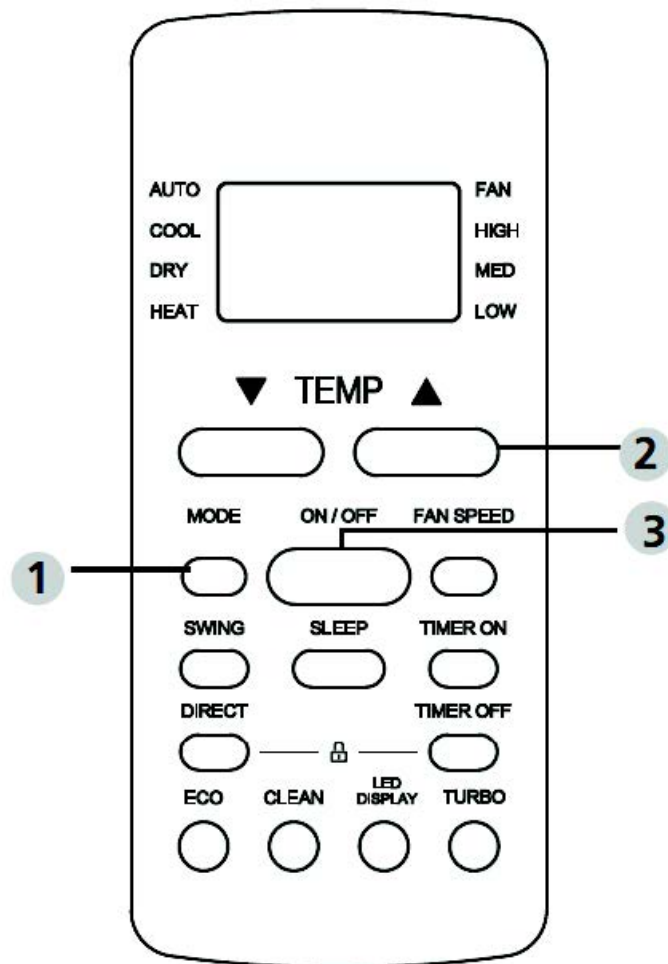

FAN MODE

1. Press the MODE button to select FAN mode.
2. Press FAN button to select the fan speed: AUTO, LOW, MED or HIGH.
3. Press the ON/OFF button to start the unit.

NOTE: You can't set temperature in FAN mode. As a result, your remote control's LCD screen will not display temperature.

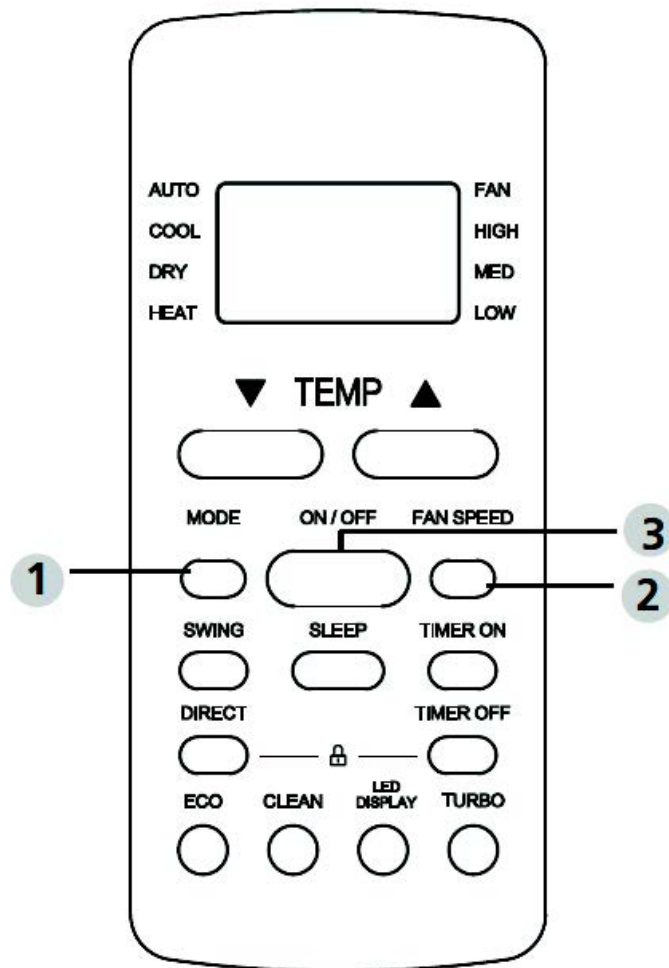

HEAT MODE

1. Press the MODE button to select HEAT mode.
2. Set your desired temperature using the TEMP ▲ or TEMP ▼ button.
3. Press FAN button to select the fan speed:
AUTO, LOW, MED or HIGH.
4. Press the ON/OFF button to start the unit.

NOTE: As outdoor temperature drops, the performance of your unit's HEAT function may be affected. In such instances, we recommend using this air conditioner in conjunction with other heating appliances.

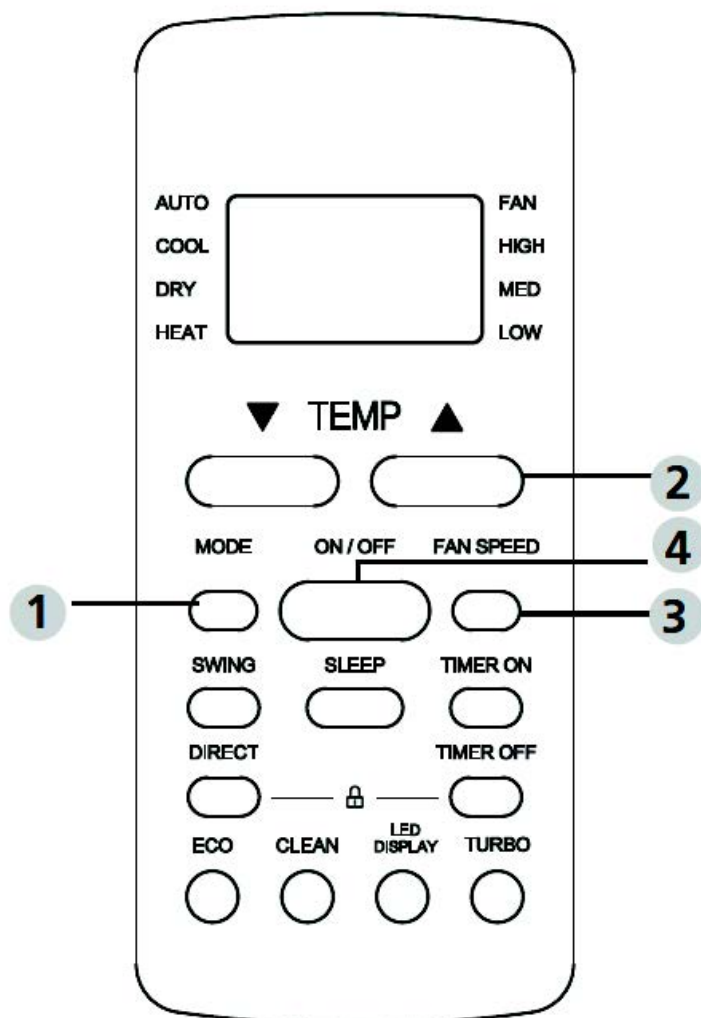

Setting the TIMER

TIMER ON/OFF – Set the amount of time after which the unit will automatically turn on/off.

TIMER on setting

1. Press TIMER ON button to initiate the ON time sequence.
2. Press Temp. up or down button for multiple times to set the desired time to turn on the unit.
3. Point remote to unit and wait 1sec, the TIMER ON will be activated.

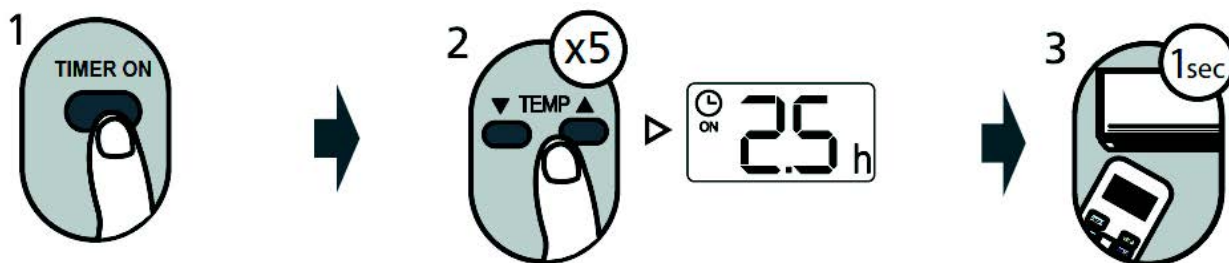

TIMER off setting

4. Press TIMER OFF button to initiate the OFF time sequence.
5. Press Temp. up or down button for multiple times to set the desired time to turn off the unit.
6. Point remote to unit and wait 1sec, the TIMER OFF will be activated.

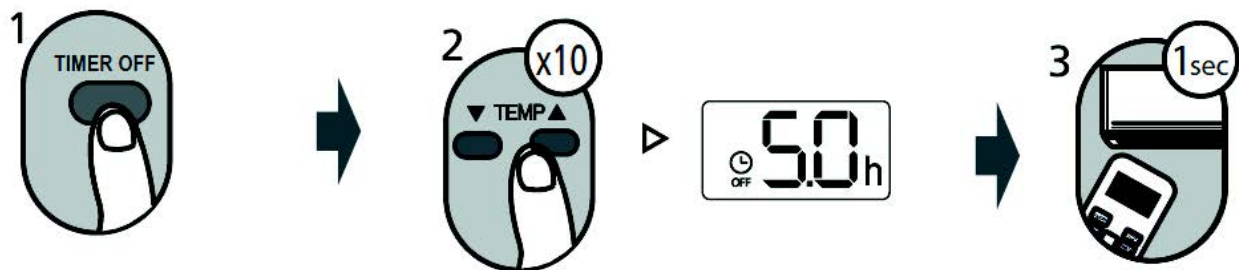

NOTE:

7. When setting the TIMER ON or TIMER OFF, the time will increase by 30 minutes increments with each press, up to 10 hours. After 10 hours and up to 24, it will increase in 1 hour increments. (For example, press 5 times to get 2.5h, and press 10 times to get 5h.) The timer will revert to 0.0 after 24.
8. Cancel either function by setting its timer to 0.0h.

TIMER ON & OFF setting(example)

Keep in mind that the time periods you set for both functions refer to hours after the current time.

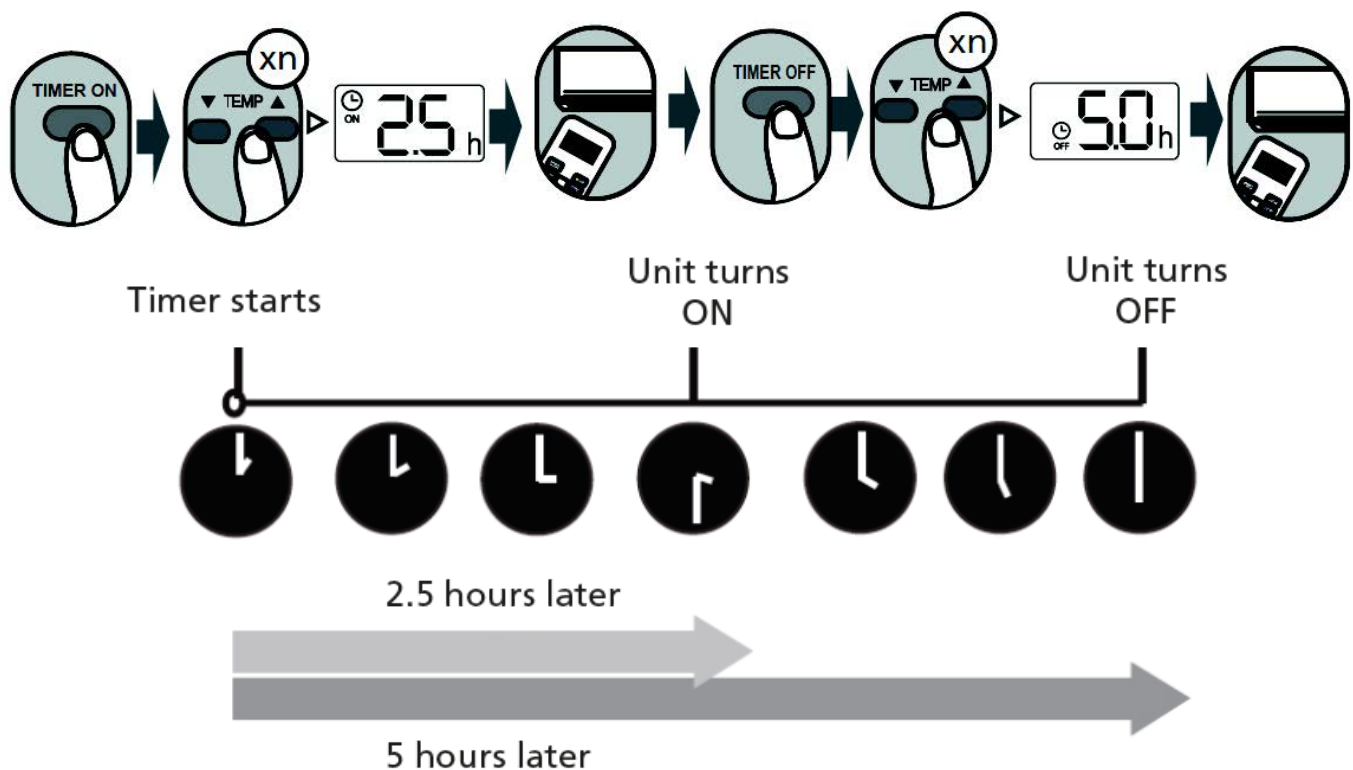

Example: If current timer is 1:00PM, to set the timer as above steps, the unit will turn on 2.5h later (3:30PM) and turn off at 6:00PM.

HOW TO USE ADVANCED FUNCTIONS

Swing function

- Press Swing button
- The horizontal louver will swing up and down automatically when pressing Swing button. Press again to make it stop.
- Keep pressing this button more than 2 seconds, the vertical louver swing function is activated.(Model dependent)

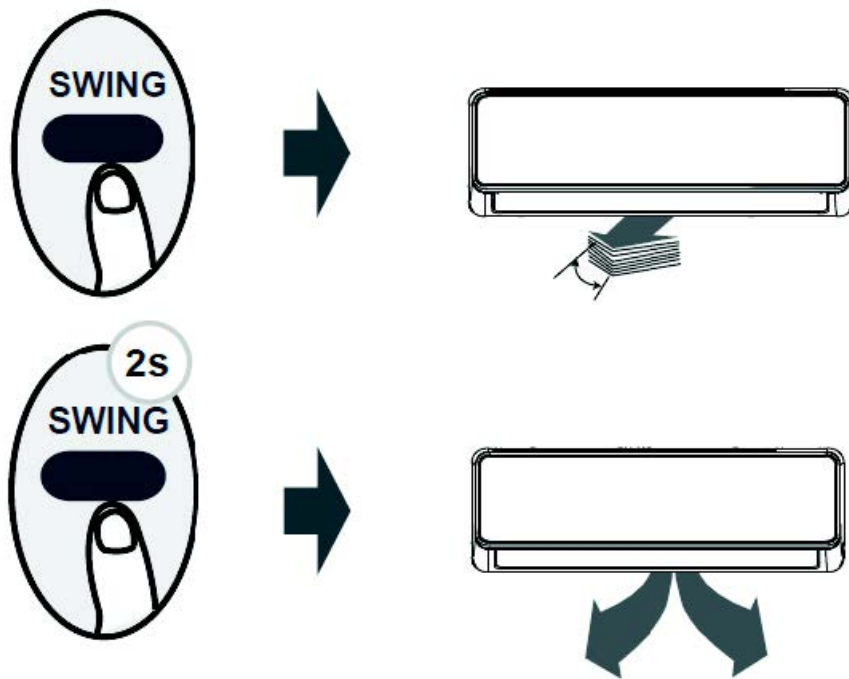

Airflow function

- Each time you press the button, it will adjust the louver by 6 °. Press the button until the direction you prefer is reached.

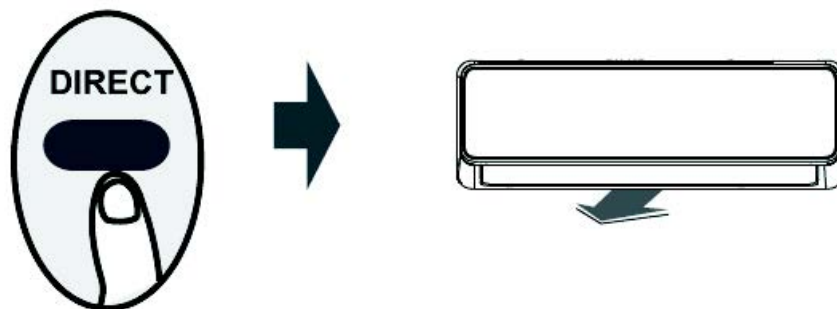

LED DISPLAY

Press this button to turn on and turn off the display on the indoor unit.

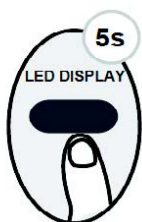

Keep pressing this button more than 5 seconds, the indoor unit will display the actual room temperature. Press more than 5 seconds again will revert back to display the setting temperature.



ECO function (some units)

Press this button under COOL Mode to enter the energy efficient mode. Note: This function is only available under COOL mode.

Under cooling mode, press this button, the remote controller will adjust the temperature automatically to 24 C/75 F, fan speed of Auto to save energy (only when the set temperature is less than 24°C/75°F). If the set temperature is above 24°C/75°F, press the ECO button, the fan speed will change to Auto, the set temperature will remain unchanged.

NOTE:

Pressing the ECO button, or modifying the mode or adjusting the set temperature to less than 24°C/75°F will stop ECO operation.

Under ECO operation, the set temperature should be 24°C/75°F or above, it may result in insufficient cooling. If you feel uncomfortable, just press the ECO button again to stop it.



SHORTCUT function (Some units)

- Used to restore the current settings or resume previous settings.
- Push this button when remote controller is on, the system will automatically revert back to the previous settings including operating mode, setting temperature, fan speed level and sleep feature(if activated).
- If pushing more than 2 seconds, the system will automatically restore the current operation settings including operating mode, setting temperature, fan speed level and sleep feature (if activated).

SLEEP function



- Push this button when remote controller is on, the system will automatically revert back to the previous settings including operating mode, setting temperature, fan speed level and sleep feature(if activated).
- If pushing more than 2 seconds, the system will automatically restore the current operation settings including operating mode, setting temperature, fan speed level and sleep feature (if activated).



Silence function

- Keep pressing Fan button for more than 2 seconds to activate/disable Silence function(some units).
- Due to low frequency operation of compressor, it may result in insufficient cooling and heating capacity. Press ON/OFF, Mode, Sleep, Turbo or Clean button while operating will cancel silence function.

FP function

- Press this button 2 times during one second under HEAT Mode and setting temperature of 16°C/60°F or 20°C/68°F(some units).
- The unit will operate at high fan speed (while compressor on) with temperature automatically set to 8°C/46°F.

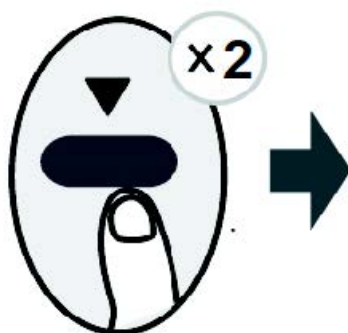

NOTE: This function is for heat pump air conditioner only.

- Press this button 2 times during one second under HEAT Mode and setting temperature of 16°C/60°F or 20°C/68°F(some units) to activate FP function.
- Press On/Off, Sleep, Mode, Fan and Temp. button while operating will cancel this function.



Distributed in Europe by PVG Holding B.V.

If you need information or if you have a problem, please visit the our website (www.qlima.com) or contact our sales support (you find its phone number on www.qlima.com)

PVG Holding BV – Kanaalstraat 12 C – 5347 KM Oss – the Netherlands P.O. Box 96 – 5340 AB Oss – the Netherlands

Documents / Resources

	<p>Qlima SCM52 Remote Control [pdf] Instruction Manual SCM 52 MULTI 1x2.5 - 2x3.2, SCM52 Remote Control, SCM52, Remote Control, Control</p>
---	---

References

- [Q Welcome to Comfortable Living: Explore Qlima's Home Page for Innovative Heating and Cooling Solutions](#)
- [User Manual](#)

Manuals+. [Privacy Policy](#)

This website is an independent publication and is neither affiliated with nor endorsed by any of the trademark owners. The "Bluetooth®" word mark and logos are registered trademarks owned by Bluetooth SIG, Inc. The "Wi-Fi®" word mark and logos are registered trademarks owned by the Wi-Fi Alliance. Any use of these marks on this website does not imply any affiliation with or endorsement.