



Qlima SC46 Series Air Conditioners Instruction Manual

[Home](#) » [Qlima](#) » Qlima SC46 Series Air Conditioners Instruction Manual 

Qlima SC46 Series Air Conditioners Instruction Manual



Contents

1 SAFETY PRECAUTIONS

2 ITEMS PACKED WITH THE UNIT

2.1 ITEMS PACKED WITH THE UNIT (for SC46xx & SC54xx models)

2.2 ITEMS PACKED WITH THE UNIT (for S46xx & S54xx & S-JAxx22 models)

3 ACTIVITIES FOR INSTALLING THE AIR CONDITIONER FOR THE S46XX AND S54XX & S-JAXX22 MODELS

4 DETERMINING THE LOCATION OF THE INSIDE AND OUTSIDE UNIT.

4.1 Determining the location of the inside and outside unit for the S46xx, S54xx & S-JAxx22, SC46xx & SC54xx models.

4.2 Determining the location of the exterior unit for the S46xx, S54xx & S-JAxx22, SC46xx & SC54xx models

5 POSSIBILITIES FOR INSTALLING THE PIPING FROM THE INTERIOR UNIT TO THE EXTERIOR UNIT.

6 MOUNTING THE INSTALLATION PLATE AND MAKING THE PIPING FEED THROUGH.

6.1 Mounting the installation plate of the interior unit.

6.2 Drilling the piping, condensation hose and cable feed-through.

7 CONNECTING THE COOLANT PIPES

7.1 Connecting and disconnecting the coolant pipes for the SC46xx & SC54xx models.

7.2 Connecting the coolant pipes for the S46xx & S54xx & S-JAxx22 models

8 CONNECTION THE CONDENSATION DRAINAGE HOSE FOR THE S46XX & S54XX & S-JAXX22, SC46XX, SC54XX MODELS

8.1 Connection the condensation discharge hose to the interior unit

8.2 Drain joint installation

9 ELECTRICAL WORK

10 CONNECTING THE ELECTRICAL CABLES

10.1 Connecting the electrical cables for the SC46xx & SC54xx models.

10.2 Connecting the electrical cables for the S46xx & S54xx & S-JAxx22 models.

11 EVACUATING THE COOLING SYSTEM OF THE S46XX & S54XX & S-JAXX22 MODELS

12 CHECK FOR COOLANT LEAKAGE FOR THE S46XX, S54XX & S-JAXX22, SC46XX & SC54XX MODELS

13 TOPPING UP COOLANT FOR PIPING LENGTHS ABOVE 05 METRES.

14 TEST RUNNING AFTER INSTALLATION

15 Documents / Resources

15.1 References

SAFETY PRECAUTIONS

The following should be always observed for safety:

- Be sure to read the following **WARNING** before installing the airconditioner.
- Be sure to observe the cautions specified here as they include important items related to safety.
- After reading this instructions, be sure to keep it together with the owners manual in a handy place for future reference.

The air conditioner contains a refrigerant and can be classified as pressurized equipment. Therefore always contact an authorized air conditioning engineer for installation and maintenance of the air conditioner. The air conditioner must be inspected and serviced on an annual base by an authorized air conditioning engineer.



WARNING

Do not install it yourself.

- Incorrect installation could cause injury due to fire, electric shock, the unit falling or leakage of water. Consult your dealer from whom you purchased the unit or an authorised installer.

Install the unit securely in a place which can bear the weight of the unit.

- When installed in an insufficiently strong place, the unit could fall causing injury.

Use the specified electrical wires to connect the indoor and outdoor units securely and attach the wires firmly to the terminal board connecting sections so the stress of the wires is not applied to the sections.

- Incorrect connection and fixing could cause a fire.

Be sure to use the provided or specified parts for the installation work.

- The use of defective parts could cause an injury due to a fire, electric shock, the unit falling, etc.

Perform the installation securely referring to the installation instruction.

- Incorrect installation could cause a personnel injury due to fire, electric shock, the unit falling or leakage of water.

Perform electrical work according to the installation manual and be sure to use an exclusive circuit.

- If the capacity of the power circuit is insufficient or there is incomplete electrical work, it could result in a fire or an electric shock.

Check that the refrigerant gas does not leak during installation or after installation is completed.

- Leaking refrigerant is bad for the environment and could cause global warming.

Attach the electrical part cover to the indoor unit and the service panel to the outdoor unit securely.

- If the electrical part covers off the indoor unit and/ or the service panel of the outdoor unit are not attached securely, it could result in a fire or electrical shock due to dust, water, etc.



CAUTIONS

- This equipment must be earthed. It can possibly cause electrical shock if grounding is not perfect. Do not use an extension cable. Otherwise it can cause electric fire or shock.

- The mains supply in the house must be equipped with an earth leak switch. If it is not equipped with an earth leak switch this could result in electrical shocks and fire.

Perform the drainage/piping work according to the installation instruction.

- If there is a defect in the drainage/piping work, water could leak from the unit and household goods could get wet and be damaged.

ITEMS PACKED WITH THE UNIT

ITEMS PACKED WITH THE UNIT (for SC46xx & SC54xx models)

Number	Name of Accessories	Quantity
1	Installation plate	1
2	Clip Anchor	8
3	Self-tapping screw 'A' ST 3.9×25	8
4	Seal	1
5	Drain joint	1
6	Connecting pipe assembly	1
7	Remote controller	1
8	Self-tapping screw 'B' ST 2.9×10	2
9	Remote controller holder	1
10	Wireless smart kit (*except S-JAxx22)	1

ITEMS PACKED WITH THE UNIT (for S46xx & S54xx & S-JAxx22 models)

Number	Name of Accessories			Quantity
1	Installation plate			1
2	Clip Anchor			8
3	Self-tapping screw 'A' ST 3.9×25			8
4	Seal			1
5	Drain joint			1
6	Connecting pipe assembly	Liquid side	Ø 6.35 (< 6.0 kW model)Ø 9.53 (> 6.0 kW model)	Not included
		Gas side	Ø 9.53 (< 3.5 kW model)	
			Ø 12.7 (≥ 3.5 kW model)Ø 16.0 (≥ 6.0 kW model)	
7	Remote controller			1
8	Self-tapping screw 'B' ST 2.9×10			2
9	Remote controller holder			1
10	Wireless smart kit (*except S-JAxx22)			1



NOTE!

Except the above provided parts, the other parts needed during installation are to be purchased separately by the buyer of the air conditioner.

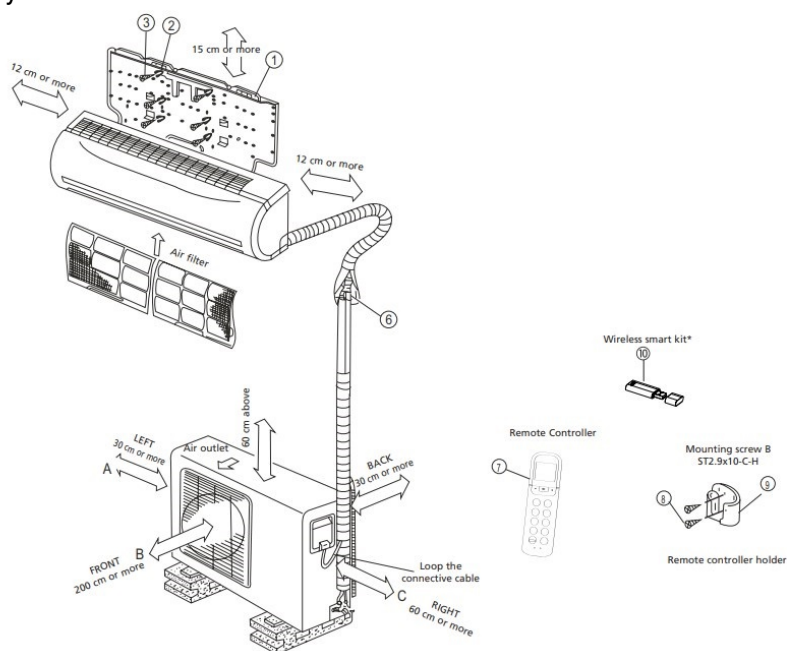



ATTENTION

This illustration is for explanation and indication purposes only. The illustration may be different from the air conditioner you purchased.

a. Decide where to position the indoor and outdoor unit. See chapter 5 and 6.



CAUTION

- Keep in mind where the condensation can be drained off to.
 - The distance between indoor and outdoor unit can be max. 4 m (the length of the piping).
- b. Fit the Installation Plate for the indoor unit. See chapter 7.1
- c. Drill a hole to outside that the piping can be fed through. See chapter 7.2.
- d. Feed the piping from the interior unit through the hole in the wall and hang the interior unit, using the hooks on the back, to the topmost hooks on the installation plate and confirm that the unit is properly attached. Do not click the bottom hooks in yet.



The piping package, coupled to the interior unit, is heavy. Never let the piping package hang freely from the interior unit. Support the whole piping package during installation of the interior unit. The weight of the piping package can cause the piping on the interior unit to bend and even break. Damage to the piping on the interior unit is caused by unprofessional installation and are not covered by the guarantee.

Bending the refrigerant piping at the back of the unit needs to be done with the highest care! The piping consists of copper. When bending the highlighted part more than 1 time the Copper will start cracking due to a physical process. Cracking can cause leakage refrigerant leakage and is not covered by the warranty. See picture 2

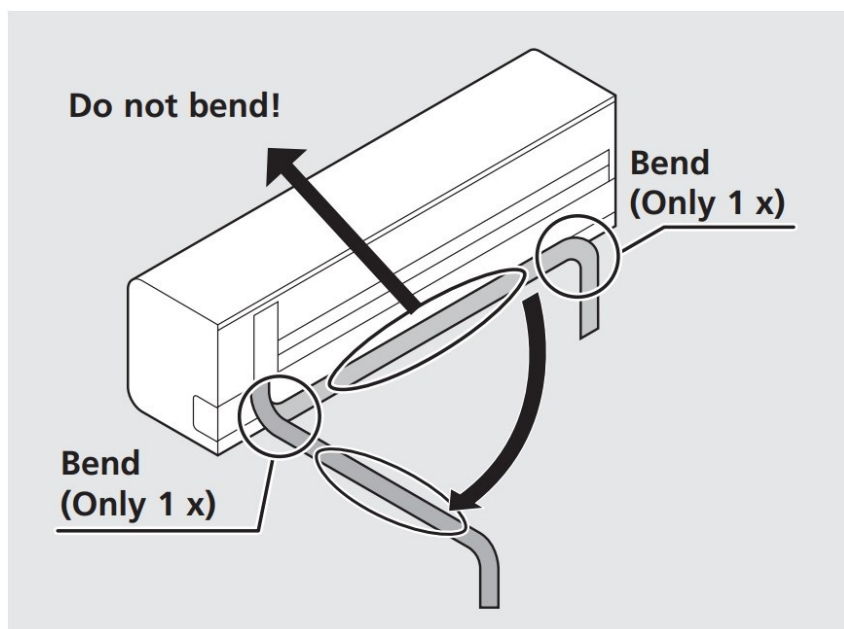

e. Feed the condensation hose through the hole in the wall and connect it to the hose which is installed on the interior unit. See chapter 9.1.



TIP

The condensation hose can be more easily attached by pulling the bottom of the interior unit about 5 cm from the wall and putting something temporarily between it and the wall so that the gap remains open. See **figure 3**.

- f. Now click the bottom hooks to of the interior unit to the mounting plate.
- g. Position the exterior unit see chapter 5.2
- h. Connect the quick connector coupling with the coupling on the exterior unit. Then connect the power cable with the earth wire to the interior and exterior unit. See chapter 8.
- i. Check the air conditioner for any cooler liquid leakage. See chapter 13.
- j. Check that the air conditioner is properly installed.
- k. Connect the plug of the power supply cable to the power supply and check that the air conditioner is working properly. See chapter 11.1.

ACTIVITIES FOR INSTALLING THE AIR CONDITIONER FOR THE S46XX AND S54XX & S-JAXX22 MODELS

- a. Determine the location where the interior unit and exterior unit can be installed. See chapter 5 and 6.
- b. Mount the mounting plate of the interior unit. See chapter 7.1.
- c. Drill a hole to outside that the lines can be fed through. See chapter 7.2.
- d. Hang the interior unit, by the hooks on the back, on the top hooks of the mounting plate and check that it is securely mounted. Do not click the bottom hooks in yet.



CAUTION

if the piping is exiting the unit behind on the right then the piping must be fed through the drilled hole at the same time as hanging the interior unit.

e. Feed the piping, the power cable and the condensation hose through the hole in the wall.



TIP

The piping, power cable and condensation hose can be attached easier by pulling the bottom of the interior unit about 5 cm from the wall and temporarily inserting something so that the gap stays open, see **figure 3**.

f. Connect the coolant pipes, the power cables and the condensation hose to the interior unit. See chapter 8.2, 9, 10 and 11.2.

g. Position the exterior unit see chapter 5.2

h. Connect the piping and the power cable to the exterior unit. See chapter 11.2.

i. Vacuum the cooling unit. See chapter 12.

j. Check the cooling circuit for leakages. See chapter 13.

k. Check that the entire system is properly installed.

l. Connect the plug of the power supply cable to the power supply and check that the air conditioner is working properly. See chapter 15.

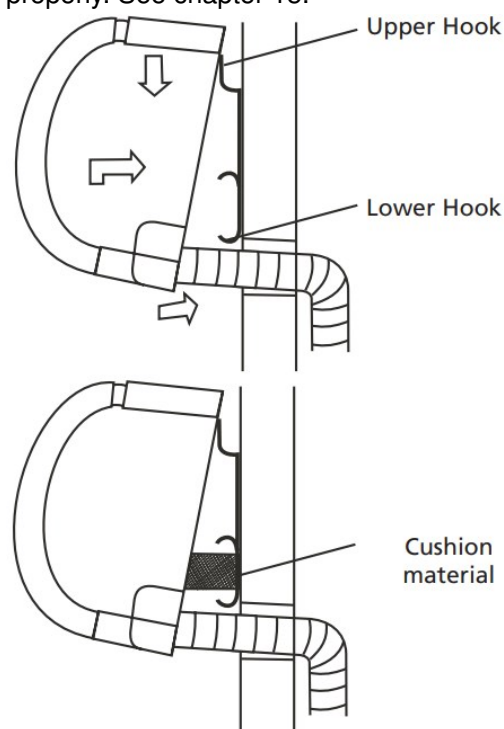

DETERMINING THE LOCATION OF THE INSIDE AND OUTSIDE UNIT.

Determining the location of the inside and outside unit for the S46xx, S54xx & S-JAxx22, SC46xx & SC54xx models.

- Do not expose the indoor unit to heat or steam.
- Select a place where there are no obstacles in front or around the unit.
- Make sure that condensation drainage can be conveniently routed away continuously going downwards.
- Do not install near a doorway.
- Ensure that the space on the left and right of the unit is more than 12cm.

- Use a wire detector to detect wires and/or electric cables. to locate studs to prevent unnecessary damage to the wall.
- The top of the indoor unit should be installed on the wall at a height of 2.3 metres or more from the floor.
- The indoor unit should be installed allowing a minimum clearance of 15cm from the ceiling.
- Be sure to level the indoor unit.
- When determining the location of the interior unit take the possible locations of the exterior unit



TAKE CARE

For the SC46xx & SC54xx models: The length of the piping is 4 metres. For the S46xx & S54xx & S JAx22 models: For units with a capacity of up to 6.0 kW, the maximum pipe length between the inside and the outside part is 20 metres. For units with a capacity > 6.0 kW, the maximum pipe length between the inside and the outside part is 30 metres.

For units with a capacity of up to 6.0 kW, the maximum difference in height between the inside and the outside part is 8 metres. For units with a capacity > 6.0 kW, the maximum difference in height between the inside and the outside part is 20 metres.

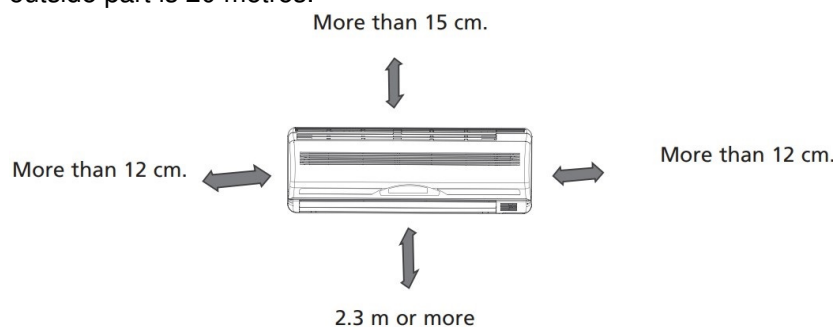

Determining the location of the exterior unit for the S46xx, S54xx & S-JAx22, SC46xx & SC54xx models

- Install the outdoor unit on a rigid base to prevent increasing noise level and vibration.



NOTE

The outdoor unit produces sound when in use, this could interfere with local legislation. It is the responsibility of the user to check and to make sure the equipment is in full compliance with local legislation.

- Determine the air outlet direction where the drained air is not blocked.
- Take the air conditioner weight into account.
- If an awning is built over the outdoor unit to prevent direct sunlight or rain exposure, make sure that heat radiation from the condenser is not restricted.
- Ensure that the clearance around the back of the unit is more than 30 cm and left side is more than 30 cm. The front of the unit should have more than 200 cm of clearance and the connection side (right side) should have more than 60 cm of clearance. See picture 5.

- Be sure to level the outdoor unit

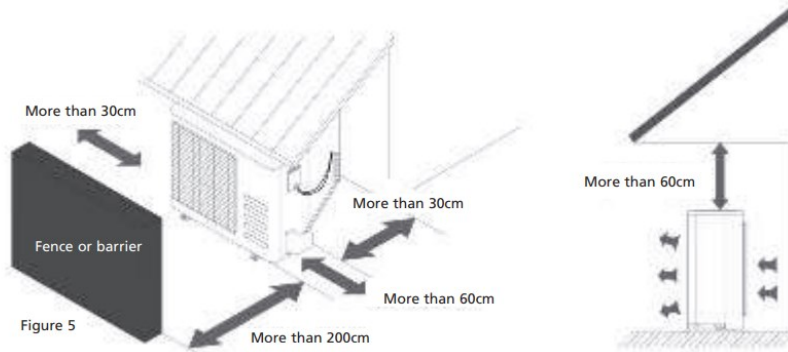
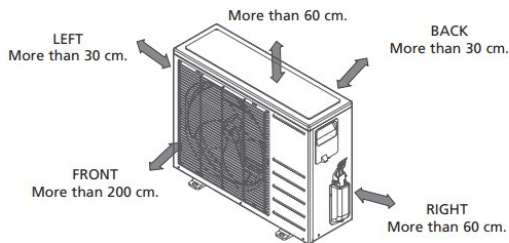

- When determining the location of the exterior unit take into account the possible location of the interior unit.
The interior and exterior units must be connected by pipes and cables.



TAKE CARE

For the SC46xx & SC54xx models: The length of the piping is 4 metres. For the S46xx & S54xx & S-JAxx22 models: For units with a capacity of up to 6.0 kW, the maximum pipe length between the inside and the outside part is 20 metres. For units with a capacity > 6.0 kW, the maximum pipe length between the inside and the outside part is 30 metres.

For units with a capacity of up to 6.0 kW, the maximum difference in height between the inside and the outside part is 8 metres. For units with a capacity > 6.0 kW, the maximum difference in height between the inside and the outside part is 20 metres.

- Do not place animals and plants or other obstacles in the path of the air inlet or outlet.
- Always install the air conditioner at an easily accessible location.
- Consult and follow local legislation regarding mounting and installation of air conditioner equipment.
- In the case that the installation place is exposed to strong wind such as a seaside, make sure the fan is operating properly by putting the unit lengthwise along the wall or using a dust or shield plates. See picture 6.

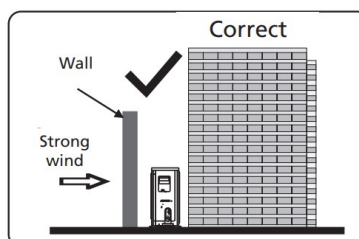
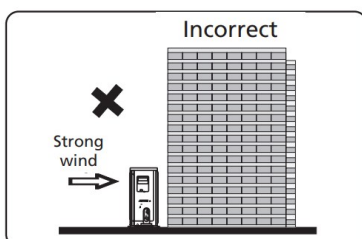

- If the exterior unit is installed on a roofing structure or exterior wall then it can result in bothersome noise and vibrations.
- Ensure that the exterior unit can be attached to a stable substructure.



ATTENTION

If need suspending installation, the installation bracket should accord with all technical requirements. The installation wall should be strong enough or actions to reinforce should be taken. The connection between bracket and wall, bracket and the air conditioner should be firm, stable and reliable. In case of any doubts or uncertainty do not attempt to install the unit but have the support calculated and engineered by a skilled engineer.

POSSIBILITIES FOR INSTALLING THE PIPING FROM THE INTERIOR UNIT TO THE EXTERIOR UNIT.

- The piping can be connected exiting from the left rear or right rear of the interior unit. Remove the left or right breakout plate. See figure 7.
- The piping can be connected exiting from the left rear or right rear. See figure 7.

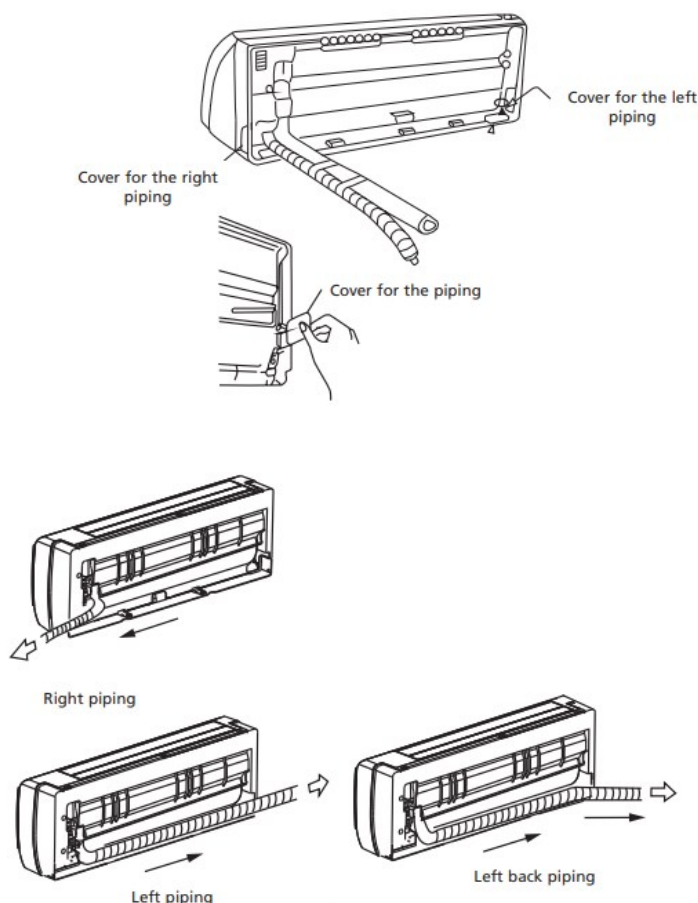

MOUNTING THE INSTALLATION PLATE AND MAKING THE PIPING FEED THROUGH.

Mounting the installation plate of the interior unit.



WARNING!

Use a pipe detector to detect electrical conduits and pipes in the wall before drilling the required holes to prevent unnecessary damage to the wall or dangerous situations.

a. Fit the installation plate horizontally on structural parts of the wall with spaces around the installation plate. See figure 8.

b. If the wall is made of brick, concrete or the like, drill eight (8) 5mm diameter holes in the wall. Insert clip anchor for appropriate mounting screws .

c. Fit the installation plate on the wall with eight (8) type “A” screws .

Correct orientation
of Installation Plate

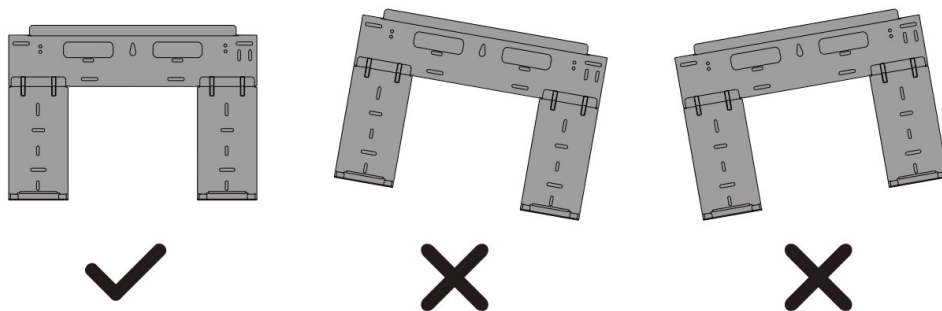

S(C)4626 / S(C)5426

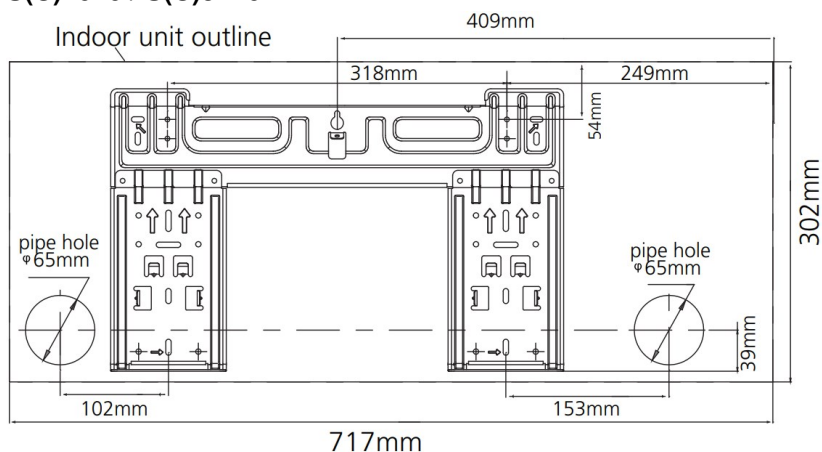

S(C)4635 / S(C)5435

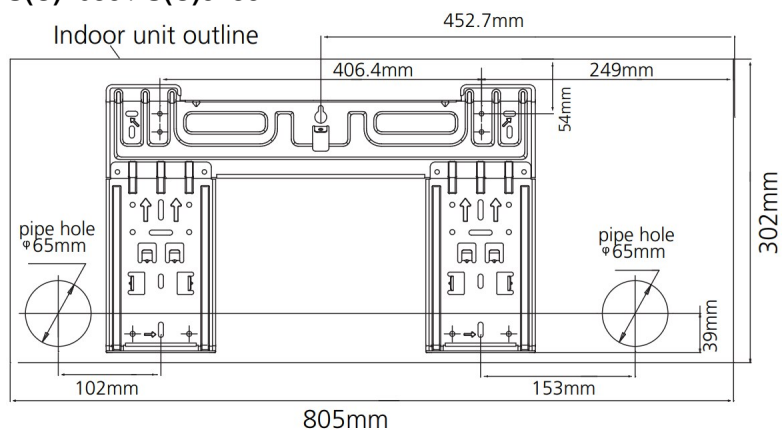

S(C)4653 / S(C)5453

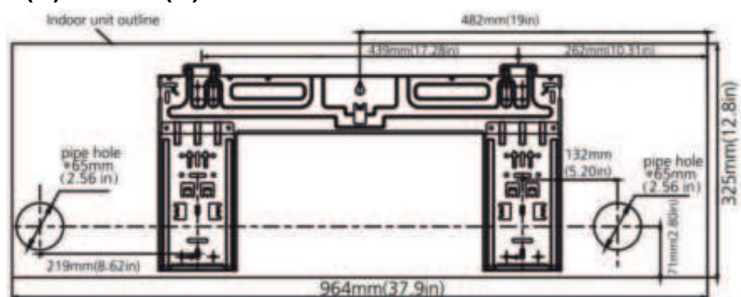

Drilling the piping, condensation hose and cable feed-through.

a. Determine the positions of the holes according to the diagram detailed in Fig. 9. Drill one (1) hole (≥ 85 mm for SC46xx & SC54xx / ≥ 65 mm for S46xx & S54xx & S-JAxx22) slanting slightly downwards to outdoor side, this will prevent water to come indoors (**fig 10**)

b. Always use wall hole conduit when drilling metal grid, metal plate or the like.

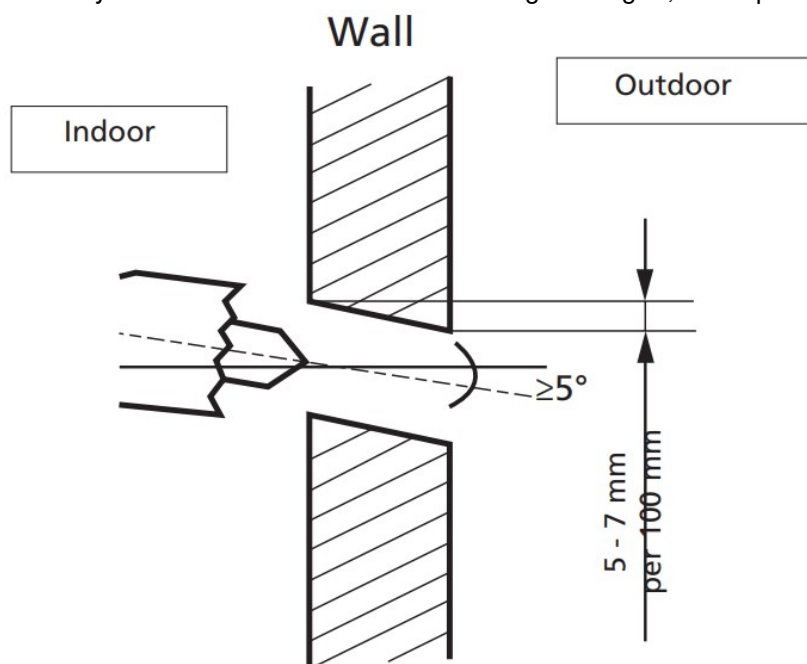

CONNECTING THE COOLANT PIPES

Connecting and disconnecting the coolant pipes for the SC46xx & SC54xx models.



TAKE CARE

Connecting the coolant pipes of an air conditioner must be carried out in accordance with the applicable national regulations and laws. Connecting the coolant pipes may only be carried out by an authorised fitter.



TAKE CARE

The piping package, coupled to the interior unit, is heavy. Never let the piping package hang freely from the interior unit. Support the whole piping package during installation of the interior unit. The weight of the piping package can cause the piping on the interior unit to bend and even break. Damage to the piping on the interior unit due to unprofessional installation and is not covered by the guarantee.



TAKE CARE

For your safety, always wear safety eye wear and work gloves when connecting the pipes. The piping is coupled the interior unit at the factory. Read through the “quick installation guide” to understand how the piping and power cable must be connected to the exterior unit.

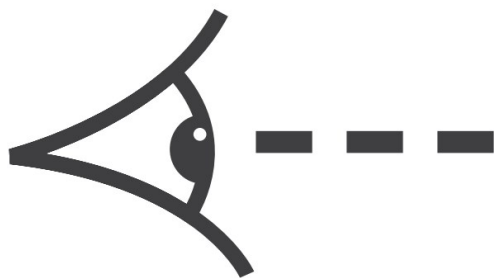
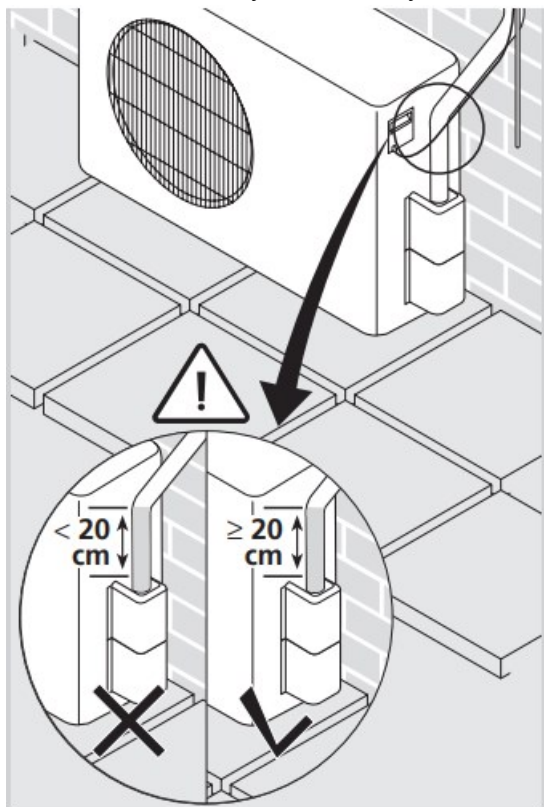

Figure 11



The last 20 cm of the refrigerant pipe, close to the connector must be kept straight. Bending can cause leakage and is not covered by the warranty.



ATTENTION

All refrigerant work and refrigerant piping should comply with the local legislation, standards and codes and should only be done by qualified and skilled people.

To disconnect the couplings:

Step 1: Shut down the A/C unit and unplug the electrical power cord from the wall outlet.

Step 2: Wait five minutes for the line pressure between the indoor compressor unit and outdoor condensing unit to equalize.

Step 3: Pull the male coupling handle up and toward the male coupling to the full back position.

Step 4: Retract the Release Sleeve on the female coupling to release the male coupling half from the female half.

Step 5: To seal and protect from dust, reinstall the protective cap and plug.

Connecting the coolant pipes for the S46xx & S54xx & S-JAxx22 models

a. Fit a gland nut or suchlike to the piping and make a so-called “flare” at the end of the piping.

b. Interior unit: Tighten the gland nut by hand to the piping on the interior unit and then tighten it with a spanner and torque wrench as shown in fig. 13.

c. Exterior unit: Tighten the gland nut by hand to the connections on the valves on the exterior unit and then tighten it with a spanner and torque wrench as shown in **fig. 13**.

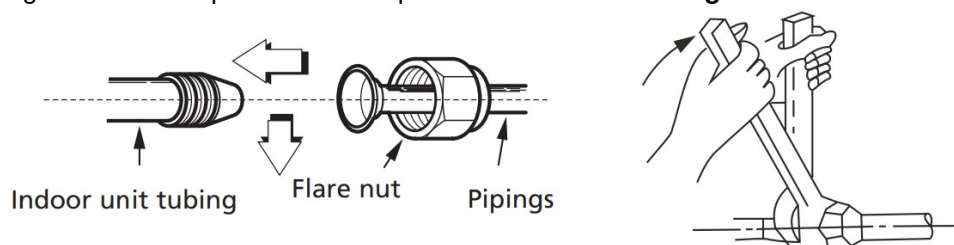

d. Select the correct tightening torque (shown table 1) in order to prevent the pipes, connecting pieces and nuts from being damaged.

Outer diam.	Tightening torque (N.cm)	Additional tightening torque (N.cm)
Ø 6.35	1500(153kgf.cm)	1600(163kgf.cm)
Ø 9.53	2500(255kgf.cm)	2600(265kgf.cm)
Ø 12.7	3500(357kgf.cm).	3600(367kgf.cm)
Ø 16.0	4500(459kgf.cm).	4700(479kgf.cm)

e. Insulate the connection points on the interior section with insulation material to prevent condensation build-up .

f. Wind the piping, connection cable and drain hose, behind the interior unit, with tape so that a firm bundle is formed. This makes it easier to mount the interior unit to the mounting plate

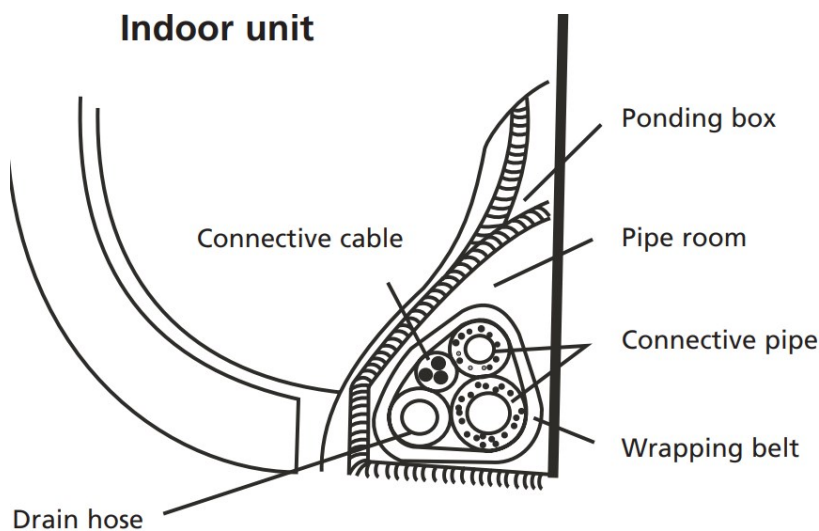

ATTENTION

Copper lines must be insulated independently from each other.



ATTENTION

Always use the highest care when bending the piping. Make sure that the piping always is bent and not buckled. In case of a buckled pipe: replace the complete piping or the buckled part, as this is a potential refrigerant leak and may cause damage to the air conditioner.

CONNECTION THE CONDENSATION DRAINAGE HOSE FOR THE S46XX & S54XX & S-JAXX22, SC46XX, SC54XX MODELS

Connection the condensation discharge hose to the interior unit

Connect the included condensation drainage hose to the interior unit by sliding the hose over the hose nipple on the interior unit. Ensure that the condensation drainage hose always runs downwards and do not hang the end in the water. See fig. 15.

Always run the condensation drainage hose under the coolant pipes to prevent that the condensation tray from overflowing.

CAUTION

- Be sure that the drain hose is located at the lowest side of the bundle. Locating at the upper side can cause drain pan to overflow inside the unit.
- Run the drain hose sloped downward over the whole length to drain out the condensed water smoothly.

Do not block water flow by a rise.

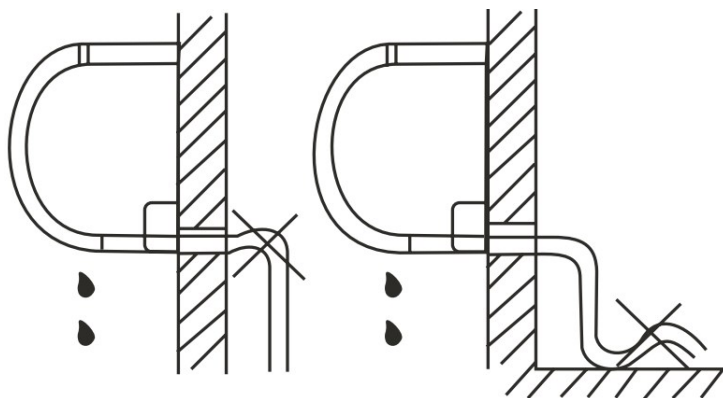

Do not put the end of drain hose into water.

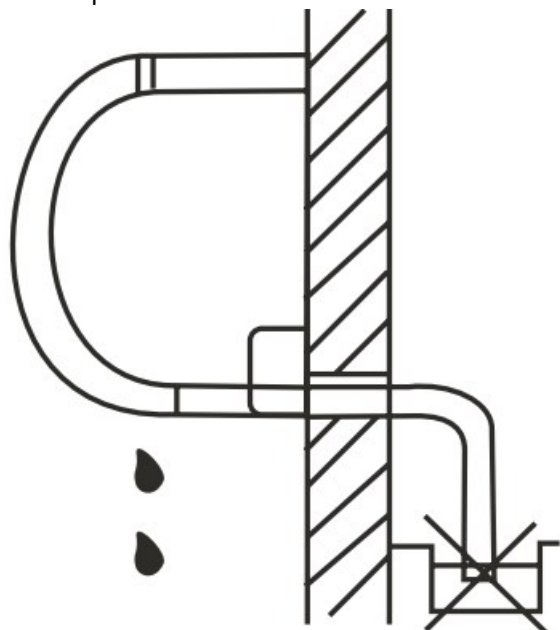

Drain joint installation

Fit the seal into the drain elbow, then insert the drain joint into the base pan hole in the bottom of the outdoor unit, rotate 90° to assemble them securely. Connect the drain joint with an extension drain hose (not included). In this way condensed water, which is produced during heating mode of the air conditioner, can be drained away. **See fig. 16.**

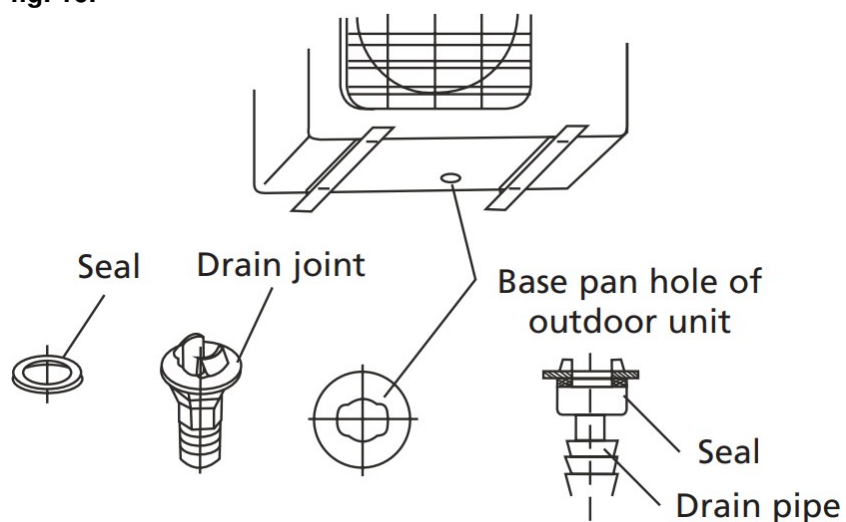

ELECTRICAL WORK

- Connect the air conditioner to a separate group. Ensure that this group has the correct fuse
- See following table.
- Power voltage supplied should be in the range of 95%~105% of rated voltage on rating table.
- The power supply must have an earth leak switch installed.
- Ensure the air conditioner is grounded well.
- Connect the wires according the attached electrical connection diagram located on the panel of the outdoor unit. See chapter 11
- All wiring must comply with local and national electrical standards and codes and be installed by qualified and skilled people.

Model	Power supply	Input Rated Current(Switch/Fuse)	Power cord size
≤ 3,5 kW	230V~50Hz	16A	2,5 mm ²
> 3,5 kW	230V~50Hz	16A slow	2,5 mm ²



NOTE!

The supply voltage should be consistent with the rated voltage of the air conditioner.

CONNECTING THE ELECTRICAL CABLES

Connecting the electrical cables for the SC46xx & SC54xx models.

- a.** 4,5 Meter cable for electrical connection between indoor and outdoor unit is delivered with the package and is included in the refrigerant piping sleeve (indoor unit).
- B.** The electrical cable is provided with an electrical quick connector.
- c.** The outdoor unit is also provided with electrical quick connector.
- d.** Remove the control cover from the outdoor unit by loosening the screw.
- e.** Click the connector of the interior unit into the connector of the exterior unit and secure the cable to the terminal block with the cable clamp mounted on it.
- f.** The earth cable must be connected directly to the metal plate on which the terminal strip is mounted. The location is indicated with the symbol

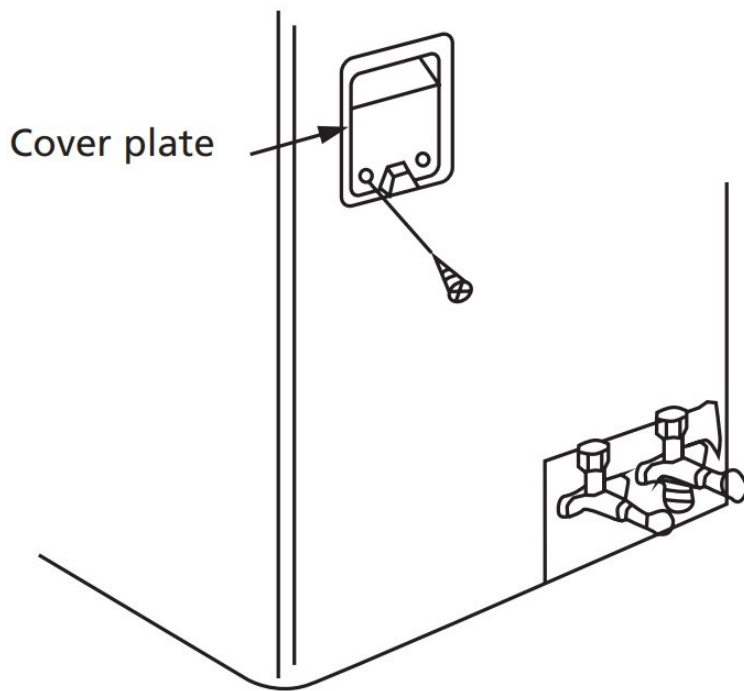

g. Only connect the power supply cable once the entire installation of the air conditioner has been completed.



TAKE CARE

For models with a capacity < 4.5 kW plug the plug into a wall socket. For models with a capacity > 4.5 kW connect the power supply cable directly the power source. Do not use a plug and socket as the high current can damage both the terminals of the plug and the socket and even cause a fire.

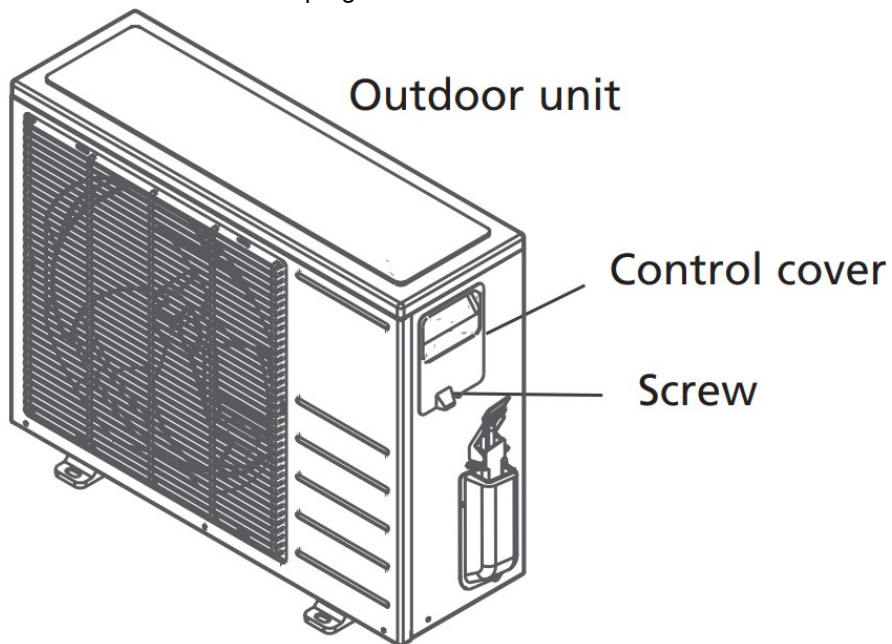

To indoor unit

Outdoor unit

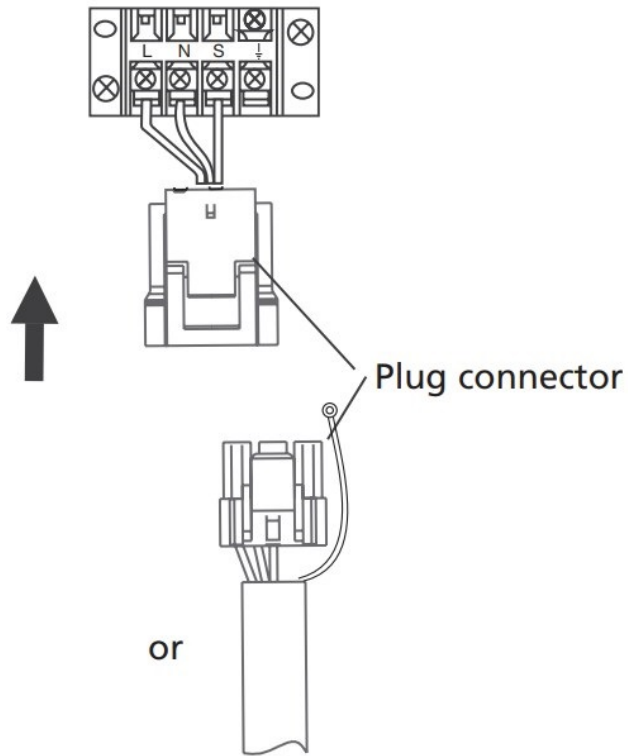

Secure the cable with cord clamp

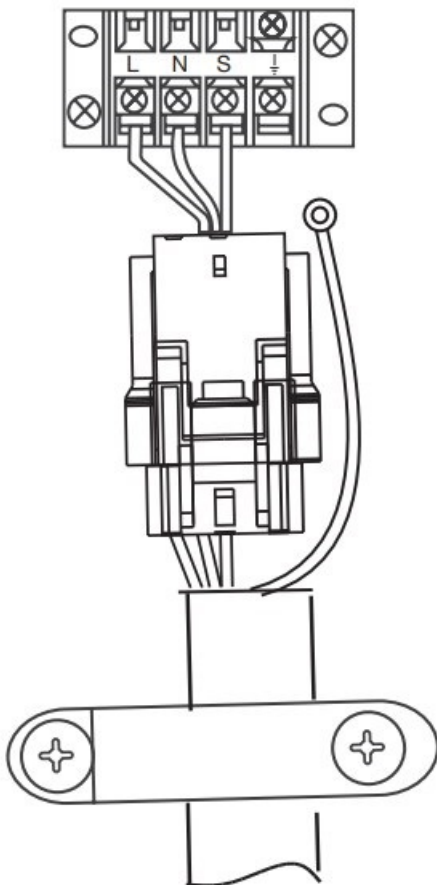

Connecting the electrical cables for the S46xx & S54xx & S-JAxx22 models.

- Connect the cable to the indoor unit
- Indoor/Outdoor connection cable should be H07RN-F type, 2,5 mm².
- To mount the cable to the interior unit: Remove the front panel and the cover plate of the terminal strip on the right hand side of the interior unit. **Figure 19.**

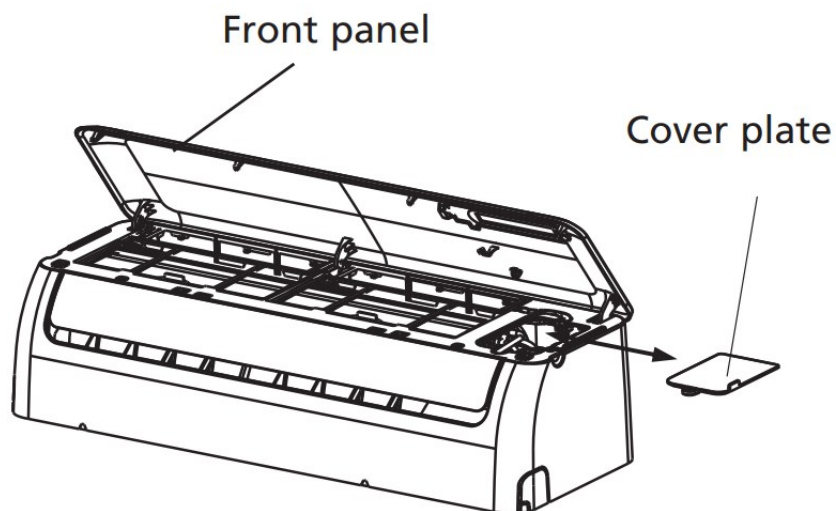

- d. The cable can be fed through from the back of the interior unit to the terminal strip.
 e. Connect the electrical wires to the terminal strip, for the correct location **see fig 20**

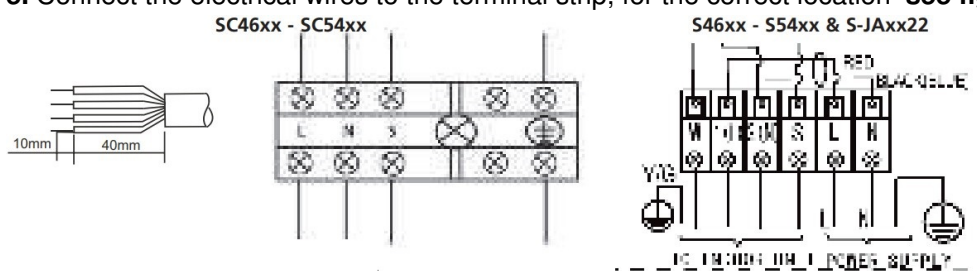

- f. Attach the cable of the indoor unit. Remove the cover plate of the terminal strip of the outdoor unit.
 g. Connect the connection cable to the terminal strip (zie picture 21). Attach the cables so that the position of the wires matches the connection of the cables to the indoor unit (the letters L N S, the earth cable and, for the models with a capacity > 6.0 kW, the numbers 1 + 2).
 h. The earth cable must be connected directly to the metal plate on which the terminal strip is mounted. The location is indicated with the symbol
 i. In models with a capacity of up to 6.0 kW, the supply cable is already preassembled on the inside part. In models with a capacity > 6.0 kW, the supply cable must be connected to the outside part (the supply cable is not included).
 j. Only connect the power supply cable once the entire installation of the air conditioner has been completed.



TAKE CARE

For models with a capacity < 4.5 kW plug the plug into a wall socket.

For models with a capacity > 4.5 kW connect the power supply cable directly the power source. Do not use a plug and socket as the high current can damage both the terminals of the plug and the socket and even cause a fire.

to outdoor unit

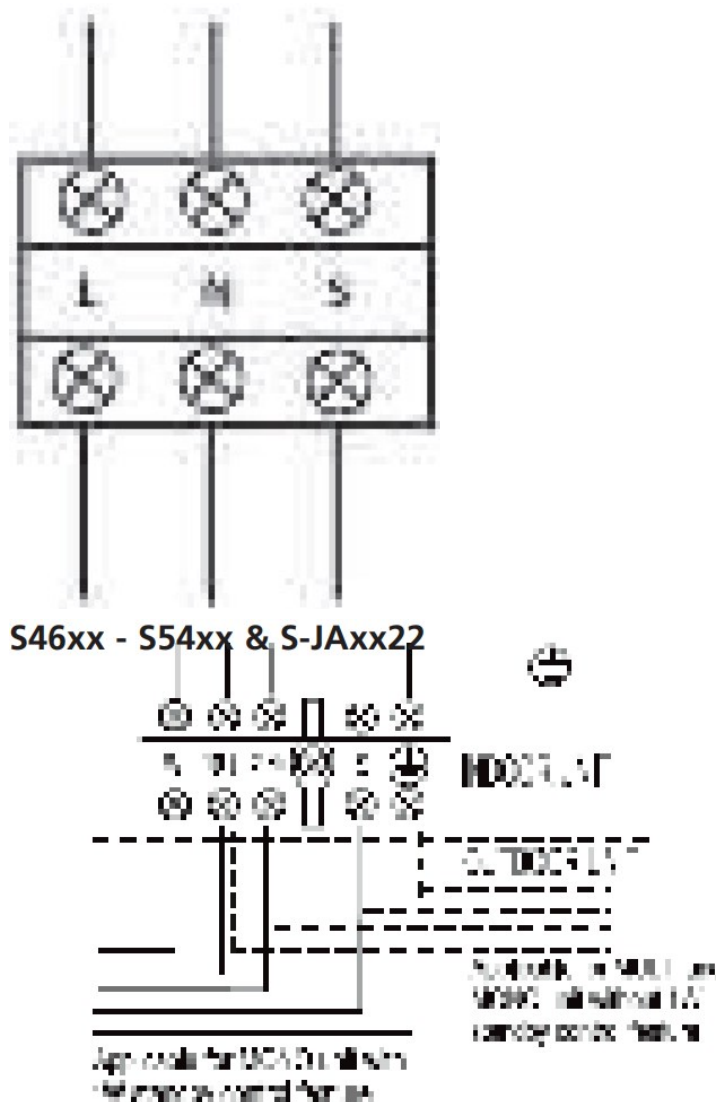

EVACUATING THE COOLING SYSTEM OF THE S46XX & S54XX & S-JAXX22 MODELS

Air and moisture that remain in the refrigerant system, e.g. after installation, can cause undesirable effects or damage as indicated below:

- Pressure in the system rises.
- Operating current rises.
- Cooling or heating efficiency drops.
- Moisture in the refrigerant circuit may freeze and block capillary tubing.
- Water may lead to corrosion of parts in the refrigeration system.
- Damage of the compressor.

Therefore, the indoor unit and tubing between the indoor and outdoor unit must always be leak tested and evacuated with aid of a vacuum pump to remove any noncondensables and moisture from the system.



TAKE CARE

Evacuating the coolant piping and the interior unit of the air conditioner must in accordance with the applicable national regulations and laws. Evacuating the coolant piping and the interior unit may only be carried out by a certified air conditioner fitter.

CHECK FOR COOLANT LEAKAGE FOR THE S46XX, S54XX & S-JAXX22, SC46XX & SC54XX MODELS



TAKE CARE

Evacuating the coolant piping and the interior unit of the air conditioner must be carried out in accordance with the applicable national regulations. The test for coolant leakage of the coolant piping and the interior unit may only be carried out by a certified fitter.

POSSIBILITIES FOR LEAK CHECK AIR CONDITIONER

- Soap water method: Apply a soap water or a liquid neutral detergent on the indoor unit connection or outdoor unit connections by a soft brush to check for leakage of the connecting points of the piping. If bubbles come out, the pipes have leakage.
- Dedicated special leak detector: Use the leak detector to check for leakage.

TOPPING UP COOLANT FOR PIPING LENGTHS ABOVE 05 METRES.



TAKE CARE

Connecting the coolant pipes of an air conditioner must be carried out in accordance with the applicable national regulations and laws. Refilling the coolant may only be carried out by an authorised fitter.

The air conditioner is filled with sufficient coolant at the factory for a pipe length of a maximum of 5 metres. If the coolant piping is longer than 5 metres then the air conditioner must be topped up with extra coolant. The amount of coolant to be added is shown in table 2

Tabel 2

Model	For piping longer than 5 metres Extra filling per meter in grams
2.5 – 2.6 kW	20
3.1 – 3.6 kW	20
4.8 – 5.4 kW	20

Only use coolant of the same type as stated on the type plate.

TEST RUNNING AFTER INSTALLATION

Perform test running after completing electrical safety check and gas leak check.
The test running time should last more than 30 minutes.

Check if all the functions works well during test running. Especially check whether the drainage of indoor unit is smooth or not.

PVG Holding BV – Kanaalstraat 12 C – 5347 KM Oss – the Netherlands P.O. Box 96 – 5340 AB Oss – the Netherlands



Documents / Resources



[Qlima SC46 Series Air Conditioners](#) [pdf] Instruction Manual
SC46 Series, SC54 Series, S46 Series, S54 Series, S-JA 22 Series, SC46 Series Air Conditioners, Air Conditioners

References

- [Q Qlima](#)
- [Q Qlima](#)
- [Q Qlima](#)
- [Q Qlima.fr | Home made climates](#)
- [Q Qlima](#)
- [Q Qlima, dé klimaatspecialist | Comfort in en om het huis](#)
- [Q Qlima](#)