

Qlima FFB105 Rectangular Bio-Ethanol Fire Pit Table User Manual

[Home](#) » [Qlima](#) » Qlima FFB105 Rectangular Bio-Ethanol Fire Pit Table User Manual 

Qlima FFB105 Rectangular Bio-Ethanol Fire Pit Table

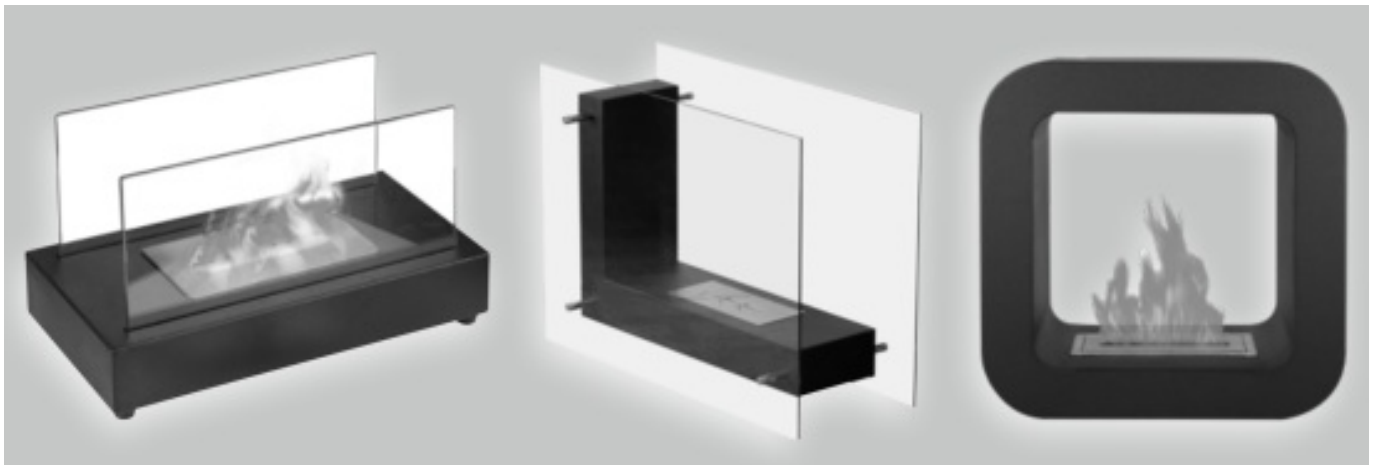

Contents

- [1 SAFETY INSTRUCTION](#)
- [2 USAGE METHODS](#)
 - [2.1 Assembly of the appliance](#)
- [3 CLEANING & MAINTENANCE](#)
- [4 STORAGE](#)
- [5 TROUBLE SHOOTIN](#)
- [6 CONDITIONS OF WARRANTY](#)
- [7 TECHNICAL SPECIFICATION](#)
- [8 Documents / Resources](#)
 - [8.1 References](#)
- [9 Related Posts](#)

SAFETY INSTRUCTION

This document is part of the appliance. Read this user manual carefully before using the appliance and keep it for future reference. This appliance is for decorative and domestic use only. This decorative appliance is designed for out- door use and/or use indoor in amply ventilated areas only. An amply ventilated area must have a minimum of 25% of the surface area open. In this way the gases produced by combustion will be removed by fresh air. The use of this appliance in enclosed areas can be dangerous and is PROHIBITED. The appliance must be installed in accordance with these instructions and with local regulations. This product is only intended to be used as a decorative fire place in normal household conditions as described in this manual.



WARNING

- If the appliance is positioned too close to inflammable materials you may risk fire. Always keep it 1 mtr away from inflammable materials
- The appliance will become hot during operation. Do not cover the device (there is risk of fire).
- Keep away from children



CAUTION – Some parts of this product can become very hot and cause burns. Particular attention has to be given where children and vulnerable people are present, make sure that children are always aware of the presence of a burning fire.

- Do not move the appliance when it is burning or still hot.
- Do not insert hands, fingers or objects into any of the appliance openings.
- Make sure that people and animals keep a 1 mtr safe distance from appliance in order to prevent them from any injury or risk of fire.
- Extinguish the fire when going to sleep.
- Have any repairs and/or maintenance carried out by a recognized service engineer only.
- Read the Directions for Use before using the appliance.
- Install the appliance only if it complies with local regulations, laws and standards.
- Install the appliance according to the instructions as described in the installation section of the directions for use
- This appliance is tested according to European safety standards. Nevertheless, as with any other device, care must be taken.
- Never use the appliance in places where harmful gases or fumes may be present (e.g. exhaust gases or paint fumes).
- This appliance is not intended for use by persons (including children) with reduced physical, sensory or mental capabilities, or lack of experience and knowledge, unless they have been given supervision or instruction concerning use of the appliance by a person responsible for their safety.
- Children should be supervised to ensure that they do not play with the appliance.
- In order to avoid overheating, do not cover the device.
- Be sure the table/floor you are placing this appliance can bear its weight
- Installation only in a location which is protected against cross aeration / air draft
- Convection air slots and rear ventilations of the appliance shall not be covered / obstructed
- Do not put any flammable items on top of the appliance
- This product can NOT be fixed to a wall or roof

USAGE METHODS

Assembly of the appliance

FFB 105 (Fig.1)

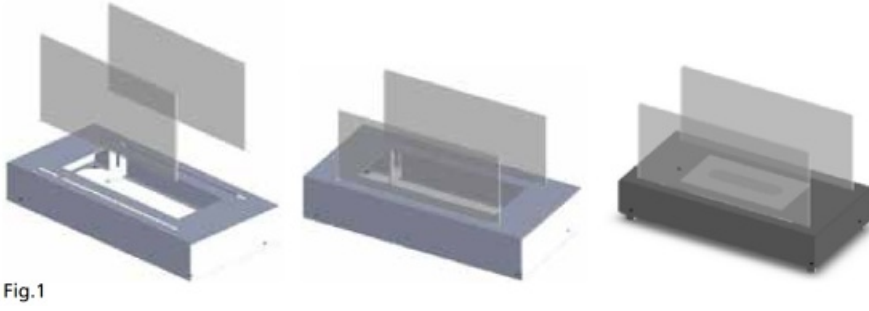

Fig.1

Parts List:

- Fireplace body 1x
- 0.5L burner 1x
- Extinguish cover 1x
- Tempered glass 2x

1. Unpack the fireplace and accessories. Check the content for completeness and any damages incurred in transit. Keep children away from the packing.
2. Only install or place on a solid floor of non-flammable material
3. Remove all packaging and information material before assembly
4. Read warning sticker covering the burner, then remove the sticker
5. If something is broken or damaged: do not use the appliance. Return the appliance to your store immediately
6. Insert the glass into the intended slot (2x)
7. Place the burner into the burning chamber of the fireplace body.

FFB 830 (Fig.2)

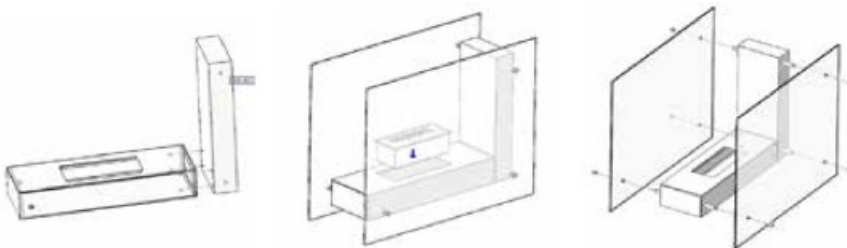

Fig. 2

Parts List:

- Fireplace body 2x
- 0.5L double-layer Burner 1x
- Control tool 1x
- Screws (5 x 30mm) 4x
- Tempered Glass 2x
- Screw (M6 x 10) 6x
- Screw cap 6x

1. Unpack the fireplace and accessories. Check the content for completeness and any damage incurred in transit.
Keep children away from the packing.
2. Only install or place on a solid floor of non-flammable material
3. Remove all packaging and information material before assembly
4. Assemble the fireplace base together and secure the glass onto the both sides of the fireplace body with 6 screws.
5. Read warning sticker covering the burner, then remove the sticker
6. If something is broken or damaged: do not use the appliance. Return the appliance to your store immediately.
7. Place the burner into the burning chamber of the fireplace body.

FFB 4242 (Fig.3)



Fig. 3

Parts List

- Fireplace body 1x
- 0.5L double-layer Burner 1x
- Control tool 1x

1. Unpack the fireplace and accessories. Check the content for completeness and any damage incurred in transit.
Keep children away from the packing.
2. Only install or place on a solid floor of non-flammable material
3. Remove all packaging and information material before assembly
4. Read warning sticker covering the burner, then remove the sticker
5. If something is broken or damaged: do not use the appliance. Return the appliance to your store immediately.
6. Place the burner into the burning chamber of the fireplace body

Safe Way to (re-) fill the Appliance

- Before refilling the appliance after extinguished fire: make sure to WAIT **FOR AT LEAST 10 MINUTES**.
- NEVER refill with a burning fire!
- Use a funnel for filling the appliance with bio ethanol.
- NEVER fill the appliance to a level above the max level indicator!

(Fig 4: max level indicator)



Fig 4

- Remove any spilled ethanol immediately – and before lighting! Use an appropriate absorbent tissue.

Safe Way to Shut down the Appliance

- Step 1: hold the extinguish tool above the burner. (Fig. 5)

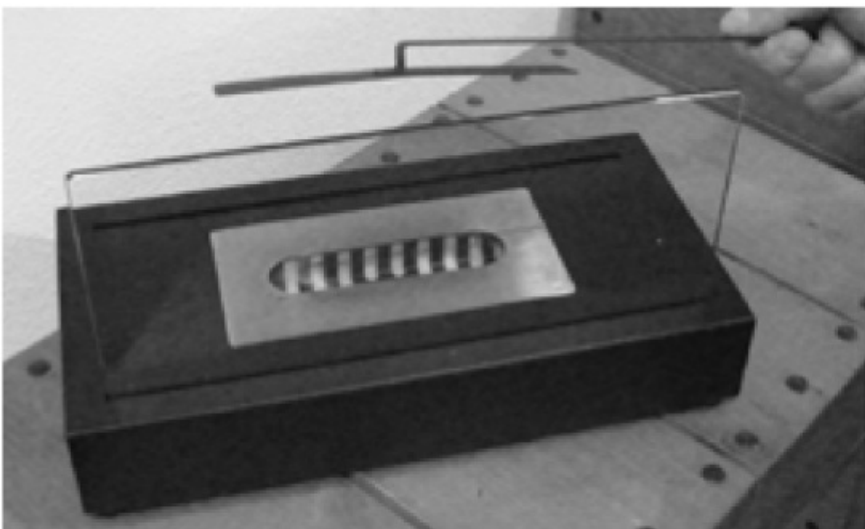

Fig. 5

- Step 2: carefully but firmly press the extinguish tool on the burner. Make sure to press firmly. (Fig. 6)

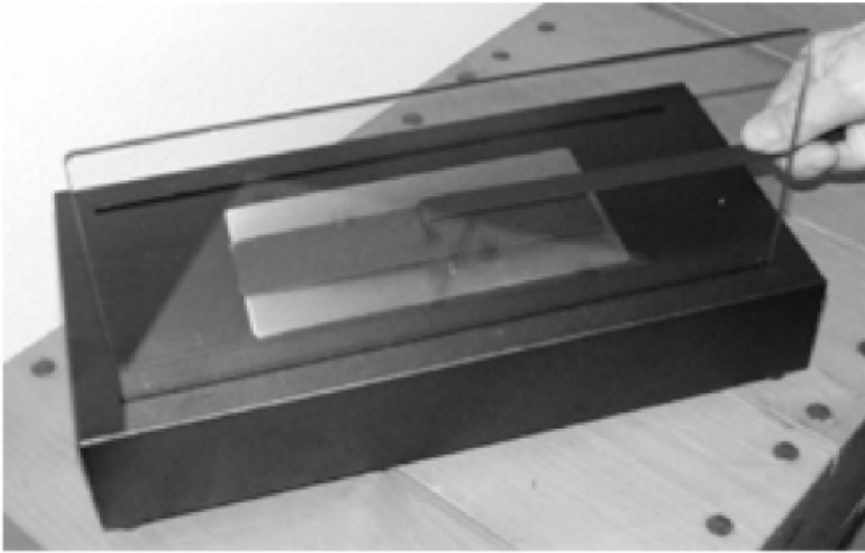

Fig. 6

- Hold for 15 seconds.
- Remove extinguish tool and verify the fire is extinguished. If in doubt: repeat the extinguish step 1 and 2.



Warning: the appliance can still be very hot!

Important notes:

- Fuel should be stored in a fire safe area. Check national regulations on how to safely store the fuel. In any case make sure to keep fuel more than 2 meters away from the burning or hot appliance.
- Make sure to have appropriate fire extinguishing equipment near the appliance. When in doubt: check with local fire department for the appropriate extinguishing equipment.

Possible suitable extinguishers are of class B and use:

- AFFF: Aqua Fluid Film Foam extinguishers
- AR-AFFF: (Alcohol-Resistant Aqueous Film Forming Foam) extinguisher
- CO2: Carbon dioxide



NEVER extinguish with water!

- Protect the appliance from wind and draught in a draughty environment.
- Do not move.
- Observe local legislation.
- Only use outdoors. Should you coincidentally use it indoors then make sure to only use the appliance in a well ventilated room (25% of the walls should be open and >60 m³).
- Only install the appliance on a solid floor or table of non combustible material!
- Keep the appliance at least 1 meter away from inflammable materials.
- Do not change the construction of the appliance!
- Only use spare parts which are approved by the manufacturer.
- When checking any malfunctioning or when in doubt: extinguish the fire using the extinguishing tool or using an extinguisher
- This appliance is NOT suitable for continuous operation.

- Never leave the appliance unattended during operation!
- Never leave the appliance when light on!
- Only use the type of fuel as specified by the manufacturer in this manual.

Igniting the fire

After filling: ignite the appliance with a suitable lighter make sure that:

- Igniting can be done at 14 cm or more from the burner opening.
- The fire can be witnessed during igniting process.



Never ignite the appliance at a distance closer than 14 cm!



Warning:

- DO NOT ignite the appliance if it is in a hot state or damaged.
- Be careful! Parts of the appliance- especially outer surface- might become hot during operation.
- Before lighting: take out the burner from its seat and check the secondary containment chamber in which the burner is seated for spilled ethanol. If spilled ethanol is witnessed: remove it.

Note:

- Only use suitable bio-ethanol with over 95% alcohol, preferred fuel brand Domestix
- Fuel will burn low at the start. Flame might hardly be visible. Allow 10 15 minutes for the flame to reach optimum temperature and visibility.
- Avoid drafts
- The glass of the appliance might become dark during use. This is normal and can be cleaned when the fire is extinguished and the appliance has cooled down.

CLEANING & MAINTENANCE

- Clean regularly with a soft cloth, luke warm water and a PH-neutral cleaning soap.
- Do not use chemical, steel-wool or scrubbing sponges to clean.

STORAGE

To enhance the lifetime of the appliance: make sure to store the appliance in a dry and well ventilated place after every usage. Always take the following steps:

- Make sure it is cooled down
- Clean it
- Make sure it is completely dry

TROUBLE SHOOTIN

Problem	Cause / Solution
Fire does not ignite	Check if proper ethanol is used
	Check if there is enough ethanol in the burner
Fire outside the appliance	<p>Extinguish with a suitable extinguisher class B use:</p> <ul style="list-style-type: none"> • AFFF: Aqua Fluid Film Foam extinguishers • AR-AFFF: (Alcohol-Resistant Aqueous Film Forming Foam) extinguisher • CO₂: Carbon dioxide <p>NEVER extinguish with water!</p>

CONDITIONS OF WARRANTY

There is a two-year warranty on your appliance from the date of purchase. All material or manufacturing defects will be repaired free of charge.

The following applies:

- All claims for compensation, including consequential damage, will not be entertained.
- Any repairs or replacement of components during the warranty period will not result in an extension of the warranty period.
- The warranty will expire if any alterations have been made, not genuine components have been fitted or if the appliance has been repaired by a third party.
- Components subject to normal wear and tear are not covered by the warranty.
- The warranty is only valid on presentation of the original, unaltered, and date stamped purchase receipt.
- The warranty does not cover damage caused by actions that deviate from those as described in the user's manual or by neglect.
- Transportation costs and the risks involved during the transportation of the appliance or components shall always be for the account of the purchaser.

To prevent unnecessary expenses, we recommend that you always carefully read the user's manual first. If this does not provide a solution, take the appliance to your distributor for repair.

The use of this product and the elements required for that purpose is entirely at the end user's own risk.

End of life time

Never dispose of non-biodegradable products in the environment. When the appliance is no longer functional, it should be disposed of in such a way as to cause minimum environmental impact, in accordance with the regulations of your local authority.

TECHNICAL SPECIFICATION

QLIMA Decorative fire place Bio ethanol	FFB105	FFB 830	FFB 4242
Net Weight (kg)	3,5	6,5	7
Max. tank volume (liter)	0,5	0,5	0,5
Max. Burning period (minutes) (*)	120	120	120
Recommended fuel	Domestix Ethanol		

(*) indicative – varies due to (for example) differences in fuel type.

Distributed in Europe by PVG Holding B.V.

If you need information or if you have a problem, please visit the our website (www.qlima.com) or contact our sales support (T: +31 412 694 694).

Documents / Resources

	<p>Qlima FFB105 Rectangular Bio-Ethanol Fire Pit Table [pdf] User Manual FFB105, FFB830, FFB4242, Rectangular Bio-Ethanol Fire Pit Table</p>
--	--

References

- [Q Qlima](#)
- [Q Qlima](#)
- [Q Qlima](#)
- [Q Qlima.fr | Home made climates](#)
- [Q Qlima](#)
- [Q Qlima, dé klimaatspecialist | Comfort in en om het huis](#)
- [Q Qlima](#)