

qico QPR-C2 Dongle Installation Guide

[Home](#) » [qico](#) » qico QPR-C2 Dongle Installation Guide 

qico QPR-C2 Dongle Installation Guide

Contents

- [1 How to use](#)
- [2 Step 1 of App setup](#)
- [3 Step 2 of App setup](#)
- [4 Step 3 of App setup](#)
- [5 Warranty Information](#)
- [6 Warranty Instructions and Conditions](#)
- [7 FCC Statement](#)
- [8 Documents / Resources](#)
- [9 Related Posts](#)

How to use

Connect the dongle to pen drive, and then connect to the type-C receptacle of computer.

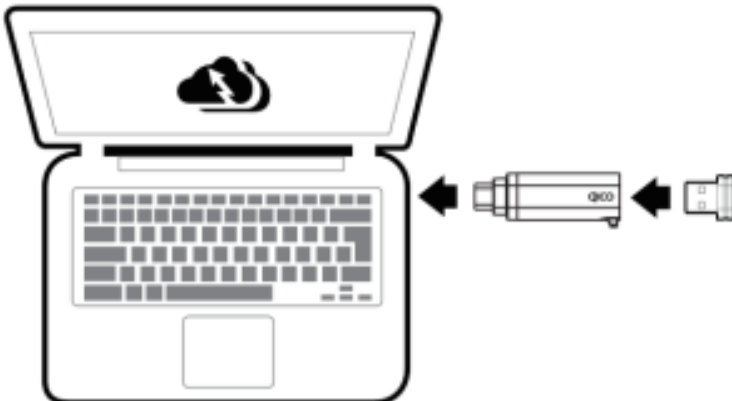

Or Connect the dongle to the USB type-A receptacle of computer.



Step 1 of App setup

Download computer and phone apps

- On your phone, scan QR code and launch qico app.



or

- For iPhone, download and install qico app from App Store.



- For Android phone, download and install qico app from Google Play.



- For Windows 10 PC, download and install qico direct from Microsoft Store.



- For MAC computer, please type in the link in web browser to download the software,



<https://lihil.com/r27km>

Step 2 of App setup

Prepare device pairing

1. Connect the qico dongle to the computer, and it will show qico device name.



2. On phone: after granting all permissions, hit “Next” button to the setup page and follow instructions.

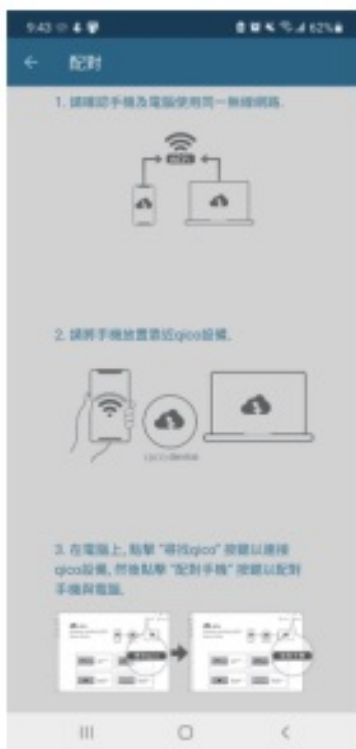

Step 3 of App setup

Pair phone and computer

1. On PC: click “pair phone” button shown below to pair your phone. When the pairing window status becomes “Ready”, put the phone close to the qico device.



2. On your phone, you will see the successful pairing dialogue. It is ready to use.

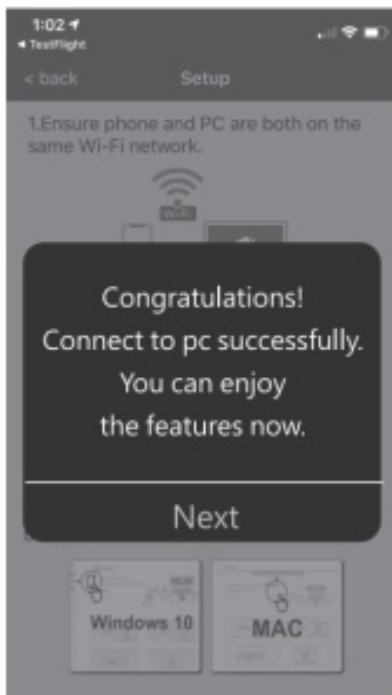

Product SPEC

- **qico dongle**

Model: QPR-C2 **Size:** 18.6x17x10.9mm

Weight: 2g

- **qico reader**

Model: QPH-N1 **Size:** 52.9 x19.5 x10.9mm

Weight:8g

- **System Requirements**

Computer requirements : Windows 10(build 1809 or above);

MAC 10.14 or above Phone requirements: Android 7 or above; iOS11 or above

Warranty Information

Thank you for buying the qico products! We provide comprehensive warranty services in accordance with the applicable national laws and regulations.

1. Within 12 months from date of purchase, any fault in listed device performance can be claimed under consumer warranty.
2. Warranty Registration Required: In qico computer app, the register option will be available in Settings page.
3. Valid product registration and invoice are essential for protecting your warranty rights. If you do not register the product or cannot provide valid invoice, we will provide 90-day warranty initiating from manufacturing date of your qico pad.

Warranty Instructions and Conditions

Your warranty is only valid under authorized use of your devices. All man-made damages and any of the following conditions voids the free warranty. Repair services will still be available to consumers at a reasonable cost for out of warranty devices.

1. The warranty period has expired.
2. Damage caused by human factors, including damages caused by usage under improper operating environment.
3. Damage caused by a force majeure (such as floods, fires, earthquakes, and lightning).
4. The user is unable to provide the product registration and valid proof of purchase or the product model and barcode do not match or are altered.

FCC Statement

This equipment has been tested and found to comply with the limits for a Class B digital device, pursuant to part 15 of the FCC Rules. These limits are designed to provide reasonable protection against harmful interference in a residential installation.

This equipment generates, uses and can radiate radio frequency energy and, if not installed and used in accordance with the instructions, may cause harmful interference to radio communications. However, there is no guarantee that interference will not occur in a particular installation. If this equipment does cause harmful interference to radio or television reception, which can be determined by turning the equipment off and on, the user is encouraged to try to correct the interference by one or more of the following measures:

- Reorient or relocate the receiving antenna.
- Increase the separation between the equipment and receiver.
- Connect the equipment into an outlet on a circuit different from that to which the receiver is connected.
- Consult the dealer or an experienced radio/TV technician for help.

Caution: Any changes or modifications to this device not explicitly approved by manufacturer could void your authority to operate this equipment.

This device complies with part 15 of the FCC Rules. Operation is subject to the following two conditions:

1. This device may not cause harmful interference, and
2. this device must accept any interference received, including interference that may cause undesired operation.

RF Exposure Information

The device has been evaluated to meet general RF exposure requirement. The device can be used in portable exposure condition without restriction.

Documents / Resources

	<p>qico QPR-C2 Dongle [pdf] Installation Guide QPR-C2, QPRC2, 2ACNO-QPR-C2, 2ACNOQPRC2, QPR-C2 Dongle, Dongle</p>
---	---

[Manuals+](#).