

QIACHIP ZBBridge-01 Smart Zigbee Bridge Hub User Manual

Contents

1 ZBBridge-01

1.1 User manual V1.0

1.2 ZigBee Bridge

1.2.1 Specifications

1.2.2 Features

1.2.3 Product Introduction

1.2.4 Operating Instruction

1.2.4.1 (1) Download APP

1.2.4.2 (2) Power on

1.2.4.3 (3) Add ZigBee Bridge

1.2.4.4 (4) Add a ZigBee sub-device ZigBee Bridge

1.2.5 LED indicator status instruction

1.2.6 Compatible Pairing Mode(AP)

1.2.7 Delete ZigBee sub-devices

1.2.8 Factory Reset

1.2.9 Common Problems

2 Documents / Resources

2.1 References

3 Related Posts



ZBBridge-01

User manual V1.0

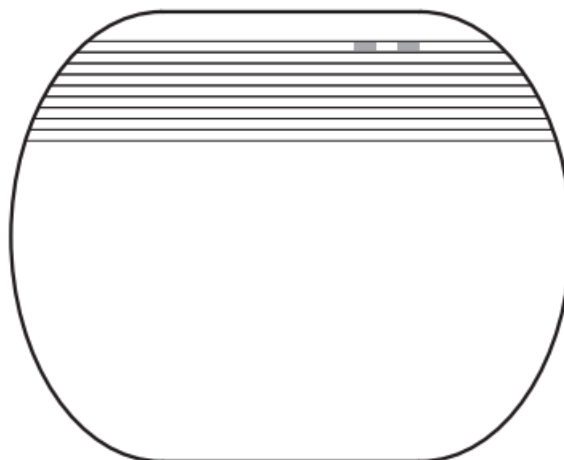

ZigBee Bridge

Specifications

Model	ZBBridge-01
Input	5V 1A
Wireless connections	IEEE 802.11 b/g/n 2.4GHz , ZigBee 3.0
Operating systems	Android 4.1 & iOS 9.0 or higher
Working temperature	-10°C~40°C
Material	PC
Dimension	76×61 x20mm

Features

This is a ZigBee Bridge that allows you to control a variety of ZigBee devices by transforming WiFi into ZigBee. You can remotely turn on/ off or schedule on/off connected ZigBee devices, or share it with your family to control them together.

Product Introduction

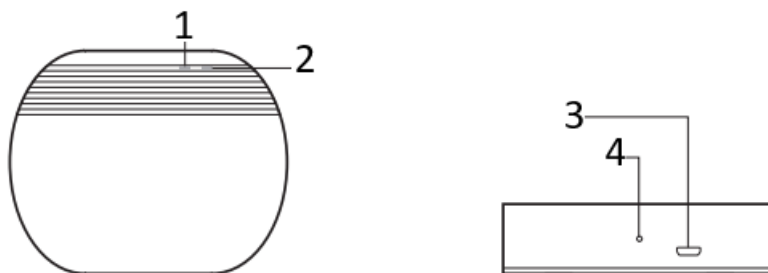

1. ZigBee LED indicator(Green)
2. WiFi LED indicator(Blue)
3. Input
4. Pairing button

Operating Instruction

(1) Download APP

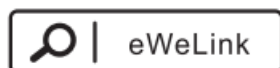

(2) Power on

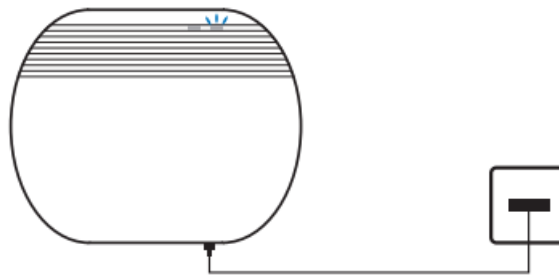

After powering on, the device will enter the quick pairing mode (Touch) during the first use. The WiFi LED indicator changes in a cycle of two short and one long flash.

⚠ The device will exit the quick pairing mode (Touch) if not paired within 3mins. If you want to enter this mode, please long press the pairing button for about 5s until the WiFi LED indicator changes in a cycle of two short and one long flash and release.

(3) Add ZigBee Bridge

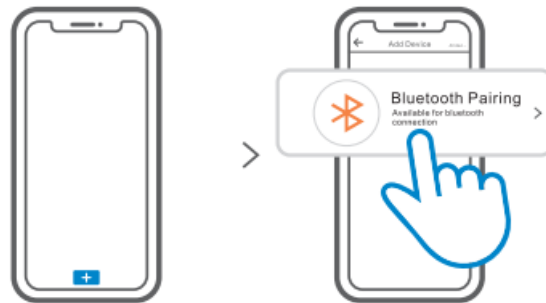

Connect your phone to 2.4GHz WiFi and turn on Bluetooth. Tap '+' and select 'Bluetooth Pairing', then operate following the prompt on the APP.

(4) Add a ZigBee sub-device ZigBee Bridge

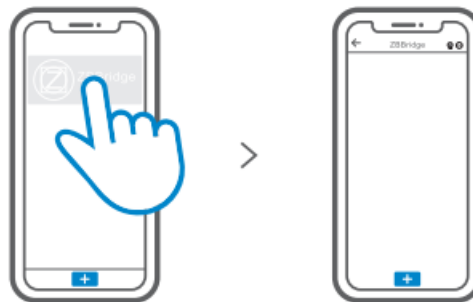

Set it to the pairing mode before adding the ZigBee sub-device. then tap '+' pair the device with the ZigBee sub-device.

⚠ ZigBee Bridge can add up to 32 sub-devices now. It will support adding more sub-devices soon.

LED indicator status instruction

Blue LED flashes (one long and two short	Quick Pairing Mode
Blue LED flashes quickly	Compatible Pairing Mode (AP)
Blue LED keeps on	Device is connected successfully
Blue LED flashes quickly once	Unable to discover the router
Blue LED flashes quickly twice	Connect to the router but fail to connect to WiFi
Blue LED flashes quickly three times	Upgrading
Green LED flashes twice	Sub-device deleting prompt
Green LED flashes slowly	Searching and adding

Compatible Pairing Mode(AP)

If you fail to enter Quick Pairing Mode (Touch), please try “Compatible Pairing Mode (AP)” to pair.

(1) Long press pairing button for 5s until the WiFi LED indicator changes in a cycle of two short flashes and one long flash and release. Long press pairing button for 5s again until the WiFi LED indicator flashes quickly, then the device enters Compatible Pairing Mode (AP).

(2) Tap “+” and select “Compatible Pairing Mode (AP)” on APP

For Android system: Enter WiFi password and tap “Next”. Be patient until pairing completes.

For iOS system: Select WiFi SSID with ITEAD-**** and enter the password 12345678, and then go back to eWeLink APP and tap “Next”. Be patient until pairing completes.

Delete ZigBee sub-devices

Long press the pairing button for 10s until the ZigBee LED indicator “flashes twice” that all paired sub-devices will be deleted successfully.

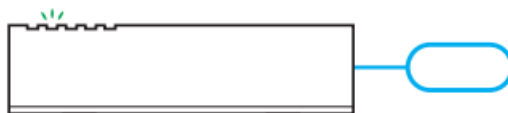

Delete single sub-device on APP

Factory Reset

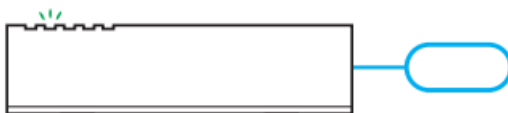

Long press the pairing button for about 5s until the WiFi LED indicator changes in a cycle of two short and one long flash and release, then the reset is successful. The device enters quick pairing mode(Touch).

Image



Please reset the device to factory defaults if you want to change the WiFi network, then reconnect the new network.

Common Problems

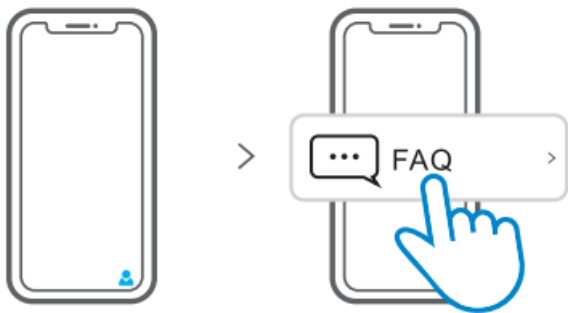

Tap “” on eWeLink APP and select “FAQ ” to check.

eWeLink has integrated with mainstream AI platforms:



Documents / Resources

	<p>QIACHIP ZBBridge-01 Smart Zigbee Bridge Hub [pdf] User Manual</p> <p>ZBBridge-01, ZBBridge-01 Smart Zigbee Bridge Hub, Smart Zigbee Bridge Hub, Zigbee Bridge Hub, Bridge Hub, Hub</p>
---	---

References

- [User Manual](#)