



# Q-TRAN QUOVA-STANDARD Linear Fixture Instruction Manual

[Home](#) » [Q-TRAN](#) » Q-TRAN QUOVA-STANDARD Linear Fixture Instruction Manual 

## Q-TRAN QUOVA-STANDARD Linear Fixture Instruction Manual



**ATTENTION:** Please read all instructions **BEFORE** installation

- **Product to be installed by a licensed electrician** – Field modifications void warranty
- **Use only with Class 2 power supply unit** — Compatible for use with Q-Tran power supplies
- Knife edge cove mount
- **Input Voltage:** 24VDC
- Diagrams for representation only and not to scale.

### Contents

[1 METHODS OF INSTALLATION](#)

[2 COMPONENTS &  
HARDWARE](#)

[3 Documents / Resources](#)

[3.1 References](#)

[4 Related Posts](#)

## METHODS OF INSTALLATION

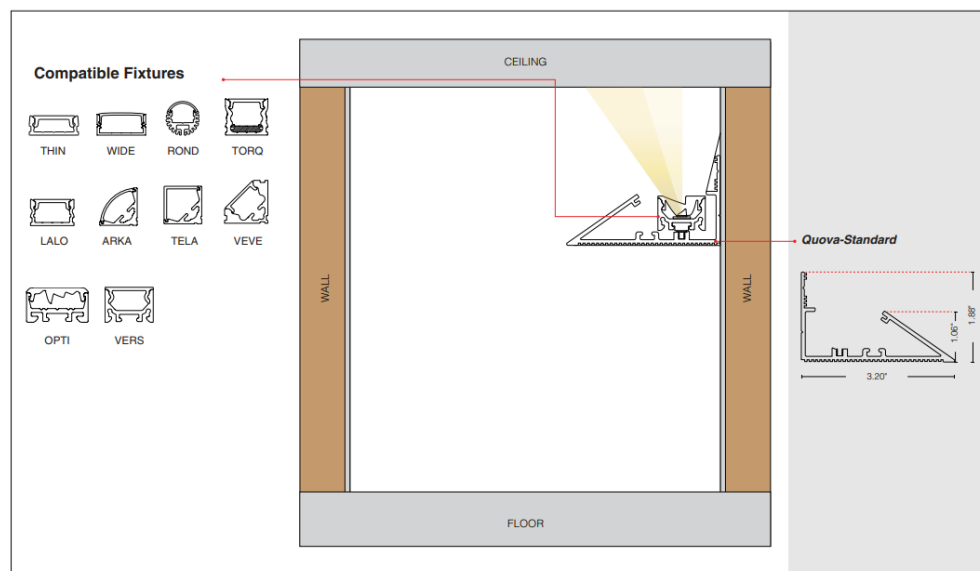

## MOUNTING METHOD

- MAIN HOUSING MOUNT:
- FIXTURES MOUNT:
- DUST COVER(optional):

### QUOVA-STANDARD

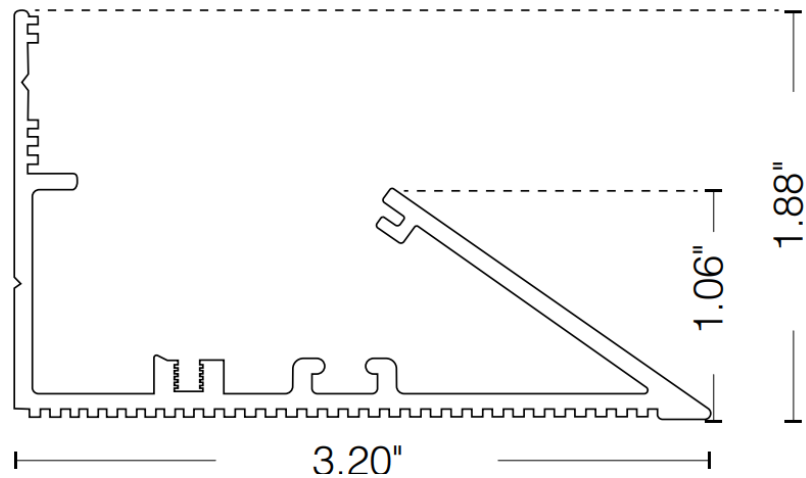

Profile with OPTI and Frosted Optional Dust Cover

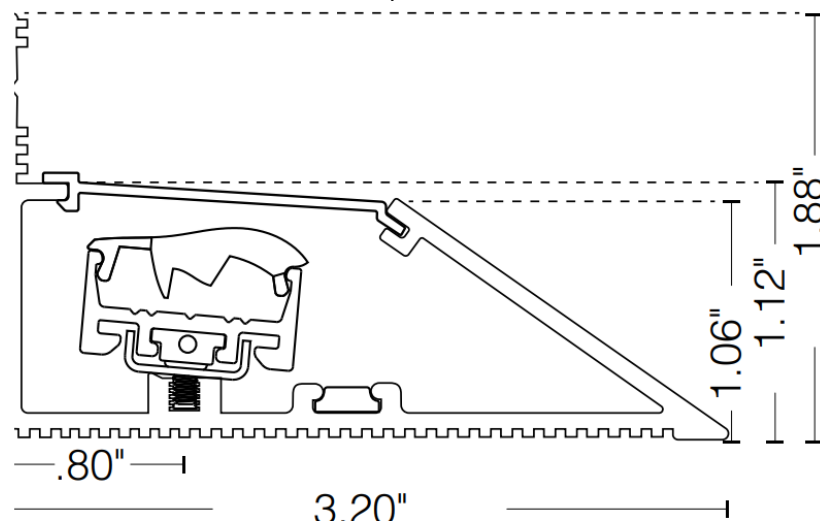

## COMPONENTS & HARDWARE

### STAINLESS STEEL CLIP

- SST-01

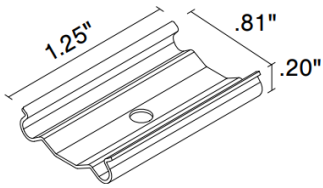

- CC-01

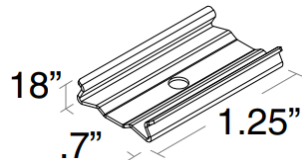

- **Included**

Stainless Steel

Phillip

#4-40 – X 3/16"

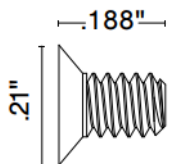

### MAGNET CLIP

- MG-01

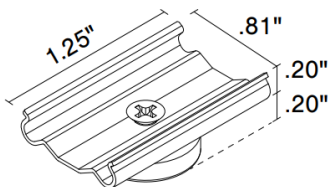

- MG-02

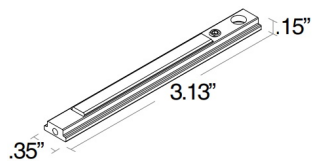

### MAGNET MOUNT ACCESSORY (sold individually)

- MMA-01

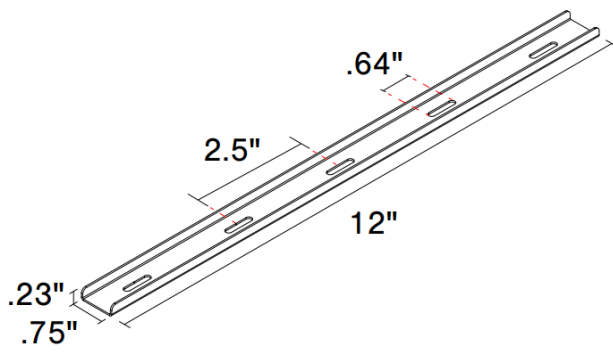

**Included**

2#6×5/8"

Flat Head SS

- MMA-02

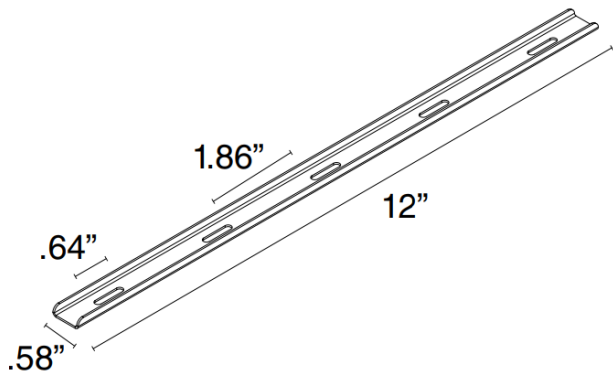

**Included**

2#6×5/8"

Flat Head SS

**DUST COVER**

**QV-STND-FR**

Frosted Dust Cover (optional)

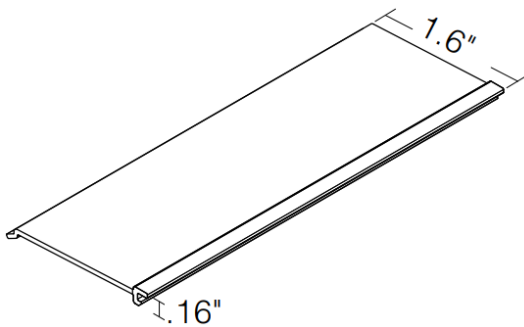

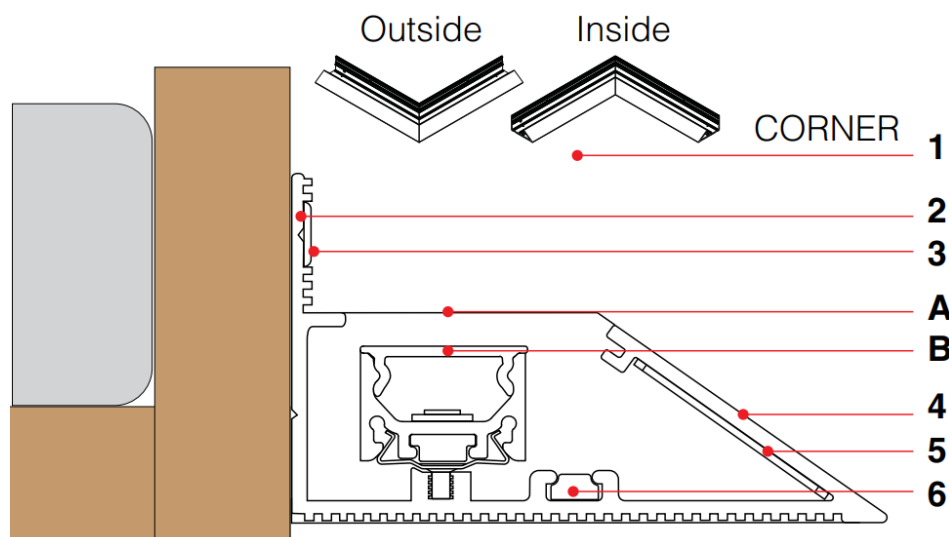

**A** – Fixture Housing  
**B** – Lighting Module

1. Inside and Outside Corners.
2. Fixture Mounting Channel.
3. Mounting Screws, by Others.
4. Fixture Housing Extrusion – Anodized Aluminum – surface treated to accept paint. Provided in 8ft nominal lengths. Field cut final piece in linear run to desired length.
5. End Cap – Used to close the end of the fixture housing extrusion. Not required when the fixture housing extrusion ends in a corner or against a wall. Available in Left and Right Configurations.
6. Inline Bracket; Designed to align and hold sections of fixture housing together.

NOTES	
STAINLESS STEEL CLIP	MAGNET CLIP
<ul style="list-style-type: none"> <li>2 clips provided for 4' or less; 4 clips provided for greater than 4'</li> </ul>	<ul style="list-style-type: none"> <li>One magnet clip per foot</li> </ul>
	<ul style="list-style-type: none"> <li>MMA-01/MMA-02 comes in 12" pieces; use at least one clip per MMA accessory</li> </ul>
	<ul style="list-style-type: none"> <li>MMA-01/MMA-02 can be cut into smaller pieces, if desired</li> </ul>

**MOUNTING METHOD: MAIN HOUSING MOUNT**

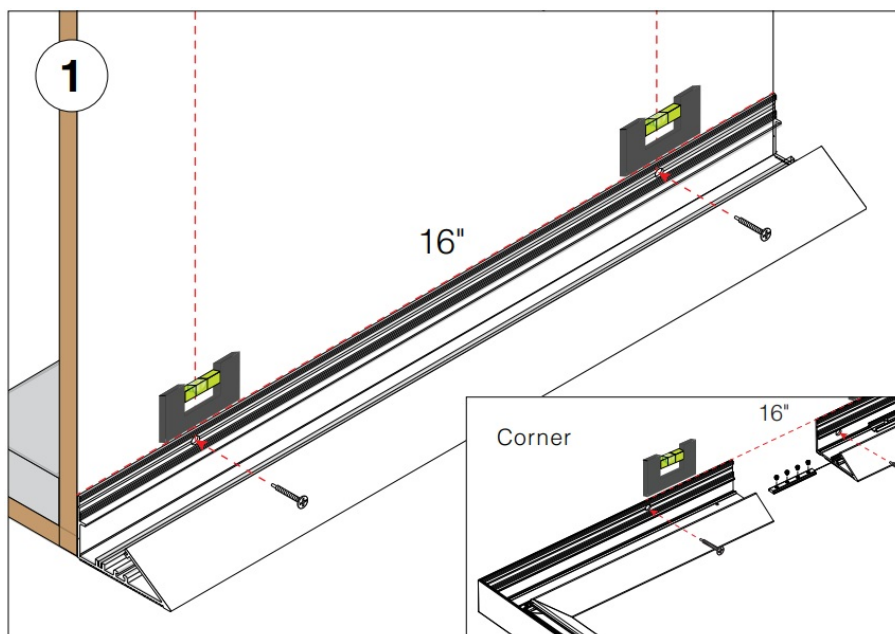

- a:** Pre-drill 1/4" pilot holes every 16" to align with studs start with corners and fill in with straight sections..  
**b:** Align QUOVA to be level, and if necessary, to line up with ceiling/soffit.  
**c:** Mount QUOVA to wall with #6 screws (by others) every 16" into studs.

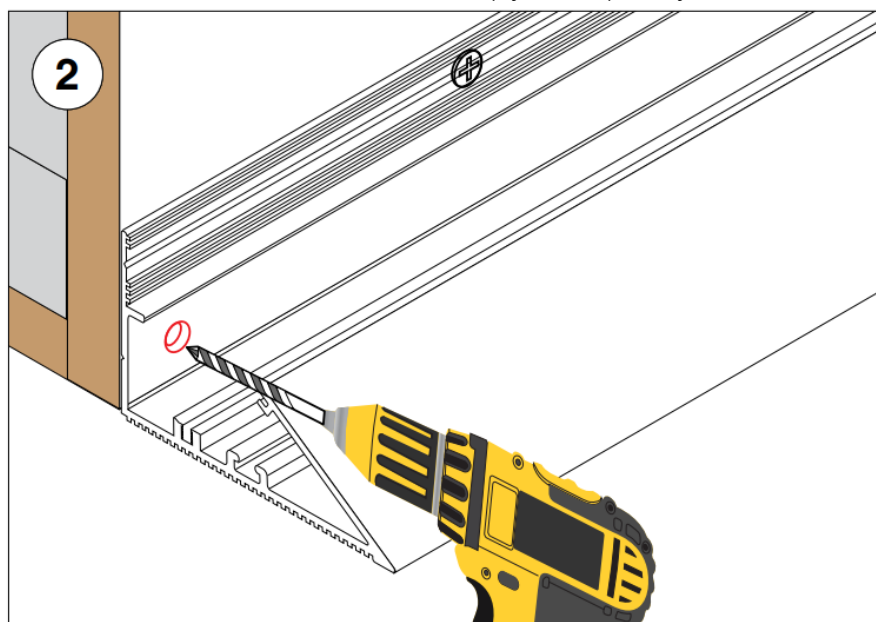

- a:** Determine wire feed location.  
**b:** Drill 1/4" Hole through QUOVA and drywall.

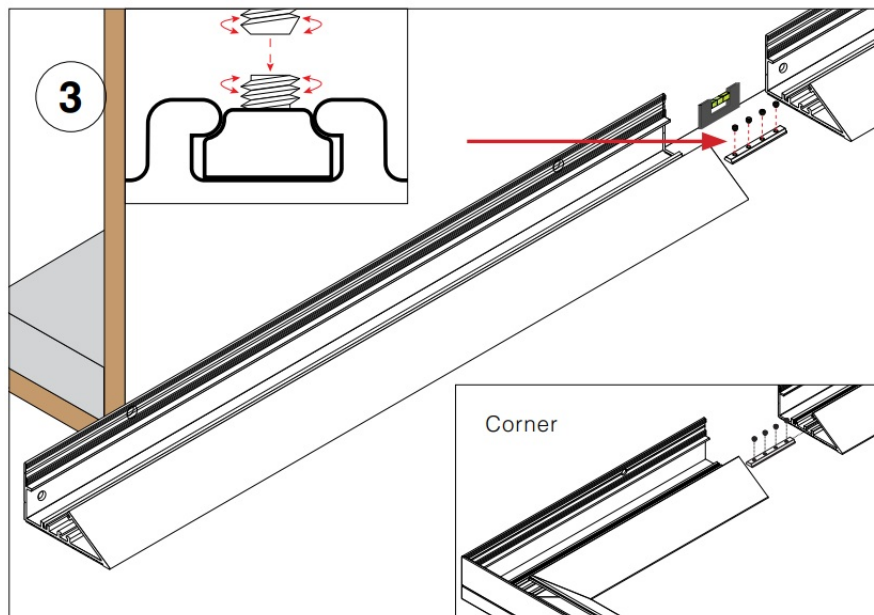

- a:** If multiple lengths are being used, install the inline bracket.
- b:** Install inline bracket in mounted piece.
- c:** Follow Instructions of step 1 for second length.
- d:** Confirm both pieces are level and aligned, mount second piece, slide inline bracket over and tighten set screws.
- e:** Repeat for additional lengths as needed.

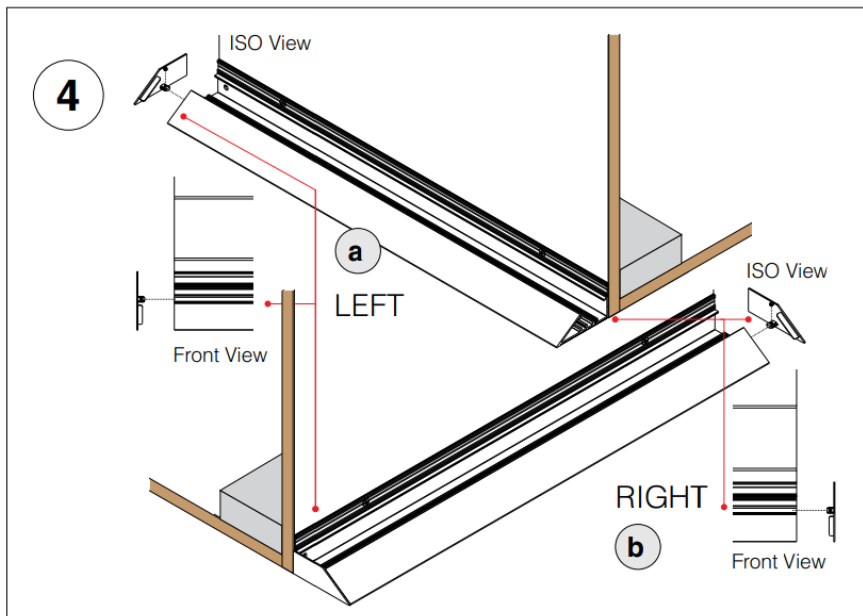

Install the endcap on the appropriate side and tighten set screw and repeat on the other side.

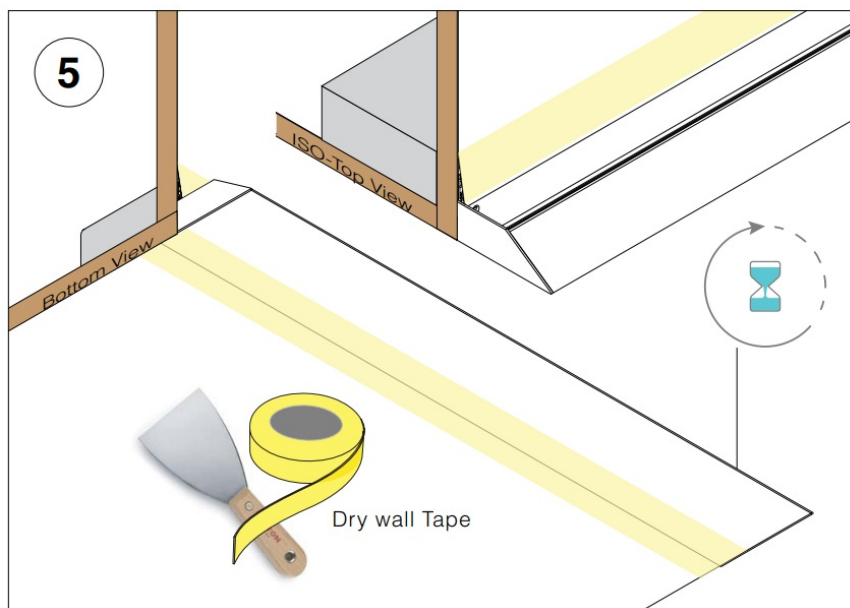

Apply drywall tape at joint of QUOVA to wall and underneath.

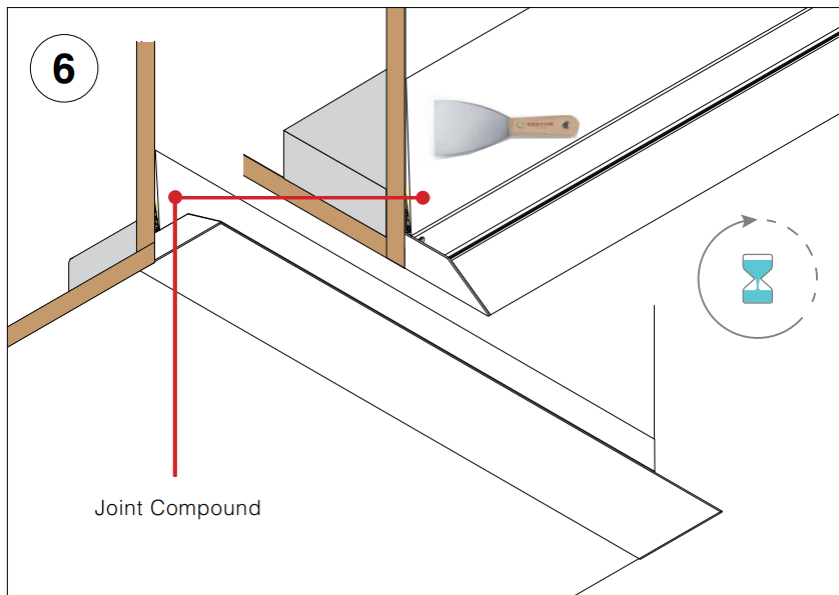

- a:** Apply joint compound to wall and underneath.
- b:** Allow to dry.
- c:** Sand and repeat as necessary.
- d:** Once completed, apply primer and paint.

#### MOUNTING METHOD: **FIXTURES MOUNT**

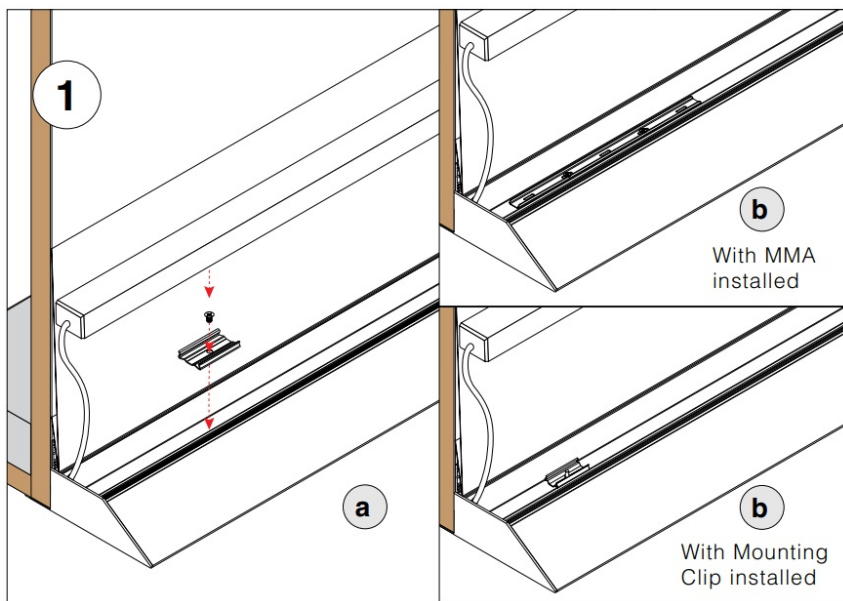

- a:** Install mounting clips in screw track.
- a&b:** Mount Lighting fixture inside of QUOVA. Run wire through pre-drilled hole back to power supply or junction box.



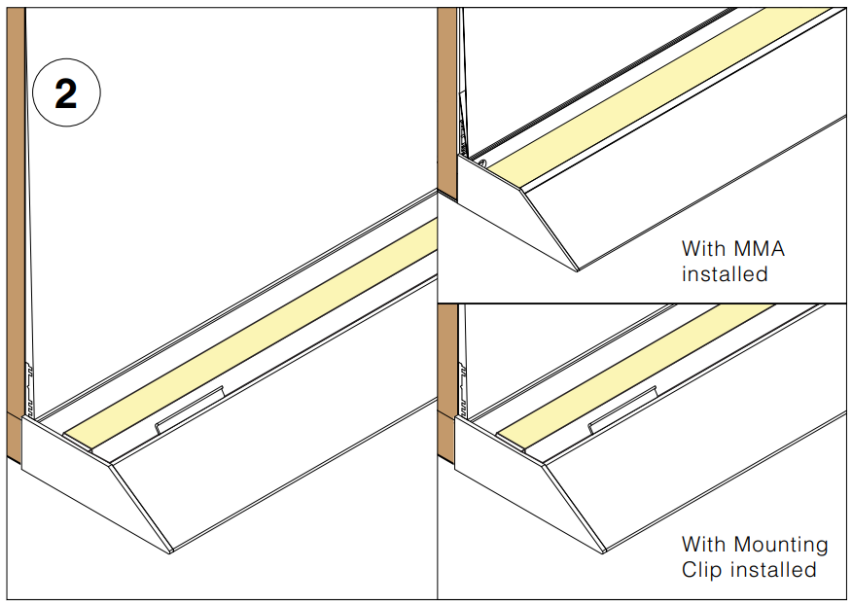

QUOVA Standard Install Assembly

© 2022 Q-Tran Inc. All rights reserved | 155 Hill St. Milford, CT 06460 | 203-367-8777 | [sales@q-tran.com](mailto:sales@q-tran.com) | [www.q-tran.com](http://www.q-tran.com) Specification subject to change. Rev-09-29-23 7

Documents / Resources

	<p><a href="#">Q-TRAN QUOVA-STANDARD Linear Fixture</a> [pdf] Instruction Manual QUOVA-STANDARD Linear Fixture, QUOVA-STANDARD, Linear Fixture, Fixture</p>
---	---

References

- [Your Name as Your Email | Hover Realnames](#)
- [LED Lighting Systems, Linear LED Lights, LED transformers | Q-Tran](#)