

```
[ hide ]
```

- 1 Q-SYS X10 Server Core Processor
- 2 EXPLANATION OF TERMS AND SYMBOLS
- 3 Maintenance and Repair
- 4 Environmental Specifications
- 5 FCC Statement
- 6 What's in the Box?
- 7 Introduction
- 8 Connections and Callouts
- 9 Installation
- 10 Documents / Resources
- 10.1 References

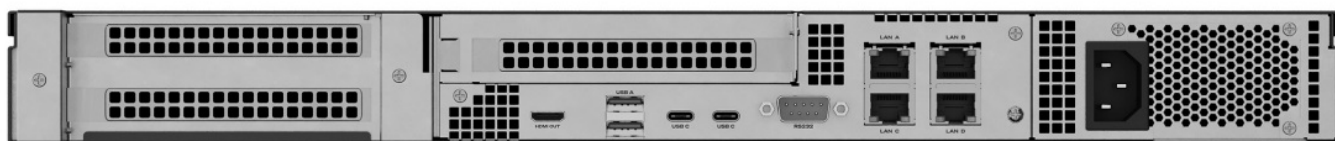

Q-SYS X10 Server Core Processor

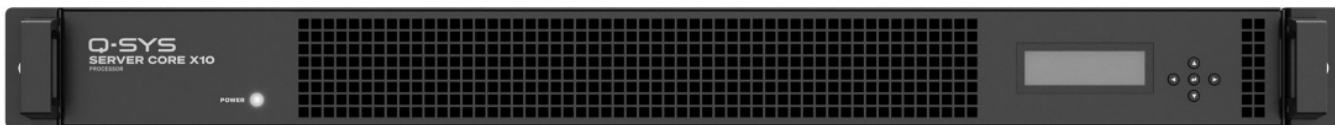

EXPLANATION OF TERMS AND SYMBOLS

- The term “WARNING!” indicates instructions regarding personal safety. If the instructions are not followed, the result may be bodily injury or death.
- The term “CAUTION!” indicates instructions regarding possible damage to physical equipment. If these instructions are not followed, it may result in damage to the equipment that may not be covered under the warranty.
- The term “IMPORTANT!” indicates instructions or information that are vital to the successful completion of the procedure.
- The term “NOTE” is used to indicate additional useful information.



The lightning flash with an arrowhead symbol in a triangle alerts the user to the presence of uninsulated dangerous voltage within the product's enclosure that may constitute a risk of electric shock to humans.



The exclamation point within a triangle alerts the user to the presence of important safety, operating, and Maintenance instructions in this manual.



IMPORTANT SAFETY INSTRUCTIONS

1. Read, follow, and keep these instructions.
2. Heed all warnings.
3. Do not use this apparatus near water.
4. Clean only with a dry cloth.
5. Do not block any ventilation opening. Install according to the manufacturer's instructions.
6. Do not install near any heat sources such as radiators, heat registers, stoves, or other apparatus (including amplifiers) that produce heat.
7. Only use attachments/accessories specified by the manufacturer.
8. Refer all servicing to qualified service personnel.
9. Adhere to all applicable local codes.
10. Consult a licensed, professional engineer when any doubts or questions arise regarding a physical equipment installation.

Maintenance and Repair



WARNING! Advanced technology, e.g., the use of modern materials and powerful electronics, requires specially adapted maintenance and repair methods. To avoid the danger of subsequent damage to the apparatus, injuries to persons and/or the creation of additional safety hazards, all maintenance or repair work on the apparatus should be performed only by a QSC authorised service station or an authorised QSC International Distributor. QSC is not responsible for any injury, harm or related damages arising from any failure of the customer, owner or user of the apparatus to facilitate those repairs.



WARNING! The Server Core X10 is designed for indoor installation only.

LITHIUM BATTERY WARNINGS



WARNING! THIS EQUIPMENT CONTAINS A NON-RECHARGEABLE LITHIUM BATTERY. LITHIUM IS A CHEMICAL KNOWN TO THE STATE OF CALIFORNIA TO CAUSE CANCER OR BIRTH DEFECTS. THE NONRECHARGEABLE LITHIUM BATTERY CONTAINED IN THIS EQUIPMENT MAY EXPLODE IF IT IS EXPOSED TO FIRE OR EXTREME HEAT. DO NOT SHORT CIRCUIT THE BATTERY. DO NOT ATTEMPT TO RECHARGE THE NON-RECHARGEABLE LITHIUM BATTERY. THERE IS A RISK OF EXPLOSION IF THE BATTERY IS REPLACED BY AN INCORRECT TYPE.

Environmental Specifications

- Expected Product Life Cycle: 10 years
- Storage Temperature Range: -40°C to +85°C (-40°F to 185°F)
- Storage Humidity Range: 10% to 95% RH @ 40°C, non-condensing
- Operating Temperature Range: 0°C to 40°C (32°F to 104°F)
- Operating Humidity Range: 10% to 95% RH @ 40°C, non-condensing

Environmental Compliance

Q-SYS complies with all applicable environmental regulations. This includes (but is not limited to) global environmental laws, such as the EU WEEE Directive (2012/19/EU),

China RoHS, Korean RoHS, U.S. Federal and State Environmental Laws and various resource recycling promotion laws around the world. For more information, visit: qsys.com/about-us/green-statement.

FCC Statement

The Q-SYS Server Core X10 has been tested and found to comply with the limits for a Class A digital device, under Part 15 of the FCC Rules. These limits are designed to provide reasonable protection against harmful interference when the equipment is operated in a commercial environment. This equipment generates, uses, and can radiate radio frequency energy. If not installed and used according to the instruction manual, it may cause harmful interference to radio communications. Operation of this equipment in a residential area is likely to cause harmful interference; in which case, the user will be required to correct the interference at his own expense.

RoHS Statements

The QSC Q-SYS Server Core X10 complies with the European RoHS Directive. The QSC Q-SYS Server Core X10 complies with “China RoHS” directives. The following table is provided for product use in China and its territories.



EFUP assessment is 10 years. This period is based on the shortest component or subassembly EFUP declaration used in the Server Core X10 product designs.

	QSC Q-SYS Server Core X10					
(Part Name)	(Hazardous Substances)					
	(Pb)	(Hg)	(Cd)	(Cr(vi))	(PBB)	(PBDE)
(PCB Assemblies)	X	O	O	O	O	O
(Chassis Assemblies)	X	O	O	O	O	O

QSC Q-SYS Server Core X10

This table is prepared following the requirements of SJ/T 11364.

O: Indicates that the concentration of the substance in all homogeneous materials of the part is below the relevant threshold specified in GB/T 26572.

X: Indicates that the concentration of the substance in at least one of the homogeneous

materials of the part is above the relevant threshold, as specified in GB/T 26572. (Replacement and reduction of content cannot be achieved currently because of technical or economic reasons.)

What's in the Box?

- Q-SYS Server Core X10
- Accessory Kit (Ear Handles and rack-mounting rail kit hardware)
- Power cable, appropriate to the region
- Warranty statement, TD-000453-01
- Safety Information & Regulatory Statements doc, TD-001718-01

Introduction

The Q-SYS Server Core X10 represents the next generation of Q-SYS processing, pairing the Q-SYS OS with off-the-shelf, enterprise-grade IT server hardware to deliver a flexible and scalable audio, video, and control solution for a vast range of applications. Server Core X10 is a fully networked, programmable AV&C processor that provides centralised processing for multiple spaces or zones while distributing network I/O where it's most convenient.

NOTE: The Q-SYS Server Core X10 processor requires Q-SYS Designer Software (QDS) for configuration and operation. QDS version compatibility information can be found [here](#). Information about the QDS components related to the Server Core X10, including their properties and controls, can be found in Q-SYS Help at help.qsys.com. Or, simply drag a Server Core X10 component from the Inventory into the Schematic and press F1.

Connections and Callouts

Front Panel

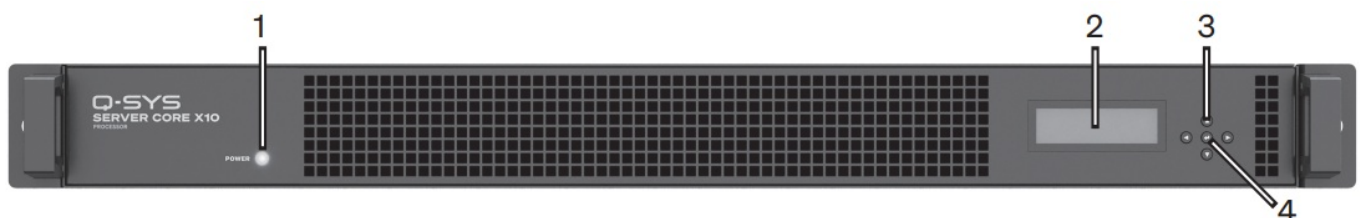

1. Power light: lights up blue when the unit is powered on.
2. Front-panel display: displays pertinent information about the core, such as its network configuration, the system it is running, active faults, etc.
3. Navigation buttons (up, down, left, right): allow the user to navigate through the menus on the front panel display:
 - a. Both the up and right buttons advance to the next menu item.
 - b. Both the down and left buttons go back to the previous menu item.
4. ID/Select button: Press the centre button to put the Core into ID mode for identification within Q-SYS Designer Software. Press again to turn off ID mode.

Back Panel

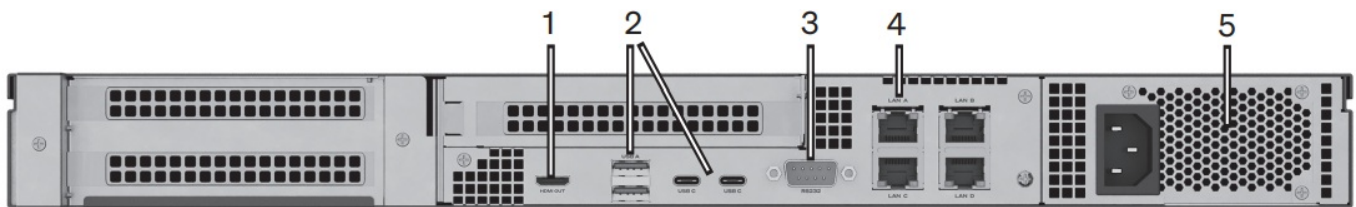

1. HDMI port: not supported.
2. USB A and USB C ports: not supported.
3. Serial communications RS232 (male DB-9): for connecting to serial devices.
4. Q-SYS LAN ports (RJ45): from left to right; top row is LAN A and LAN B, bottom row is LAN C and LAN D.
5. Power supply unit (PSU).

Installation

The following procedures explain how to install the ear handles and slide rail accessories onto the system chassis and into the rack.

Ear Handle Installation

To install the pair of mounting ears and handles in the accessory box, insert the provided screws into the front-right and front-left mounting ears, and fasten them.

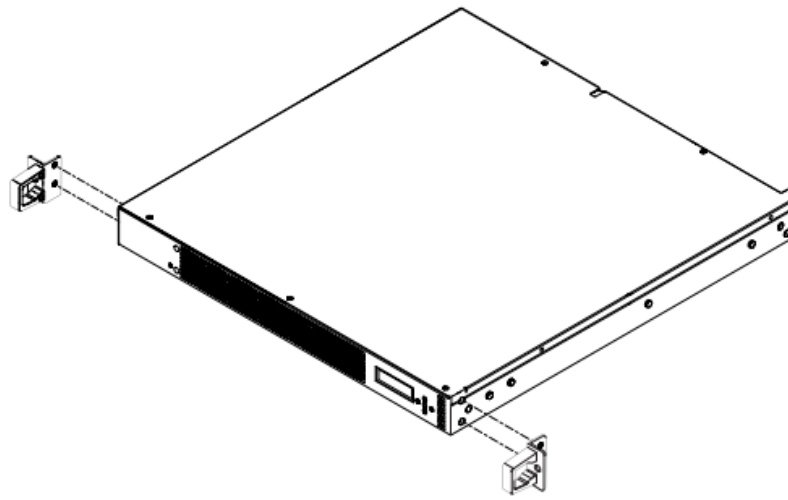

Slide Rail Preparation

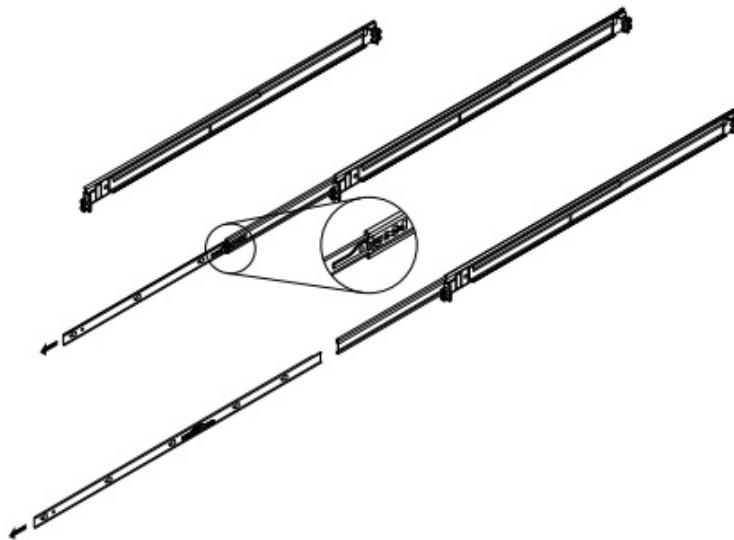

1. Release the inner rail from the outer rail.
 - a. Extend the inner rail until it stops.
 - b. Press the release lever on the inner rail to remove it.
2. Attach the inner rail to the chassis.

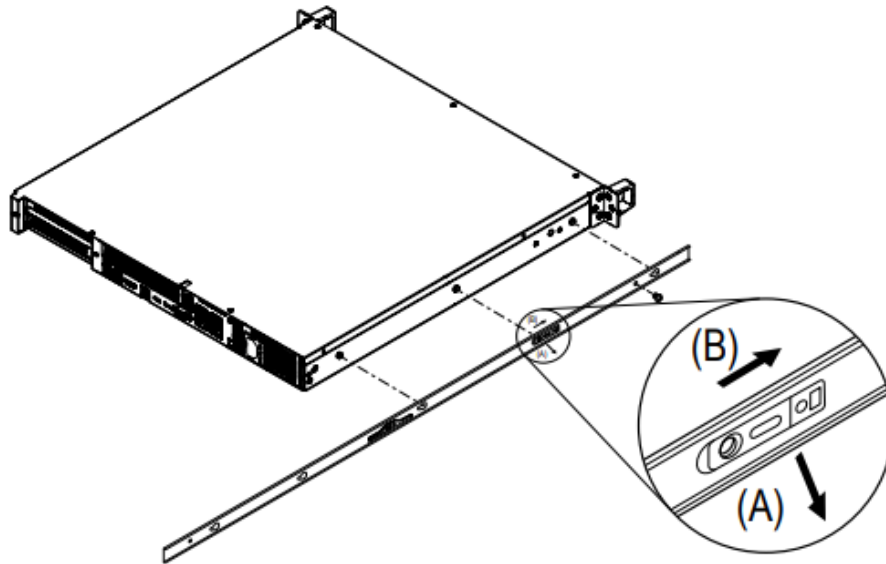

3. Press the released inner rail against the chassis of the server or AV system. Then lift the clip (A) and slide the inner rail toward the chassis rear (B).

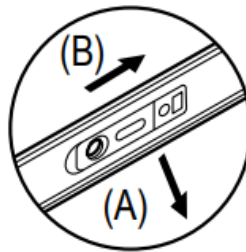

Rack Rail Installation

Server Racks

1. Lift the lever on the outer rail. Aim the rack mount pin at the front rack post and push forward to lock.

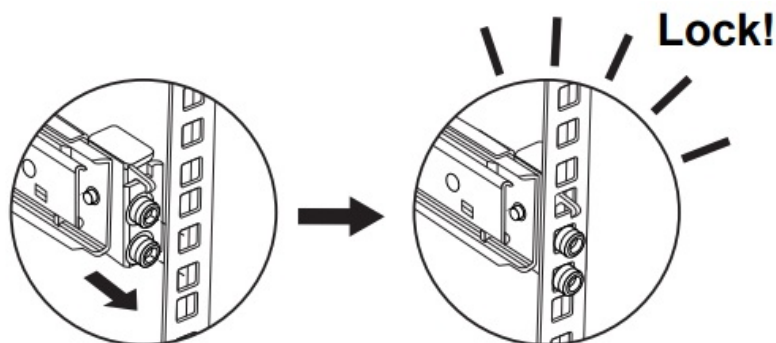

2. Lift the lever again. Align the rear rack mount pin to the rack post and pull back to lock the rear of the outer rail.

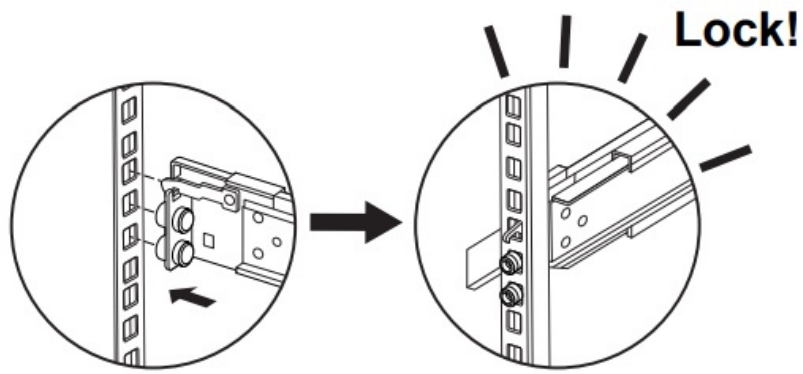

AV Racks

1. Align the front of the outer rail with the AV rack's round mounting holes. Insert and tighten #10-32 rack screws (two per side).
2. Repeat steps for the rear.

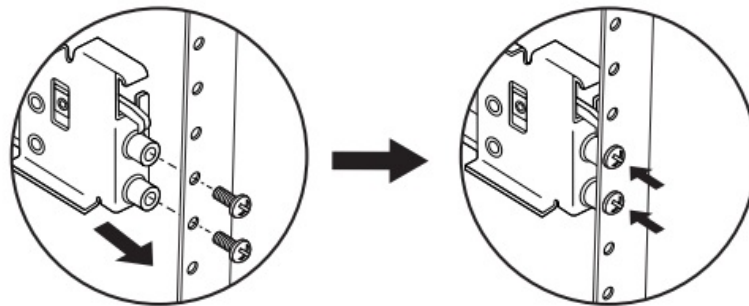

System Installation

Mount the system onto the rack:

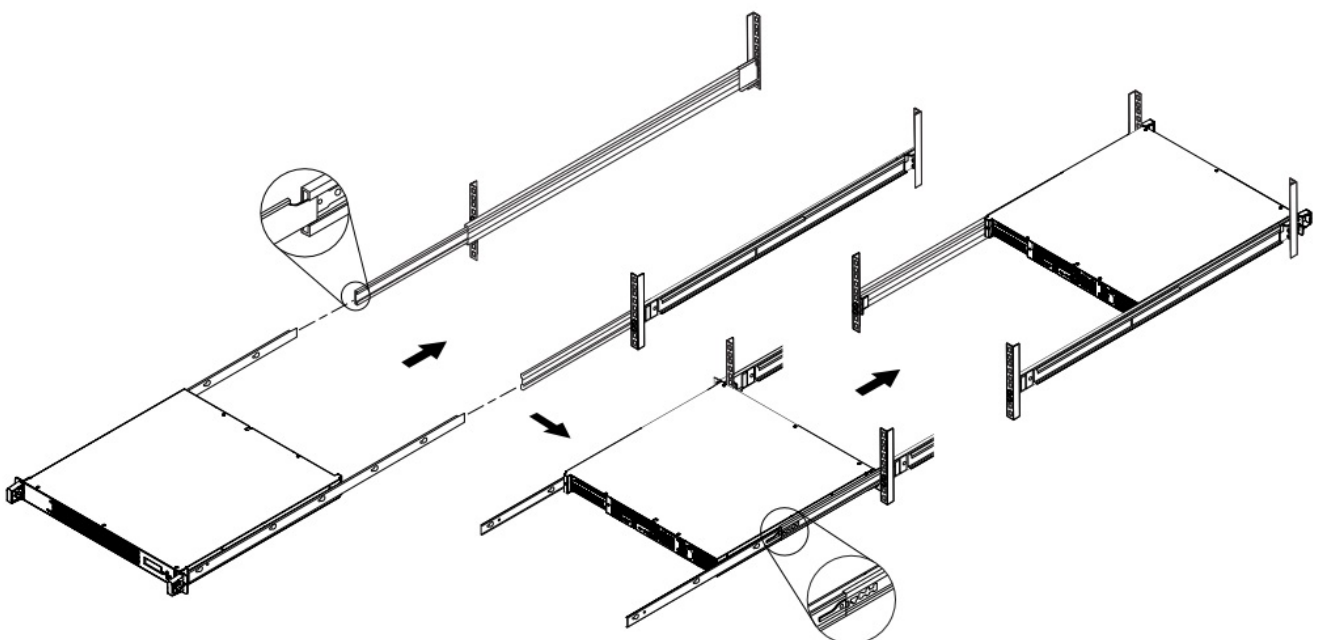

1. Ensure the ball-bearing retainer in the outer rail is locked in the forward position.

2. Pull the middle rail out of the outer rail until it locks.
3. Align the system's inner rails (attached in earlier steps) with the middle rail and push the system fully into the rack until it locks.

Outer Rail Removal

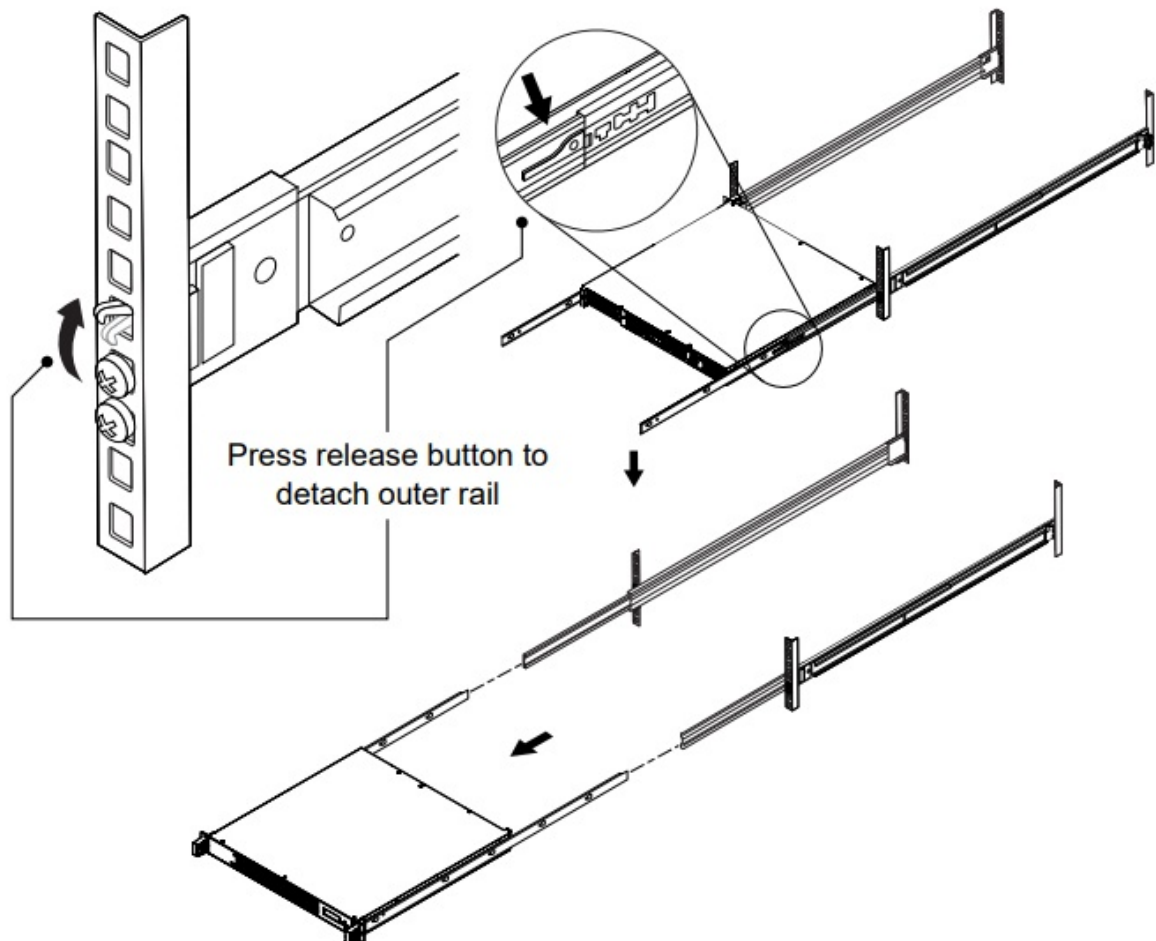

1. To remove the outer rail from the rack, press the release latch on the side of the rail.
2. Slide the rail out from the mounting rack.

Knowledge Base

Find answers to common questions, troubleshooting information, tips, and application notes. Link to support policies and resources, including Q-SYS Help, software and firmware, product documents, and training videos. Create support cases.

support.qsys.com

Customer Support

Refer to the Contact Us page on the Q-SYS website for Technical Support and Customer Care, including their phone numbers and hours of operation.

Warranty

For a copy of the QSC Limited Warranty, go to:

qsys.com/support/warranty-statement/

2025 QSC, LLC All rights reserved. QSC, the QSC logo, Q-SYS, and the Q-SYS logo are registered trademarks of QSC, LLC in the U.S. Patent and Trademark Office and other countries. Patents may be applied for or pending. All other trademarks are the property of their respective owners. qsys.com/patents.
qsys.com/trademarks

Documents / Resources

	<p>Q-SYS X10 Server Core Processor [pdf] User Manual</p> <p>WA-001009-01, WA-001009-01-A, X10 Server Core Processor, X10, Serv er Core Processor, Core Processor, Processor</p>
--	---

References

- [User Manual](#)

Leave a comment

Your email address will not be published. Required fields are marked *

Comment *

Name

Email

Website

☐ Save my name, email, and website in this browser for the next time I comment.

Post Comment

Search:

e.g. whirlpool wrf535swhz

Search

[Manuals+](#) | [Upload](#) | [Deep Search](#) | [Privacy Policy](#) | [@manuals.plus](#) | [YouTube](#)

This website is an independent publication and is neither affiliated with nor endorsed by any of the trademark owners. The "Bluetooth®" word mark and logos are registered trademarks owned by Bluetooth SIG, Inc. The "Wi-Fi®" word mark and logos are registered trademarks owned by the Wi-Fi Alliance. Any use of these marks on this website does not imply any affiliation with or endorsement.