



Pyronix HOMECONTROLHUB Security and Alarm System User Guide

[Home](#) » [Pyronix](#) » Pyronix HOMECONTROLHUB Security and Alarm System User Guide 



HOMECONTROLHUB USER GUIDE

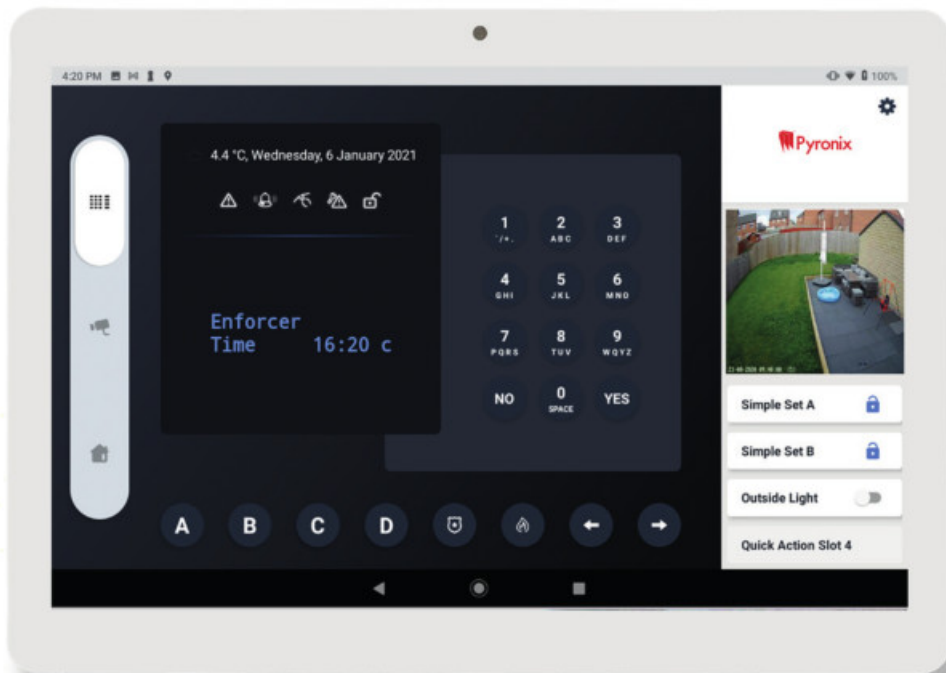

Document: RMKT090579-01

LightCamera

Smart Security Light Camera

Verify alarms and take action on-demand with a remotely activated siren and twoway talk, paired with powerful flood ligand full-HD video.

- Built-in siren, 100dB
- Two-way talk
- Night Vision, up to 60ft/18m
- Motion Detection
- Dual Lights, 2500 lm
- View via tablet app



<https://bit.ly/2CZirIY>

SmartPlug

Plug in to the Potential

Upgrade your home to a Smart Home with the SmartPlug. Take control of various plug in appliances and instantly manage them through the App interface, creating powerful scenes and automation.

- 13A load
- Instant control via tablet app
- Reduce your carbon footprint
- Create scenarios via the tablet app
- Connects to 2.4GHz Wi-Fi network



<https://bit.ly/2YCrAbQ>

Ask your installation company for more details.

Contents

- [1 INITIAL SET UP](#)
- [2 MAIN SCREEN OVERVIEW](#)
- [3 SETTINGS](#)
- [4 CAMERAS](#)
- [5 SMART HOMES](#)
- [6 Documents / Resources](#)
- [7 Related Posts](#)

INITIAL SET UP

PYRONIXCLOUD LOG IN AND ENFORCER CONNECTION

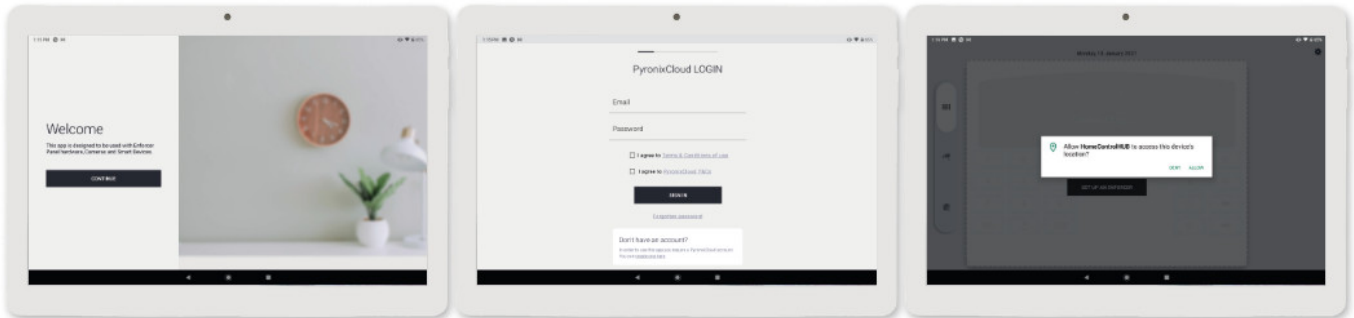

STEP 1

Download HomeControlHUB to a compatible tablet. Please check the Google Play Store for a list of compatible devices.

- Select the 'continue' button.

STEP 2

HomeControlHUB now needs to be connected to the End User's PyronixCloud account.

- Enter your PyronixCloud email address and password.
- Read and accept the T&Cs
- Click 'Sign In'.

STEP 3

HomeControlHUB will request access to the location of the device. This will allow it to search for the control panel.

- Select 'allow'.

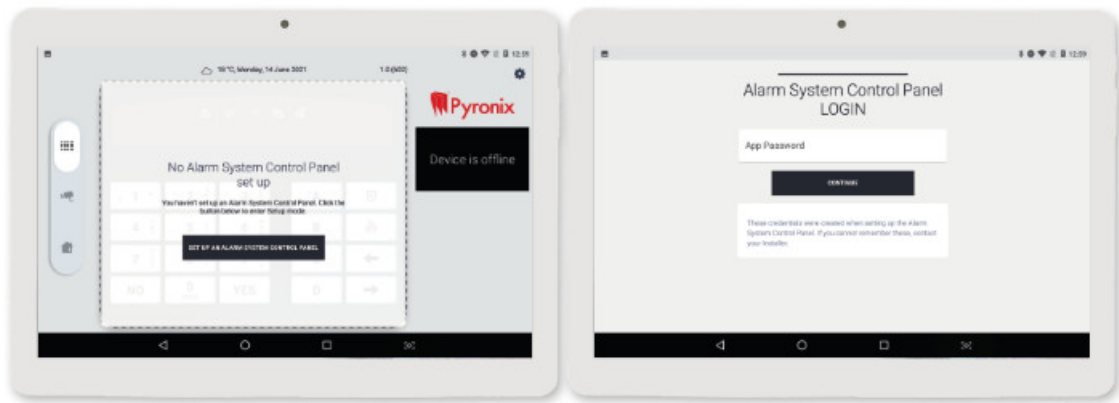

STEP 4

HomeControlHUB now needs to be connected to the Enforcer.

- Select 'Set Up an Alarm System Control Panel'.

STEP 5

HomeControlHUB needs one final security check before connecting to the panel.

- Enter the app password.
- Select 'continue'.



www.pyronixcloud.com

HIK-CONNECT OR PROCONTROL+ LOG IN

Visual surveillance products can be linked through a Hik-Connect account which supports both the ProControl+ and Hik-Connect apps.

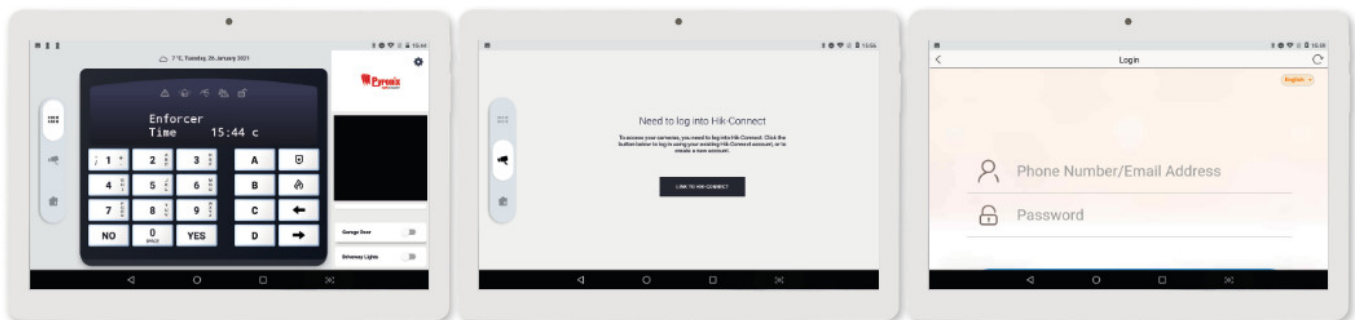

STEP 1

To add new or existing Hik-Connect cameras, tap the camera tab on the left side of the main screen.

STEP 2

Select 'Link to Hik-Connect' to be transferred to a webpage to log into or create a Hik-Connect account.

STEP 3

Enter the email address or phone number and the password of the existing HikConnect account. Select

'Authorized Login By Hik-Connect' (E.g. 4407798123456)

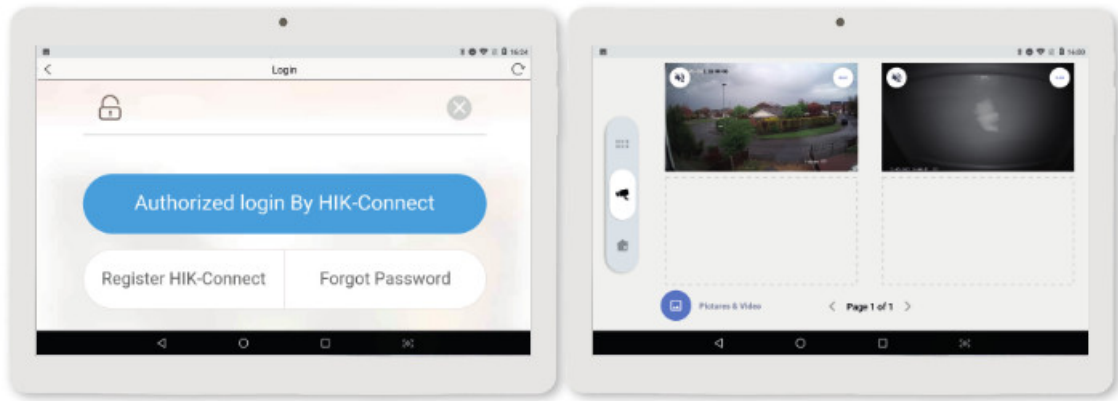

REGISTER

If you do not have an account, scroll to the bottom and select 'Register Hik-Connect' to create one.

STEP 4

Any cameras that have been added to this account will now appear on the camera's home screen.

Please note: Cameras with encrypted video streams require the entry of a verification code set in the camera when installed.



www.pyronix.com/uk/procontrol/

MAIN SCREEN OVERVIEW

Dashboard

The dashboard tab allows the user to control the system, view a selected camera and trigger quick actions.

Cameras

View live camera streams and saved media from the cameras.

Smart home

Automate devices to activate at certain times or when a panel event is triggered, create scenes that activate at the touch of a button, or switch devices on and off.

Settings

Allows for the customisation of the dashboard including changing the visual appearance of the dashboard, editing the quick actions available and selecting the quick view camera.

Company logo

If uploaded to the cloud account, the security installation company logo will be displayed here.

Camera quick view

A camera can be selected as a quick view on the dashboard. This will be a live stream from the chosen camera.

Keypad

Imitates a physical keypad allowing full programming whilst displaying the LCD screens and scrolling through the menu.

Quick actions

Configured quick actions can be selected so that they can be triggered directly from the dashboard.

SETTINGS

CUSTOMISE DASHBOARD

Keypad style

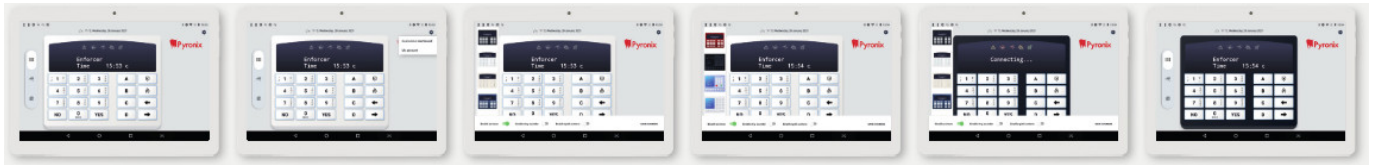

STEP 1

Tap the cog symbol in the top right corner.

STEP 2

Select 'Customise Dashboard'.

STEP 3

Swipe up/down to scroll through the available styles that appear on the left.

STEP 4

Tap to preview the keypad styles.

STEP 5

When a style has been selected, tap 'save changes' in the bottom right.

STEP 6

The keypad style has now been changed.



Live view camera



STEP 1

Tap the cog symbol in the top right corner.

STEP 2

Select 'Customise Dashboard'.

STEP 3

Tap 'Change Camera'.

STEP 4

Select the camera to add to the dashboard.

STEP 5

Tap 'Save Changes'.

STEP 6

The camera will now appear on the dashboard.

Quick actions



STEP 1

Tap the cog symbol in the top right corner.

STEP 2

Select 'Customise Dashboard'.

STEP 3

Tap the toggle switch next to 'Enable Quick Actions'.

STEP 4

The quick action slots are visible to the right. Tap to assign an action.

STEP 5

Tap the quick action category to reveal the available actions.

STEP 6

Select the action to link to the slot and tap 'Save Changes'.



STEP 7

If required, repeat steps 4, 5, and 6 for the other quick action slots.

STEP 8

Select 'Save Changes'.

STEP 9

Swipe up/down to scroll through the assigned quick actions on the right.

QUICK ACTION SLOT OPTIONS

Smart devices

Smart devices such as smart plugs have been learned to HomeControlHUB. Unless configured in a scene or automation, these are generally toggled on and off.

See 'Smart Devices' on page 16 for more information.

Scenes

Scenes are a sequence of events that are manually triggered by the user. They can include a single or multiple smart devices and delays between the actions of the smart devices if necessary.

See 'Scenes' on page 18 for more information.

Installer defined

Simple sets that are switched on in the panel.

Outputs

Pre-programmed actions of the security system intended to instruct another device to operate.

Typically these are physical outputs that are connected to an ancillary device such as a light, a set of lights or an electric gate.

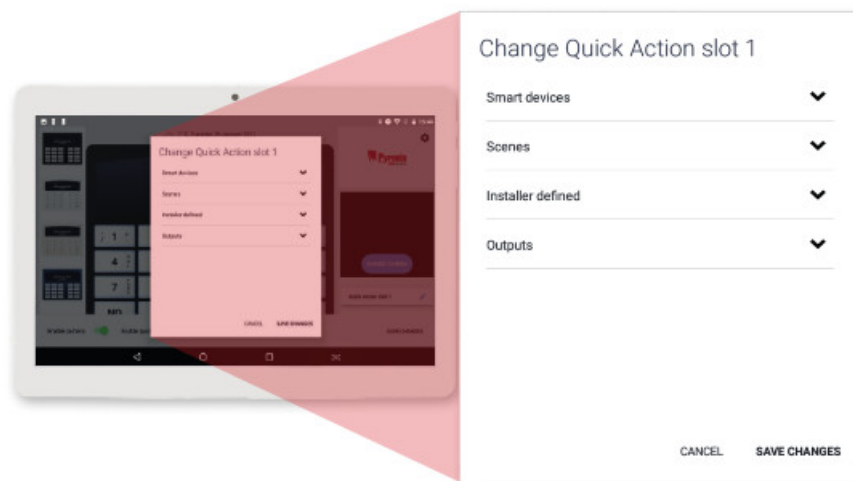

CAMERAS

ENCRYPTION AUTHORISATION

If the camera on the Hik-Connect or ProControl has an encrypted video stream, it requires entry of a verification code configured in the camera when installed.

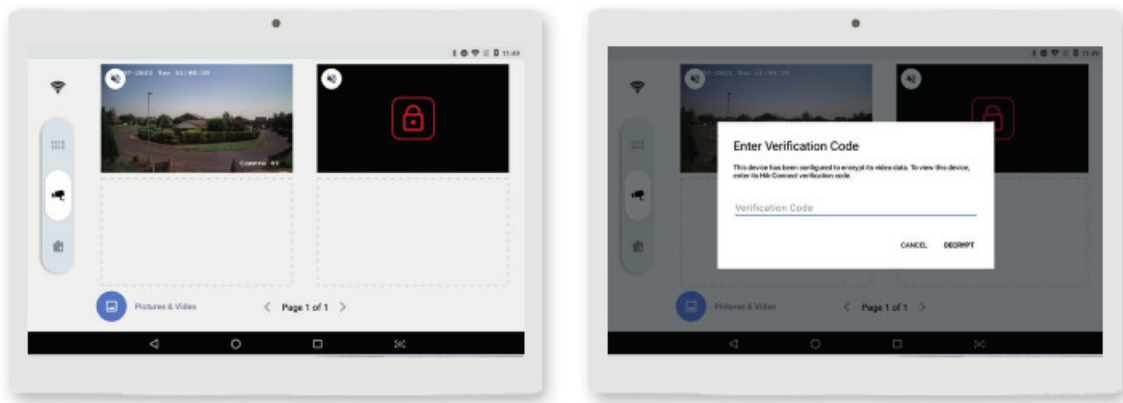

A camera requiring a verification code will appear blank with a red padlock. Tap the red padlock to enter the verification code.

The verification code was created when installing the camera. This needs entering here and tap 'Decrypt'.

OFFLINE DEVICES

If there is an issue with a camera stream, HomeControlHUB will display that the 'Device is offline'. If this message is displayed, the first thing to check/try are:

- The camera and the network router has power
- Re-connecting the camera to the Wi-Fi
- Check if settings have changed the wireless network and the router

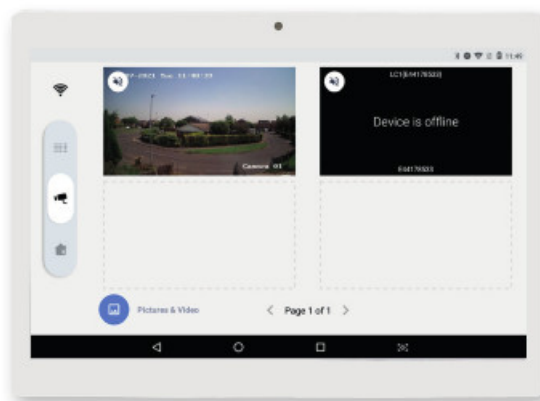

REORDERING CAMERAS (DRAG AND DROP)

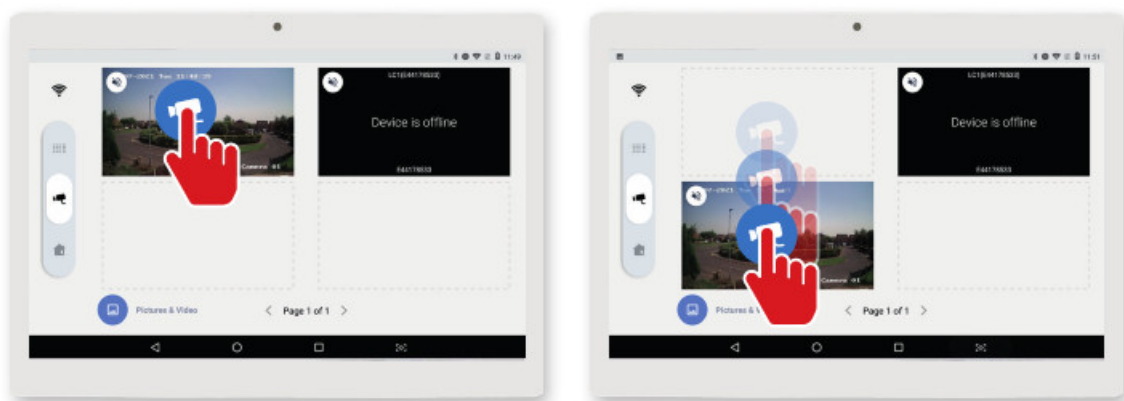

Press and hold on the stream that is to be moved until the blue camera icon appears. Drag the stream to the position the new position and then release.

CAMERA FULL-SCREEN OVERVIEW

Please note: The below functions may differ or not be accessible depending on the camera capabilities.

Mute

Press to toggle between audio and mute.

Stream quality

Switches the stream quality from high definition (HD) to standard definition (SD) and back.



Zoom

Move the slider up to zoom in and down to zoom back out. Once zoomed in, the screen can be panned by swiping.

Pan

Tap the arrows to rotate/pan the camera in that direction.

Record feed

Tap to start recording video of the live stream. Tap again to stop recording. This will then be saved to the tablet.

Take screenshot

Tap to take a still image of the current view. This will then be saved to the tablet.



SMART HOMES

SMART DEVICES



STEP 1

Tap the Smart Home tab on the left side of the main screen.

STEP 2

Tap 'Add New Smart Device'.

STEP 3

Following the on-display instructions, place the smart device in 'Discovery Mode' and press 'Continue'.

STEP 4

Enter the Wi-Fi credentials of the network that the smart device is to connect to and press 'Confirm'.

STEP 5

HomeControlHUB will now scan for smart devices in 'Discovery Mode'.

STEP 6

Once the device in 'Discovery Mode', has been found, HomeControlHUB will install it.



STEP 7

The smart device can now be given a name so it is easier to identify.

STEP 8

Tap 'Done'.

STEP 9

The device appears under the 'Smart Devices' column and can be toggled on or off by tapping the device name.





SCENES

Program a scene to initiate a series of tasks when triggered by the user, for example, switching the living room lamp on and the fan off simultaneously, or even with a delay between the two smart devices. Once initiated, it will progress until it has completed the full sequence.



STEP 1

Tap the Smart Home tab on the left side of the main screen.

STEP 2

Tap 'Create New Scene'.

STEP 3

Configure the first task of the sequence, it can be a device action or a delay.

Run a Device

To configure a device, select 'Run the device', a smart device from the drop-down menu and the function to run.

STEP 4

Select 'Add another task'.

STEP 5

Configure the second task of the sequence. It can be a device action or a delay.

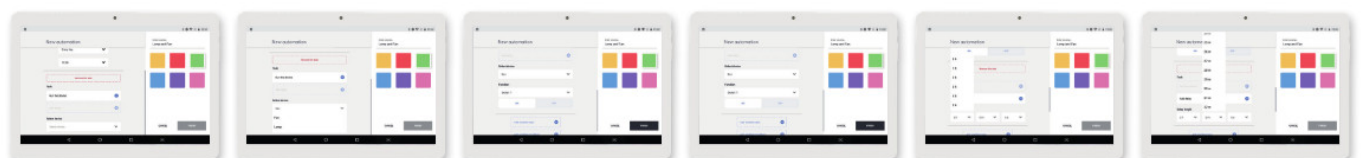

DELAY

To configure a delay, select 'Select delay' and enter the time delay period using the drop-down boxes.

STEP 6

Repeat steps 3, 4 and 5 to add more tasks to the sequence.

STEP 7

Tap 'Enter a name' and label the scene so it can be identified on HomeControlHUB.

STEP 8

Select a colour for the scene. This will determine the colour of the scene in the list. Tap 'finish' to complete.

STEP 9

The scene is now added under the 'Scenes' column and the sequence can be initiated by tapping the scene.

ACTIVATE THE SCENE

As the tasks in the scene are carried out, the smart devices can be seen switching on or off in the 'Smart Devices' column.



AUTOMATION

Automation is a preprogrammed series of events that will operate without the need to be triggered by the end-user.

Below is an example of an automation sequence where the fan switches on and after a delay, the lamp follows on.



STEP 1

Tap the Smart Home tab on the left side of the main screen.

STEP 2

Select 'Create new automation'.

STEP 3

Enter a name for the automation and pick the color it will appear in on the smart home screen.

STEP 4 – (schedule)

Select 'Schedule' and choose the days that the automation is to run on.

STEP 5 – (schedule)

Select 'Start time' then drag the circle to the hour that the automation is to start at.

STEP 6 – (schedule)

Repeat with the minutes past the hour then tap 'OK'.

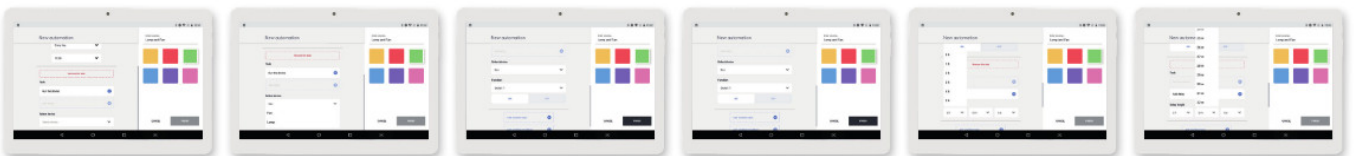

STEP 7 – (fan)

Select 'Run the device'.

STEP 8 – (fan)

Tap 'Select device' and choose the smart device that is to switch at the programmed time.

STEP 9 – (fan)

Select 'function', 'switch', then whether the smart device is to switch on or off at the programmed time.

STEP 10 – (delay)

Select 'Add another task' and then 'Add Delay'.

STEP 11 – (delay)

Select the number of hours that the delay is to last.

STEP 12 – (delay)

Do the same for the minutes and seconds.

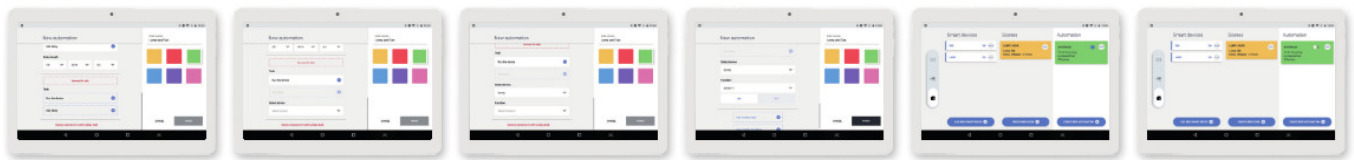

STEP 13 – (lamp)

Select 'Run the device'.

STEP 14 – (lamp)

Tap 'Select device' and choose the smart device that is to switch after the delay.

STEP 15 – (lamp)

Select 'function', 'switch', then whether the smart device is to switch on or off after the delay.

STEP 16

Tap 'Finish' to save the automation.

STEP 17

The created automation will now appear in the 'Automation' column.

TOGGLE ON/OFF

The automation can be toggled on and off using the slider next to the automation name.

SMART DEVICE APPLICATION CAPABILITIES CHART



SECURITY			
Arm/disarm areas	√	√	√
Trigger outputs	√	√	√
Bypass zones	√	√	√
Access system menus	√	X	X
View event log	√	√	√
View full panel log	√	X	X

Biometric authorization to the system	X	√	X
Geofence feature	X	√	X
Voice push notifications	X	√	√
VIDEO			
View cameras	√	Coming soon	√
Playback recordings	√	Coming soon	√
Add new cameras	X	Coming soon	√
Record live stream	√	Coming soon	√
Take screenshots	√	Coming soon	√
Camera controls	√	Coming soon	√
HOME AUTOMATION			
Add smart devices	√	Coming soon	X
Create scenes	√	Coming soon	X

Create automatic sequences	√	Coming soon	X
----------------------------	---	-------------	---

NOTES



Documents / Resources

	Pyronix HOMECONTROLHUB Security and Alarm System [pdf] User Guide HOMECONTROLHUB, Security and Alarm System
---	--

[Manuals+](#).