



Pyle PTVSP50BK Wireless TV Listening Speaker User Manual

[Home](#) » [Pyle](#) » Pyle PTVSP50BK Wireless TV Listening Speaker User Manual 

Contents

- [1 Pyle PTVSP50BK Wireless TV Listening Speaker](#)
- [2 Package Contents](#)
- [3 Features Identification](#)
- [4 CONNECTION AND SET UP](#)
- [5 Battery Charging](#)
- [6 OPERATION](#)
- [7 TROUBLESHOOTING](#)
- [8 CLEANING AND MAINTENANCE](#)
- [9 WHAT'S IN THE BOX:](#)
- [10 FEATURES](#)
- [11 TECHNICAL SPECS](#)
- [12 Frequently Asked Questions](#)
- [13 Related Posts](#)

PYLE

Pyle PTVSP50BK Wireless TV Listening Speaker



Please read this operating guide carefully before use and keep it for future reference. If you have any questions, please feel free to contact our Customer Service department

IMPORTANT SAFETY INSTRUCTIONS

Please read these instructions carefully before using the Wireless TV Speaker.

- Always keep the system dry. Do not immerse in water.
- For your safety, do not attempt to open the unit or battery compartment. Attempting to open or open the battery compartment violates your warranty.
- The Wireless TV Speaker uses a lithium-ion battery. Please observe the safety and handling instructions for the lithium-ion battery. Please dispose of the unit/used batteries properly, following any local regulations.
- Do not dispose of the unit/used batteries in the household trash. Do not incinerate.
Take the equipment to a nearby recycling center.
- Do not unplug by pulling on the cord. To unplug, grasp the plug, not the cord.
Unplug from the outlet when not in use and before servicing or cleaning.
- Do not operate any device with a damaged cord or plug, or after the device malfunctions, or is dropped or damaged in any manner. Return the device to the nearest authorized service facility for examination, repair or electrical or mechanical adjustment.
- This device is intended for home and personal use only.

Package Contents



1 Wireless Receiver
(Speaker)



2 AC Adapter



1 Transmitter Base



1 Audio Cord



1 Digital Optical Cord



1 Audio Switch Cable

Features Identification

Receiver

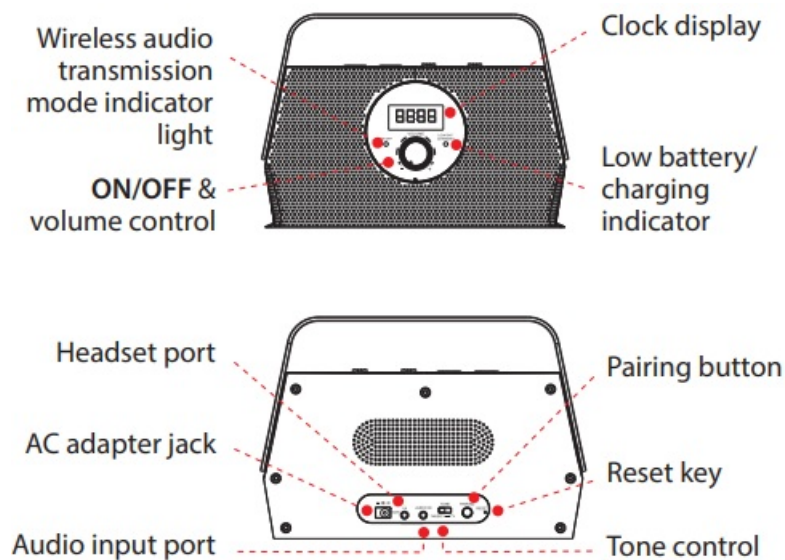

Wireless audio transmission mode operation description

CONNECTION AND SET UP

Select an Audio Connection:

Locate the Audio Out connector on the back of your TV.

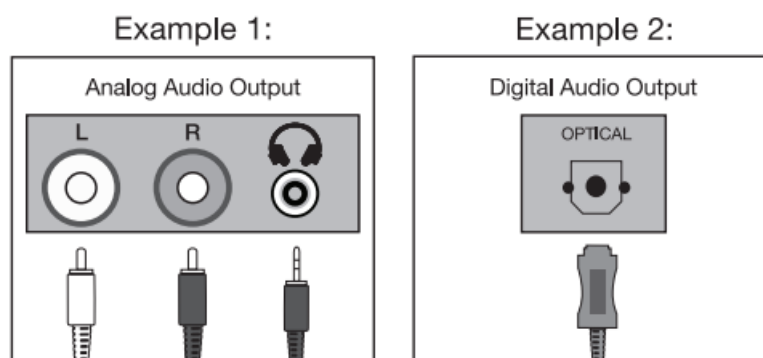

1. If your TV has an analog output connector (see example 1), the inserted audio cable can be used with the Wireless TV Speaker.
2. If your TV has a digital output connector (see example 2), plug in an optical cable and it will work with the Wireless TV Speaker.

For TVs, with audio-output ports

If your TV has a headphone jack, it's an analog output. Connect the base of the Wireless TV Speaker to the TV using the provided audio cable, as shown in the figure below.

Note

in most cases, the TV speaker volume will be muted when using this type of connection.

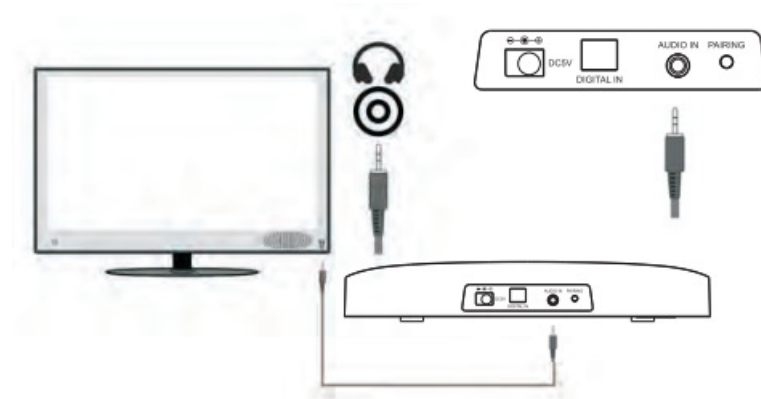

Wireless audio transmission mode operation description

For TVs with Audio-Out Ports (RCA Type)

If your TV has audio output RCA-type ports on the back of your TV, it is an analog output. Use the provided audio cable and connect the base of the Wireless TV Speaker to your TV as shown below.

PLEASE NOTE

In most cases, TV speakers are NOT muted with this type of connection.

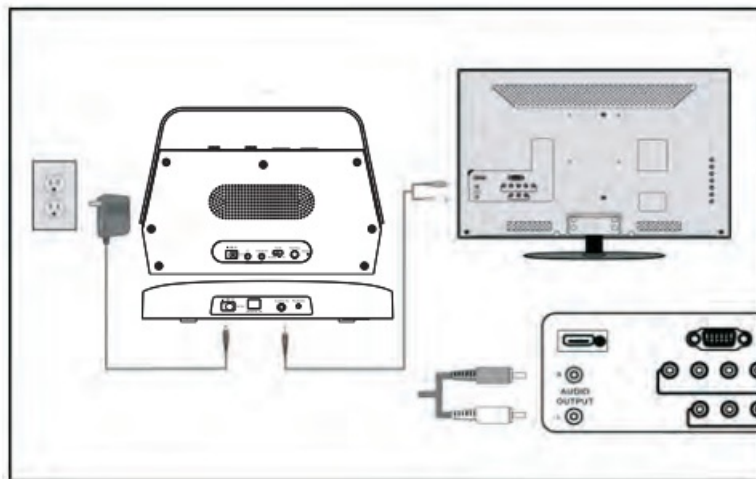

For TVs with Digital Output port (optical):

If your TV has a digital optical audio output port, using the included optical cable, connect it to the base of the Wireless TV Speaker as shown below. In most cases, TV speakers are NOT muted with this type of connection.

PLEASE NOTE:

Newer TVs have the option to set digital audio output to either Dolby or PCM. The Wireless TV Speaker only works with PCM audio format, simply set your TV to PCM digital output. Contact your TV manufacturer for assistance if necessary.

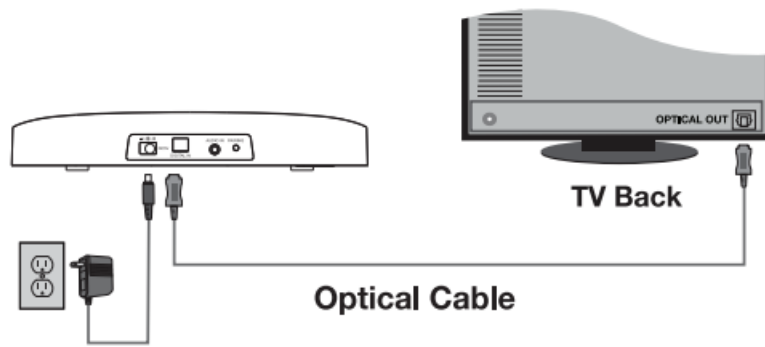

Wireless audio transmission mode operation description

Placement of Transmitter Base

For best results, place the Transmitter Base on top of your TV stand, or on top of your TV, as shown below.



Battery Charging

Place the receiver on the base (as shown) for charging for 6+ hours before first use. During charging, the Low Battery/Charge indicator blinks. When it is fully charged, the indicator light will stop blinking and stay steadily lit. A fully charged battery will give you up to 8 hours of listening time. When the receiver is not in use or when the Low Battery indicator blinks, place the receiver on the base for recharging.

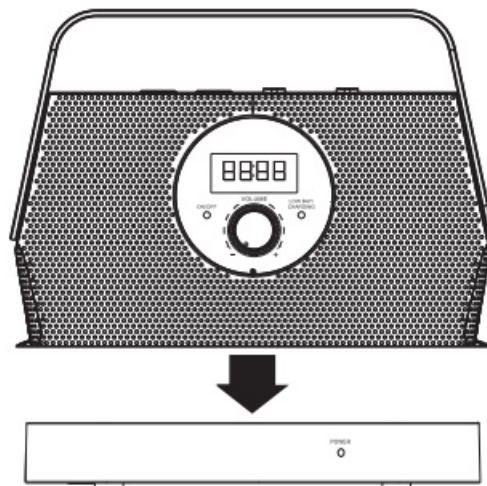

Wireless audio transmission mode operation description

OPERATION

ON/OFF, Volume, and Tone Control

1. Rotate the switch knob to turn the receiver on or off and adjust its volume, and rotate the mode switch to switch to 2.4G mode. At this time, the wireless audio transmission status indicator light is on.
2. You can turn your TV speaker to Low or to Off. On some TVs, you may need to use your remote to go into the TV's Menu to achieve an optimal audio/speaker setting. Please refer to your TV user manual for details.
3. To conserve battery power, the receiver will shift into standby mode if no audio signal is received from the base (after your TV is turned off) for a period longer than three minutes. The volume ON/OFF indicator will be off during this standby time. When an audio signal is received, the receiver will re-activate.

NOTE: If the receiver has hibernated too long and missed the contacts with the base, rotate the knob, turn off the receiver and then turn the receiver back on again to re-sync with the base.

4. Set the Tone Control to a position that enables you to hear and understand the dialog best.

Pairing Additional Receivers

You can add up to 50 receivers to work with your base. Each added receiver, must be "paired" with the base as follows:

- Make sure your new receiver is fully charged.
- Make sure your current base and receiver is working properly and audio is playing on the receiver.
- Continue the audio playing to the base and receiver.

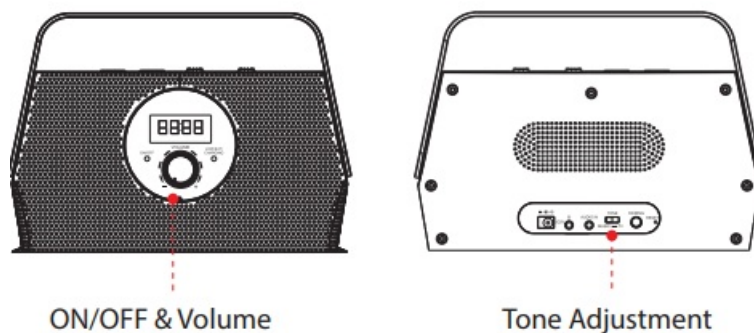

Wireless audio transmission mode operation description Pairing Additional Receivers (continued)

1. Turn the new receiver ON.
2. Press and hold (about 5 seconds) the PAIRING button on the bottom of the receiver until the ON/OFF indicator starts blinking. Pairing period is approximately 20 seconds.
3. Press and hold (about 3 seconds) the PAIRING button on the back of the base until the power indicator starts blinking. It will start pairing with the new receiver.
4. As soon as pairing is successful (less than 2 seconds), the new receiver's ON/OFF indicator will stop blinking, and audio sounds will be played within 5 seconds.
5. Repeat these steps again if pairing is not successful.

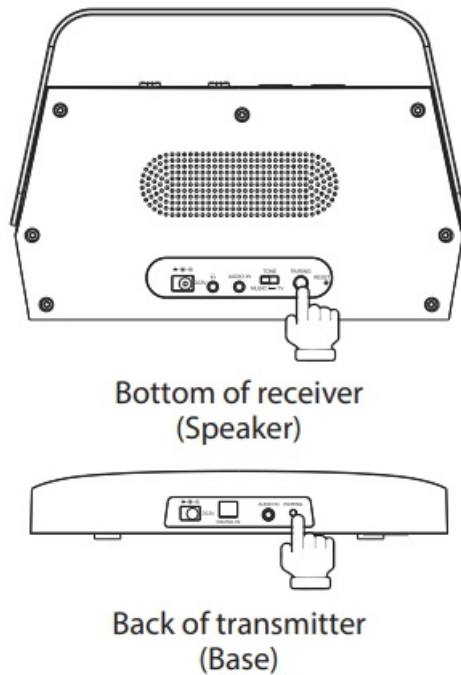

Using Headphones

Plug your headphones into the headphone jack as shown. No sound will be emitted from the speakers. Adjust the headphone volume by rotating the volume knob.

Wireless audio transmission mode operation description

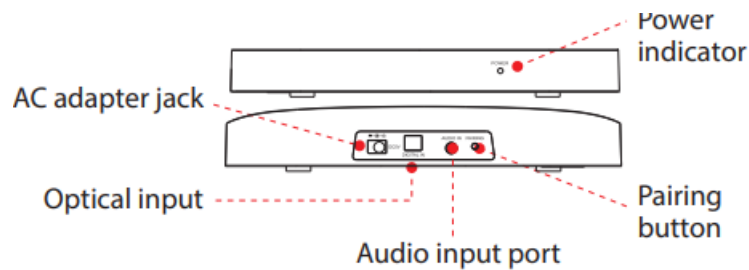

TROUBLESHOOTING

- **No sound from the receiver**

Check all connections to ensure that all the cords are firmly connected at the back of the base and TV. Also, confirm that the receiver is not more than 100 feet away from the base.

- **There is sound from the TV speaker, but no sound from the receiver**

Check your TV speaker setting by going into the TV Menu, using your TV remote, and ensuring the TV is sending audio signals to the base.

- **The Low Battery/Charging indicator keeps blinking on the receiver**

This indicates that the battery is low and needs to be placed on the base for recharging. When fully charged, the blinking will stop (in about 3 hours). If the blinking does not stop, check to make sure the receiver is firmly connected and properly aligned to the base.

CLEANING AND MAINTENANCE

Unplug the AC Adapter from the wall. Then, use a dry, soft cloth to clean and dust the outside surfaces and the charging contacts on the Base. Do not immerse the Receiver in water.

FCC INFORMATION °FOR U.S. CUSTOMERS ONLY, PART 15 OF FCC RULES INFORMATION

This device complies with Part 15 of the FCC rules. Operation is subject to the following two conditions:

1. this device may not cause harmful interference, and
2. this device must accept any interference received, including interference that may cause undesired operation.

This equipment has been tested and found to comply with the limits of a Class B digital device, pursuant to Part 15 of FCC rules. These limits are designed to provide reasonable protection against harmful interference in residential installation.

This equipment generates, uses, and can radiate radio frequency energy and, if not installed and used in accordance with the instructions, may cause harmful interference to radio communications. However, there is no guarantee that interference will not occur in a particular installation. If this equipment does cause harmful interference to radio or television reception, which can be determined by turning the equipment off and on, you may try one the following methods to correct the interference:

1. Where it can be done safely, re-orient the receiving television or radio antenna.
2. To the extent possible, relocate the television, radio, or other receiver, with respect to the cordless phone.
3. Connect the cordless phone AC adapter into a different electrical outlet.
4. Consult the dealer or an experienced radio/TV technician for help.

Modifications

Any modification not expressly approved by the manufacturer of this device could void the user's authority to operate the device.

This Class B digital device complies with Canadian ICES- 003, RSS 201 Issue 8.

WHAT'S IN THE BOX:



- TV Speaker
- Charging Transmitter Base
- Wall Power Adapter
- Digital Audio Cable
- RCA Cable
- 3.5mm Audio Cable

Warning

This product can expose you to a chemical or group of chemicals. vich may include "Acrylonitrile* which is known in the state of California to cause cancer, birt detects, or other reproductive harm, For more info, go to <https://www.p6swarnings.ca.gov/>

FEATURES

- Perfect for Bed-Side TV Listening
- Enjoy Wireless Audio from a Distance
- Connects to Your TV for Comfortable Sound Levels
- Avoid Excessive Noise & Place TV Audio Quietly Nearby
- Transmitter Base Sends Audio to the Speaker
- Dual Full Range Speakers
- Extended Wireless Range
- Universal TV Compatibility
- Built-in Rechargeable Battery
- Adjustable Rotary Volume Control
- Headphone Jack for Quiet Listening
- Hi-Fidelity Stereo Sound Reproduction
- Innovative FHSS Technology – Auto Signal Fine Tuning
- Also Compatible with Home Theater Systems, Stereos, Radios (PCM)
- Includes Clock Display

TECHNICAL SPECS

- Audio Transmission Frequency: 2.4Ghz
- Wireless Range: Up to 100'+ ft.
- FHSS (Frequency Hopping Spread Spectrum)
- Dual Speakers: 2 x 5 Watt, 4 Ohm
- Rechargeable Battery: 3.7V Lithium-ion, 1600mAh
- Power: 100/240V (DC 5V 1.5A Power Adapter)
- Speaker Size (L x W x H): 8.85" x 3.26" x 6.18" -inches

Questions? Issues?

We are here to help!

Phone: (1) 718-535-1800 Email: support@pyleusa.com

Frequently Asked Questions

What is the Pyle PTVSP50BK Wireless TV Listening Speaker?

The Pyle PTVSP50BK is a wireless speaker system designed for TV listening. It allows you to stream audio wirelessly from your TV to the speaker for a more personalized listening experience.

How does the wireless connection work?

The PTVSP50BK speaker connects to your TV using a wireless transmitter that plugs into the audio output of

your television. The speaker and transmitter pair wirelessly to establish a connection, allowing audio to be transmitted from the TV to the speaker.

What is the range of the wireless connection?

The wireless range of the Pyle PTVSP50BK is typically around 100 feet, which should provide sufficient coverage for most home setups. However, the range may vary depending on your specific environment.

Can I use the Pyle PTVSP50BK with any TV?

The PTVSP50BK is compatible with most TVs that have an audio output. It supports both analog (RCA) and digital (optical and coaxial) audio connections, so you should be able to connect it to your TV regardless of the available audio output options.

Can I connect multiple PTVSP50BK speakers to one transmitter?

No, the PTVSP50BK system does not support connecting multiple speakers to a single transmitter. Each speaker requires its own individual transmitter for wireless connectivity.

Does the PTVSP50BK have built-in volume controls?

Yes, the PTVSP50BK speaker has its own volume control buttons. You can adjust the volume directly on the speaker itself, allowing you to fine-tune the audio level according to your preference.

How is the sound quality of the PTVSP50BK speaker?

The sound quality of the PTVSP50BK is generally good, offering clear and balanced audio reproduction. However, it's important to note that sound quality can also depend on the source material and individual listening preferences.

Does the PTVSP50BK have a headphone jack?

No, the PTVSP50BK speaker does not have a headphone jack. It is primarily designed to provide audio for personal listening without the need for headphones.

What is the power source for the PTVSP50BK speaker?

The PTVSP50BK is powered by an AC adapter that needs to be connected to a power outlet. The speaker does not have a built-in battery, so it requires a continuous power supply.

Can I use the PTVSP50BK speaker without the wireless transmitter?

No, the PTVSP50BK speaker relies on the wireless transmitter for audio connectivity. The speaker cannot function independently or connect directly to other devices without the transmitter.

Does the PTVSP50BK support Bluetooth connectivity?

No, the PTVSP50BK does not have built-in Bluetooth functionality. It uses its proprietary wireless transmission technology through the included transmitter for audio streaming.

Can I use the PTVSP50BK speaker for purposes other than TV listening?

While the PTVSP50BK is primarily designed for TV listening, it can be used with other audio sources as long as they have compatible audio outputs. However, keep in mind that the speaker's features and design are optimized for TV audio, so its performance may vary when used with different sources.

—

Download this PDF Link: [Pyle PTVSP50BK Wireless TV Listening Speaker User Manual](#)

Manuals+.