

PXN VD4 Bundle Arcade Stick

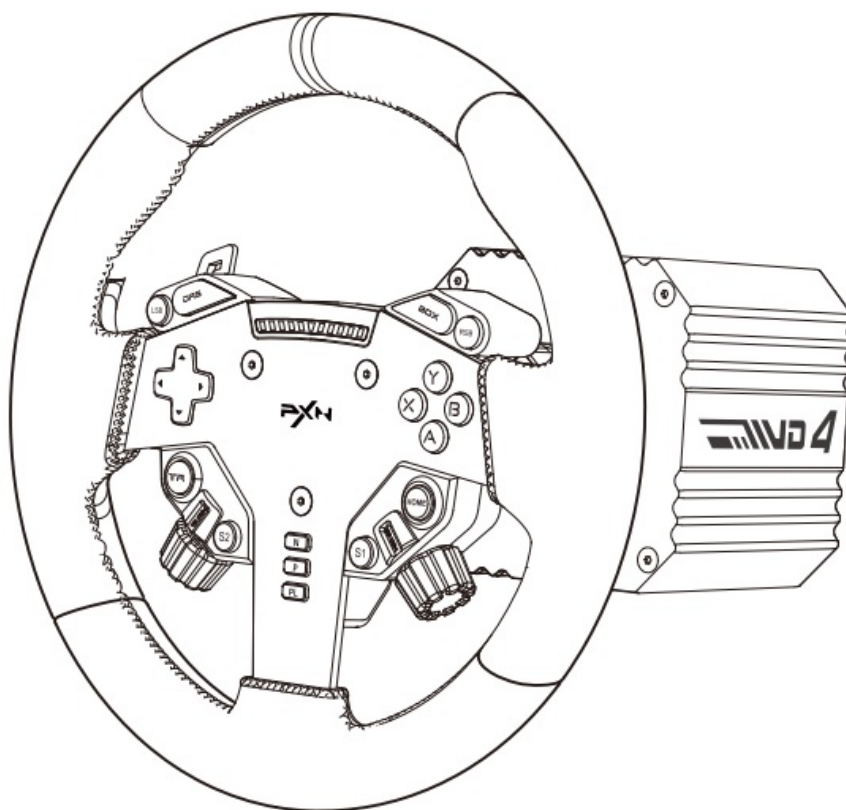

Contents [[hide](#)]

- 1 [Thank you](#)
- 2 [Safety](#)
- 3 [Ventilation](#)
- 4 [Temperature](#)
- 5 [Supported Platforms](#)
- 6 [Product Contents](#)
- 7 [Product Overview](#)
- 8 [Steering Wheel Installation](#)
- 9 [Base Mounting](#)
- 10 [Pedal Assembly](#)
- 11 [Use on PC](#)
- 12 [PC Software Configuration](#)
- 13 [E-STOP Switch](#)
- 14 [Product Specifications](#)
- 15 [Documents / Resources](#)
 - 15.1 [References](#)

Thank you

Thank you for choosing and supporting PXN. Please read this manual carefully before starting to enjoy your gaming experience.

Safety

WARNING

- When connecting, installing, and removing this product, apply appropriate force. Do not twist or pull the connectors.
- Avoid splashing any liquids onto the product or its ports.
- Keep this product in a dry place. Do not expose it to fire, or environments with high humidity, temperature, or smoke.
- Please use the power cable provided with the base. Do not use any other power cable.

- If the cable or its connectors are damaged, cracked, or broken, do not use the power cable.
- Ensure the power cable is properly inserted into the power socket and correctly connected to the port on the back of the base.
- Do not disassemble, modify, or attempt repairs on your own. Any maintenance must be performed by the manufacturer, their authorized representative, or qualified technicians.
- Only use accessories/components specified by the manufacturer.
- If any unusual sound, heat or odor occurs with this product, please stop using it and disconnect the power cable from the power outlet and unplug other cables.
- If the product is not used for a long time, please disconnect the power cable from the power outlet, which must be located near the product and must be easy to plug and unplug the power cable.

Ventilation

Make sure not to block any of the air vents on the racing wheel base. For optimal ventilation, ensure the following:

- Keep the racing wheel base at least 10cm away from any wall.
- Do not place the base in any confined space.
- Do not cover the base.
- Do not let any dust build up on the air vents.

Temperature

- If the device's temperature becomes too high (60°C and above) due to ventilation, environment, usage or other reasons, the base motor will automatically reduce the output power.
- If the device's temperature becomes too high (70°C and above) due to ventilation, environment, usage or other reasons, the base motor will automatically power OFF.
- Do not touch any part of the motor when the output power of the base motor is reduced or power OFF due to high temperature.

WARNING -Possible injuries caused by force feedback and repetitive movements

To prevent injury from force feedback and repetitive motions, please follow these usage recommendations:

- Avoid extended gaming sessions.
- Take a break of 10 to 15 minutes after each hour of using this product.
- If you feel any fatigue or pain in your hands, wrists, arms, feet or legs, please stop playing and rest for a few hours before you start playing again.
- If the symptoms or pain indicated persist when you start playing again, please stop playing and consult your doctor.
- Please keep out of children's reach.
- Ensure that the racing wheel base is secured according to the instructions in this manual.

Heavy Product!

Be careful not to drop the product on yourself or on anyone else!

Automatic Calibration

The racing wheel will automatically calibrate after successful connection and power ON. During calibration, the motor will rotate towards the left and the right before stopping at the center.

WARNING

To avoid improper calibration or personal injuries, please don't touch the racing wheel during the auto- calibration.

If the product do not operate correctly, or if calibration seems incorrect:

Turn off the PC and disconnect the power supply of this product entirely. Then reconnect all cables and accessories as well as restart the PC and then enter the game again.

The product can only be operated by users aged 16 or above.

WARNING – Pedal Clamping Hazard While Playing Games

- Keep the pedal set out of the reach of children.
- Never place your fingers on or anywhere near the sides of the pedals during play.
- Never place your fingers on or anywhere near the rear base of the pedals during play.
- Never place your fingers on or anywhere near the front base of the pedals during play.

NEVER



NEVER



NEVER



For safety reasons, never use the pedal set barefoot or with only socks on your feet.
PXN® is not responsible for injuries caused by using the pedals without shoes.

Automatic Pedal Calibration

The pedals are automatically calibrated by pressing the pedal to its maximum travel after a successful connection.

Supported Platforms

Supported Platforms: PC

PC System Requirement: Windows 7/8/10/11

Product Contents

- Steering Wheel *1

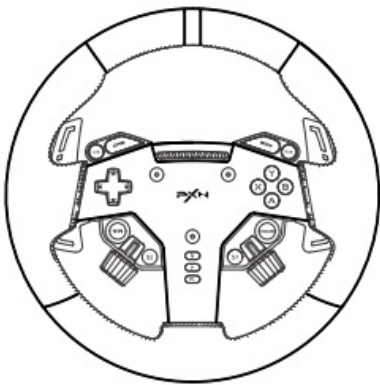

- Wheel Base *1

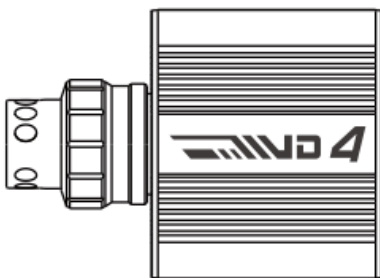

- Pedal *1

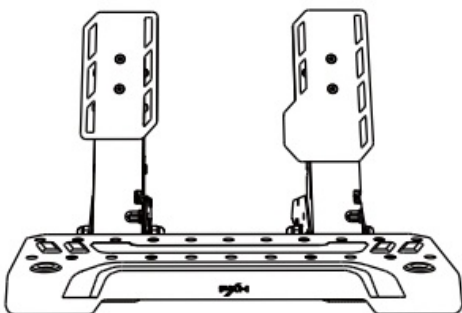

- Power Adapter *1

Pedal Dual Head RJ11

Crystal Head Data Cable *1

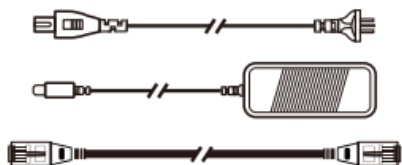

- TYPE-C to USB-A Data Cable *2

TYPE-C to TYPE-C cable *1

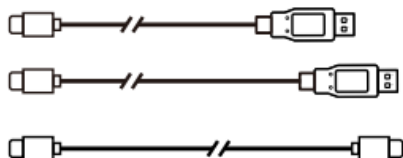

- User Manual *1



- M6 Nut *5



- M6 Washer *10



- Cable Clip *1



- 4mm Wrench *1



- 2.5mm Wrench *1



- KM6*50mm *2



- KM4x6mm *8



- TM6x30mm *2



- TM6x12mm*9



- M6 Double Open-End Wrench *1



Product Overview

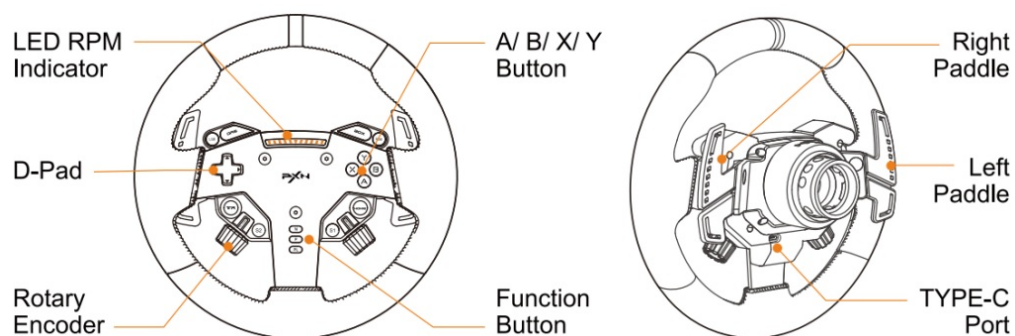

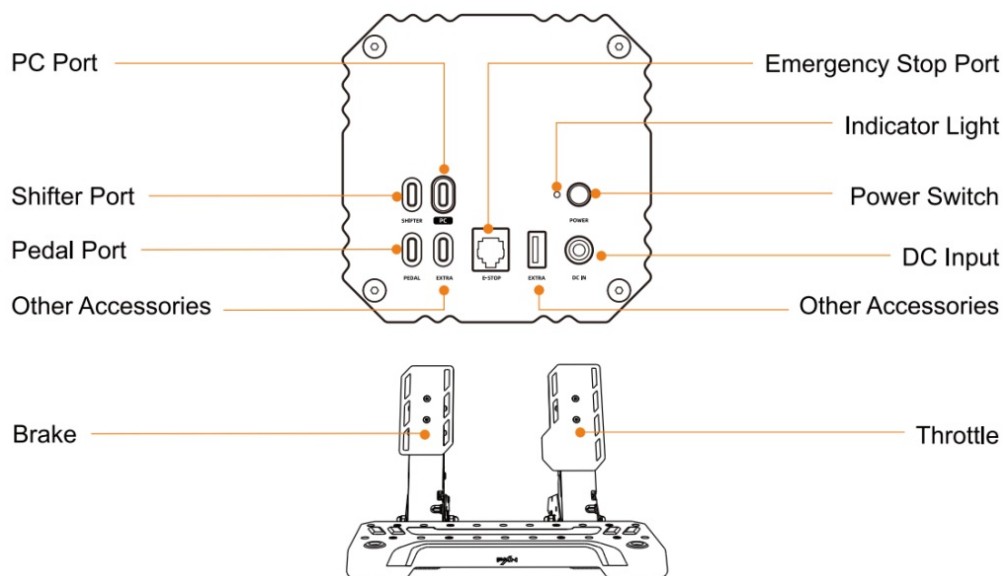

Steering Wheel Installation

Step 1 Align the 6/4 steel beads on the steering wheel quick-release hub with the corresponding grooves on the wheel base.

Step 2 Press the orange locking mechanism toward the steering wheel.

Step 3 Push the wheel fully into the base and release the orange mechanism. The quick-release will auto-lock. To remove, press the orange mechanism and pull the wheel outward.

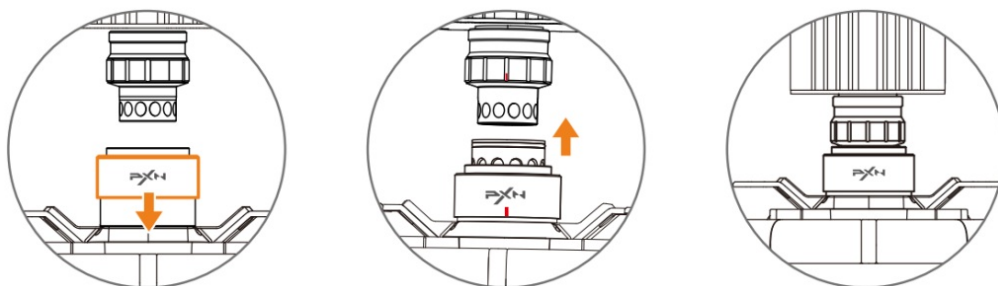

Note: After installation, firmly pull the steering wheel backward to confirm secure attachment. If loose, rotate the steering wheel slightly or reinstall it and repeat the check.

Base Mounting

* The base must be securely mounted to a sturdy sim rig or racing seat using screws.

Step 1 Position the base and align the bottom screw holes with the mounting holes.

Step 2 Secure using the provided screws and allen wrench.

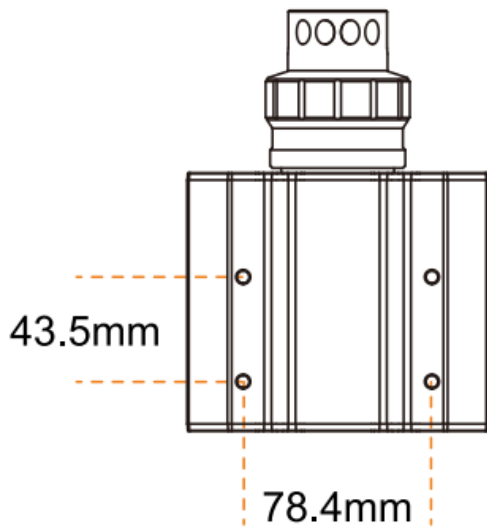

Pedal Assembly

Step 1 Remove the pedal set and footboard from the package.

Step 2 Use the RJ11 cable to connect the throttle module to the brake module.

Step 3 Insert the data cable and connect it to the wheel base or PC, then fix it to the bracket for use.

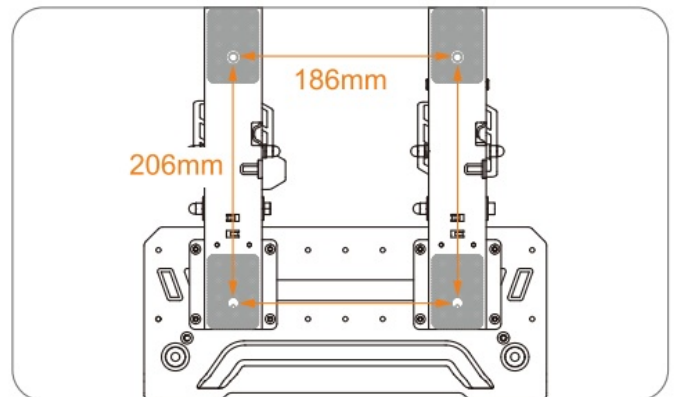
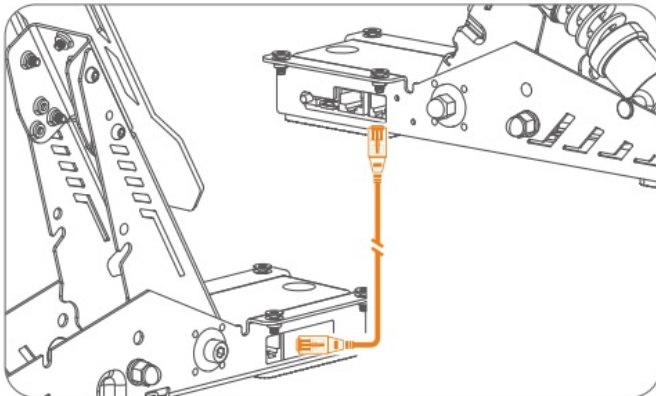

Use on PC

Step 1 Attach the steering wheel to the VD4 base.

Step 2 Connect the shifter and pedals to the corresponding ports on the back of the base.

Step 3 Mount the base securely and connect the power adapter.

Step 4 Connect the base to a PC via the Type-C data cable.

Step 5 After a successful connection, the base status LED will remain solid.

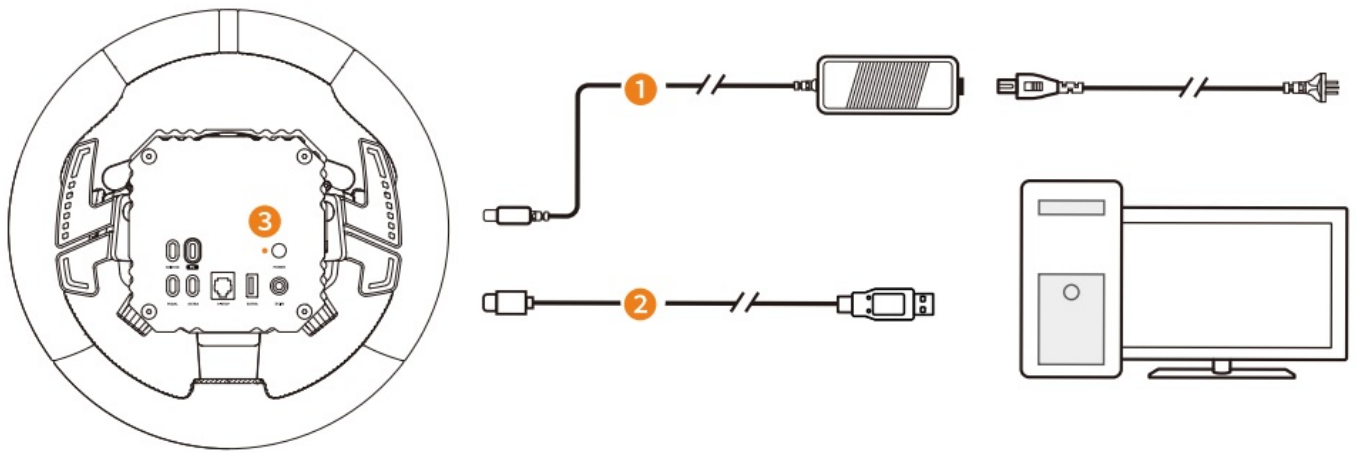

PC Software Configuration

Advanced Steering Wheel Configuration via PC Software. Download [PXN SimRacing]:

<https://www.e-pxn.com/news>

Scan the QR code to view more



Main Function:

- Effective steering angle setting
- Force feedback value adjustment
- Wheel base function test
- Steering wheel button test
- Steering wheel RPM light customization

E-STOP Switch

- * If an emergency stop switch is installed, make sure that the emergency stop switch is released before use.
- * The emergency stop switch needs to be purchased separately.

Step 1 Fix the emergency stop switch within reach of both hands and connect it to the E-STOP port on the back of the base.

Step 2 Press the emergency stop switch to cut off the base motor drive in case of emergency during use.

Step 3 Rotate the E-STOP switch clockwise to reset. Do not approach the wheel base at this time.

- Press to Emergency Stop:

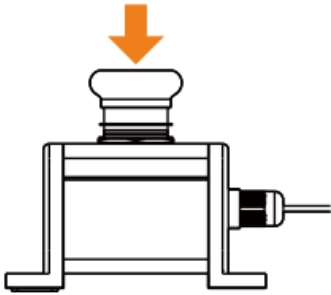

- Rotate to Reset:

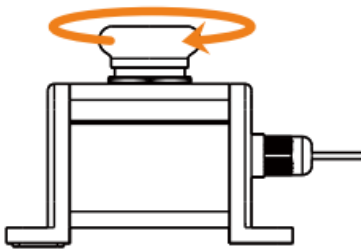

Product Specifications

Model	VD4 Bundle F
Connection Method	Wired Connection
Operating Voltage	DC24V (Motor), 5V (USB)
Operating Current	3A (Motor), ≤500mA (USB)
Package Dimensions	About 418 * 410 * 274mm
Product Dimensions	About 280 * 280 * 112mm (Steering Wheel) About 175 * 125 * 125mm (Wheel Base) About 350 * 342 * 224mm Pedal)

Product Weight	About 1050 g (Steering Wheel) About 3720 g (Wheel Base) About 2943 g (Pedal)
Operating Temperature	10 – 40 °C
Operating Humidity	20 ~ 80%



Warning

- Please read this user manual carefully before operation.
- Avoid strong vibration and dropping from heights.
- Do not disassemble, modify, or repair on your own.
- Prevent water or other liquids from entering the product to avoid damage.
- Avoid storing in damp, high-temperature, or oily environments.
- Use appropriate force when connecting and removing devices.
- Children should use this product under adult supervision.



Documents / Resources

	PXN VD4 Bundle Arcade Stick [pdf] User Manual VD4 Bundle Arcade Stick, VD4, Bundle Arcade Stick, Arcade Stick, Stick
--	---

References

- [User Manual](#)

📁 Arcade Stick, Bundle Arcade Stick, PXN, stick, VD4, VD4 Bundle Arcade

📁 PXN Stick

Leave a comment

Your email address will not be published. Required fields are marked *

Comment *

Name

Email

Website

☐ Save my name, email, and website in this browser for the next time I comment.

Post Comment

Search:

e.g. whirlpool wrf535swhz

Search

[Manuals+](#) | [Upload](#) | [Deep Search](#) | [Privacy Policy](#) | [@manuals.plus](#) | [YouTube](#)

This website is an independent publication and is neither affiliated with nor endorsed by any of the trademark owners. The "Bluetooth®" word mark and logos are registered trademarks owned by Bluetooth SIG, Inc. The "Wi-Fi®" word mark and logos are registered trademarks owned by the Wi-Fi Alliance. Any use of these marks on this website does not imply any affiliation with or endorsement.