



PURMO CVF Flex Floor Bracket Instruction Manual

[Home](#) » [PURMO](#) » PURMO CVF Flex Floor Bracket Instruction Manual 

Contents

- 1 PURMO CVF Flex Floor Bracket
- 2 Product Usage Instructions
- 3 SPECIFICATION
- 4 Installation Guide Floor bracket
- 5 Documents / Resources
 - 5.1 References



PURMO CVF Flex Floor Bracket



Product Information:

- Product Name: Flex Floor Bracket (CVF/FCVF/RCVF)
- Type: T11 / T21 / T22 / T33
- Height: 300 – 900 mm
- Manufacturer: Purmo Group Plc
- Address: Bulevardi 46, P.O. Box 115, FI-00121 Helsinki
- Website: www.purmogroup.com
- Product Code: PMI536 – Rev 0

Product Usage Instructions

Important Note: For the correct installation of radiators using the Flex Floor Bracket, it is essential to follow the instructions and consider various factors to ensure safe and proper usage.

1. Before installation, carefully read the entire user manual and make sure you understand all the instructions.
2. Ensure that the fixing method used to secure the radiator to the floor is suitable for both intended use and potential misuse.
3. Consider the type and condition of the floor before finalizing the installation. The floor should be able to support the weight of the radiator and withstand any additional forces.
4. Begin by attaching the Flex Floor Bracket to the radiator. Use the appropriate bracket type (T11, T21, T22, or T33) based on your specific radiator model.
5. Adjust the height of the bracket within the range of 300 – 900 mm to ensure proper positioning.
6. Once the bracket is attached, secure the radiator to the floor using the recommended fixing method.
7. Ensure that the radiator is stable and does not wobble or move after installation. If there are any issues, recheck the installation steps and make necessary adjustments.
8. Do not exceed the maximum weight capacity specified for the Flex Floor Bracket. For F1 brackets, the

maximum weight capacity is 220 kg per bracket.

9. Regularly inspect the installation to ensure it remains secure and in good condition. If any damage or issues are detected, take appropriate action to rectify them to maintain safe usage.
10. Follow all local regulations and guidelines related to radiator installation and safety.

Important Safety Warning: Improper installation and use of the Flex Floor Bracket may result in damage or accidents. The manufacturer assumes no liability for any such damages caused by improper installation and use.

SPECIFICATION

BH	BL	No.
300 - 500	400 - 1800	2
	2000 - 3000	3
600 - 900	400 - 1200	2
	1300 - 1800	3
	2000 - 2300	4
	2600 - 3000	5



 220 kg / bracket

BL	X	Y
400	~116	~80
500 - 3000	~150	~90

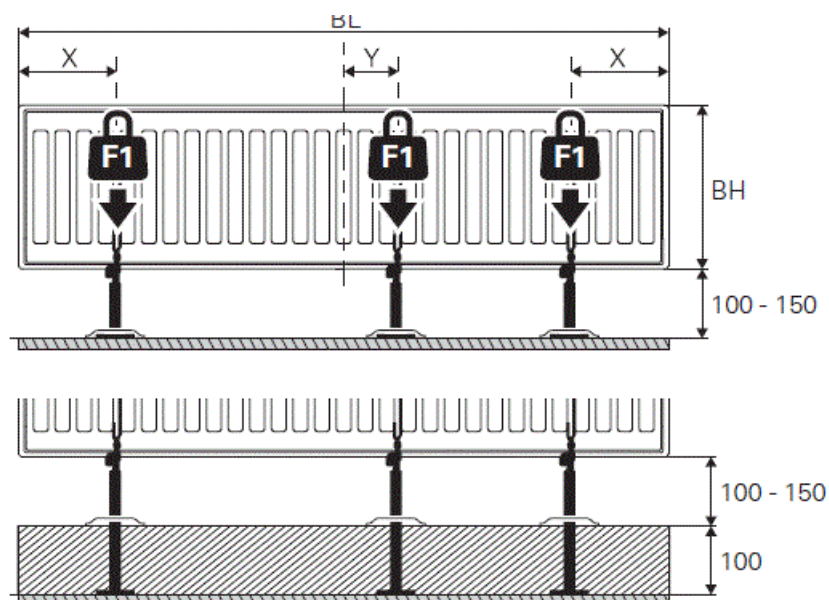

Installation Guide Floor bracket

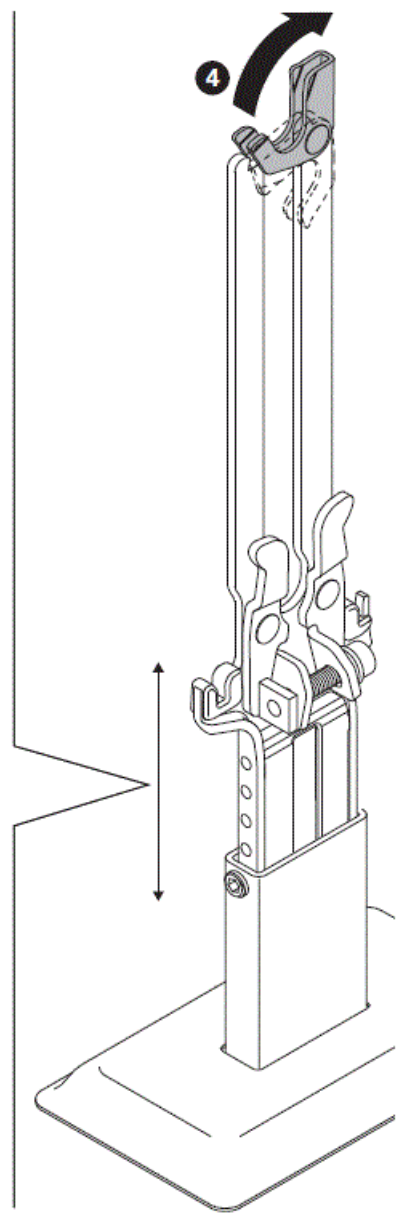
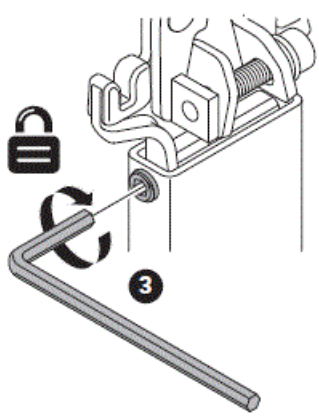
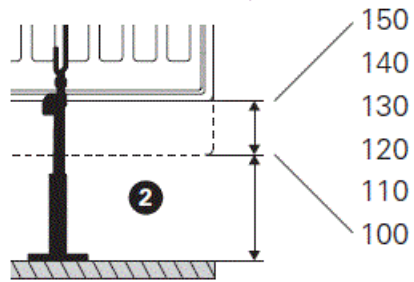
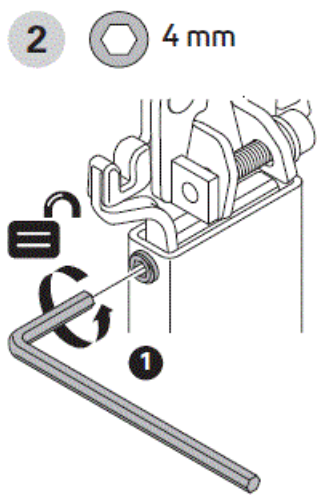

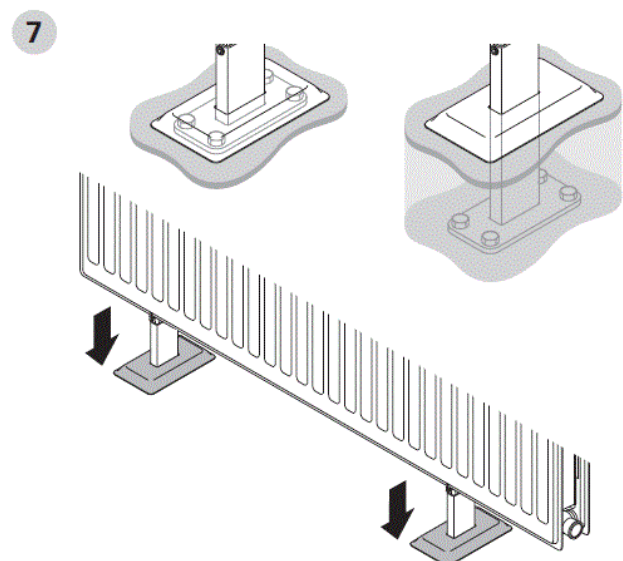
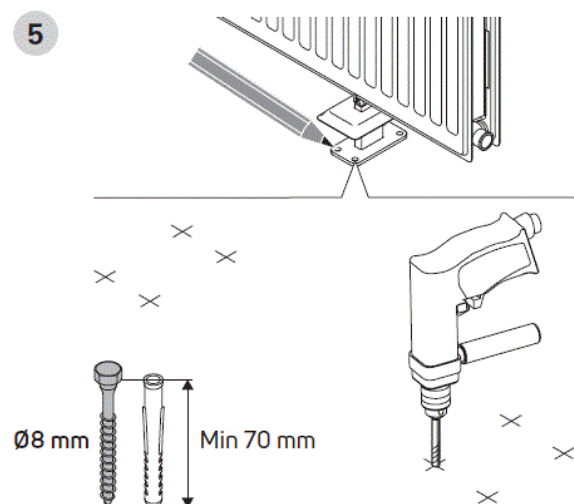
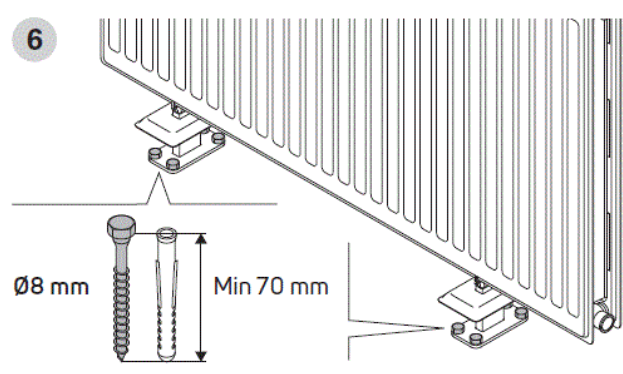
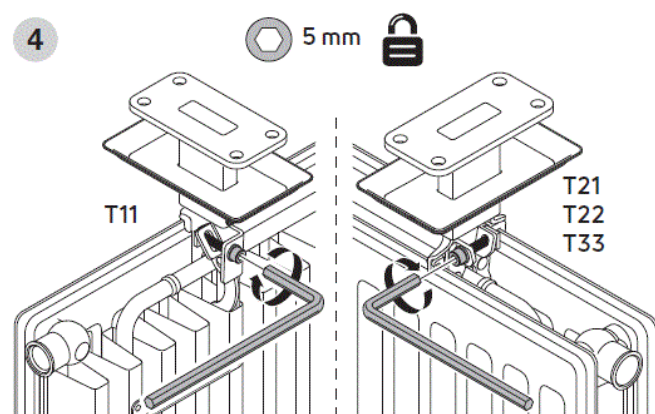
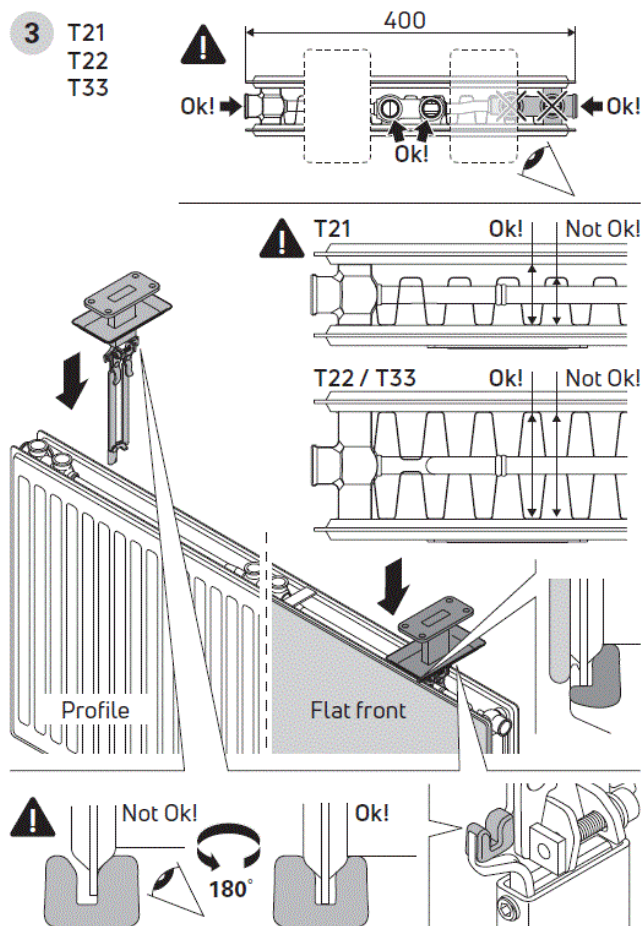
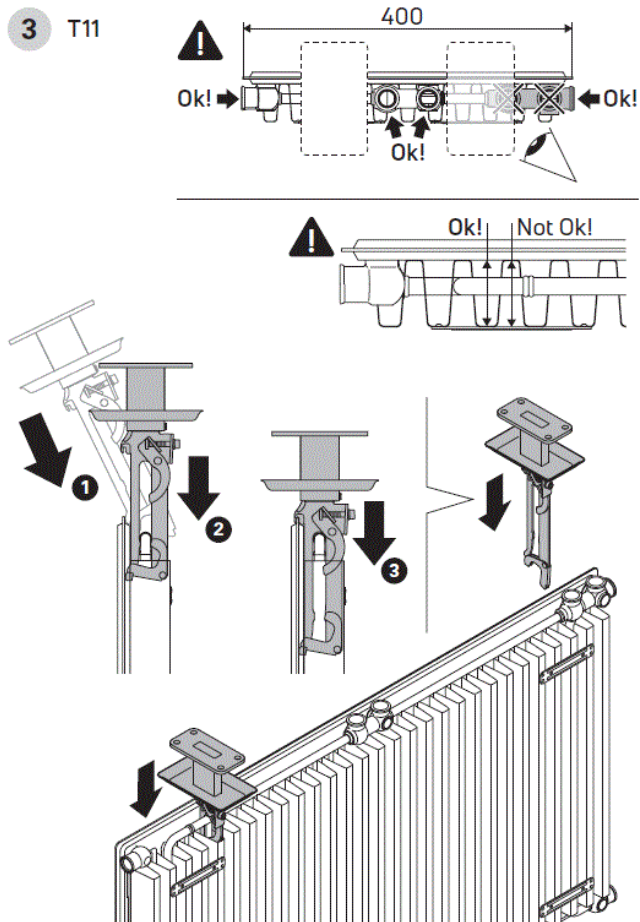

IMPORTANT!

For the correct installation of radiators it is essential that the fixing of the radiator is carried out in such a way that it

is suitable for intended use AND predictable misuse. A number of elements need to be taken into consideration including the fixing method used to secure the radiator to the floor, the type and condition of the floor itself, and any additional potential forces or weights, prior to finalising installation.

We assume no liability for damage caused by improper installation and use!

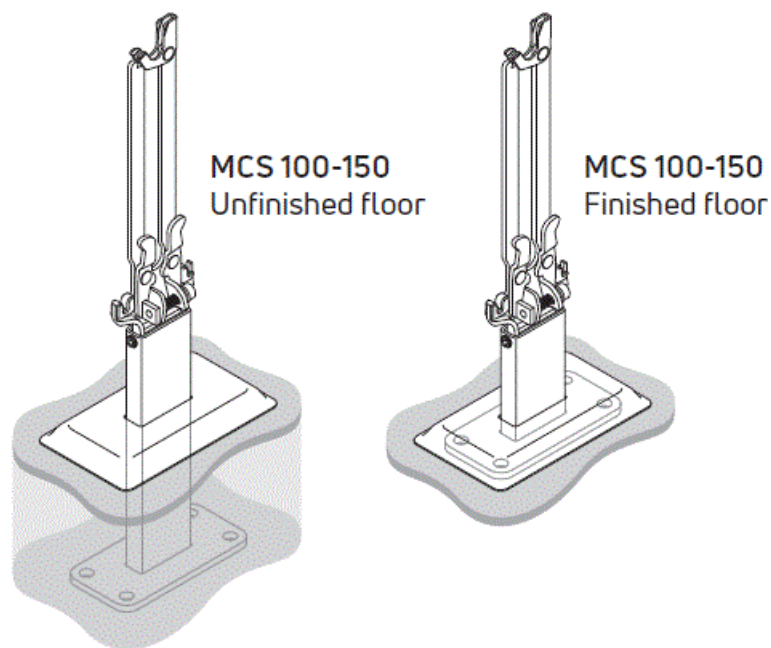

Flex Floor Bracket (CVF/FCVF/RCVF)

- **Type:** T11 / 21 / 22 / 33
- **Height:** 300 – 900 mm

Purmo Group Plc

Bulevardi 46, P.O. Box 115

FI-00121 Helsinki

www.purmogroup.com

Documents / Resources

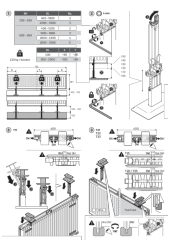
	<p>PURMO CVF Flex Floor Bracket [pdf] Instruction Manual CVF, FCVF, RCVF, CVF Flex Floor Bracket, Flex Floor Bracket, Floor Bracket</p>
---	---

References

- [Purmo Group - Complete solutions in heating and cooling](#)

