

## Puretec RU194-4 Reverse Osmosis Filter System User Guide

[Home](#) » [Puretec](#) » Puretec RU194-4 Reverse Osmosis Filter System User Guide 

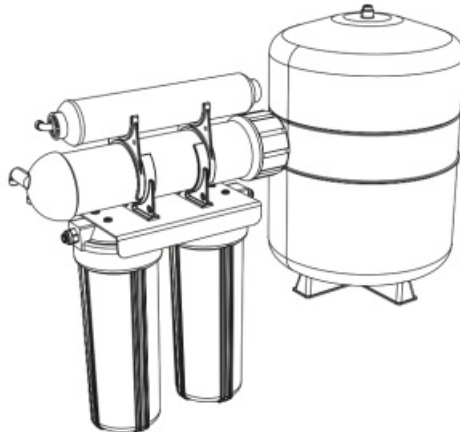

User Guide

Reverse Osmosis Filter System | **RU194-4**

For correct operation & installation, it is essential to observe these instructions.

## Contents

- [1 Puretec Customer Service](#)
- [2 Operation](#)
- [3 Cartridge Replacement](#)
- [4 Cartridge Install](#)
- [5 Installation](#)
- [6 Installation Requirements](#)
- [7 Fig. 1 – Parts Diagram](#)
- [8 Installation Procedure](#)
- [9 Fig. 2 – How To Use Quick Connect Fittings](#)
- [10 Use Guidelines](#)
- [11 Warranty](#)
- [12 Documents / Resources](#)
- [13 Related Posts](#)

## Puretec Customer Service

Thank you for purchasing a Puretec Basic under sink drinking water system. Your system is a proven performer manufactured from only quality materials and components and will give years of 'spring fresh' water free of impurities if maintained properly.

The system is designed for metropolitan supply water but can be used in other situations. For other types of water supply please contact your stockist. The Puretec Basic filter systems cartridges need replacing regularly to maintain optimum performance. This is a simple procedure when following instructions. For cartridge replacements contact your stockist.

## Operation

The Puretec Basic under sink systems are designed to run economically for many years dependent on the initial installation and periodical maintenance.

Flush systems for 10 minutes after any period of non-use more than 2 days. For a period of non-use of 2 weeks or more, it may be necessary to replace cartridges.

Caution: Do not use with water that is microbiologically unsafe or with water of unknown quality without adequate disinfection before or after the system.

## Cartridge Replacement

To maintain the high quality of the purified water the cartridges need changing every 6 months dependent on water quality and usage.

You can obtain replacement cartridges from your dealer and to maintain performance, and warranty use genuine Puretec replacements.

	Stage 1	Stage 2	Stage 3	Stage 4
Replacement Parts:	Sediment Removal Cartridge	Taste & Odour Removal Cartridge	Inline Filter Cartridge	Reverse Osmosis Membrane
RU194-4	MB051	EC051	IN142	MMT-1812-75

## Cartridge Install

To change the filter cartridges adhere to the following procedure.

1. Close ball valve to prevent water flow, close tank valve.
2. Relieve water pressure by operating faucet lever.
3. Unscrew Filter Housing using the spanner wrench and discard cartridges. When removing housings place a container underneath to catch any spillage. Membrane housing cap can be unscrewed by hand.
4. Clean the inside of the housing. Check O-ring and lubricate with food grade silicone lubricant or similar. Replace O-ring if kinked or damaged.
5. Install new cartridges and replace housing screwing them up HAND TIGHT ONLY. Puretec MB051 filter is on the inlet side and Puretec EC051 on the outlet side.

**NOTE:** When removing the membrane from the packaging, only remove the outer shrinkwrap packaging, DO NOT remove any other packaging from the membrane.

6. Restore water supply & check for leaks, rectifying them, if any, before leaving the unit.  
After installing cartridges flush unit for 5 – 10 minutes.

## Installation

This system comes complete with an installation kit enabling it to be connected to 15 mm (1/2") copper pipe (cold supply only – hot water should be filtered prior to heating). Included is a control valve incorporating backflow prevention, anti hammer, flow control and pressure limiting capabilities according to The Australian Standards in full compliance with the relevant laws.

**Note:** the PLV is standard in selected systems.

Installation Note: A water filter system/tap, like any product, has a limited life and may eventually fail. Also sometimes failure happens early due to unforeseen circumstances. To avoid possible property damage, this product should be regularly examined for leakage and/ or deterioration and replaced when necessary. A drain pan, plumbed to an appropriate drain or outfitted with a leak detector, should be used in those applications where any leakage could cause property damage, and/or the water supply should be turned off if no one is home/present.

## Installation Requirements

1. 15 mm (1/2") cold water line.
2. Mix/Max pressure: 300 – 600\* kPa.
3. Min/Max temperature: 0° – 38 °C (protect from freezing).
4. Suitable location for faucet.

Alternative fittings may be required if being connected to anything other than 15 mm (1/2") copper pipe. No electrical or drainage requirements needed. \*If pressure exceeds 500kPa an approved pressure limiting device needs to be fitted.

## Fig. 1 – Parts Diagram

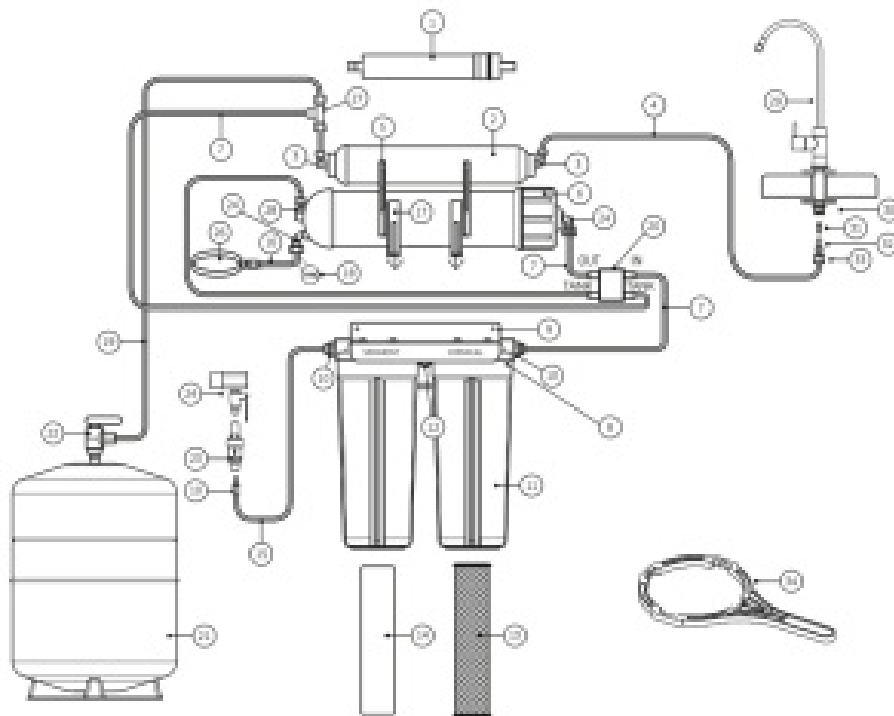

No.	Part No.	DESCRIPTION	Qty
1	MMT1812-75	Filter Membrane	1
2	IN142	Inline Filter	1
3	KEA44	1/4" Quick Connect Elbow	2
4	KTU4BL	Tube – Blue	2m
5	ROR-MILB	Bracket – Membrane to Inline	2
6	ROR-HM	Membrane Housing	1
7	KTU4W	Tube – White	Fitted
8	HDOR	10" Housing O-ring	2
9	HDBK12	Bracket	1

10	KSA44	Quick Connect Straight Adaptor	3
11	HD1006-S	10" Housing	2
12	BFN004	1/4" Hex Nipple	1
13	ECO51	5 Micron, 10" Carbon Block Cartridge	1
14	MBOS1	5 Micron, 10" Melt Blown Cartridge	1
15	KTU4G	Tube – Green	2m
16	KTU4BK	Tube – Black	2m
17	RA-MB	Bracket – Bracket to Membrane	1

18	RA-FRSO	Flow Restrictor	Fitted
19	KTU4Y	Tube – Yellow	1
20	RA-VSOC	RO Shut-off Valve	1
21	RA-T3.2	Tank – 12 Litres	1
22	KSOVE44N	Quick Connect Elbow Shut-off Valve	1
23	PVM45PH	Pressure Limiting Valve	1
24	KEA42	Y4" x 1/2" Quick Connect Elbow	2
25	BFA700	Ball Valve Adaptor	1
26	RA-CL4	1/4" Drain Clamp	1
27	KTC44	Quick Connect Tee 1/4"	1
28	RA-VCE	Quick Connect RIGID Elbow CHECK Valve	1
29	OT250	High Loop Faucet	1
30	DFU-FC180/250	Faucet Mounting Kit (inc. plastic washer, DFU-NOI, DFU-N0, DFU-BN parts)	–
31	DFU-NOI	Nylon Olive Nut	–
32	DFU-NO	Nylon Olive	–
33	DFU-BN	Brass Nut	–
34	HDW10	Housing Wrench	1

## Installation Procedure

**Important Note: Do not cut the BLACK tube when installing this system.**

1. Shut off the water supply to the kitchen sink.
2. Find a convenient location for the purifier under the sink, taking into consideration ease of access and best use of cupboard space. Using self-tapping screws provided, attach the purifier to the cupboard wall in the desired location. Choose a location where water spillage will not cause damage and out of direct sunlight.
3. Connect the adaptor to the cold water line and install isolation valve, flow control valve and tube adaptor to allow the 1/4" O.D. plastic GREEN tubing to be connected.
4. Select location on kitchen sink to install faucet. Make sure there is adequate access under the bench top for the hoses. The faucet supplied with the system requires a ½" (12 mm) hole. Use a centre punch to locate the position to drill. Drill a pilot hole and gradually enlarge until you have the correct size hole. Connect BLUE tube

to faucet.

5. To install faucet, place in order the small rubber washer, chrome washer and large rubber washer onto the threaded end of faucet. Insert the faucet into the hole in the sink. Slip the large plastic washer and lock washer onto threaded end of faucet and screw on nut. Tighten nut, making sure faucet is correctly positioned on top.  
**Note:** Reverse osmosis systems are unique in that they flush the impurities away. Therefore every RO systems has both pure PRODUCT water and dirty REJECT water. The ratio of Product to Reject is generally about one to two. The ratio can be adjusted to recover a higher ratio rate but the life of the membrane will be reduced. The Reject water is usually dispensed down the drain although it can be directed to the garden if desired. To be environmentally friendly, the Puretec RU system has a built in shut off valve so that when the storage tank is full it stops producing water.
6. Install the drain clamp by drilling a 4 mm hole in the waste pipe. Position the drain clamp above the trap. Connect 1/4" BLACK drain tube to drain clamp and tighten compression nut. Do not allow drain hose to protrude more than 10 mm into drain, making sure the holes in the drain and the clamp are exactly aligned. This can be done by inserting a thin Phillips screwdriver through them whilst tightening the clamp.
7. When connecting the green, red, blue and yellow tubes leave plenty of extra length so that the purifier can be repositioned during servicing without having to disconnect all the hoses.
8. Connect YELLOW tube to storage tank. Screw ball valve to tank outlet and ensure valve is open.
9. Once unit has been completely plumbed it will need to be actuated. To do this ensure isolation valve is off and faucet is open. Gradually open isolation valve to begin water production. The first sign will be water running to drain. This is normal and then finally product water will begin coming out faucet. This may take several minutes. At this stage close faucet. This forces product water to fill up the storage tank. To check that water is still being produced, check water is running to drain. This should continue for several hours until tank is full. When tank is full, the pressure in the tank will overcome the inlet water pressure and the shut-off valve will activate, shutting off the inlet water. To check this, check if water is running to drain. Once tank is full, no water should run to drain. To flush system, allow tank to fill, open faucet outlet until water stops, close faucet and allow tank to fill. Check all connections for leaks.
10. Reverse osmosis systems produce water slowly, almost drop to drop. If the tank is empty to begin with, it will take the tank 3 to 4 hours to fill. Reverse osmosis systems product water slowly. Initially filling the tank will take 3 – 4 hours. Fill and empty twice before drinking water from the system. This is essential in order to flush away any sterilising solution in the membrane.
11. Check all connections are tightened properly. Check for leaks.
12. To dispense drinking water from the faucet, push and hold the handle down or push up for continuous operation.
13. When the unit is in place and the water lines are installed, the unit should be run for 4 hours before the purified water is used, on initial start up. The unit cannot be stored for more than 2 weeks without use, or damage to the membrane may occur. Please enquire if this is the case. For a period of non-use greater than 2 days, flush for 10 minutes before use. For non-use periods of more than 2 weeks, the cartridges may need replacing.
14. The sediment and chemical removal filters should be replaced every 6 months. The membrane should be replaced when water quality deteriorates or every 18 – 24 months, depending on incoming water quality.  
Use only genuine Puretec replacement cartridges and cartridges that are suitable for this appliance.

**Fig. 2 – How To Use Quick Connect Fittings**

1. Cut the tube square and push in to the tube stop. For metal tube remove burrs and chamfer tube end to prevent O-Ring seal being damaged.



2. Fitting grips before it seals. Ensure tube is pushed in to tube stop.

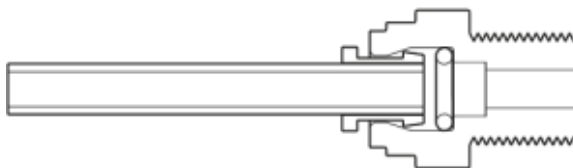

3. Tube is secured in position.

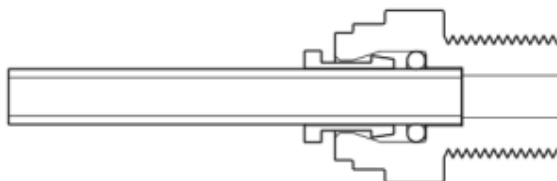

#### 4. DISCONNECTION PROCEDURE

Push collet against body and slide tube out of fitting.

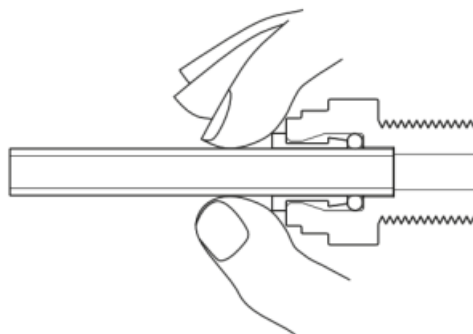

### Use Guidelines

- Minimum operating pressure 300 kPa.
- Maximum pressure 600\* kPa.
- Do not allow exposure to temperatures below 0 °C (protect from freezing).
- Maximum operating temperature 38 °C.
- Nominal flow rate 4 Lpm.
- This system must be installed according to local plumbing codes on the cold water line.
- Replacement Cartridges: See Cartridge Installation
- This system requires regular replacement of the filter cartridge to maintain proper operation.  
Varying chlorine, sediment, or organic substance levels may affect replacement frequency.
- Be sure to change the filter cartridges at least every 8,000 litres or 6 months whichever occurs first; or whenever you detect a change in taste, odour, or decrease in flow. 8,000 litres is approximately equal to using 20 litres daily for one year.

**Caution:** Do not use with water that is microbiologically unsafe or of unknown quality without adequate disinfection before or after the system.

All pictures and information are supplied as a guide only.

Important Note: Sales of products are subject to our Terms & Conditions which are available upon request. All



specifications, prices and photos are a guide only and are subject to change without notice. Please ring to confirm details. Do not use products with microbiologically unsafe water without adequate disinfection.

\*If pressure exceeds 500kPa an approved pressure limiting device needs to be fitted. Maximum flow depends on cartridge, vessel, pressure, impurities etc.

## Warranty

Any claim under this warranty must be made within 1 year of the date of purchase of the product. This product is warranted to be free of defect of material and workmanship for 1 year from date of purchase. To make a claim under the warranty, take the product and proof of purchase to place where you purchased the product, and they will lodge a Warranty Request with Puretec. 1 year warranty is parts and labour. Excludes consumables.

Puretec will pay your reasonable, direct expenses of claiming under this warranty. You may submit details and proof of your expense claim to place of purchase for consideration. The warranty only applies if the product was used and/or installed in accordance with the user guide and/or installation instructions. This warranty is given in lieu of all other express or implied warranties and the manufacturer shall in no circumstance be held liable for damages consequential or otherwise or delays caused or faulty manufacturing except as excluded by law.

Applicable to all above, is that the warranties need to be approved by Puretec to ensure product was not incorrectly used, installed or claimed. False and incorrect claims will be pursued at Puretec's discretion, including chargeable inspection and labour costs incurred.

### WARRANTY/AUSTRALIA

This warranty is given by Puretec Pty Ltd, ABN 44 164 806 688, 37-43 Brodie Road, Lonsdale SA 5160, telephone no. 1300 140 140 and email at [sales@puretec.com.au](mailto:sales@puretec.com.au).

This warranty is provided in addition to other rights and remedies you have under law: Our goods come with guarantees which cannot be excluded under the Australian Consumer Law. You are entitled to replacement or refund for a major failure and to compensation for other reasonably foreseeable loss or damage. You are also entitled to have the goods repaired or replaced if the goods fail to be of acceptable quality and the failure does not amount to a major failure.

### WARRANTY/NEW ZEALAND

This warranty is given by Puretec Ltd, Reg. No 4464398, PO Box 875 Cambridge 3450 NZ, telephone no. 0800 130 140 and email at [sales@puretec.co.nz](mailto:sales@puretec.co.nz).

This warranty is provided in addition to other rights and remedies you have under law: Our goods come with guarantees which cannot be excluded under the Consumer Guarantees Act. You are entitled to replacement or refund for a major failure and to compensation for other reasonably foreseeable loss or damage. You are also entitled to have the goods repaired or replaced if the goods fail to be of acceptable quality and the failure does not amount to a major failure.

	<b>AUSTRALIA</b> P: 1300 140 140 E: <a href="mailto:sales@puretec.com.au">sales@puretec.com.au</a> W: <a href="http://puretec.com.au">puretec.com.au</a>	<b>NEW ZEALAND</b> P: 0800 130 140 E: <a href="mailto:sates@puretec.co.nz">sates@puretec.co.nz</a> W: <a href="http://puretec.co.nz">puretec.co.nz</a>
---	--	---

## Documents / Resources

 <p>The image shows the cover of the user guide for the Puretec RU194-4 Reverse Osmosis Filter System. It features the Puretec logo at the top left, a line drawing of the filter system components (a large storage tank and two smaller inline filters) in the center, and the text 'User Guide' and 'Reverse Osmosis Filter System - RU194-4' at the bottom.</p>	<p><a href="#">Puretec RU194-4 Reverse Osmosis Filter System</a> [pdf] User Guide RU194-4, Reverse Osmosis Filter System, RU194-4 Reverse Osmosis Filter System</p>
---	---