



PURE JONGO T6 Wireless WiFi Bluetooth Speaker System User Guide

[Home](#) » [Pure](#) » PURE JONGO T6 Wireless WiFi Bluetooth Speaker System User Guide 

PURE

Jongo

T6 Wireless WiFi Bluetooth Speaker System
User Guide



Contents

[1 Get Connected](#)

[2 Jongo T6 Safety](#)

[Instructions](#)

[3 Documents / Resources](#)

[3.1 References](#)

Get Connected

Download the Pure Connect app

Download the Pure Connect app on your iOS or Android device, and connect your Jongo to a world of music. Pure Connect lets you stream your own music collection, gives you access to over 20,000 live radio stations from across the world, podcasts and a library of over 200,000 on-demand programs.



from the Apple App Store

http://delivr.com/1fkhj_qr



from Google Play

http://delivr.com/1fkhi_qr

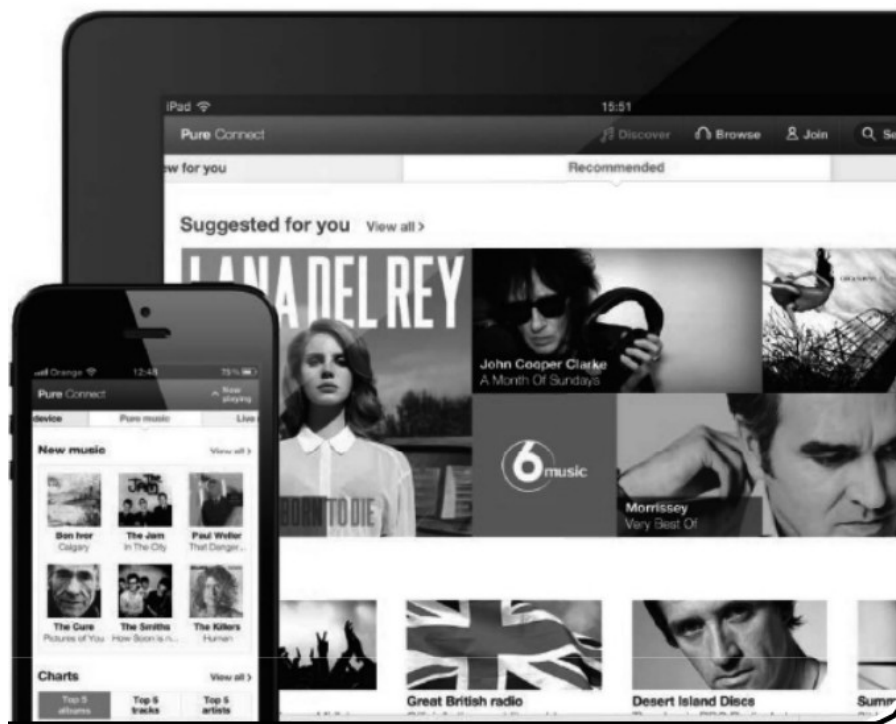

Setting up your first Jongo?

- Insert the connector of the supplied AC power cord into Jongo (A) and switch on the power (B).
- If you have already set up your first Jongo, jump to step 7.
- When the Power light turns solid green, press the Wi-Fi button (C) on the back.

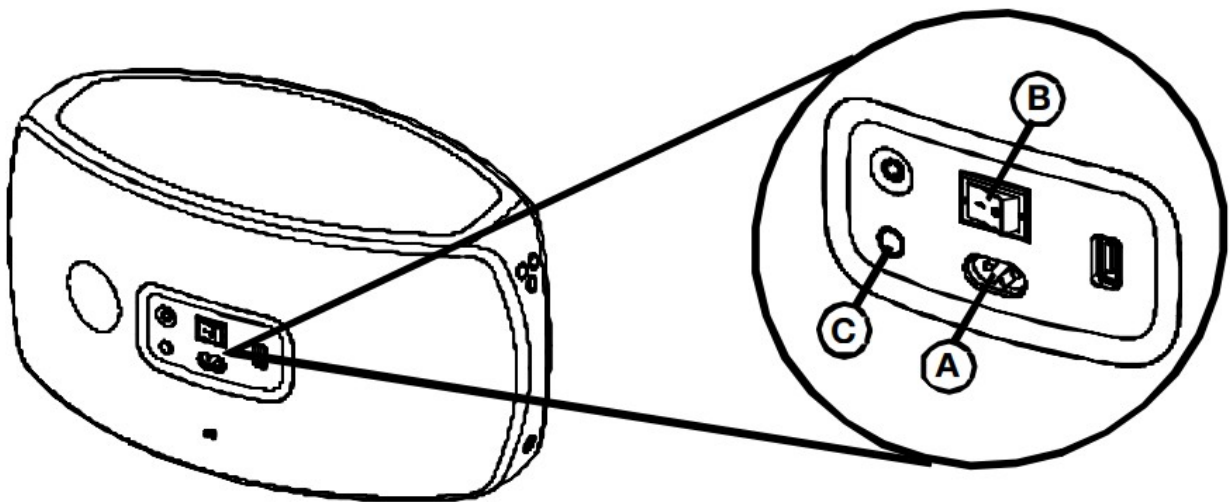

☀ Wait a few seconds for the Power light to 2N flash amber.

Search for Jongo

- On your mobile device search for available Wi-Fi networks.
- Your Jongo will be listed as a network.
- Connect to this network.

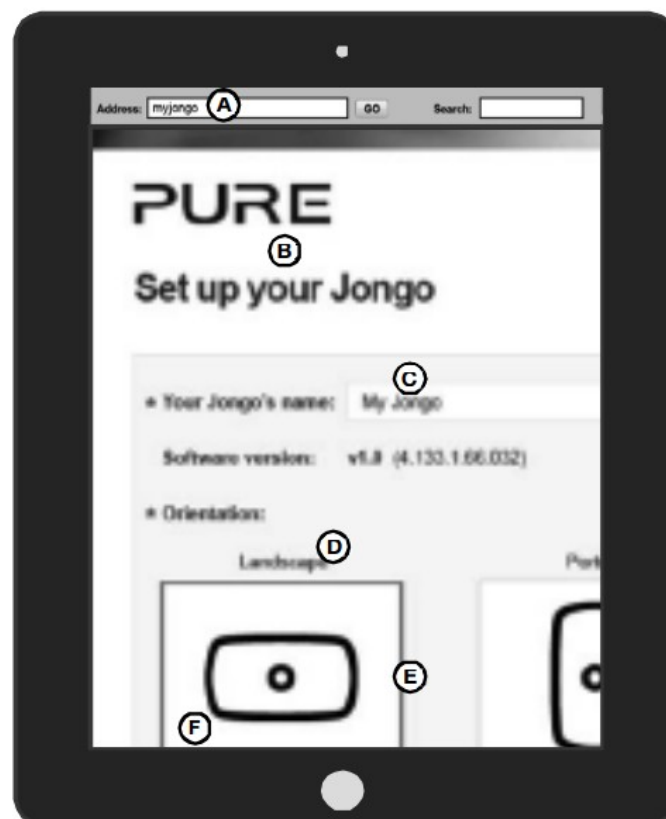
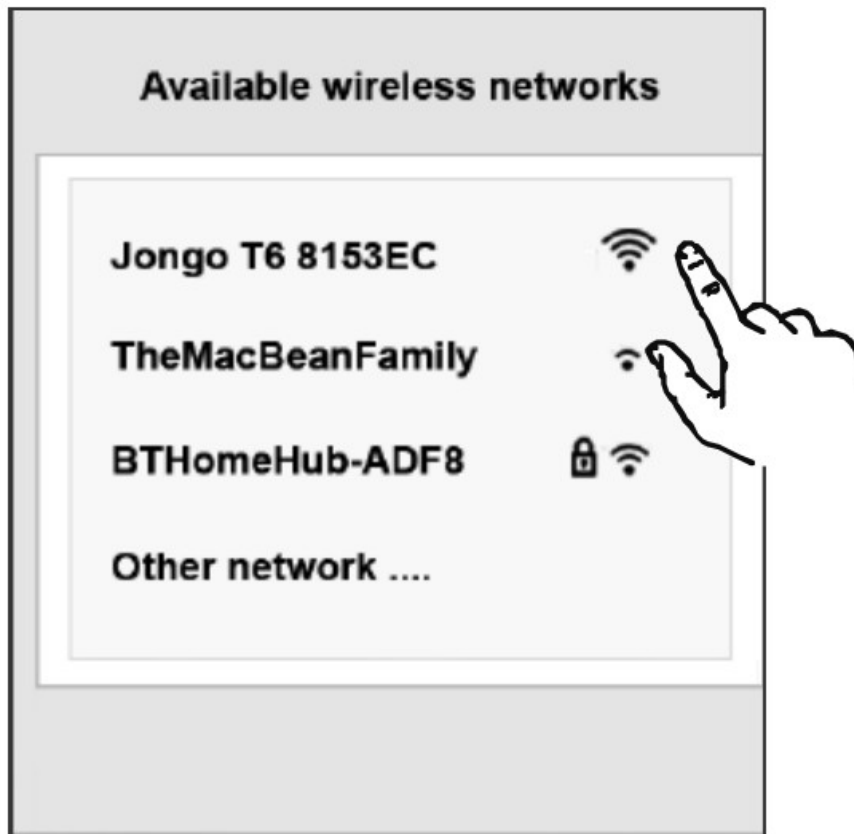

Add Jongo to your wireless network

A. The Jongo Setup page should open automatically @1 your device.

B. If not, open your internet browser and enter myjongo i1 the address bar.

C. If you want =0 rename your Jongo, type i1 the tlew name.

Select whether your Jongo has been positioned i1 Landscape o Portrait mode.

D. Select your wireless network.

E. Enter your network password i required.

F. Tap Save.

Once you tap Save the light will pulse and then turn solid green to show that your Jongo is connected.



If the connection fails, the light will flash red. Don't worry, this probably means you mistyped your Wi-Fi password.

Just go back to step 2 and try again.

If the problem persists visit support.pure.com/us

Choose your music

Open the Pure Connect App and select the music you want to listen to. You can choose from Pure Music*, live radio, on-demand content, ambient sounds and the music stored on your device.

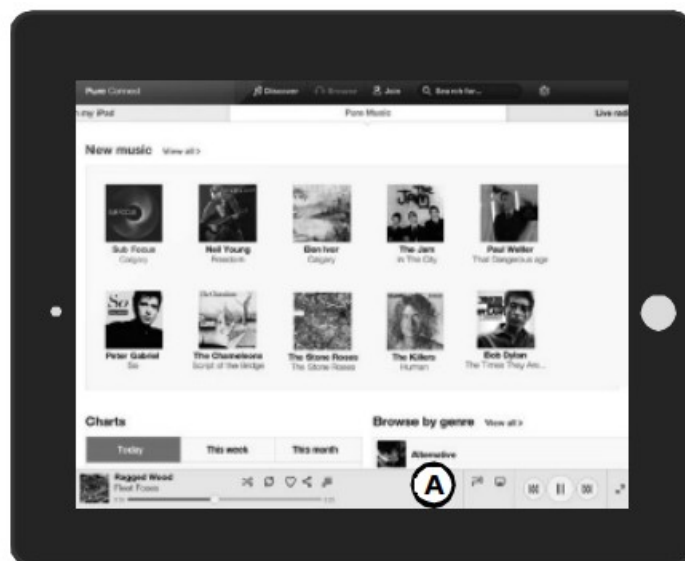

After selecting the content that you want to listen to, the player bar will appear at the bottom of the screen.

Start streaming!

To stream to your Jongo:

- Tap in the list of available Jongs in the player bar to view a list of available Jongs on your network.
- Tap next to the Jongs you want to stream to.

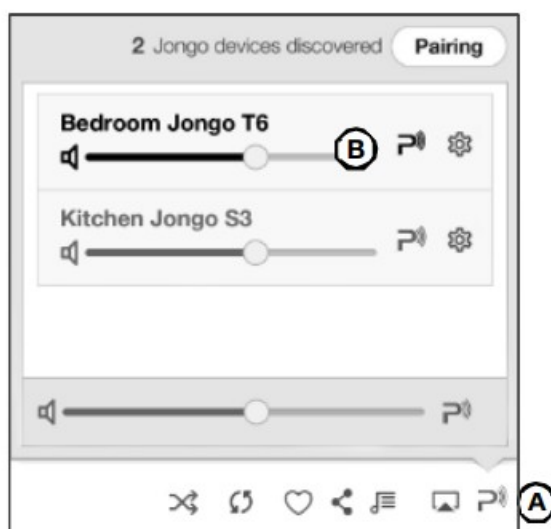

Congratulations!

You're all set up. Enjoy your music.

Adding another Jongo to your network?

- Switch on your new Jongo.
- Press and hold the Wi-Fi button on any other Jongo that is already connected to your network until the Power light pulses green.
- Press and hold the Wi-Fi button on the back of the new Jongo until the Power light pulses green.

After around 30 seconds, the Power lights on both Jongs will light steady green to confirm that the new Jongo is connected to your network.

If the connection fails, the light will flash red. Don't worry, just go back to step 2 and follow the standard setup.

Using Bluetooth

1. Enable the Bluetooth option on your mobile device and search for Bluetooth devices.
2. pair . , If your device requires a key, enter '0000'.

Need more help?

Watch our Jongo setup video at: www.pure.com/jongo-setup-video



Download the full user guide at: support.pure.com/uS

Did you know?

You can use two Jongo T8 speakers together in stereo.

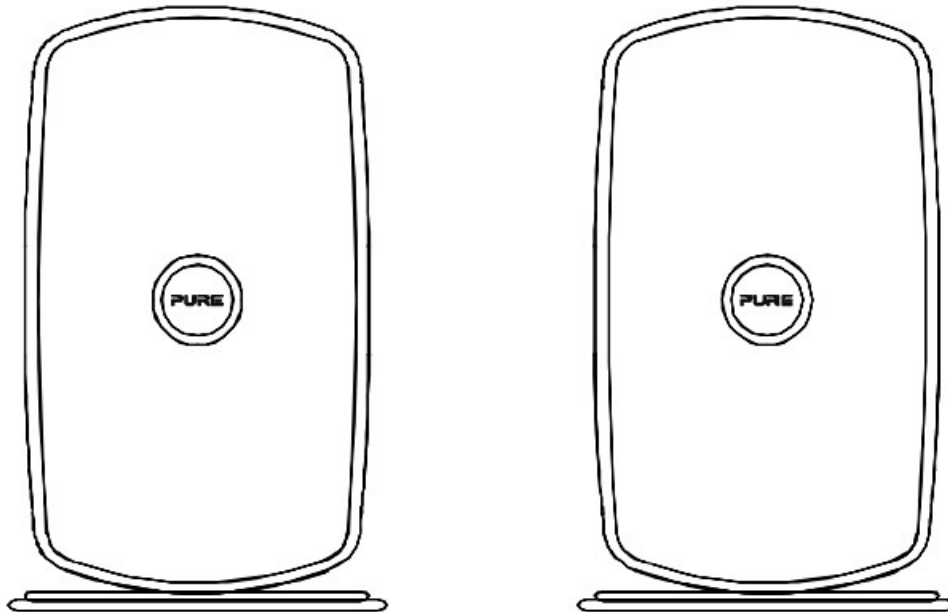

Find out More at: www.pure.com/jongo-stereo-pair

"Pure Music is only available in certain countries. Please see <http://Apure.com/availability/> for details

Jongo T6 Safety Instructions

1. Read these instructions ~ All the safety and operating instructions should be read before this product is operated.
2. Keep these instructions ~ The safety and operating instructions should be retained for future reference.
3. Heed all warnings ~ All warnings on the appliance and in the operating instructions should be adhered to.
4. Follow all instructions – All operating and use instructions should be followed.
5. Ensure that the apparatus has adequate ventilation (at least 106 spaces all round),

6. Do not use the apparatus near water.
7. Do not use the apparatus near water.
8. Do not install near any heat sources such as radiators, heat registers, stoves, or other apparatus (including amplifiers) that produce heat.
9. Do not block any ventilation openings. Install in accordance with the manufacturer's instructions.
10. Only use attachments/accessories specified by the manufacturer.
11. Unplug the apparatus during lightning storms or when unused for long periods of time.
12. **WARNING:** To reduce the risk of electric shock, do not expose this apparatus to rain or moisture. The apparatus shall not be exposed to dripping or splashing and that objects filled with liquids, such as vases, shall not be placed on apparatus.
13. **WARNING:** To reduce the risk of electric shock, do not remove plastic casing or screws as there are no user-serviceable parts inside.
14. Refer all servicing to qualified service personnel. Servicing is required when the apparatus has been damaged in any way, such as power-supply cord or plugs damaged, if it has been spilled or objects have fallen into the apparatus, the apparatus has been exposed to rain or moisture, does not operate normally, or has been dropped.
15. **WARNING:** Please refer to the information on the bottom exterior of the enclosure for electrical and safety information before installing or operating the apparatus. If you are installing Jongo with the removable stand in portrait mode, this information can be located behind the trim panel.
16. When plugged in, the apparatus remains connected to AC power.
17. To disconnect completely, unplug from the AC socket.
18. Ensure that the AC power plug is readily accessible in case isolation from the AC power is required.
19.  This equipment is a Class I or double insulated electrical appliance. It has been designed in such a way that it does not require a safety connection to electrical earth.

Warranty information

Imagination Technologies Limited warrants to the end user that this product will be free from defects in materials and workmanship in the course of normal use for a period of two years from the date of purchase. This guarantee covers breakdowns due to manufacturing or design faults; it does not apply in cases such as accidental damage, however caused, wear and tear, negligence, adjustment, modification or repair not authorized by us. Should you have a problem with your unit please contact your supplier or contact Pure Support at: <http://Support.Pure.com/us>

Disclaimer

Imagination Technologies Limited makes no representation or warranties with respect to the content of this document and specifically disclaims any implied warranties of merchantability or fitness for any particular purpose. Further, Imagination Technologies Limited reserves the right to revise this publication and to make changes in it from time to time without obligation of Imagination Technologies Limited to notify any person or organization of such revisions or changes.

Trademarks

Jongo, Pure, the Pure logo, Imagination Technologies and the Imagination Technologies logo are trademarks of registered trademarks of Imagination Technologies Limited.

Copyright

Copyright © 2013 Imagination Technologies Limited. All rights reserved. No part of this publication may be copied or distributed, transmitted, transcribed, stored in a retrieval system, or translated or any human or computer language, in any form or by any means, electronic, mechanical, magnetic, manual or otherwise, or disclosed to third parties without the express written permission of Imagination Technologies Limited. Version 2 July 2013,

Acknowledgement of License Agreements

Portions of the code used in Jongo T6 are subject to the GPL, LGPL, BSD, and other open source licenses. For more details please refer to: <http://www.pure.com/icensin>

Approvals



CE marked. Hereby, Pure, declares that this Band II LPD device is in compliance with the essential

equipments and other relevant provisions of Directive 1999/5/EC. The Declaration of Conformity may be Consulted at: <http://www.pure.com/RETTE-DoC>.

Australian C-Tick N 1600 and Electrical Safety.

FCC NOTICE TO A USER IN THE UNITED STATES

Warning: Changes or modifications to this Unit not expressly approved by the party responsible for compliance could void the user's authority to operate the equipment.

NOTE: This equipment has been tested and found to comply with the limits for a Class B digital device, pursuant to Part 15 of the FCC Rules. These limits are designed to provide reasonable protection against harmful interference in a residential installation. This equipment generates, uses and can radiate radio frequency energy and, if not installed and used in accordance with the instructions, may cause harmful interference to radio communications. However, there is no guarantee that interference will not occur in a particular installation. If this equipment does cause harmful interference to radio or television reception, which can be determined by turning the equipment off and on, the user is encouraged to try to correct the interference by one or more of the following measures:

- Reorient or relocate the receiving antenna.
- Increase the separation between the equipment and receiver
- Connect the equipment into an outlet on a circuit different from that to which the receiver is connected.
- Consult the dealer or an experienced radio/TV technician for help.

This device complies with Part 15 of the FCC Rules. Operation is subject to the following two conditions: (1) this device may not cause harmful interference, and (2) this device must accept any interference received, including interference that may cause undesired operation.

FCC Radiation Exposure Statement: Caution: This Transmitter must be installed to provide a separation distance of at least 20 m from all persons.

IC NOTICE TO A USER IN CANADA

Since digital circuitry may cause interference to other radio or television tuners nearby, switch this Unit off when not in use or move it away from the affected radio/television tuner.

NOTE: This digital apparatus does not exceed the Class B limits of radio noise emissions from digital apparatus as set out in the Radio Interference Regulations of Industry Canada. These limits are designed to provide reasonable protection against harmful interference in a residential installation. This equipment generates, uses and can radiate radio frequency energy and, if not installed and used in accordance with the instructions, may cause harmful interference to radio communications. However, there is no guarantee that interference will not occur in a particular installation. If this equipment does cause harmful interference to radio or television operation (which can be determined by turning the equipment off), the User is encouraged to try to correct the interference by one or more of the following measures:

- Reorient or relocate the receiving antenna.
- Increase the separation between the equipment and receiver
- Connect the equipment into an outlet on a circuit different from that to which the receiver is connected.
- Consult the dealer or an experienced radio/TV technician for help.

PURE

Jongo

www.pure.com

connect.pure.com

Pure North America

Imagination Technologies

955 East Arques Avenue

Sunnyvale,

CA 94085

USA

www.pure.com/us

<http://support.pure.com/us>

Pure UK Headquarters

Imagination Technologies Limited

Home Park Estate

Kings Langley

Herts, WD4 8LZ

United Kingdom

[WWW.pure.com](http://www.pure.com)

<http://support.pure.com>

Documents / Resources

	<p>PURE JONGO T6 Wireless WiFi Bluetooth Speaker System [pdf] User Guide JONGO T6 Wireless WiFi Bluetooth Speaker System, JONGO T6, Wireless WiFi Bluetooth Speaker System, Bluetooth Speaker System, Speaker System, System</p>
---	--

References

-  [Manual-Hub.com - Free PDF manuals!](#)
- [User Manual](#)

[Manuals+](#), [Privacy Policy](#)

This website is an independent publication and is neither affiliated with nor endorsed by any of the trademark owners. The "Bluetooth®" word mark and logos are registered trademarks owned by Bluetooth SIG, Inc. The "Wi-Fi®" word mark and logos are registered trademarks owned by the Wi-Fi Alliance. Any use of these marks on this website does not imply any affiliation with or endorsement.