

PURE Classic H4 DAB Plus Radio with Bluetooth Radio



# PURE Classic H4 DAB Plus Radio with Bluetooth Radio User Guide

[Home](#) » [Pure](#) » PURE Classic H4 DAB Plus Radio with Bluetooth Radio User Guide 

## Contents

- [1 PURE Classic H4 DAB Plus Radio with Bluetooth Radio](#)
- [2 Product Information](#)
- [3 Product Usage Instructions](#)
- [4 In the box](#)
- [5 Getting started...](#)
- [6 Product controls](#)
- [7 DAB & FM Presets](#)
- [8 Kitchen timer](#)
- [9 Documents / Resources](#)
  - [9.1 References](#)
- [10 Related Posts](#)

# PURE

**PURE Classic H4 DAB Plus Radio with Bluetooth Radio**



## Product Information

### Specifications:

- **Model:** Evoke H4
- **Power Adaptor:** UK plug, EU plug
- **Supported Sources:** DAB Radio, FM Radio, Bluetooth, Auxiliary input, USB Playback

## Product Usage Instructions

### Accessing EQ Settings:

1. Press the menu button to access the EQ settings.
2. Use the select encoder to highlight "System Settings" and push the select dial.
3. Highlight the "Equaliser" option and push the select dial.
4. Select the specific Equaliser option you wish to set and push the select dial.

### Product Controls:

- **Volume:** Use the volume up/down buttons to adjust volume levels.
- **Menu/Back:** Press to access the menu or go back to the previous screen.
- **Bluetooth Pair/Unpair:** Press and hold for 2 seconds to pair or unpair Bluetooth devices.
- **Push to Mute:** Quickly mute the audio.
- **Select Source:** Choose between different audio sources.
- **Kitchen Timer:** Set a timer for the kitchen use.
- **Push to Select:** Confirm selections or settings.
- **Quick Access Presets:** Quickly access preset radio stations.
- **Menu Navigation:** Navigate through the menu options.
- **Station Selection:** Choose radio stations using the select dial.
- **Standby On/Off:** Turn the device on or off.

- **Preset List:** Access and manage preset radio stations.

## Sources:

**DAB Radio:** Use the select dial to navigate DABstations and push to select a station.

**FM Radio:** Navigate FM stations using the selectdial. Turn slowly to adjust the frequency and quickly for station scanning.

**Bluetooth:** Switch to Bluetooth mode for pairing.Press for 2 seconds to disconnect.

**Auxiliary Input:** Connect an external music player for audio playback.

**USB Playback:** Connect a USB stick, select 'MusicPlayer mode, and play stored MP3 files.

## DAB & FM Presets:

### • Saving Presets:

1. To save a radio station, hold the preset list button for 2 seconds.
2. Navigate to the desired preset slot using the select dial.
3. Push the select dial to save the station to the selected slot.

### • Recalling Presets:

1. To recall a preset, tap the preset list button and navigate to the desired station using the select dial.
2. Push the select dial to tune in to the selected radio station.

## FAQ

### • Q: How do I switch between different audio sources?

- **A:** To switch between audio sources, use the "Select Source" button on the device. Press the button to cycle through DAB Radio, FM Radio, Bluetooth, Auxiliary input, and USB playback.

### • Q: Can I save multiple radio stations as presets?

- **A:** Yes, you can save multiple radio station presets. Simply follow the instructions in the manual to save your favourite stations to preset slots on the device.

### • Q: How do I adjust the EQ settings?

- **A:** To adjust the EQ settings, access the system settings menu, navigate to Equaliser, and choose from the available Equaliser options such as Dynamic, Comfort, or Neutral. Select your preferred option to customize the sound according to your preferences.

## In the box

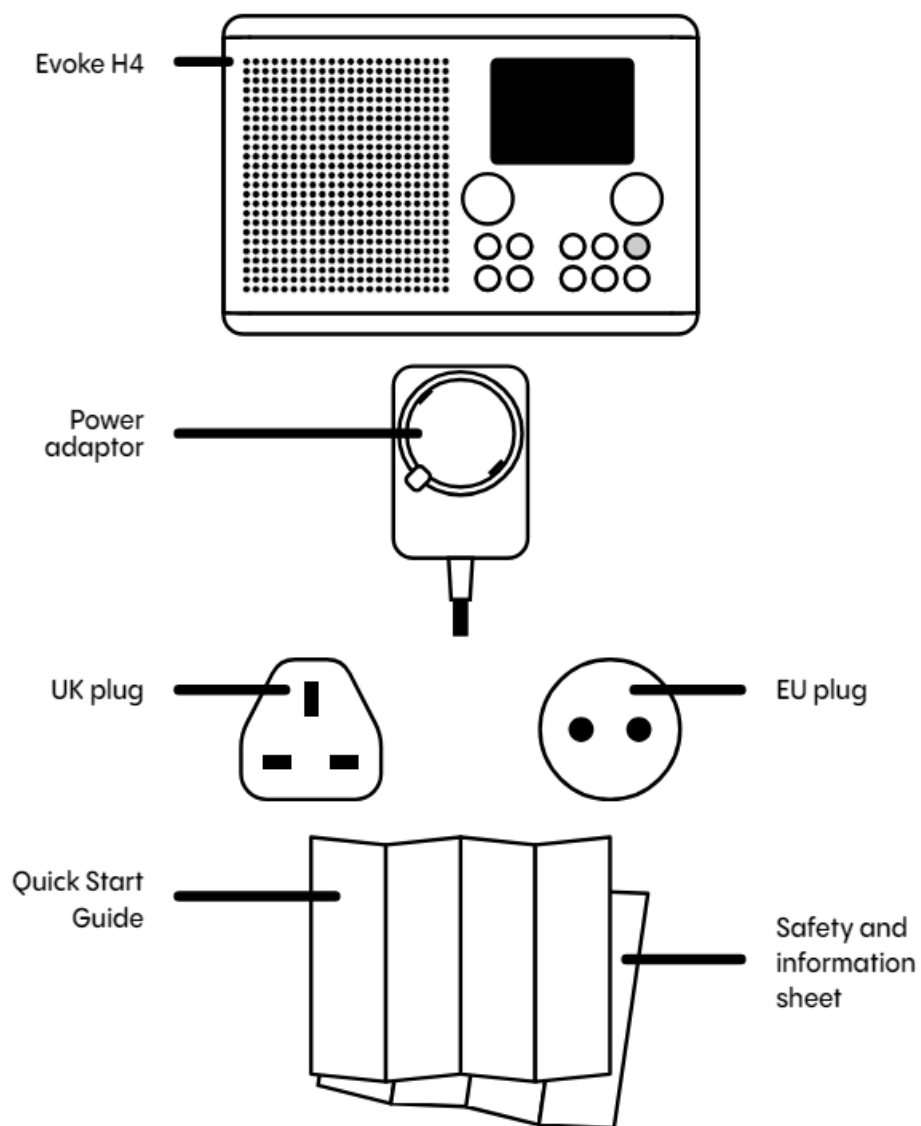

**Getting started...**

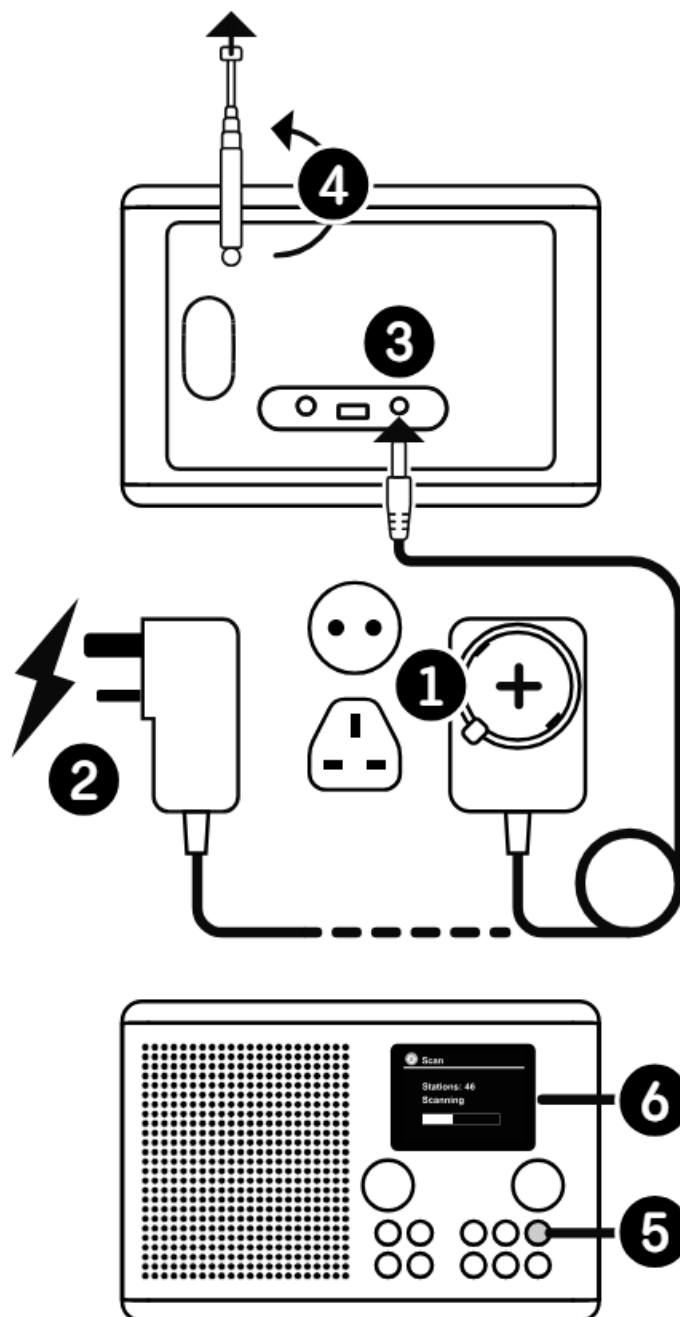

## Product controls

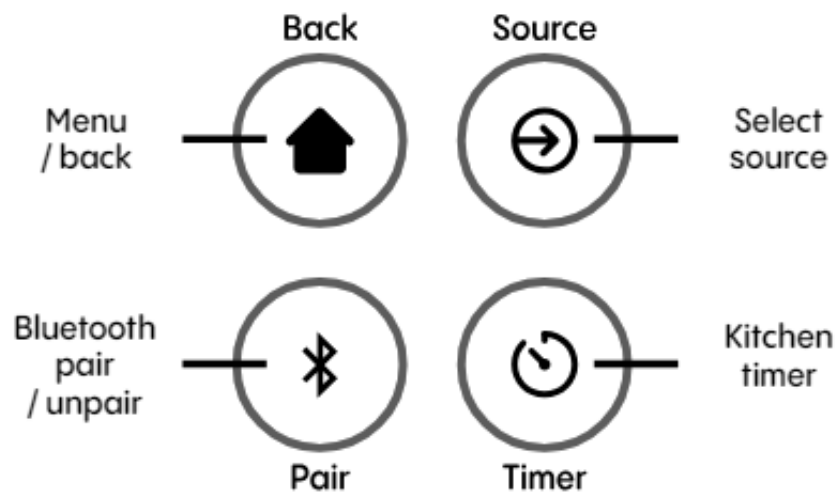
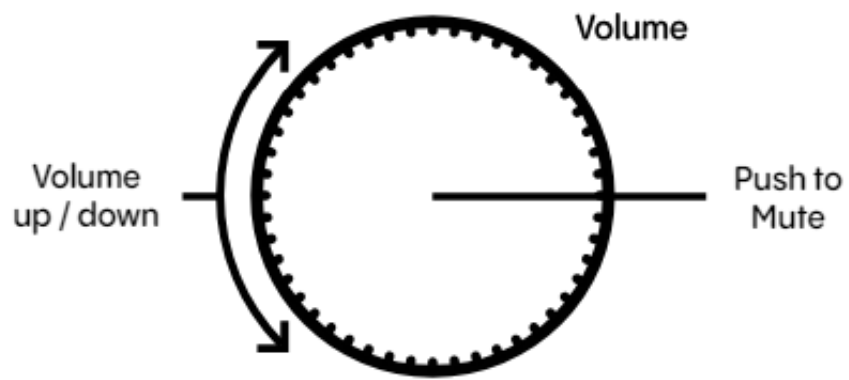

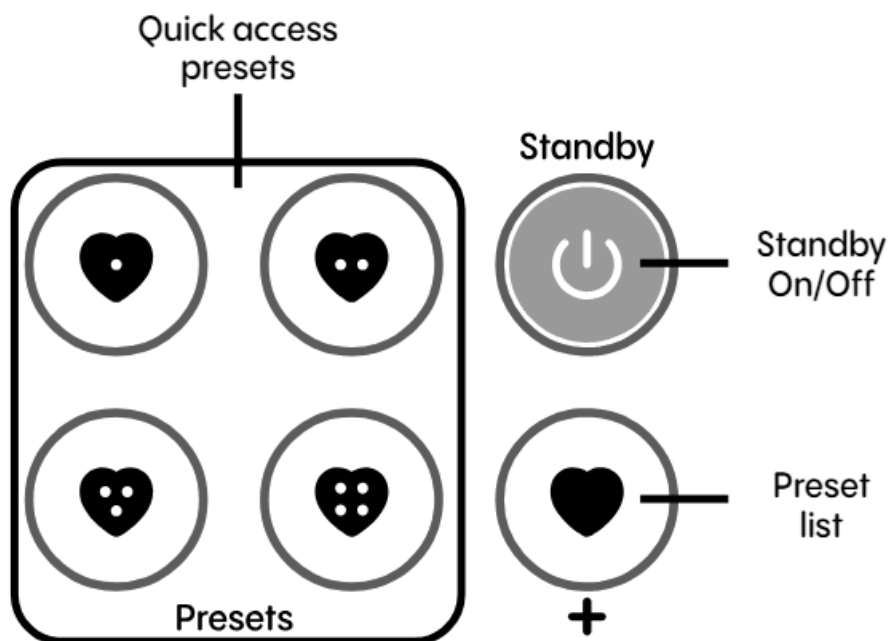
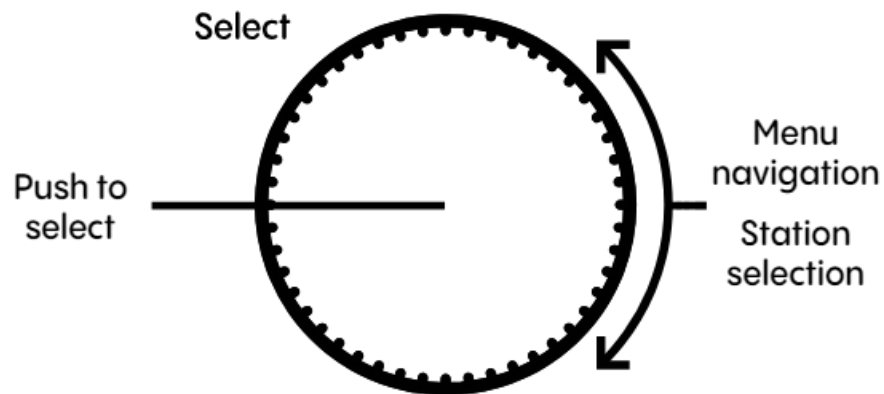

## Sources



DAB Radio

Use the select dial to navigate the DAB station list. To select a station push the select dial.





FM Radio

Use the select dial to navigate FM stations.  
 To increase or decrease the radio frequency turn the dial slowly.  
 To scan for the next or previous station turn the select dial quickly in either direction.



Bluetooth

Switch to Bluetooth  Pairing mode will start automatically. To disconnect, press Bluetooth  for 2sec



#### **Auxiliary input**

Connect a line-level audio device, such as an external music player, to listen through the receiver.



#### **USB Playback**

Connect a USB memory stick\*, select 'Music Player' mode and listen to stored MP3 music files.

For compatibility information visit [support.pure-audio.com](https://support.pure-audio.com)

### **DAB & FM Presets**

#### **Saving presets**

To save the current playing radio station to the preset list hold the preset list button  for 2 seconds

Turn the select dial to navigate to the present slot you would like to save to.  
Push the select dial to save the station to the highlighted slot.





To save the current playing radio station to one of the quick preset buttons hold the preset button you would like to save the station on for 2 seconds.

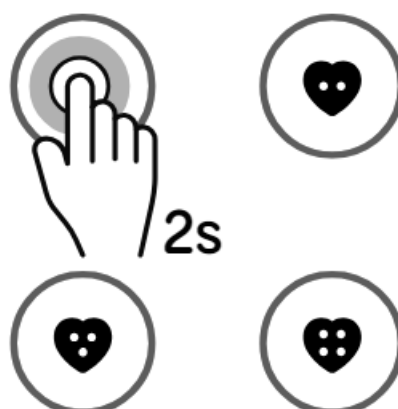

## Recalling presets

To recall a preset from the preset list the preset list button.  
Turn the select dial to navigate the preset list.  
Push the select dial to tune in to the highlighted radio station

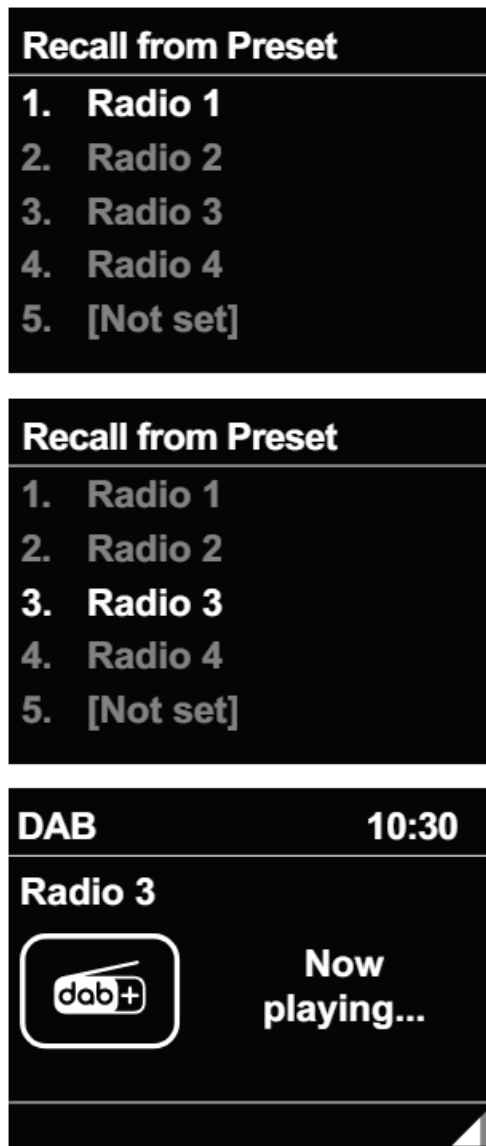



To recall one of the saved radio stations saved to a preset button, tap the button to tune in.



## Kitchen timer

- Using the kitchen timer
- Press the timer  button to configure a kitchen timer.
- Push the select dial to go through hours, minutes and seconds
- Turn the select dial to adjust each value.

- The timer will start automatically.
- To view a running kitchen timer, tap the timer  button again.
- To adjust the running time use the select dial.
- The timer will continue with its updated running time automatically.
- Long press the timer  button to cancel the running timer.

## EQ's

### To access the EQ settings

To begin accessing the EQ settings press the menu button. 

Highlight System Settings using the select encoder then push the select dial.

Highlight the Equaliser option then push the select dial.

Highlight the Equaliser option you wish to set then push the select dial.

**DAB**

---

Full Scan

Manual Tune

Prune Invalid

DRC

**System Settings**

**System Settings**

---

Equaliser

Time/Date

Backlight

Language

Factory Reset

**Equaliser**

---

Dynamic

Comfort

Neutral

- **Dynamic:** Deep bass extension – dynamic vocals and instruments
- **Comfort:** Easy listening all-day
- **Neutral:** Sound as close to the source material

**For more help or support**

**please visit us at:**

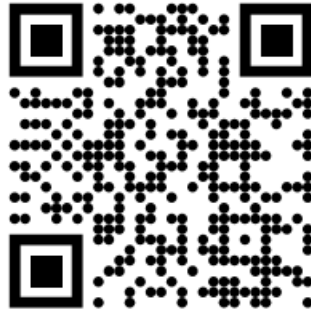

- [support.pure-audio.com](https://support.pure-audio.com)

---

## Documents / Resources

	<a href="#">PURE Classic H4 DAB Plus Radio with Bluetooth Radio</a> [pdf] User Guide Classic H4 DAB Plus Radio with Bluetooth Radio, Classic H4, DAB Plus Radio with Bluetooth R adio, Radio with Bluetooth Radio, Bluetooth Radio
---	--

## References

- [PURE SUPPORT](#)
- [User Manual](#)

[Manuals+](#), [Privacy Policy](#)

This website is an independent publication and is neither affiliated with nor endorsed by any of the trademark owners. The "Bluetooth®" word mark and logos are registered trademarks owned by Bluetooth SIG, Inc. The "Wi-Fi®" word mark and logos are registered trademarks owned by the Wi-Fi Alliance. Any use of these marks on this website does not imply any affiliation with or endorsement.