

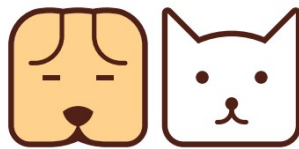

PUPPY KITTY Doll Automatic Pet Feeder with Wifi User Manual

[Home](#) » [PUPPY KITTY](#) » PUPPY KITTY Doll Automatic Pet Feeder with Wifi User Manual 



PUPPY KITTY

Automatic Pet Feeder with Wi-Fi
Product Manual

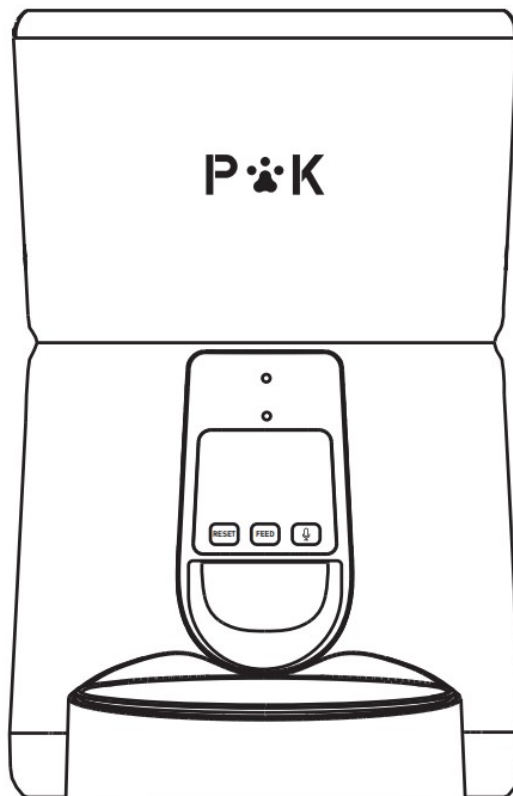

Doll
New Version: With Bluetooth

Contents

- 1 Warranty
- 2 Warning
- 3 Notice
- 4 Package Contents
- 5 Product Parameter
- 6 Product Overview
- 7 Startup
- 8 Details
- 9 Connecting to the feeder
- 10 Control the feeder via app
- 11 Maintenance
- 12 Troubleshooting
- 13 For further questions
- 14 Documents / Resources
- 15 Related Posts

Warranty

A. Two-year limited warranty, non-transferable.

B. This product is supported by the manufacturer's limited warranty.

For all information about the warranty and its conditions applicable to this product, you can contact us 24/7 at Service@puppy-Kitty.shop.

Warning

1	Dispose of all packaging materials properly.
2	Keep away from children
3	Do NOT use rechargeable batteries.
4	Do NOT immerse the base part in water at any time.
5	Do NOT disassemble the unit other than as instructed in this Manual.
6	Always unplug when not in use and before cleaning.
7	Before leaving for extended time, always replace batteries with new ones.
8	To avoid tripping, always position power cord out of the way of foot traffic.
9	Only use attachments recommended or sold by the manufacturer.

Notice

1	Not suitable for wet, canned or moist food.
2	When using the powerplug and batteries at the same time, batteries get used as backup Power.
3	Working temperature: -10°C to 40°C.
4	suitable for dry food only, with size ranging from 2-12 mm in diameter.

Package Contents

1x Puppy Kitty Pet Feeder
1x User Manual
2x Food Tray
5x Quick Connect Guide
1x 5V Power Adapter & Cord

Product Parameter

APP Name:	Smart Life
APP installation requirement:	Android 5.0/10S 7.0 or above
Product Size:	33×21.5×19.5cm
Net weight:	1.88 KG
Capacity:	4L
Product Materials:	ABS
Wi-Fi Band:	2.4 Ghz
Adapter Parameters:	Input:110-220V,50/60HZ,0.4A Output:5.0V,1000mA
Power:	DC 5V power adapter; 3x alkaline D batteries(not included)

Product Overview

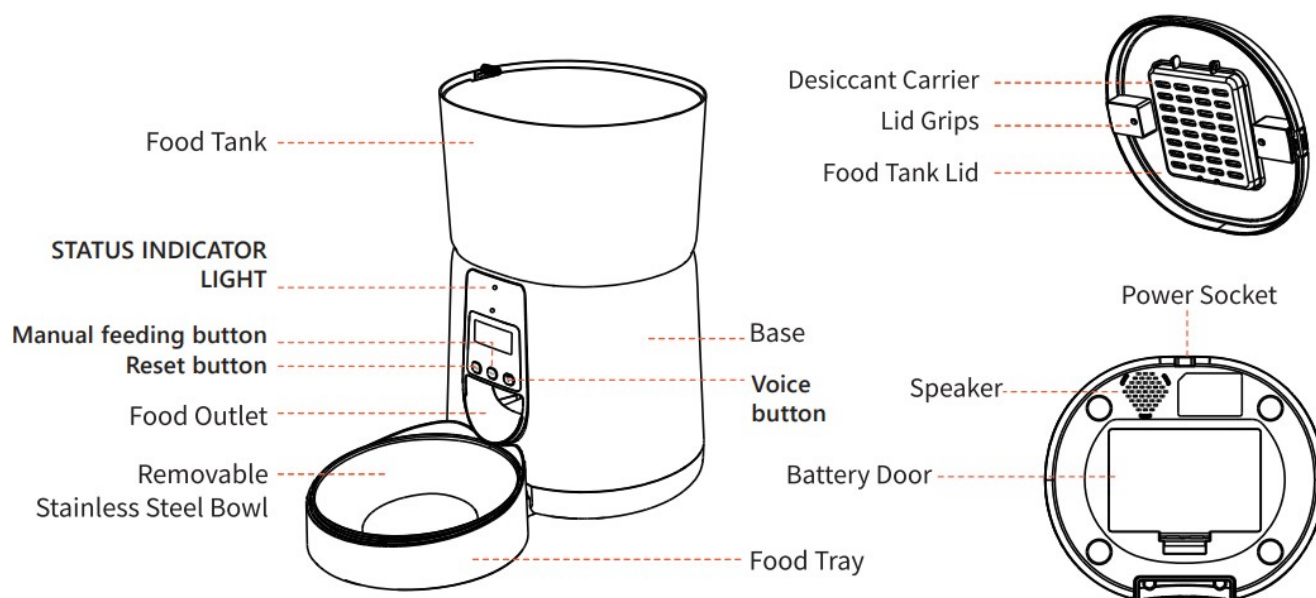

Startup

1.Assemble the Food Tray

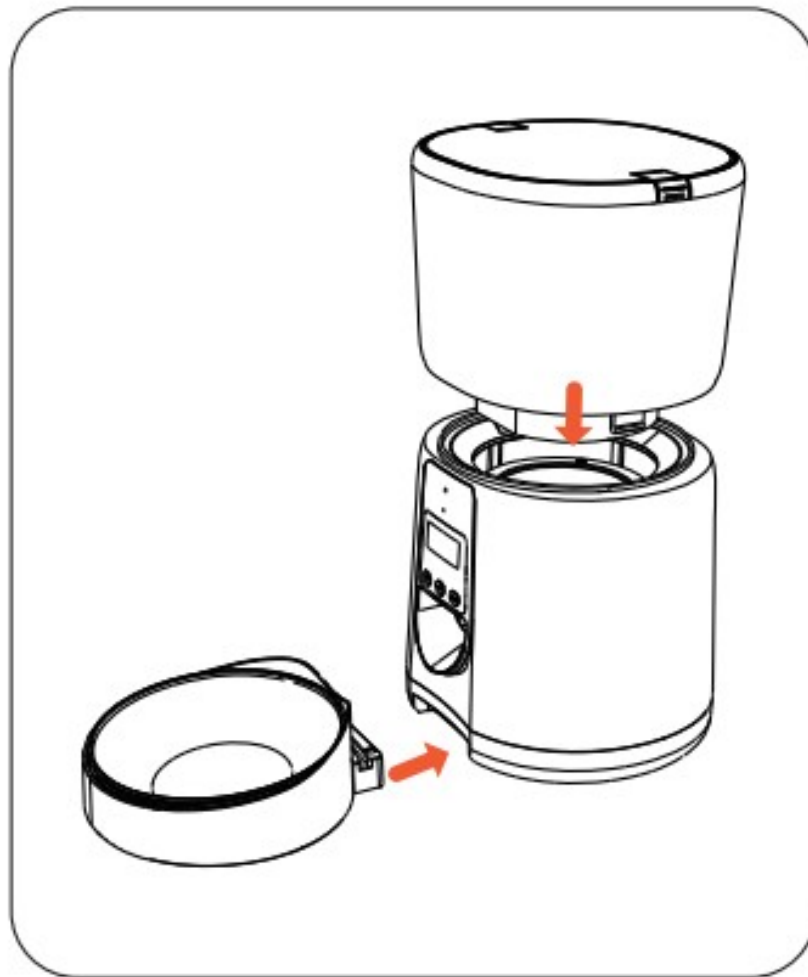

- Install the food tank into the base.
- Put the removable stainless steel bowl into the food tray, and install the food tray into base.

Note:

1. Please empty and remove the tray before moving the feeder.
2. Hold the base instead of any other parts when lifting the feeder.

2.Placing Desiccant Bag

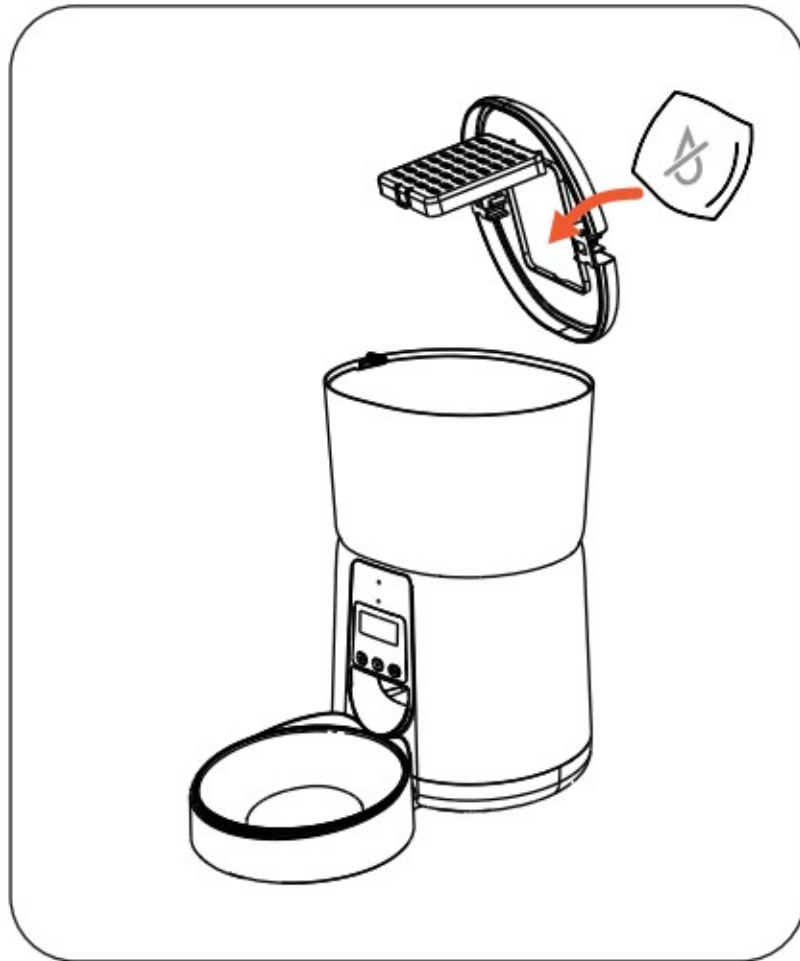

Open the food tank lid and put the desiccant bag (1 Included) into the desiccant carrier.

Note:

1. Recommend to use and replace the desiccant bag once every half month.
2. Please remove the desiccant bag before cleaning the food tank lid.

3.Connecting Power

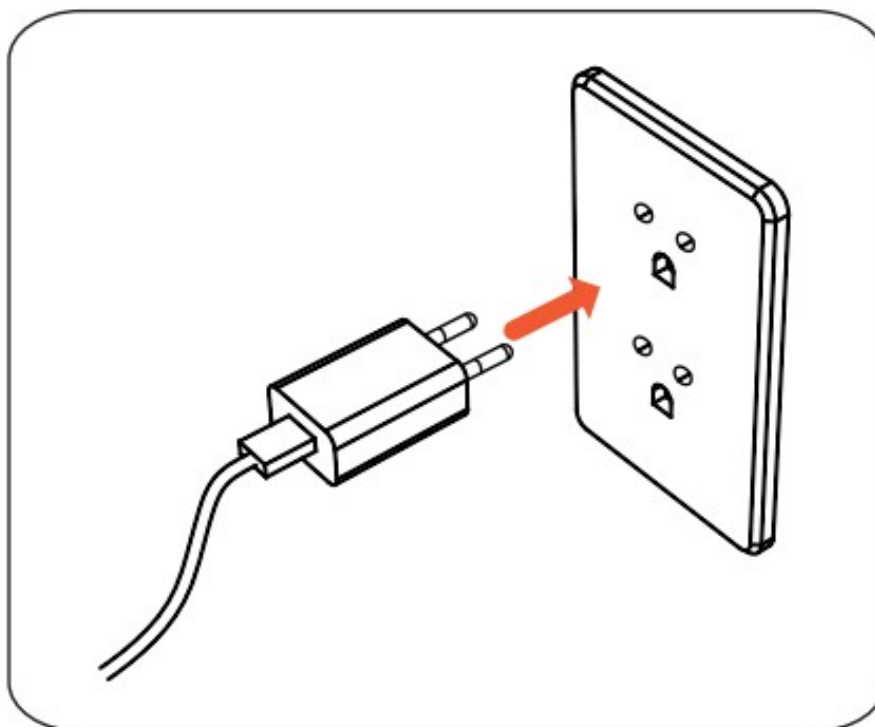

- Insert the 5V power adapter into a wall socket. Plug in the power socket of the feeder and the LCD screen will light up.
- Open the battery compartment at the bottom of the unit, and install 3 alkaline D batteries (not included) in case of outage

Note.

1. Battery NOT includes.
2. Before connecting to power, make sure all parts are clean and completely dry.
3. The battery should power with an output of 4-5V; the battery level icon on the display blinks on a low battery level(<4V).

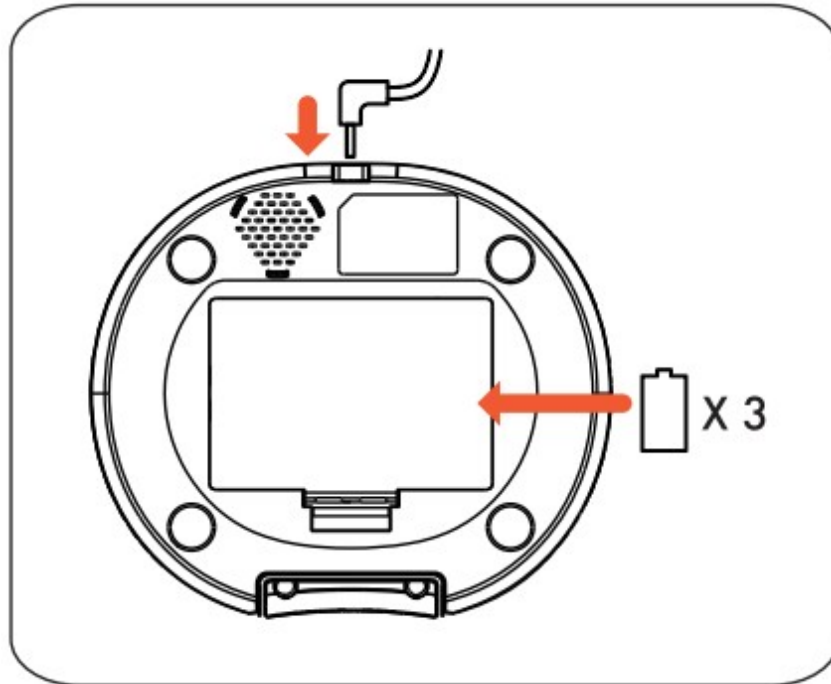

4. Change the batteries every 6 months if not in use for a long time.
5. Recommend using both battery and adapter in case any of power cut off.

4. Fill Food Tank

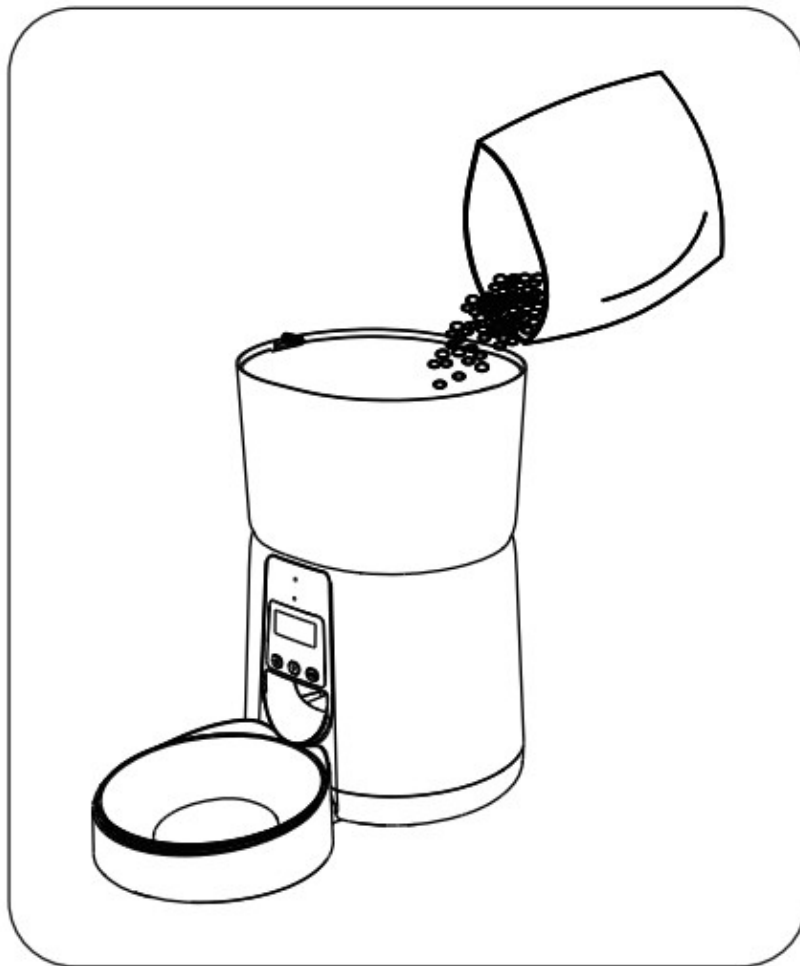



- Fill food tank with dry pet food. Close the lid and it will snap into place due to gravity.

Note:



1. Do not use canned, wet or moist pet food.
2. Recommend kibble size ranging from 2-12mm/0.07-0.48in in diameter.

Details

Buttons

	<p>Press and hold the button. After the beep, call your dog or cat, then release the button. A double beep occurs after successful recording</p>
	<p>1.Click once to serve 1 portion of food. 2Hold the Button for 6 seconds to lock or unlock the device.</p>
	<p>Pressing and holding the button resets the device to the factory settings after the beep.</p>

LED Indicators

<div><p>Blue Light</p></div>	Quick blinking	The device is looking for your phone
	Continously On	Connected to the network
	3 Second Blinking	Booting up
<div><p>Red Light</p></div>	Blinks when the food gear is blocked	
	on for 6 seconds when switching between AP and WIFI mode	
	Flashes twice when you are locking or unlocking the pet feeder	

Connecting to the feeder

Please use the quick start guide to establish the connection.



01



02



ATTENZIONE!

The 2.4GHz Wi-Fi network password must not contain special characters ("","@","#","%","&","^","~"etc.), otherwise the Smart Life App will not be able to connect to the pet feeder during the setup process.

03

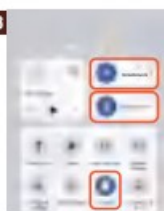

Turn on the Wi-Fi, Bluetooth and location of your phone.

04

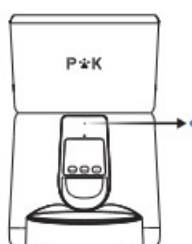

Plug in the Pet Feeder and wait for the blue light to start flashing rapidly.

05



Scan the QR code and download "Smart Life" APP

Control the feeder via app

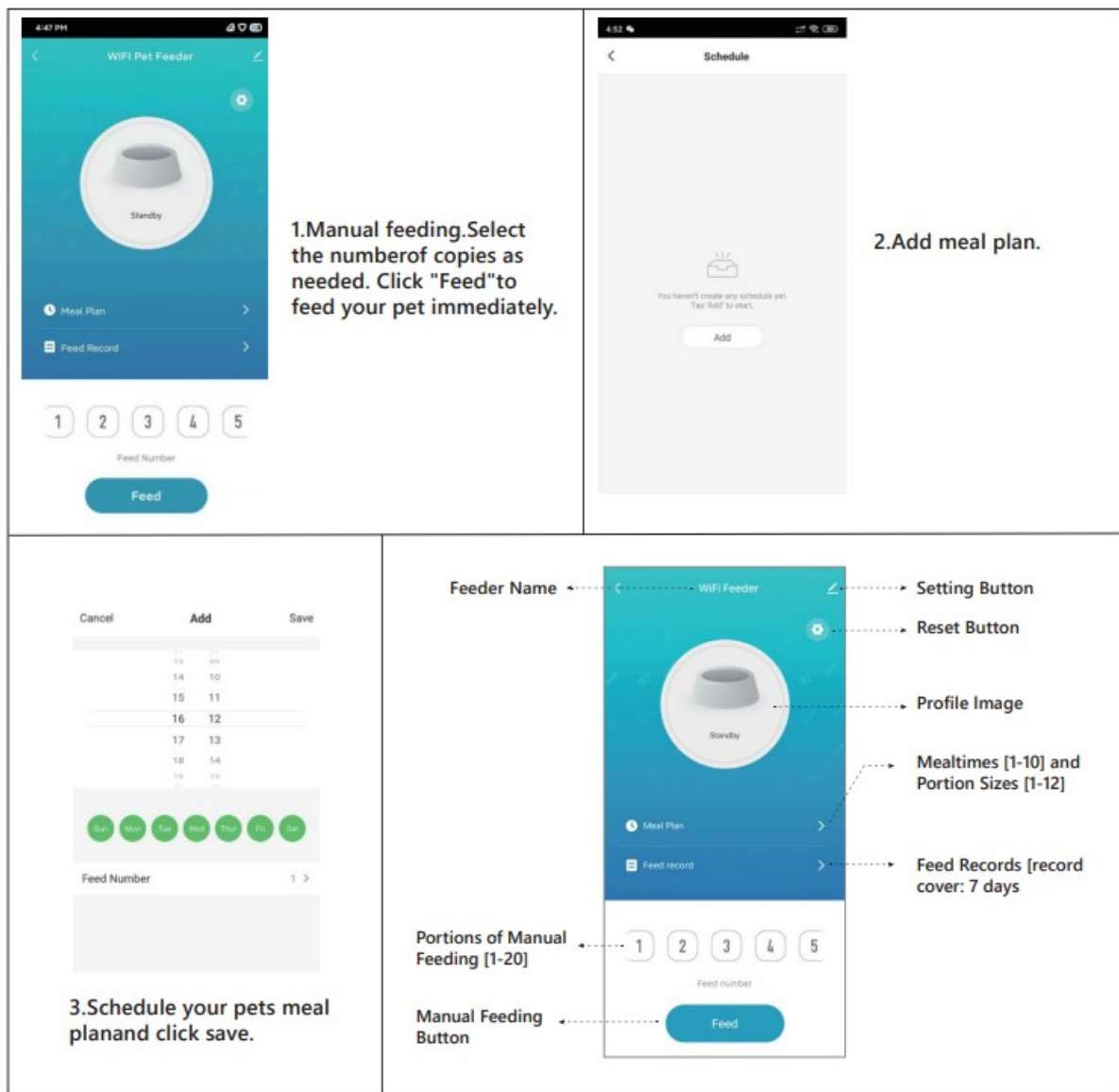

Maintenance

1. Please clean the feeder once a month.
2. Food container, food tray, and the lid can be cleaned with water.

Troubleshooting

Problems	Solutions
The food does not come out	Dry food size should range from 2-12 mm diameter.
	Check the chute and food outlet for foreign objects.
	Check whether battery power is low.
The feeder does not respond	Check that the power cable is properly plugged into the device and power plug.
	Check that the batteries are inserted correctly and are not dead.
2.4 Ghz Network configuration issues	If it is a dual-frequency router, please access the router and turn off the 5 Ghz Wi-Fi signal.
	Save and restart the router, and then reconfigure the feeder.
	5G WLAN is not supported, Bluetooth must be enabled and the APP password must not contain special characters (!"#\$%&'()*=?...).
Pet feeder is frequently offline	Restart the router and feeder.
	Put the pet feeder within 10m of the router.
	Please update to the latest version of the APP
	Change the routers IP address to: 192.168.1.1 or 192.168.0.1

For further questions

If problems persist, contact us 24/7 at Service@puppykitty.shop.



Documents / Resources

	<p>PUPPY KITTY Doll Automatic Pet Feeder with Wifi [pdf] User Manual</p> <p>Doll Automatic Pet Feeder with Wifi, Doll, Automatic Pet Feeder with Wifi, Pet Feeder with Wifi, Feeder with Wifi</p>
--	---