

Punkt MCo2 Apostrophy



Punkt MC02 Apostrophy Instructions

[Home](#) » [Punkt](#) » Punkt MC02 Apostrophy Instructions 

Contents

1 Punkt MC02 Apostrophy

2 How to sync contacts with Apostrophy contacts on the MC02

3 Documents / Resources

3.1 References

4 Related Posts



Punkt MC02 Apostrophy



How to sync contacts with Apostrophy contacts on the MC02

1. Ensure you have an internet connection (SIM data or WLAN).
2. Ensure you have completed 'My Account' set up.
3. This guide is to sync contacts with your Personal contacts from your online Apostrophy account. Refer to kb.aphy.app/documentation for more information.
4. Tap 'My Account' from the Home screen and then 'SYNC ACCOUNT'.
5. Tap 'Contacts' on the Home screen.
6. If you have configured 'My Account', correctly then your contacts should have synchronised.
7. Tap the 4 horizontal bars to see the Contacts accounts.
8. To Auto-sync your contacts, Tap to turn on, or configure it in Settings -> Accounts.
9. If your contact list is empty, it may be that you have not completed step 2 – see the 'How to guides' for configuring 'My Account'.

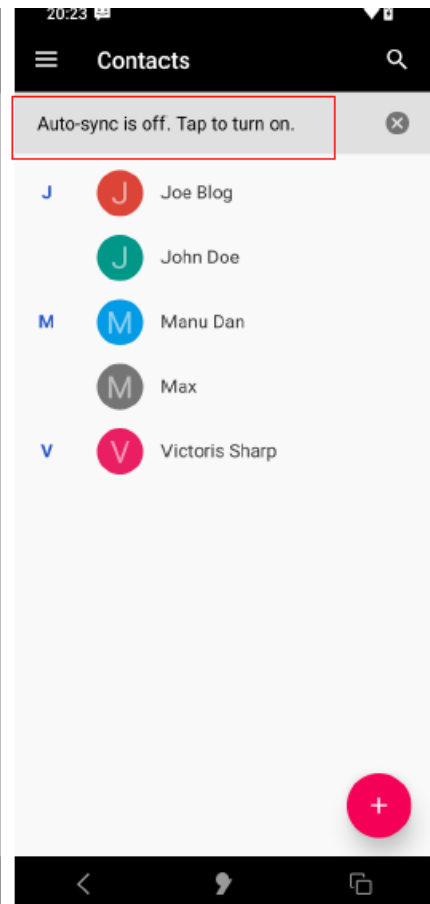
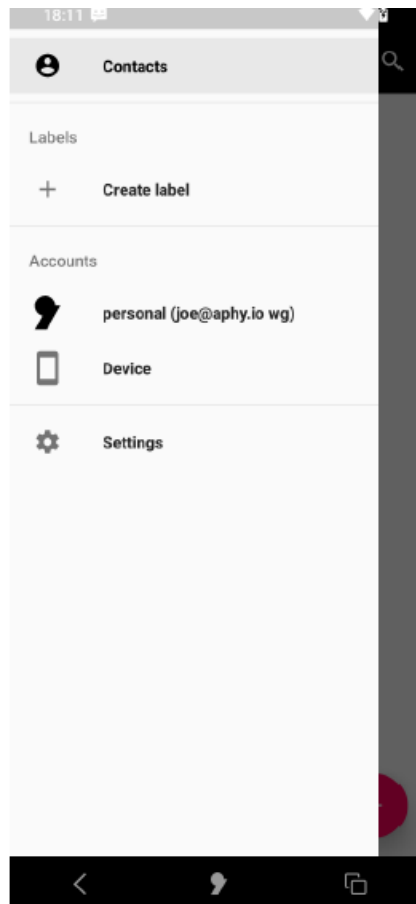
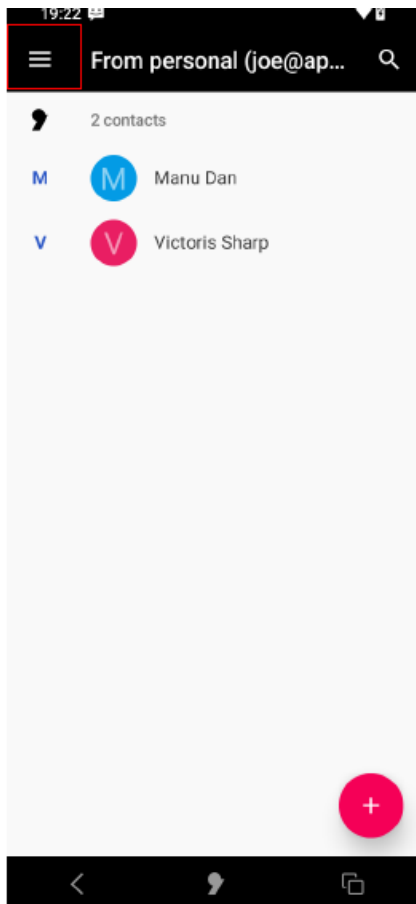
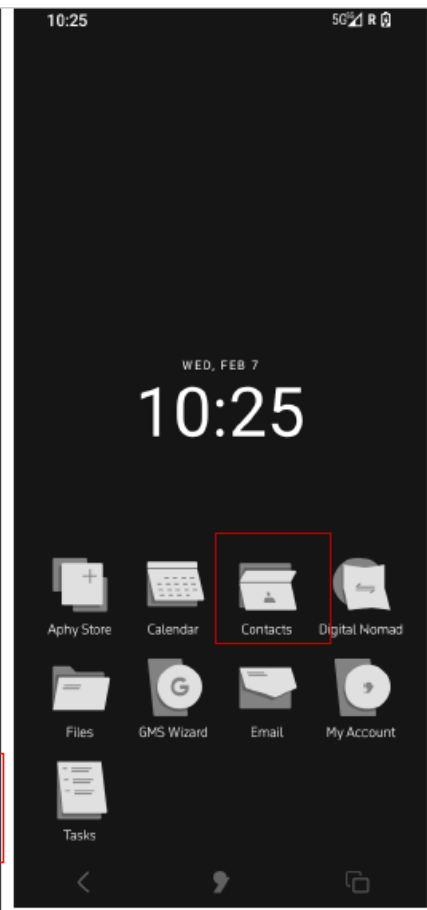
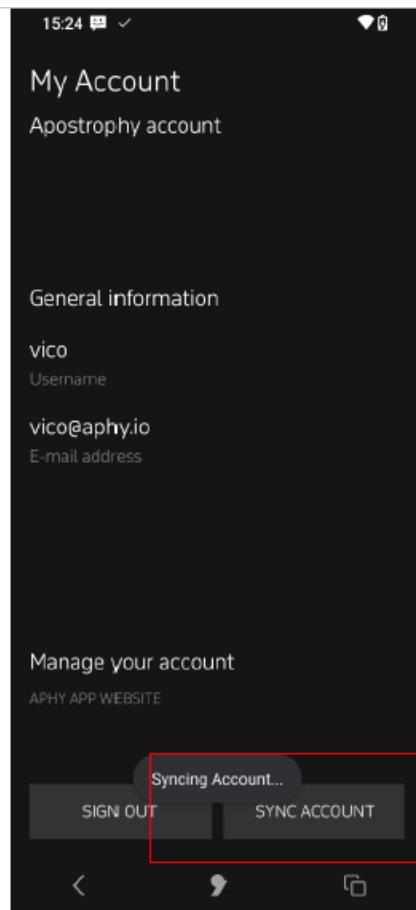
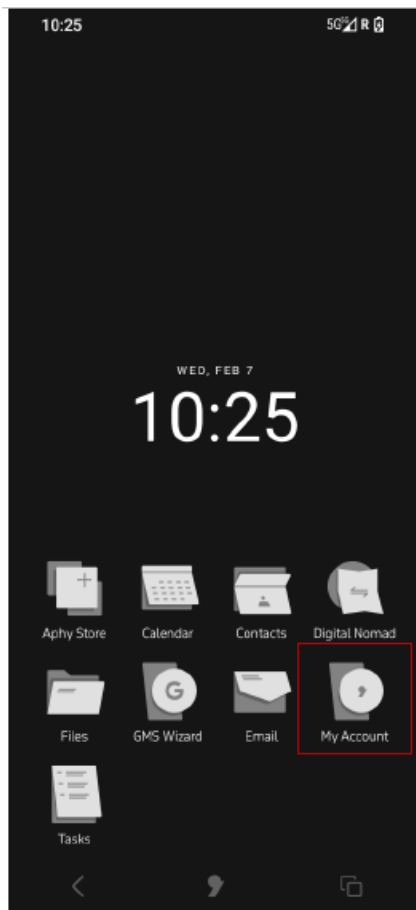

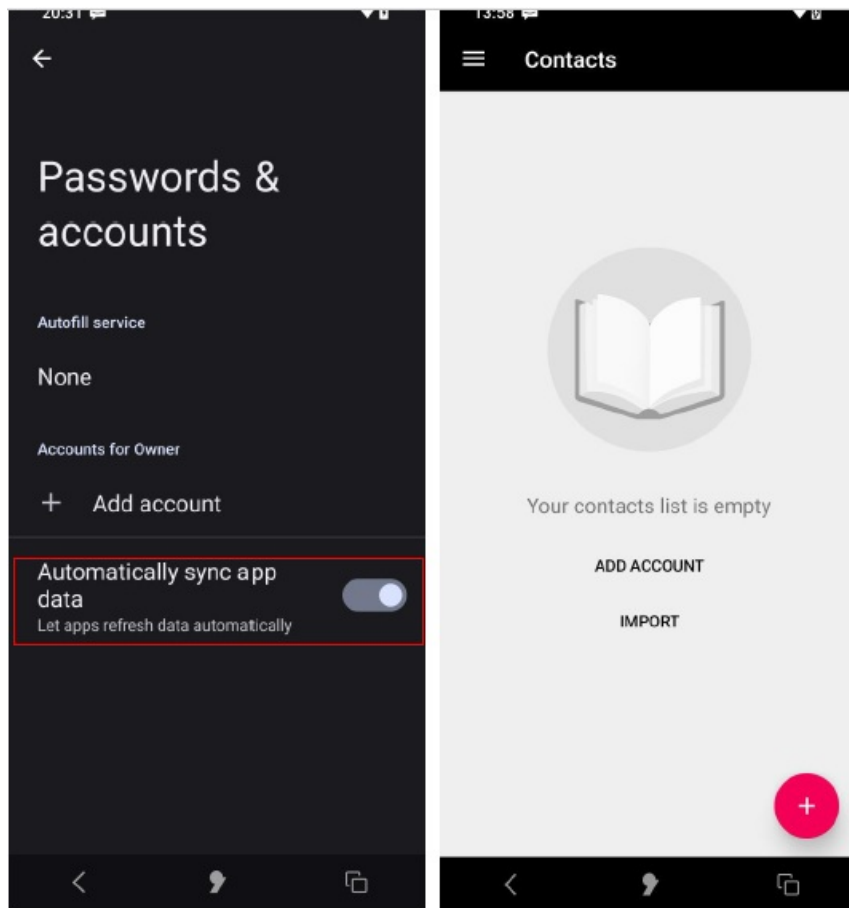

- punkt.ch
- info@punkt.ch
- **Tel** +4 1 91 924 9000 3
- **Fax** +4 1 91 924 9 04
- Punkt Tronics AG Via Losanna
- CH-6901 Lugano Switzerland

Documents / Resources

	Punkt MC02 Apostrophe [pdf] Instructions MC02 Apostrophe, MC02, Apostrophe
---	---

References

- [User Manual](#)

[Manuals+](#), [Privacy Policy](#)

This website is an independent publication and is neither affiliated with nor endorsed by any of the trademark owners. The "Bluetooth®" word mark and logos are registered trademarks owned by Bluetooth SIG, Inc. The "Wi-Fi®" word mark and logos are registered trademarks owned by the Wi-Fi Alliance. Any use of these marks on this website does not imply any affiliation with or endorsement.