

N2P | Pump Controls
Pump Controls N2P
Sentry Remote Alarm
Panel



Pump Controls N2P Sentry Remote Alarm Panel Installation Guide

[Home](#) » [Pump Controls](#) » Pump Controls N2P Sentry Remote Alarm Panel Installation Guide 

Contents

- [1 Pump Controls N2P Sentry Remote Alarm Panel](#)
- [2 Product Information](#)
- [3 Product Usage Instructions](#)
- [4 OVERVIEW](#)
- [5 Installation Instructions](#)
- [6 Documents / Resources](#)
 - [6.1 References](#)
- [7 Related Posts](#)



N2P | Pump Controls

Pump Controls N2P Sentry Remote Alarm Panel



Product Information

Specifications

- Product Name: Sentry Remote Alarm Panel
- Compatibility: Integrates with N2P pump control series
- Functionality: Notifies of faults, compatible with voltage-free contact alarms
- Power Supply: 230V

Product Usage Instructions

Installation Guide

The Sentry controller is designed to notify users of faults and can be integrated with N2P pump control series. It is suitable for pump controls, UV treatment systems, blocked filters, or any application that requires an alarm triggered by a voltage-free contact.

Electrical Work

All electrical work related to the installation of the Sentry controller must comply with required wiring regulations to ensure safety and proper functionality.

Wiring Diagram

Refer to the attached wiring diagram provided in the user manual when installing the controller to ensure correct connections.

Installation Instructions

1. Connect a protected 230V power supply to the alarm panel.

2. Refer to the wiring diagram for proper connections.
3. Ensure all electrical work is conducted according to regulations.
4. Integrate the alarm panel with the compatible N2P pump control series.

FAQ (Frequently Asked Questions)

Q: Can the Sentry Remote Alarm Panel be used with other pump control series?

A: The Sentry Remote Alarm Panel is specifically designed for integration with the N2P pump control series for optimal performance.

Sentry Remote Alarm Panel

Installation Guide

OVERVIEW

The Sentry controller notifies you in the event of a fault and can be integrated with any of the N2P pump control series.

Use it for pump controls, UV treatment, blocked filters, or any application that has a voltage-free contact for an alarm.

CONTROLLER SPECS

The controller is rated to 200–260 VAC, 0.1kW, 50Hz and is designed to be mounted in a standard light switch flush box.

- All electrical work must be carried out per required wiring regulations.
- Refer to attached wiring diagram when installing the controller.

pumpcontrols.com.au pumpcontrols.co.nz

Installation Instructions

1. Connect a protected 230V power supply to the alarm panel. The rated current draw of the alarm panel is <0.1A at 230V.
2. The alarm panel can accept a voltage-free connection to the terminals labelled Black and Brown. If this input closes, a buzzer will sound and the Fault LED will illuminate. The buzzer can be muted by pressing the mute button.
3. When there is no fault, the green System OK LED illuminates.
4. Place the alarm panel into a standard light switch flush box and ensure it is secured in place.

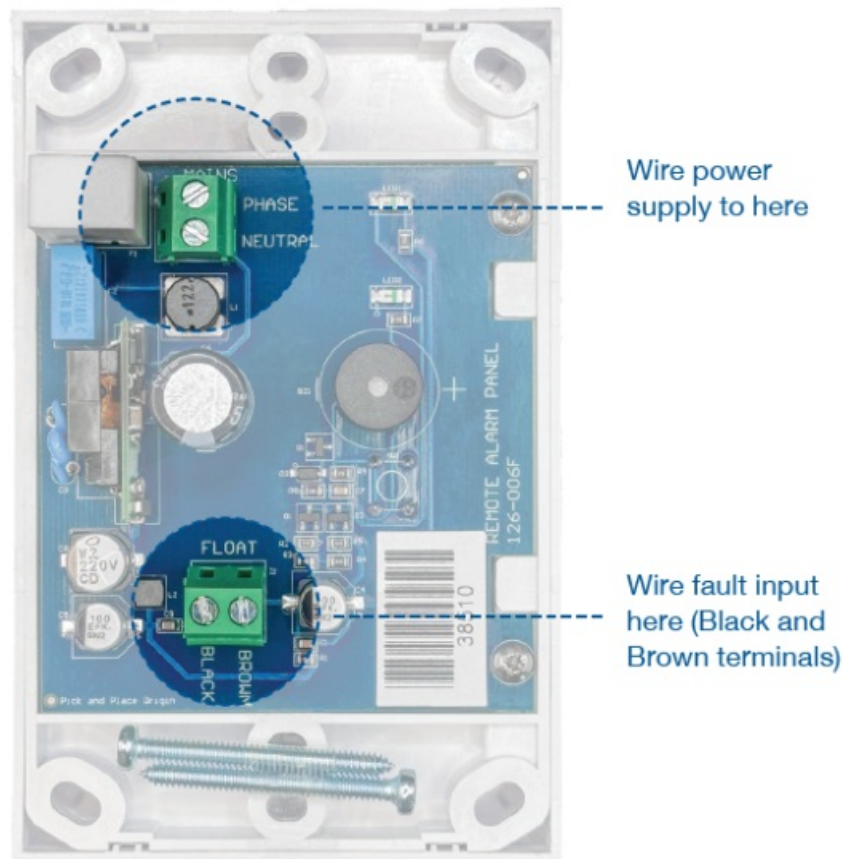

Note: The top two terminals labelled Phase and Neutral is where to wire power supply and the fault inputs are wired into the terminals at base, labelled Float.

Any questions about installation? Please visit our website | www.pumpcontrols.com.au | www.pumpcontrols.co.nz

Documents / Resources

	<p>Pump Controls N2P Sentry Remote Alarm Panel [pdf] Installation Guide</p> <p>N2P Sentry Remote Alarm Panel, N2P, Sentry Remote Alarm Panel, Remote Alarm Panel, Alarm Panel, Panel</p>
---	---

References

- [N2P | Pump Controls](#)
- [N2P | Pump Controls](#)
- [N2P | Pump Controls](#)
- [User Manual](#)

[Manuals+](#), [Privacy Policy](#)

This website is an independent publication and is neither affiliated with nor endorsed by any of the trademark owners. The "Bluetooth®" word mark and logos are registered trademarks owned by Bluetooth SIG, Inc. The "Wi-Fi®" word mark and logos are registered trademarks owned by the Wi-Fi Alliance. Any use of these marks on this website does not imply any affiliation with or endorsement.