



PULWTOP BD205C USB C Dock and Stand for Mac Mini Instruction Manual

[Home](#) » [PULWTOP](#) » PULWTOP BD205C USB C Dock and Stand for Mac Mini Instruction Manual 

PULWTOP BD205C USB C Dock and Stand for Mac Mini Instruction Manual



Contents

- [1 Instruction Manual](#)
- [2 Specifications](#)
- [3 Package Content](#)
- [4 Physical Layout](#)
- [5 SSD Installation Steps](#)
- [6 Troubleshooting](#)
- [7 Documents / Resources](#)
 - [7.1 References](#)
- [8 Related Posts](#)

Instruction Manual

USB3.2 GEN2 10Gbps Hub with Aluminum Profiled USB C cable and all-aluminum profile housing. The USB multiport adapter is easy to use and portable. The total Length of the wire is 40CM plus and the diameter is 5MM. The Mac mini hub stand with high-speed interfaces, it will be a perfect accessory for your Mac Mini.

Specifications

Product Name: USB C Dock & Stand for Mac Mini

Input: USB C Male 3.2 GEN2

Output:

2 USB-C Gen2: 10Gbps

1* UHS-I TF & MicroSD: 104Mb/s

1 * M.2 NVMe & SATA SSD: Max 10 Gbps

Product Size: 135*88* 59mm

Full Load: lower than 48°C

Package Content

- USB.C Hub withstand for Mac mini
- Instruction Manual

Physical Layout

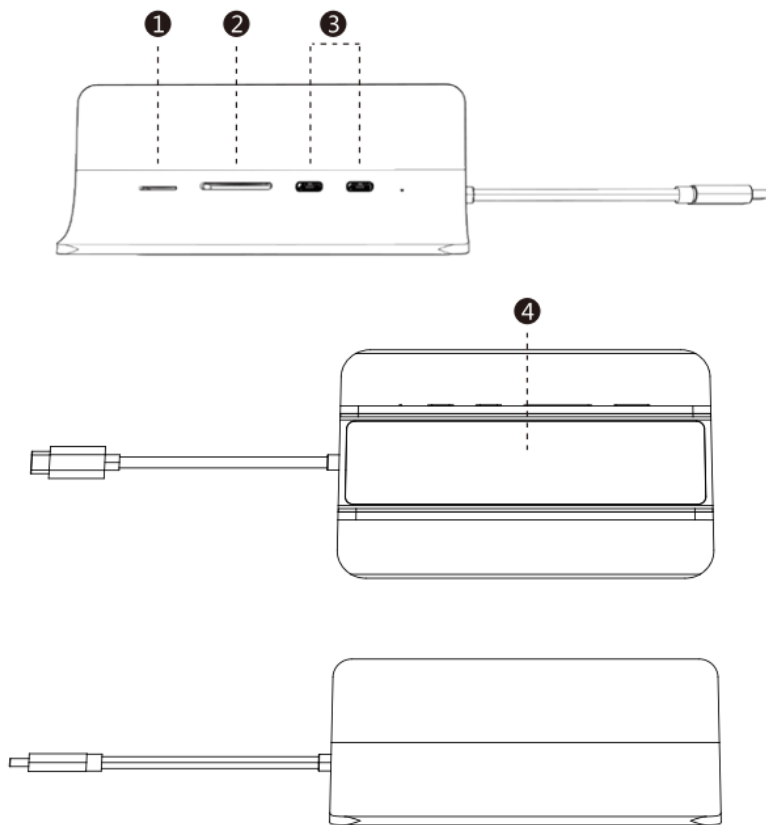

1. TF Card
2. SD Card
3. USBC 3.2 Gen2
4. M.2 NVMe & SATA SSD card slot

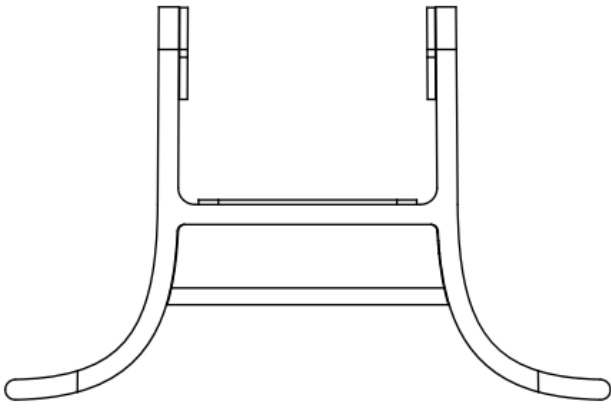

SSD Installation Steps

1. Open the magnetic cover

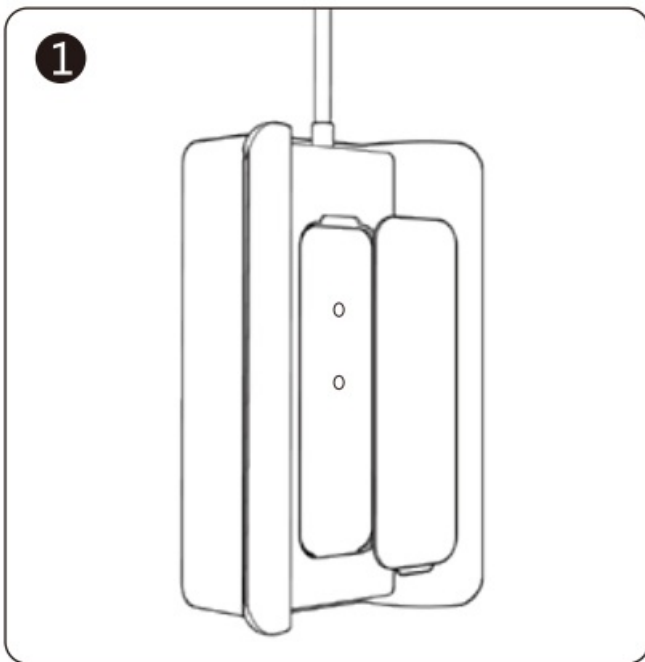

2. Embed SSD

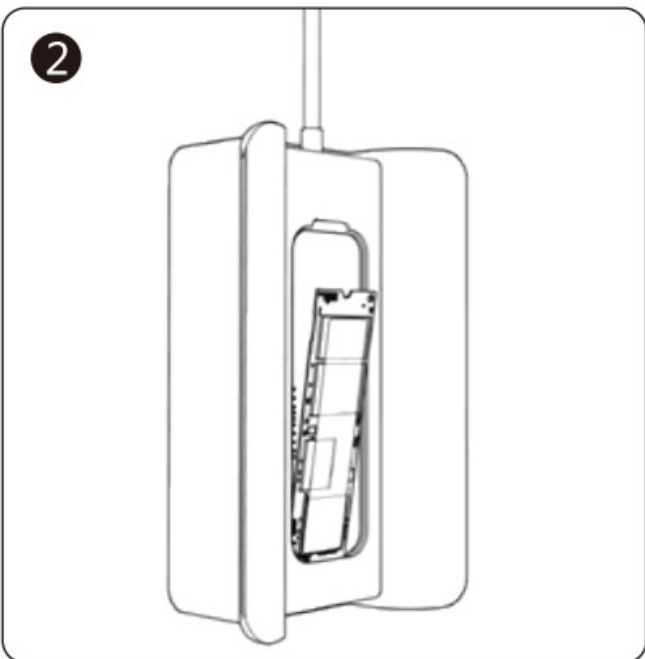

3. Press and fix the rubber cap

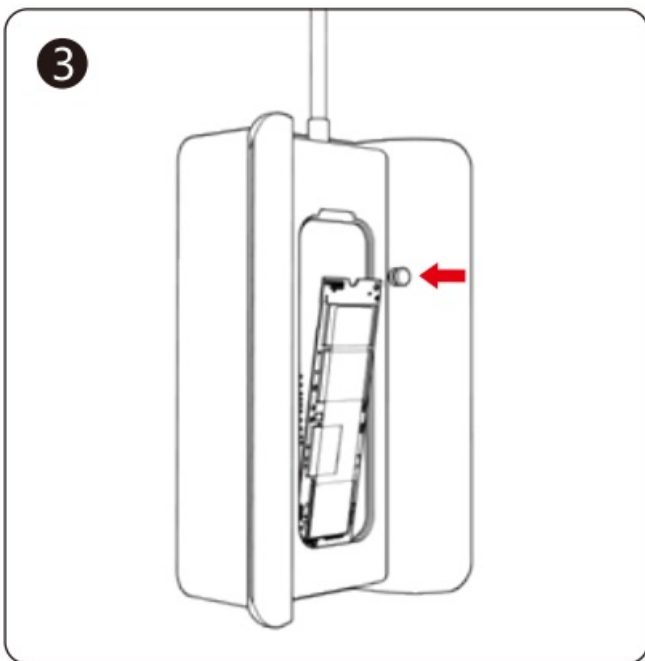

4. Put on the magnetic cover

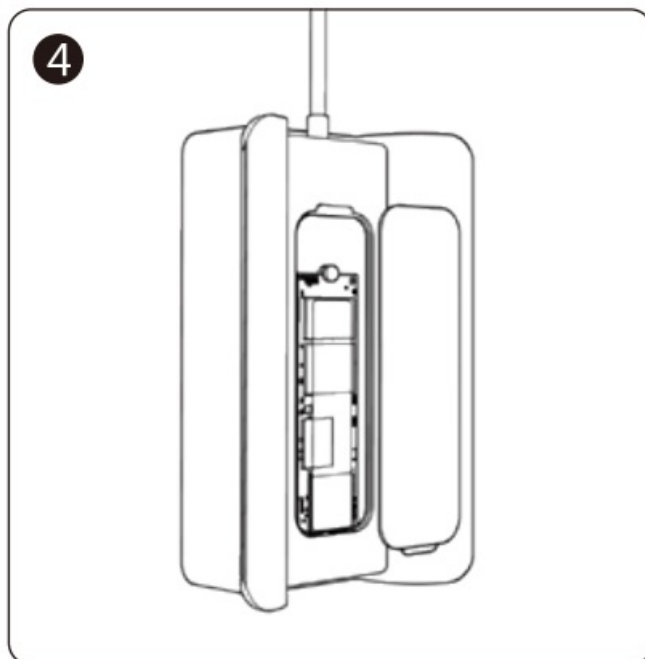

1. Connect the USB C Male 3.2 Gen2 of Mac Mini Hub to the Thunderbolt port of Mac Mini.

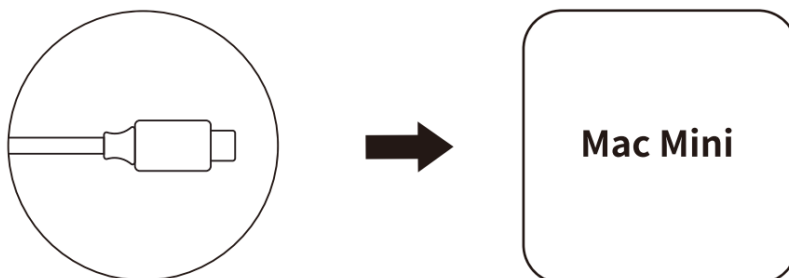

2. The hub supports the M.2 PCIe NVMe SSD interface (Up to 10Gbps), compatible with M.2 NVMe SSD or M.2 SATA SSD (size: 2242/2260/2280). *Please note: The depth of the SSD card slot is about 0.4CM (0.16 inch).



3. Connect the USB peripherals via the USB C 3.2 ports(Only data transfer), data speed is up to 10Gbps. ***Note:** The USB C port only supports data transfer, not support power delivery to the peripherals.

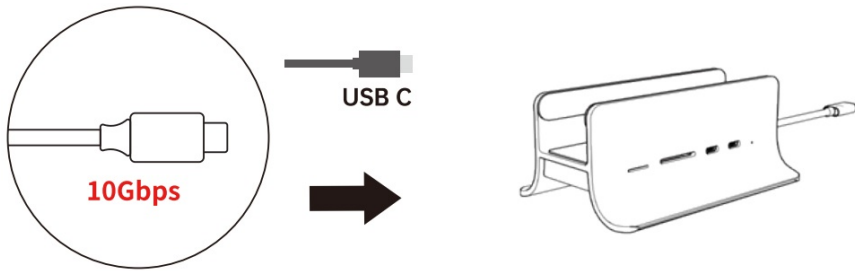

4. Insert SD and TF cards into the card slot to support data speeds of up to 150MB/S (UHS-I). Simultaneous reading, writing, and plugging between all interfaces are not affected.

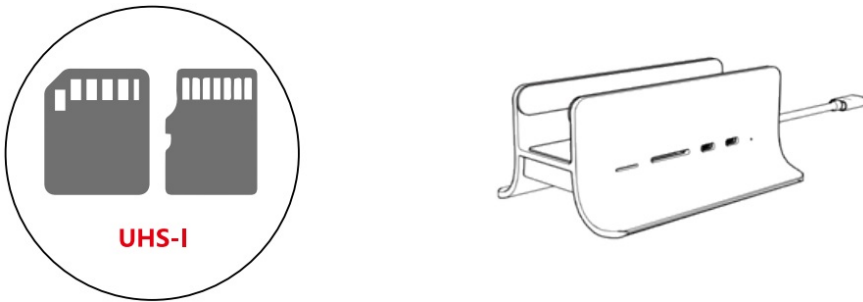

Troubleshooting

Q1: Can USB C on this hub support video displaying?

A1: No, the 2 USB C ports are only support data transmission.

Q2: What SSD should I choose to suit the hub?

A2: This hub is compatible with M Key and B+M Key M.2 SSD (2242/2260/2280).

Some NVMe SSDs compatible:

- Samsung 980 Pro, Samsung 970 EVO;
- Western Digital Black SN850, Western Digital Black SN750,
- Western Digital Blue SN550;
- Acer FA100;
- Crucial P2;
- Intel 670P Series;
- Silicon Motion SM2263XT, etc.

Some M.2 SATA SSDS compatible:

Samsung 860 EVO, Samsung 850 EVO; Western Digital Green, Western Digital Blue; Kingston UV500, Kingston A400; Adata SU800, etc.

Q3: Why can't I get 10Gbps speed?

A3: This 5-port USB-C upstream interface has a maximum theoretical bandwidth of 10Gbps. When we connect only one USB-C port or SSD slot, the maximum speed (10Gbps) can be achieved, but when multiple interfaces are connected, the bandwidth will be automatically allocated, so the actual speed we reach will always be less than 10Gbps.

Q4: Why the hub can't support Apple USB SuperDrive?

A4: Because Apple USB SuperDrive consumes a lot of power, the hub won't provide enough power. It is recommended to connect to the Thunderbolt port on the computer itself.

Documents / Resources

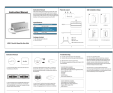

[PULWTOP BD205C USB C Dock and Stand for Mac Mini](#) [pdf] Instruction Manual
BD205C USB C Dock and Stand for Mac Mini, BD205C, USB C Dock and Stand for Mac Mini,
Dock and Stand for Mac Mini, Stand for Mac Mini

References

- [User Manual](#)