

Pulsar eS2 eSports Large Mousepad User Manual

[Home](#) » [Pulsar](#) » Pulsar eS2 eSports Large Mousepad User Manual 

Contents

- [1 Pulsar eS2 eSports Large Mousepad](#)
- [2 Product Information](#)
- [3 Product Usage Instructions](#)
- [4 INSTRUCTION](#)
- [5 Installation](#)
- [6 Documents / Resources](#)



Pulsar eS2 eSports Large Mousepad

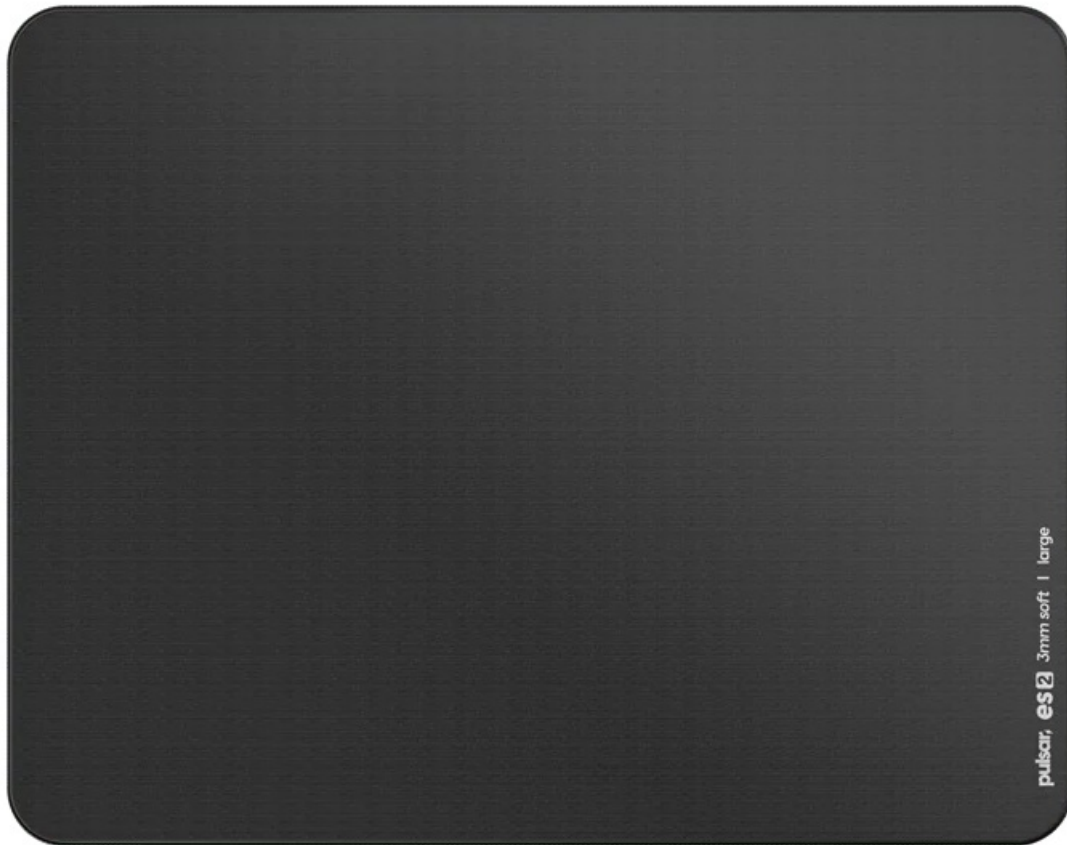

Product Information

The product is an electronic device designed for various applications. It is compact, lightweight, and easy to use. The device comes with multiple features and settings to meet your specific needs. Please read the user manual carefully before using the product.

Product Usage Instructions

Please follow the steps below to install and use the product:

1. Choose a suitable location for installation, ensuring proper ventilation and accessibility to power sources.
2. Connect the product to the power source using the provided cable.
3. Once powered on, familiarize yourself with the control buttons and display panel.
4. Refer to the user manual for specific instructions on how to navigate through the different features and settings.
5. To use a specific application, select the corresponding mode or option from the menu.
6. Adjust any customizable settings according to your preferences.
7. For troubleshooting and maintenance, refer to the troubleshooting section in the user manual.
8. When not in use, turn off the product and disconnect it from the power source.

For further details and safety instructions, please refer to the complete user manual provided with the product.

INSTRUCTION

- Please avoid letting the bottom materials stick with each other.
- Please be gentle when peeling off the mouse pad from your table.
- Please wipe the bottom with damp microfiber cloth when it is dirty (please don't use alcohol)

Installation

1. First, thoroughly wipe the desk where you want to put the pad, making sure that there is no dust or residue left before applying the pad.

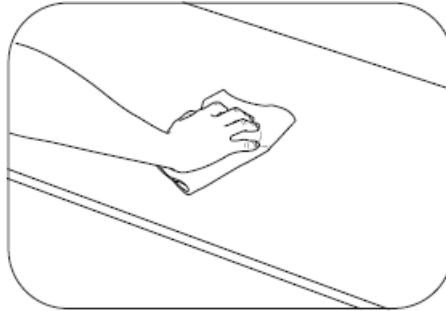

2. Remove the protective paper sheet.

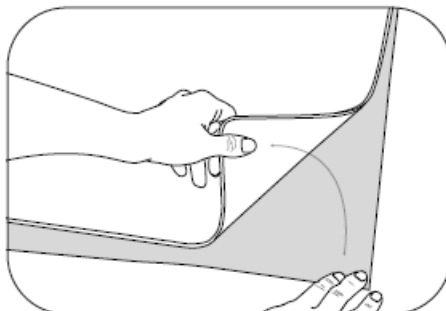

3. Start by applying the pad on one side, and then progressively apply the pad towards the opposite side. Make sure to apply enough pressure on all of the surface of the pad to push out any air that gets trapped beneath.

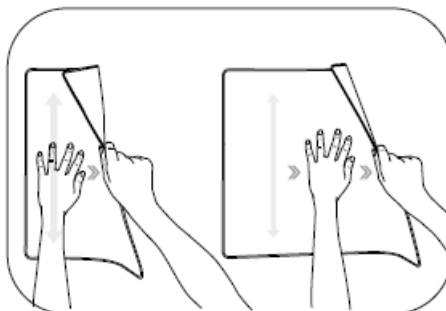

4. Finally, after you have applied your pad on the desk, check the surface of the pad with your hands and make sure that no air is left trapped underneath. Push out any left air bubbles from the center of the pad towards the sides.

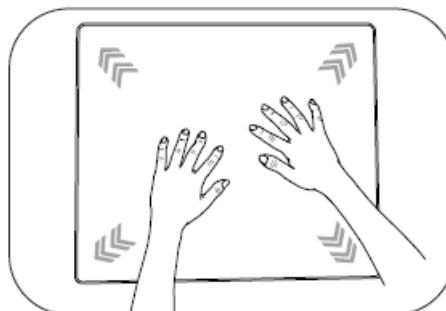

Documents / Resources



[Pulsar eS2 eSports Large Mousepad](#) [pdf] User Manual
eS2 eSports Large Mousepad, eS2 eSports, Large Mousepad