



PROTOCOL AEROFLUX Folding Drone with Live Streaming Camera Instruction Manual

[Home](#) » [PROTOCOL](#) » PROTOCOL AEROFLUX Folding Drone with Live Streaming Camera Instruction Manual



Contents

- [1 PROTOCOL AEROFLUX Folding Drone with Live Streaming Camera](#)
- [2 DRONE DIAGRAM](#)
- [3 ACCESSORIES INCLUDED](#)
- [4 BATTERY CHARGING FOR DRONE](#)
- [5 A BATTERY INSTRUCTIONS](#)
- [6 ADDITIONAL BATTERY INFORMATION AND WARNINGS](#)
- [7 INSTALLING REMOTE BATTERIES](#)
- [8 FAQ](#)
- [9 Documents / Resources](#)
- [10 Related Posts](#)

protocol

PROTOCOL AEROFLUX Folding Drone with Live Streaming Camera



Product Information

- **Product Name:** Folding Drone with Live Streaming Camera
- **Model Number:** SMPTC-90008
- **Supplier:** Samsonico USA LLC
- **Address:** 4925 Westin Park Dr. Conway, Arkansas, 72034, USA
- **Manufactured in:** China

Product Usage Instructions

1. Do not mix old and new batteries.
2. Do not mix alkaline, standard (carbon-zinc), or rechargeable (ni-cad, ni-mh, etc.) batteries.
3. Ensure compliance with FCC Rules:
 - This device may not cause harmful interference.
 - This device must accept any interference received, including interference that may cause undesired interference.
 - To mitigate interference, you can:
 - Reorient or relocate the receiving antenna.
 - Increase the separation between the equipment and the receiver.
 - Connect the equipment to an outlet on a circuit different from that to which the receiver is connected.
 - Consult the dealer or an experienced radio/TV technician for help.
4. Additional Battery Information and Warnings:
 - Do not mix old and new batteries.
 - Do not mix alkaline, standard (carbon-zinc), or rechargeable (ni-cad, ni-mh, etc.) batteries.
5. To fold the drone:
 - Follow the instructions provided by the manufacturer.
6. For live streaming camera usage:
 - Refer to the instruction manual provided by the manufacturer.

Please read this manual carefully before operation and keep it properly for future reference.

DRONE DIAGRAM

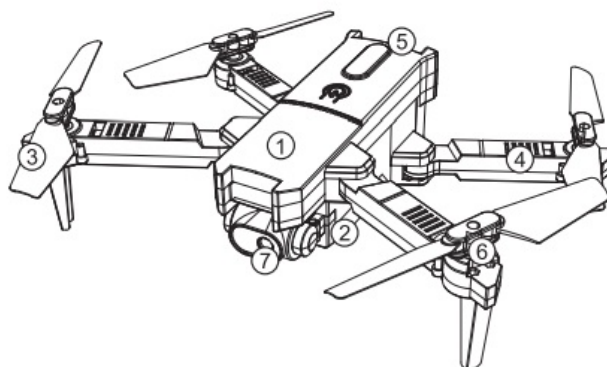

1. Upper Body

2. Lower Body
3. Propeller
4. Arm
5. Battery
6. Motor
7. camera

ACCESSORIES INCLUDED

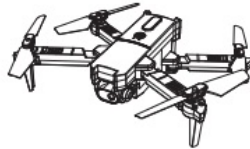

Drone x1
(Battery included)

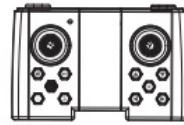

Remote Control x1

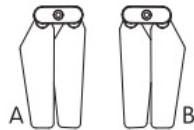

Spare Propellers Ax1 Bx1



Blade Guard x4



USB Charger x1



Screwdriver x1



User Manual x1

PRE-FLIGHT PREPARATION

FLIGHT ENVIRONMENT



Indoor: Large spaces away from barriers, crowds or pets.



Outdoor: Sunny, windless and breezy weather.



Please keep the drone in sight during the flight and keep it away from barriers, high-tension cables, trees and people.



Do not fly in extreme environment, such as extreme heat or cold, strong wind or heavy rain.

OPEN THE ARMS

OPENING STEPS

Open the front arm(close to the camera)

Open the back arm

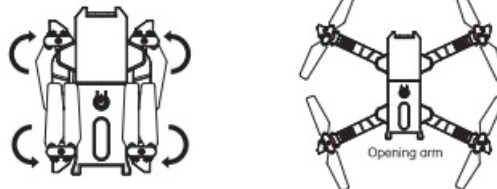

ASSEMBLING BLADE GUARDS

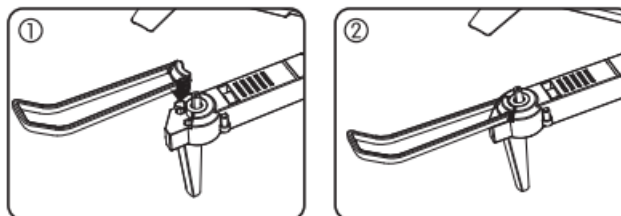

Align the blade guard with the arm (Figure 1) and press until it is securely in place (figure 2).

ASSEMBLING PROPELLERS

Align the blades with the motor shaft and install them, the arm letter must be consistent with the blade letter. Tighten the screw clockwise.

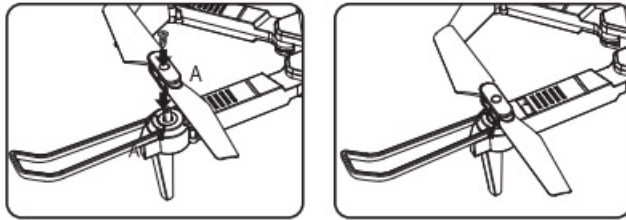

BATTERY CHARGING FOR DRONE

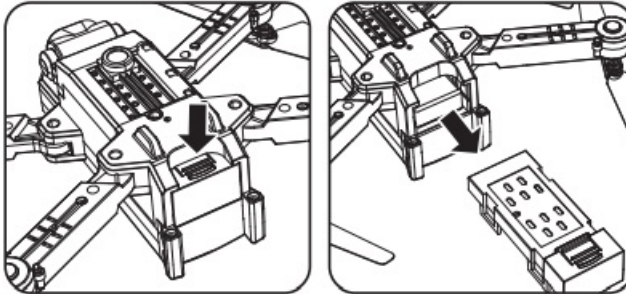

- Remove the lithium battery from the bottom of the drone

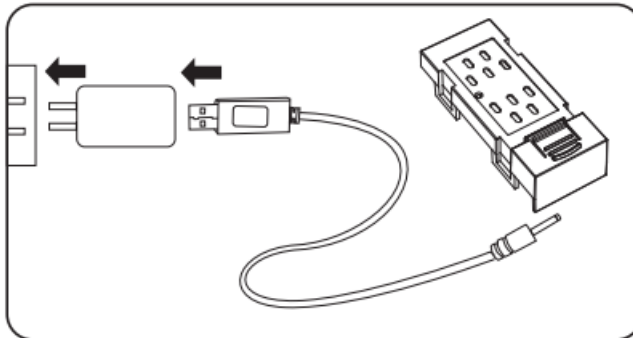

- Connect the USB charging cable with the charging interface of the lithium battery.

A BATTERY INSTRUCTIONS

- A body injury or property loss. Users must be aware of the risks and take full responsibility for using batteries improperly.
- If battery leakage occurs, please avoid contacting your eyes or skin with electrolytes. Once it happens, please wash your eyes with clean water and seek medical care immediately.
- Please remove the plug immediately if you sense any unusual smell noise or smoke!

Battery Charging

- Please use the charger from the original factory to ensure safe
- Do not charge the outworn battery.
- Do not overcharge the battery. Please unplug the charger once fully charged.
- Do not charge the battery next to inflammable, such as carpet, timber floor, or wood furniture, or on the surface of electro-conductive objects.
- Please always keep an eye on the battery when charging.
- Do not charge the battery which has not cooled down yet.
- The charging temperature should be between 0°to 40°C.

Battery Recycling

- Do not dispose of the battery as daily rubbish. Please familiarize yourself with the local garbage disposal method and dispose of it according to the special requirement.

ADDITIONAL BATTERY INFORMATION AND WARNINGS

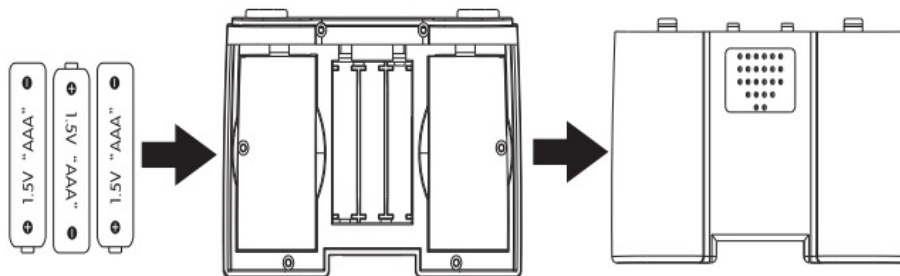

We recommend the use of alkaline batteries only. Always connect the battery to the correct polarity + to + and – to –. Do not throw away used batteries in the garbage, use recycling centers or dispose of them at a recycling depot. Do not dispose of batteries in a fire, they may leak or explode. Univ uses the batteries special. Batteries should be replaced by adults. Check batteries regularly for any leaks. Remove empty batteries. Do not recharge Non-rechargeable batteries. Store charging remove rechargeable batteries. Rechargeable batteries must be charged under adult supervision only. Do not mix old and new batteries and Do not mix alkaline, standard carbon zinc or etc. Connection terminal must not be short-circuited. Subject to technical change and change of color. Please keep this information for future reference.

"This device complies with part 15 of the FCC Rules. Operation is subject to the following two conditions: (1) This device may not cause harmful interference. This device must accept any interference received, including interference that may cause undesired operation. **CAUTION:** Changes or modifications not expressly approved by the party responsible for the compliance could void the user's authority to operate the equipment."

Note: This equipment has been tested and found to comply with the limits for a Class B digital device, pursuant to part 15 of the FCC Rules. These limits are designed to provide reasonable protection against harmful interference in a residential installation. This equipment generates, uses, and can radiate radio frequency energy and, if not installed and used in accordance with the instructions, may cause harmful interference to radio communications. However, there is no guarantee that interference will not occur in a particular installation. If this equipment does cause harmful interference to radio or television reception, which can be determined by turning the equipment off and on, the user is encouraged to try to correct the interference by one or more of the following measures:

- Reorient or relocate the receiving antenna.
- Increase the separation between the equipment and the receiver.
- Connect the equipment to an outlet on a circuit different from that to which the receiver is connected.
- Consult the dealer or an experienced radio/TV technician for help.

Product name: AEROFLUX FOLDING DRONE WITH LIVE STREAMING CAMERA

- Model NO- SMPTC.OnCOS
- Supplier: SAMSONICO USA LLC
- Address 4C25 WESTIN PARK
- DR.CONWAY ARKANSAS, 72034, USA FC
- MADE IN CHINA

REMOTE CONTROL DIAGRAM

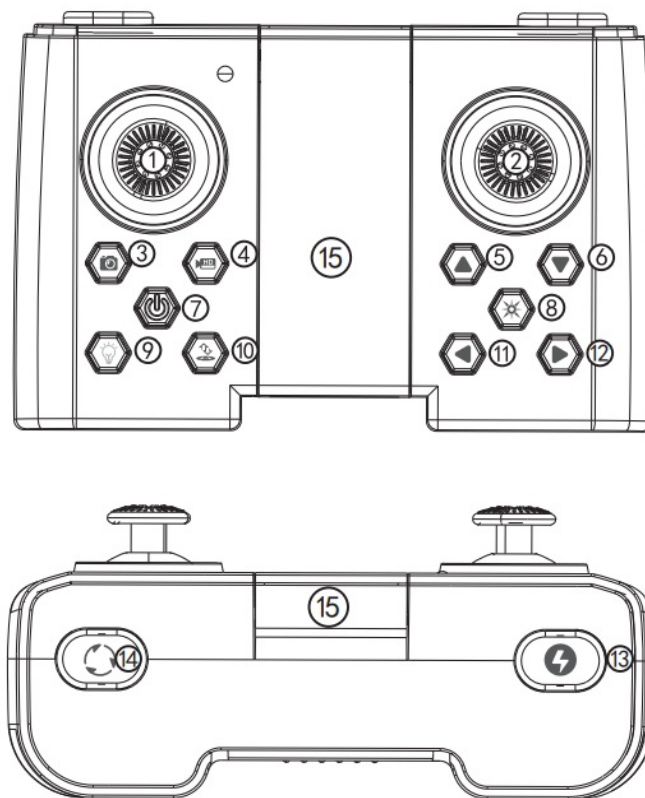

1. Left Stick
2. (Throttle Up/Down
3. Left/Right Turn)
4. Right Stick
5. (Forward/Backward
6. Left/Right Bank)
7. Photo Video
8. Forward Trim
9. Backward Trim
10. Power On/Off
11. Headless Mode
12. right On/Off
13. One keymapping
14. Left Trim Right Trim
15. Speed Flips
16. Phone Holder-Pull up to install phone

INSTALLING REMOTE BATTERIES

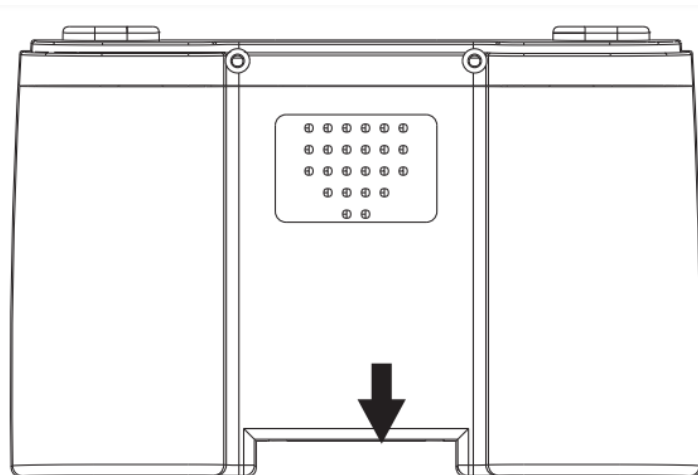

Open the remote control battery cover Remote control battery installation

AAA batteries

Open the battery cover and insert the 3 AAA batteries correctly according to the electrode instructions. (Batteries not included)

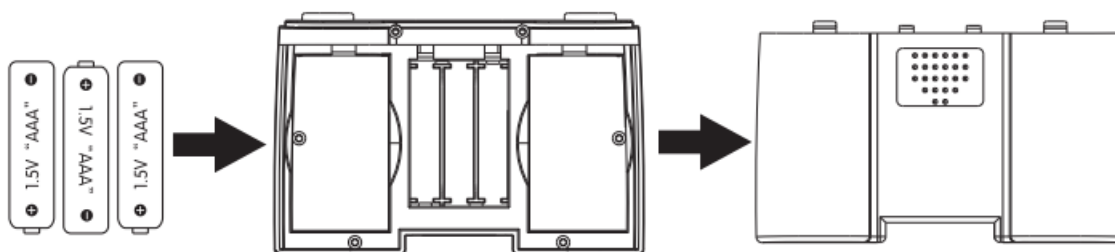

Notes

1. Make sure the batteries are loaded correctly according to the polarity indications on the battery compartment.
2. Please do not mix old and new batteries together.
3. Please do not mix different types of batteries together.

TURNING ON AND SYNCING THE DRONE&REMOTE

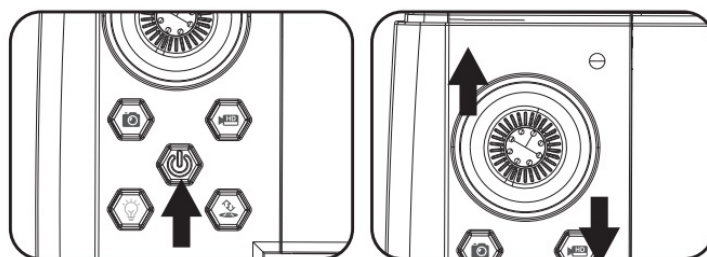

1. Turn on the drone and place it on a level surface. Then turn on the remote. The indicator light of the remote and the drone's LED will flash.
2. Push the throttle up and then down. The drone will beep twice and the lights will go steady. Syncing is complete.

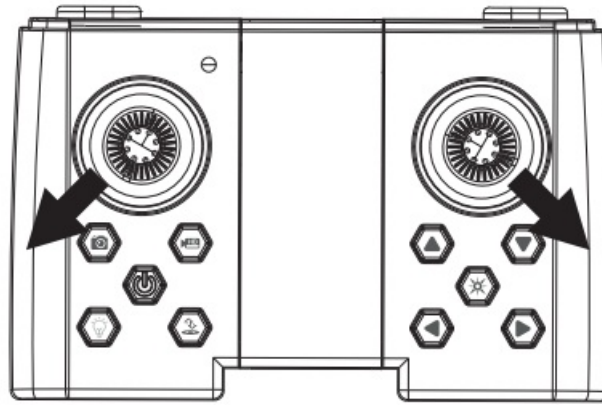

CALIBRATING THE DRONE

If the aircraft cannot rise vertically after taking off, it can be corrected by pulling the left and right joysticks into a lower outer corner at the same time. The remote will beep and the indicator lights will flash quickly and then go steady. Calibration is complete.

START YOUR FLIGHT

Idle Mode: Push the throttle up and release. The drone's blades will spin but the drone will not take off. The blades will stop spinning after 5-6 seconds of inactivity.

One-key Take-off

Press the "One-key Take-off" button, and the drone blades rotate and automatically fly to a height of 1.5 meters

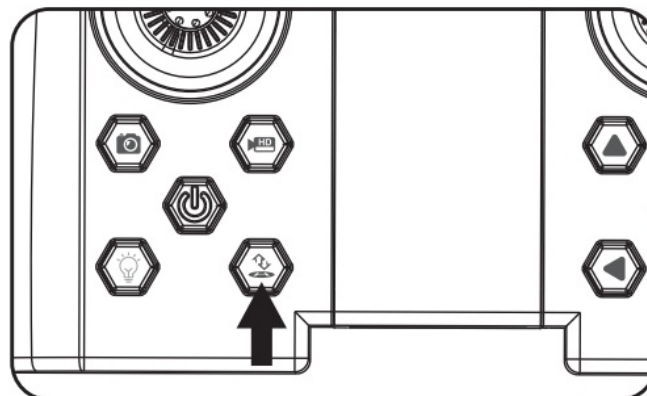

Basic Flight

Use the left joystick to control the flight altitude and turn the left/right, and the right joystick to control the forward, backward, left, and right side flight directions.

360° FLIPS

When the drone reaches more than 3 meters high, press the Flip button and move the right joystick in the desired direction.

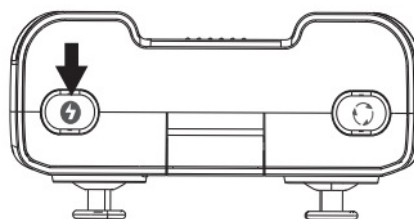

The drone will rotate in that direction. Right joystick Flip Backward

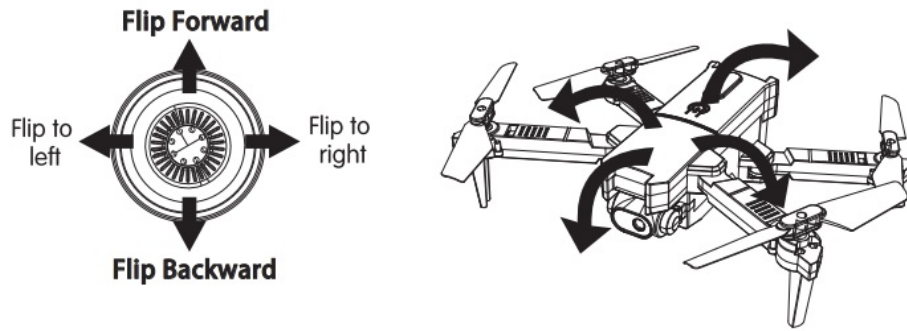

Headless Mode

Users have the option to exit the default orientation (the nose is the front of the drone). In Headless Mode, users can operate the drone without orientation. Regardless of where the drone is pointing, it will turn left or right according to the remote's command. Turn on the drone and remote and calibrate. Press the Headless Mode key. The remote will beep once and engage. Press again to leave Headless Mode. The remote will beep again and return to the default orientation

Speed Mode

When the aircraft takes off, it is by default in the low-speed mode (3-gear switching); gently press the speed button. A "beep" sound for low-speed gear, two "beep" sounds for medium-speed gear and three "beep" sound for high-speed gear.

Hover

When you release the left joystick (throttle) after the ascent/descent action, the drone will hover at a certain height.

Left joystick

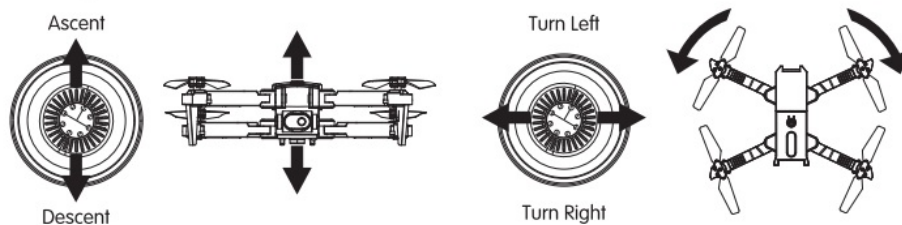

Right joystick

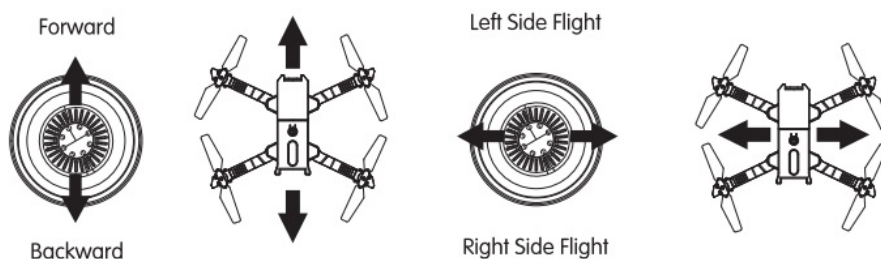

TRIM FUNCTION

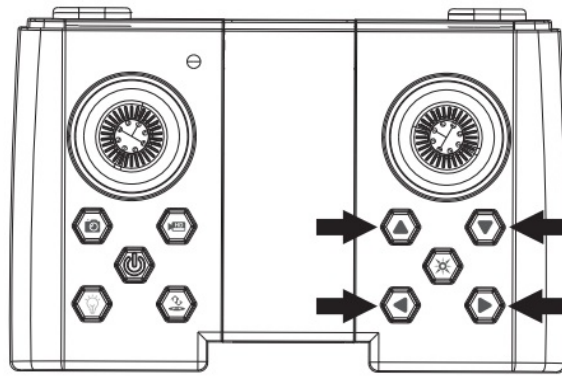

When the aircraft drifts in different directions, you can use the trim to correct it. When the aircraft leaves the ground and the aircraft deviates to the back/forward, press the Forward/ Backward trim key to trim. When the aircraft leaves the ground and the aircraft deviates to the left/right, press the Right/Left trim key to adjust. The remote will emit a long beep when the drone is centered.

1. Forward/ BackwardTrim
2. Left/Right Bank Trim

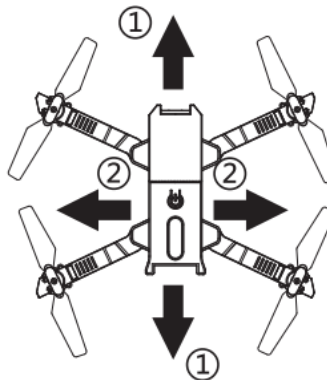

Notes

When the drone is within 30cm of the ground, it will be affected by the blade vortex and become unstable. This is the “ground effect The lower the drone is, the greater the effect will be.

FAQ

PROBLEMS	CAUSES	SOLUTIONS
Control failure	Not connect with the quadcopter battery.	Connect the quadcopter battery in right way.
	Too strong wind force.	Do not fly in windy days. The performance and the control of the quadcopter will be affected by the strong winds.

Fail to ascend	The rotation speed of main blades is too slow.	Push up the throttle joystick.
	The battery of the quadcopter is not fully charged.	Please fully charge the quadcopter.
Landing too soon	The throttle stick is pulled down too fast.	Pull down the throttle stick slowly to perform a smooth landing.
Out of control	Beyond the effective controlling distance.	Ensure operation within the controllable distance: remote control of 100 meters and WIFI control of 40–50 meters.

APP INSTRUCTIONS & PHOTO/VIDEO INSTALLING AND CONNECTING TO THE APP

1. The App is available in both Apple and Android App stores Search "Protocol AeroFlux" and connect to you.
2. Turn on the drone and the remote.
3. Once it turned on, AeroFlux will transfer a WiFi signal. Make sure your smartphone is connected to the signal.
4. Open the App and press 'START'.
5. It will show and live stream the camera view.

The App contains a guide for icons and functions, including photos and videos, within the App. -or inquiries

Documents / Resources

	<p>PROTOCOL AEROFLUX Folding Drone with Live Streaming Camera [pdf] Instruction Manual</p> <p>F190, 2AWOUF190, AEROFLUX Folding Drone with Live Streaming Camera, AEROFLUX, Folding Drone with Live Streaming Camera, AEROFLUX Folding Drone, Folding Drone, Drone</p>
---	--