



# ProtoArc XK03 Foldable Keyboard User Manual

[Home](#) » [ProtoArc](#) » ProtoArc XK03 Foldable Keyboard User Manual 

# ProtoArc

XK03

User Manual

Portable Folding Ergonomic Keyboard

## Contents

- [1 Product Features](#)
- [2 Bluetooth Connection](#)
- [3 How to Switch Between Three Devices](#)
- [4 Keyboard Charging](#)
- [5 Multimedia Function Keys](#)
- [6 Product Parameters](#)
- [7 Warm Reminder](#)
- [8 Sleep Mode](#)
- [9 Packing List](#)
- [10 Documents / Resources](#)
- [11 Related Posts](#)

## Product Features

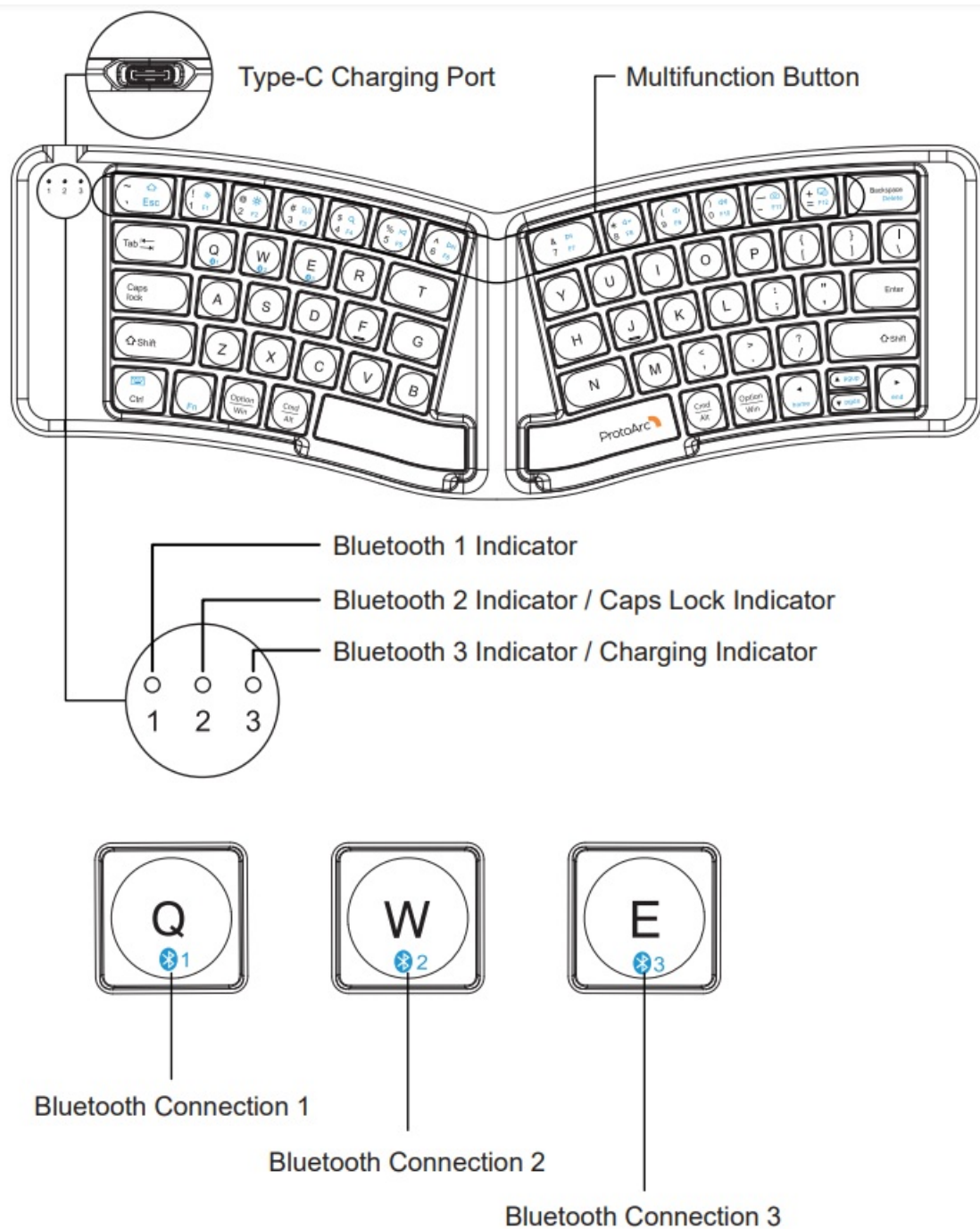

## Bluetooth Connection

1.

1

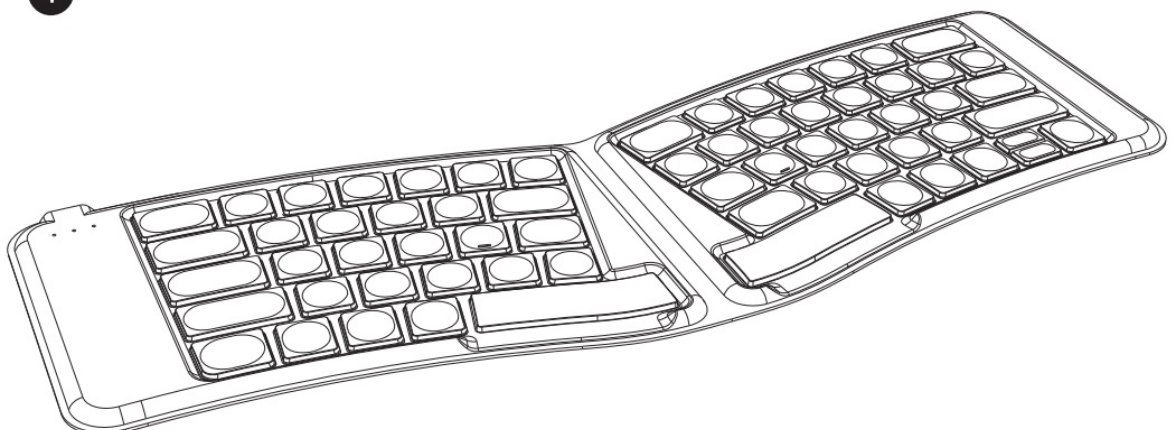

## Unfold the Keyboard

2

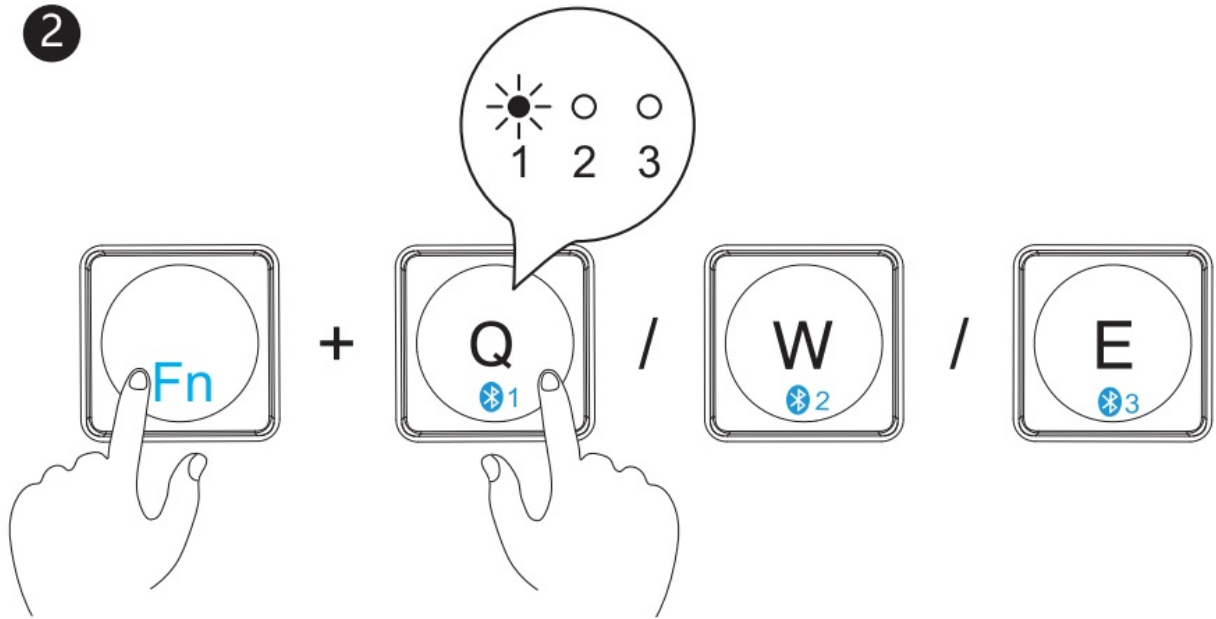

2. Shortly press “Fn” + “\*1/\*2/\*3” to choose the channel; Long press “Fn” + “\*1/\*2/\*3”, the white indicator flash quickly, and the keyboard enters into pairing mode.

## Windows 10 System

1. Click “Bluetooth Devices”.

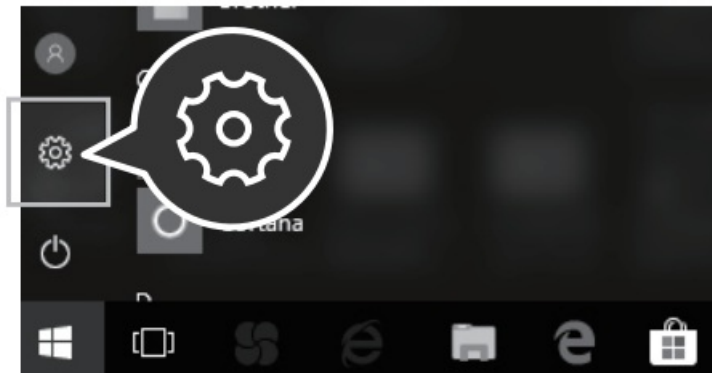

2. Click “Add or Remove Bluetooth Devices”.

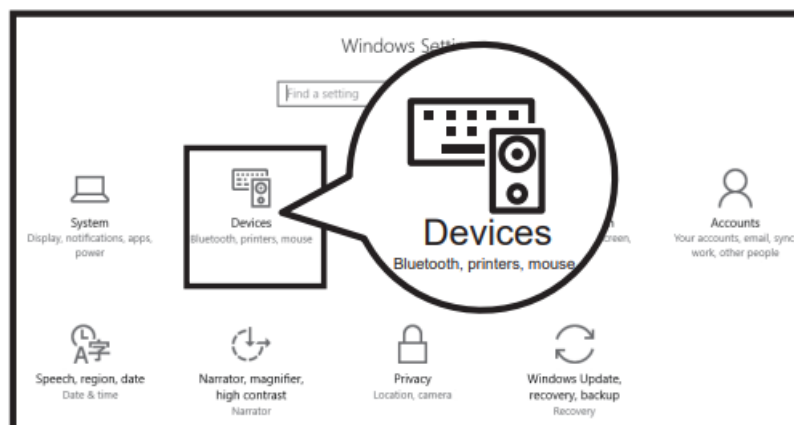

3. Your computer will automatically search for “ProtoArc XK03” and then click “pair”.

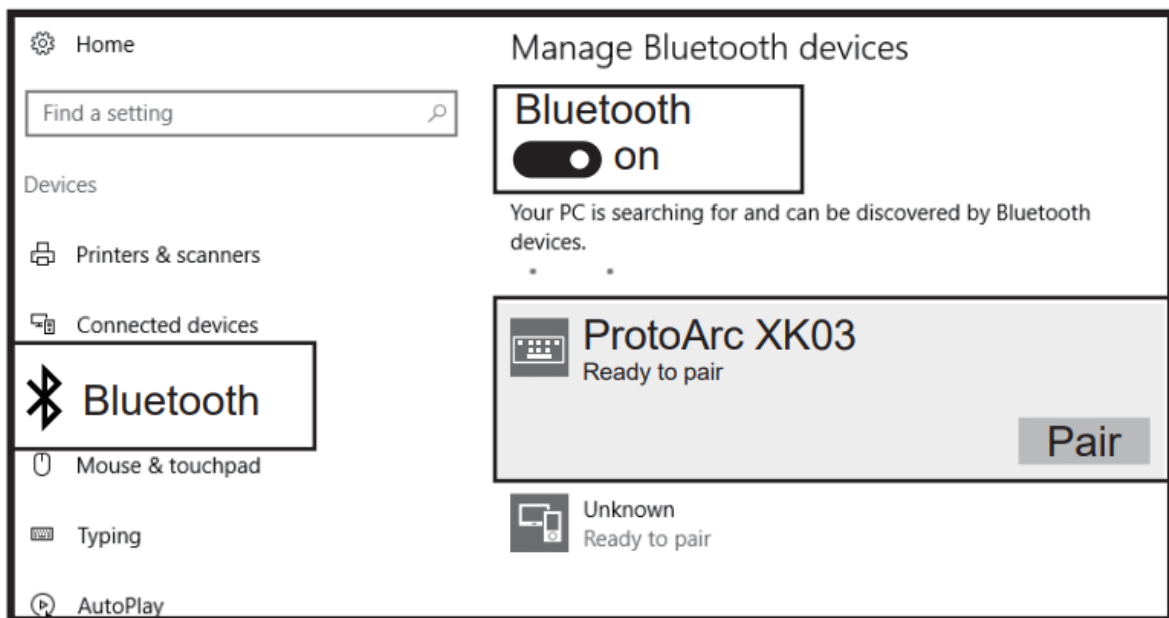

4. "ProtoArc XK03" is connected and it can be used normally.

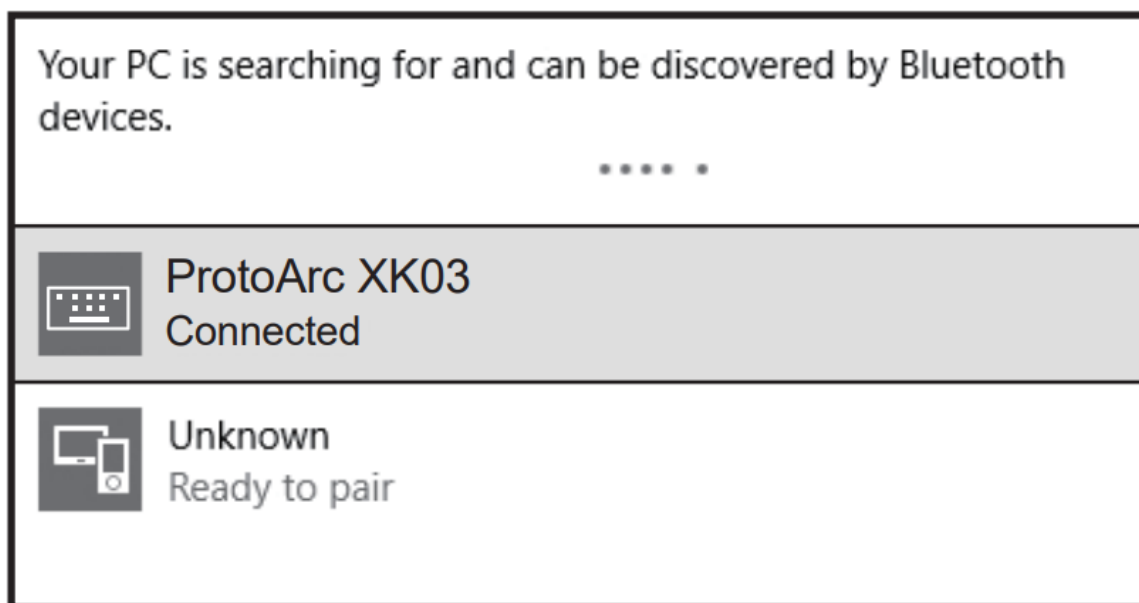

## Mac OS System

Please complete the Bluetooth connection step ①② before pairing.

1. Click "System Preferences" on Mac.



2. Click “Bluetooth” in “System Preferences”.

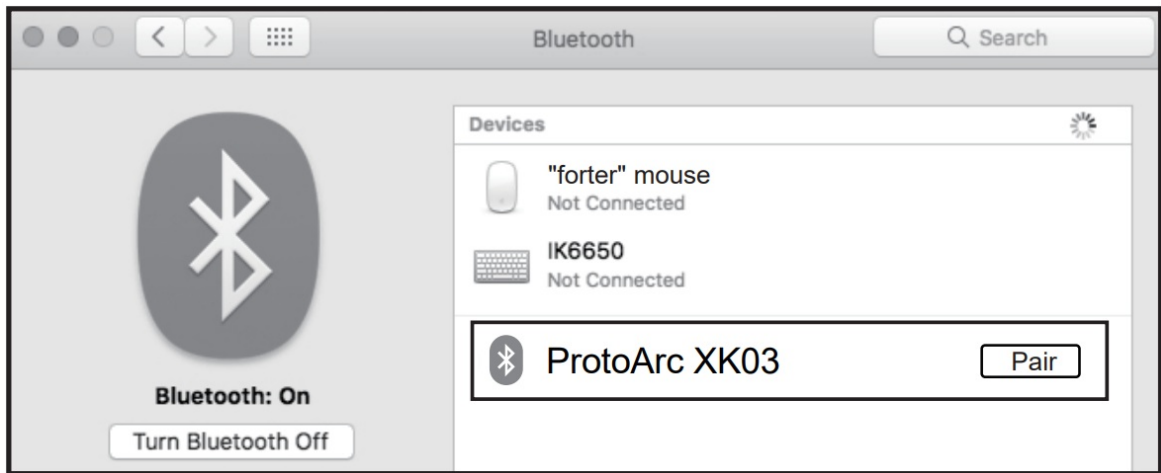

3. Your device will automatically find “ProtoArc XK03”, then click “pair”, when it shows connected, the keyboard is ready to use.

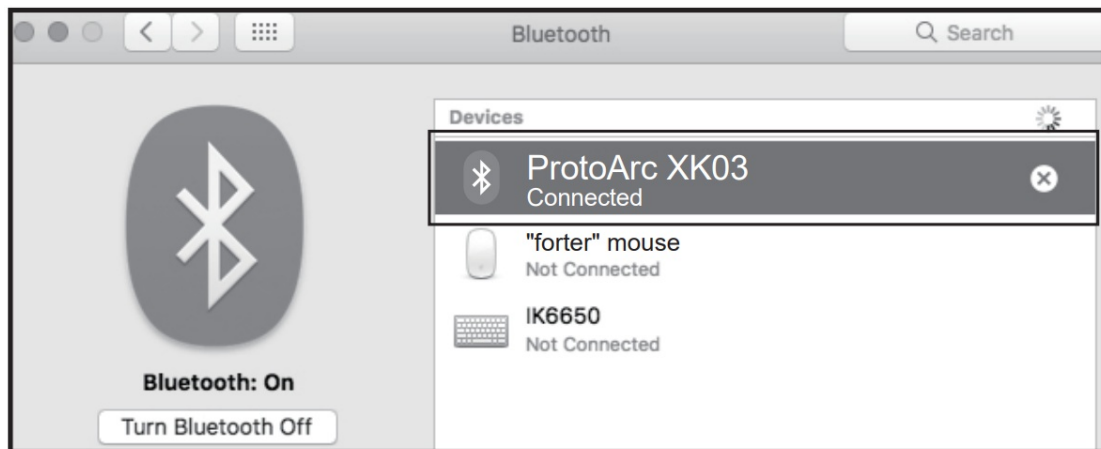

## iOS System

Please complete the Bluetooth connection step ①② before pairing.

1. Click “Settings” on the device and then turn on Bluetooth.



2. Your device will automatically find “ProtoArc XK03”, then click “pair”, complete pairing.

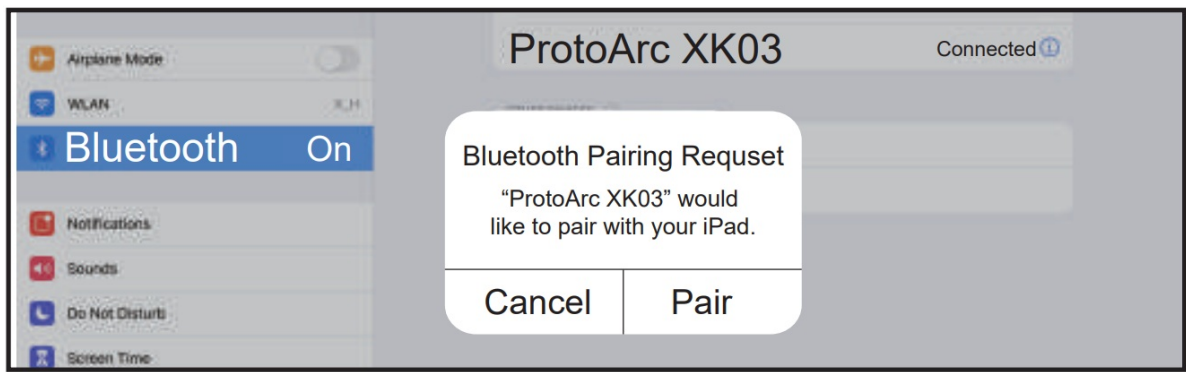

3. "ProtoArc XK03" is connected and it can be used normally.

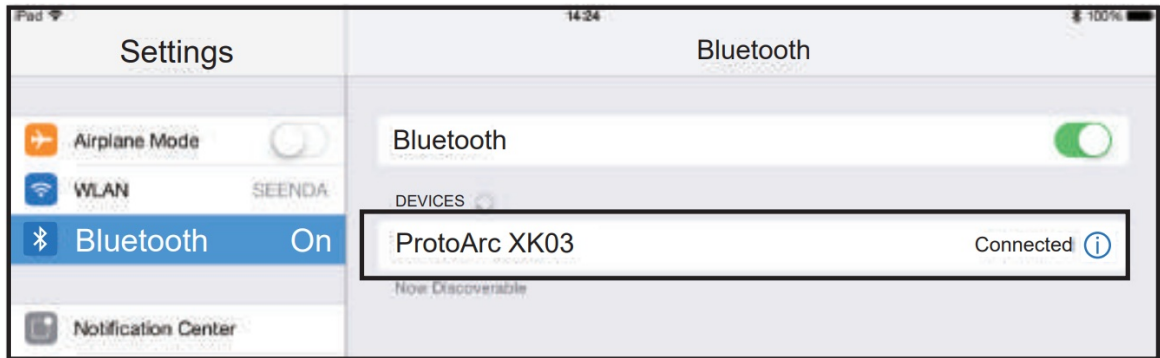

## Android System

Please complete the Bluetooth connection step ①② before pairing.

1. Click "Settings" on the device and then turn on Bluetooth.

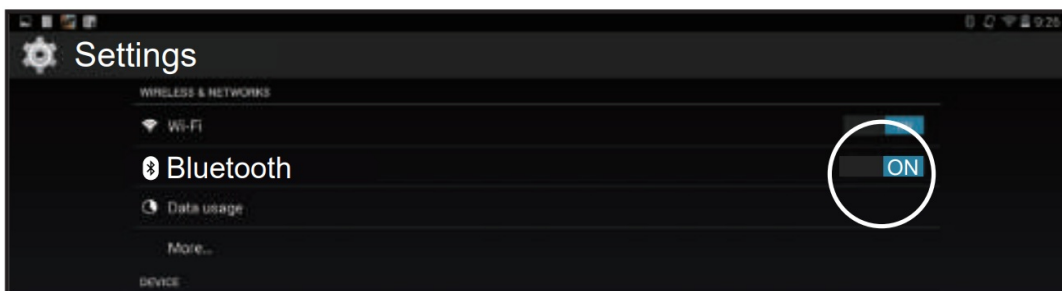

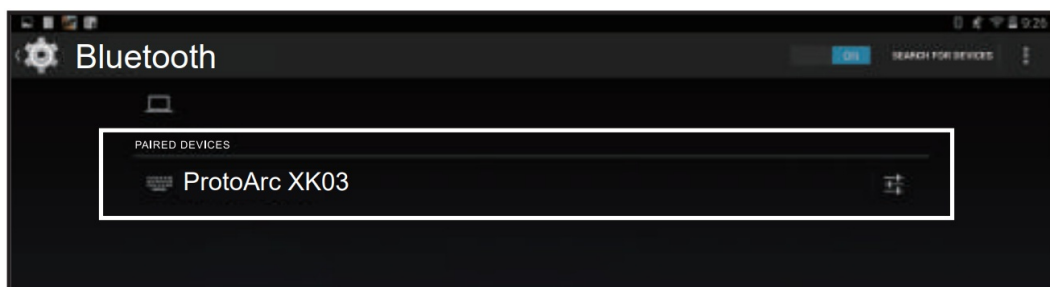

2. Your device will automatically find "ProtoArc XK03", then click "pair", complete pairing.



3. "ProtoArc XK03" is connected and it can be used normally.



## How to Switch Between Three Devices

After getting connected to three device, you can easily switch the connection by pressing “Fn” + “1/2/3”

## BT2 Device Connection

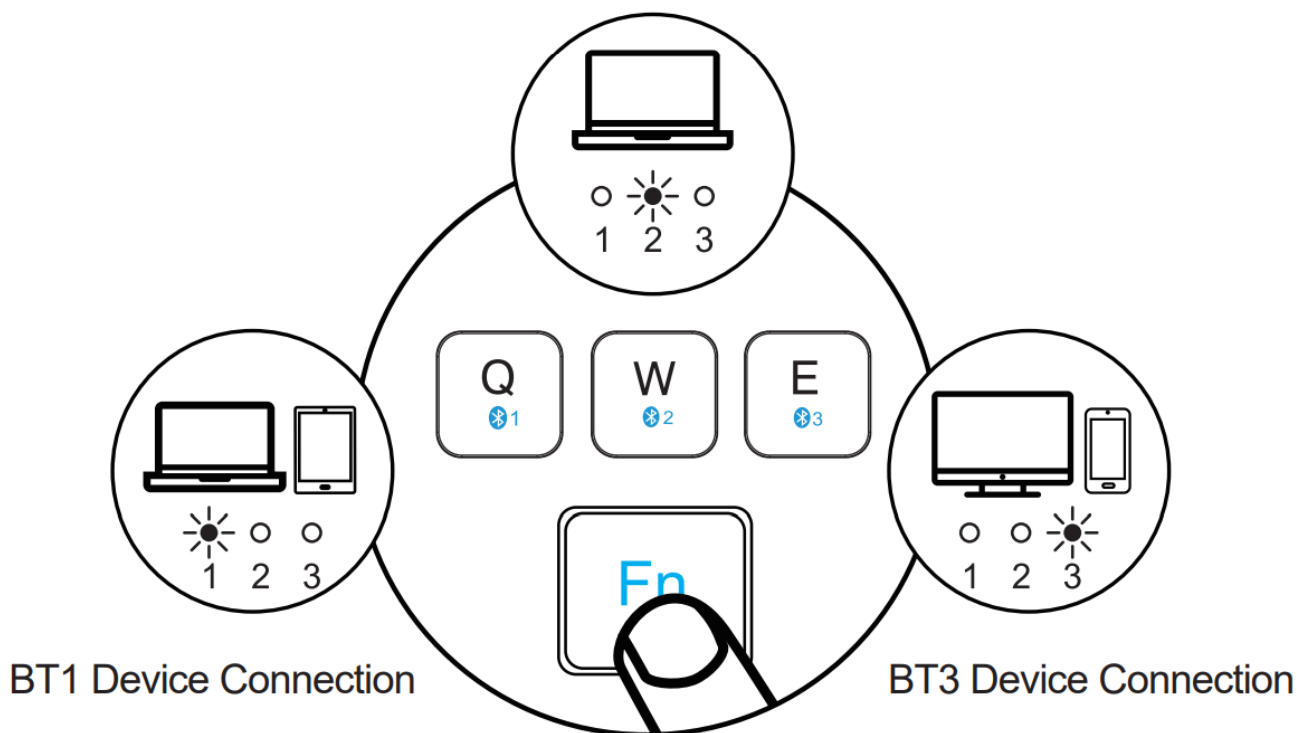

## Keyboard Charging

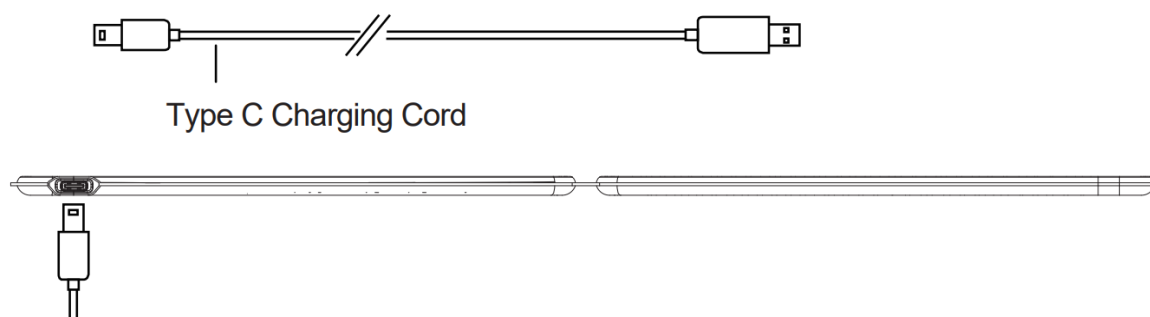



### \*Notice:

When the power is low, the white light of the channel in use will flash until it is turned off;

When the power of the keyboard is low, there will be a delay or lag when typing, which will affect normal use.

Please connect the power supply to charge in time to ensure that the keyboard has sufficient power for normal work.

## Multimedia Function Keys

| Keys  | Windows                   | Android/iOS/Mac           |
|---|---------------------------|---------------------------|
|    | Home Page                 | Home Page                 |
|    | Light –                   | Light –                   |
|    | Light +                   | Light +                   |
|    | Application Window Switch | Application Window Switch |
|    | Search                    | Search                    |
|    | Previous                  | Previous                  |
|    | Play/Pause                | Play/Pause                |
|   | Next Track                | Next Track                |
|  | Mute                      | Mute                      |
|  | Volume –                  | Volume –                  |
|  | Volume +                  | Volume +                  |
|  | Screenshot                | Screenshot                |
|  | Lock Screen               | Lock Screen               |
|  | /                         | Virtual Keyboard          |

**Note:** Simultaneously press “Fn” + corresponding keys to achieve multimedia functions.

## Product Parameters

Battery capacity: 250mAh

Working voltage: 3.7V

Working current: ≤2mA

Standby current: ≤1mA

Sleeping current: ≤0.3mA

Standby time: ≥365 Days

Working time: 130 Hours

Charging time:  $\leq 2$  Hours

Wake up way: Press any key

Size: 392.6×142.9×6.4mm(Unfolded) 195.3×142.9×12.8mm(Folded)

## Warm Reminder

1. If the keyboard fails to connect normally, it is recommended to turn off the keyboard, restart the Bluetooth of the device, and connect again; or delete the redundant Bluetooth option name in the Bluetooth connection list of the device and connect again.
2. Press “Fn” + “BT1/BT2/BT3” to switch to corresponding Bluetooth channels, it can use normally in 3 seconds.
3. The keyboard has a memory function. When a normally connected device is turned off and powered on again, the keyboard will default to connect this device through original channel, and the channel indicator will be on.

## Sleep Mode

1. When the keyboard is not used for more than 30 minutes, it will automatically enter into sleep mode and the indicator light will turn off.
2. When using the keyboard again, just hit any key, the keyboard will wake up within 3 seconds, and the lights come back on and keyboard starts working.

## Packing List

- ▶ 1\* Foldable Bluetooth Keyboard
- ▶ 1\* Type-C Charging Cable
- ▶ 1\* Collapsible Phone Holder
- ▶ 1\* User Manual

[support@protoarc.com](mailto:support@protoarc.com)

[www.protoarc.com](http://www.protoarc.com)

ProtoArc 

---

## Documents / Resources

|   |   |
|---|---|
| <div><div>ProtoArc</div><div>3003</div></div> <div><div>User Manual</div><div>Portable Folding Ergonomic Keyboard</div></div> <div><div>support@protoarc.com   www.protoarc.com</div></div> | <div><div><a href="#">ProtoArc XK03 Foldable Keyboard</a> [pdf] User Manual</div><div>XK03 Foldable Keyboard, XK03, Foldable Keyboard, Keyboard</div></div> |
|---|---|