



ProtoArc XK02 Triple Folding Keyboard with Touchpad User Manual

[Home](#) » [ProtoArc](#) » ProtoArc XK02 Triple Folding Keyboard with Touchpad User Manual 

ProtoArc XK02 Triple Folding Keyboard with Touchpad User Manual



Contents

- 1 Front
- 2 Back
- 3 Product Function
- 4 Bluetooth Connection Method
- 5 Mac OS System
- 6 iOS System
- 7 Android System
- 8 How to Switch Between Three Device
- 9 Keyboard Charging
- 10 Touchpad Function Guide
- 11 Multimedia Keys Function
- 12 Product Parameters
- 13 Warm Reminder
- 14 Sleep Mode
- 15 Packing List
- 16 Documents / Resources
- 17 Related Posts

Front

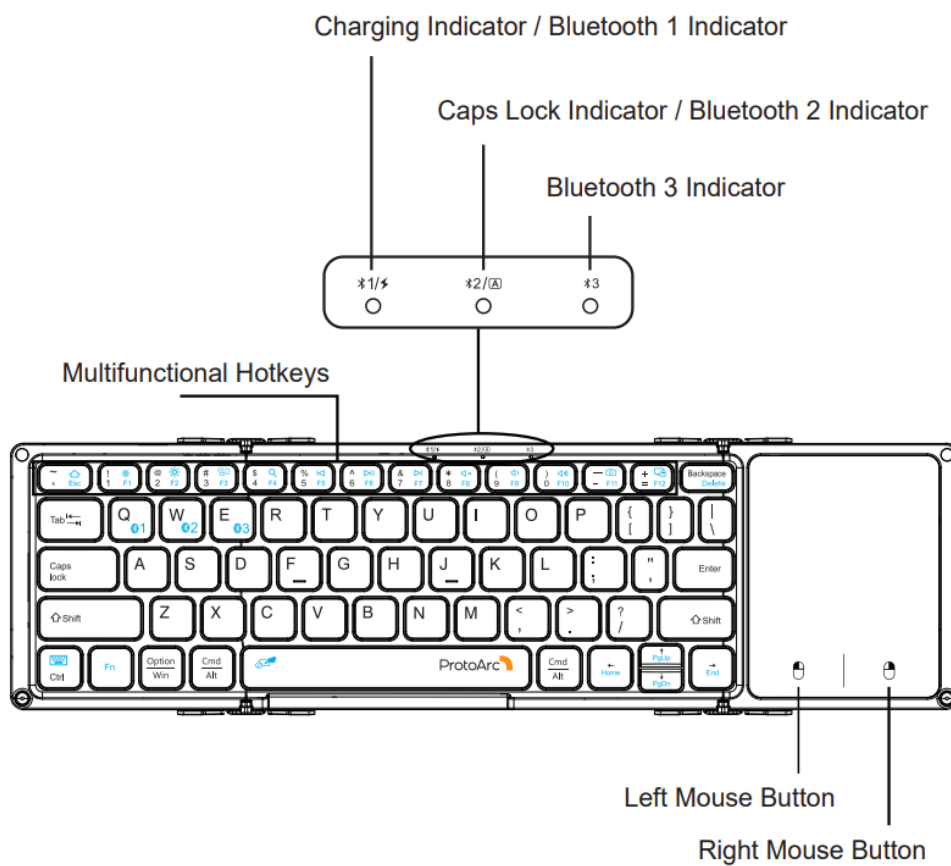

Back

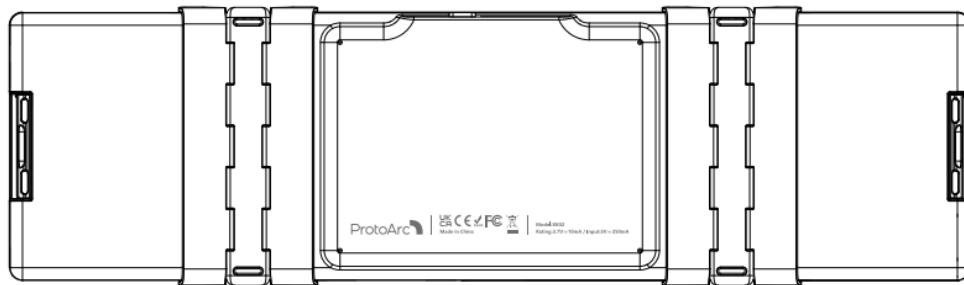

Product Function

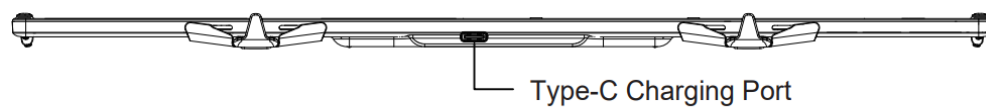

Bluetooth Channel 1



Bluetooth Channel 2



Bluetooth Channel 3

Bluetooth Connection Method

1. Unfold the Keyboard.

1

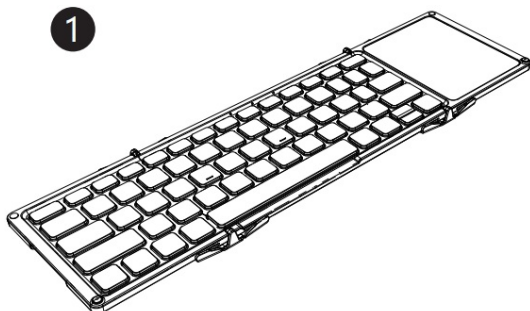

2. Short press "Fn+BT1" to choose Bluetooth Channel 1, the BT1 white indicator will flash once, then long press "Fn+BT1", the BT1 white indicator flashes quickly, keyboard enters into pairing mode.

2

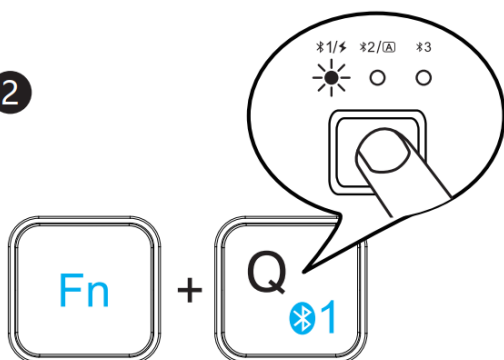

3. Short press "Fn+BT2" to choose Bluetooth Channel 2, the BT2 white indicator will flash once, then long press "Fn+BT2", the BT2 white indicator flashes quickly, keyboard enters into pairing mode.

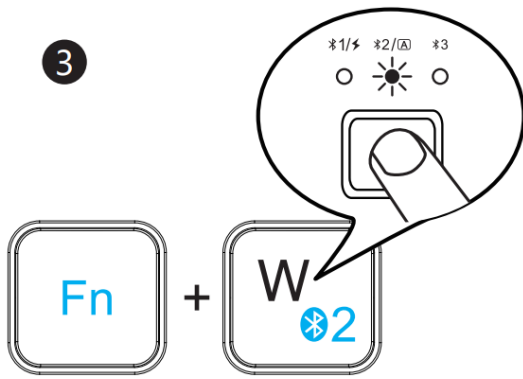

4. Short press “Fn+BT3” to choose Bluetooth Channel 3, the BT3 white indicator will flash once, then long press “Fn+BT3”, the BT3 white indicator flashes quickly, keyboard enters into pairing mode.

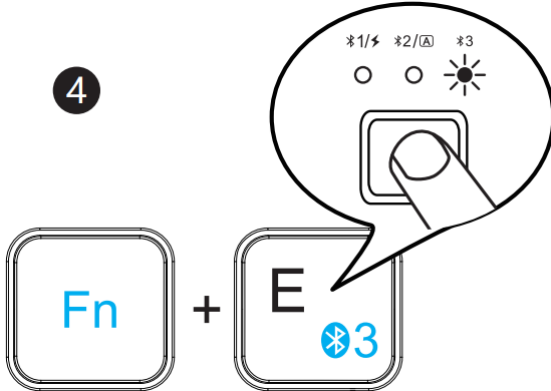

Windows 10 System

5. Click SETTING – DEVICES.

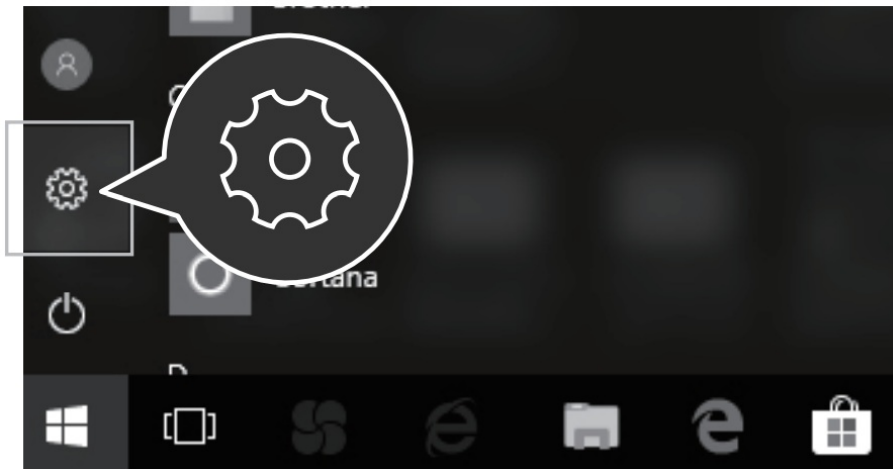

6. Click ADDING BLUETOOTH OR OTHER DEVICES.

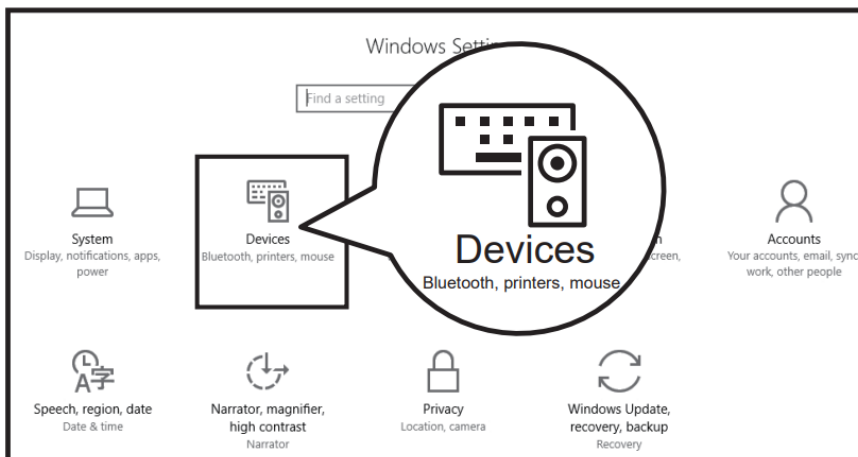

7. When the devices find ProtoArc XK02, click PAIR.

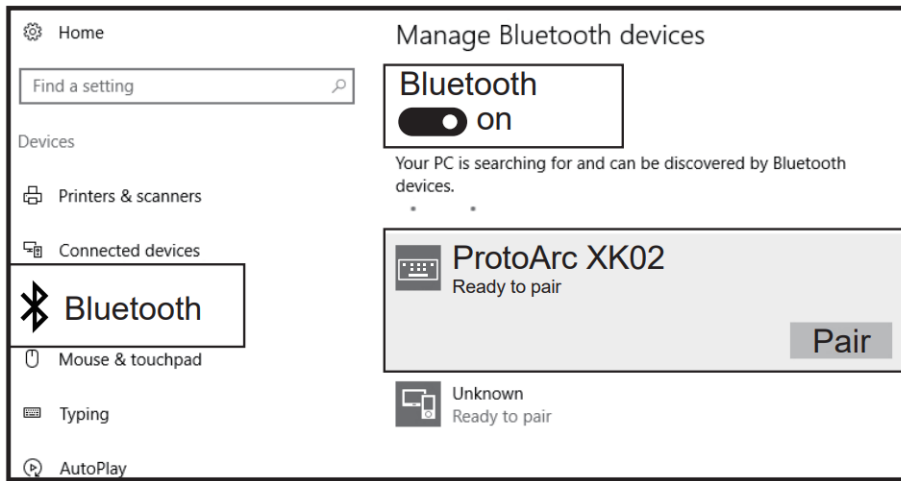

8. When ProtoArc XK02 shows CONNECTED, the keyboard is ready to use.

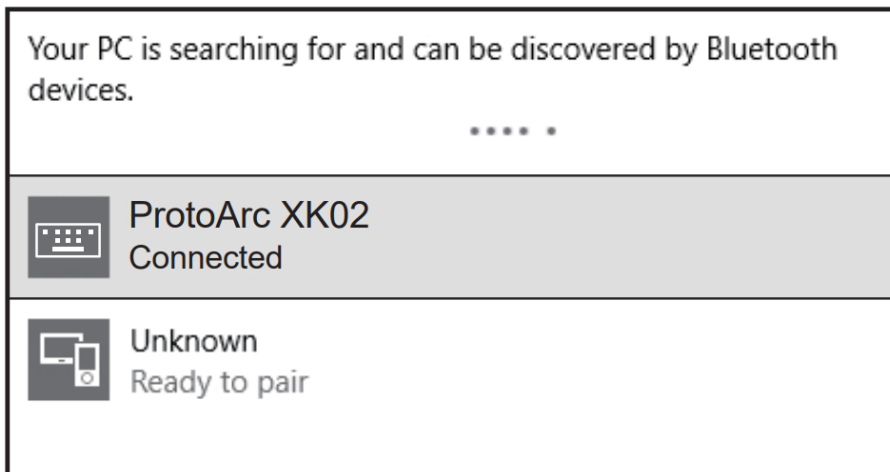

Mac OS System

Before pairing the keyboard, please operate as step 1,2,3,4 to make sure the keyboard entering into pairing mode.

- Click SYSTEM PREFERENCES – BLUETOOTH.



- When the devices find ProtoArc XK02, click PAIR.

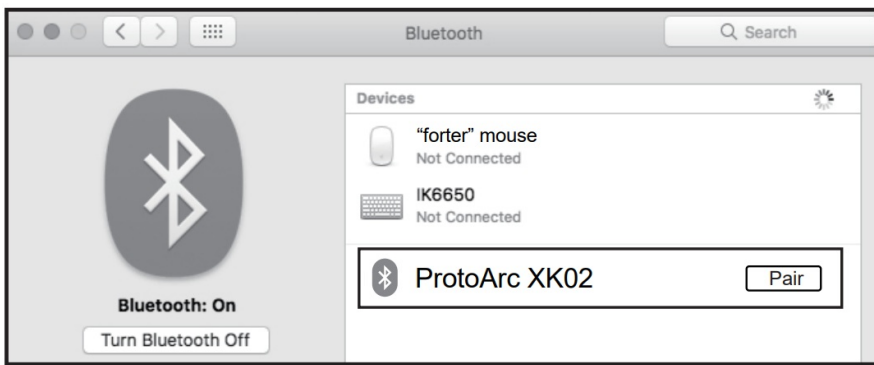

- When ProtoArc XK02 shows CONNECTED, the keyboard is ready to use.

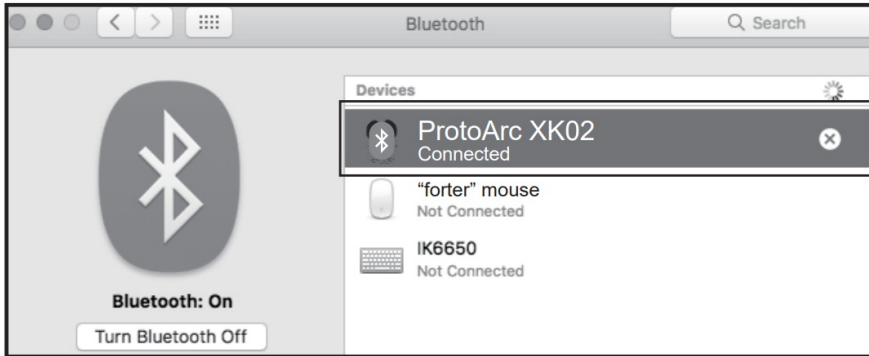

iOS System

Before pairing the keyboard, please operate as step 1,2,3,4 to make sure the keyboard entering into pairing mode.

- Click SETTING and turn on the BLUETOOTH.



- When the devices find ProtoArc XK02, click PAIR

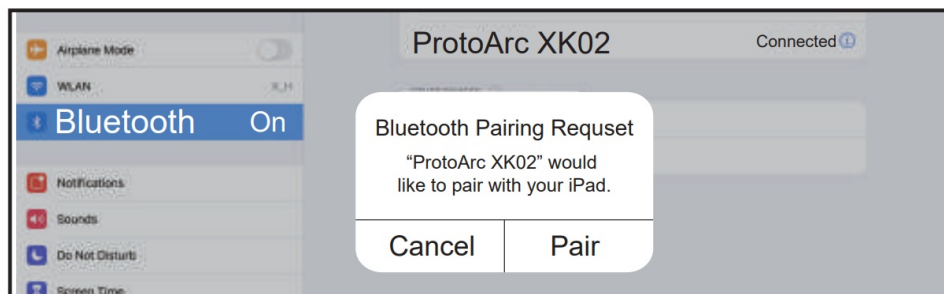

- When ProtoArc XK02 shows CONNECTED, the keyboard is ready to use.



Android System

Before pairing the keyboard, please operate as step 1,2,3,4 to make sure the keyboard entering into pairing mode.

- Click SETTING and turn on the BLUETOOTH.

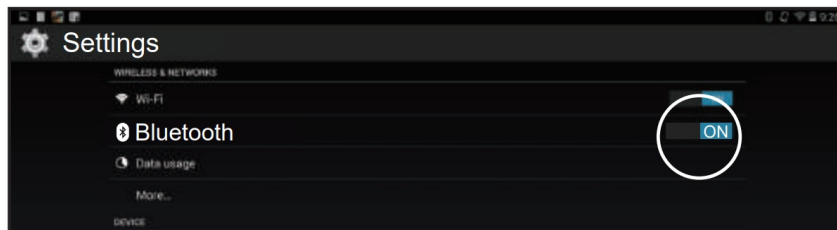

- When the devices find ProtoArc XK02, click PAIR

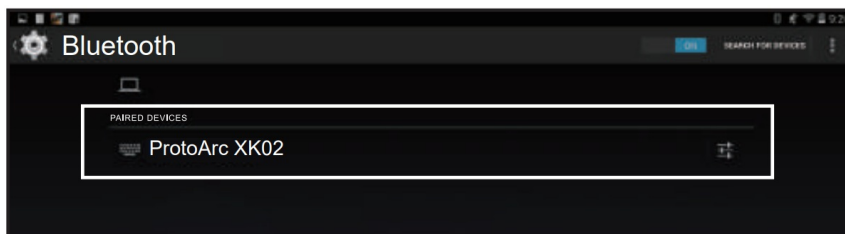

- When ProtoArc XK02 shows CONNECTED, the keyboard is ready to use.



How to Switch Between Three Device

After successfully connected to 2 or 3 devices, you can switch between them easily by pressing “Fn” + “BT1/BT2/BT3”.

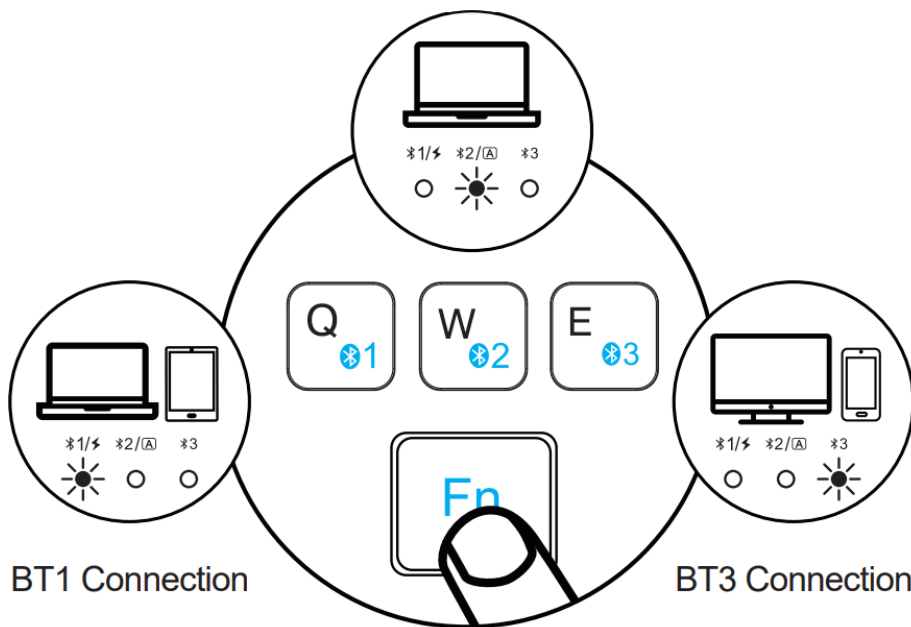

Keyboard Charging

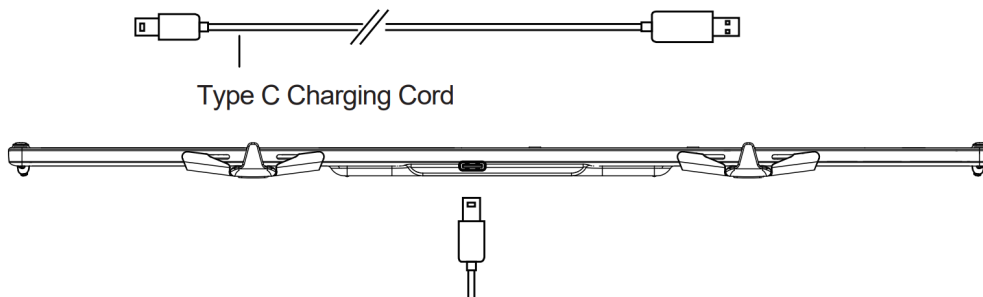

1. When the keyboard is in low power condition, the corresponding BT channel in use will flash in White light. Also there will be a delay or lag while typing, which will affect normal use.
2. Please recharge the keyboard in time via the type C cable to ensure the keyboard has sufficient power for using.

Touchpad Function Guide

- One finger click
 - **Left click**

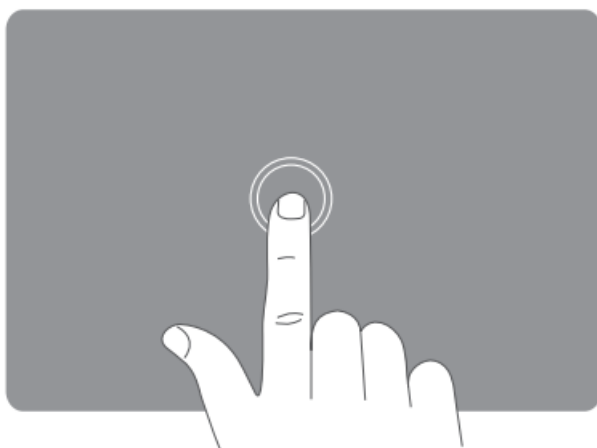

- One finger click twice

- **Double click**

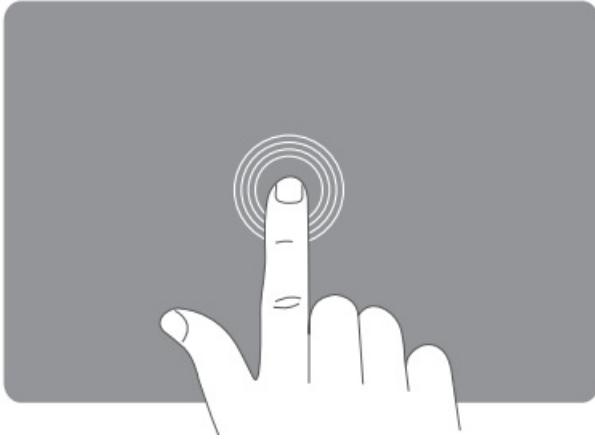

- One finger slide

- **Move cursor**

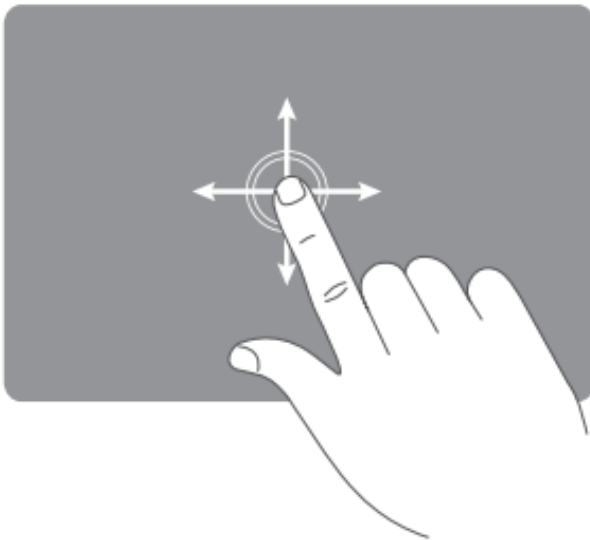

- One finger double click to drag

- **Drag**

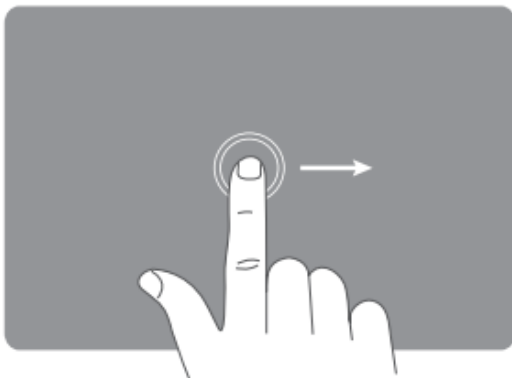

- Two fingers click

- **Right click**

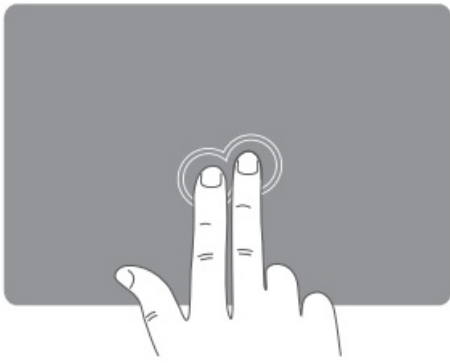

- Two fingers slide up/down/left/right
 - **Mouse Scroll**

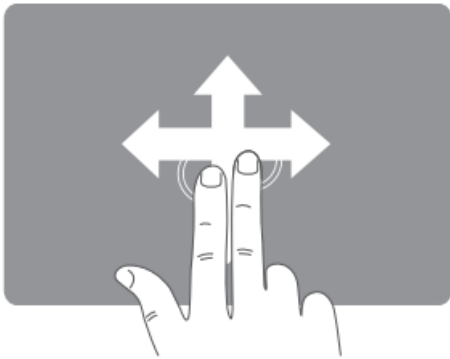

- Pinch with two fingers
 - **Zoom in or out**



- Three fingers swipe up
 - Win: Open task browser**
 - iOS: Open the App switcher**
 - Android: Open task browser**

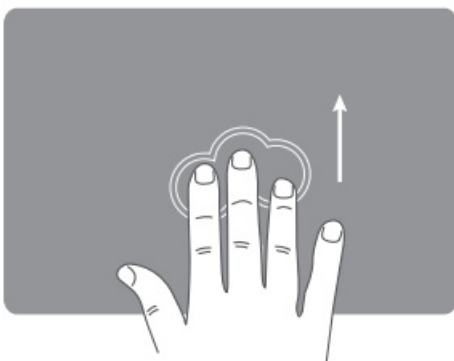

- Three fingers swipe down
 - Win: Back to the desktop**

iOS: N/A

Android: N/A

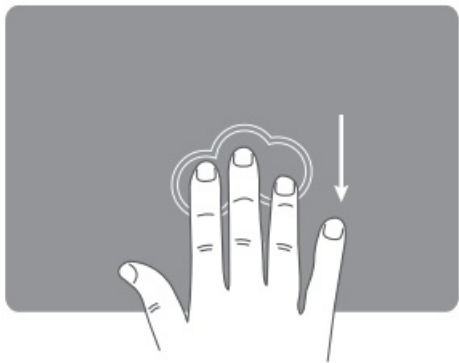

- Three fingers swipe to the left/right
 - **Show the Previous/Next mission**

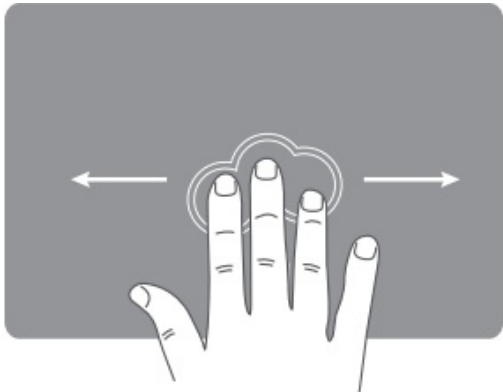

- Four fingers click

Win: Activate Operation Center

iOS: Screenshot





Android: N/A



Multimedia Keys Function

KEY	iOS/OS/Android	iOS/OS/Android	Windows	Windows
	Fn+	Fn+Shift+	Fn+	Fn+Shift+

	HOME	Esc	Homepage	Esc
	Brightness Down	F1	Brightness Down	F1
	Brightness Up	F2	Brightness Up	F2
	Switch App	F3	Switch App	F3
	Search	F4	Search	F4
	Previous	F5	Previous	F5
	Play & Pause	F6	Play & Pause	F6
	Next	F7	Next	F7
	Mute	F8	Mute	F8
	Volume Down	F9	Volume Down	F9

	Volume Up	F10	Volume Up	F10
	Screenshot	F11	Screenshot	F11
	Lock Screen	F12	Lock Screen	F12
	Turn on / Turn off touchpad function		Turn on / Turn off touchpad function	

Product Parameters

Item Name	Specification Parameter
System Available	Bluetooth applicable system: Windows 7, Windows 8, Windows 10 or later Mac OS X 10.10 or later Android 4.3 or higher
Battery Capacity	210 mAh
Sleep Time	Enter into sleep mode after 30 minutes of inactivity
Battery Life	1000 Times charge-discharge cycles
Keys Life	3 Million Times keystrokes
Stand-by Time	200 Days
Wake Up Method	Click any keys to wake up the keyboard
Working Distance	10 Meters
Keys Working Current	
Touchpad Working Current	
Product Dimensions	327 x 94.9 x 11.7 mm (unfolding) 185 x 94.9 x 17.3 mm (folding)

Warm Reminder

1. If the keyboard fails to connect normally, it is recommended to turn off the keyboard, restart the Bluetooth of the device, and connect again; or delete the redundant Bluetooth option name in the Bluetooth connection list of the device and connect again.
2. Press “Fn” + “BT1/BT2/BT3” to switch to corresponding Bluetooth channels, it can use normally in 3 seconds.

3. The keyboard has a memory function. When a normally connected device is turned off and powered on again, the keyboard will default to connect this device through original channel, and the channel indicator will be on.

Sleep Mode

1. When the keyboard is not used for more than 30 minutes, it will automatically enter into sleep mode and the indicator light will turn off.
2. When using the keyboard again, just hit any key, the keyboard will wake up within 3 seconds, and the lights come back on and keyboard starts working.

Packing List

- 1 * Foldable Bluetooth Keyboard
- 1 * Type-C Charging Cable
- 1 * Collapsible Phone Holder
- 1 * Storage Bag
- 1 * User Manual



Documents / Resources

<div><div>ProtoArc</div><div>3002</div><div>User Manual</div><div>Triple Folding Keyboard with Touchpad</div><div>support@protoarc.com www.protoarc.com</div></div>	<div>ProtoArc XK02 Triple Folding Keyboard with Touchpad [pdf] User Manual</div> <div>XK02 Triple Folding Keyboard with Touchpad, XK02, Triple Folding Keyboard with Touchpad, F olding Keyboard with Touchpad, Keyboard with Touchpad, Touchpad</div>
---	--