



# ProtoArc XK02 Foldable Bluetooth Keyboard with Touchpad User Manual

[Home](#) » [ProtoArc](#) » ProtoArc XK02 Foldable Bluetooth Keyboard with Touchpad User Manual 



## XK02 User Manual Triple Folding Keyboard with Touchpad

### Contents

- [1 XK02 Foldable Bluetooth Keyboard with Touchpad](#)
- [2 Product Function](#)
- [3 Bluetooth Connection Method](#)
- [4 Android System](#)
- [5 How to Switch Between Three Device](#)
- [6 Keyboard Charging](#)
- [7 Touchpad Function Guide](#)
- [8 Multimedia Keys Function](#)
- [9 Product Parameters](#)
- [10 Warm Reminder](#)
- [11 Sleep Mode](#)
- [12 Packing List](#)
- [13 Documents / Resources](#)

**XK02 Foldable Bluetooth Keyboard with Touchpad**



Front

Charging Indicator / Bluetooth 1 Indicator

Caps Lock Indicator / Bluetooth 2 Indicator

Bluetooth 3 Indicator

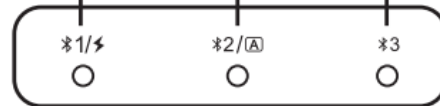

Multifunctional Hotkeys

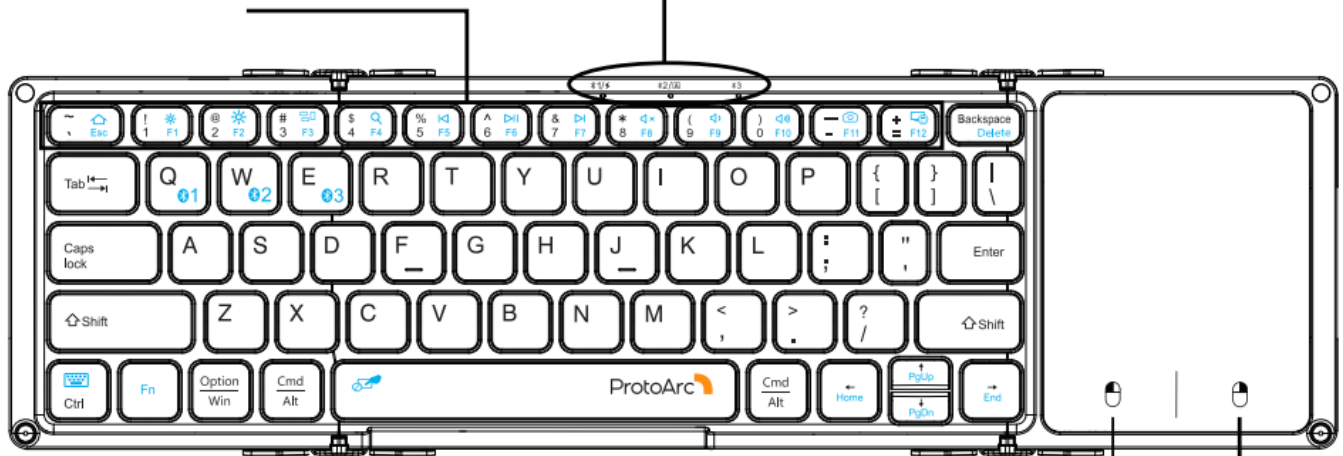

Left Mouse Button

Right Mouse Button

Back

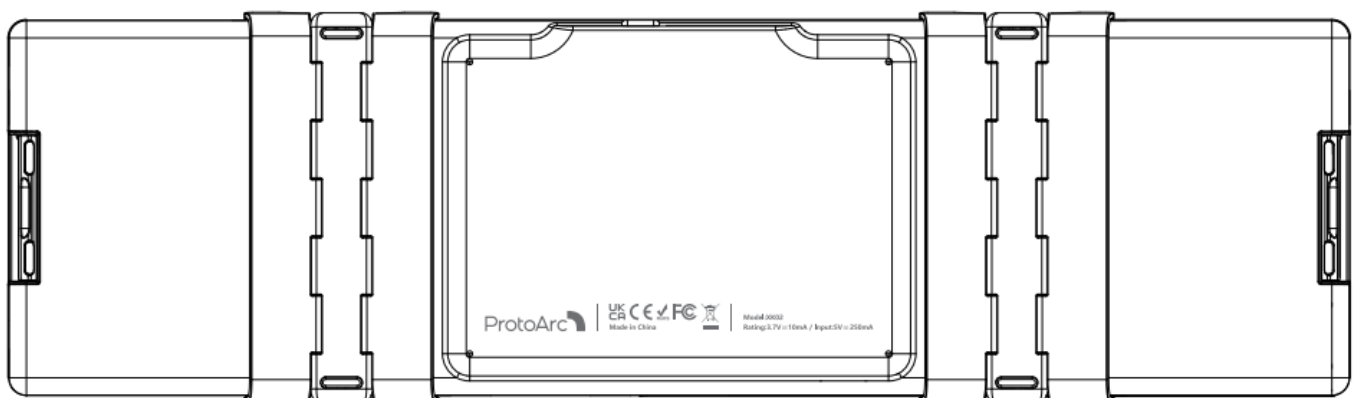

## Product Function

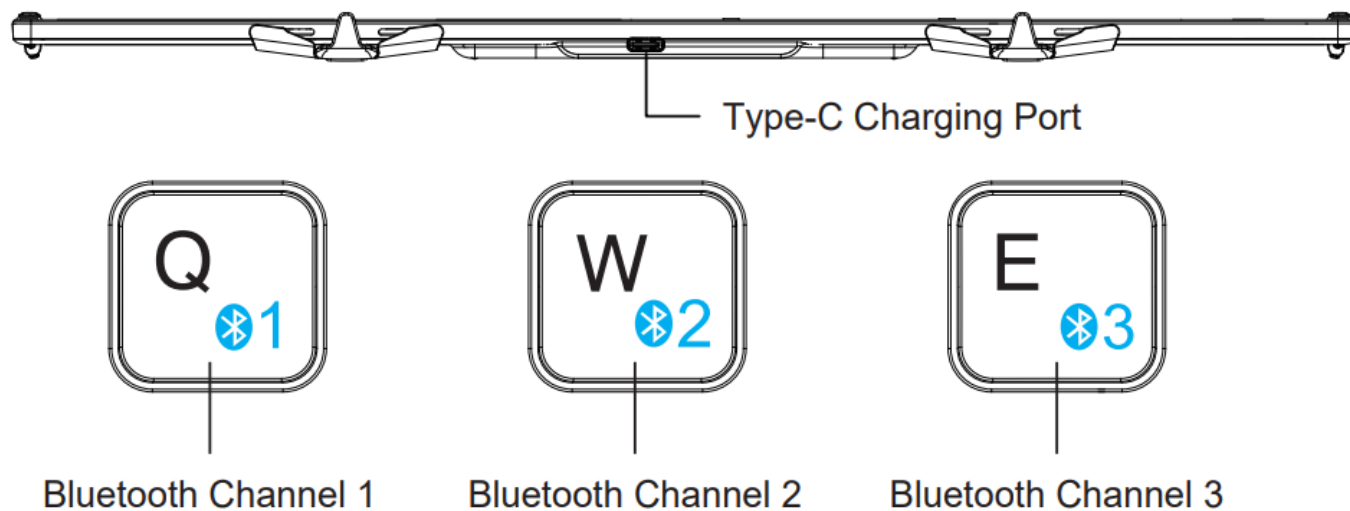

## Bluetooth Connection Method



1. Unfold the Keyboard.

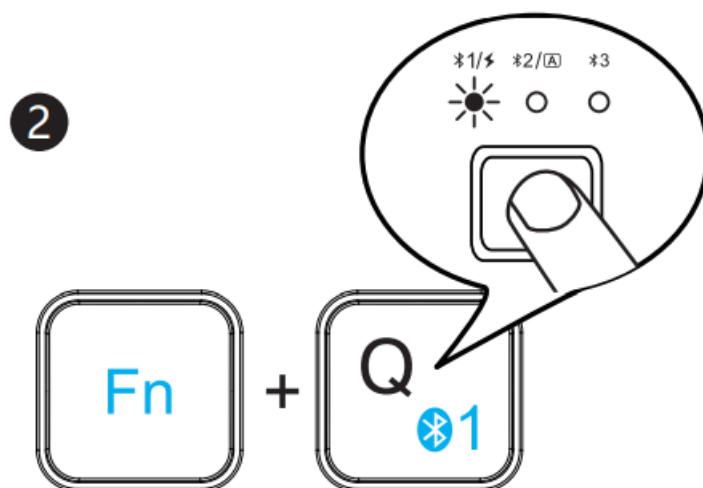

2. Short press “Fn+BT1” to choose Bluetooth Channel 1, the BT1 white indicator will flash once, then long press “Fn+BT1”, the BT1 white indicator flashes quickly, keyboard enters into pairing mode.

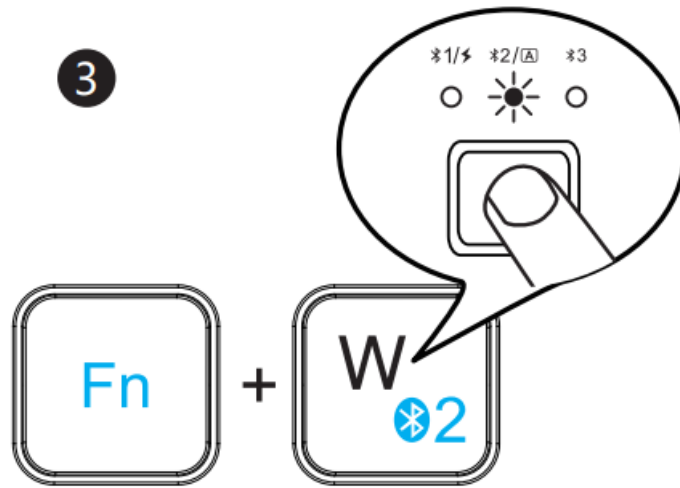

3. Short press “Fn+BT2” to choose Bluetooth Channel 2, the BT2 white indicator will flash once, then long press “Fn+BT2”, the BT2 white indicator flashes quickly, keyboard enters into pairing mode.

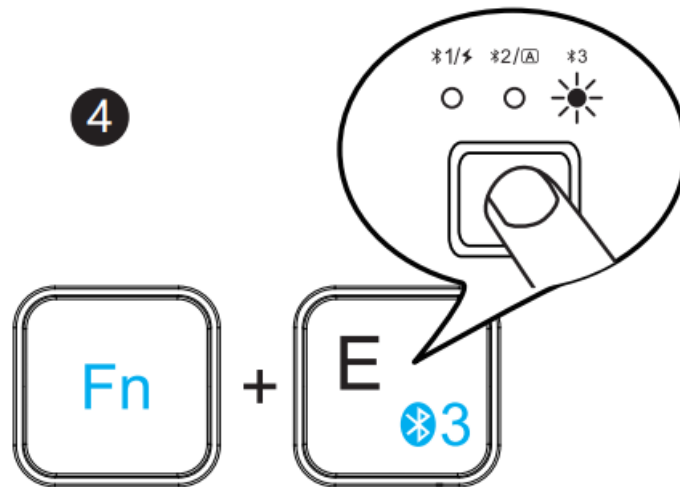

4. Short press “Fn+BT3” to choose Bluetooth Channel 3, the BT3 white indicator will flash once, then long press “Fn+BT3”, the BT3 white indicator flashes quickly, keyboard enters into pairing mode.

#### **Windows 10 System**

5. Click SETTING – DEVICES.

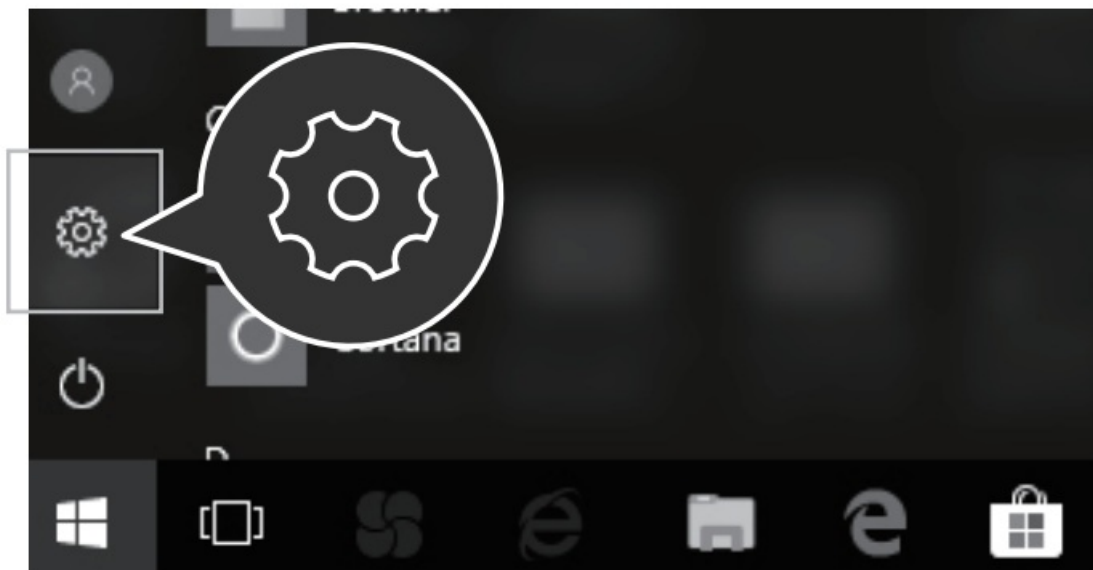

6. Click ADDING BLUETOOTH OR OTHER DEVICES.

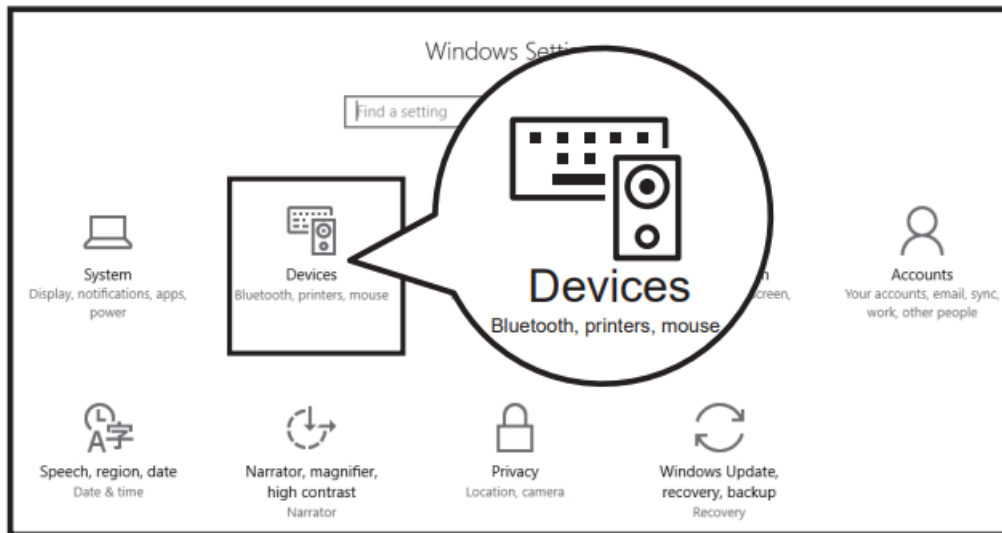

7. When the devices find ProtoArc XK02, click PAIR.

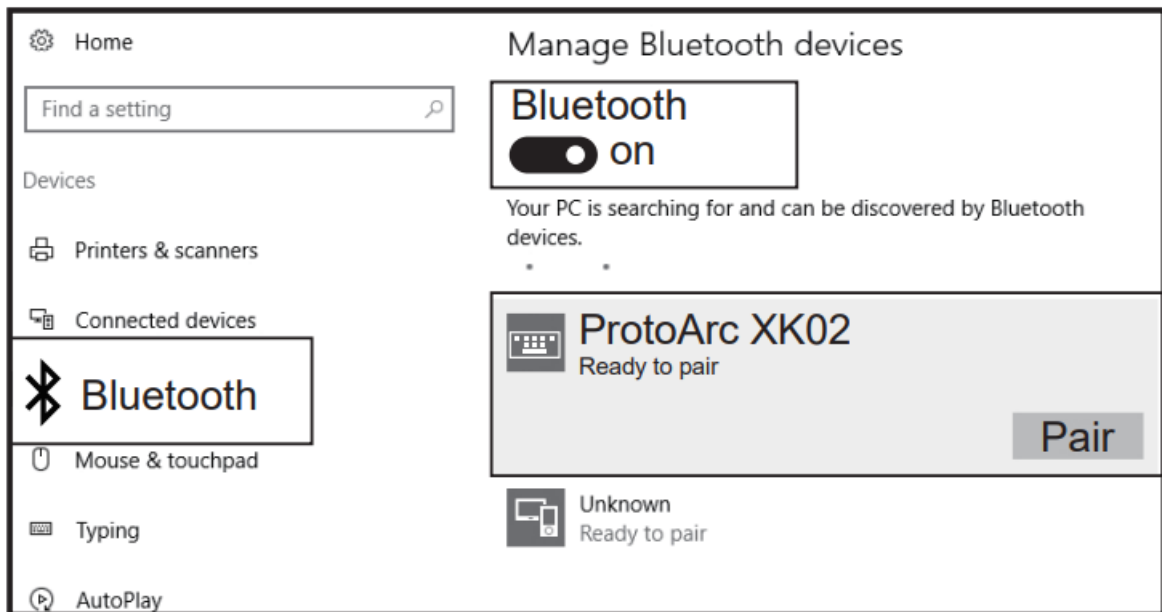

8. When ProtoArc XK02 shows CONNECTED, the keyboard is ready to use.

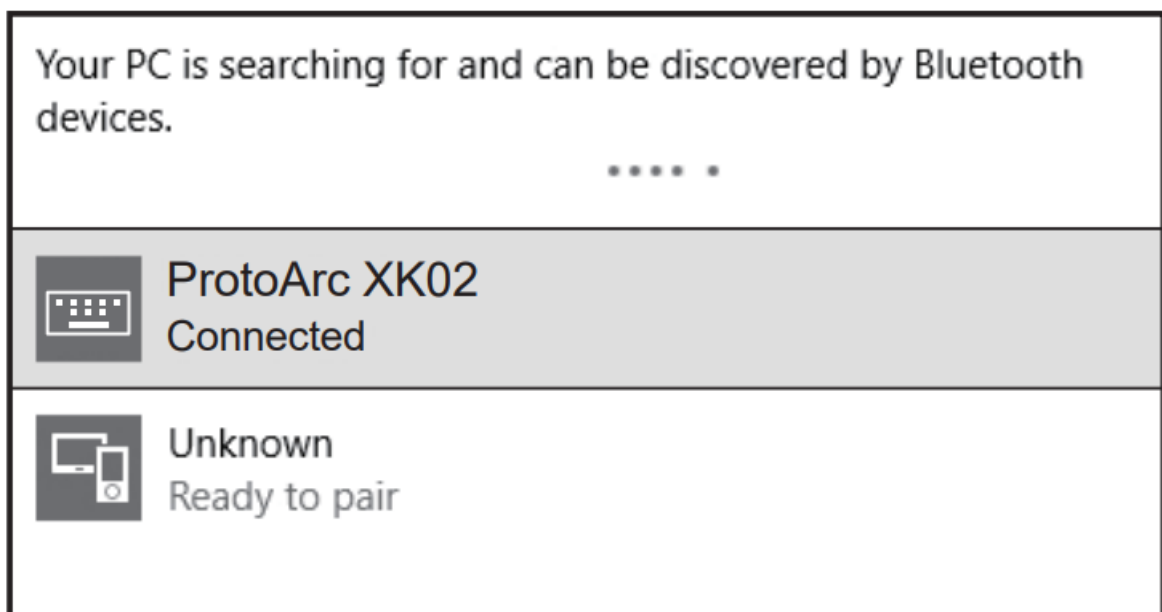

## Mac OS System

Before pairing the keyboard, please operate as step 1,2,3,4 to make sure the keyboard entering into pairing mode.

1. Click SYSTEM PREFERENCES – BLUETOOTH.



2. When the devices find ProtoArc XK02, click PAIR.

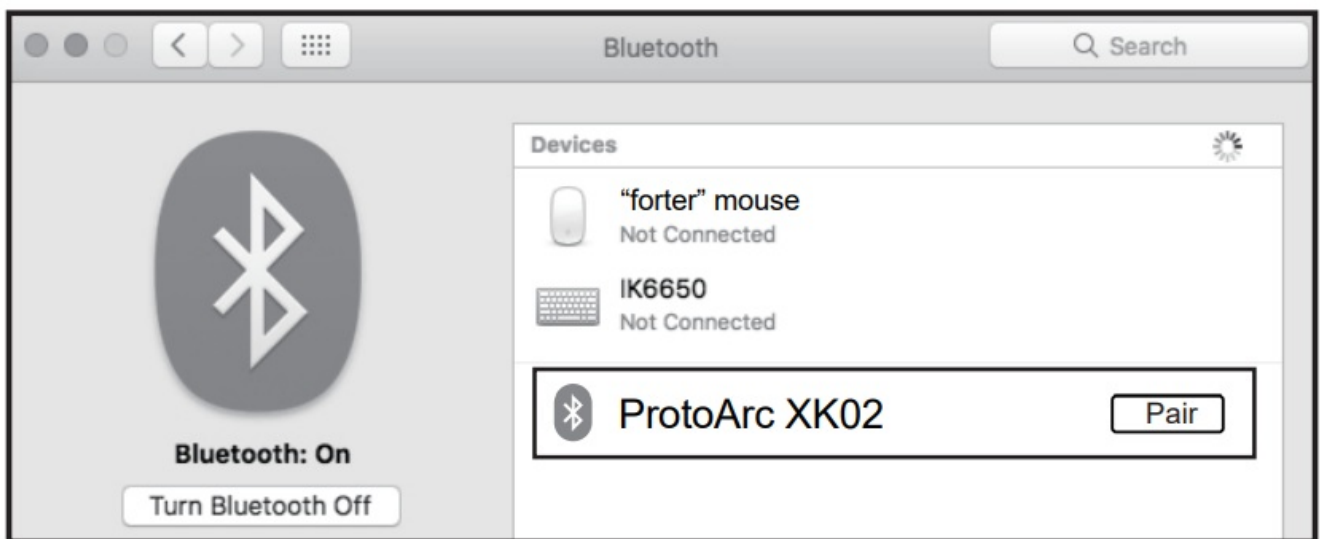

3. When ProtoArc XK02 shows CONNECTED, the keyboard is ready to use.

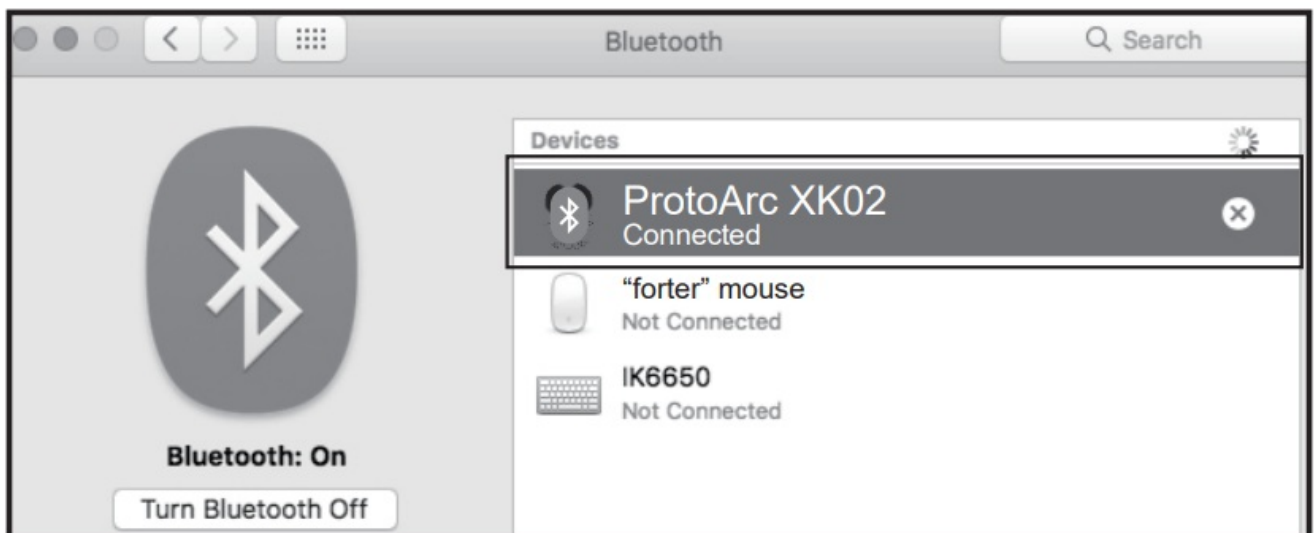

## iOS System

Before pairing the keyboard, please operate as step 1,2,3,4 to make sure the keyboard entering into pairing mode.

1. Click SETTING and turn on the BLUETOOTH.





2. When the devices find ProtoArc XK02, click PAIR.

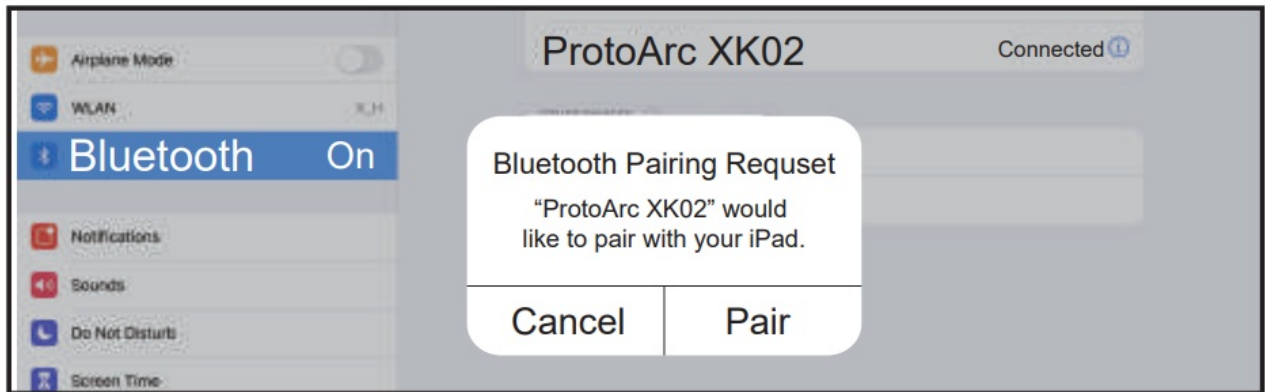

3. When ProtoArc XK02 shows CONNECTED, the keyboard is ready to use.

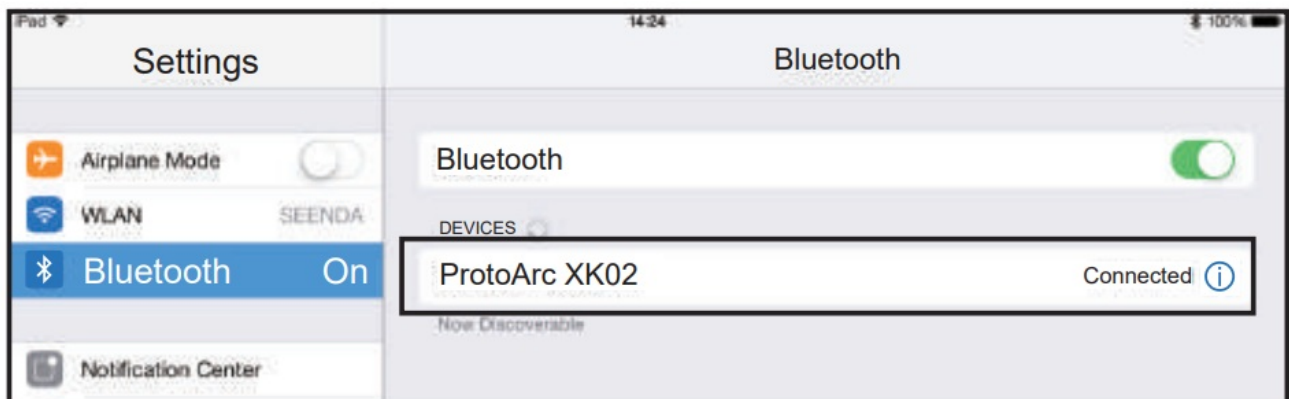

## Android System

Before pairing the keyboard, please operate as step 1,2,3,4 to make sure the keyboard entering into pairing mode.

1. Click SETTING and turn on the BLUETOOTH.

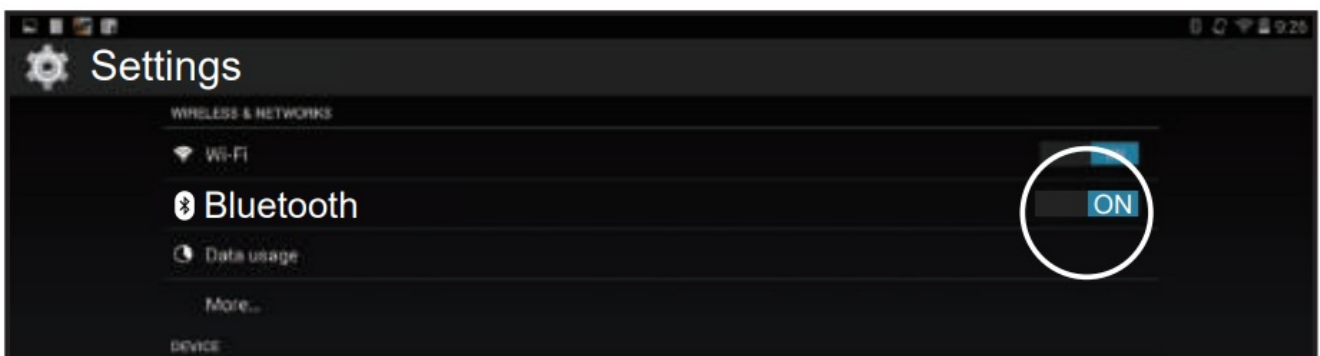

2. When the devices find ProtoArc XK02, click PAIR.



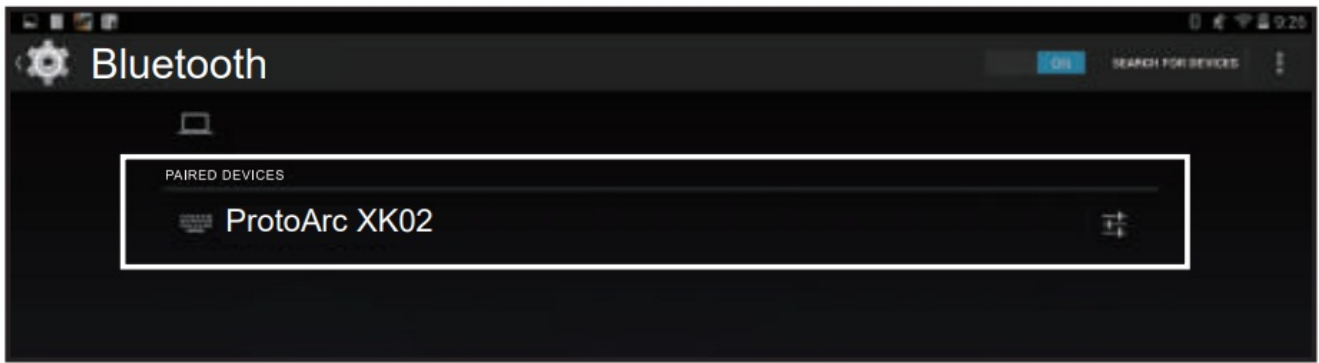

3. When ProtoArc XK02 shows CONNECTED, the keyboard is ready to use.

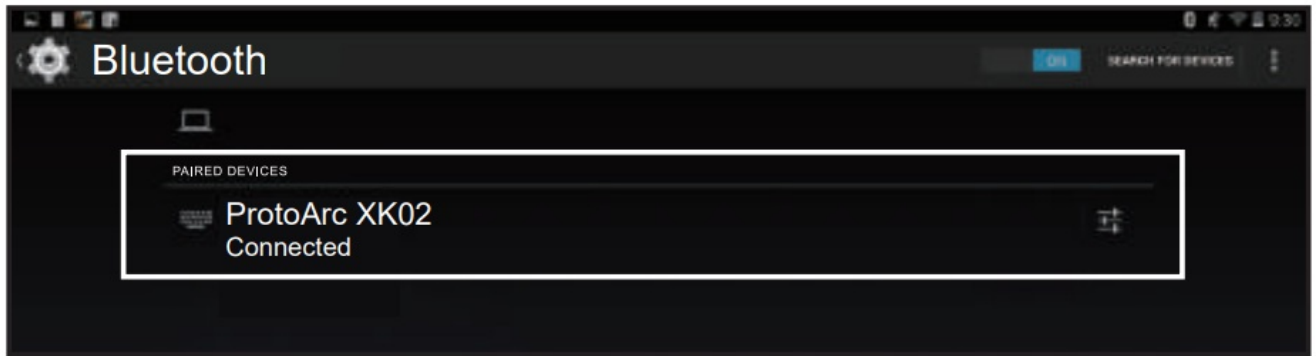

## How to Switch Between Three Device

After successfully connected to 2 or 3 devices, you can switch between them easily by pressing “Fn” + “BT1/BT2/BT3”.

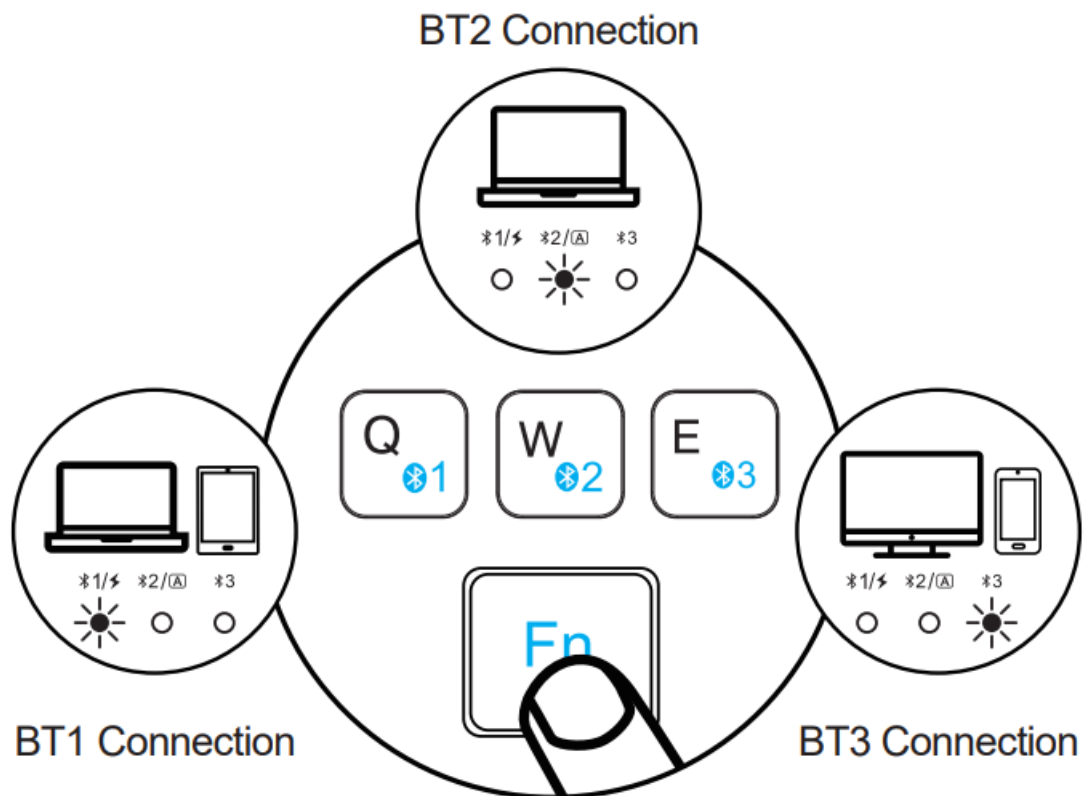

## Keyboard Charging

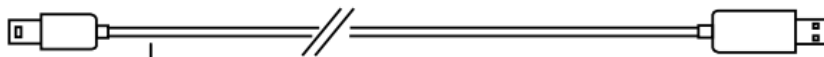

Type C Charging Cord

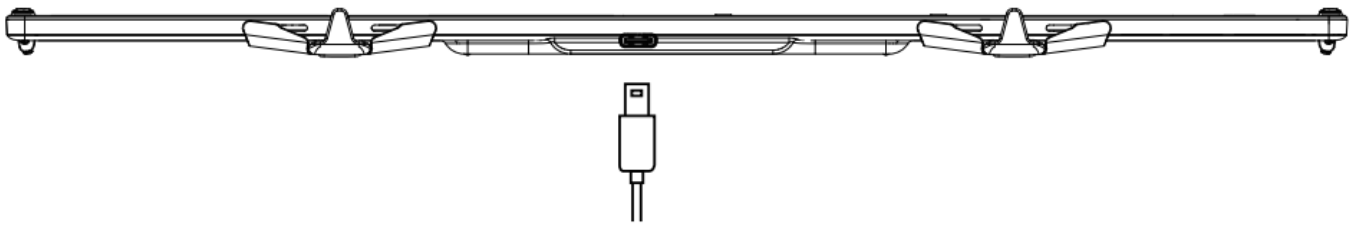

1. When the keyboard is in low power condition, the corresponding BT channel in use will flash in White light. Also there will be a delay or lag while typing, which will affect normal use.
2. Please recharge the keyboard in time via the type C cable to ensure the keyboard has sufficient power for using.

## Touchpad Function Guide

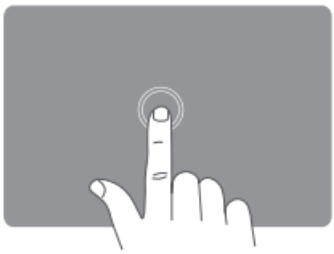
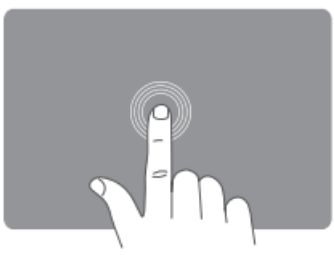
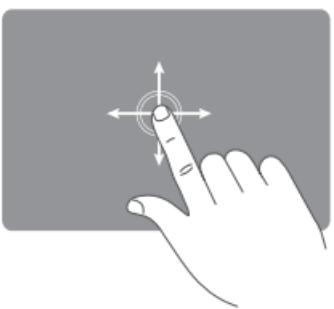
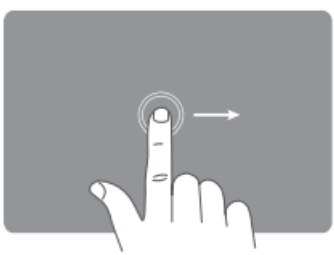
|   |  |
|---|--|
|   | <p>One finger click<br/>– <b>Left click</b></p>          |
|  | <p>One finger click twice<br/>– <b>Double click</b></p>  |
|  | <p>One finger slide<br/>– <b>Move cursor</b></p>         |
|  | <p>One finger double click to drag<br/>– <b>Drag</b></p> |

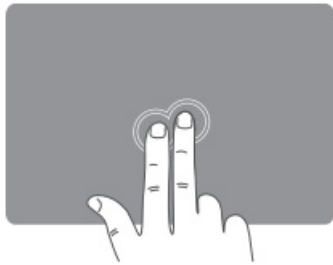

Two fingers click  
– **Right click**



Two fingers slide up/down/left/right  
– **Mouse Scroll**



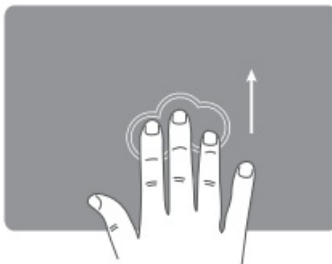

Pinch with two fingers  
– **Zoom in or out**





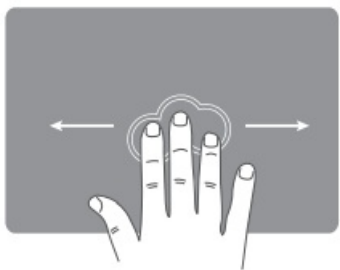

Three fingers swipe up  
**Win: Open task browser**  
**iOS: Open the App switcher**  
**Android: Open task browser**



Three fingers swipe down  
**Win: Back to the desktop**  
**iOS: N/A**  
**Android: N/A**

|   |  |
|---|--|
|   | <p>Three fingers swipe to the left/right<br/>– <b>Show the Previous/Next mission</b></p>                               |
|  | <p>Four fingers click<br/><b>Win: Activate Operation Center</b><br/><b>iOS: Screenshot</b><br/><b>Android: N/A</b></p> |

## Multimedia Keys Function

| KEY   | iOS/OS/Android                       | iOS/OS/Android | Windows                              | Windows   |
|---|--------------------------------------|----------------|--------------------------------------|-----------|
|   | Fn+                                  | Fn+Shift+      | Fn+                                  | Fn+Shift+ |
|   | HOME                                 | Esc            | Homepage                             | Esc       |
|  | Brightness Down                      | F1             | Brightness Down                      | F1        |
|  | Brightness Up                        | F2             | Brightness Up                        | F2        |
|  | Switch App                           | F3             | Switch App                           | F3        |
|  | Search                               | F4             | Search                               | F4        |
|  | Previous                             | F5             | Previous                             | F5        |
|  | Play & Pause                         | F6             | Play & Pause                         | F6        |
|  | Next                                 | F7             | Next                                 | F7        |
|  | Mute                                 | F8             | Mute                                 | F8        |
|  | Volume Down                          | F9             | Volume Down                          | F9        |
|  | Volume Up                            | F10            | Volume Up                            | F10       |
|  | Screenshot                           | F11            | Screenshot                           | F11       |
|  | Lock Screen                          | F12            | Lock Screen                          | F12       |
|  | Turn on / Turn off touchpad function |                | Turn on / Turn off touchpad function |           |

## Product Parameters

| Item Name                | Specification Parameter   |
|--------------------------|---|
| System Available         | Bluetooth applicable system:<br>Windows 7, Windows 8, Windows 10 or later Mac OS X 10.10 or later Android 4.3 or higher |
| Battery Capacity         | 210 mAh   |
| Sleep Time               | Enter into sleep mode after 30 minutes of inactivity  |
| Battery Life             | 1000 Times charge-discharge cycles  |
| Keys Life                | 3 Million Times keystrokes  |
| Stand-by Time            | 200 Days  |
| Wake Up Method           | Click any keys to wake up the keyboard  |
| Working Distance         | 10 Meters   |
| Keys Working Current     | 5.3mA   |
| Touchpad Working Current | ≤ 9mA   |
| Product Dimensions       | 327 x 94.9 x 11.7 mm (unfolding) 185 x 94.9 x 17.3 mm (folding)   |

## Warm Reminder

1. If the keyboard fails to connect normally, it is recommended to turn off the keyboard, restart the Bluetooth of the device, and connect again; or delete the redundant Bluetooth option name in the Bluetooth connection list of the device and connect again.
2. Press “Fn” + “BT1/BT2/BT3” to switch to corresponding Bluetooth channels, it can use normally in 3 seconds.
3. The keyboard has a memory function. When a normally connected device is turned off and powered on again, the keyboard will default to connect this device through original channel, and the channel indicator will be on.

## Sleep Mode

1. When the keyboard is not used for more than 30 minutes, it will automatically enter into sleep mode and the indicator light will turn off.
2. When using the keyboard again, just hit any key, the keyboard will wake up within 3 seconds, and the lights come back on and keyboard starts working.

## Packing List

- 1 \* Foldable Bluetooth Keyboard
- 1 \* Type-C Charging Cable
- 1 \* Collapsible Phone Holder
- 1 \* Storage Bag
- 1 \* User Manual



Documents / Resources

|  |  |
|--|--|
| <div><div>ProtoArc</div><div>3002</div></div> <div><div>User Manual</div><div>Triple Folding Keyboard with Touchpad</div></div> <div><div>support@protoarc.com   www.protoarc.com</div></div> | <div><div><a href="#">ProtoArc XK02 Foldable Bluetooth Keyboard with Touchpad</a> [pdf] User Manual</div><div>XK02 Foldable Bluetooth Keyboard with Touchpad, XK02, Foldable Bluetooth Keyboard with To</div><div>uchpad, Bluetooth Keyboard with Touchpad, Keyboard with Touchpad, Touchpad</div></div> |
|--|--|