

ProtoArc XK01 TP Foldable Wireless Keyboard with Touchpad



ProtoArc XK01 TP Foldable Wireless Keyboard with Touchpad User Manual

[Home](#) » [ProtoArc](#) » ProtoArc XK01 TP Foldable Wireless Keyboard with Touchpad User Manual 

Contents

- 1 [ProtoArc XK01 TP Foldable Wireless Keyboard with Touchpad](#)
- 2 [Product Information](#)
- 3 [Product Usage Instructions](#)
- 4 [Product Features](#)
- 5 [Bluetooth Connection](#)
- 6 [How to Switch Connection Mode](#)
- 7 [Keyboard Charging](#)
- 8 [Multimedia Function Keys](#)
- 9 [How to Use Special Characters in British English](#)
- 10 [Touchpad Function Explanation](#)
- 11 [Product Parameters](#)
- 12 [Sleep Mode](#)
- 13 [FAQ](#)
- 14 [Packing List](#)
- 15 [EU Declaration of Conformity](#)
- 16 [Documents / Resources](#)
 - 16.1 [References](#)
- 17 [Related Posts](#)



ProtoArc XK01 TP Foldable Wireless Keyboard with Touchpad



Product Information

Specifications

- Product Name: XK01 TP Foldable Wireless Keyboard with Touchpad
- Manufacturer: ProtoArc
- Website: www.protoarc.com
- Email Support:
 - US: support@protoarc.com
 - UK: support-uk@protoarc.com
- Contact Number (US): (+1) [866-287-6188](tel:866-287-6188)
- Operating Hours: Monday-Friday, 10am-1pm, 2pm-7pm (Eastern Time) *Closed during Holidays
- Features:
 - Multifunction Button
 - Type-C Charging Port
 - Left and Right Mouse Buttons
 - Charging Indicator / Low Battery Indicator
 - Caps Lock Indicator
 - Bluetooth Connection 1, 2, 3
 - Multimedia Function Keys

Product Usage Instructions

Bluetooth Connection

1. Unfold the keyboard.
2. Single press to choose any Bluetooth connection, the white indicator light flashes once to enter Bluetooth mode. Then long press for 3-5s. When the white indicator light is flashing quickly, it enters Bluetooth pairing mode.
3. Turn on the Bluetooth settings on your device, search or select ProtoArc XK01 TP and start Bluetooth pairing until the connection is completed.

XK01 TP

User Manual

Foldable Wireless Keyboard with Touchpad

- www.protoarc.com
- US: support@protoarc.com
- UK: support-uk@protoarc.com
- United States: (+1) **866-287-6188**
- Monday-Friday: 10am-1pm , 2pm -7pm (Eastern Time)*Closed during Holidays

Product Features

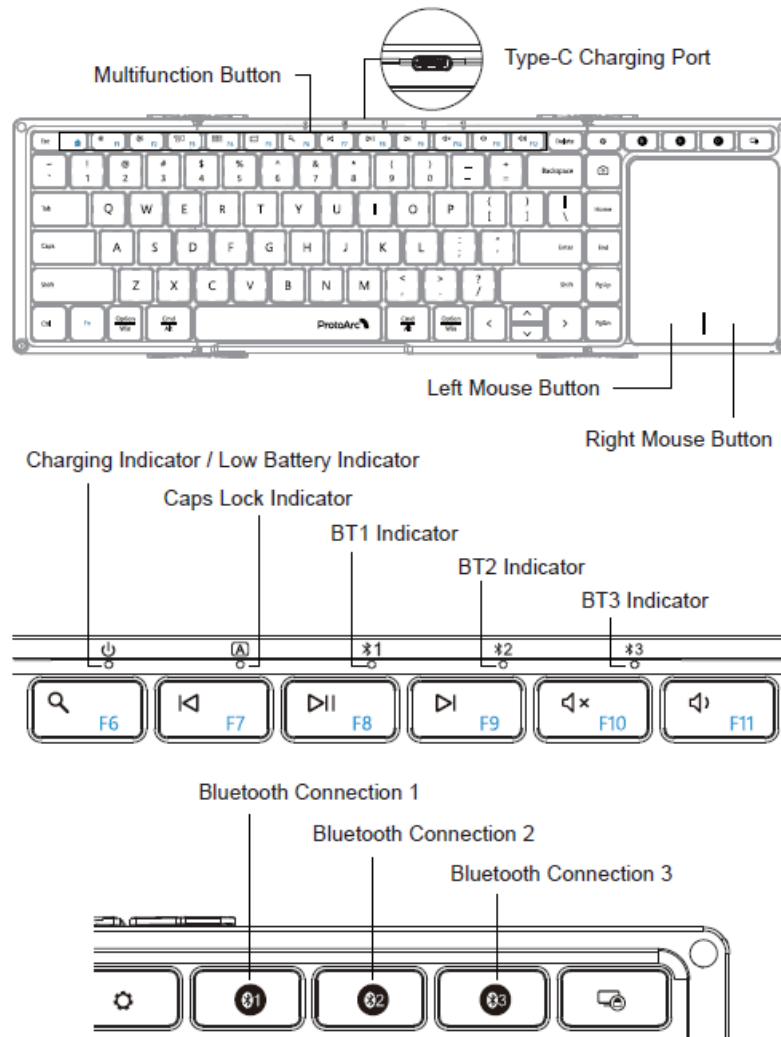

Bluetooth Connection

1. Unfold the Keyboard.



2. Single press to choose any Bluetooth connection ① / ② / ③, the white indicator light flashes once to enter Bluetooth mode. Then long press for 3-5s. When the white indicator light flashing quickly, it enters Bluetooth pairing mode.

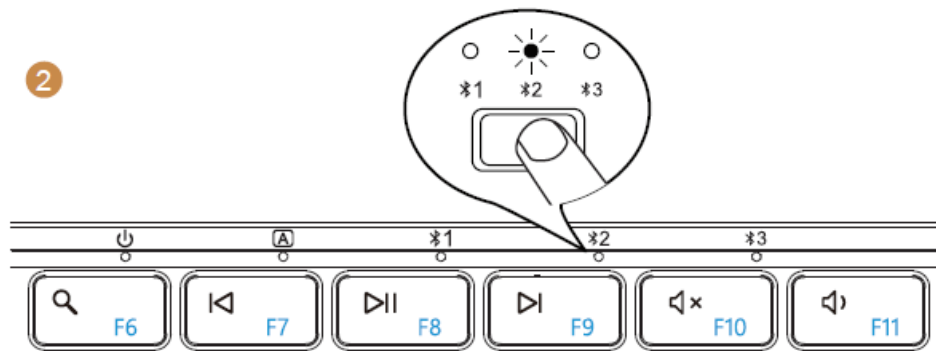

3. Turn on the Bluetooth settings on your device, search or select “ProtoArc XK01 TP” and start Bluetooth pairing until the connection is completed.

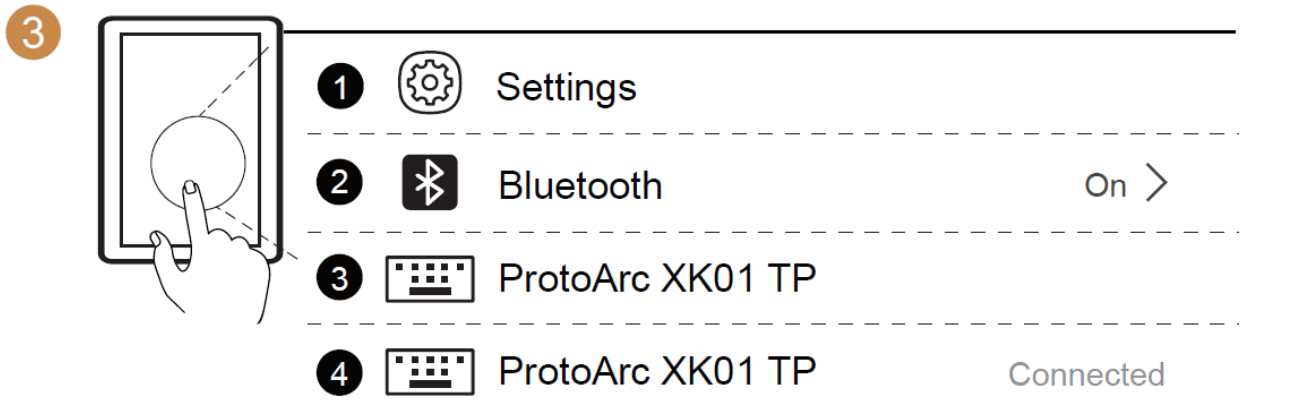

How to Switch Connection Mode

- ❶ / ❷ / ❸ After connection, short press the keyboard connection button to easily switch to multiple devices.

BT2 Device Connection

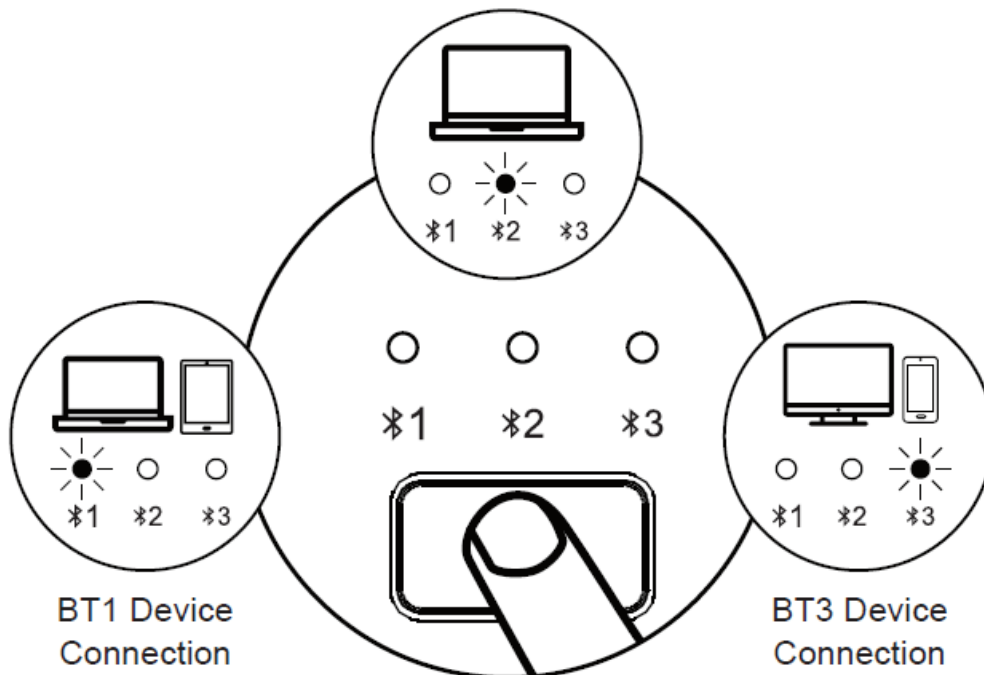

Keyboard Charging

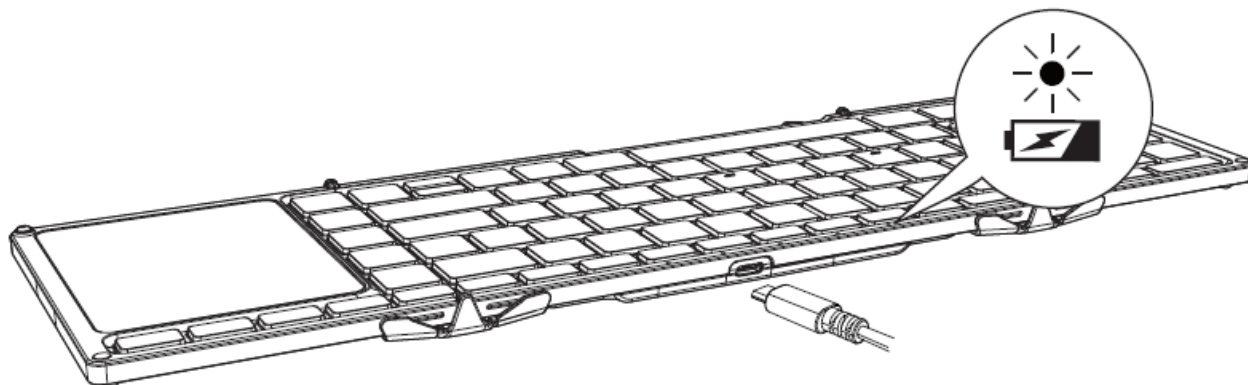

When the battery is too low, the low battery indicator will turn red and flash quickly. Please connect to the power supply to charge in time to ensure that the keyboard has sufficient power to meet normal work.

If the battery of the keyboard is too low, there will be delays and freezes and other problems in typing, which affect normal use.

Power indicator turns red while charging, then turn off after fully charged.

Multimedia Function Keys

Keys	Windows OS	Android OS	iOS	Mac OS
	Light -	Light -	Light -	Light -
	Light +	Light +	Light +	Light +
	Window Switch	Window Switch	/	Window Switch
	Application Switch	Application Switch	Open latest Window	Open latest Window
	Display Desktop	Go Home	Go Home	Go Home
	Search	Search	Search	/
	Previous Track	Previous Track	Previous Track	Previous Track
	Play & Pause	Play & Pause	Play & Pause	Play & Pause
	Next Track	Next Track	Next Track	Next Track
	Mute	Mute	Mute	Mute
	Volume -	Volume -	Volume -	Volume -
	Volume +	Volume +	Volume +	Volume +
	Setup	/	/	/
	Lock Screen	Lock Screen	Lock Screen	/
	Screenshot	Screenshot	Screenshot	Screenshot
	FN+ESC (FN lock) button to turn on or turn off the FN function			

Note: The FN function is a cyclic mode (F1-F12 and multimedia functions are cyclically used).

How to Use Special Characters in British English

On MacOS/iPadOS/iOS system

Press the key and you can type the symbol shows in the right square frame.			
	§		2
	\		'
	~		

Press and hold the key "Shift", then press the corresponding key, you can type the symbol shows in the right square frame.			
	±		@
			""
	~		

Press and hold the key "Option/Win", then press the corresponding key, you can type the symbol shows in the right square frame	
	€

On Android/Windows

Press the key and you can type the symbol shows in the right square frame.			
			2
	#		'
	\		

Press and hold the key "Shift", then press the corresponding key, you can type the symbol shows in the right square frame.			
			//
			@

Press and hold the key "Cmd/Alt" (the key on the right side of the keyboard), then press the corresponding key, you can type the symbol "¡" and "€".			
			€

Touchpad Function Explanation



Single Finger Tap
- Mouse Left Click



Single Finger Slide
- Move the Cursor



Two Fingers Tap
- Mouse Right Click



Pinch with Two Fingers
- Zoom In or Out



Two Fingers Slide Up/Down/Left/Right
- Mouse Scroll Wheel



Three Fingers Tap
Windows 10/11: Search

Three Fingers Swipe Up

- Windows 10/11: Open Task View
- IOS 13.4.1 and above: Task Center
- Mac OS 12.0 and above: Task Center

Three Fingers Swipe Down

- Windows 10/11: Back to Desktop
- Android 10.0: Back to the Homepage
- IOS 13.4.1 and above: Current Mission
- Mac OS 12.0 and above: Current Mission

Three Fingers Slide Left/Right

- Windows 10/11: Switch Between Active Windows Android 10.0: Switch App
- IOS 13.4.1 and above: Switch App
- Mac OS 12.0 and above: Switch App

Four Fingers Tap

- Windows 10/11: Open Action Center

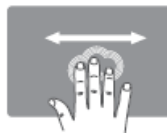
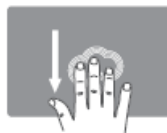

Product Parameters

Battery Capacity	300mAh
Working Current	≤7mA
Sleep Current	20uA
Charging Current	190mA(±20mA)
Standby Current	≤0.3mA
Standby Time	≥150 Days
Charging Time	<2 hours
Sleep time	30 minutes
Wake Up Way	Press any key
Weight	297g
Keyboard Dimension	386.4×119.7×12.4mm(Unfolded) 215.5×119.7×20.9mm(Folded)

Sleep Mode

1. When the keyboard is not used for more than 30 minutes, it will automatically enter the sleep mode and the indicator light will be off.
2. When you use the keyboard again, you only need to press any key, and the keyboard will wake up within 3 seconds. The indicator will light up again and starts to work.

FAQ

1. The tablet cannot connect to the Bluetooth keyboard?

1. First, check if the Bluetooth keyboard is in pairing mode(Long press /button for 3-5 seconds, and the corresponding Bluetooth indicator light will continuously flash, indicating successful Bluetooth pairing). Then, enable Bluetooth on the tablet and search “ProtoArc XK01 TP” to establish the connection.
2. Verify that the Bluetooth keyboard has sufficient battery power. Insufficient battery power can also prevent the connection. Please charge the Bluetooth keyboard before use.

2. The keyboard indicator light keeps flashing during use?

When the keyboard indicator light keeps flashing during use, it indicates that the battery is running low. Please recharge the keyboard as soon as possible.

3. The device shows that the Bluetooth keyboard is disconnected.

If the Bluetooth keyboard remains unused for a period of time, the device may automatically disable the Bluetooth function to save power. Press any key on the keyboard to wake it up, and the Bluetooth connection will be restored automatically.

Packing List

- 1* Foldable Bluetooth Keyboard
- 1* Type-C Charging Cable
- 1* Collapsible Phone Holder

- 1* Storage Bag
- 1* User Manual

EU Declaration of Conformity

- Declared Object: Foldable Wireless Keyboard with Touchpad
- Model: XK01 TP
- Rating: 3.7V 10mA
- Input: 5V 250mA
- Place of Production: Made in China
- Manufacturer: Shenzhen Hangshi Electronic Technology Co., LTD
- **Address:**

EC REP

- Business name: g.L.L. GmbH
- Business address: Bauernvogtkoppel, 55c, 22393, Hamburg, Germany
- Email: g.L.L.DE@outlook.com
- Tel: +49 162 3305764
- It is our sole responsibility to declare that the above products are in full compliance with Directive

UK REP

- Business name: AMANTO INTERNATIONAL TRADE LIMITED
- Business address: The Imperial, 31-33 St Stephens Gardens, Notting Hill,
- London, United Kingdom, W2 5NA
- Email: AmantoUK@outlook.com
- Tel: +44 7921 801 942

It is our sole responsibility to declare that the above products are in full compliance with Directive 2014/53/EU, 2011/65/EU (as amended)

- Position: Managing Director
- Date of Sign: 2022.1.5
- Signature:
- EU agent name:
- Date of Sign: 2022.1.5



