



ProtoArc R68 Wireless Mechanical Keyboard User Manual

[Home](#) » [ProtoArc](#) » ProtoArc R68 Wireless Mechanical Keyboard User Manual 

Contents

- [1 ProtoArc R68 Wireless Mechanical Keyboard](#)
- [2 Product Information](#)
- [3 Function Overview](#)
- [4 Wired Connection](#)
- [5 Bluetooth Connection](#)
- [6 Mode Switching](#)
- [7 Charging Guide](#)
- [8 Custom Driver](#)
- [9 Technical Specifications](#)
- [10 Troubleshooting](#)
- [11 Switch Replacement](#)
- [12 Important Safety and Compliance Information](#)
- [13 FCC Compliance Statement](#)
- [14 Documents / Resources](#)
 - [14.1 References](#)
- [15 Related Posts](#)



ProtoArc R68 Wireless Mechanical Keyboard



Product Information

The product is a keyboard that offers multiple connection options, including wired, 2.4G wireless, and Bluetooth. It has 5 different channels (BT1, BT2, BT3, 2.4G, and wired) and can connect up to 5 devices simultaneously. The keyboard supports both Windows and Mac systems, with the default layout set to Windows.

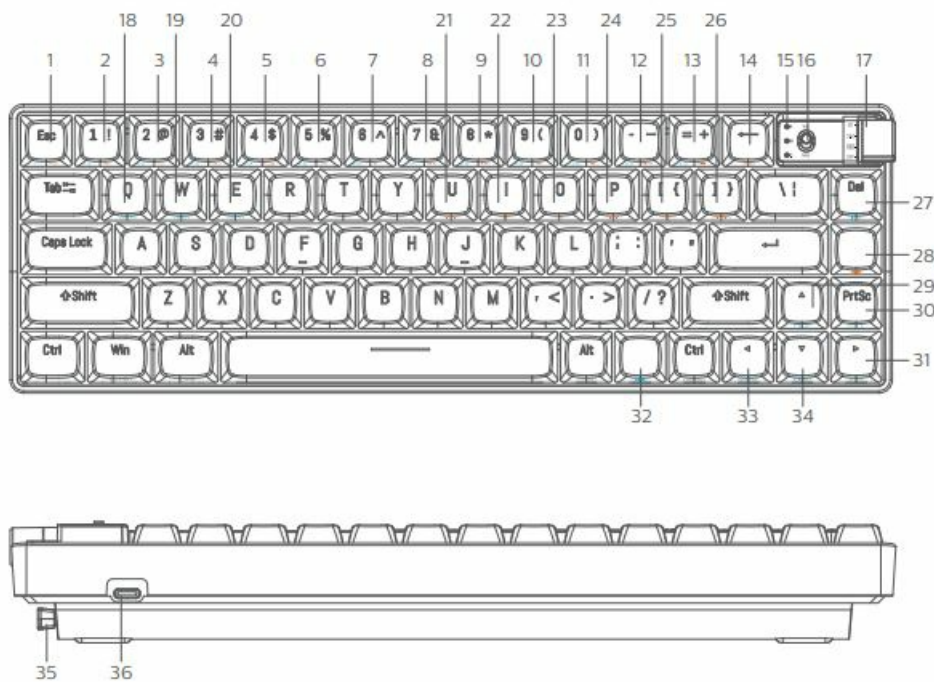

Function Overview

1. **Fn** + **~** : Enter ` or press Shift at the same time to enter ~
Fn + **↺** : Reset
2. **Fn** + **F1** : F1 function key
Fn + **☀** : Screen brightness -
3. **Fn** + **F2** : F2 function key
Fn + **☀** : Screen brightness +
4. **Fn** + **F3** : F3 function key
Fn + **🖥** : Multi screen display
5. **Fn** + **F4** : F4 function key
Fn + **🖥** : Back to the desktop
6. **Fn** + **F5** : F5 function key
Fn + **🎵** : Media Player
7. **Fn** + **F6** : F6 function key
Fn + **⏮** : Play/Pause
8. **Fn** + **F7** : F7 function key
Fn + **⏮** : Prev song
9. **Fn** + **F8** : F8 function key
Fn + **⏭** : Next song
10. **Fn** + **F9** : F9 function key
Fn + **🔇** : Mute
11. **Fn** + **F10** : F10 function key
Fn + **🔊** : Volume -
12. **Fn** + **F11** : F11 function key
Fn + **🔊** : Volume +
13. **Fn** + **F12** : F12 function key
Fn + **🌐** : Input method switching
14. **Fn** + **🌑** : Monochromatic light switching
15. **A** : Caps lock indicator
M : Mode switch
🔋 : Low battery indicator
16. Win/Mac System switch
17. OFF switch
🖥 Wired mode
2.4G wireless mode
BT Bluetooth mode
18. **Fn** + **BT1** : Bluetooth mode 1
19. **Fn** + **BT2** : Bluetooth mode 2
20. **Fn** + **BT3** : Bluetooth mode 3
21. **Fn** + **🌈** : Switch the RGB light mode
22. **Fn** + **🕒** : Decrease the RGB light frequency
23. **Fn** + **🕒** : Increase the RGB light frequency
24. **Fn** + **🌟** : Increase the RGB light brightness
25. **Fn** + **🌟** : Decrease the RGB light brightness
26. **Fn** + **🌈** : RGB Light switch
27. **Fn** + **Ins** : Insert
28. **Fn** : Fn key (orange)
29. **Fn** + **PgUp** : PgUp
30. **Fn** + **ScLk** : ScLK
31. **Fn** + **End** : End
32. **Fn** : Fn key (blue)
33. **Fn** + **Home** : Home
34. **Fn** + **PgDn** : PgDn
35. 2.4G receiver
36. Type-C charging/wired interface

Wired Connection

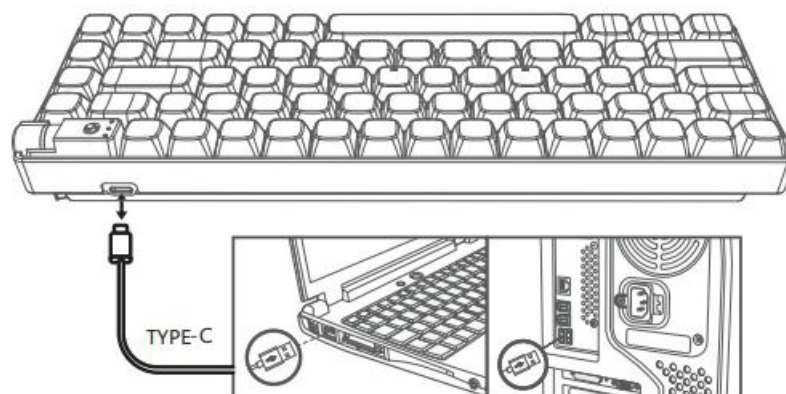

1. Insert the TYPE-C interface of the charging cable into the keyboard, and connect the USB interface to your computer.
- 2.

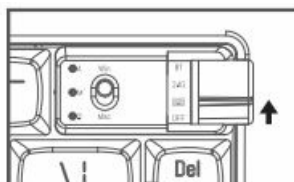

Switch to  Wired mode, 1 indicator will flash once and then go out, indicating a successful connection.

2.4G Connection

1. Take out the receiver and insert the receiver into the USB port of the computer

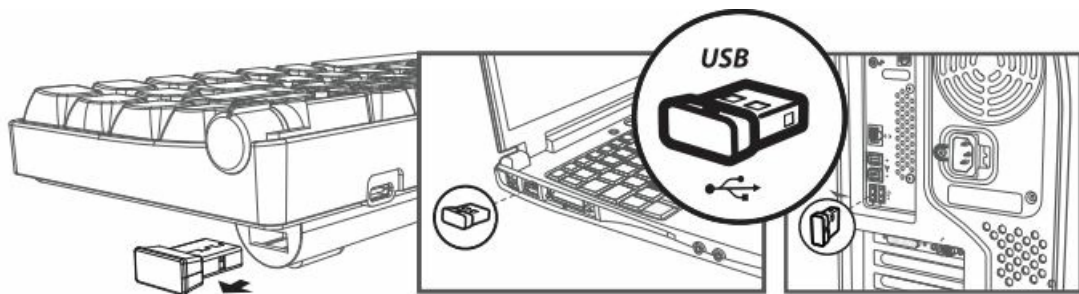

2. Switch to 2.4G mode, the 1 indicator will flash twice and then go off, indicating a successful connection

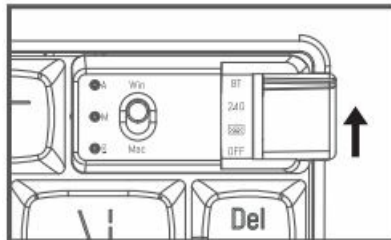

Type – C USB connector using method

During the 2.4GHz usage, there may be latency caused by external signal interference, which can be reduced by using a Type-C to USB adapter to minimize the interference.

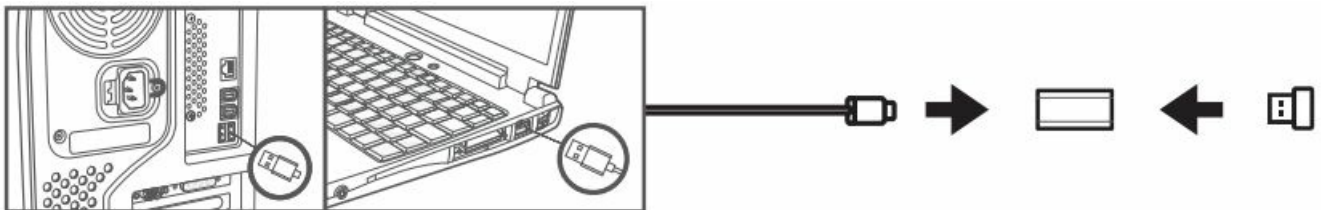

1. Insert the USB end of the cable into the USB port of the computer
2. Insert the Type-C end of the cable into the Type-C port of the adapter
3. Plug the USB receiver into the USB port of the adapter
4. Place the USB receiver close to the keyboard to minimize interference

Bluetooth Connection

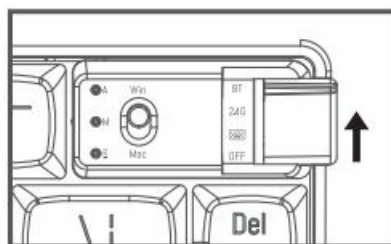

1. Switch to BT mode, the 1 indicator will flash three times and then go out.

Take the connection to BT1 as an example as follows:

1. Long press the Fn + Q key about 3 to 5 seconds, the corresponding indicator light will flash quickly, and then enter the Bluetooth pairing mode.

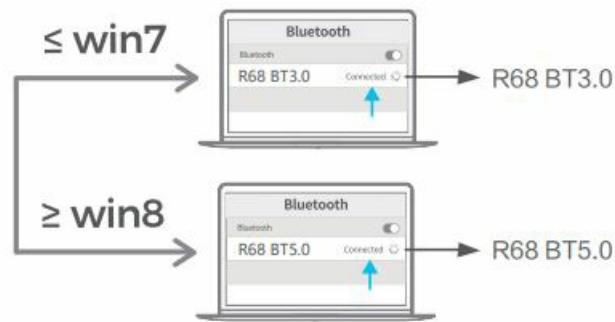

2. Turn on the Bluetooth of your computer or other device, search and select “R100 BT3.0” or “R100 BT5.0” and start Bluetooth pairing until the connection is completed.

Notice:

1. Windows 7 and below system versions do not support Bluetooth 5.0;
2. The device number corresponding to Bluetooths 3.0 is R68 BT3.0, and the device number corresponding to Bluetooth 5.0 is R68 BT5.0

Mode Switching

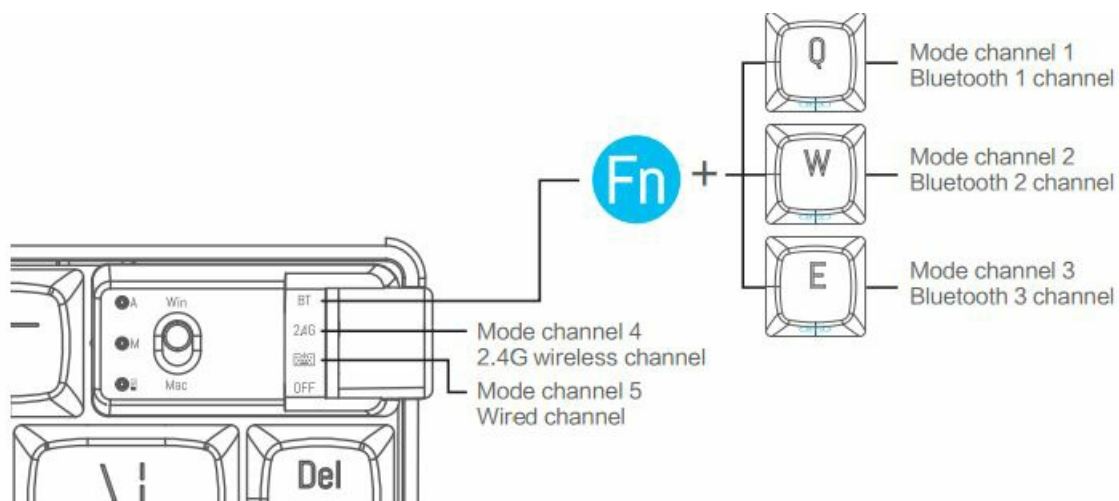

1. **Mode channel:** The keyboard has 5 channels, BT1, BT2, BT3, 2.4G, wired, and 5 devices can be connected at the same time.
2. **Mode rotary knob:** Turn the mode rotary knob between OFF/Wired/2.4G/BT. Press Fn (blue) + Q, W or E to switch between different Bluetooth channels of BT1, BT2 and BT3.

iOS/Mac/Win layout switching

Switch to Windows system

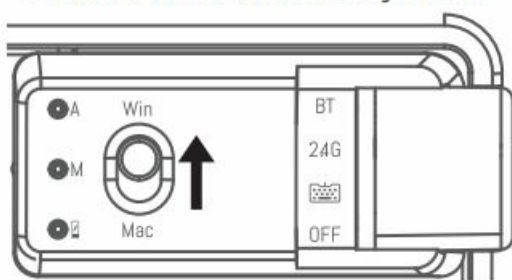

Switch to MAC system

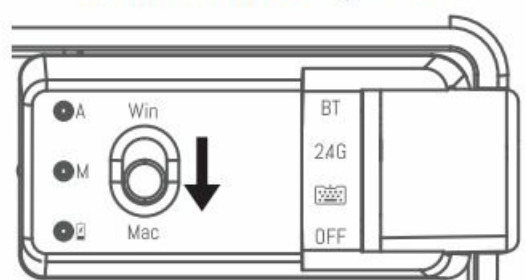

Note: the default setting is Windows layout

Charging Guide

1. **Low voltage reminder:**  The light flashes in red, indicating low voltage

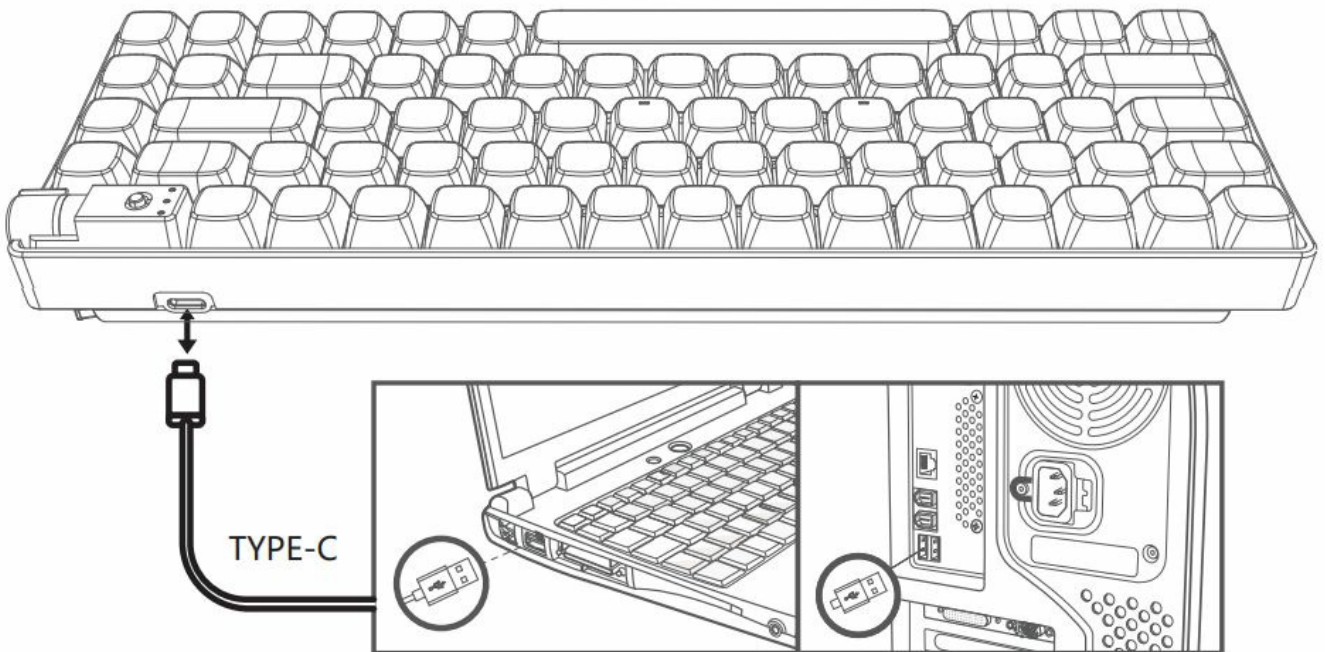

2. When the charging cable's Type-C interface is plugged into the keyboard and the USB interface is connected to your computer, the charging process begins, and the light stays red continuously.

3.  When the charging is complete, the light turns green.

Notice:

During the charging process, all modes are not controlled by the "ON/OFF" switch and are directly powered by the charging cable.

Custom Driver

For custom mode please go to the following URL to download official driver. <https://www.protoarc.com>

Find "Support" from the Header Menu > "Driver Downloads"

Note: The driver can only be used in wired and 2.4G mode

Technical Specifications

- **Connection method:** wired / 2.4GHz / Bluetooth 3.0 / Bluetooth 5.0
- **Wireless range:** 2.4GHz(49ft/15 meters), Bluetooth(33ft/10 meters)
- **Working current and voltage:** 5V, 500mA(max)
- **Keyboard keys:** 67
- **Keycap material:** PBT
- **Mechanical switch lifespan:** 100 million times
- **Lithium battery capacity:** 2100mAh
- **Keyboard product size:** 12.2" x 4" x 1.6"

- **Weight:** 1.56 lbs

System Requirements

1. 1 x USB port
2. Bluetooth 3.0/Bluetooth 5.0
3. Windows® 7, Windows® 8, Windows® 10 or later, Android 3.2 and above; Mac OS 10.5 or later

Note Multimedia functions are partially invalid in different OS versions.

Troubleshooting

1. Ensure that the product's USB wireless receiver is properly inserted into the computer's USB port.
2. Ensure that your computer meets the minimum system requirements.
3. If the product and the wireless receiver are beyond the effective connection distance, please reduce the distance between the product and the receiver.

Attention

1. For cleaning, please use dry, soft cotton fabric, etc.
2. Do not fold or bend the product.
3. Do not forcefully disassemble the product.
4. Avoid getting the product wet, exposed to direct sunlight, or near open flames.
5. Do not directly rinse with water.
6. The keyboard is designed to be charged with a rated voltage of 5V based on the USB protocol. Please use the computer's USB interface for charging and avoid using a charger to charge the keyboard.
7. During use, prevent liquids from entering the internal components, as this may cause short circuits and electrical malfunctions.

Switch Replacement

1. Use the keycap puller(included) to pull out the keycap
2. Pull out the switch with the switch puller(included)

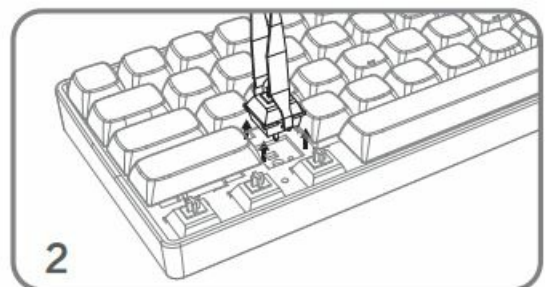
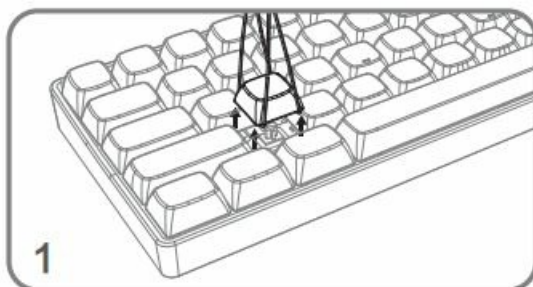

3. To install the new switch, align it with the corresponding holes on the keyboard.
4. Place the new switch on the socket.

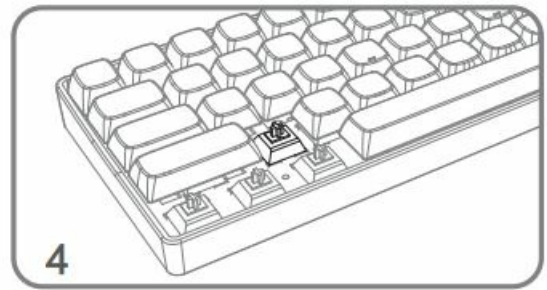
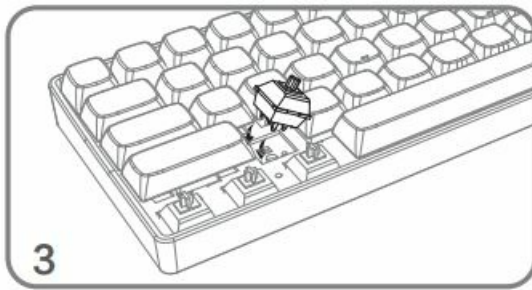

5. Gently press the new switch into the socket

6. Once the keycap is installed, it can be used normally.

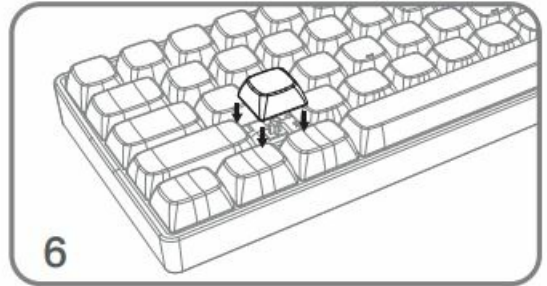
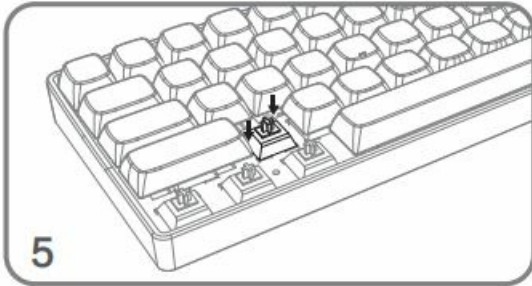

Important Safety and Compliance Information

Disposal of product and packing material

Important Safety and Compliance Information

Waste Electrical and Electronic Equipment-WEEE

This symbol on the product or on its packaging indicates that this product must not be disposed of with your household waste.

Instead, it is your responsibility to dispose of your waste equipment by handing it over to a designated collection point for the recycling or waste electrical and electronic equipment. The separate collection and recycling of your waste equipment at the time of disposal will help to conserve natural resource and ensure that it is recycled in a manner that protects human health and the environment. For more information about where you can drop off your waste equipment for recycling, please contact the local city office, the household waste disposal service or the shop where you purchased the product.

CE Declaration of Conformity

This device complies with the requirements set out in the Council Directive on the Approximation of the Laws of the Member States relating to Electromagnetic Compatibility Directive (2014/30/EU), RoHS directive (2011/65/EU) and Radio Equipment Directive (2014/53/EU)(for Radio Equipment)

This product has been tested and found to comply with the harmonized standards for Information Technology Equipment, these harmonized standards published under Directives of Official Journal of the European Union.

Federal Communications Commission (FCC) Notice

This equipment has been tested and found to comply with the limits for a Class B digital device, pursuant to Part 15 of the FCC Rules. These limits are designed to provide reasonable protection against harmful interference in a residential installation. This equipment generates, uses and can radiate radio frequency energy and, if not installed and used in accordance with the instructions, may cause harmful interference to radio communications

However, there is no guarantee that interference will not occur in a particular installation. If this equipment does cause harmful interference to radio or television reception, which can be determined by turning the equipment off and on, the user is encouraged to try to correct the interference by one or more of the following measures:

- Reorient or relocate the receiving antenna.

- Increase the separation between the equipment and receiver.
- Connect the equipment into an outlet on a circuit different from that to which the receiver is connected.
- Consult the dealer or an experienced radio/TV technician for help.

Changes or modifications not expressly approved by the party responsible for compliance could void the user's authority to operate the equipment.

THIS CLASS B DIGITAL APPARATUS MEETS ALL REQUIREMENTS OF THE CANADIAN INTERFERENCE – CAUSING EQUIPMENT REGULATIONS.

FCC Compliance Statement

This device complies with Part 15 of the FCC Rules. Operation is subject to the following two conditions:

1. This device may not cause harmful interference,
2. This device must accept any interference received, including interference that may cause undesired operation

Dear customer,

Thank you for purchasing ROYALAXE x ProtoArc products. To ensure you receive reliable after-sales service, please read the following instructions carefully. The product warranty period is valid for one year from the date of purchase (the date of receipt of the return receipt and the invoice date of the buyer).

The following situations are not covered by the after-sales service:

1. Inability to provide a valid warranty card and invoice (excluding those that can prove the product is within the valid warranty period) or any unauthorized alteration of the warranty.
2. The product model and serial number on the warranty card do not match the physical product or lack the distributor's seal.
3. Alteration, removal, or illegibility of the model number, serial number, or production date code on the product.
4. Defects resulting from excessive use outside the intended purpose, such as non-stop use in a commercial environment.
5. Damage caused by not using the product in accordance with the provided instructions.
6. Damage caused by the use of pirated software or computer viruses during use.
7. Damage caused by accidents, unauthorized repair, or service from unapproved vendors.
8. Damage caused by force majeure.
9. Product malfunction due to accidental disconnection, signal interference, or other influencing factors during use.
10. Normal wear and tear defects or defects in consumable parts by nature.
11. The product not functioning properly because it was not originally designed, manufactured, or approved for use in the country where you use the product, which might occur when you imported the product.

If the product functions you purchased are defective or cannot be used normally, please contact your local retailer

The serial number filled in the form must match the actual product. This certificate is the primary document for after-sales service, so please keep it safe. If you need technical support, please present this warranty card, and we will provide quality and professional services.

| | | |
|---|--------------------------|--|
| Commodity Information | Name | |
| | Place of origin | |
| | Model No. | |
| | Serial No. | |
| User info. | Name | |
| | Address | |
| | Tel. | |
| | Postcode | |
| Sales info. | Retailer | |
| | Address | |
| | Tel. | |
| | Postcode | |
| | Sale date | |
| | Invoice No. | |
| | Stamp & Signature | |
| <p>Dear customer, the above information is to be filled in by the seller. Please cooperate with us. Thank you !</p> <p>The following information shall be filled in by the maintenance agency and returned to the customer.</p> | | |
| Maintenance info. | Maintenance company name | |
| | Address | |
| | Tel. | |
| | Postcode | |
| | Document No. | |
| | Date | |
| | Signature | |

Customer Support:

- **Email:** support@protoarc.com Co-created by ProtoArc × RoyalAxe
- **Manufacturer:** Dongguan Lingjie Electronics & Technology Co., Ltd
- **Address:** No. 23 Zhenxing North Road, Xiegang Town, Dongguan,Guangdong, China
- **Web:** <https://www.protoarc.com>

Documents / Resources

| | |
|---|---|
|  | ProtoArc R68 Wireless Mechanical Keyboard [pdf] User Manual R68, B1X6TEb9T7L, R68 Wireless Mechanical Keyboard, Wireless Mechanical Keyboard, Mechanical Keyboard, Keyboard |
|---|---|

References

-  [ProtoArc® Healthier Workspace: Home Office And More](#)

Manuals+