

## Contents [ [hide](#) ]

- [1 ProtoArc KM90-A Keyboard Mouse](#)
- [2 Packing List](#)
- [3 Product Features](#)
- [4 Keyboard Bluetooth Connection](#)
- [5 Channel Switch Method](#)
- [6 Backlight Brightness Adjustment](#)
- [7 Charging Guide](#)
- [8 Multimedia Function Keys](#)
- [9 Product Parameters](#)
- [10 EU Declaration of Conformity](#)
- [11 Documents / Resources](#)
  - [11.1 References](#)

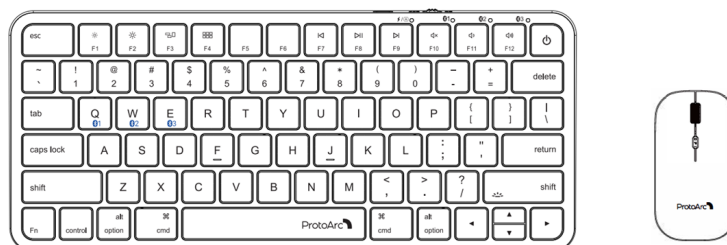

## ProtoArc KM90-A Keyboard Mouse



## Packing List

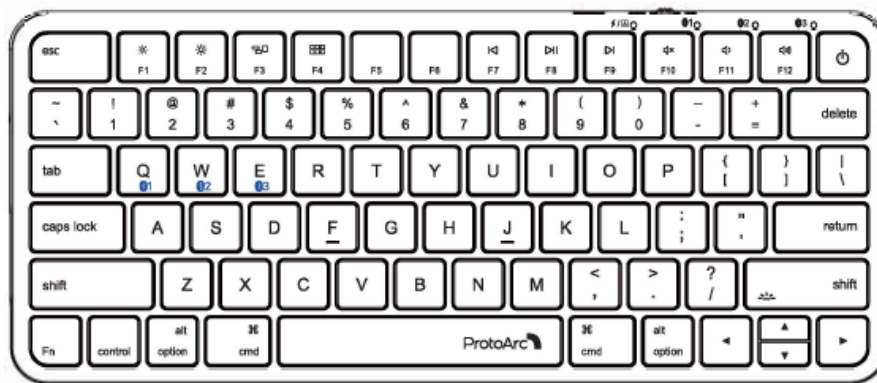

**Wireless Bluetooth Keyboard\* 1**



**Mouse\* 1**



**Type-C  
Charging Cable\* 1**

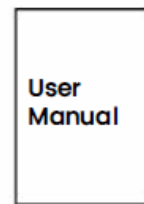

**User Manual\* 1**

## Product Features

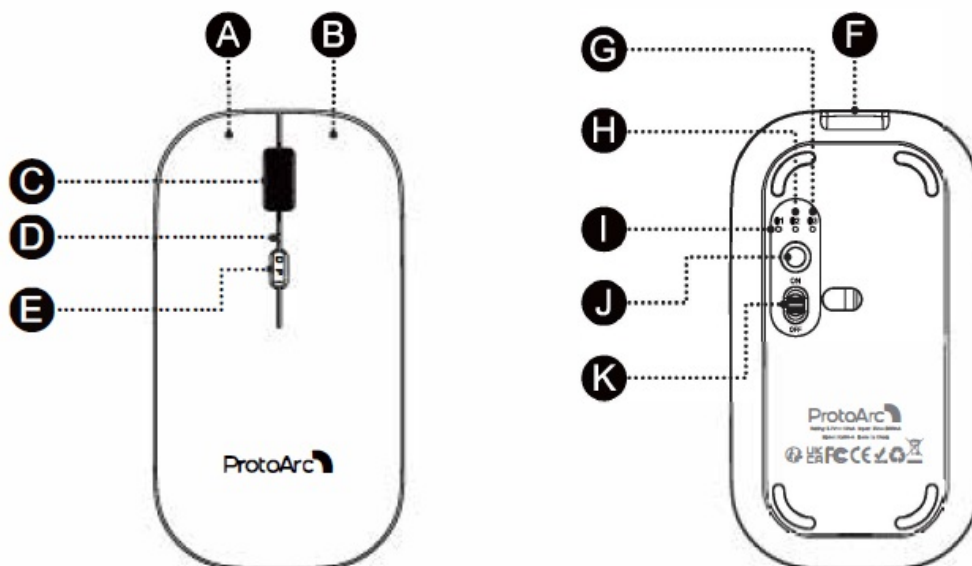
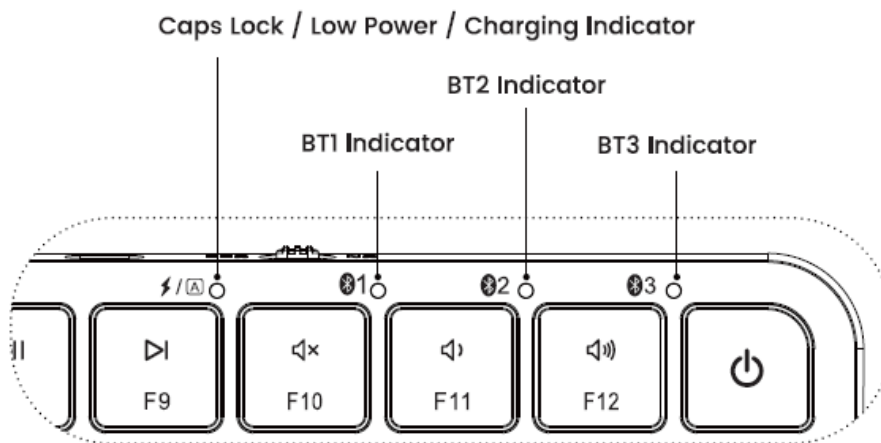
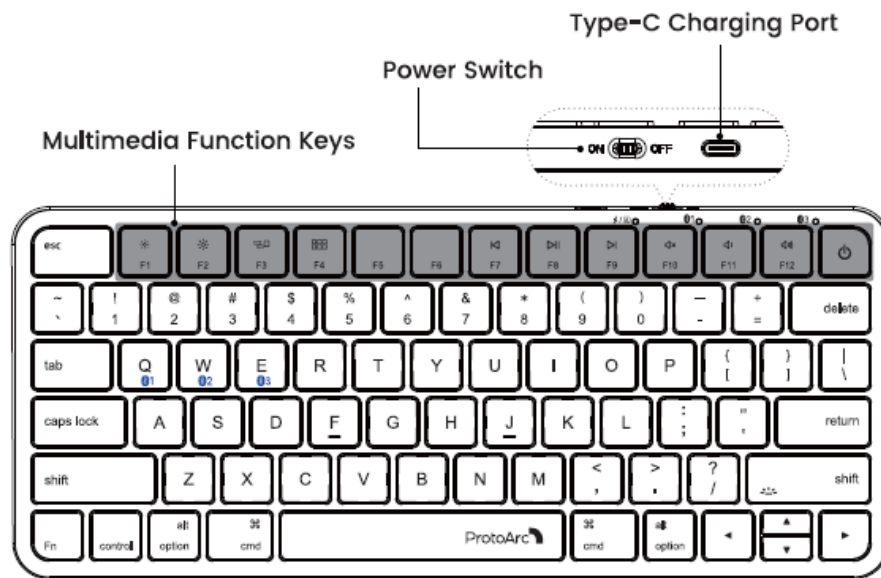

- A Left Button
- B Scroll Wheel Button
- C DPI Button
- D BT3 Indicator

- E BTI Indicator
- F Power Switch
- G Right Button
- H Low Power / Charging Indicator
- I Type-c Charging Port
- J BT2 Indicator
- K Channel Switch Button

## Keyboard Bluetooth Connection

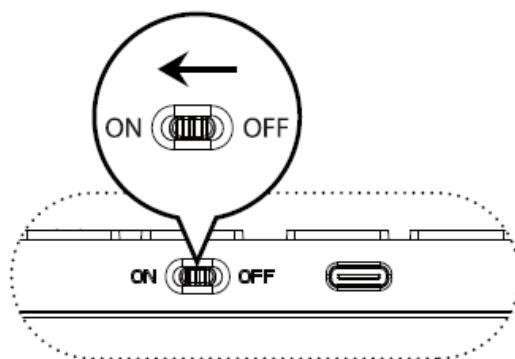

1. Turn the power switch to ON.

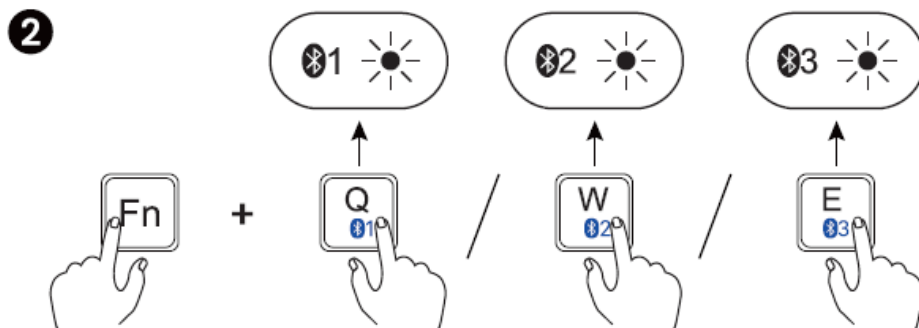

2. Press Fn + **Q** / **W** / **E** to switch Bluetooth channel.

Long press Fn + **Q** / **W** / **E** channel button for 3-5 seconds until the corresponding indicator light flashes quickly, the keyboard enters into Bluetooth pairing mode.

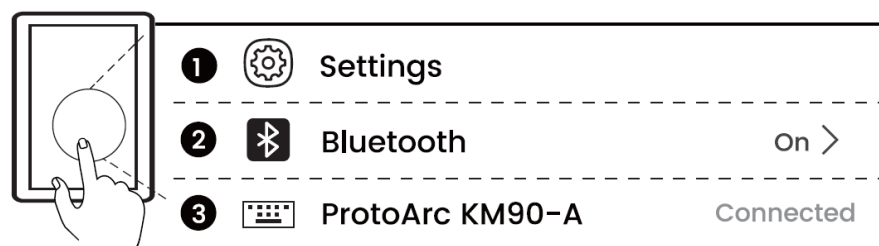

3. Turn on the Bluetooth settings on your device, search or select

“ProtoArc KM90-A” and start Bluetooth pairing until the connection is completed.

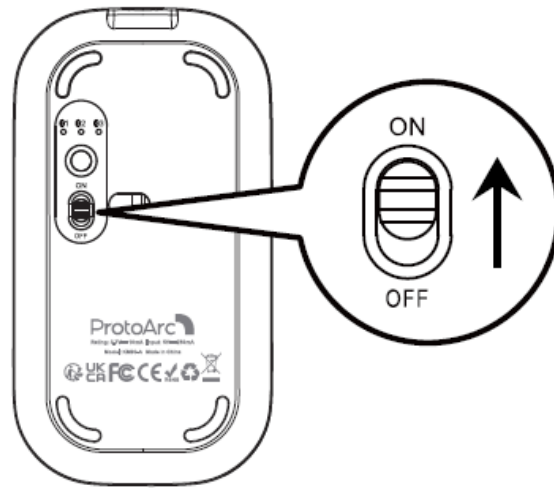

1. Turn the power switch to ON.

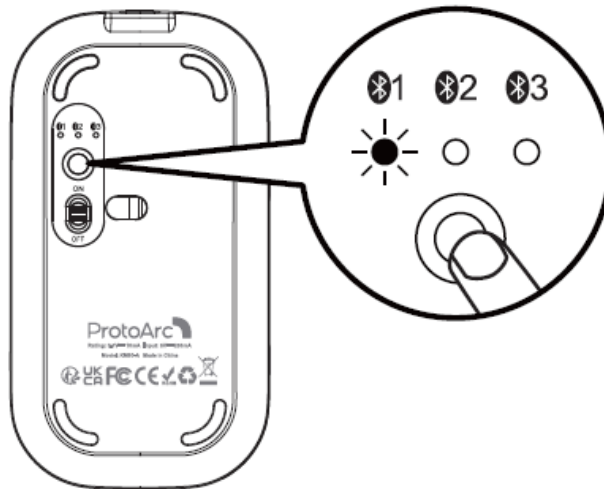

2. Press the channel switch button until the ❶ / ❷ / ❸ indicator is on. Long press the channel switch button for 3-5 seconds until the corresponding channel indicator flashes quickly, and it enters Bluetooth pairing mode.

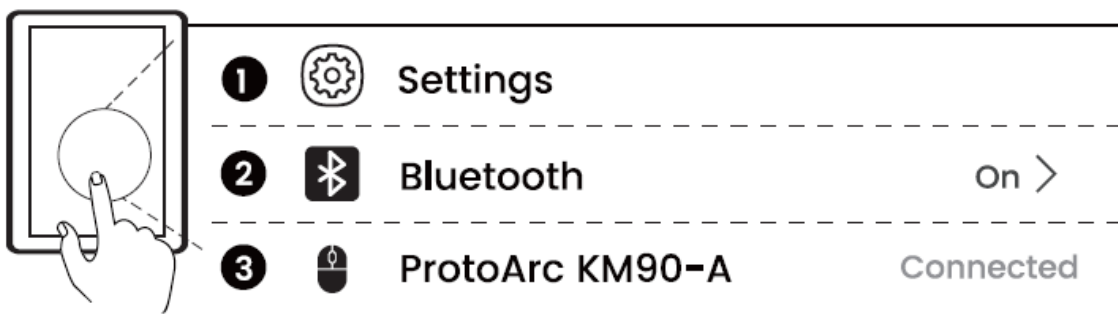

3. Turn on the Bluetooth settings on your device, search or select “ProtoArc KM90-A” and start Bluetooth pairing until the connection is completed.

## Channel Switch Method

**Keyboard:**

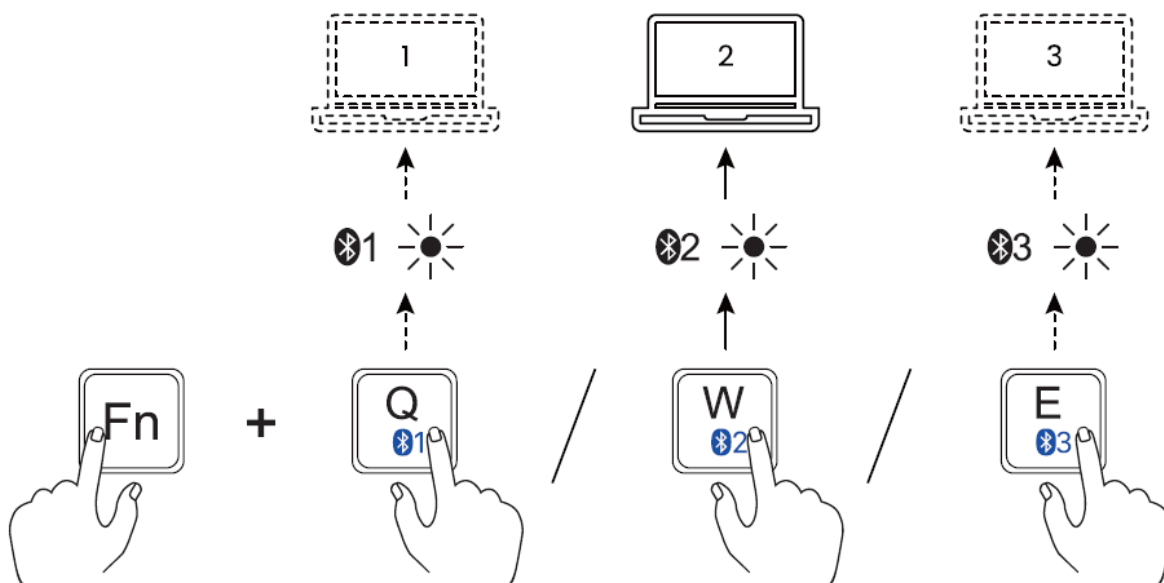

After all the Bluetooth channels are connected, press **Fn** + **Q** / **W** / **E** to switch between multiple devices.

### Mouse:

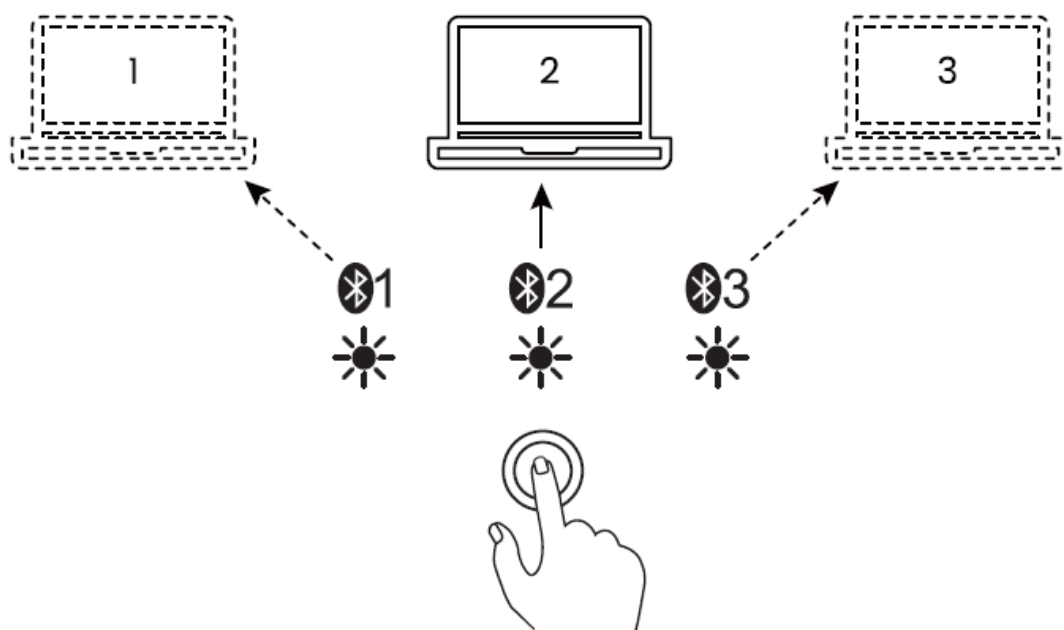

After channels **1** / **2** / **3** are all connected, short press mode switch button on the bottom of the mouse, easily switch between multiple devices.

### Backlight Brightness Adjustment

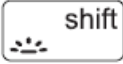

Press Fn +  key to adjust the backlight brightness.

- First press: Turns on backlight at 30% brightness
- Second press: Adjusts to 60% brightness
- Third press: Adjusts to 100% brightness
- Fourth press: Turns off backlight

The backlight will automatically turn off after 2 minutes of inactivity. Press any key to reactivate the backlight.

After 60 minutes of inactivity, the keyboard will enter sleep mode, and the backlight will turn off. Press any key to wake up the keyboard and the backlight requires manual reactivation.

## Charging Guide



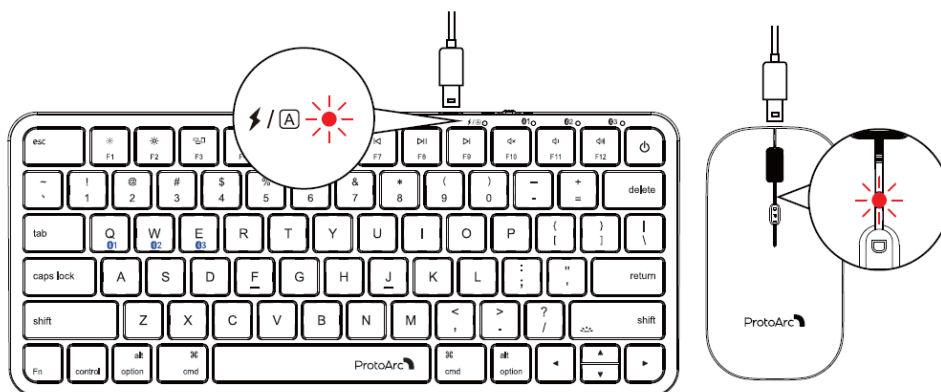







1. When the battery is low, the low battery indicator light will start flashing in red until the keyboard/mouse is turned off.
2. To charge the device, insert the Type-c port into the keyboard/mouse and the USB-A port into the computer. The red indicator light stays on while charging.
3. A full charge typically requires 3 to 4 hours per cycle, and the indicator light will turn green when fully charged.



### Notice:

If the mouse or keyboard is low battery, there will be delays, freezes and other problems. Please connect to the power supply for charging in a timely manner to ensure that the keyboard/mouse has sufficient battery power to get normal performance.

## Multimedia Function Keys

Key	Function
	Light decreased
	Light increased
	Mission Control
	Open Launchpad
	Previous track
	Play & Pause
	Next track
	Mute
	Volume down
	Volume up
	In the Mac system, Long press: Pop-up window to select shutdown In the IOS system, Short press: Screen lock

Note: Direct press is multimedia function. The F1-F12 functions need to be activated by pressing Fn + F1-F12 keys.

## Product Parameters

### Keyboard Parameters:

Compatible Operating systems	Mac OS 10.12 and above
Battery capacity	1200mAh
Working voltage	3.7V
Working current	≤2mA



Sleeping current	≤0.03mA
Standby time	200 Days
Working time	400 Hours (no backlight)
Charging time	3-4 Hours
Sleep time	Enter into the sleep mode with no operation for 60 minutes
Battery life	1000 times charge and discharge
Key life	3 Millions strokes
Operating distance	Within 8 meters
Wake up way	Press any key
Dimensions	286.32*121.38*14.03mm / 11.27*4.78*0.552in
1 Level Brightness Working Time	≤20Hours
2 Level Brightness Working Time	≤16Hours
3 Level Brightness Working Time	≤10 Hours

### Mouse Parameters:

Engine	Optics
DPI	1000/1600/2400 DPI
Mouse Button Life	More than 3 million times
Battery capacity	500mAh

Battery Life	1000 times charge and discharge cycles
Standby time	200 Days
Working time	83 Hours
Charging time	3-4 Hours
Dimensions	107.95×58.61×31.45mm / 4.25 X 2.31X 1.24in

### Kind Note

1. When the keyboard is not connected properly, please turn off the power switch, restart the Bluetooth of the device and connect again, or delete extra Bluetooth device names in the Bluetooth list, and connect again.
2. Please press the channel button to switch between the devices that already connected successfully, wait for 3 seconds, it will work properly.
3. The keyboard has memory function, when the keyboard is connected properly at one channel, turn off the keyboard and turn on again, the keyboard will be in the default channel, and the indicator light of this channel is on.
4. Operating System Compatibility: This keyboard is designed to work only with the macOS operating system. It is not compatible with Linux, Windows, or the Windows installed on Mac hardware. Using this keyboard with any incompatible operating system will prevent the media keys and function keys from working, and may cause other features to be unavailable or unstable.
5. System 8. Hardware Requirements: Devices manufactured before 2013 or running macOS versions below 10.12 are not supported.

### Sleep Mode

1. When the keyboard is not used for over 60 minutes, the keyboard will automatically enter into the sleep mode, the indicator light will be off.
2. When you want to use the keyboard again, please press any key, the keyboard will

wake up within 3 seconds, and the indicator light will be on again.

## Safety Warning

**IMPORTANT:** To reduce risk of fire, electric shock, or injury, follow these safety instructions.

- **Charging Safely:** Use only the provided cable. Charge in a well-ventilated, dry area away from inflammable materials.
- **Battery Handling:** Do not attempt to replace the item's lithium battery. Battery replacement should be conducted by qualified personnel to prevent hazards.
- **Heat Exposure:** Avoid leaving the item in high-temperature environments or in direct sunlight, which could result in a fire hazard.
- **Liquid Exposure:** Keep the item away from water and liquids. Do not use if wet until thoroughly dried.
- **Damage and Leakage:** Cease usage and consult customer service if the item is damaged or the battery leaks.
- **Correct Disposal:** Follow local regulations for disposing of electronic devices and batteries. Do not dispose of with household waste.
- **Radio Frequency Interference:** This device may cause interference with other electronics. Keep a safe distance from sensitive devices.
- **Child Safety:** Keep the item and its components out of reach of children to avoid choking or battery ingestion hazards. Never allow children to handle the item unsupervised.

**CAUTION:** Non-compliance with the above warnings can lead to serious injury or property damage.

For further assistance or information, please contact our customer service.

Emergency Contact: +1 [866-287-6188](tel:866-287-6188) (United States)

## EU Declaration of Conformity

- **Declared Object:** Multi-Device Backlit Bluetooth Mac Keyboard and Mouse Combo
- **Model:** KM90-A
- **Rating:** 3.7V  $\approx$  10mA

- Input: 5V==250mA
- Place of Production : Made in China
- Manufacturer: Shenzhen Hangshi Electronic Technology Co., LTD
- Email: [chen.zhao@bow.cn](mailto:chen.zhao@bow.cn)
- Address: Floor 2, Building A1, Zone G, Democratic West Industrial Zone, Democratic Community, Shajing Street, Bao'an District, Shenzhen City, Guangdong Province, China, 518104

## European

### Representative:

- |    |     |
|----|-----|
| EC | REP |
|----|-----|

 Business name: g.LL. GmbH
- Business address: Bauernvogtkoppel. 55c, 22393, Hamburg, Germany
- Email: [g.L.L.DE@outlook.com](mailto:g.L.L.DE@outlook.com)
- Tel: +49 162 3305764
- |    |     |
|----|-----|
| UK | REP |
|----|-----|

 Business name: AMANTO INTERNATIONAL TRADE LIMITED
- Business address: The Imperial, 31-33 St Stephens Gardens, Notting Hill, London, United Kingdom, W2 5NA
- Email: [AmantoUK@outlook.com](mailto:AmantoUK@outlook.com)
- Tel: +44 7921 801 942

It Is our sole responsibility to declare that the above products are In full compliance with Directive 2014/53/EU, 2011/5/EU (as amended)

- [www.protoarc.com](http://www.protoarc.com)

## us

- [support@protoarc.com](mailto:support@protoarc.com)
- ( + 1) [866-287-6188](tel:866-287-6188)
- Mon-Sun: 9AM – 1PM; 2PM – 6PM PT(Eastern Time)
- \*Closed during Holidays

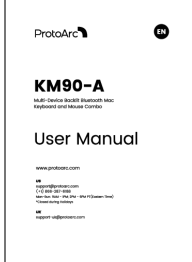

## UK

# Documents / Resources

	<p><a href="#">ProtoArc KM90-A Keyboard Mouse [pdf]</a> User Manual</p> <p>KM90-A, KM90-A Keyboard Mouse, Keyboard Mouse, Mouse</p>
---	---

## References

- [User Manual](#)

 Keyboard Mouse, KM90-A, KM90-A Keyboard Mouse, mouse,  
 ProtoArc    ProtoArc

---

## Leave a comment

Your email address will not be published. Required fields are marked \*

Comment \*

Name

Email

Website

☐ Save my name, email, and website in this browser for the next time I comment.

**Post Comment**

**Search:**

e.g. whirlpool wrf535swhz

**Search**

[Manuals+](#) | [Upload](#) | [Deep Search](#) | [Privacy Policy](#) | [@manuals.plus](#) | [YouTube](#)

This website is an independent publication and is neither affiliated with nor endorsed by any of the trademark owners. The "Bluetooth®" word mark and logos are registered trademarks owned by Bluetooth SIG, Inc. The "Wi-Fi®" word mark and logos are registered trademarks owned by the Wi-Fi Alliance. Any use of these marks on this website does not imply any affiliation with or endorsement.