

ProtoArc
KM201
Wireless
Mechanical
Keyboard and
Mouse Combo



ProtoArc KM201 Wireless Mechanical Keyboard and Mouse Combo User Manual

[Home](#) » [ProtoArc](#) » ProtoArc KM201 Wireless Mechanical Keyboard and Mouse Combo User Manual 

Contents

- [1 ProtoArc KM201 Wireless Mechanical Keyboard and Mouse Combo](#)
- [2 PRODUCT FEATURES](#)
- [3 2.4G Wireless Connection](#)
- [4 CHARGING GUIDE](#)
- [5 Multimedia Function Button](#)
- [6 Product Specifications](#)
- [7 Packing List](#)
- [8 CONTACT INFORMATION](#)
- [9 Documents / Resources](#)
 - [9.1 References](#)
- [10 Related Posts](#)



ProtoArc KM201 Wireless Mechanical Keyboard and Mouse Combo



PRODUCT FEATURES

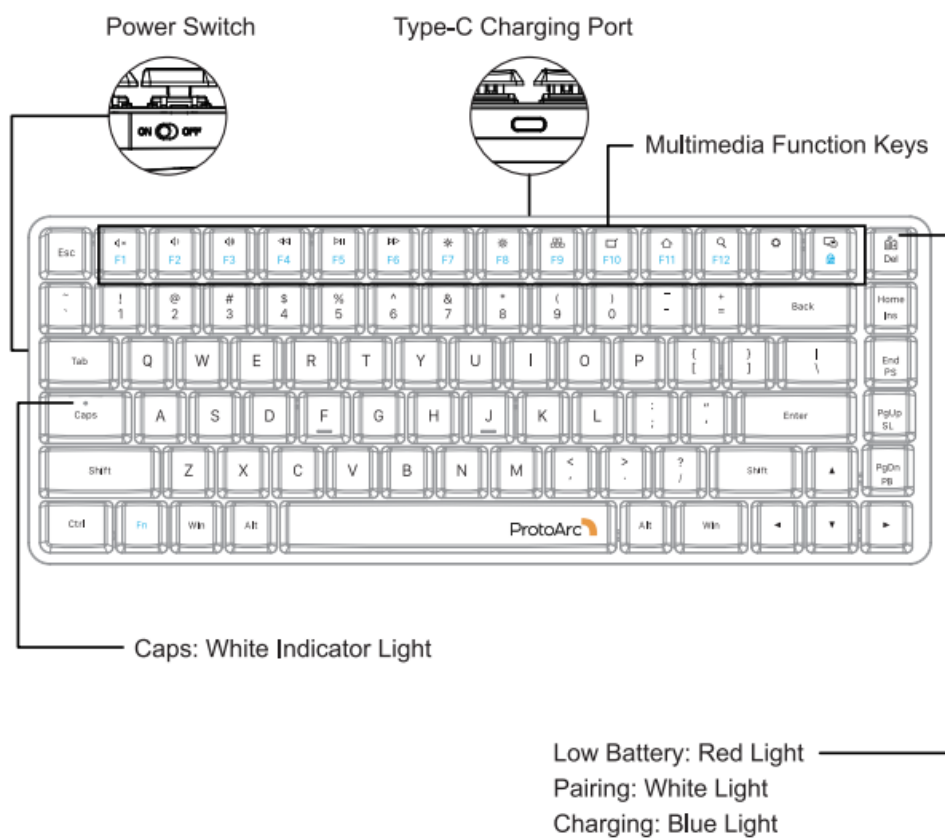

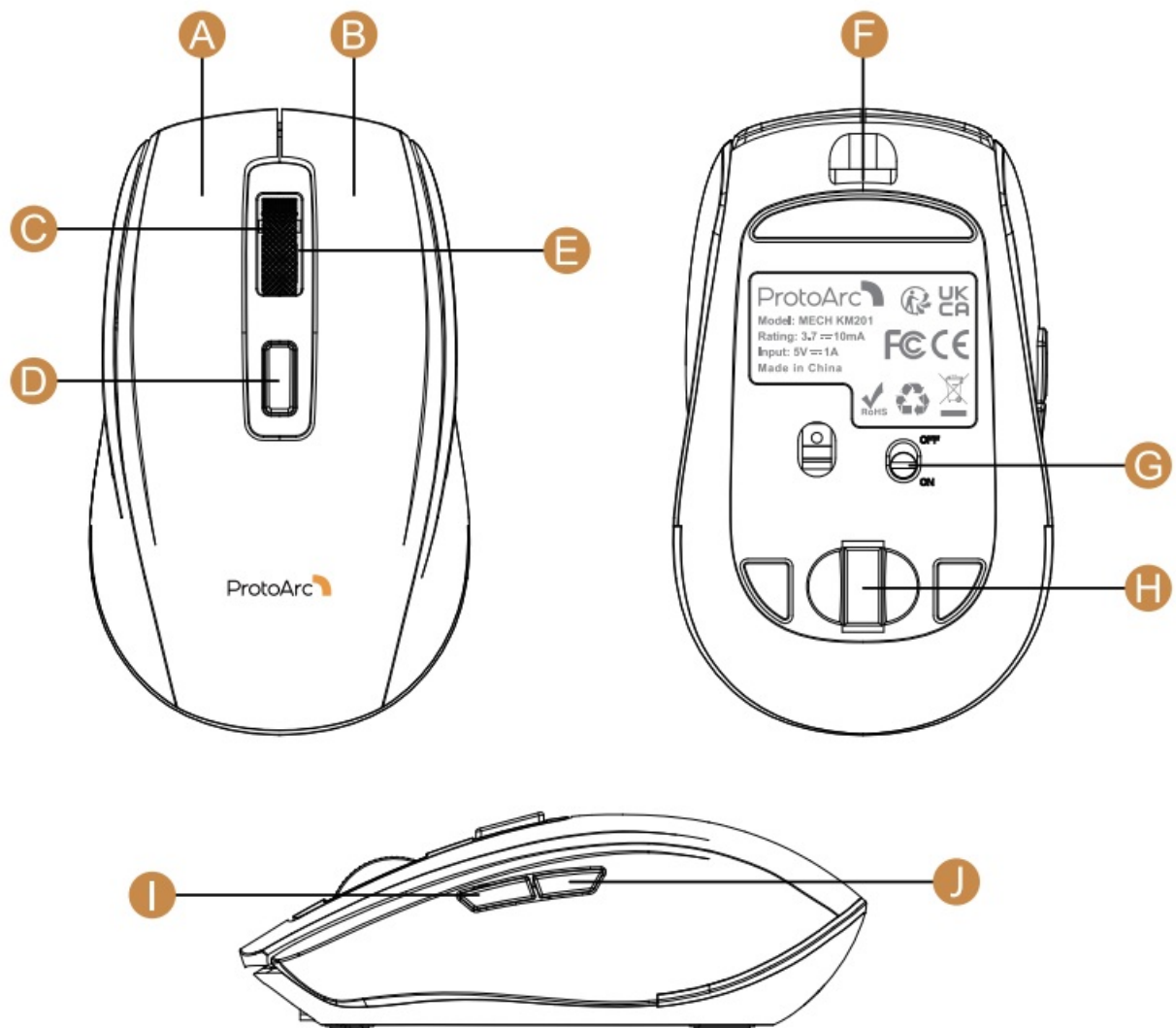

- **A** Left Button
- **B** Right Button
- **C** Scroll Wheel Button
- **D** DPI Switch Button
- **E Low Battery/Pairing:** Red Light
- **F** Type-C Charging Port
 - **Charging:** Blue Light
 - **DPI:** Red Light
- **G** Power Switch
- **H** USB Receiver
- **I** Forward Button
- **J** Backward Button

2.4G Wireless Connection

1. Turn on the power switch of the keyboard and mouse.

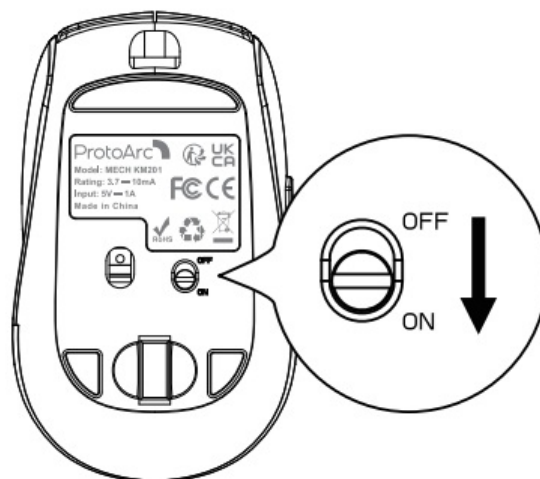
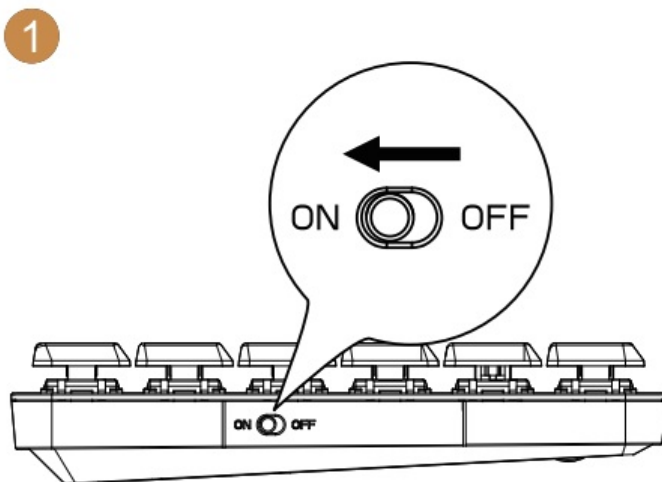

2. Take out the USB receiver from the bottom of the mouse and insert it into your computer's USB port, the keyboard and mouse are now ready for use.

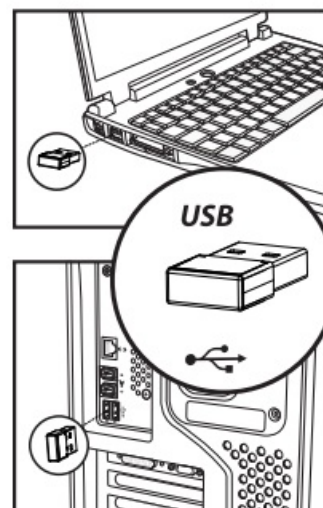
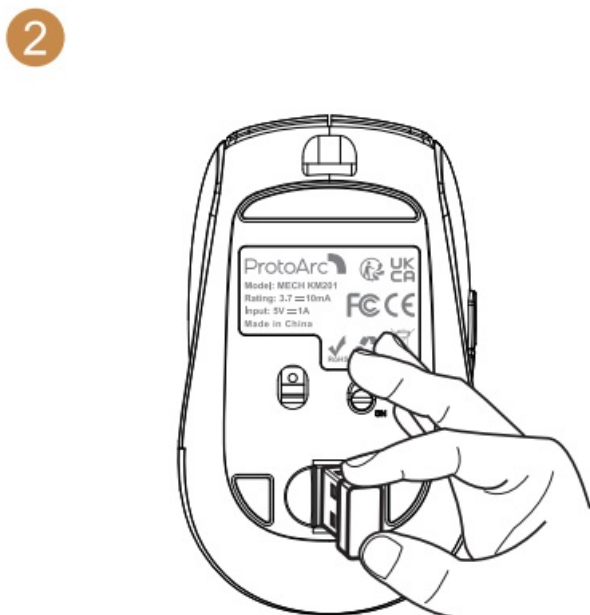



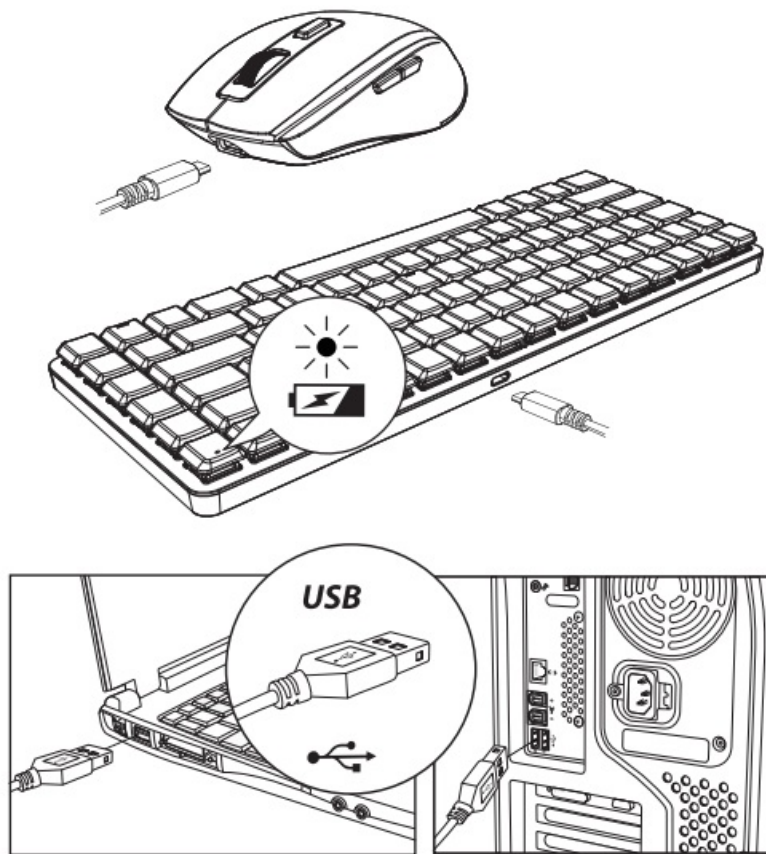











CHARGING GUIDE



1. When the battery is low, the low battery indicator light will start flashing in Red until the keyboard/mouse is turned off.
2. Insert the USB-A end into the computer port and plug the Type-C end into the keyboard/mouse. The blue indicator light will stay on constantly during charging.
3. A full charging cycle takes approximately 2 to 3 hours. Once the keyboard and mouse are fully charged, the charging indicator blue light will automatically turn off.

Multimedia Function Button

Key	Function
	Mute
	Volume Down
	Volume Up
	Previous
	Play&Stop
	Next
	Decrease Brightness
	Increase Brightness
	Multi-window Preview
	Show Desktop
	Home
	Search
	Computer System Setting
	Lock Screen
	FN Lock

The direct press is a multi-media function, the F1-F 12 function needs press FN plus implementation.

Product Specifications

Keyboard Parameters:

Compatibility	Supports Win XP to Win 11
Battery Capacity	300mAh
Working Current	<10mA
Sleep Current	<50uA
Charging Time	<2Hour
Wake Up Way	Press any key
Weight	18.34oz(520g)
Keyboard Dimension	12.24 * 4.76 * 1.03 inch

Mouse Parameters:

Engine	Optics
DPI	800/1200 (Default)/1600DPI
Working Current	<10mA
Battery Capacity	300mAh
Charging Time	<2Hour
Weight	2.65oz(75g)
Mouse Dimension	4.27 * 2.59 * 1.47 inch

Sleep Mode

1. When the keyboard has no activity for more than 5 seconds, it will automatically enter sleep mode, and the indicator light will turn off.
2. To wake up the keyboard, simply press any key on the keyboard, and it will be ready within 3 seconds. The indicator light will light up again.

Tips

1. If the keyboard and mouse are not working or stop pairing? Please charge the keyboard and mouse immediately, and press and hold the ESC+K keys on the keyboard for more than 3 seconds, the white indicator light will illuminate when the 2.4G pairing is successful. Keep the USB receiver and keyboard within a distance of approximately 10cm. Insert the receiver into a USB port on your computer, once the white indicator light turns off, it should work normally. Turn the power switch on the bottom of the mouse to the ON position. Simultaneously, press and hold the left, middle, and right buttons for more than 3 seconds until the red indicator light under the scroll wheel illuminates. Keep the USB receiver and mouse within a distance of approximately 10cm. After inserting the receiver into a USB port on your computer, the red indicator light will turn off, indicating that it is ready for normal operation.
2. Does it support compatibility with Mac OS systems? It only supports basic functions and is not compatible with some multimedia and special key combination features.
3. Can the mechanical switches be replaced? The switches are soldered and cannot be replaced by customers. However, the keycaps can be replaced with cross-shaped keycaps.

Packing List

- 1 x Wireless Keyboard
- 1 x Wireless Mouse
- 1 x Type C Charging Cable
- 1 x User Manual

CONTACT INFORMATION

- support@protoarc.com
- www.protoarc.com
- **United States:** (+1) [866-287-6188](tel:866-287-6188)
- **Monday-Friday:** 10 am-1 pm, 2 pm-7 pm (Eastern Time)*Closed during Holidays

Documents / Resources

	ProtoArc KM201 Wireless Mechanical Keyboard and Mouse Combo [pdf] User Manual KM201 Wireless Mechanical Keyboard and Mouse Combo, KM201, Wireless Mechanical Keyboard and Mouse Combo, Mechanical Keyboard and Mouse Combo, Keyboard and Mouse Combo, Mouse Combo, Combo
---	---

References

- [User Manual](#)

[Manuals+](#), [Privacy Policy](#)

This website is an independent publication and is neither affiliated with nor endorsed by any of the trademark owners. The "Bluetooth®" word mark and logos are registered trademarks owned by Bluetooth SIG, Inc. The "Wi-Fi®" word mark and logos are registered trademarks owned by the Wi-Fi Alliance. Any use of these marks on this website does not imply any affiliation with or endorsement.