

ProtoArc HubMouse USB C Wireless Bluetooth Mouse



ProtoArc HubMouse USB C Wireless Bluetooth Mouse User Manual

[Home](#) » [ProtoArc](#) » ProtoArc HubMouse USB C Wireless Bluetooth Mouse User Manual 

Contents

- [1 ProtoArc HubMouse USB C Wireless Bluetooth Mouse](#)
- [2 Product Information](#)
- [3 Product Usage Instructions](#)
- [4 Product Function](#)
- [5 2.4G Connection](#)
- [6 Bluetooth Connection](#)
- [7 Mode Switch Method](#)
- [8 USB Cable Charging](#)
- [9 Main Specifications](#)
- [10 Package Contents](#)
- [11 Documents / Resources](#)
 - [11.1 References](#)
- [12 Related Posts](#)



ProtoArc HubMouse USB C Wireless Bluetooth Mouse



Product Specifications:

- Rating: 3.7V 10mA
- Input: 5V 250mA
- Model: HubMouse
- Made in China
- Dimensions: 109*61*31mm

Product Information

The HubMouse is a versatile hub device that combines multiple functions in one compact unit. It features HDMI, TYPE-C, USB3.0, and PD Charge interfaces, making it compatible with a wide range of devices.

Hub Capabilities:

- 2.4G receiver for seamless mouse connection
- HDMI: Supports up to 4K resolution
- USB 3.0: Transfer bandwidth up to 5.0 Gbps (500 MB/s)
- PD fast charge: Charging power up to 60W
- Supports Systems: Mac OS / Windows / Linux / iOS / Android

Product Usage Instructions

1. Plug the HUB into the Type-C port on your device.
2. Take out the HUB from the packaging.
3. Press the mode switch button until the white light is on, indicating that the mouse is in USB mode.

Frequently Asked Questions (FAQ):

Q: What devices are compatible with the HubMouse?

A: The HubMouse is compatible with devices running Mac OS, Windows, Linux, iOS, and Android operating systems.

Q: What is the maximum resolution supported by the HDMI interface?

A: The HDMI interface on the HubMouse supports up to 4K resolution.

Product Function

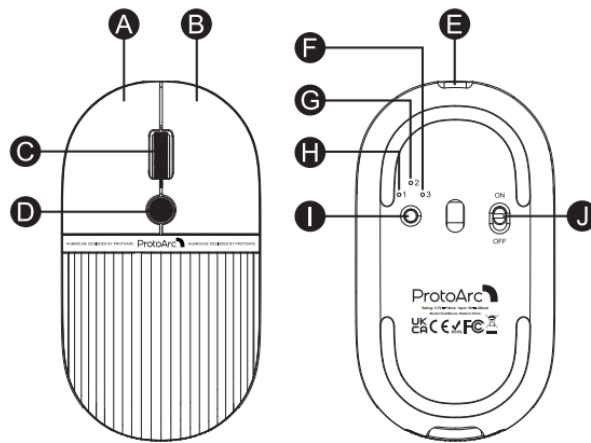

- **A** Left Button
- **B** Right Button
- **C** Scroll Wheel
- **D** DPI Switch Button
- **E** Micro USB Charging Port
- **F** Bluetooth Indicator Light 2
- **G** Bluetooth Indicator Light 1
- **H** USB Indicator Light
- **I** Mode Switch Button
- **J** Power Switch
- **K** USB Receiver
- **L** Low Battery Indicator Light / Charging Indicator Light

Introduction to HUB capabilities

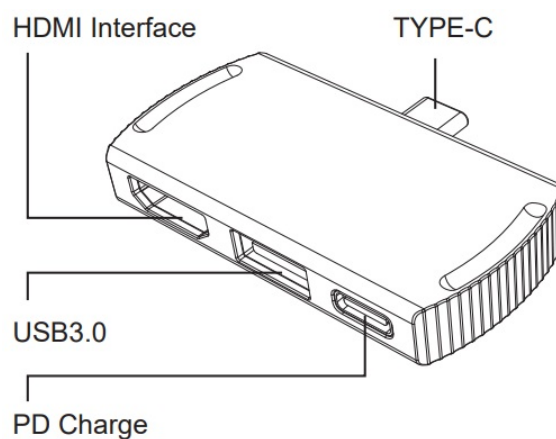

The HUB comes with a 2.4G receiver that is perfectly linked to the mouse

- HDMI: Maximum 4K support
- USB 3.0: maximum transfer bandwidth up to 5.0 Gbps (500 MB/s)
- PD fast charge: the charging power can reach 60W
- Support System: Compatible with Mac OS / Windows / Linux / IOS / Android disclaimer

2.4G Connection

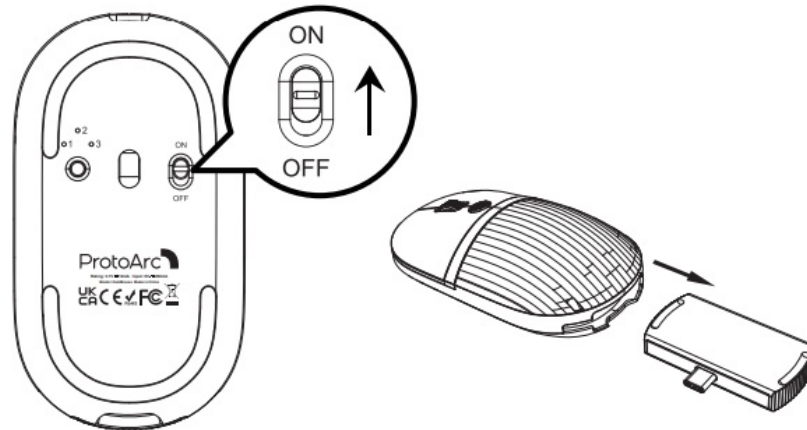

1. Slide the power switch to "ON".
2. Take out the HUB.
3. Plug the HUB into the Type-C port.
4. Press the mode switch button until the white light is on, means that the mouse enters the USB mode.

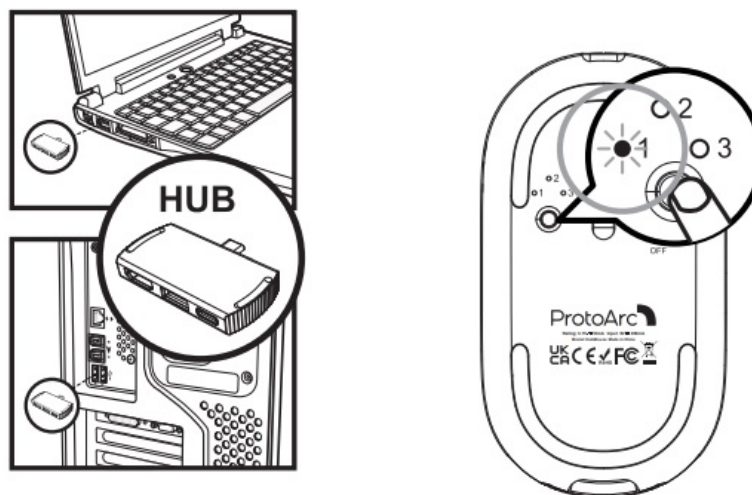

Bluetooth Connection

Windows System (Take Windows 10 as an example)

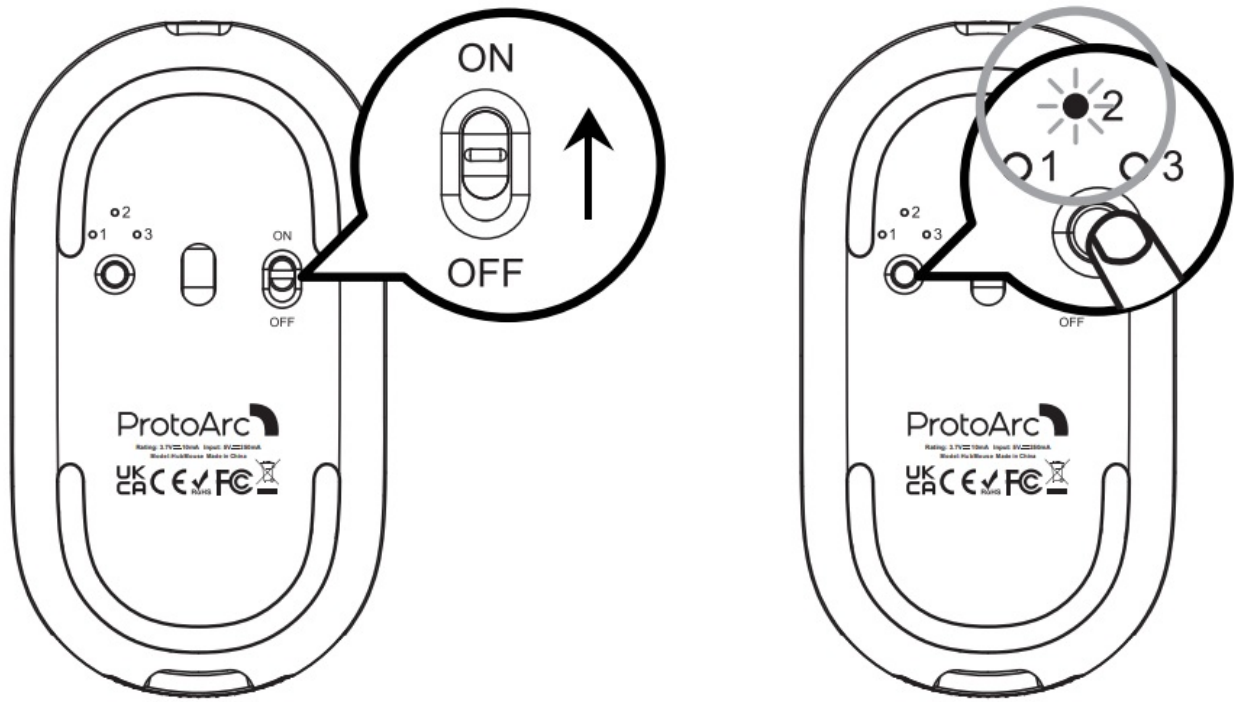

1. Slide the power switch to “ON”.
2. Press the mode switch button to switch to BT1 or BT2, the white light flashes slowly.
3. Long press the mode switch button for 3-5 seconds until the white light flashes quickly, means that the mouse enters the Bluetooth pairing mode.

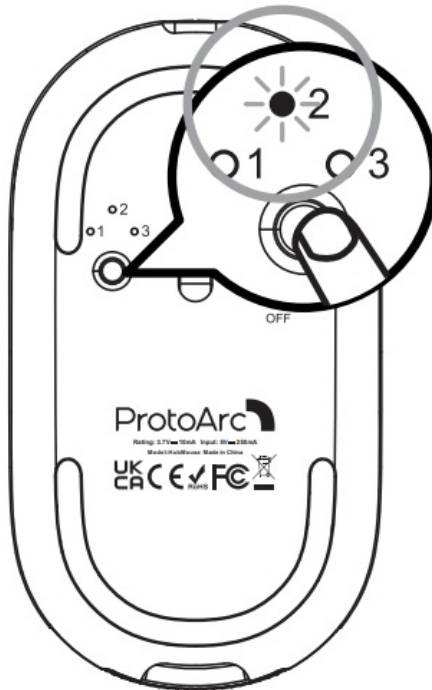

4. Find “Bluetooth Device” on the computer.

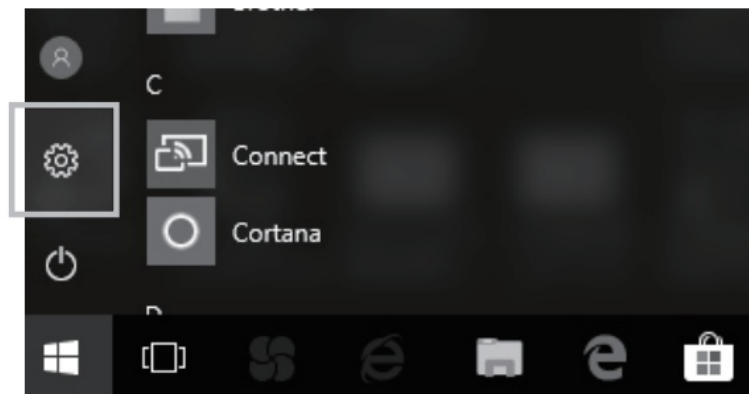

5. Choose “Add / Delete Bluetooth Devices”.

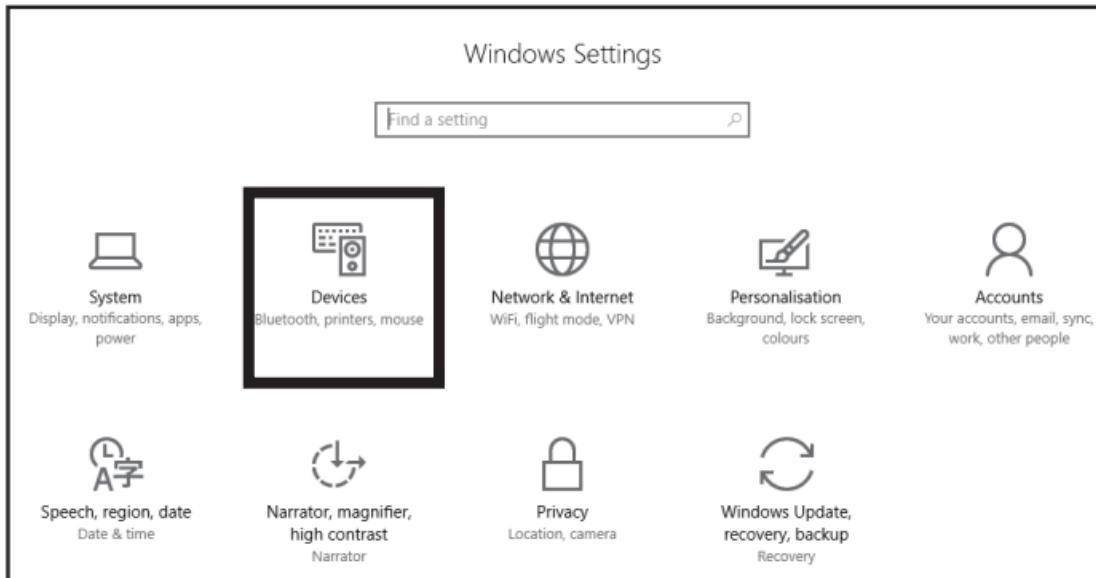

6. Find the device “HubMouse” and click to pair.

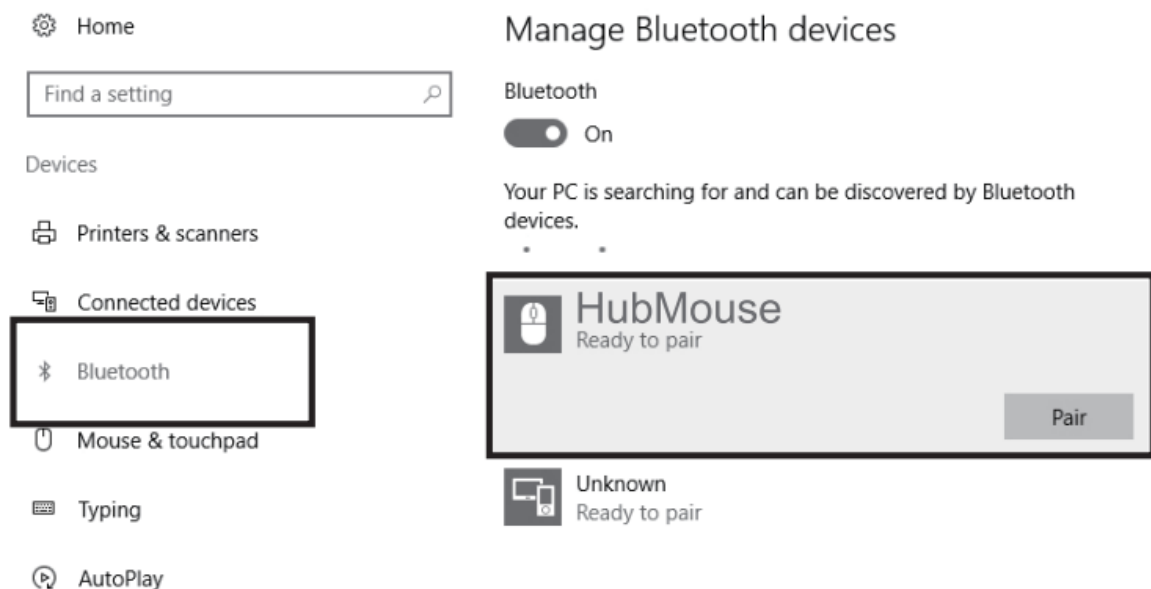

7. Successfully paired when it shows “HubMouse” Connected.

Your PC is searching for and can be discovered by Bluetooth devices.

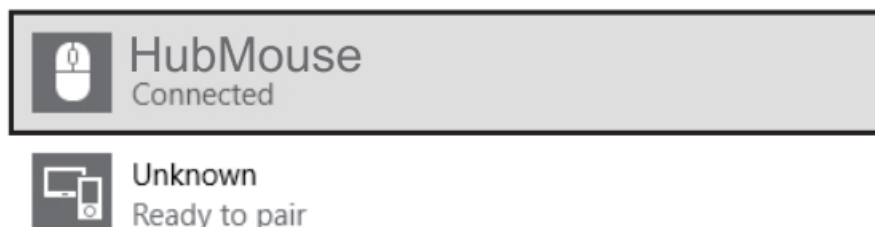

Mac OS System

Refers to Bluetooth Mode Installation Steps 1, 2 and 3 before pairing.

1. Click “System Preferences” on Macs.



2. Choose “Bluetooth” in System Preferences.



3. Search and pair “HubMouse” and complete connection.

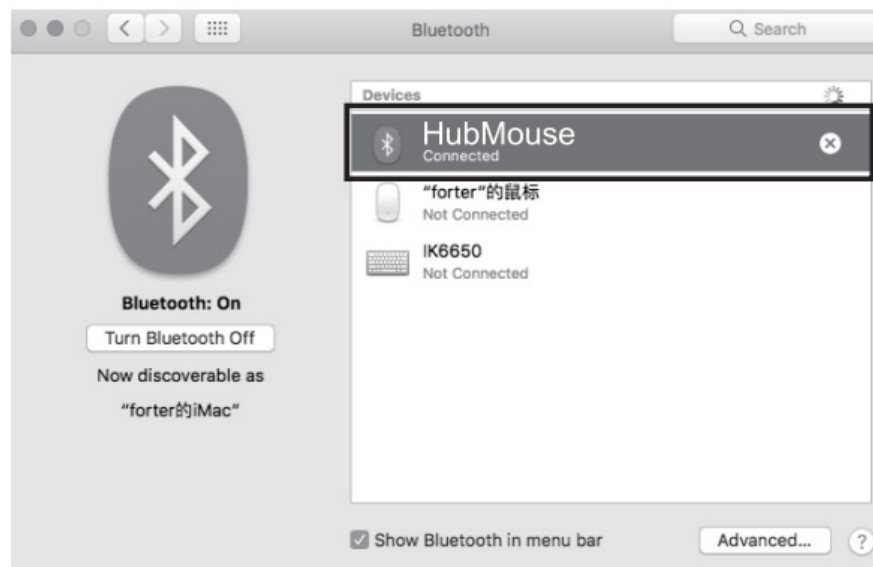

Mode Switch Method

After completing BT1, BT2 and 2.4G connection, short press the mode switch button on the bottom of the mouse to easily switch between devices.

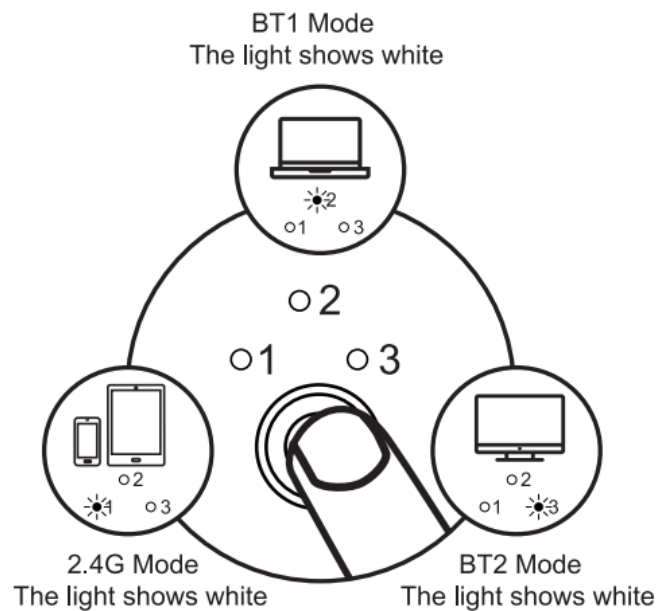

Short press the mode switch button on the bottom of the mouse.

USB Cable Charging

1. Use the included USB cable to charge the mouse when the battery is low.

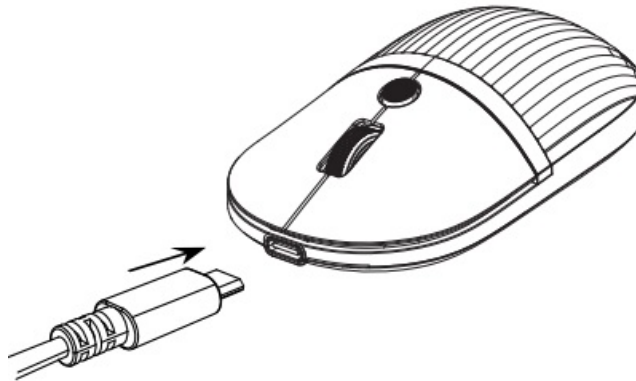

2. Plug the USB charging cable into the USB port of your computer, the light on the bottom shows red while charging, the charging process is about 4-6 hours (The light flashes red when the battery voltage is 3.7V, at this time the battery needs to be charged, the light turns red while charging and will be off after fully charged).

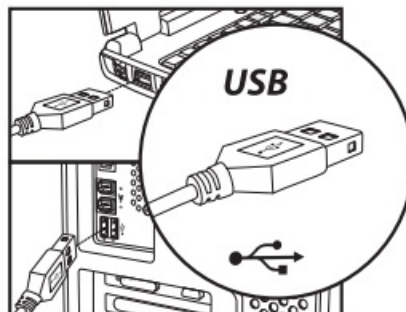

Main Specifications

- Chip: Nordic NRF51802
- Engine: Optical
- Mouse DPI: 1000/1600/2400 dpi

- Mouse Button Life: Over 3 million times click
- Capacitance capacity: 300mAh/3.7V
- Mouse Size: 109*61*31mm
- Mouse Weight: 79g

2.4GHz Transmission Main Specifications:

- Transmission Distance: 10 meters
- Working Voltage: 3.7V
- Working Current: 6.0\$0.5mA
- Mouse Polling Rate: 250Hz

Bluetooth Transmission Main Specifications:

- Transmission Distance: 10 meters
- Working Voltage: 3.7V
- Working Current: 6.0\$0.5mA
- Mouse Polling Rate: 125Hz

System Requirement:

- Bluetooth Receiving Device, USB port
- Windows 8 / Windows 10 Version or above
- Mac OS X 10.10 Version or above
- Android 4.3 Version or above

Package Contents

- 1 × Mouse
- 1 x HUB
- 1 x USB Charging Cable
- 1 × User Manual

Documents / Resources

<div>ProtoArc</div> <div>User Manual HubMouse</div> <div>support@protoarc.com www.protoarc.com</div>	<div>ProtoArc HubMouse USB C Wireless Bluetooth Mouse [pdf] User Manual</div> <div>HubMouse USB C Wireless Bluetooth Mouse, HubMouse, USB C Wireless Bluetooth Mouse, Wireless Bluetooth Mouse, Bluetooth Mouse</div>
---	---

References

- [User Manual](#)

[Manuals+.](#) [Privacy Policy](#)

This website is an independent publication and is neither affiliated with nor endorsed by any of the trademark owners. The "Bluetooth®" word mark and logos are registered trademarks owned by Bluetooth SIG, Inc. The "Wi-Fi®" word mark and logos are registered trademarks owned by the Wi-Fi Alliance. Any use of these marks on this website does not imply any affiliation with or endorsement.