



# ProtoArc EM13 Wireless Ergonomic Vertical Mouse User Manual

[Home](#) » [ProtoArc](#) » ProtoArc EM13 Wireless Ergonomic Vertical Mouse User Manual 

# ProtoArc

EM13

User Manual

2.4G+Bluetooth+Bluetooth Wireless  
Rechargeable Left-Handed Vertical Mouse

## Contents

- [1 Product Featured](#)
- [2 2.4G USB Connection](#)
- [3 Bluetooth Connection](#)
- [4 How to Switch Connection Mode](#)
- [5 How to Charge the Mouse](#)
- [6 Specifications](#)
- [7 Package List](#)
- [8 Documents / Resources](#)
  - [8.1 References](#)

## Product Featured

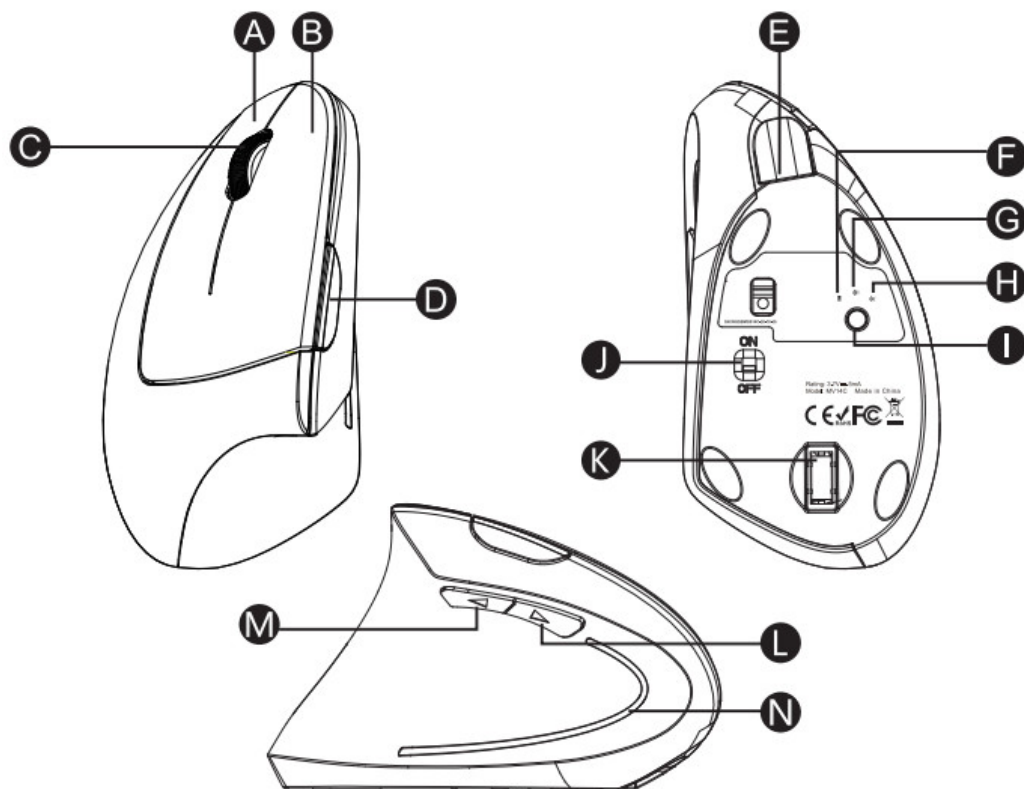

- A. Right Button
- B. Left Button
- C. Scroll Wheel Button
- D. DPI Switch Button
- E. Type-C Charging Port
- F. 2.4G Indicator
- G. Bluetooth 1 Indicator
- H. Bluetooth 2 Indicator
- I. Mode Switch Button
- J. Power Switch
- K. USB Receiver
- L. Forward Button
- M. Backward Button
- N. Low-Power Indicator Light / DPI Indicator Light

## 2.4G USB Connection

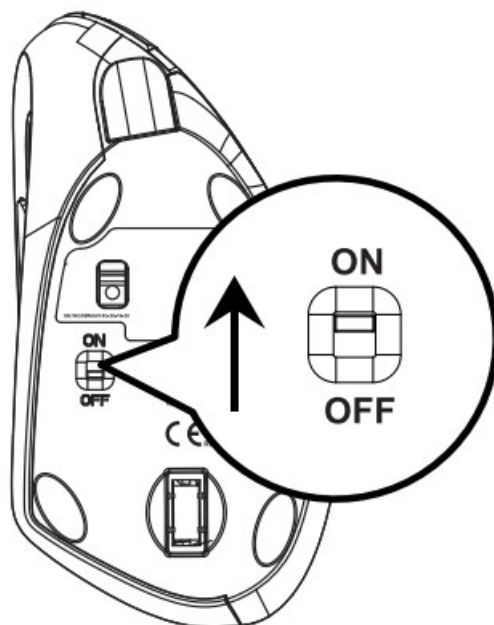

1. Turn on the power switch to ON

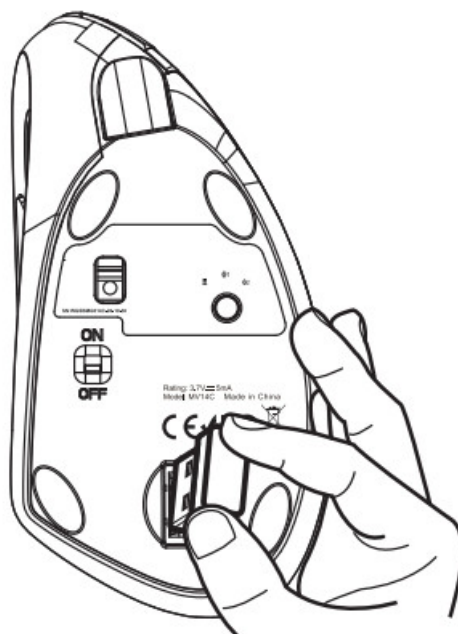

2. Take out the USB receiver

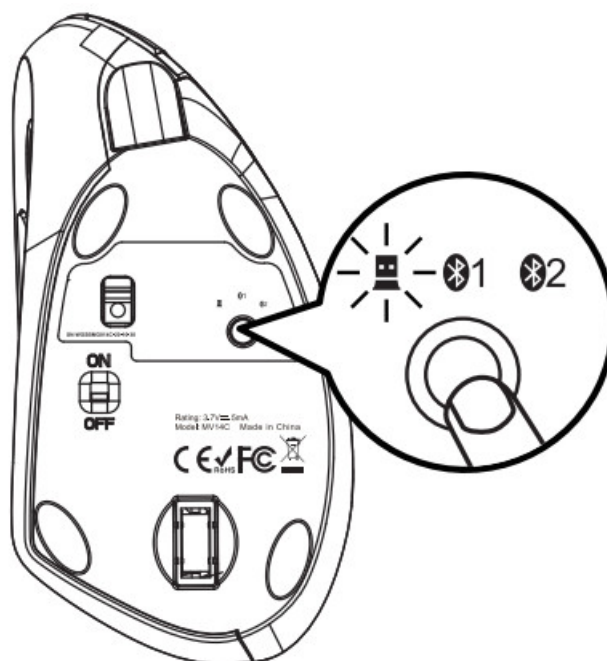

2. Press the Mode Switch Button until white light is on, enter 2.4G USB mode

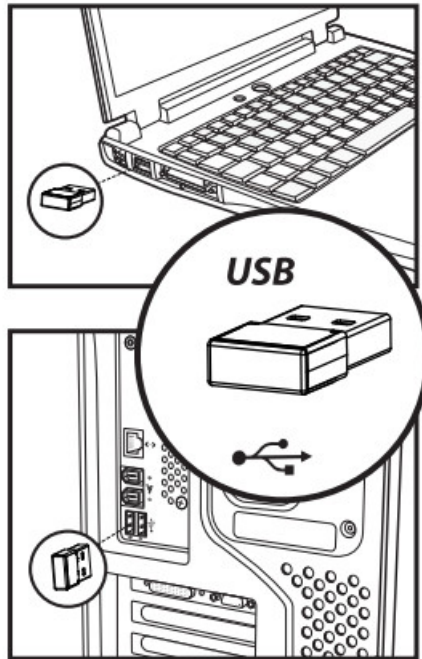

3. Plug USB receiver into the USB port of the computer

### Bluetooth Connection

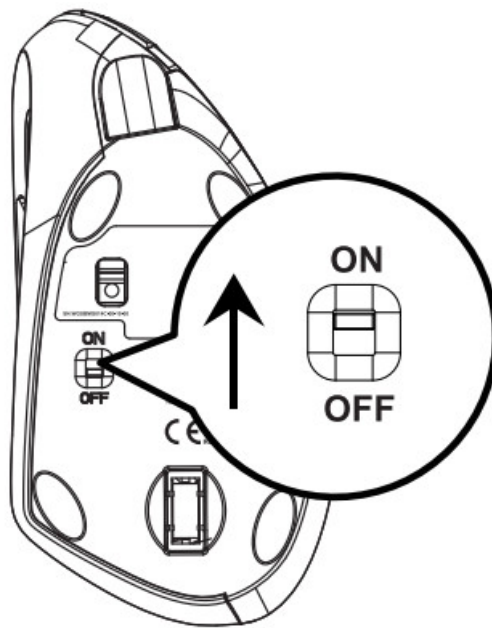

1. Turn on the power switch to ON

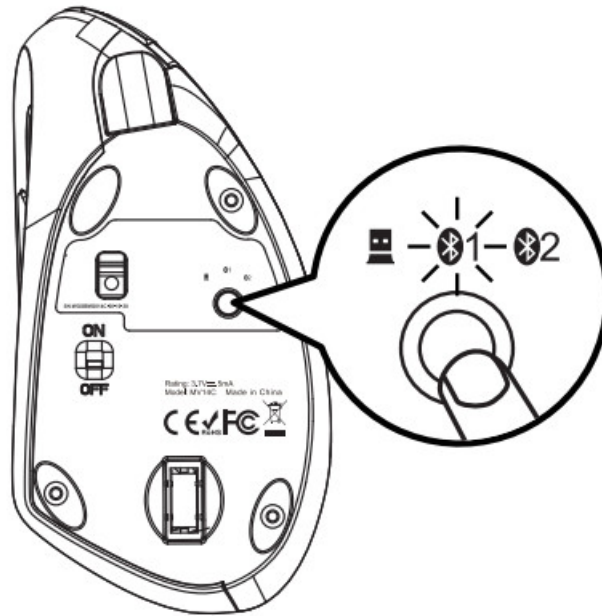

2. Press the Mode Switch Button to switch ❶ or ❷ at this time the white light flashes slowly.

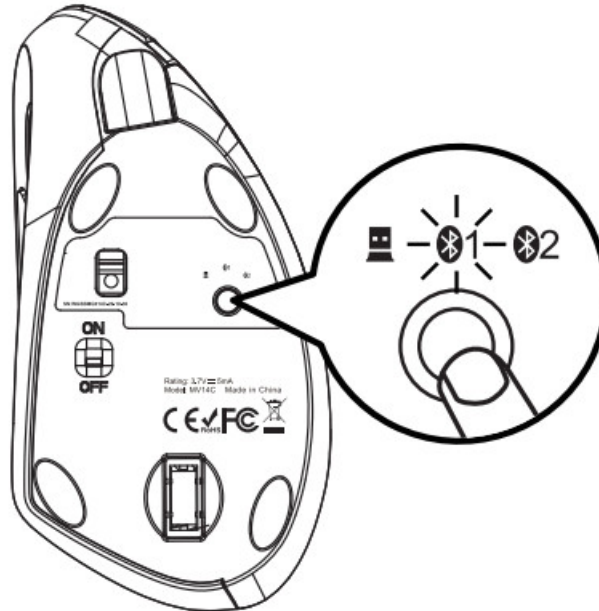

3. Long press the Mode Switch Button for 310 5 seconds, until the white light flashes quickly, enter the Bluetooth paying mode.

## Windows 10 System

- 4 Click "Bluetooth Device" on your computer



- 5 Click "Add or Delete Bluetooth Devices"

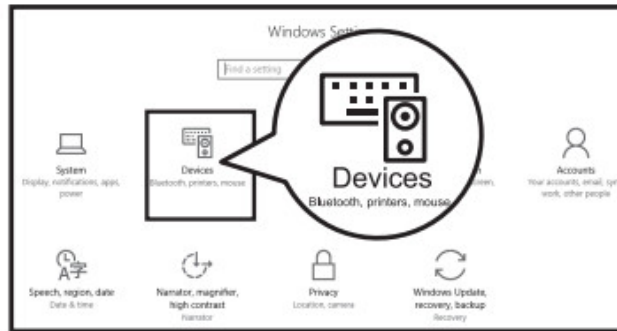

- 6 Bluetooth search for "ProtoArc EM13", click "Pair"

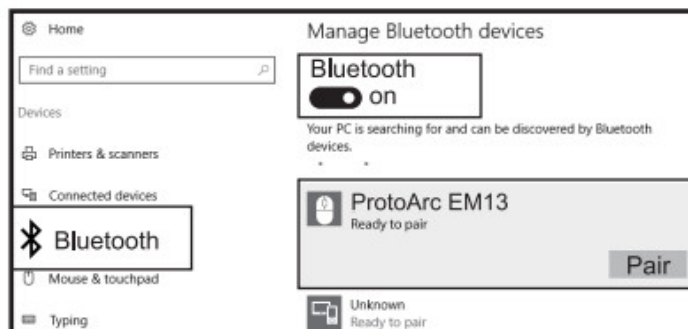

- 7 "ProtoArc EM13" is "Connected", can be used normally

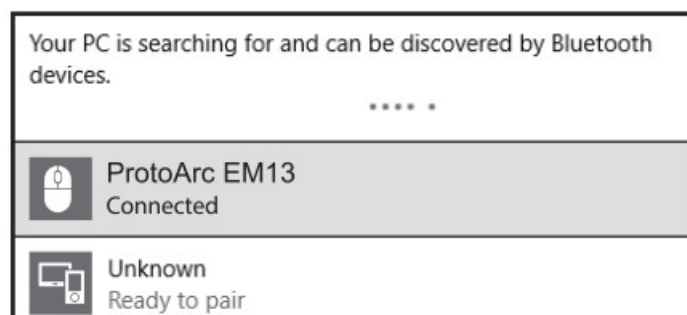

## Mac OS System

Please complete step 1, 2 and 3 in \* Bluetooth Connection Before pairing,

- ④ Click "System Preferences" on Mac



- ⑤ Click "Bluetooth" in "System Preferences"



- ⑥ Bluetooth search for "ProtoArc EM13" and click "Pair" to complete the installation, the mouse can be used normally



## iOS System

The mouse function is only supported by systems above iOS 13

Please complete step 1, 2 and 3 in \* Bluetooth Connection Before pairing

4 Click "Settings" on your device and turn on "Accessibility"

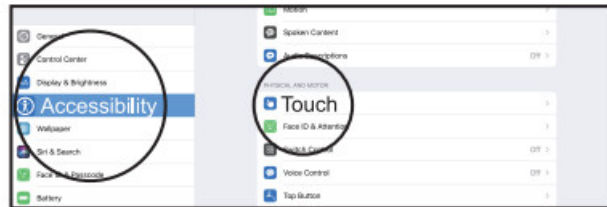

5 Click "Touch"



6 Turn on "AssistiveTouch"



7 Click "Settings" on your device and turn on "Bluetooth"



8 Bluetooth search for "ProtoArc EM13" and click "Pair" to complete the pairing process



9 "ProtoArc EM13" is "Connected" , the mouse can be used normally

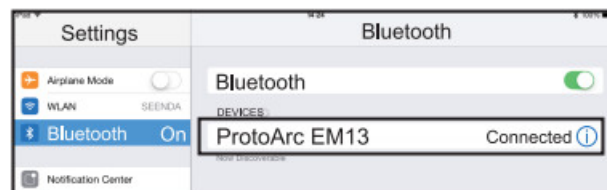

## Android System

Please complete step 1, 2 and 3 in ' Bluetooth Connection Before pairing



- 4 Click "Settings" on your device and turn on "Bluetooth"

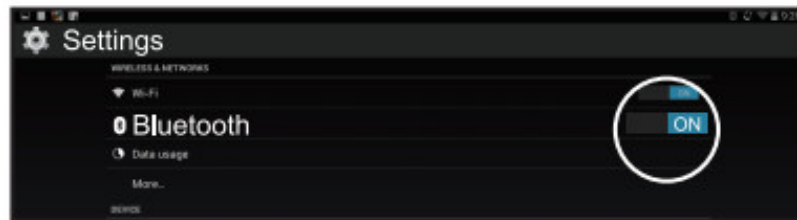

- 5 Bluetooth search for "ProtoArc EM13" and click "Pair" to complete the pairing process

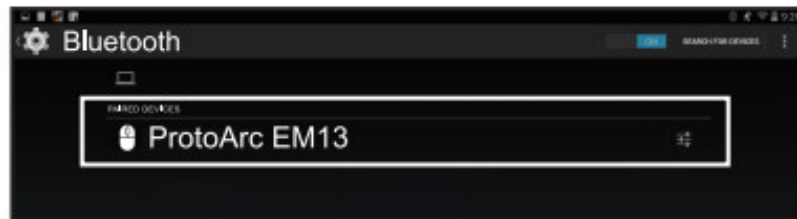

- 6 "ProtoArc EM13" is "Connected", the mouse can be used normally

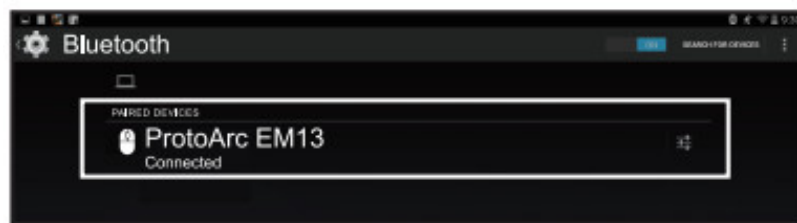

## How to Switch Connection Mode

After Bluetooth and USB wireless mode is connected, press USB / Bluetooth mode switch button to switch between different devices. One press can only switch mode once. You may need o press it twice to get the mode you want.

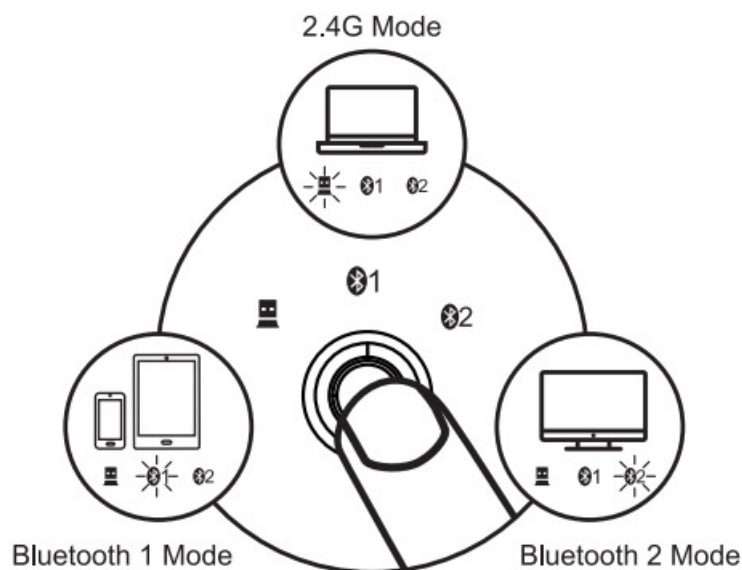

Press USB / Bluetooth mode switch button

## How to Charge the Mouse

1. When the battery power is low, please charge the mouse with the included USB charging cable (by inserting the USB charging cable into USB port of the **computer**).

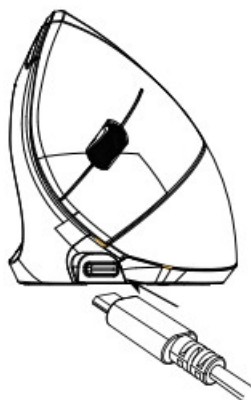

**Note:** Best to use original data transmission cable.

2. While charging, power indicator turns blue. A full charge cycle takes about 1-2 hours and the indicator light will automatically shuts off when charging is complete.

Also, when the battery power is too low (around 3.4V), the red indicator will flash

Press DPI Switch Button first level indicator light flashes once, Second level indicator light flashes twice, Third level indicator light flashes three times.

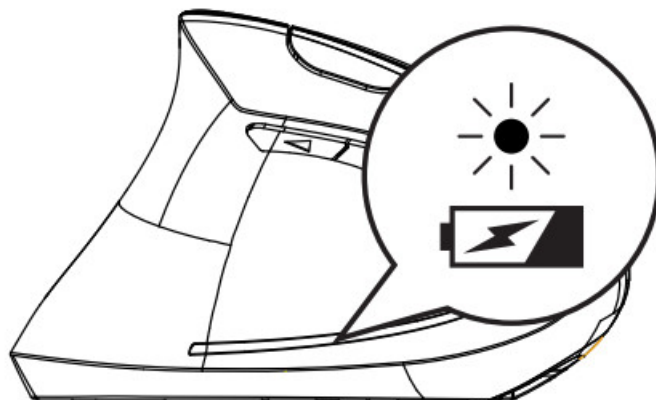
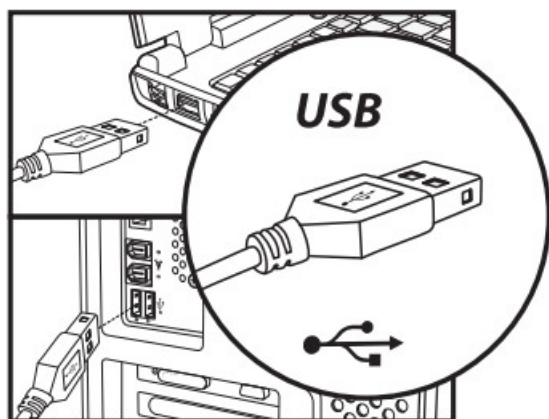

## Specifications

### Basic Parameter:

Chip: Nordic NRF51802

Engine: optics

Li-on Battery: 300mAh

DPI level: 1000-1600-2400DPI

Click life: more than

3 million times

Dimension: 120.5 x 63.4 x 76mm

Weight: 125g

### Bluetooth Connection Parameter:

Bluetooth version: 4.0

Working distance: 10m

Voltage: 3.7V

Current: 4mA

Report rate: 90Hz

System requirement:

Bluetooth-enable device

Windows 8, Windows 10

Mac Os X 10.12 or higher version  
Android 4.3 or higher version  
**2.4G Wireless Connection Parameter:**  
Working distance: 10m  
Voltage: 3.7V  
Current: 5.5mA  
Frequency: 125Hz  
System requirement:  
Device with USB port  
Windows XP, Window 7,  
Windows 8, Windows 10;  
Mac OS X 10.12 or higher version

## Package List

- 1x Wireless Mouse
- 1x Type-C Charging Cable
- 1x USB Receiver
- 1 x User Manual



---

## Documents / Resources

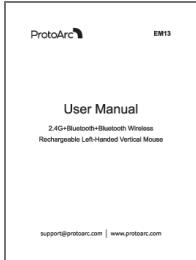
 The image shows the front cover of the ProtoArc EM13 User Manual. It features the ProtoArc logo at the top left, the model number "EM13" at the top right, and the title "User Manual" in the center. Below the title, it lists the product features: "2.4G+Bluetooth+Bluetooth Wireless" and "Rechargeable Left-Handed Vertical Mouse". At the bottom, it provides the contact information "support@protoarc.com   www.protoarc.com".	<p><a href="#">ProtoArc EM13 Wireless Ergonomic Vertical Mouse</a> [pdf] User Manual</p> <p>EM13 Wireless Ergonomic Vertical Mouse, EM13, Wireless Ergonomic Vertical Mouse, Ergonomic Vertical Mouse, Vertical Mouse, Mouse</p>
--	--

## References

- [User Manual](#)