



ProtoArc EM04 Wireless Rechargeable Trackball Mouse User Manual

[Home](#) » [ProtoArc](#) » ProtoArc EM04 Wireless Rechargeable Trackball Mouse User Manual 

ProtoArc EM04 Wireless Rechargeable Trackball Mouse

Contents

- [1 Product Features](#)
- [2 2.4G USB Connection](#)
- [3 Bluetooth Connection](#)
- [4 Windows 10 System](#)
- [5 Mac OS System](#)
- [6 iOS System](#)
- [7 Android system](#)
- [8 Charging Function Guide](#)
- [9 How to switch connection mode](#)
- [10 Data parameters](#)
- [11 What's in Package](#)
- [12 Customer Support](#)
- [13 Documents / Resources](#)
- [14 Related Posts](#)



Product Features

- A** Left Button
- B** Right Button
- C** Forward Button
- D** Backward Button
- E** Trackball
- F** Scroll Wheel
- G** DPI Button
- H** Charging / DPI Indicator
- I** TYPE-C Charging Port
- J** Wireless 2 Indicator
- K** Wireless 1 Indicator
- L** 2.4G Indicator
- M** Switch Device Button
- N** Power Switch
- O** USB Receiver

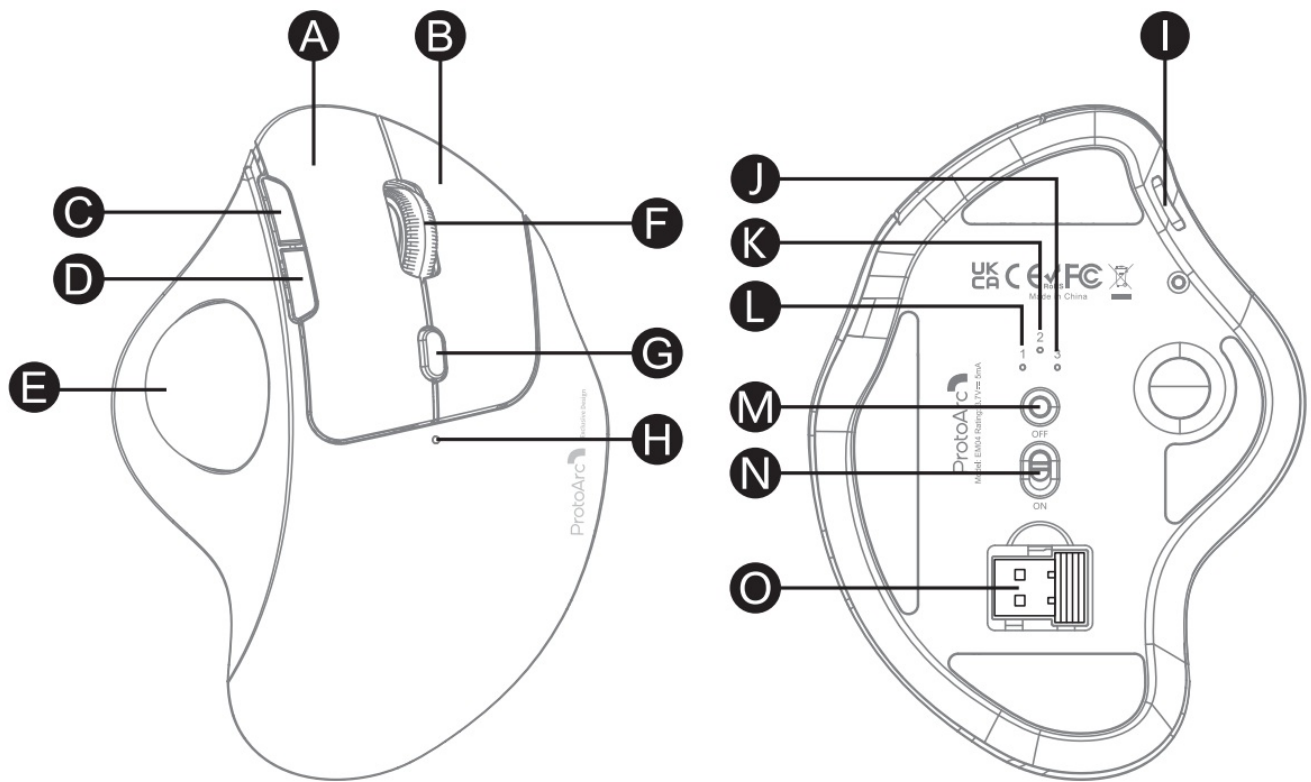

2.4G USB Connection

1. Turn on the power switch to ON.

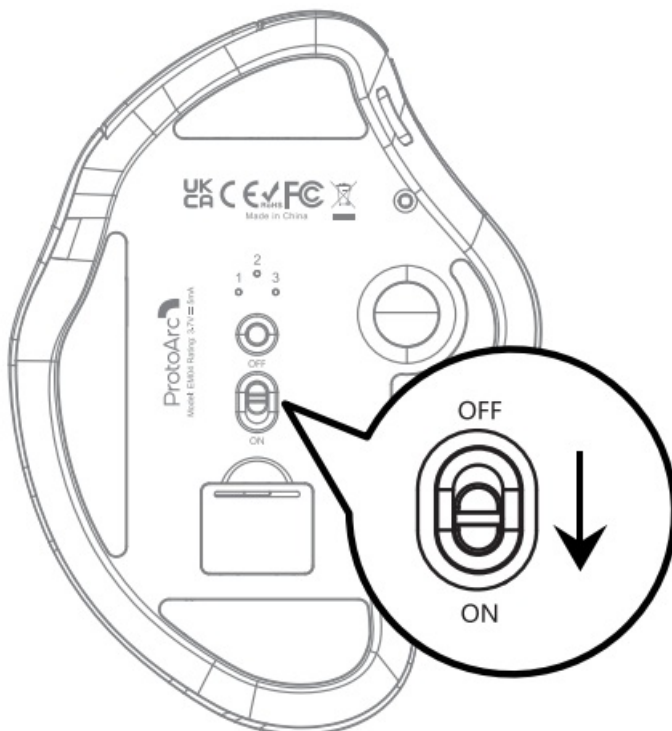

2. Take out the receiver.

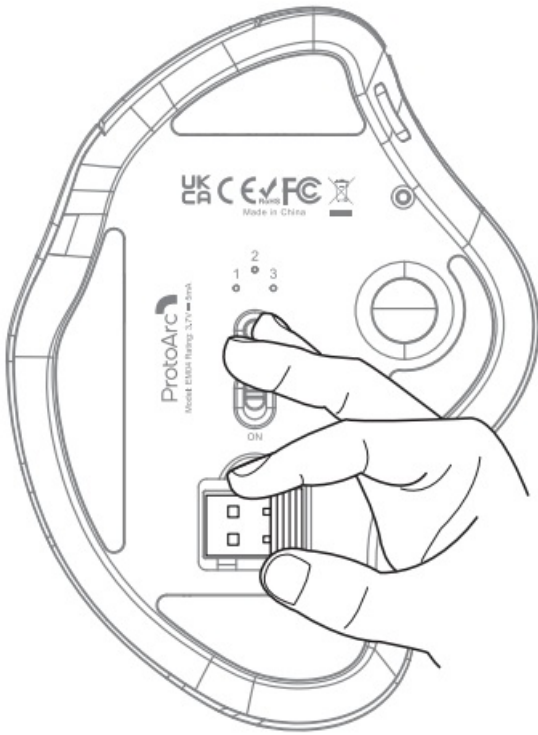

3. Press the mode switch button until the white light 1 is on and enter 2.4G mode.

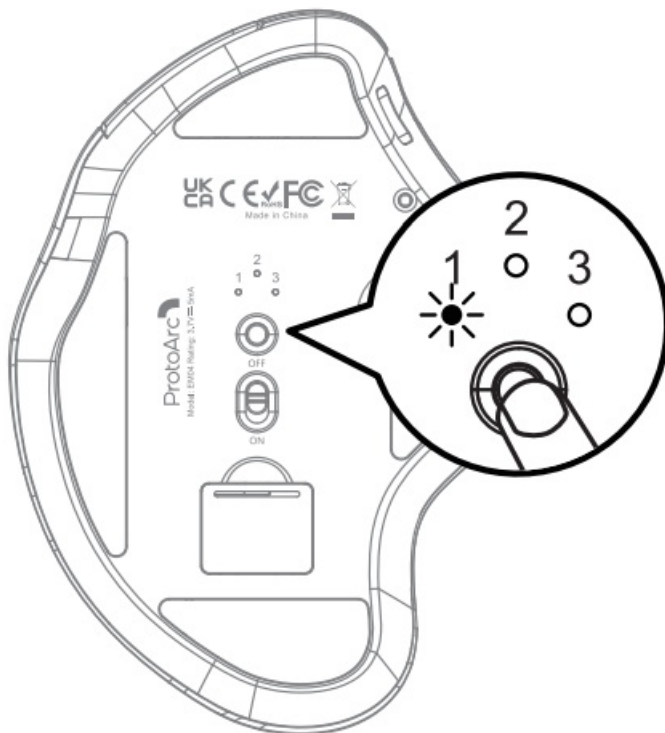

4. Insert the usb receiver into your computer's usb port.

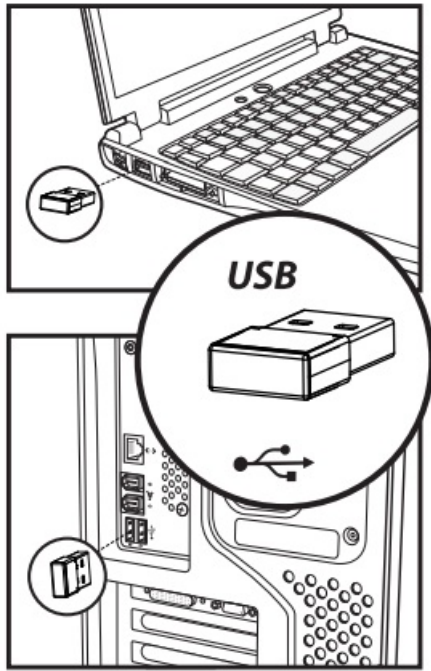

Bluetooth Connection

1. Turn on the power switch to ON.

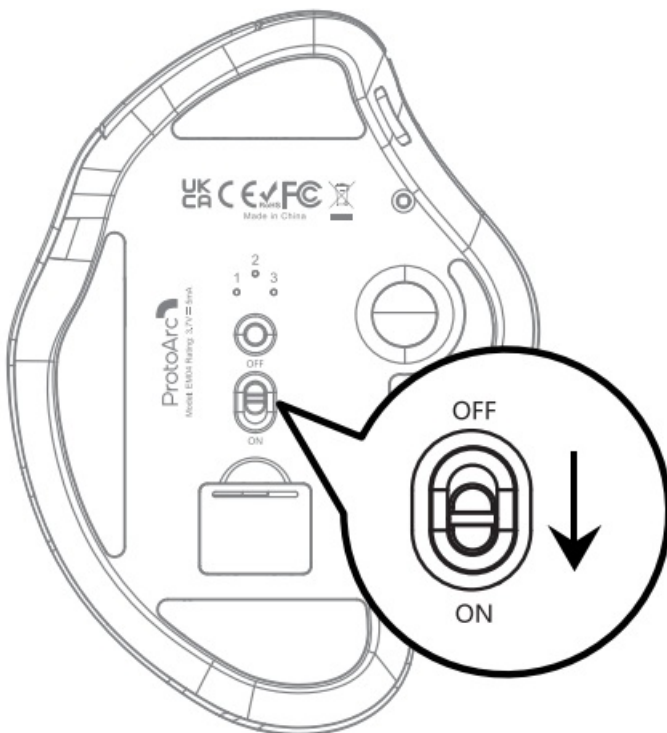

2. Press the mode switch button and switch to 2 or 3 mode, the white light flashes slowly.

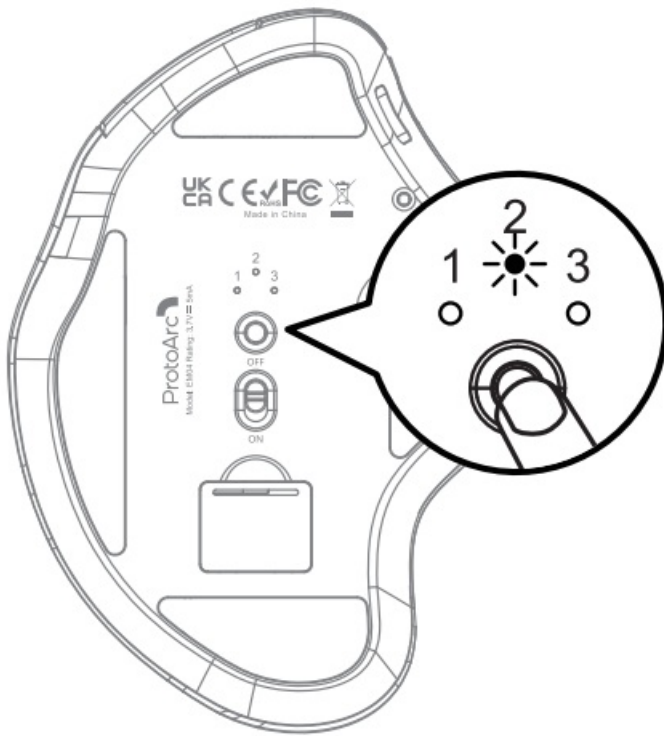

3. Press and hold the mode switch button for 3-5 seconds until the white light flashes quickly, then the mouse enters the Bluetooth pairing mode.

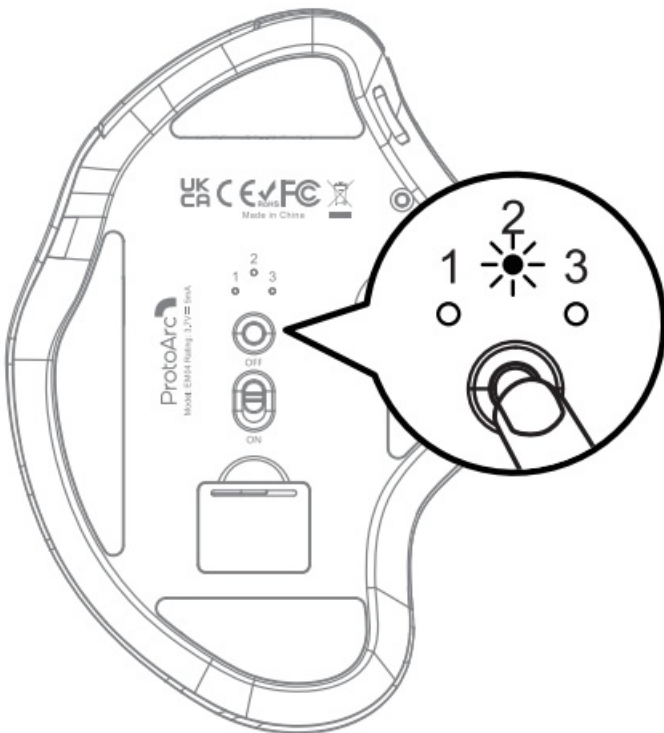

Windows 10 System

4. Click "Bluetooth device".



5. Click “Add or remove a Bluetooth device”.

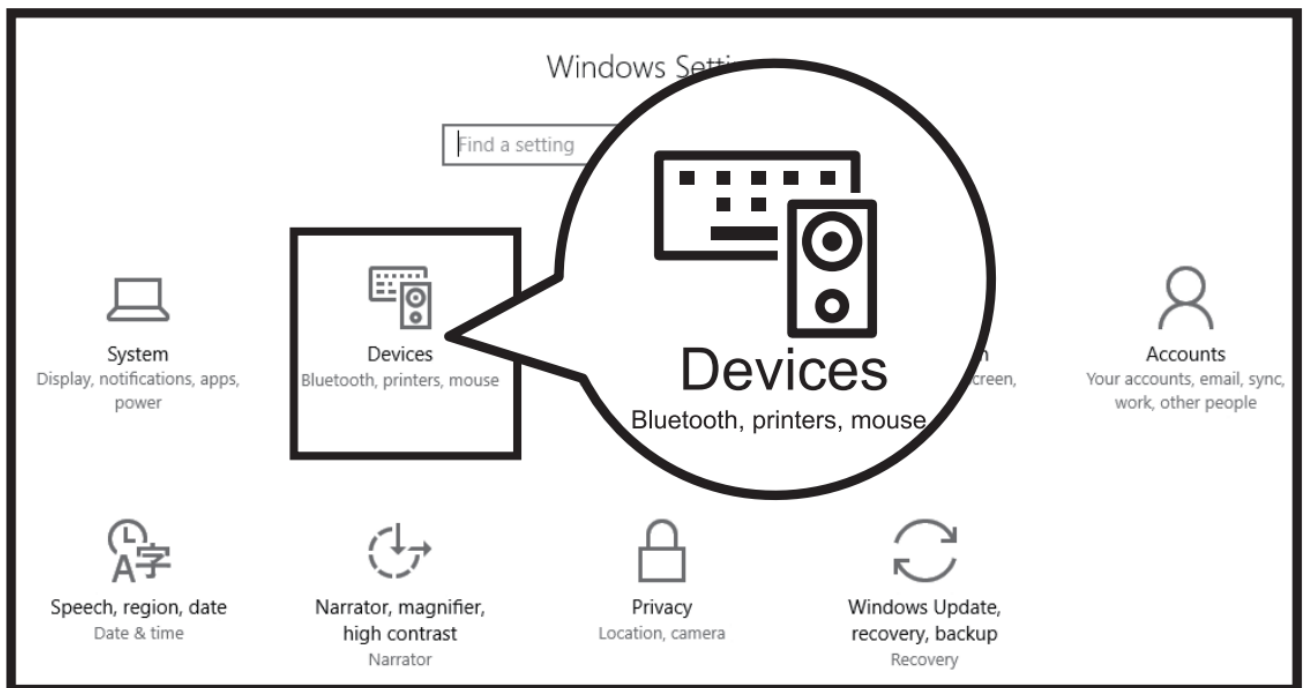

6. Your computer will automatically search for “ProtoArc EM04” and then click “pair”.

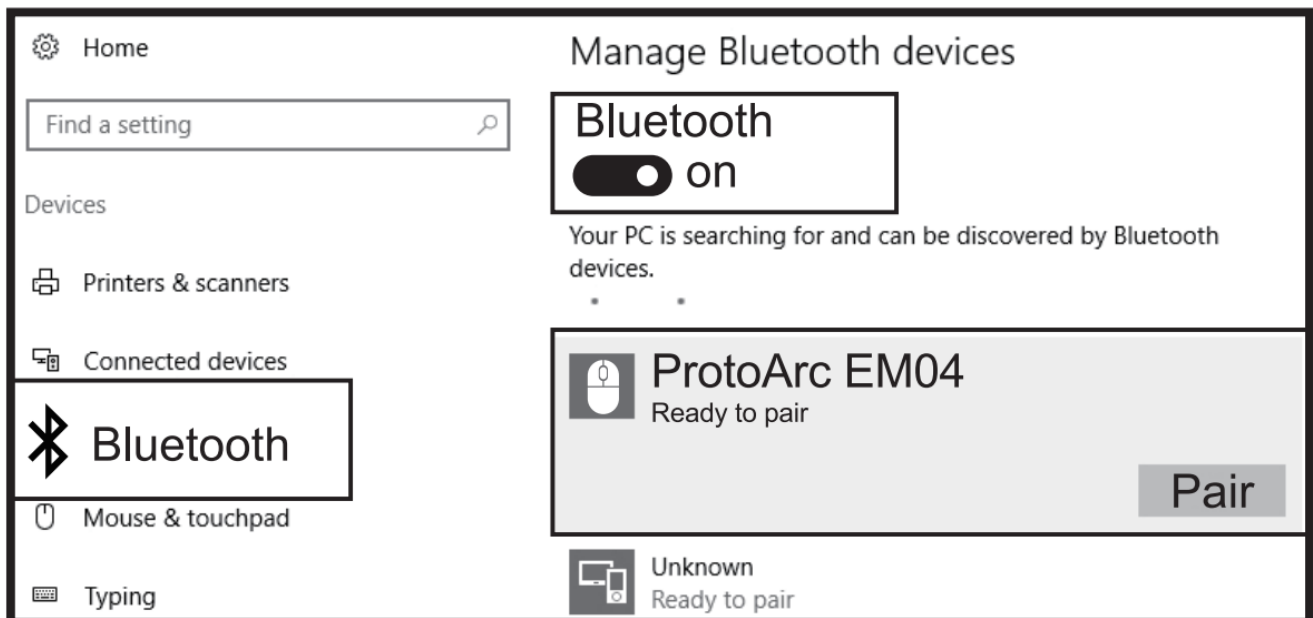

7. “ProtoArc EM04” is connected and can be used normally.

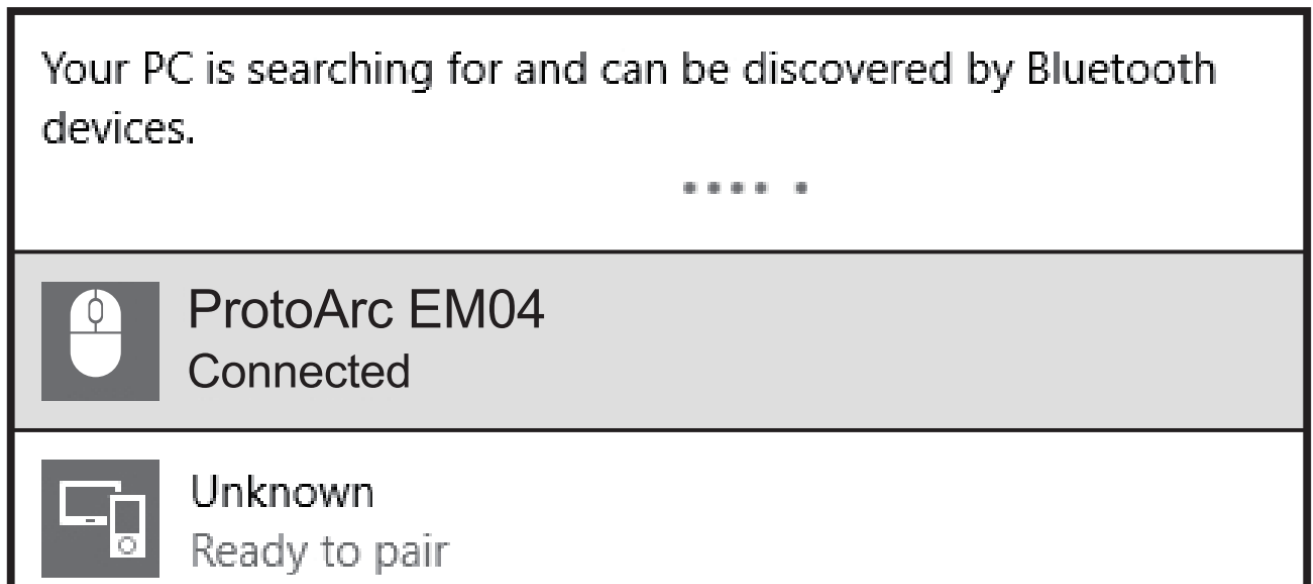

Mac OS System

Please complete the Bluetooth mode installation step 123 before pairing.

1. Click “System Preferences” on Mac.



2. Click “Bluetooth” in “System Preferences”.

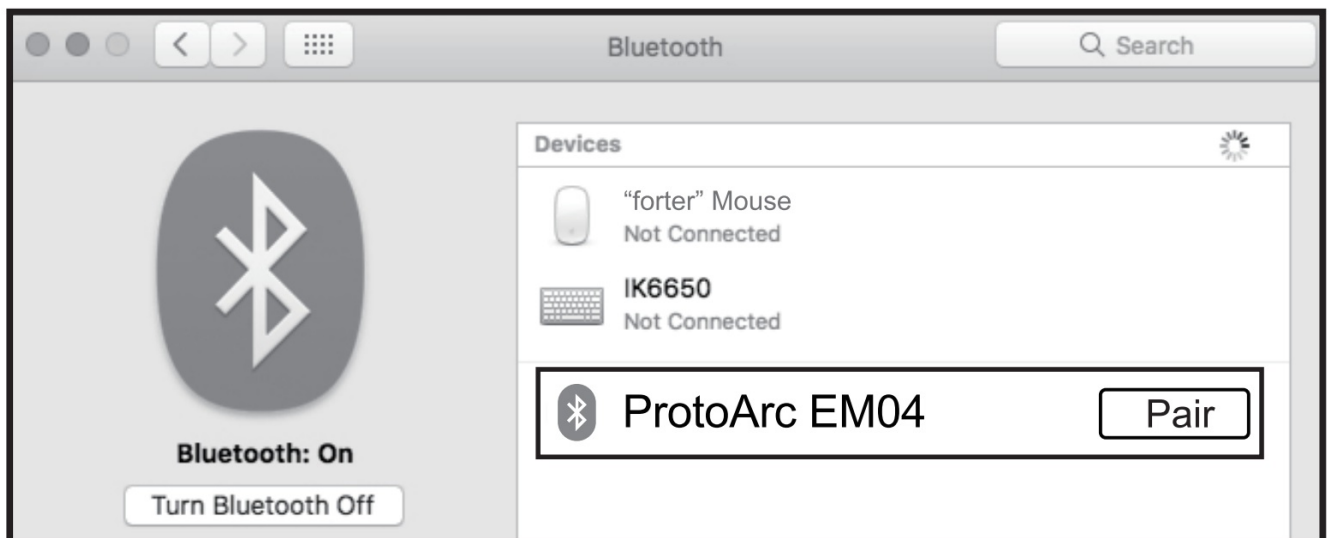

3. Your computer will automatically find “ProtoArc EM04”. then click “pair”, and you can use ii after installation.

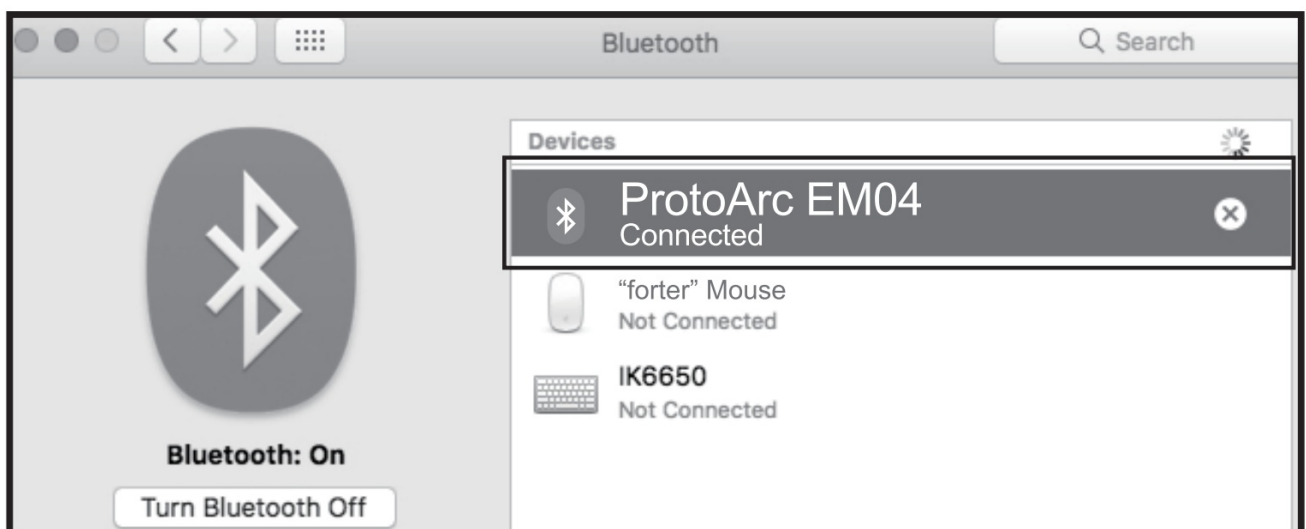

iOS System

Only the system above iOS 13 supports the mouse function.

Please complete the Bluetooth mode installation step 123 before pairing.

1. Click Settings on your device, then turn on Accessibility.

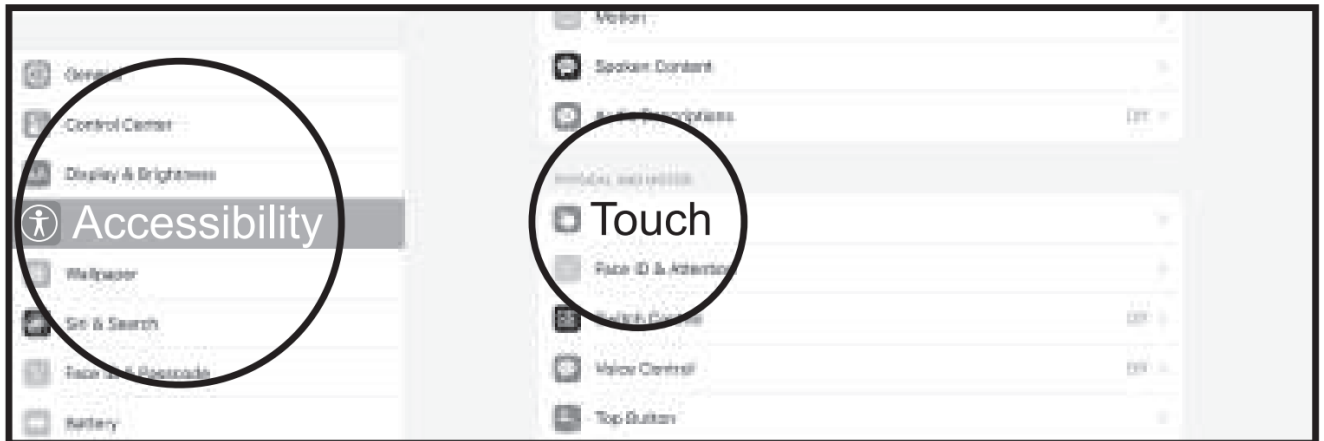

2. Click Touch.

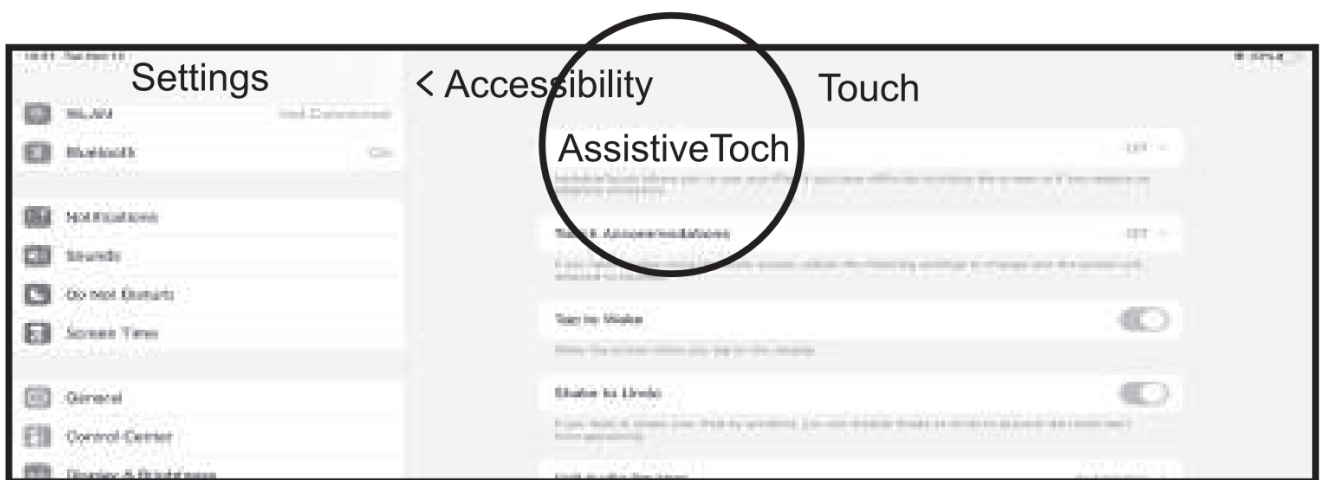

3. Turn on Assistive Touch.

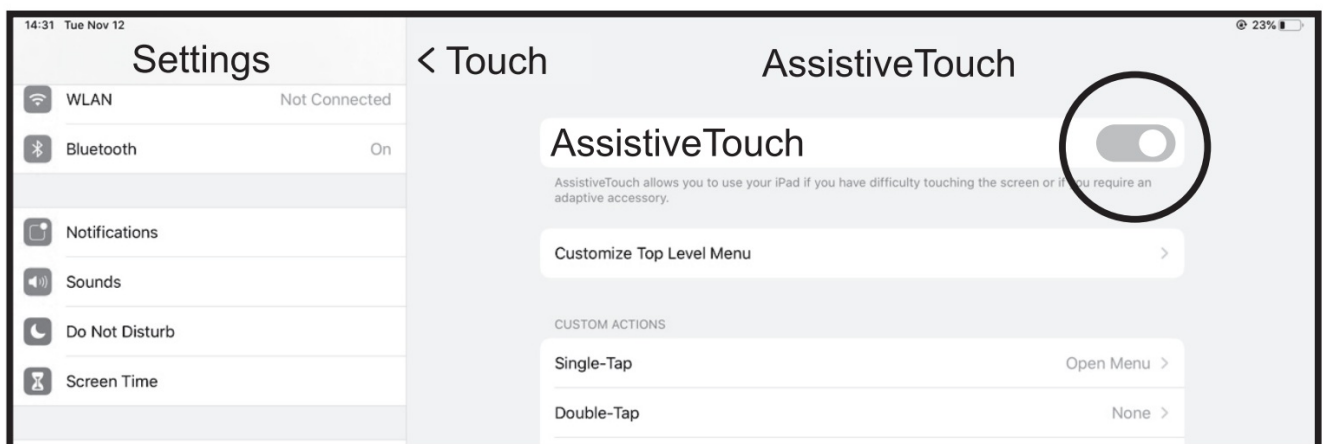

4. Click Settings on the device, then turn on Bluetooth.

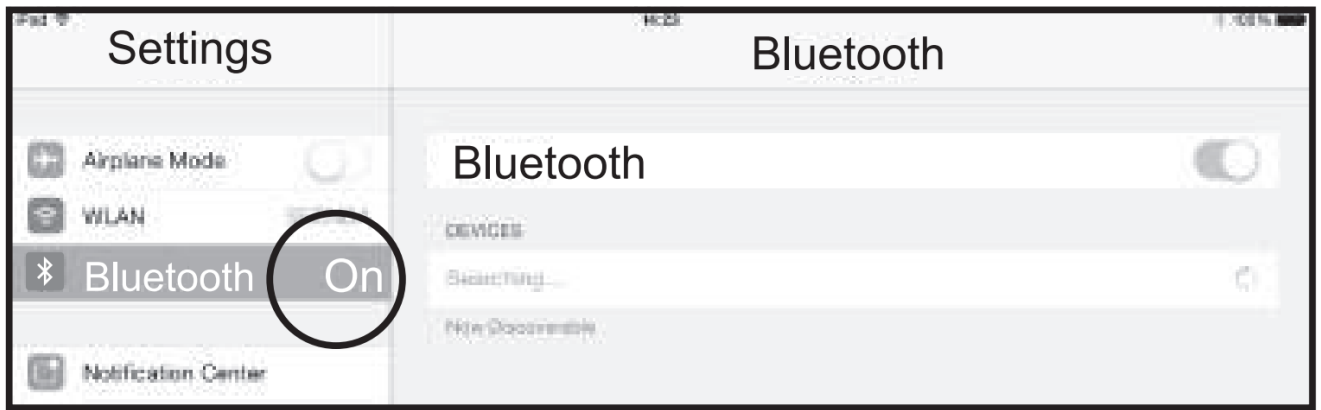

5. Your computer will automatically find “ProtoArc EM04”, then click “Pair”, complete pairing.

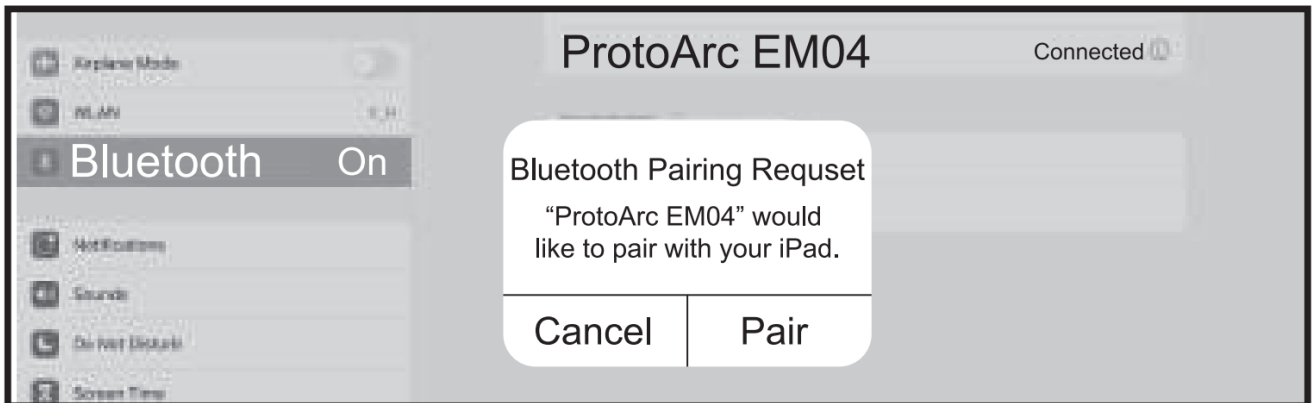

6. “ProtoArc EM04” is connected and can be used normally.

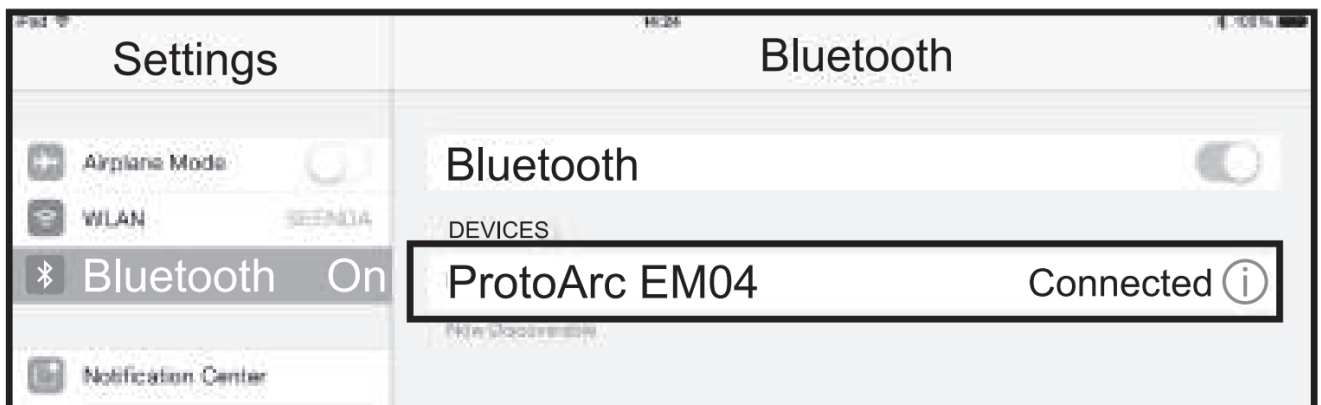

Android system

Please complete the Bluetooth mode installation step 123 before pairing.

1. Click Settings on the device, then turn on Bluetooth



2. Your computer will automatically find “ProtoArc EM04”, then click “pair”, complete pairing.

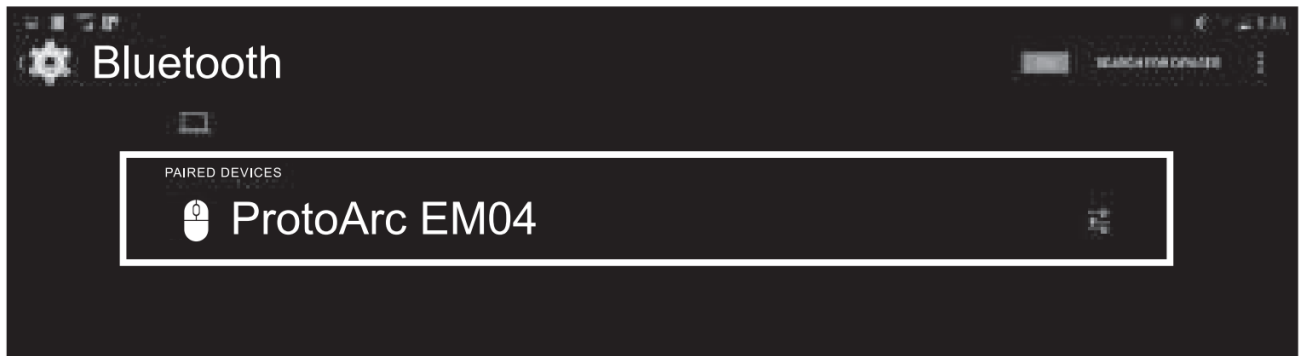

3. “ProtoArc EM04” is connected and can be used normally

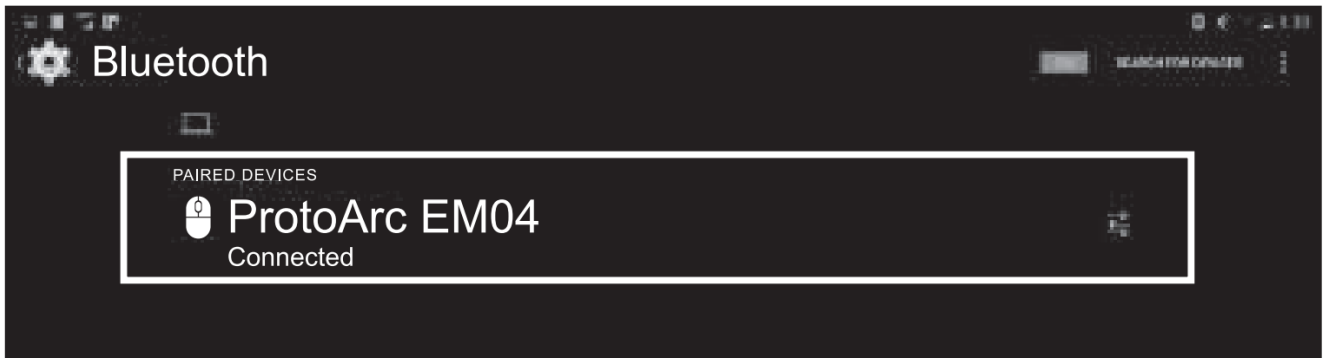

Charging Function Guide

When the power is insufficient, the charging indicator and the corresponding channel indicator flash until it is turned off. Please connect the power supply for charging in time, and use the USB cable to connect the TYPE-C charging Port.

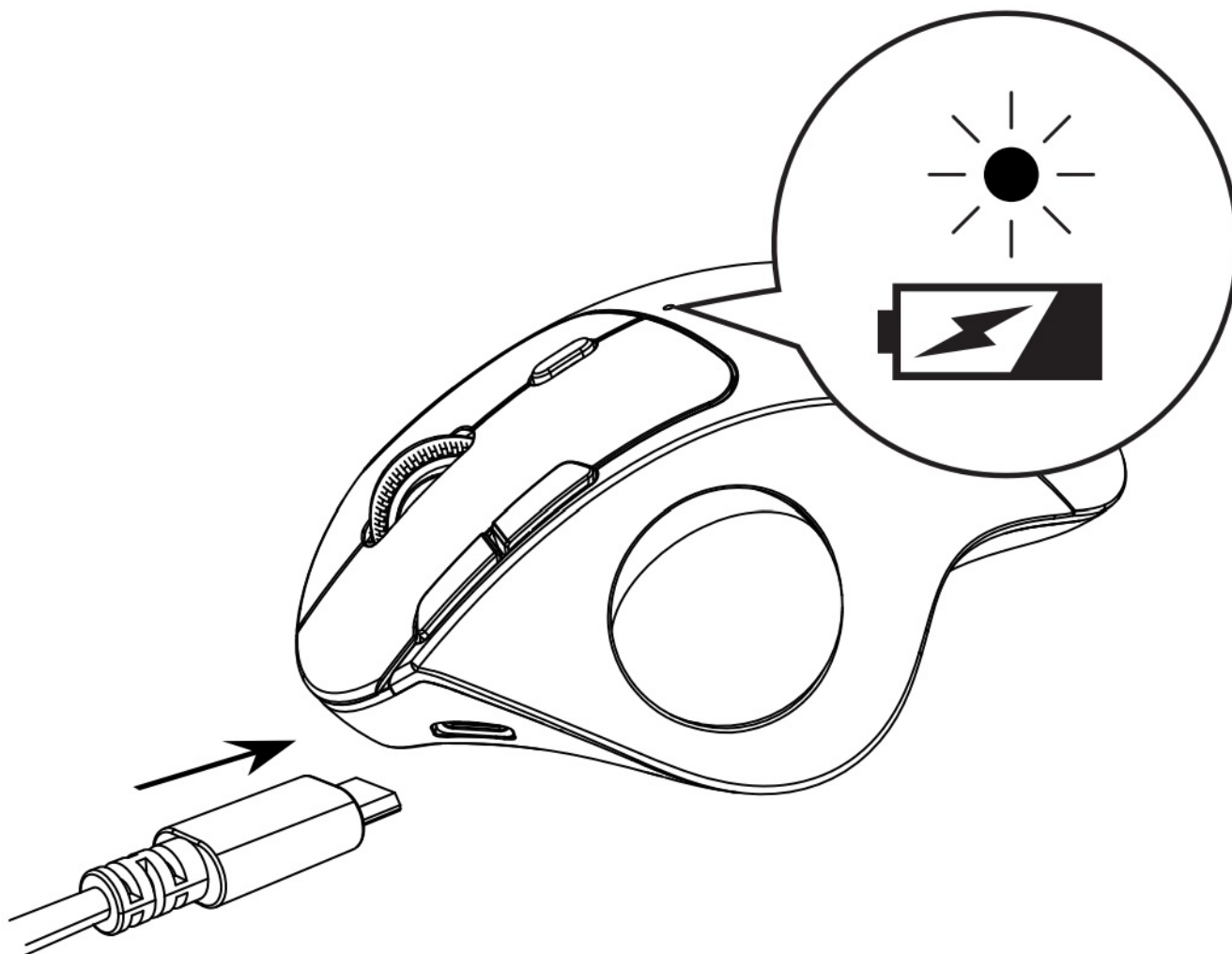

Connect the charging cable to the USB port of the computer, the charging indicator is always on during charging, the charging time is about 1-3.5 hours and the indicator light turns off when charging is complete.

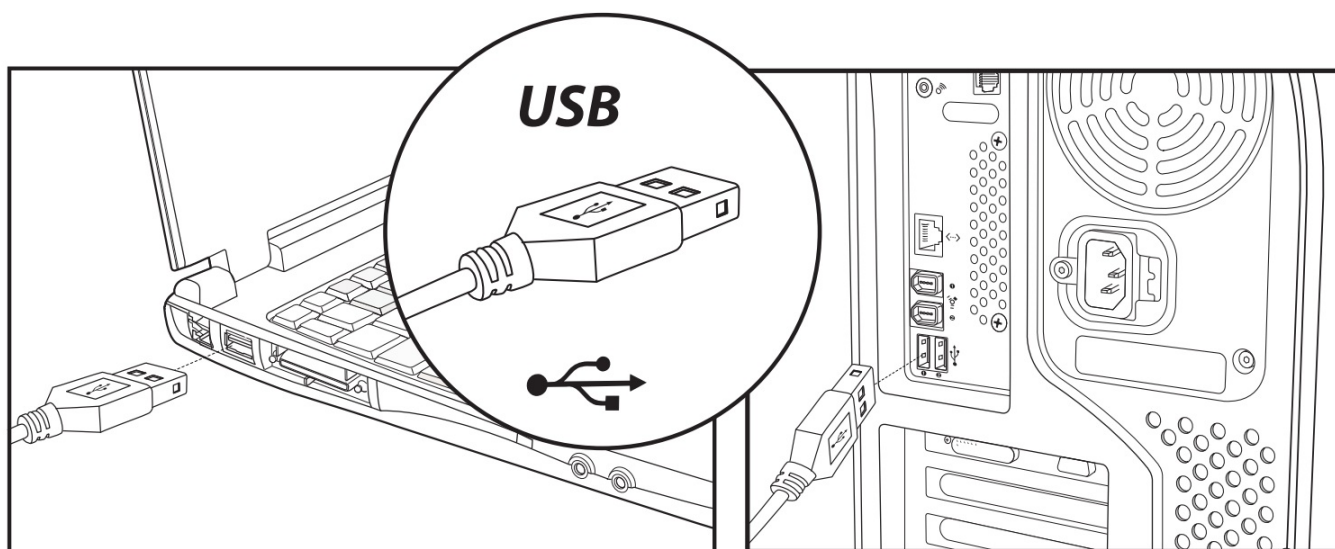

How to switch connection mode

After BT1, BT2 and 2.4G USB mode is connected, press the mode switch button on the top of the mouse to switch between multiple devices.

Wireless 1 Device Connection

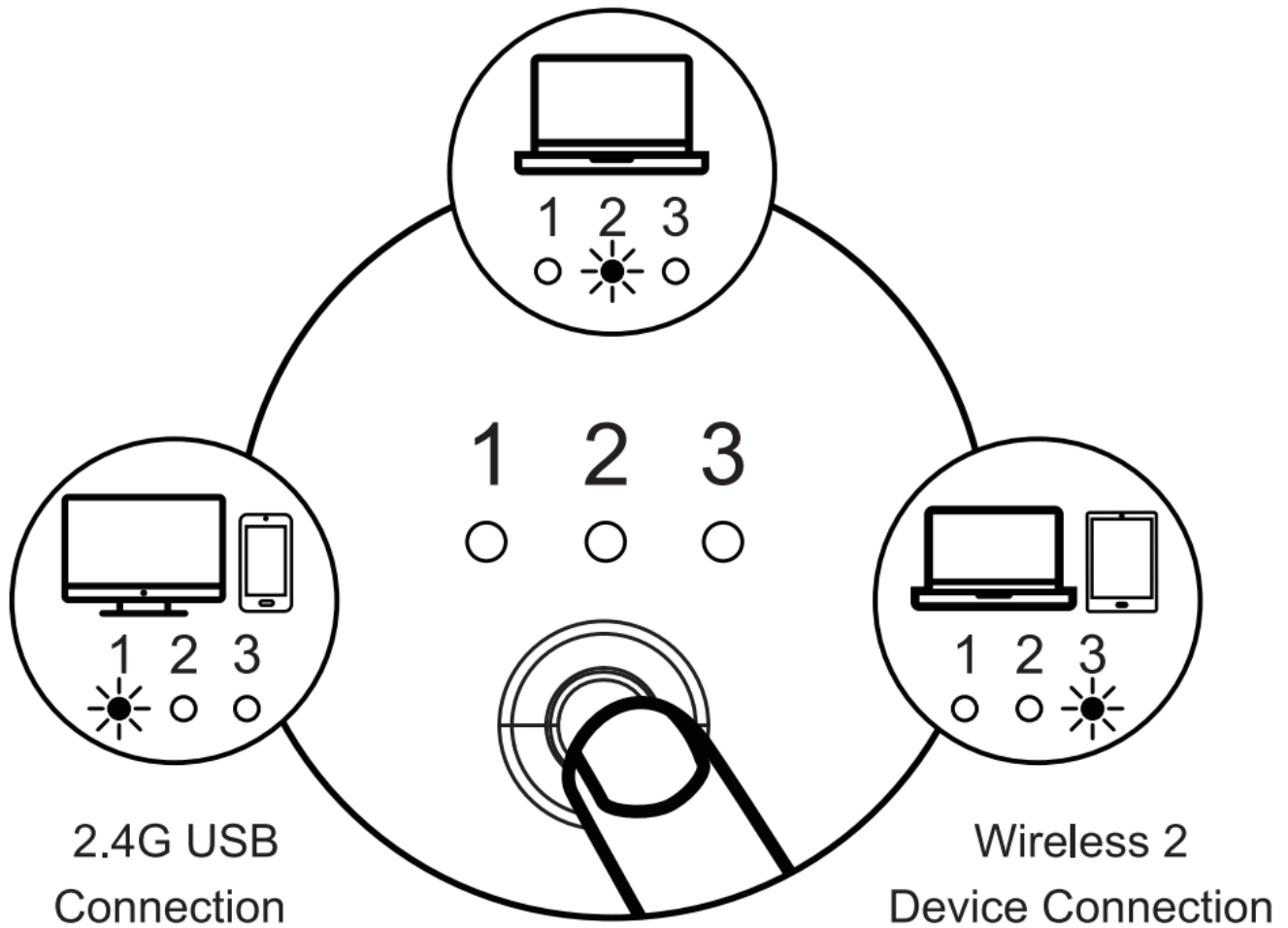

Data parameters

Basic parameter:

Movement Detection Technology: Optical

Lithium Battery Capacity: 300mA

DPI: 200-400-800-1200-1600

Click Life: 3 million+

Dimension: 136.8*100.5*52.3mm

Weight: 119g

Bluetooth transmission parameters:

Transmission distance: 1 Om

Working Voltage: 3. 7V

Working current: 8mA

Reaction rate: 125Hz

System requirement:

Bluetooth-enable device

Windows 8, Windows 10 or higher version

Mac OS x 10.10 or higher version

Android 4.3 or higher version

2.4G transmission parameters:

Transmission distance: 20m

Working Voltage: 3.7V

Working current: 10mA

Reaction rate: 250Hz

System requirement:

An available USB port

Windows XP, Windows 7, Windows 8, Windows 10 or higher version

Mac OS x 10.10 or higher version

What's in Package

- 1 x Wireless Mouse
- 1 x USB Receiver
- 1 x Type C Charging Cable
- 1 x User Manual

Customer Support

support@protoarc.com

www.protoarc.com

ProtoArc

Documents / Resources

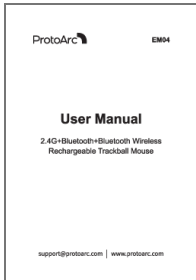
 <p>The image shows the cover of the ProtoArc EM04 User Manual. It features the ProtoArc logo at the top left, the model number EM04 at the top right, and the title 'User Manual' in the center. Below the title, it specifies '2.4G+Bluetooth+Bluetooth Wireless Rechargeable Trackball Mouse'. At the bottom, it provides the contact information 'support@protoarc.com www.protoarc.com'.</p>	<p>ProtoArc EM04 Wireless Rechargeable Trackball Mouse [pdf] User Manual</p> <p>EM04, EM04 Wireless Rechargeable Trackball Mouse, Wireless Rechargeable Trackball Mouse, Rechargeable Trackball Mouse, Trackball Mouse, Mouse</p>
--	---

